

PROJECT REFERENCE NO. <i>R-5921</i>	SHEET NO. <i>UC-21</i>
DESIGNED BY: <i>BCH</i>	
DRAWN BY: <i>KSA</i>	
CHECKED BY:	
APPROVED BY:	
REVISER:	
NORTH CAROLINA DEPARTMENT OF TRANSPORTATION	
UTILITIES ENGINEERING SEC. PHONE: (919) 707-6690 FAX: (919) 250-4151	
<b>UTILITY CONSTRUCTION</b> DOCUMENT NOT CONSIDERED FINAL UNLESS ALL SIGNATURES COMPLETED	

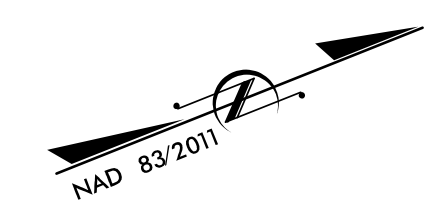

MATCHLINE -L- STA 218 + 00.00  
 MATCH TO SHEET UC-20

MATCHLINE -L- STA. 232 + 00.00  
 MATCH TO SHEET UC-22

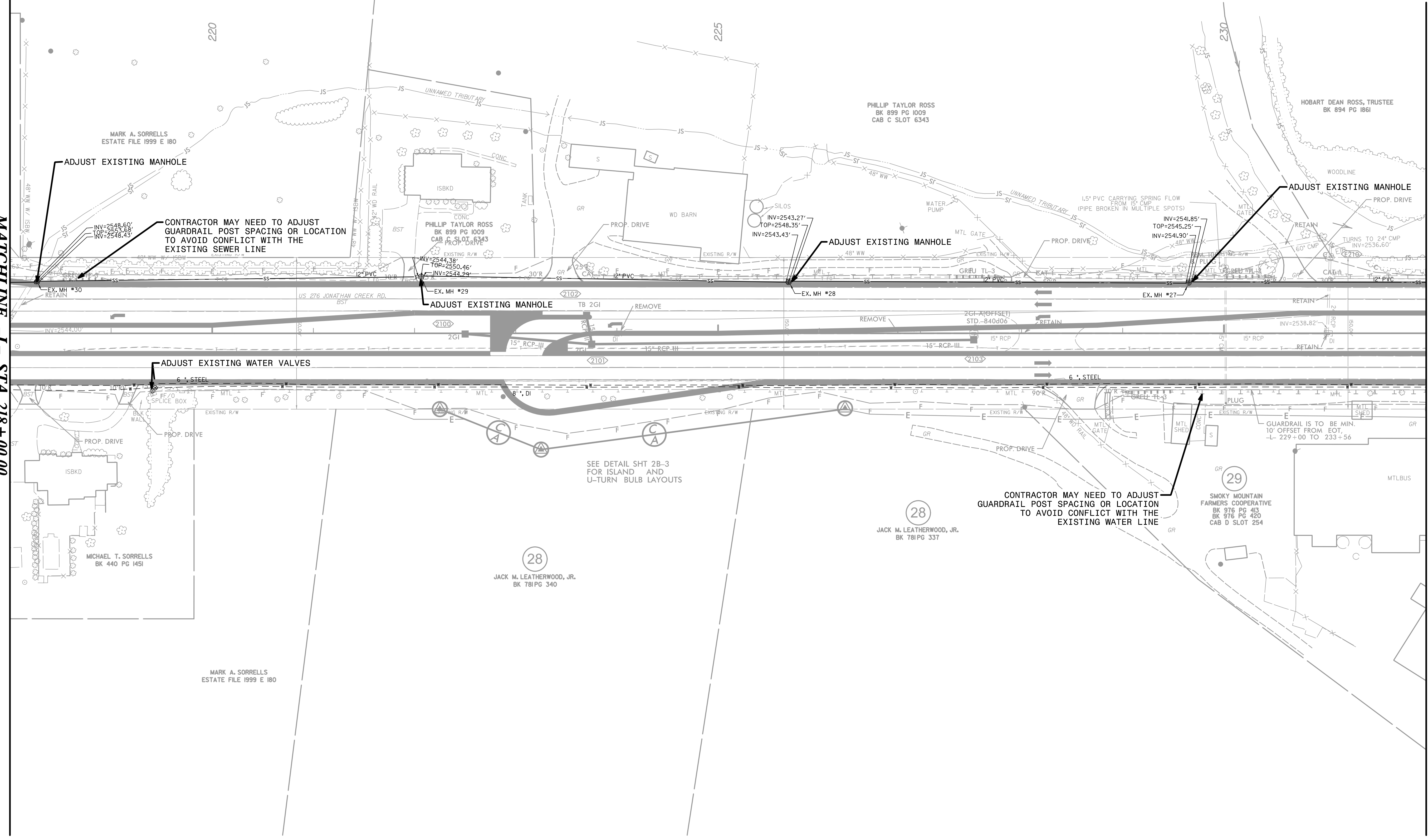

ADJUST EXISTING MANHOLE

CONTRACTOR MAY NEED TO ADJUST  
 GUARDRAIL POST SPACING OR LOCATION  
 TO AVOID CONFLICT WITH THE  
 EXISTING SEWER LINE

ADJUST EXISTING MANHOLE

ADJUST EXISTING MANHOLE

ADJUST EXISTING MANHOLE

ADJUST EXISTING WATER VALVES

CONTRACTOR MAY NEED TO ADJUST  
 GUARDRAIL POST SPACING OR LOCATION  
 TO AVOID CONFLICT WITH THE  
 EXISTING WATER LINE

SEE DETAIL SHT 2B-3  
 FOR ISLAND AND  
 U-TURN BULB LAYOUTS

GUARDRAIL IS TO BE MIN.  
 10' OFFSET FROM EOT,  
 -L- 229+00 TO 233+56

MARK A. SORRELLS  
 ESTATE FILE 1999 E 180

PHILLIP TAYLOR ROSS  
 BK 899 PG 1009  
 CAB C SLOT 6343

PHILLIP TAYLOR ROSS  
 BK 899 PG 1009  
 CAB C SLOT 6343

HOBART DEAN ROSS, TRUSTEE  
 BK 894 PG 1861

MICHAEL T. SORRELLS  
 BK 440 PG 1451

JACK M. LEATHERWOOD, JR.  
 BK 781 PG 340

JACK M. LEATHERWOOD, JR.  
 BK 781 PG 337

SMOKY MOUNTAIN  
 FARMERS COOPERATIVE  
 BK 976 PG 43  
 BK 976 PG 420  
 CAB D SLOT 254

MARK A. SORRELLS  
 ESTATE FILE 1999 E 180