

The estimated quantity of "2" Water Service Line" on this plan sheet is 260 linear feet. The actual quantity will vary based on field conditions and will be determined during construction.

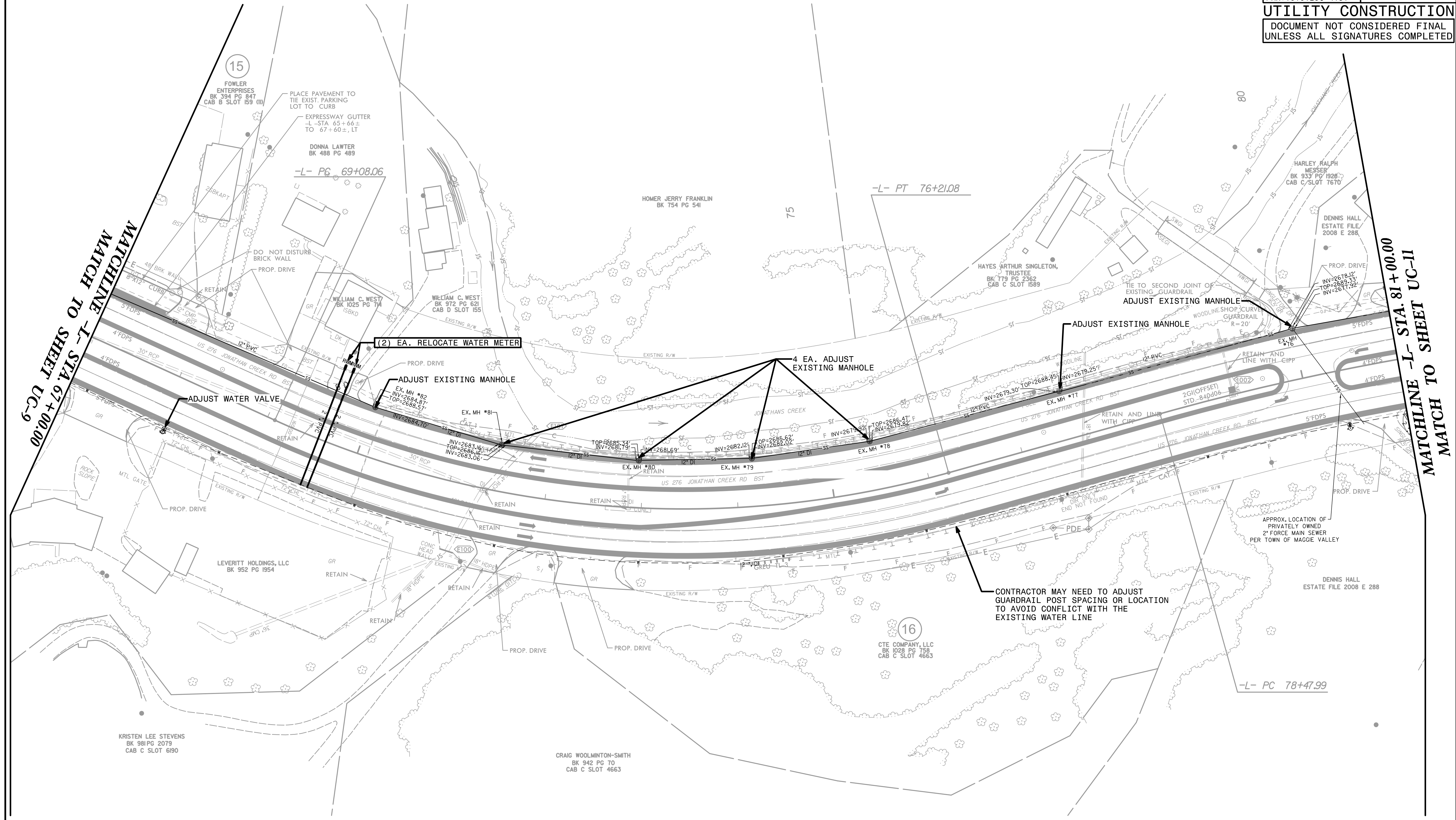

PROJECT REFERENCE NO. <i>R-5921</i>	SHEET NO. <i>UC-10</i>
DESIGNED BY: <i>BCH</i>	
DRAWN BY: <i>KSA</i>	
CHECKED BY:	
APPROVED BY:	
REVISED:	
NORTH CAROLINA DEPARTMENT OF TRANSPORTATION UTILITIES ENGINEERING SEC. PHONE: (919) 707-6690 FAX: (919) 250-4151 UTILITY CONSTRUCTION PLANS ONLY	
<b>UTILITY CONSTRUCTION</b> DOCUMENT NOT CONSIDERED FINAL UNLESS ALL SIGNATURES COMPLETED	



MATCHLINE -L- STA. 67+00.00 MATCH TO SHEET UC-9

MATCHLINE -L- STA. 81+00.00 MATCH TO SHEET UC-11

CONTRACTOR MAY NEED TO ADJUST GUARDRAIL POST SPACING OR LOCATION TO AVOID CONFLICT WITH THE EXISTING WATER LINE

KRISTEN LEE STEVENS  
BK 981 PG 2079  
CAB C SLOT 6190

CRAIG WOOLMINTON-SMITH  
BK 942 PG 70  
CAB C SLOT 4663

16  
CTE COMPANY, LLC  
BK 1028 PG 758  
CAB C SLOT 4663

DENNIS HALL  
ESTATE FILE 2008 E 288