

**TIP PROJECT: R-5921**

**CONTRACT: C204943**

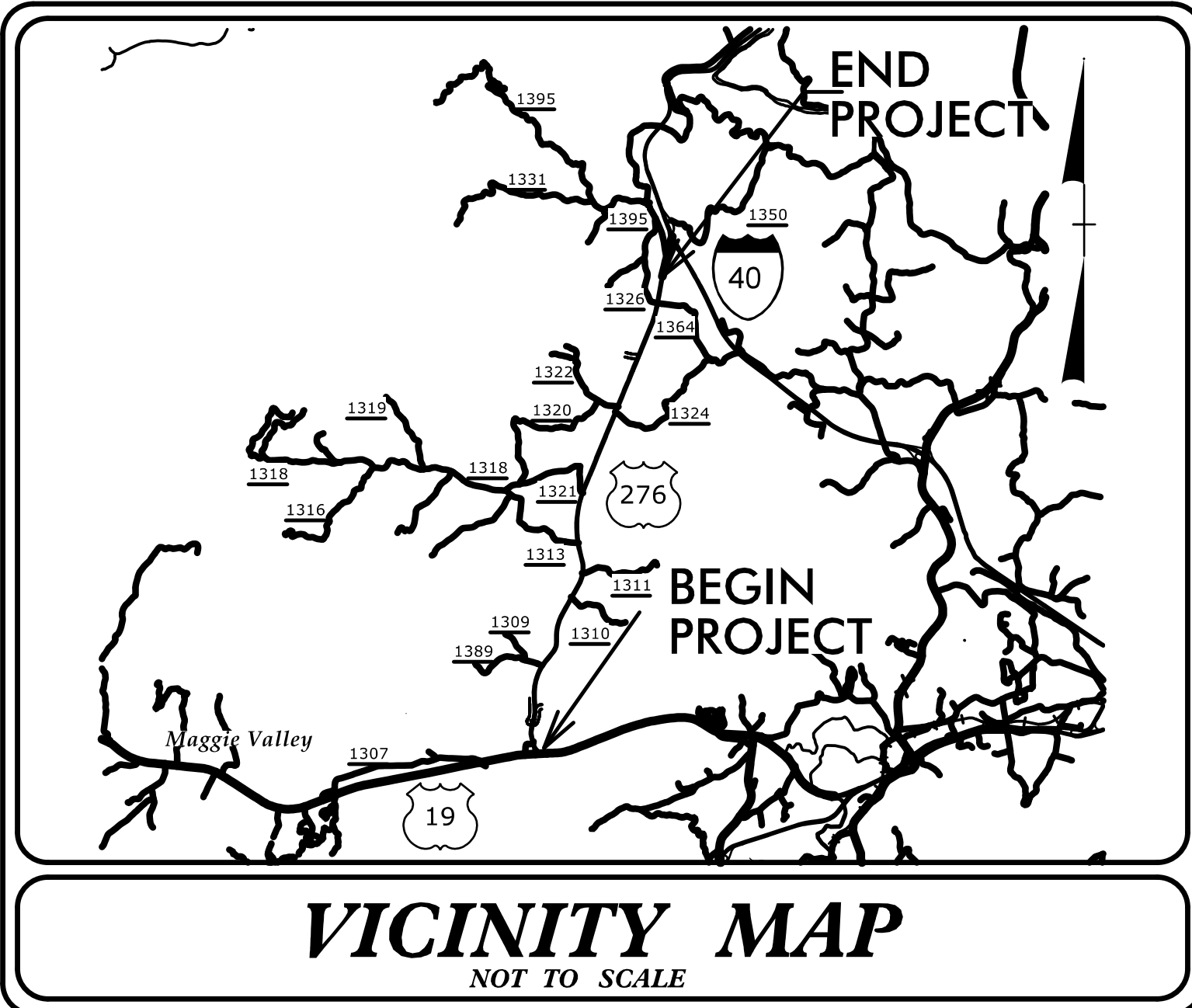

STATE OF NORTH CAROLINA  
DIVISION OF HIGHWAYS  
PLAN FOR PROPOSED  
HIGHWAY EROSION CONTROL

**HAYWOOD COUNTY**  
LOCATION: MODERNIZE US 276 (JONATHAN CREEK ROAD)  
FROM US 19 TO 0.5 MILES SOUTH OF I-40

TYPE OF WORK: GRADING, PAVING, AND DRAINAGE

STATE	STATE PROJECT REFERENCE NO.	SHEET NO.	TOTAL SHEETS
N.C.	R-5921	EC-1	
STATE PROJ. NO.	F.A. PROJ. NO.	DESCRIPTION	
48470.1.1	0276019	PE	
48470.2.1	0276019	R/W & UTIL	
48470.3.1	0276019	CONST.	

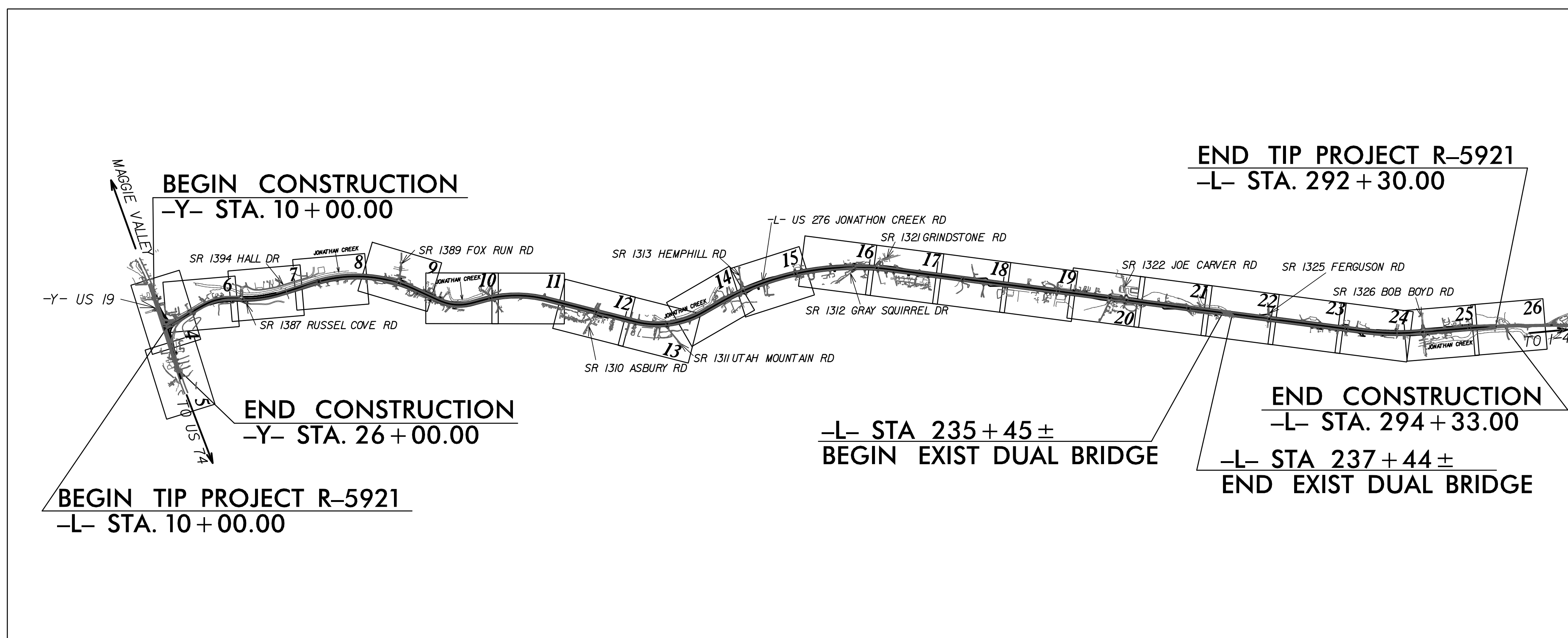

THIS PROJECT CONTAINS EROSION CONTROL PLANS FOR CLEARING AND GRUBBING PHASE OF CONSTRUCTION.

THIS PROJECT HAS BEEN DESIGNED TO SENSITIVE WATERSHED STANDARDS.

ENVIRONMENTALLY SENSITIVE AREA(S) EXIST ON THIS PROJECT  
Refer To E. C. Special Provisions for Special Considerations.

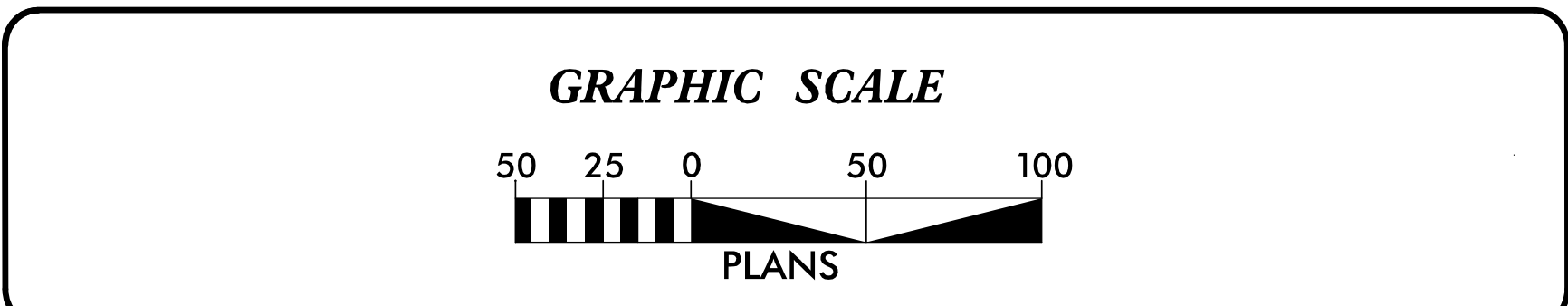

THESE EROSION AND SEDIMENT CONTROL PLANS COMPLY WITH THE REGULATIONS SET FORTH BY THE NCG 010000 GENERAL STORMWATER CONSTRUCTION PERMIT ISSUED BY THE NORTH CAROLINA DEPARTMENT OF ENVIRONMENTAL QUALITY DIVISION OF ENERGY, MINERAL, AND LAND RESOURCES.



Prepared In the Office of:  
**TGS ENGINEERS**  
201 W. MARION ST-STE 200  
SHELBY, NC 28150

Designed by:  
**Andrew H. Cochrane, PE** 3015  
NAME LEVEL III CERTIFICATION NO.

Roadway Standard Drawings

The "Roadway Standard Drawings"- Roadway Design Unit - N. C. Department of Transportation - Raleigh, N. C., dated January 2024 and the latest revision thereto are applicable to this project and by reference hereby are considered a part of these plans.