



6/2/24

PROJECT REFERENCE NO. R-5921	SHEET NO. RW23
Location and Surveys	
MATTER AND CRAIG ENGINEERS & SURVEYORS 12 BROAD STREET ASHEVILLE NORTH CAROLINA 28801 (828) 254-2201 FAX (828) 254-4562 NC LIC. NO. C-1154	
PROJECT SURVEYOR	
	
DOCUMENT NOT CONSIDERED FINAL UNLESS ALL SIGNATURES COMPLETED	

I, R.L. Zietlow, certify that the right of way and permanent easement monumentation for this project shown herein was completed under my direct and responsible charge from an actual survey made under my supervision; that all horizontal closures had a minimum ratio of precision of 1:10,000 (Class A). Field work was performed from 11/21/22 to 8/6/24, and all coordinates are based on NAD83/2011. That this survey was performed to meet the requirements of 21NCAc 56.1600 as applicable.

This 6th day of August, 2024.

Delegated by:

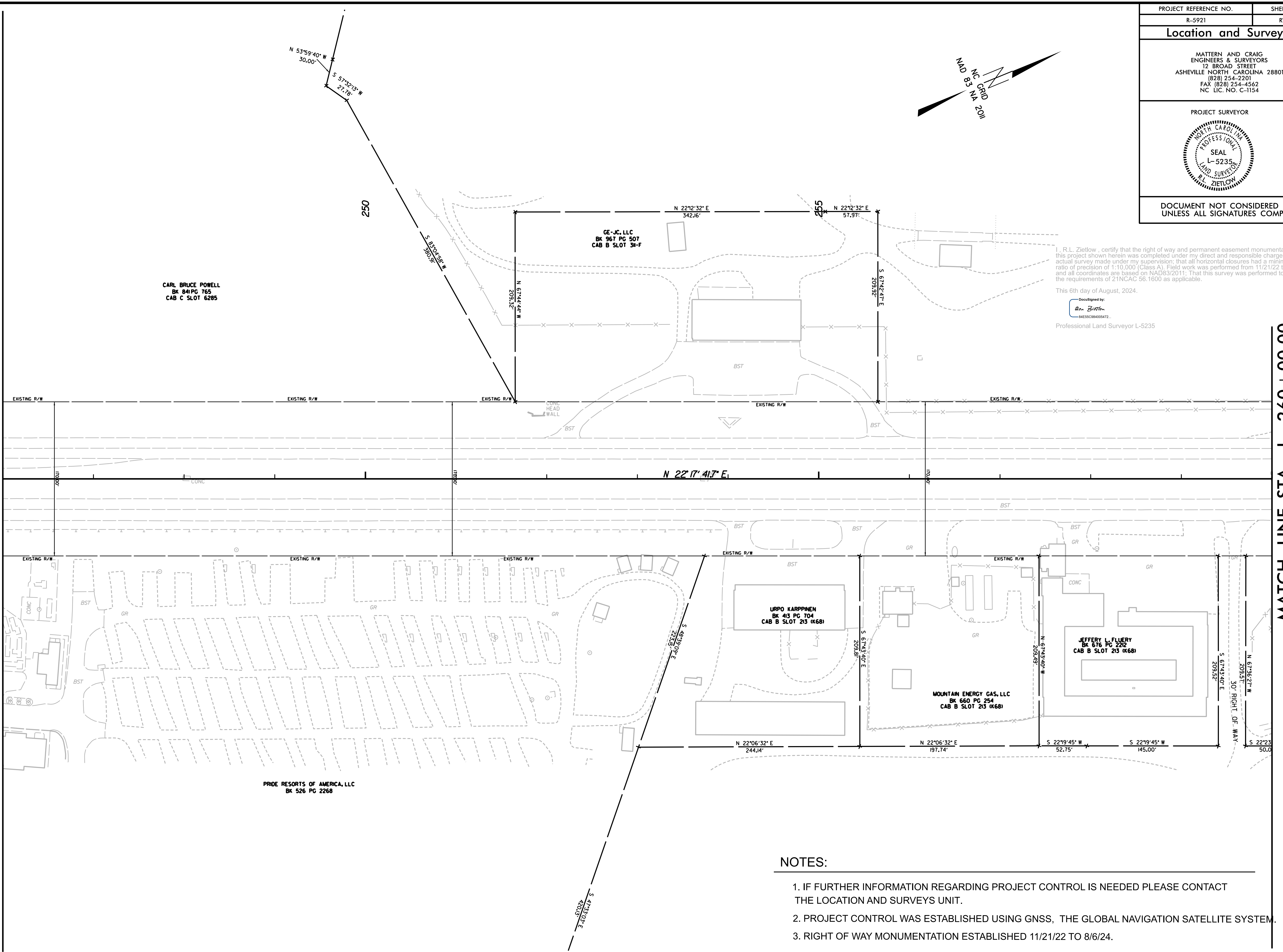
Professional Land Surveyor L-5235



MATCH LINE STA -L- 246 + 00.00
MATCH TO SHEET NO. 22

MATCH LINE STA -L- 260 + 00.00
MATCH TO SHEET NO. 24

REVISIONS

31 JUL 2024 13:23
L:\5921\NCDOT\Survey\3921\AL-r5921\RW Staking\Jzietlow\3921\AL-r5921\Working Folders\Survey\Deliverables\con_moc4\AR-5921\11s-rw23.dgn
R.L. Zietlow

NOTES:

1. IF FURTHER INFORMATION REGARDING PROJECT CONTROL IS NEEDED PLEASE CONTACT THE LOCATION AND SURVEYS UNIT.
2. PROJECT CONTROL WAS ESTABLISHED USING GNSS, THE GLOBAL NAVIGATION SATELLITE SYSTEM.
3. RIGHT OF WAY MONUMENTATION ESTABLISHED 11/21/22 TO 8/6/24.