

STATE	STATE PROJECT REFERENCE NO.	SHEET NO.	TOTAL SHEETS
N.C.	R-5921	RW01	36

STATE OF NORTH CAROLINA
DIVISION OF HIGHWAYS

SURVEY CONTROL, EXISTING CENTERLINES,
RIGHT OF WAY, EASEMENTS AND PROPERTY TIES

HAYWOOD COUNTY

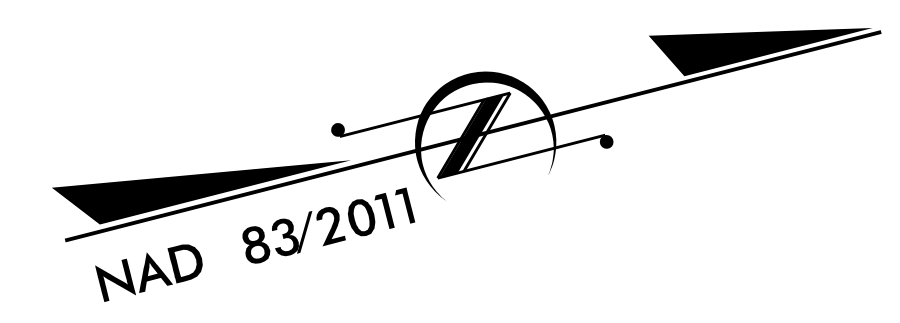

TIP PROJECT: R-5921

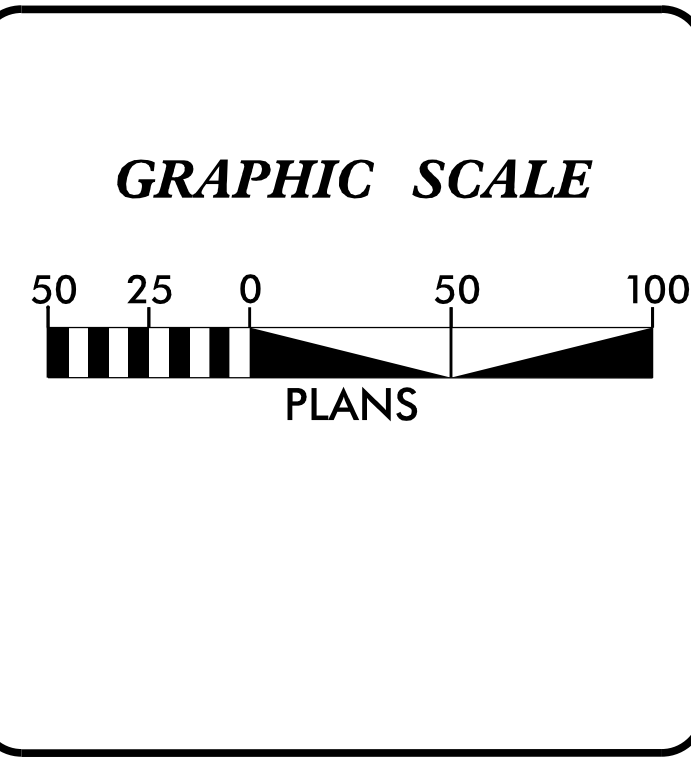
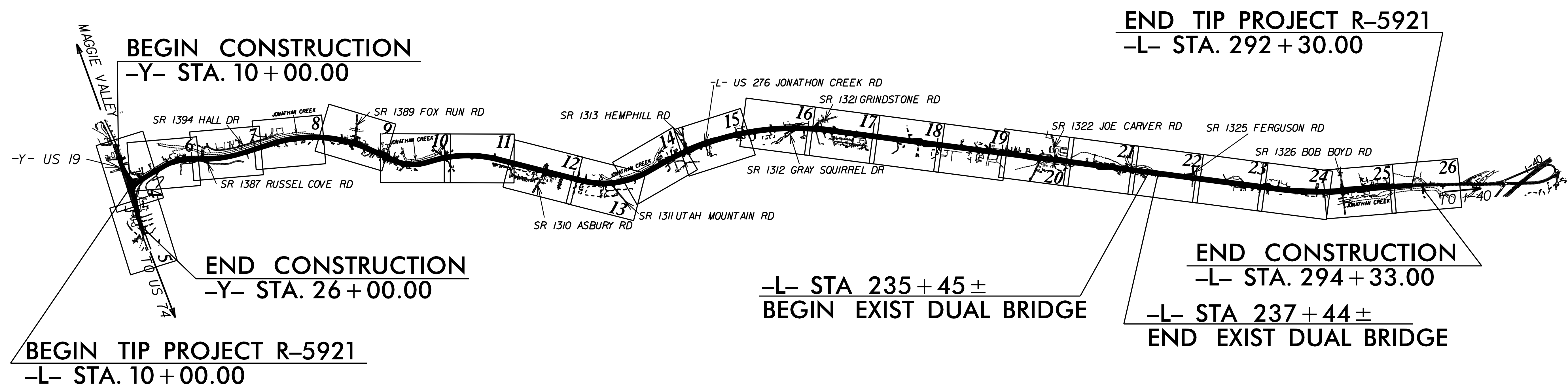

DATUM DESCRIPTION

THE LOCALIZED COORDINATE SYSTEM DEVELOPED FOR THIS PROJECT IS BASED ON THE STATE PLANE COORDINATES ESTABLISHED BY NCDOT FOR MONUMENT "G106"

WITH NAD 83/NA 2011 STATE PLANE GRID COORDINATES OF
NORTHING: 682555.515(ft) EASTING: 804080.456(ft)
ELEVATION: 2611.42(ft)

THE AVERAGE COMBINED GRID FACTOR USED ON THIS PROJECT (GROUND TO GRID) IS: 1.000233649

THE N.C. LAMBERT GRID BEARING AND LOCALIZED HORIZONTAL GROUND DISTANCE FROM "G106" TO -L- STATION 10+00 IS
S9°55'11"W 13510.81(ft)

ALL LINEAR DIMENSIONS ARE LOCALIZED HORIZONTAL DISTANCES
VERTICAL DATUM USED IS NAVD 88

Prepared In the Office of:

Mattern & Craig
ENGINEERS SURVEYORS

12 BROAD STREET
ASHEVILLE, NORTH CAROLINA 28801
(828) 254-2201
FAX (828) 254-4562
NC LIC. NO. C-1154

2018 STANDARD SPECIFICATIONS

RIGHT OF WAY DATE: JANUARY 9, 2023	LETTING DATE: NOVEMBER 19, 2024
--	---

PROFESSIONAL LAND SURVEYOR

DocuSigned by:
R. Zietlow
SIGNATURE: _____

08/06/2024
Date: _____

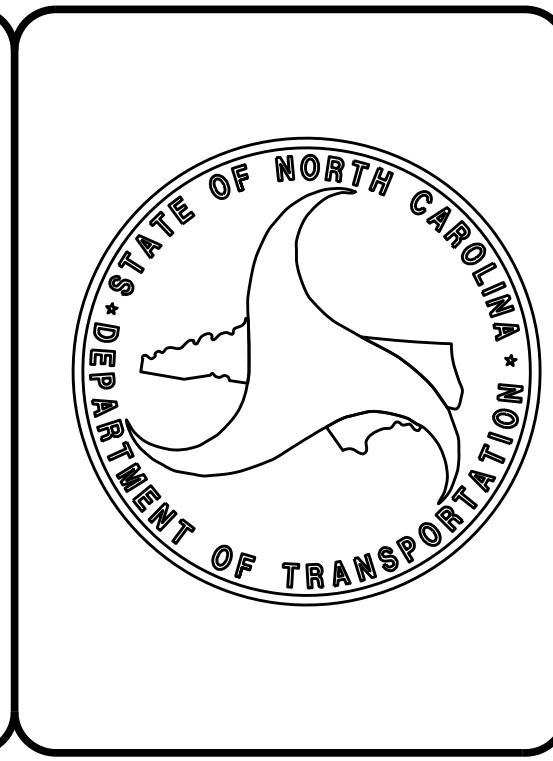

31-JUL-2024 13:59 I:\5921\NCDOT SURVEY\5921\5921RW Staking Johnatn Crk\06 Working Folders\SURVEY\Deliverables\com_mac4\R-5921_Ls_rw01.dgn AT: MC-NBK-L55-T