

5/28/24

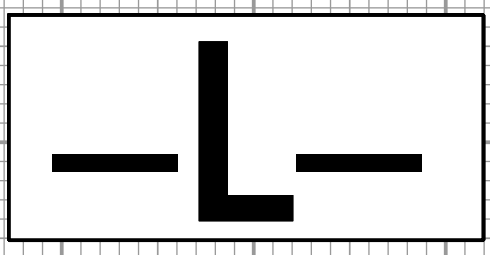

PROJECT REFERENCE NO. <i>R-5921</i>	SHEET NO. <i>29</i>
ROADWAY DESIGN ENGINEER <i>SEAL Terry</i> 35018 8/26/2024	HYDRAULICS ENGINEER <i>SEAL Henry</i> 16800 8/26/2024

**DOCUMENT NOT CONSIDERED FINAL
UNLESS ALL SIGNATURES COMPLETED**

TGS ENGINEERS
 201 W. MARION ST. STE 200
 SHELBY, NC 28150
 PH (704) 476-0003
 CORP. LICENSE NO.: C-0275

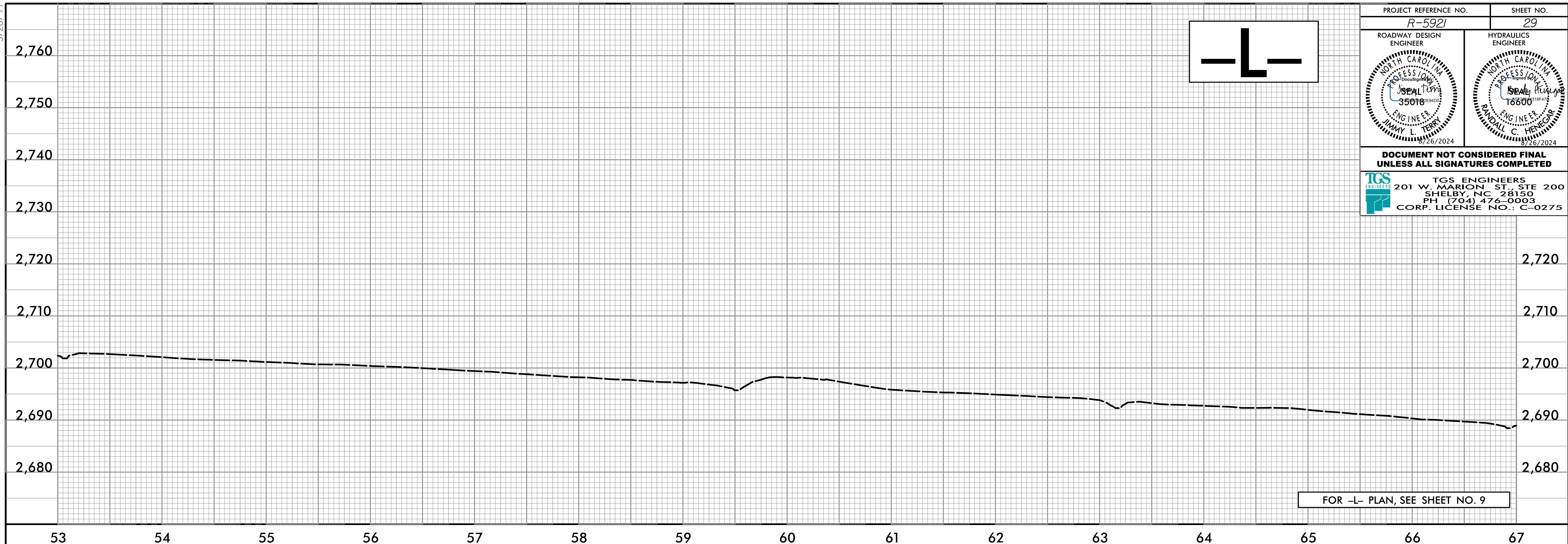

FOR -L- PLAN, SEE SHEET NO. 9

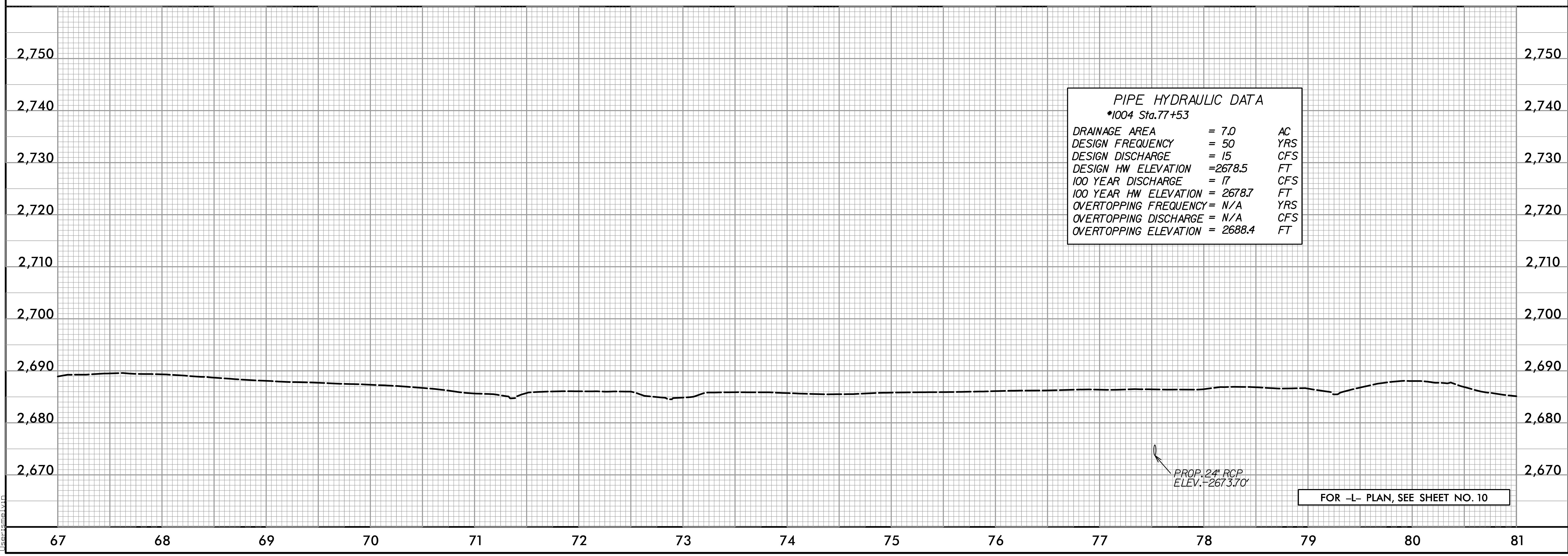

PIPE HYDRAULIC DATA
 *1004 Sta.77+53

DRAINAGE AREA	= 7.0	AC
DESIGN FREQUENCY	= 50	YRS
DESIGN DISCHARGE	= 15	CFS
DESIGN HW ELEVATION	= 2678.5	FT
100 YEAR DISCHARGE	= 17	CFS
100 YEAR HW ELEVATION	= 2678.7	FT
OVERTOPPING FREQUENCY	= N/A	YRS
OVERTOPPING DISCHARGE	= N/A	CFS
OVERTOPPING ELEVATION	= 2688.4	FT

PROP. 24" RCP
 ELEV. = 2673.70'

FOR -L- PLAN, SEE SHEET NO. 10

5/28/2024
 R:\Projects\2024\Roadway\Proj\R-5921_Rdy.pfl.dgn
 User:smal