

NOTE: ALL DRIVEWAYS ARE TO BE ASPHALT UNLESS OTHERWISE NOTED.

PROJECT REFERENCE NO. <b>R-5921</b>	SHEET NO. <b>26</b>
RW SHEET NO.	
ROADWAY DESIGN ENGINEER	HYDRAULICS ENGINEER
<b>DOCUMENT NOT CONSIDERED FINAL UNLESS ALL SIGNATURES COMPLETED</b>	
<b>TGS ENGINEERS</b> 201 W. MARION ST STE 200 SHELBY, NC 28150 PH (704) 476-0003 CORP. LICENSE NO.: C-0275	

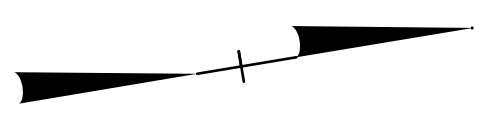

MATCH LINE STA -L- 288+00.00  
MATCH TO SHEET NO. 25

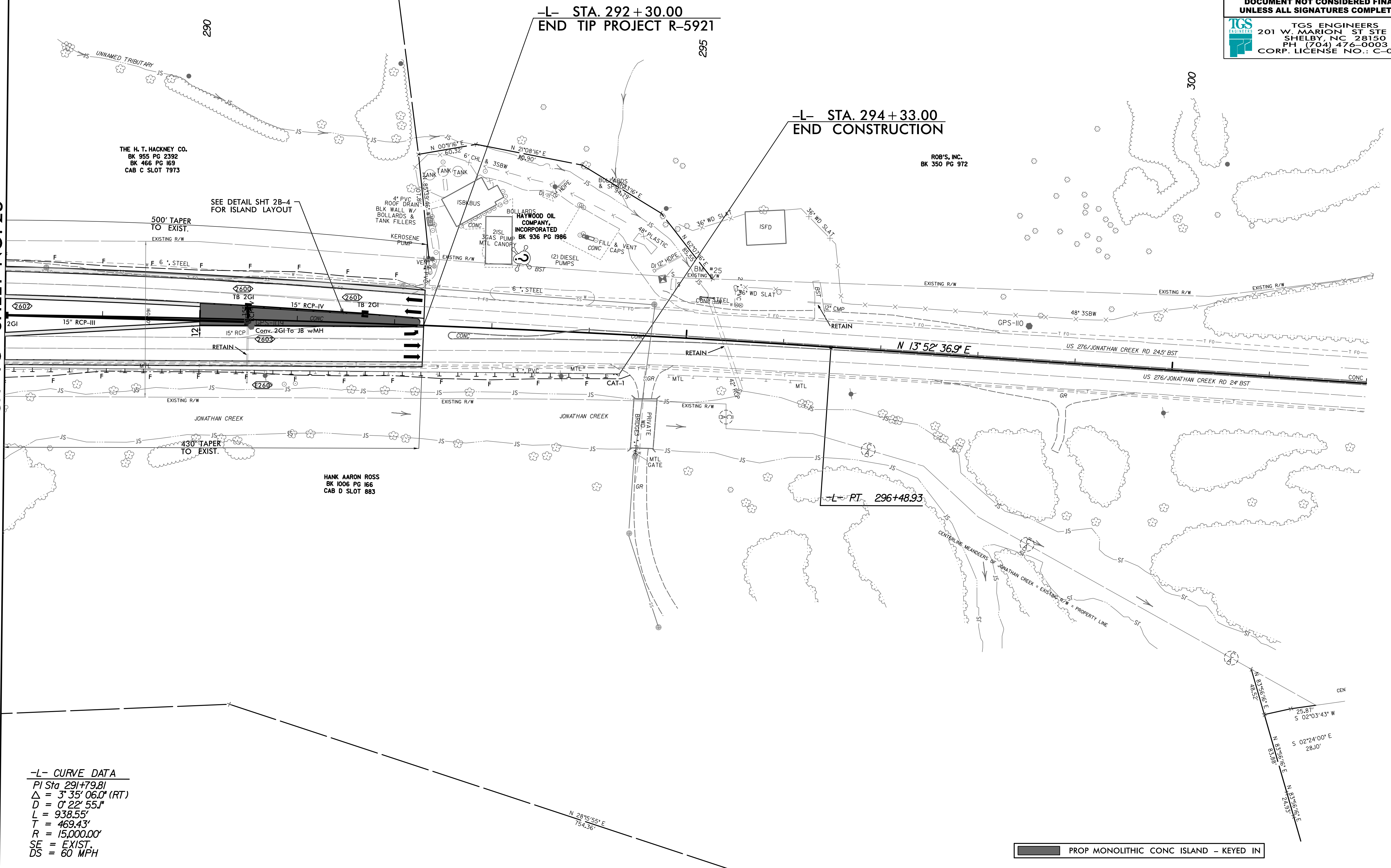

-L- STA. 292+30.00  
END TIP PROJECT R-5921

-L- STA. 294+33.00  
END CONSTRUCTION

-L- RT. 296+48.93

**-L- CURVE DATA**  
 PI Sta 291+79.81  
 $\Delta = 3^{\circ} 35' 06.0''$  (RT)  
 $D = 0^{\circ} 22' 55.1''$   
 $L = 938.55'$   
 $T = 469.43'$   
 $R = 15,000.00'$   
 SE = EXIST.  
 DS = 60 MPH

PROP MONOLITHIC CONC ISLAND - KEYED IN

REVISIONS

8/17/2024  
 X:\NC\001\R-5921\Roadway\Proj\R-5921\_Rdy\_psh.dgn  
 8/17/2024