

8/17/24

NOTE: ALL DRIVEWAYS ARE TO BE ASPHALT UNLESS OTHERWISE NOTED.

PROJECT REFERENCE NO. R-5921		SHEET NO. 12	
RW SHEET NO.		HYDRAULICS ENGINEER	
ROADWAY DESIGN ENGINEER		PROFESSIONAL ENGINEER	
DOCUMENT NOT CONSIDERED FINAL UNLESS ALL SIGNATURES COMPLETED			
TGS ENGINEERS 201 W. MARION ST STE 200 SHELBY, NC 28150 PH: (704) 476-0003 CORP. LICENSE NO.: C-0275			

REVISIONS

MATCH LINE STA -L- 95 + 00.00
MATCH TO SHEET NO. 11

MATCH LINE STA -L- 109 + 00.00
MATCH TO SHEET NO. 13

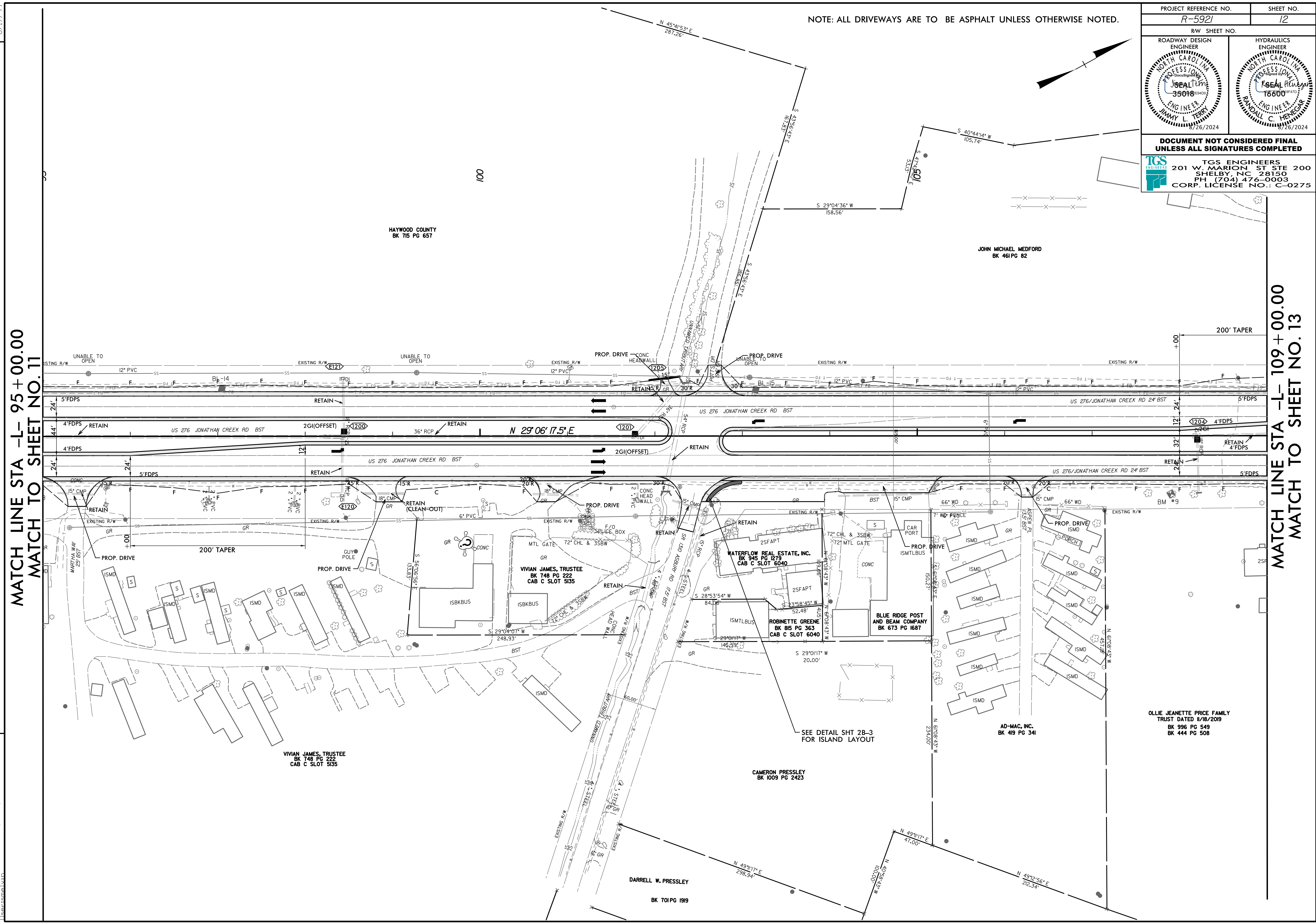

8/17/24 R-5921-Roadway-Proc-NR-5921-Rdy-psh-12.dgn

OLLIE JEANETTE PRICE FAMILY
TRUST DATED 11/18/2019
BK 996 PG 549
BK 444 PG 508

VIVIAN JAMES TRUSTEE
BK 748 PG 222
CAB C SLOT 5135

CAMERON PRESSLEY
BK 1009 PG 2423

DARRELL W. PRESSLEY
BK 701 PG 1919

AD-MAC, INC.
BK 419 PG 341

SEE DETAIL SHT 2B-3
FOR ISLAND LAYOUT

ROBINETTE GREEN
BK 815 PG 363
CAB C SLOT 6040

WATERFLOW REAL ESTATE, INC.
BK 945 PG 1273
CAB C SLOT 6040

VIVIAN JAMES TRUSTEE
BK 748 PG 222
CAB C SLOT 5135

HAYWOOD COUNTY
BK 715 PG 657

JOHN MICHAEL MEDFORD
BK 461 PG 82