

8/17/99

DESIGN DETAILS

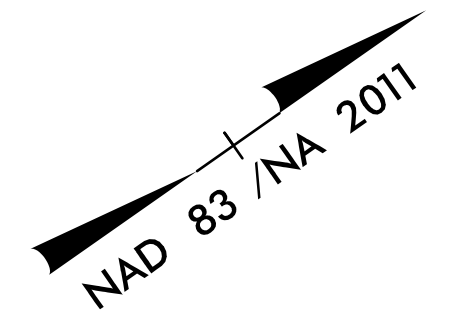

PROJECT REFERENCE NO. U-6020	SHEET NO. 2B-1
RW SHEET NO.	
ROADWAY DESIGN ENGINEER	
4/26/2024 9:47 AM EDT	
DOCUMENT NOT CONSIDERED FINAL	
UNLESS ALL SIGNATURES COMPLETED	
TGS ENGINEERS 706 HILLSBOROUGH ST., SUITE 200 RALEIGH, NC 27603 PH (919) 773-8887 CORP. LICENSE NO.: C-0275	

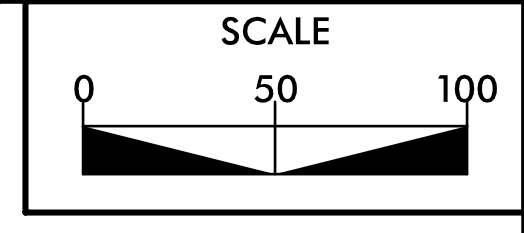

END T.I.P. PROJECT U-6020
-L- POT Sta. 21+25.00

-L-	-Y1-	-Y2-	-Y1-	-Y1-
PI Sta 16+25.30 Δ = 39° 49' 09.2" (LT) D = 10' 44' 58.8" L = 370.42' T = 193.04' R = 533.00' SE = 0.04	PI Sta 10+84.86 Δ = 4° 38' 01.7" (RT) D = 5' 43' 46.5" L = 80.88' T = 40.46' R = 1,000.00'	PI Sta 17+30.16 Δ = 25° 56' 38.5" (RT) D = 3' 49' 11.0" L = 679.21' T = 345.53' R = 1,500.00' SE = 0.04	PI Sta 22+09.36 Δ = 2° 36' 24.9" (RT) D = 0' 53' 45.2" L = 290.99' T = 145.52' R = 6,395.48' SE = SEE PLANS	

-Y2-	-Y2-	-Y2-
PI Sta 11+5.20 Δ = 55° 18' 48.8" (RT) D = 57' 17" 44.8" L = 96.54' T = 52.40' R = 100.00' SE = SEE PLANS	PI Sta 13+71.32 Δ = 34° 33' 37.2" (RT) D = 15' 09' 27.4" L = 228.01' T = 117.59' R = 378.00' SE = SEE PLANS	PI Sta 15+33.54 Δ = 12° 46' 11.7" (RT) D = 12' 22' 29.6" L = 103.19' T = 51.81' R = 463.00' SE = EXIST.

-DRW2-	-DRW3-	-DRW4-
PI Sta 10+62.68 Δ = 15° 27' 19.5" (LT) D = 57' 17" 44.8" L = 26.97' T = 13.57' R = 100.00' SE = SEE PLANS	PI Sta 10+53.06 Δ = 5° 27' 08.0" (LT) D = 57' 17" 44.8" L = 9.52' T = 4.76' R = 100.00' SE = SEE PLANS	PI Sta 10+28.47 Δ = 34° 02' 18.6" (LT) D = 114' 35' 29.6" L = 29.70' T = 15.30' R = 50.00' SE = SEE PLANS

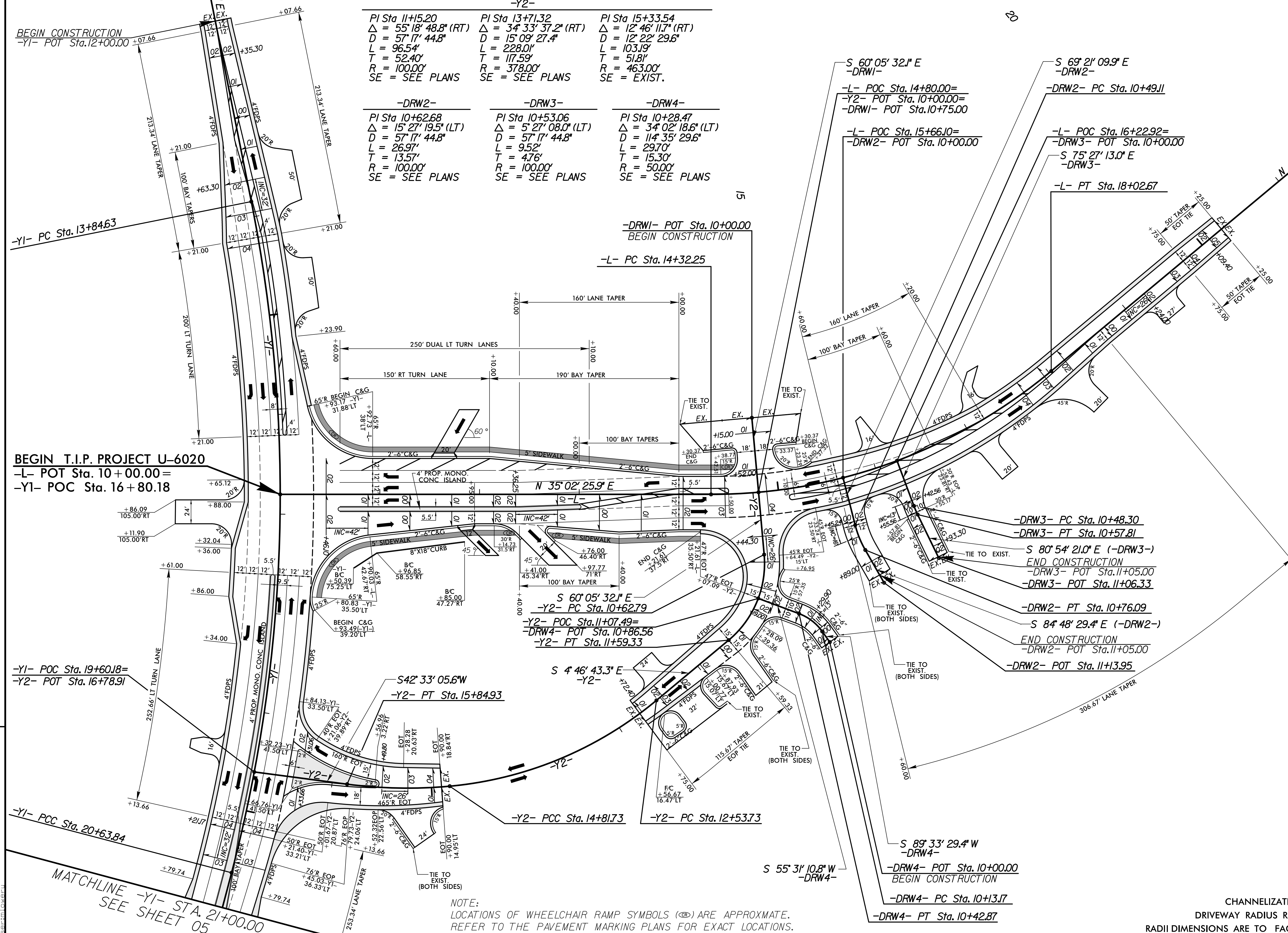

BEGIN T.I.P. PROJECT U-6020
-L- POT Sta. 10+00.00 =
-Y1- POC Sta. 16+80.18

-Y1- POC Sta. 19+60.18 =
-Y2- POT Sta. 16+78.91

-Y1- POC Sta. 20+63.84
MATCHLINE -Y1- STA. 21+00.00
SEE SHEET 05

NOTE:
LOCATIONS OF WHEELCHAIR RAMP SYMBOLS (♻️) ARE APPROXIMATE.
REFER TO THE PAVEMENT MARKING PLANS FOR EXACT LOCATIONS.

-DRW3- PC Sta. 10+48.30
-DRW3- PT Sta. 10+57.81
END CONSTRUCTION
-DRW3- POT Sta. 11+05.00
-DRW3- POT Sta. 11+06.33
-DRW2- PT Sta. 10+76.09
S 8° 48' 29.4" E (-DRW2-)
END CONSTRUCTION
-DRW2- POT Sta. 11+05.00
-DRW2- POT Sta. 11+13.95

SEE SHEET 04 FOR -L-, -Y1-, -Y2-, -DRW1-,
-DRW2-, -DRW3-, & -DRW4- PLAN
SEE SHEET 06 FOR -L- & -Y1- PROFILES
SEE SHEET 07 FOR -Y2-, -DRW1-, -DRW2-,
-DRW3-, & -DRW4- PROFILES

CHANNELIZATION RADII ARE 3' UNLESS OTHERWISE NOTED
DRIVEWAY RADIUS RETURNS ARE 10'R UNLESS OTHERWISE NOTED
RADII DIMENSIONS ARE TO FACE OF CURB (FC) UNLESS OTHERWISE NOTED

REVISIONS

3/8/2024
C:\projects\6020\Roadway\Proj\U6020\Fdu\psh_2b-1.dgn
User: mlowery