

STATE	STATE PROJECT REFERENCE NO.	SHEET NO.	TOTAL SHEETS
N.C.	P5715	RW01	

STATE OF NORTH CAROLINA  
DIVISION OF HIGHWAYS

SURVEY CONTROL, EXISTING CENTERLINES,  
RIGHT OF WAY, EASEMENTS AND PROPERTY TIES

**WAKE COUNTY**

LOCATION: NEW HOPE CHURCH ROAD GRADE SEPARATION OVER  
CSX RAIL LINE (CROSSING NO. 630607N AT MILEPOST S 152.32)

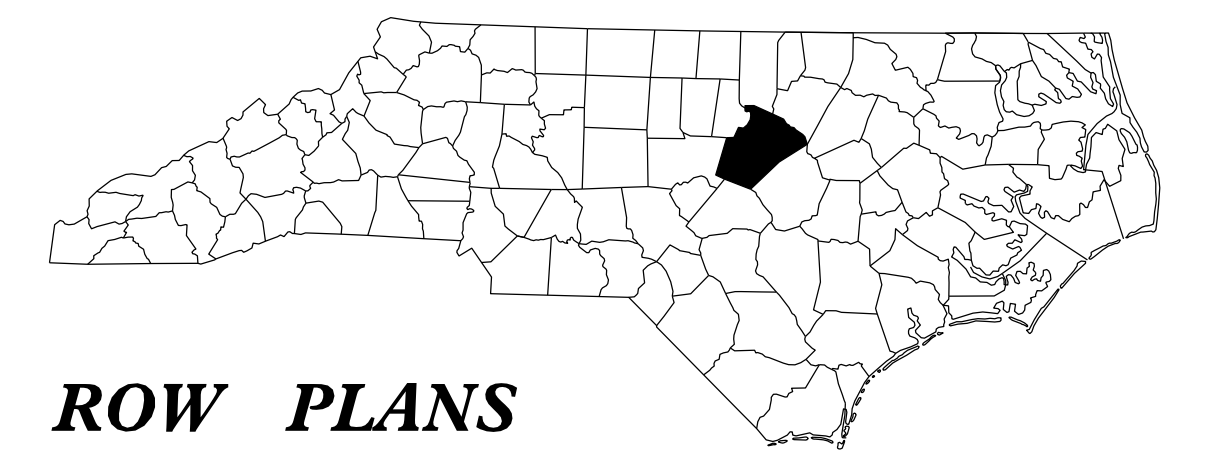

ROW PLANS

**TIP PROJECT: P5715**

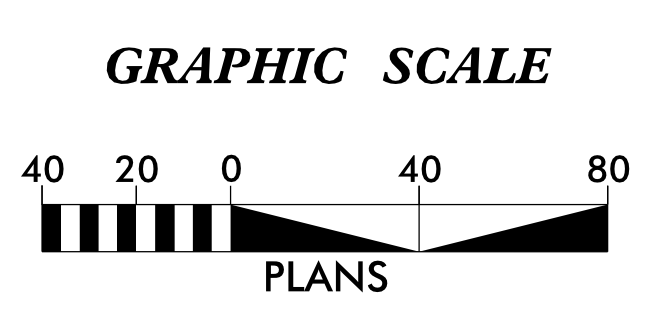
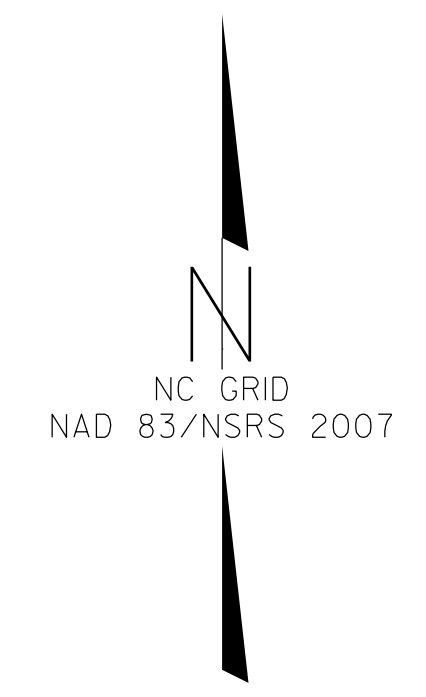
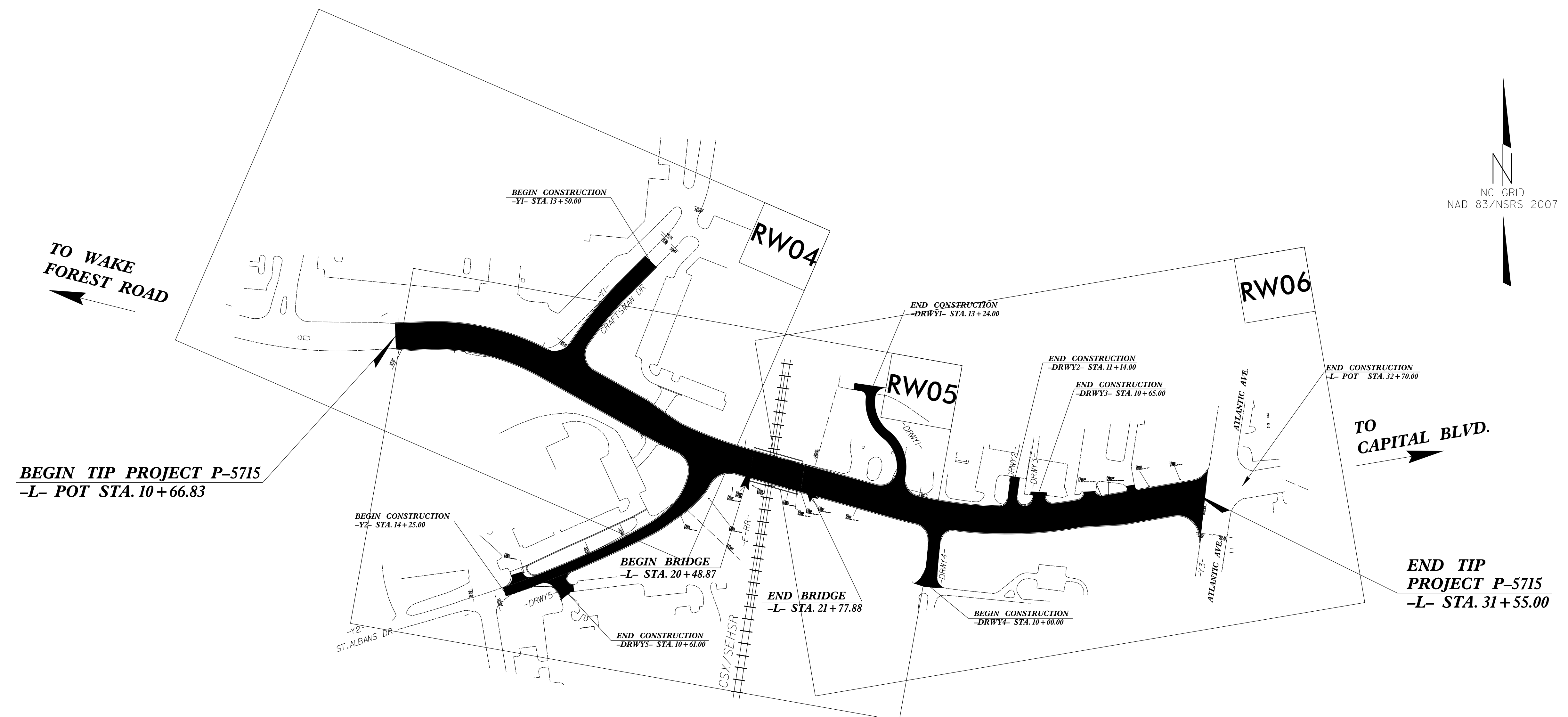

**DATUM DESCRIPTION**

THE LOCALIZED COORDINATE SYSTEM DEVELOPED FOR THIS PROJECT IS BASED ON THE STATE PLANE COORDINATES ESTABLISHED BY NCGS FOR MONUMENT "SEHSR-4" WITH NAD 83/NSRS 2007 STATE PLANE GRID COORDINATES OF NORTHING: 777,964,330(ft) EASTING: 2,125,243,897(ft) ELEVATION: 312.92(ft)

THE AVERAGE COMBINED GRID FACTOR USED ON THIS PROJECT (GROUND TO GRID) IS: 0.99992346

THE N.C. LAMBERT GRID BEARING AND LOCALIZED HORIZONTAL GROUND DISTANCE FROM "SEHSR-4" TO -L- STATION 11+87.34 IS S 26-28'22" W 20,827.22(ft)

ALL LINEAR DIMENSIONS ARE LOCALIZED HORIZONTAL DISTANCES VERTICAL DATUM USED IS NAVD 88

Prepared in the Office of:  
**DIVISION OF HIGHWAYS**  
1000 Birch Ridge Dr., Raleigh NC, 27610

2018 STANDARD SPECIFICATIONS

RIGHT OF WAY DATE:  
June 28, 2018

LETTING DATE:  
December 21, 2021

ESP ASSOCIATES, INC  
2200 GATEWAY CENTRE BLVD.,  
SUITE 216  
MORRISVILLE, NC 27560

PROFESSIONAL LAND SURVEYOR

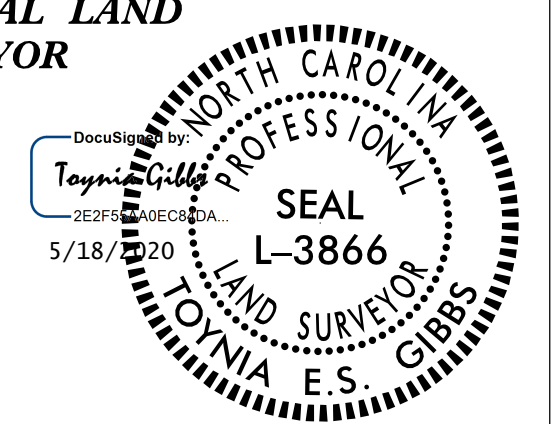

DocuSigned by:  
Toinia Gibbs  
SIGNATURE:

5/18/2020  
Date:

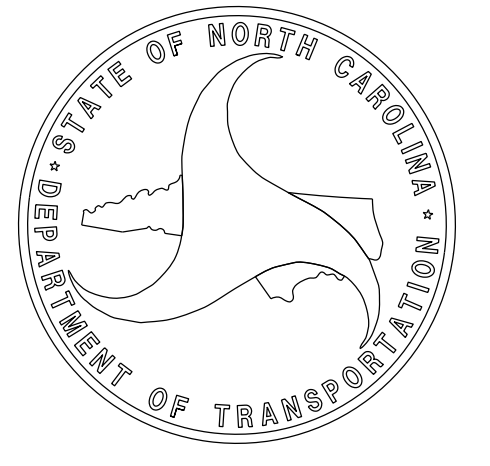

\$\$\$\$\$SYTIME\$\$\$\$\$  
\$\$\$\$\$DGN\$\$\$\$\$  
\$\$\$\$\$USERNAME\$\$\$\$\$