

STATE OF NORTH CAROLINA  
DIVISION OF HIGHWAYS

**TRANSPORTATION MANAGEMENT PLAN**

**DAVIDSON COUNTY**

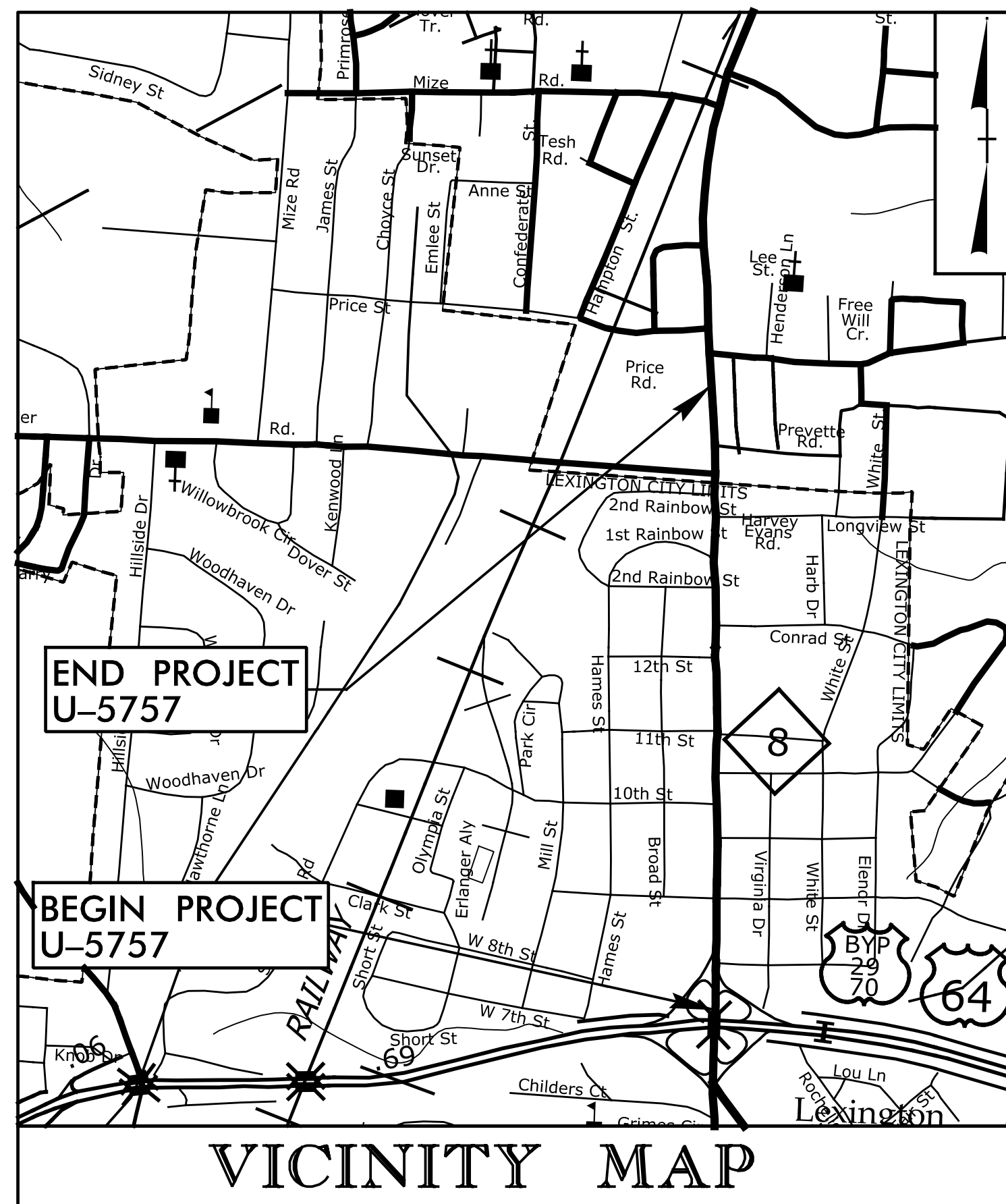
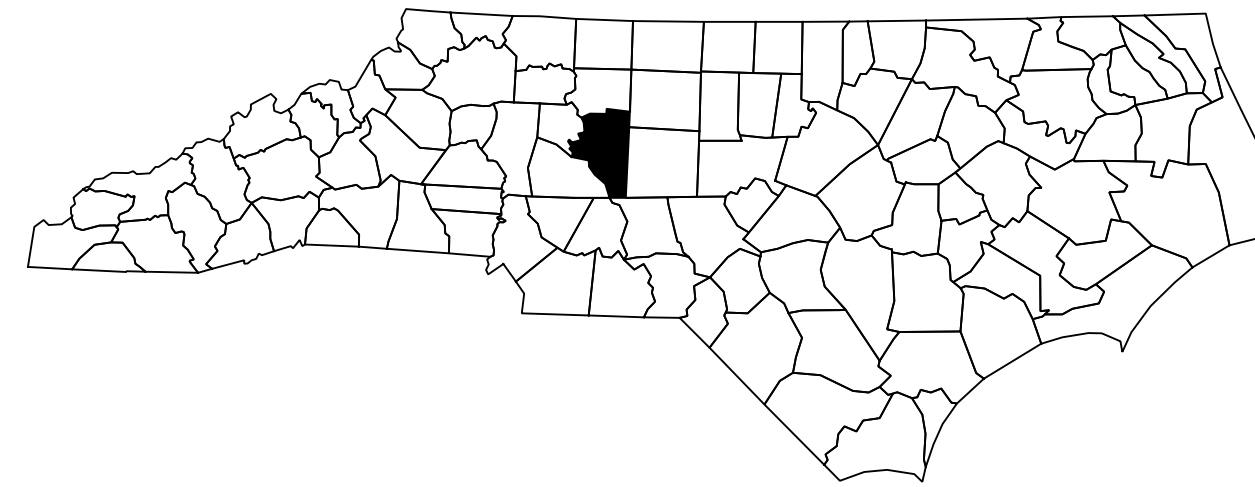

**LOCATION: NC 8 (WINSTON ROAD) FROM US 29 /US 70 TO SR 1846 (ARRINGTON DRIVE) IN LEXINGTON**

**TYPE OF WORK: GRADING, DRAINAGE, PAVING, AND SIGNALS**

VICINITY MAP

<u>SHEET NO.</u>	<u>TITLE</u>
TMP-1	TITLE SHEET, VICINITY MAP, AND INDEX OF SHEETS
TMP-1A	LIST OF APPLICABLE ROADWAY STANDARD DRAWINGS, AND LEGEND
TMP-2	TRANSPORTATION OPERATIONS PLAN: (MANAGEMENT STRATEGIES AND GENERAL NOTES)
TMP-3	PHASING
TMP-4-6	PHASE I
TMP-7-9	PHASE II
TMP-10-12	PHASE III

SHEET NO.  
TMP-1

**U-5757**

**TIP PROJECT:**

6/19/2024 X:\2015\PL15.010.00\_U-5757\_NC8\_WinstonRd\_widen\_Lexington\TrafficControl\CP\U-5757\_TC\_TMP\_01.dgn jbauman

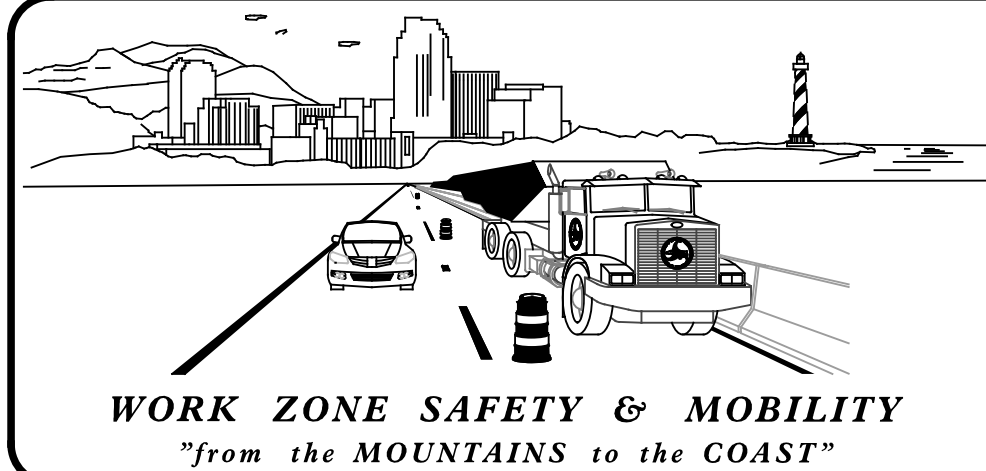

PLANS PREPARED BY:

STEVE MILLER, P.E.

JOHN BAUMAN, P.E.

NCDOT CONTACTS:

AL BLANTON, PE, PLS  
PROJECT ENGINEER

PROJECT DESIGN ENGINEER



DOCUMENT NOT CONSIDERED FINAL  
UNLESS ALL SIGNATURES COMPLETED

**TRANSYSTEMS**

1 Glenwood Avenue  
Raleigh, NC 27603  
Tel: 919.789.9977  
Fax: 919.789.9591  
License: F-0453

APPROVED: \_\_\_\_\_

DATE: \_\_\_\_\_

SEAL



# ROADWAY STANDARD DRAWINGS

THE FOLLOWING ROADWAY STANDARDS AS SHOWN IN "ROADWAY STANDARD DRAWINGS" - N.C. DEPARTMENT OF TRANSPORTATION - RALEIGH, N.C., DATED JANUARY 2024 ARE APPLICABLE TO THIS PROJECT AND BY REFERENCE HEREBY ARE CONSIDERED A PART OF THESE PLANS:

STD. NO.	TITLE
1101.01	WORK ZONE ADVANCE WARNING SIGNS
1101.02	TEMPORARY LANE CLOSURES
1101.04	TEMPORARY SHOULDER CLOSURES
1101.05	WORK ZONE VEHICLE ACCESSES
1101.11	TRAFFIC CONTROL DESIGN TABLES
1110.01	STATIONARY WORK ZONE SIGNS
1110.02	PORTABLE WORK ZONE SIGNS
1115.01	FLASHING ARROW BOARDS
1130.01	DRUMS
1135.01	CONES
1145.01	BARRICADES - TYPE III
1150.01	FLAGGERS
1165.01	TRUCK MOUNTED ATTENUATOR
1180.01	SKINNY DRUMS
1205.01	PAVEMENT MARKINGS - LINE TYPES AND OFFSETS
1205.02	PAVEMENT MARKINGS - TWO LANE AND MULTILANE ROADWAYS
1205.04	PAVEMENT MARKINGS - INTERSECTIONS
1205.05	PAVEMENT MARKINGS - TURN LANES
1205.07	PAVEMENT MARKINGS - PEDESTRIAN CROSSWALKS
1205.08	PAVEMENT MARKINGS - SYMBOLS AND WORD MESSAGES
1205.09	PAVEMENT MARKINGS - PAINTED ISLANDS

## LEGEND

### GENERAL

- DIRECTION OF TRAFFIC FLOW
- DIRECTION OF PEDESTRIAN TRAFFIC FLOW
- EXIST. PVMT.
- NORTH ARROW
- PROPOSED PVMT.
- TEMP. SHORING (LOCATION PURPOSES ONLY)



### SIGNALS

- EXISTING
- PROPOSED
- TEMPORARY

### PAVEMENT MARKINGS

- EXISTING LINES
- TEMPORARY LINES

### TRAFFIC CONTROL DEVICES

- BARRICADE (TYPE III)
- CONE
- DRUM SKINNY DRUM TUBULAR MARKER
- TEMPORARY CRASH CUSHION
- FLASHING ARROW BOARD
- FLAGGER
- LAW ENFORCEMENT
- TRUCK MOUNTED ATTENUATOR (TMA)
- CHANGEABLE MESSAGE SIGN

### TEMPORARY SIGNING

- PORTABLE SIGN
- STATIONARY SIGN
- STATIONARY OR PORTABLE SIGN

### PAVEMENT MARKERS

- CRYSTAL/CRYSTAL
- CRYSTAL/RED
- YELLOW/YELLOW

### PAVEMENT MARKING SYMBOLS

- PAVEMENT MARKING SYMBOLS

### TEMPORARY PAVEMENT MARKING SCHEDULE

SYMBOL	DESCRIPTION	PAINT (24")
P61	WHITE STOP BAR	
		PAINT (4")
P1	WHITE EDGE LINE	
P2	WHITE SOLID LANE LINE	
P3	10 FT. WHITE SKIP	
P4	3 FT. - 9 FT./SP WHITE MINISKIP	
P5	2 FT. - 6 FT./SP WHITE MINISKIP	
P10	YELLOW EDGE LINE	
P11	YELLOW SINGLE CENTER	
P12	10 FT. YELLOW SKIP	
P13	YELLOW DOUBLE CENTER	
		PAINT (8")
P42	YELLOW DIAGONAL	
P43	WHITE SOLID LANE LINE	
P44	3 FT. - 9 FT./SP WHITE MINISKIP	
P46	WHITE CROSSWALK LINE	
		PAINT PAVEMENT MARKING SYMBOLS
P70	LEFT TURN ARROW	
P71	RIGHT TURN ARROW	
P72	STRAIGHT ARROW	
P74	COMBO RIGHT/STRAIGHT ARROW	
P76	COMBO LEFT/RIGHT/STRAIGHT ARROW	
P79	MERGE ARROW	
P81	ELONGATED STRAIGHT ARROW	
P90	BICYCLE SYMBOL, HEATED IN PLACE AND BICYCLE STRAIGHT ARROW, HEATED IN PLACE	
P94	SHARROW, HEATED IN PLACE	
P100	ALPHANUMERIC CHARACTER	

6/10/2024 X:\2015\PL15-010-00\_U-5757\_N08\_WinstonRd\_widen\_Lexington\TrafficControl\TCP\U-5757\_TC\_TMP\_01A.dgn jbauman

**TRANSYSTEMS**  
 1 Glenwood Avenue  
 Raleigh, NC 27603  
 Tel: 919.789.9977  
 Fax: 919.789.9591  
 License: F-0453

APPROVED: \_\_\_\_\_  
 DATE: \_\_\_\_\_  
 SEAL



**ROADWAY STANDARD DRAWINGS & LEGEND**

**DOCUMENT NOT CONSIDERED FINAL UNLESS ALL SIGNATURES COMPLETED**

## MANAGEMENT STRATEGIES

- LOCAL ACCESS TO ALL RESIDENCES AND BUSINESSES WILL BE MAINTAINED AT ALL TIMES DURING CONSTRUCTION
- PROVIDE ONE MONTH NOTICE TO THE ENGINEER, DAVIDSON COUNTY EMERGENCY SERVICES, AND DAVIDSON COUNTY SCHOOL OFFICIALS PRIOR TO ROAD CLOSURE

## GENERAL NOTES

CHANGES MAY BE REQUIRED WHEN PHYSICAL DIMENSIONS IN THE DETAIL DRAWINGS, STANDARD DETAILS, AND ROADWAY DETAILS ARE NOT ATTAINABLE TO MEET FIELD CONDITIONS OR RESULT IN DUPLICATE OR UNDESIRED OVERLAPPING OF DEVICES. MODIFICATION MAY INCLUDE: MOVING, SUPPLEMENTING, COVERING, OR REMOVAL OF DEVICES AS DIRECTED BY THE ENGINEER.

THE FOLLOWING GENERAL NOTES APPLY AT ALL TIMES FOR THE DURATION OF THE CONSTRUCTION PROJECT EXCEPT WHEN OTHERWISE NOTED IN THE PLAN OR DIRECTED BY THE ENGINEER.

### TIME RESTRICTIONS

- A) DO NOT CLOSE OR NARROW TRAVEL LANES AS FOLLOWS:
- |                              |                                   |
|------------------------------|-----------------------------------|
| ROAD NAME: NC 8 (WINSTON RD) | DAY AND TIME RESTRICTIONS         |
|                              | MONDAY-FRIDAY 7:00 A.M.-9:00 A.M. |
|                              | 4:00 P.M.-7:00 P.M.               |
- B) DO NOT CLOSE OR NARROW TRAVEL LANES DURING HOLIDAYS AND SPECIAL EVENTS AS FOLLOWS:
- ROAD NAME: NC 8 (WINSTON RD)
- HOLIDAY
1. FOR ANY UNEXPECTED OCCURRENCE THAT CREATES UNUSUALLY HIGH TRAFFIC VOLUMES, AS DIRECTED BY THE ENGINEER.
  2. FOR NEW YEAR'S, BETWEEN THE HOURS OF 7:00 A.M. DECEMBER 31ST TO 7:00 P.M. JANUARY 2ND. IF NEW YEAR'S DAY IS ON A FRIDAY, SATURDAY, SUNDAY, OR MONDAY THEN UNTIL 7:00 P.M. THE FOLLOWING TUESDAY.
  3. FOR EASTER, BETWEEN THE HOURS OF 7:00 A.M. THURSDAY AND 7:00 P.M. MONDAY.
  4. FOR MEMORIAL DAY, BETWEEN THE HOURS OF 7:00 A.M. FRIDAY TO 7:00 P.M. TUESDAY.
  5. FOR INDEPENDENCE DAY, BETWEEN THE HOURS OF 7:00 A.M. THE DAY BEFORE INDEPENDENCE DAY AND 7:00 P.M. THE DAY AFTER INDEPENDENCE DAY.  
  
IF INDEPENDENCE DAY IS ON A FRIDAY, SATURDAY, SUNDAY, OR MONDAY THEN BETWEEN THE HOURS OF 7:00 A.M. THE THURSDAY BEFORE INDEPENDENCE DAY AND 7:00 P.M. THE TUESDAY AFTER INDEPENDENCE DAY.
  6. FOR LABOR DAY, BETWEEN THE HOURS OF 7:00 A.M. FRIDAY AND 7:00 P.M. TUESDAY.
  7. FOR THANKSGIVING DAY, BETWEEN THE HOURS OF 7:00 A.M. TUESDAY TO 7:00 A.M. MONDAY.
  8. FOR CHRISTMAS, BETWEEN THE HOURS OF 7:00 A.M. THE FRIDAY BEFORE THE WEEK OF CHRISTMAS DAY AND 7:00 P.M. THE FOLLOWING TUESDAY AFTER THE WEEK OF CHRISTMAS.

### LANE AND SHOULDER CLOSURE REQUIREMENTS

- C) REMOVE LANE CLOSURE DEVICES FROM THE LANE WHEN WORK IS NOT BEING PERFORMED BEHIND THE LANE CLOSURE OR WHEN A LANE CLOSURE IS NO LONGER NEEDED OR AS DIRECTED BY THE ENGINEER.
- D) WHEN PERSONNEL AND/OR EQUIPMENT ARE WORKING WITHIN 15 FT OF AN OPEN TRAVEL LANE, CLOSE THE NEAREST OPEN SHOULDER USING ROADWAY STANDARD DRAWING NO. 1101.04 UNLESS THE WORK AREA IS PROTECTED BY BARRIER OR GUARDRAIL OR A LANE CLOSURE IS INSTALLED.
- E) WHEN PERSONNEL AND/OR EQUIPMENT ARE WORKING ON THE SHOULDER ADJACENT TO AN UNDIVIDED FACILITY AND WITHIN 5 FT OF AN OPEN TRAVEL LANE, CLOSE THE NEAREST OPEN TRAVEL LANE USING ROADWAY STANDARD DRAWING NO. 1101.02 UNLESS THE WORK AREA IS PROTECTED BY BARRIER OR GUARDRAIL.
- WHEN PERSONNEL AND/OR EQUIPMENT ARE WORKING ON THE SHOULDER ADJACENT TO A DIVIDED FACILITY AND WITHIN 10 FT OF AN OPEN TRAVEL LANE, CLOSE THE NEAREST OPEN TRAVEL LANE USING ROADWAY STANDARD DRAWING NO. 1101.02 UNLESS THE WORK AREA IS PROTECTED BY BARRIER OR GUARDRAIL.
- F) WHEN PERSONNEL AND/OR EQUIPMENT ARE WORKING WITHIN A LANE OF TRAVEL OF AN UNDIVIDED OR DIVIDED FACILITY, CLOSE THE LANE ACCORDING TO THE TRAFFIC CONTROL PLANS, ROADWAY STANDARD DRAWINGS, OR AS DIRECTED BY THE ENGINEER. CONDUCT THE WORK SO THAT ALL PERSONNEL AND/OR EQUIPMENT REMAIN WITHIN THE CLOSED TRAVEL LANE.
- G) DO NOT WORK SIMULTANEOUSLY WITHIN 15 FT ON BOTH SIDES OF AN OPEN TRAVELWAY, RAMP, OR LOOP WITHIN THE SAME LOCATION UNLESS PROTECTED WITH GUARDRAIL OR BARRIER.

### PAVEMENT EDGE DROP OFF REQUIREMENTS

- H) BACKFILL AT A 6:1 SLOPE UP TO THE EDGE AND ELEVATION OF EXISTING PAVEMENT IN AREAS ADJACENT TO AN OPENED TRAVEL LANE THAT HAS AN EDGE OF PAVEMENT DROP-OFF AS FOLLOWS:
- BACKFILL DROP-OFFS THAT EXCEED 2 INCHES ON ROADWAYS WITH POSTED SPEED LIMITS OF 45 MPH OR GREATER.
- BACKFILL DROP-OFFS THAT EXCEED 3 INCHES ON ROADWAYS WITH POSTED SPEED LIMITS LESS THAN 45 MPH.
- BACKFILL WITH SUITABLE COMPACTED MATERIAL, AS APPROVED BY THE ENGINEER, AT NO EXPENSE TO THE DEPARTMENT.
- I) DO NOT EXCEED A DIFFERENCE OF 2 INCHES IN ELEVATION BETWEEN OPEN LANES OF TRAFFIC FOR NOMINAL LIFTS OF 1.5 INCHES. INSTALL ADVANCE WARNING "UNEVEN LANES" SIGNS (W8-11) 350 FEET IN ADVANCE AND A MINIMUM OF EVERY HALF MILE THROUGHOUT THE UNEVEN AREA.

### TRAFFIC PATTERN ALTERATIONS

- J) NOTIFY THE ENGINEER ONE MONTH PRIOR TO ANY TRAFFIC PATTERN ALTERATION.

### SIGNING

- K) INSTALL ADVANCE WORK ZONE WARNING SIGNS WHEN WORK IS WITHIN 40 FT FROM THE EDGE OF TRAVEL LANE AND NO MORE THAN THREE (3) DAYS PRIOR TO THE BEGINNING OF CONSTRUCTION.
- L) ENSURE ALL NECESSARY SIGNING IS IN PLACE PRIOR TO ALTERING ANY TRAFFIC PATTERN.
- M) WHEN LANE CLOSURES ARE NOT IN EFFECT SPACE CHANNELIZING DEVICES IN WORK AREAS NO GREATER IN FEET THAN TWICE THE POSTED SPEED LIMIT (MPH) EXCEPT, 10 FT ON-CENTER IN RADII, AND 3 FT OFF THE EDGE OF AN OPEN TRAVELWAY. REFER TO STANDARD SPECIFICATIONS FOR ROADS AND STRUCTURES SECTIONS 1130 (DRUMS), 1135 (CONES), AND 1180 (SKINNY DRUMS) FOR ADDITIONAL REQUIREMENTS.
- N) PLACE TYPE III BARRICADES, WITH "ROAD CLOSED" SIGN R11-2 ATTACHED, OF SUFFICIENT LENGTH TO CLOSE ENTIRE ROADWAY.
- O) PLACE ADDITIONAL SETS OF THREE CHANNELIZING DEVICES (DRUMS) PERPENDICULAR TO THE EDGE OF TRAVELWAY ON 500 FT CENTERS WHEN UNOPENED LANES ARE CLOSED TO TRAFFIC.

### PAVEMENT MARKINGS AND MARKERS

- P) INSTALL TEMPORARY PAVEMENT MARKINGS AND TEMPORARY PAVEMENT MARKERS ON INTERIM LAYERS OF PAVEMENT AS FOLLOWS:
- |                  |         |        |
|------------------|---------|--------|
| ROAD NAME        | MARKING | MARKER |
| NC8 (WINSTON RD) | PAINT   | NONE   |
- Q) PLACE ONE APPLICATION OF PAINT FOR TEMPORARY TRAFFIC PATTERNS. PLACE A SECOND APPLICATION OF PAINT SIX (6) MONTHS AFTER THE INITIAL APPLICATION AND EVERY SIX MONTHS AS DIRECTED BY THE ENGINEER.
- R) TIE PROPOSED PAVEMENT MARKING LINES TO EXISTING PAVEMENT MARKING LINES.
- S) REMOVE/REPLACE ANY CONFLICTING/DAMAGED PAVEMENT MARKINGS AND MARKERS BY THE END OF EACH DAY'S OPERATION.
- T) TRACE THE PROPOSED MONOLITHIC ISLAND LOCATIONS WITH PROPER COLOR PAVEMENT MARKINGS PRIOR TO INSTALLATION. PLACE DRUMS TO DELINEATE ANY PROPOSED MONOLITHIC ISLANDS.

### MISCELLANEOUS

- U) ALL CURB RAMP LOCATIONS SHALL BE DERIVED FROM STATIONING SHOWN ON PAVEMENT MARKING PLANS OR AS DIRECTED BY THE ENGINEER IN COORDINATION WITH THE SIGNING AND DELINEATION UNIT.
- V) CONTRACTOR SHALL MAINTAIN SIDEWALK ACCESS AT ALL TIMES AS STATED IN THE PHASING. CONTRACTOR SHALL BE RESPONSIBLE TO PROVIDE TEMPORARY SIDEWALKS (CONCRETE, ASPHALT, OR OTHER SUITABLE MATERIAL AS APPROVED BY THE ENGINEER) AT ALL LOCATIONS WHERE THE OPEN PEDESTRIAN TRAVELWAY HAS BEEN REMOVED FOR CONSTRUCTION OPERATIONS (UTILITIES, DRAINAGE, ETC.).

6/19/2024 X:\2015\PL15-010-00\_U-5757\_NC8\_WinstonRd\_widen\_Lexington\TrafficControl\TCP\U-5757\_TC\_TMP\_02.dgn jbauman

**TRANSYSTEMS**  
1 Glenwood Avenue  
Raleigh, NC 27603  
Tel: 919.789.9977  
Fax: 919.789.9591  
License: F-0453

APPROVED: \_\_\_\_\_  
DATE: \_\_\_\_\_

SEAL

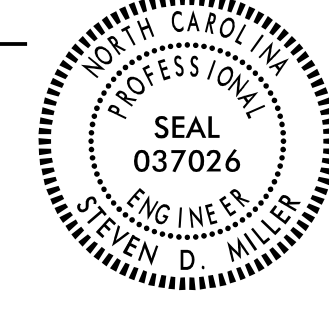

**DOCUMENT NOT CONSIDERED FINAL  
UNLESS ALL SIGNATURES COMPLETED**

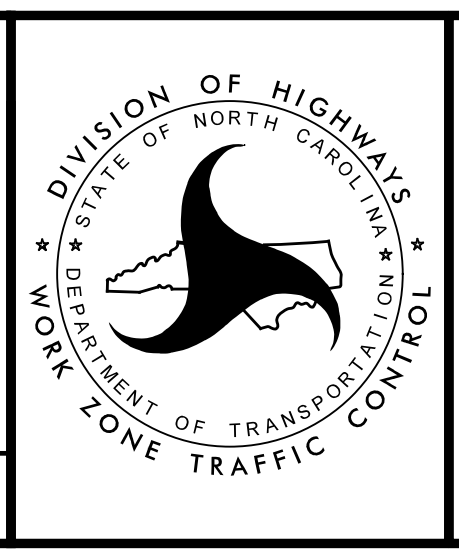

## TRANSPORTATION OPERATIONS PLAN

## PHASING

### PHASE I

- STEP 1: USING ROADWAY STANDARD DRAWING 1101.01 SHEETS 2 AND 3 OF 3  
INSTALL ADVANCE WARNING SIGNS ON NC 8 AND ALL -Y- LINES.
- STEP 2: USING ROADWAY STANDARD DRAWING 1101.02 SHEETS 1 AND 3 OF 19,  
BEGIN CONSTRUCTION ON THE RIGHT SIDE OF -L- AS SHOWN ON TMP 4-6  
UP TO BUT NOT INCLUDING THE FINAL LAYER OF SURFACE COURSE.  
CONTRACTOR MUST CLOSE SIDEWALK USING PEDESTRIAN BARRICADES AND  
AUDIBLE WARNING DEVICES AS SHOWN ON TMP-4.

WORK IN A CONTINUOUS MANNER TO COMPLETE THE WORK OF PHASE I STEP 3 IN SEVENTY-TWO (72) CONSECUTIVE HOURS. SEE INTERMEDIATE CONTRACT TIME AND LIQUIDATED DAMAGES.

- STEP 3: USING ROADWAY STANDARD DRAWING 1101.02 SHEETS 1 AND 3 OF 19,  
COMPLETE CONSTRUCTION NECESSARY FOR PHASE II PATTERN. PLACE  
TEMPORARY PAVEMENT MARKINGS AND MARKERS AND SHIFT TRAFFIC TO  
PHASE II PATTERN.

NOTE: WEDGE AS NEEDED TO MAINTAIN SMOOTH TRANSITION FROM PROPOSED TO EXISTING.

NOTE: ADJUST SIGNAL PATTERNS AS NEEDED WHERE TRAFFIC PATTERNS ARE AFFECTED BY CROSSOVERS.

### PHASE II

- STEP 1: AWAY FROM TRAFFIC AND USING ROADWAY STANDARD DRAWING 1101.02 SHEETS 1 AND 3 OF 19 AS NEEDED, COMPLETE CONSTRUCTION ON THE LEFT SIDE OF -L- .
- STEP 2: USING ROADWAY STANDARD DRAWING 1101.02 SHEETS 1 AND 3 OF 19,  
WEDGE UP TO, BUT NOT INCLUDING THE FINAL LAYER OF SURFACE COURSE,  
PLACE TEMPORARY PAVEMENT MARKINGS AND MARKERS IN THE FINAL PATTERN AND SHIFT TRAFFIC TO PHASE III PATTERN.

NOTE: ADJUST SIGNAL PATTERNS AS NEEDED WHERE TRAFFIC PATTERNS ARE AFFECTED BY CROSSOVERS.

### PHASE III

- STEP 1: USING ROADWAY STANDARD DRAWING 1101.02 SHEETS 1 AND 3 OF 19,  
CONSTRUCT CONCRETE MEDIAN ISLANDS AND MEDIAN CURB & GUTTER.
- STEP 2: USING ROADWAY STANDARD DRAWING 1101.02 SHEETS 1 AND 3 OF 19,  
PLACE FINAL LAYER OF SURFACE COURSE, FINAL PAVEMENT MARKINGS AND MARKINGS PER THE FINAL PAVEMENT MARKING PLAN.
- STEP 3: REMOVE ALL WORK ZONE TRAFFIC CONTROL DEVICES.

7/24/2024 X:\2015\PL15.010.00\_U-5757\_NC8\_WinstonRd\_widen\_Lexington\Traffic\TrafficControl\TCP\U-5757\_TC\_TMP\_03.dgn jbauman

**TRANSYSTEMS**  
1 Glenwood Avenue  
Raleigh, NC 27603  
Tel: 919.789.9977  
Fax: 919.789.9591  
License: F-0453

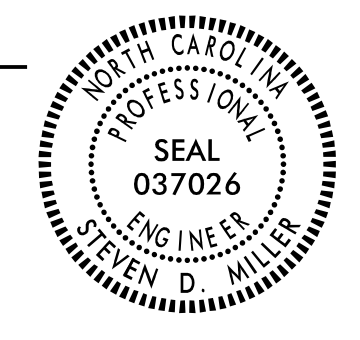
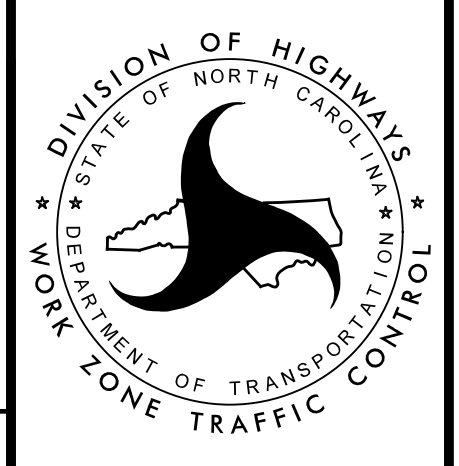
APPROVED: _____ DATE: _____ <div style="text-align: center; margin-top: 10px;">  </div>		<h1 style="font-size: 2em; margin: 0;">PHASING</h1>
<b>DOCUMENT NOT CONSIDERED FINAL UNLESS ALL SIGNATURES COMPLETED</b>		

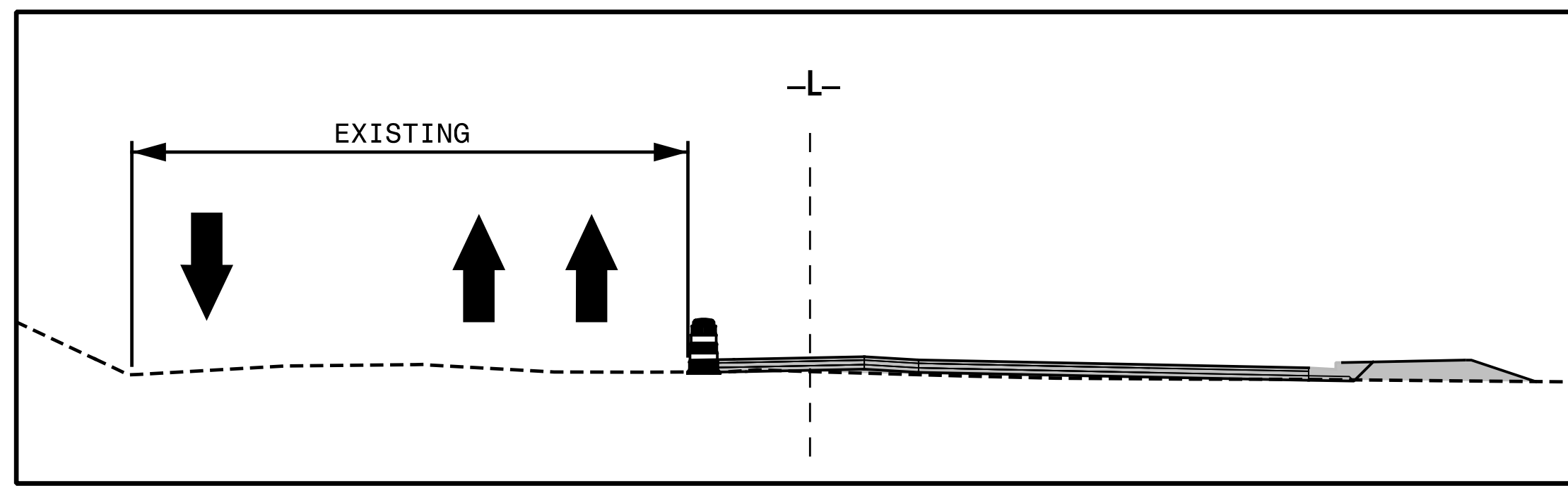
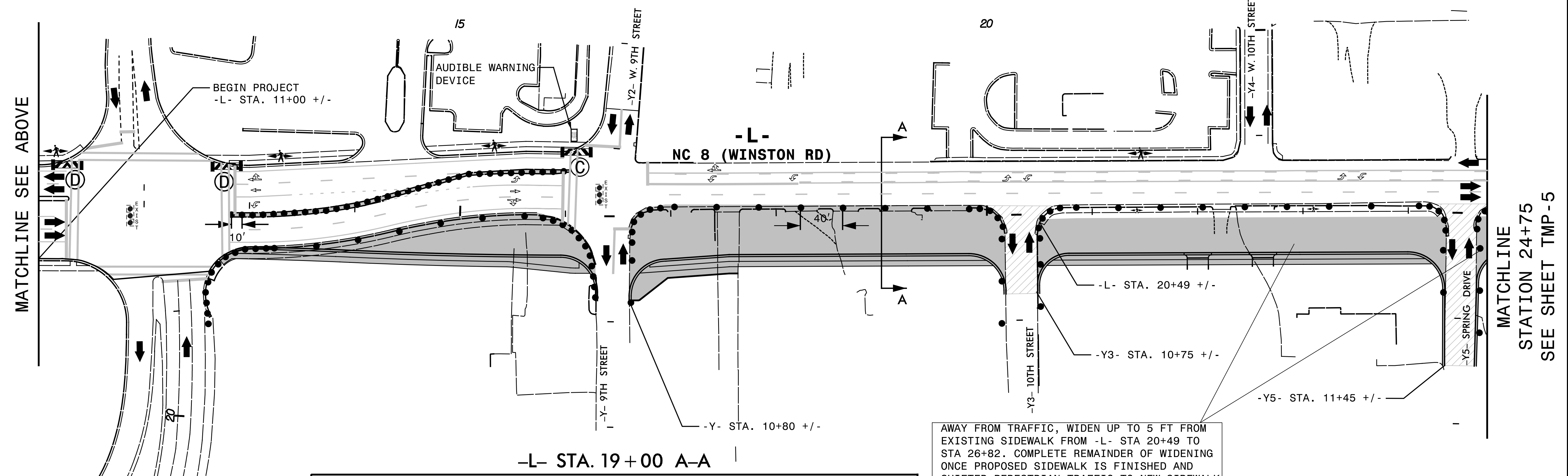
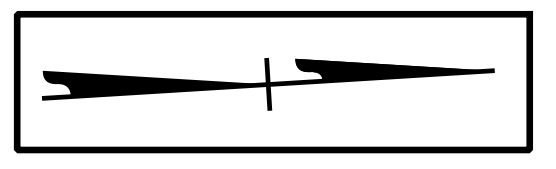
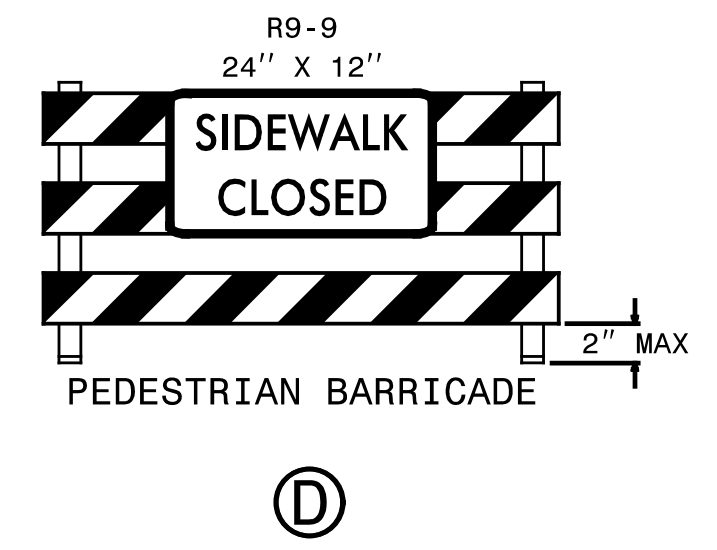
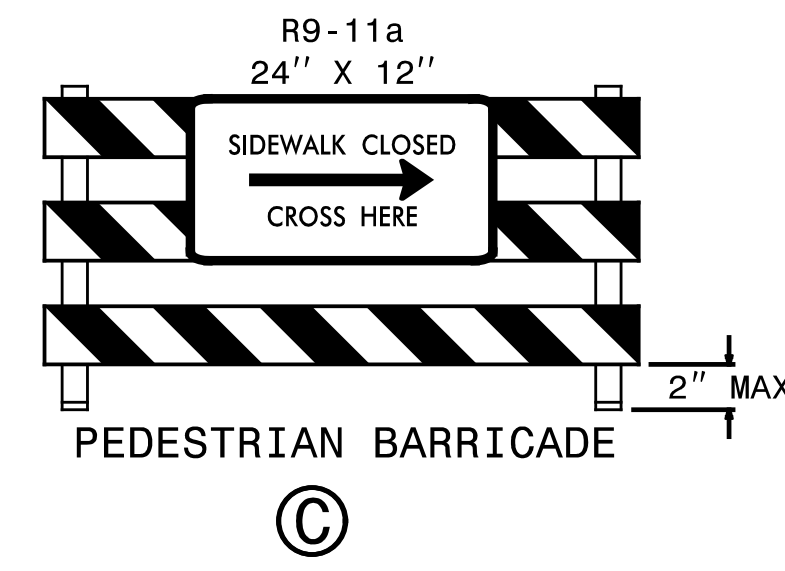
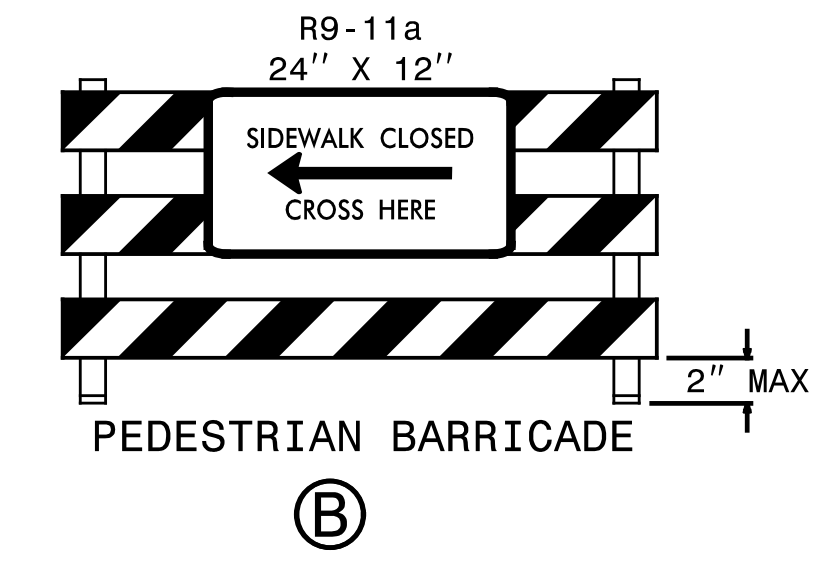
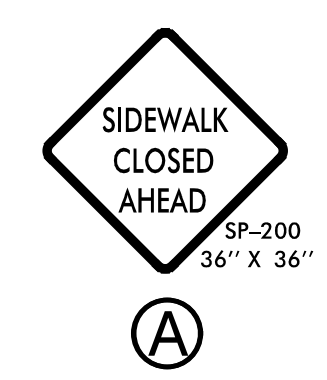
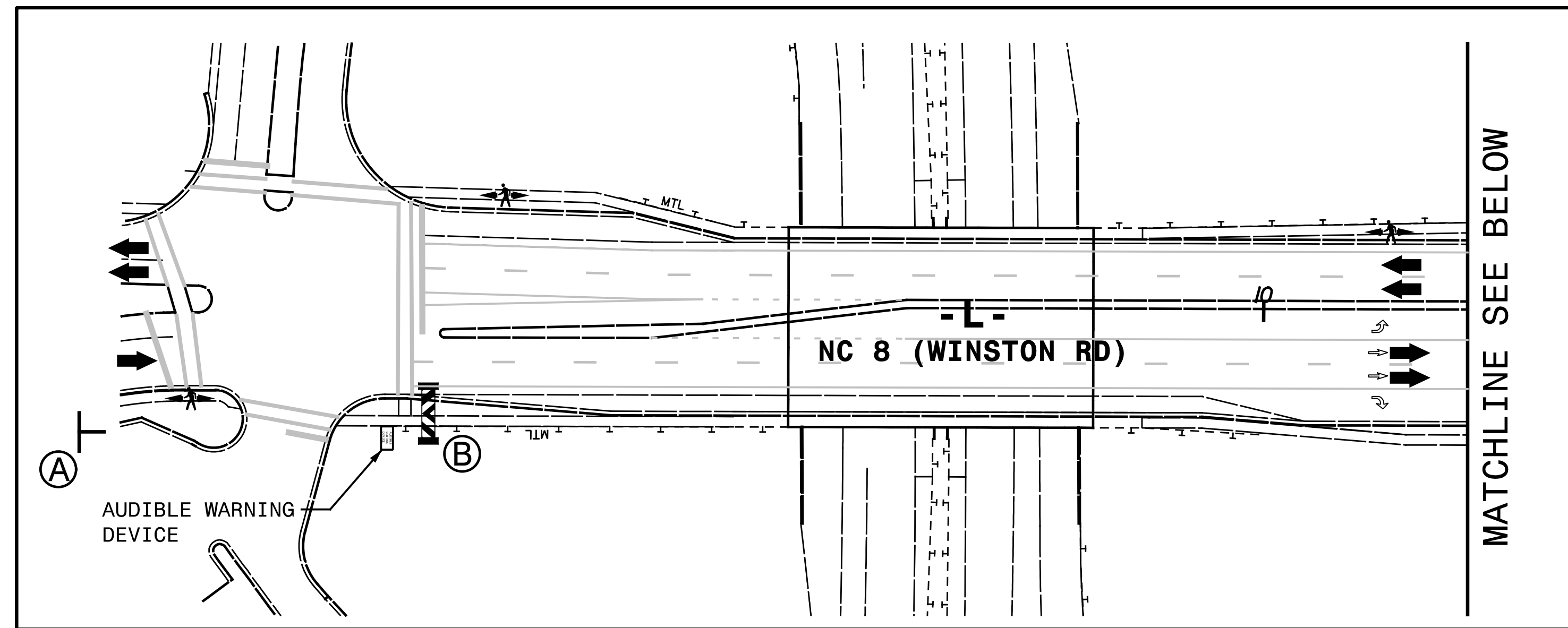

AWAY FROM TRAFFIC, WIDEN UP TO 5 FT FROM EXISTING SIDEWALK FROM -L- STA 20+49 TO STA 26+82. COMPLETE REMAINDER OF WIDENING ONCE PROPOSED SIDEWALK IS FINISHED AND SHIFTED PEDESTRIAN TRAFFIC TO NEW SIDEWALK

4/24/2024 X:\2015\PL15-010-00\_U-5757\_NC8\_WinstonRd\_widen\_Lexington\TrafficControl\U-5757\_TC\_TMP\_04.dgn jbauman

**TRANSYSTEMS**  
 1 Glenwood Avenue  
 Raleigh, NC 27603  
 Tel: 919.789.9977  
 Fax: 919.789.9591  
 License: F-0453

APPROVED: \_\_\_\_\_  
 DATE: \_\_\_\_\_  
 SEAL

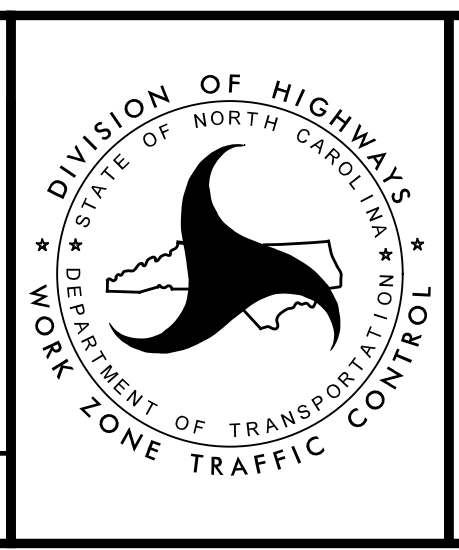

**PHASE I**

**DOCUMENT NOT CONSIDERED FINAL UNLESS ALL SIGNATURES COMPLETED**

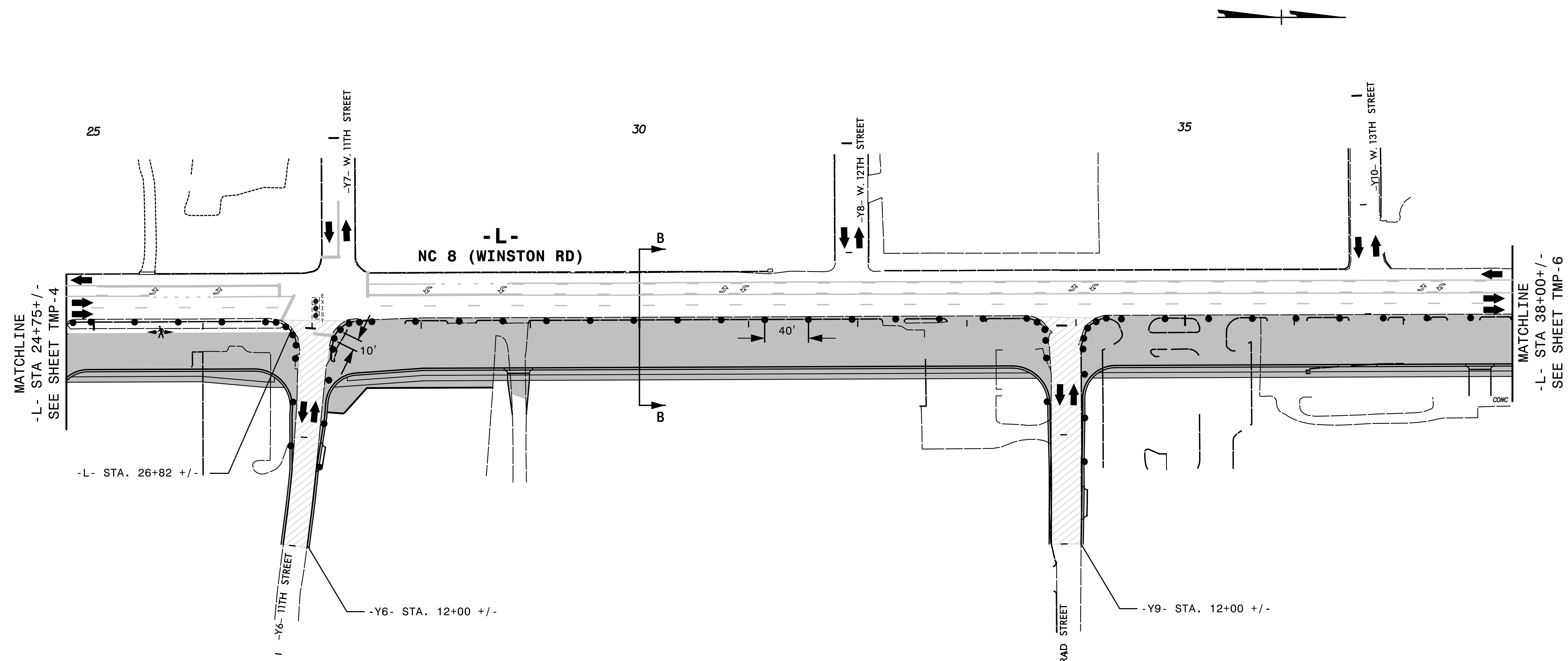

MATCHLINE  
-L- STA 24+75+/-  
SEE SHEET TMP-4

MATCHLINE  
-L- STA 38+00+/-  
SEE SHEET TMP-6

-L- STA. 26+82 +/-

-Y6- 11TH STREET

-Y6- STA. 12+00 +/-

-L-  
NC 8 (WINSTON RD)

30

-Y8- W. 12TH STREET

35

-Y10- W. 13TH STREET

-Y9- CONRAD STREET

-Y9- STA. 12+00 +/-

-L- STA. 30+00 B-B

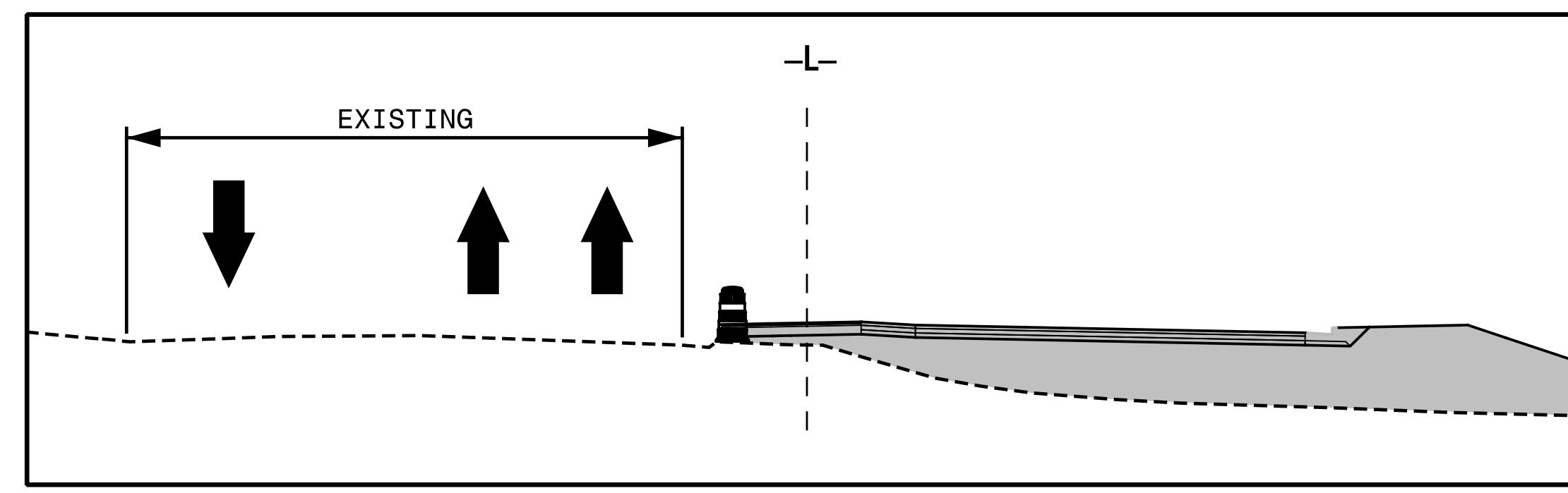

4/24/2024  
X:\2015\PL15-010-00\_U-5757\_NC8\_WinstonRd\_widen\_Lexington\Traffic\TrafficControl\U-5757-TC-TMP\_05.dgn  
jbauman

**TRANSYSTEMS**  
1 Glenwood Avenue  
Raleigh, NC 27603  
Tel: 919.789.9977  
Fax: 919.789.9591  
License: F-0453

APPROVED: \_\_\_\_\_  
DATE: \_\_\_\_\_  
SEAL  
**SEAL**  
037026  
ENGINEER  
STEVEN D. MILLER

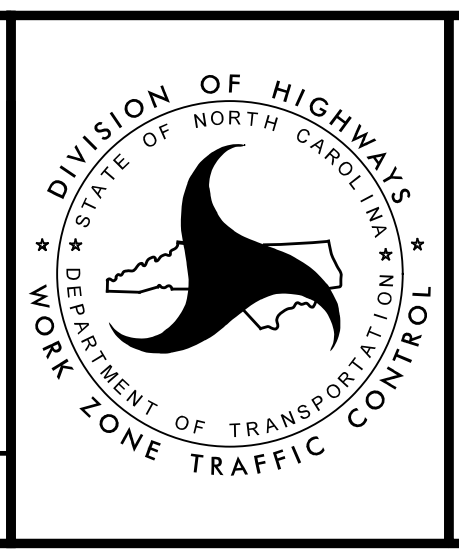

**PHASE I**

**DOCUMENT NOT CONSIDERED FINAL  
UNLESS ALL SIGNATURES COMPLETED**

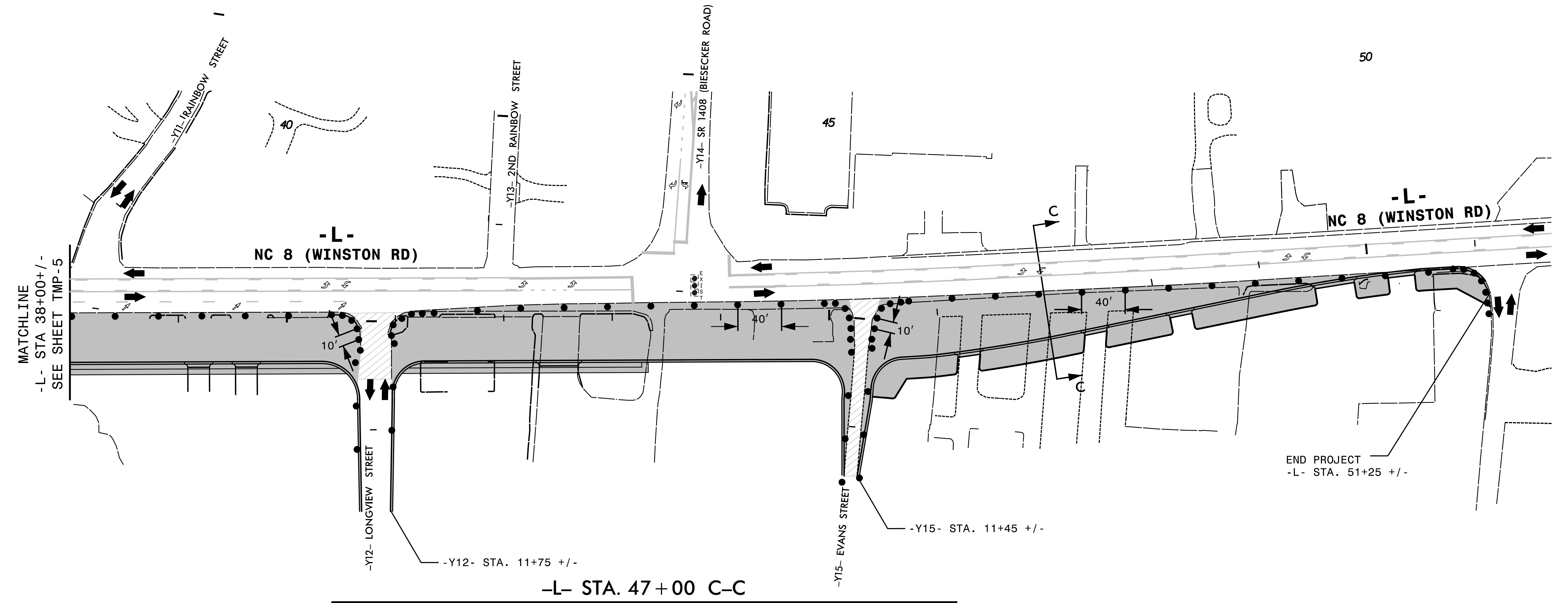
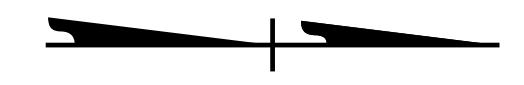

4/24/2024  
 X:\2015\PL15-010-00\_U-5757\_NC8\_WinstonRd\_widen\_Lexington\TrafficControl\TCP\U-5757\_TC\_TMP\_06.dgn  
 jbauman

**TRANSYSTEMS**  
 1 Glenwood Avenue  
 Raleigh, NC 27603  
 Tel: 919.789.9977  
 Fax: 919.789.9591  
 License: F-0453

APPROVED: \_\_\_\_\_  
 DATE: \_\_\_\_\_  
 SEAL

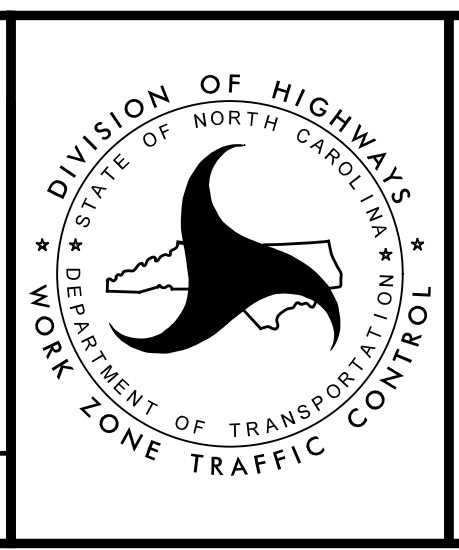

PHASE I

DOCUMENT NOT CONSIDERED FINAL  
UNLESS ALL SIGNATURES COMPLETED

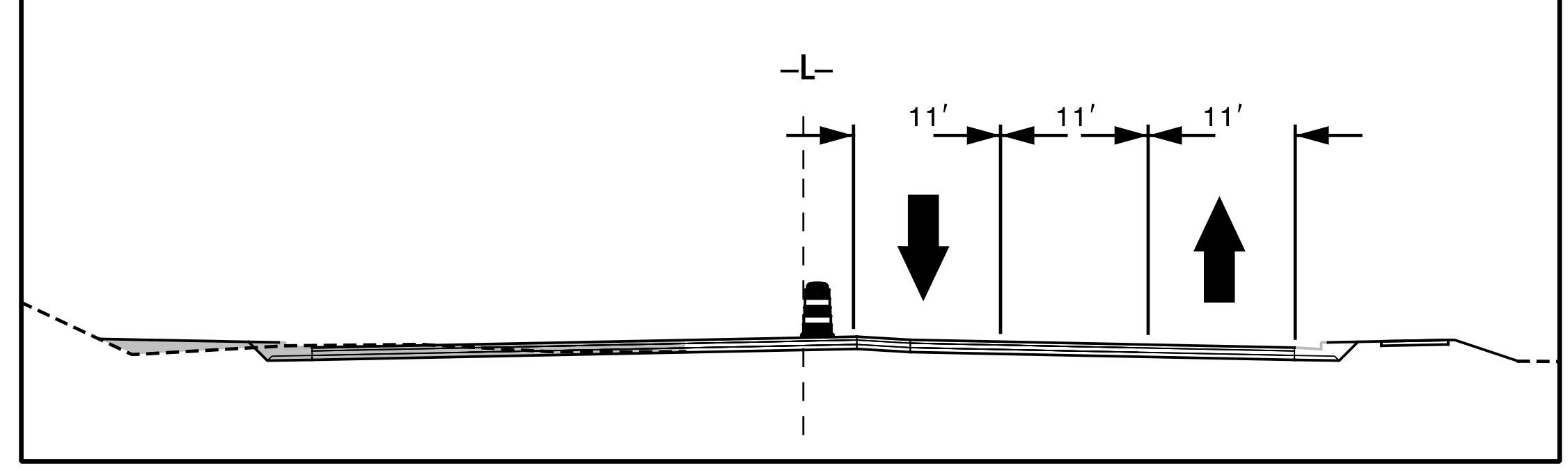
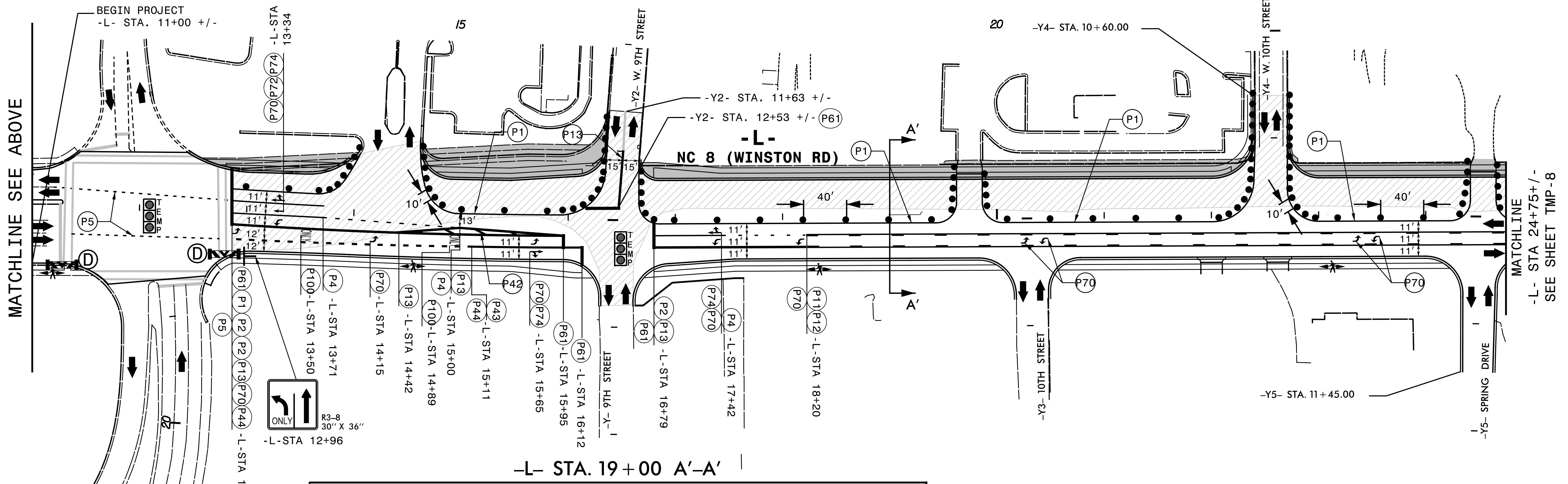
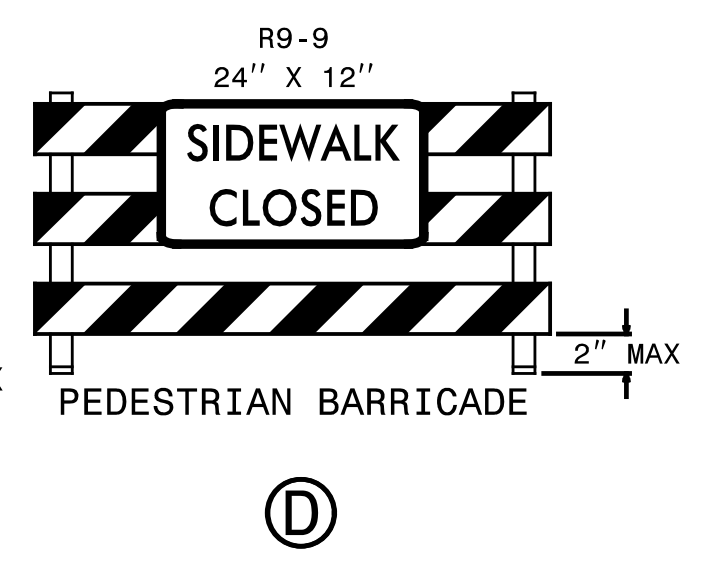
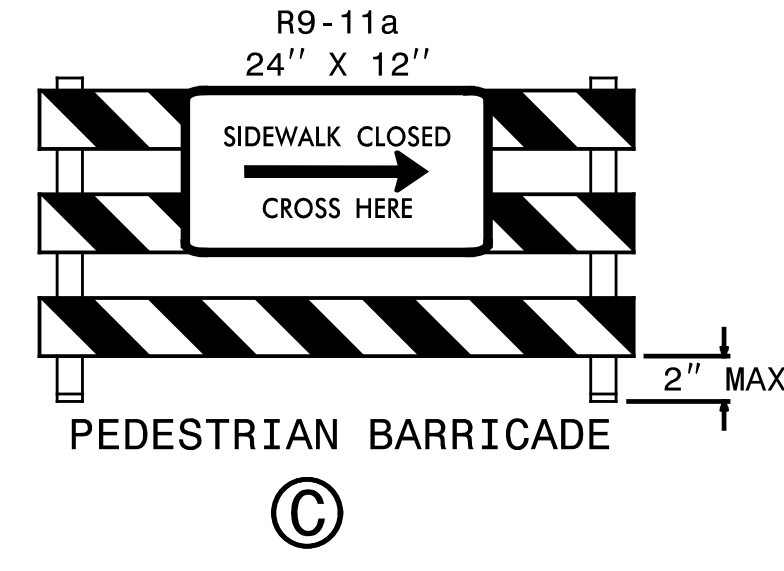
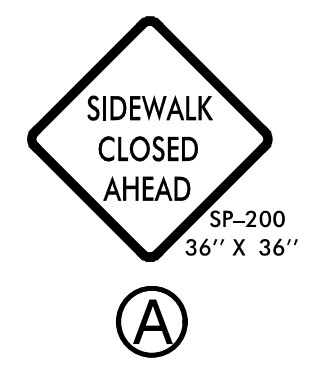
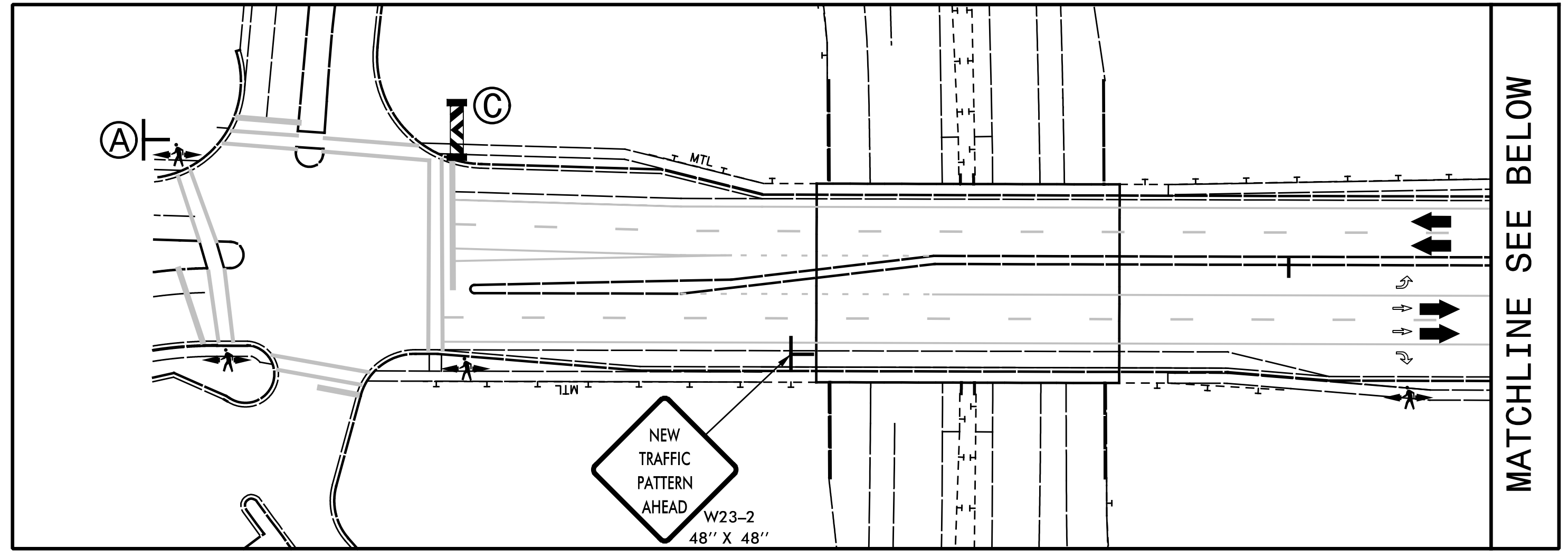

MATCHLINE SEE ABOVE

MATCHLINE SEE BELOW

MATCHLINE  
-L- STA 24+75 +/-  
SEE SHEET TMP-8

4/24/2024  
X:\2015\PL15-010-00\_U-5757\_NC8\_WinstonRd\_widen\_Lexington\Traffic\TrafficControl\TCP\U-5757\_TC\_TMP-07.dgn  
jbauman

**TRANSYSTEMS**  
1 Glenwood Avenue  
Raleigh, NC 27603  
Tel: 919.789.9977  
Fax: 919.789.9591  
License: F-0453

APPROVED: \_\_\_\_\_  
DATE: \_\_\_\_\_  
SEAL

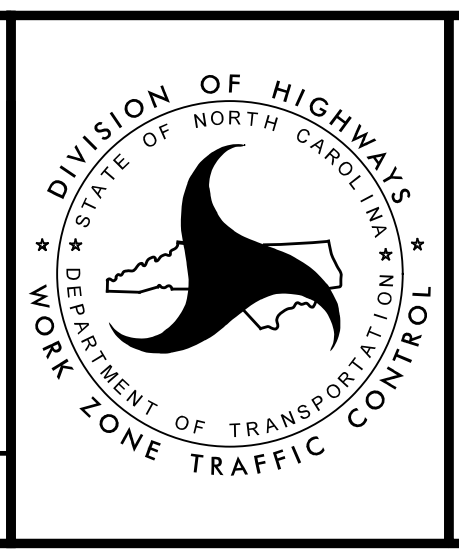

**PHASE II**

**DOCUMENT NOT CONSIDERED FINAL  
UNLESS ALL SIGNATURES COMPLETED**



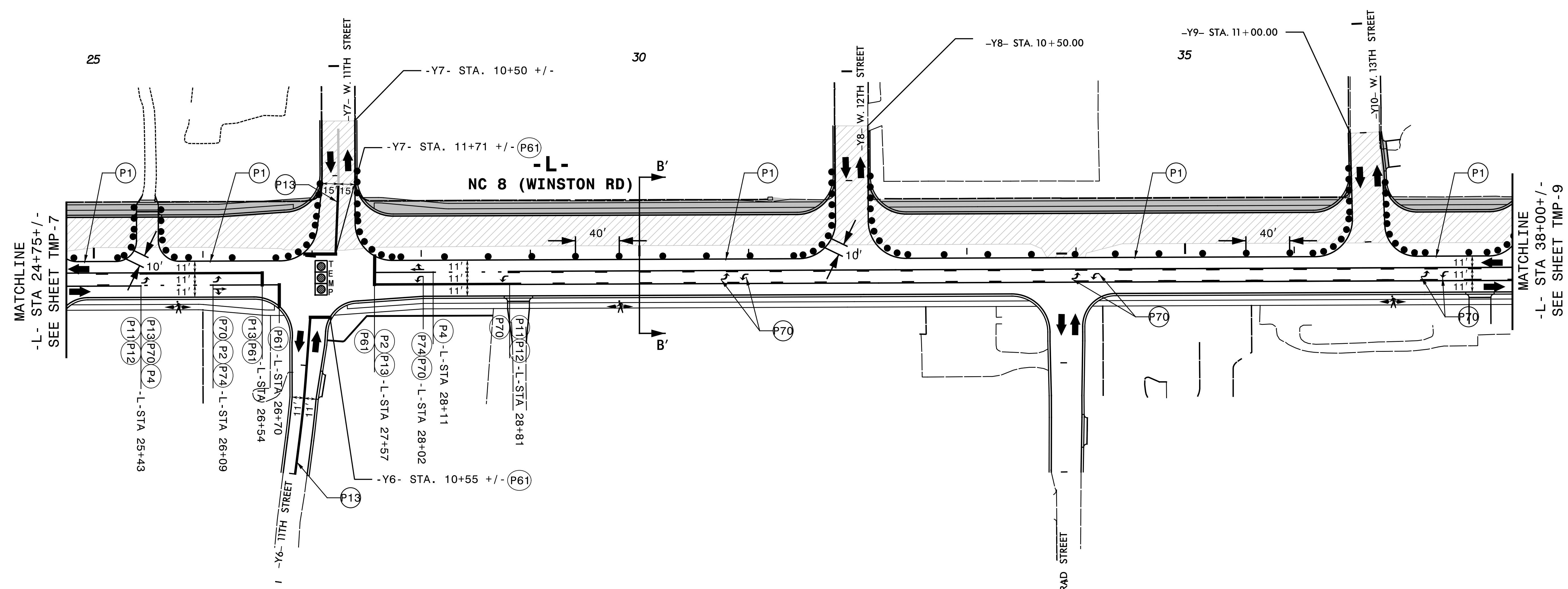
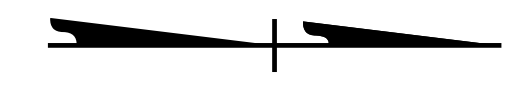

-L- STA. 30+00 B'-B'

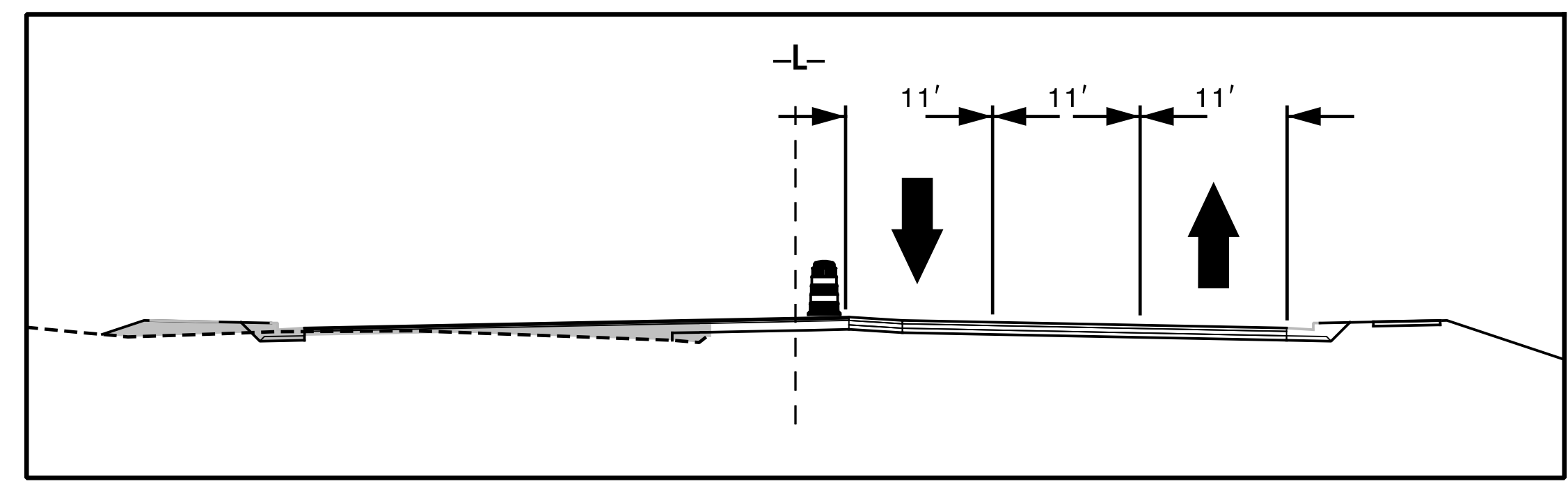

4/24/2024 X:\2015\PL15-010-00\_U-5757\_NC8\_WinstonRd\_widen\_Lexington\Traffic\TrafficControl\TCP\U-5757\_TC\_TMP\_08.dgn jbauman

**TRANSYSTEMS**  
 1 Glenwood Avenue  
 Raleigh, NC 27603  
 Tel: 919.789.9977  
 Fax: 919.789.9591  
 License: F-0453

APPROVED: \_\_\_\_\_  
 DATE: \_\_\_\_\_  
 SEAL

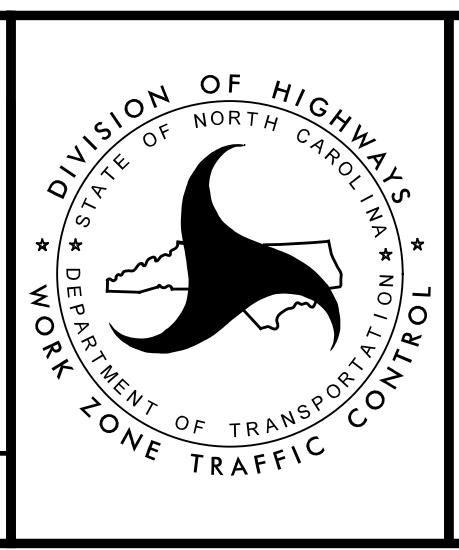

**PHASE II**

**DOCUMENT NOT CONSIDERED FINAL  
 UNLESS ALL SIGNATURES COMPLETED**

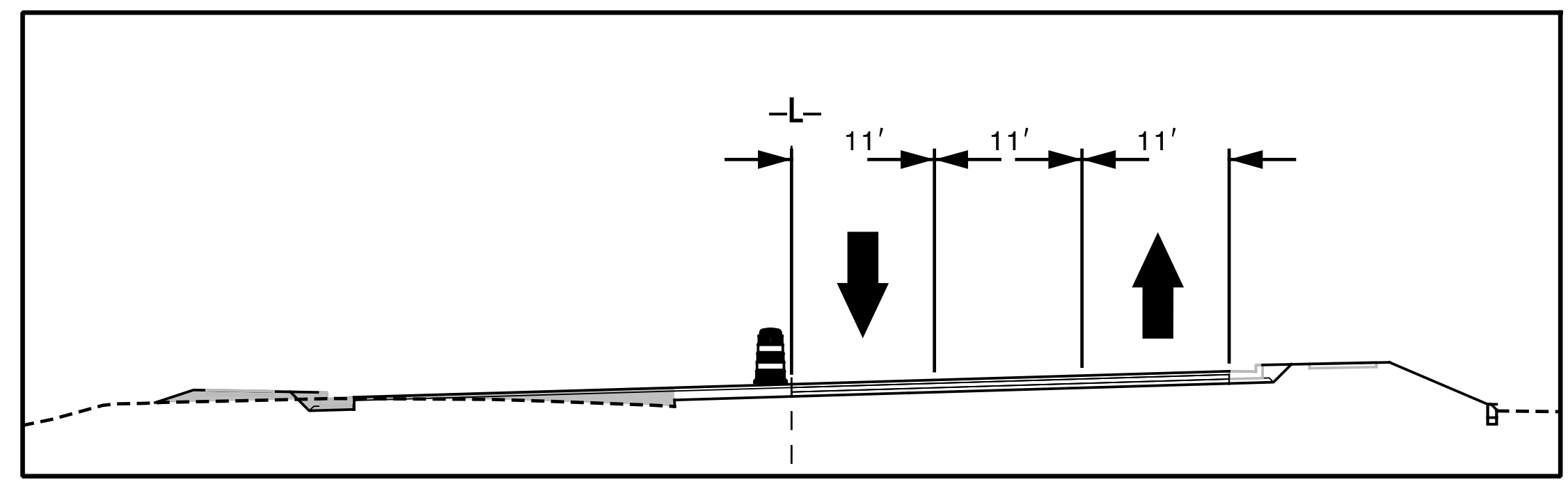
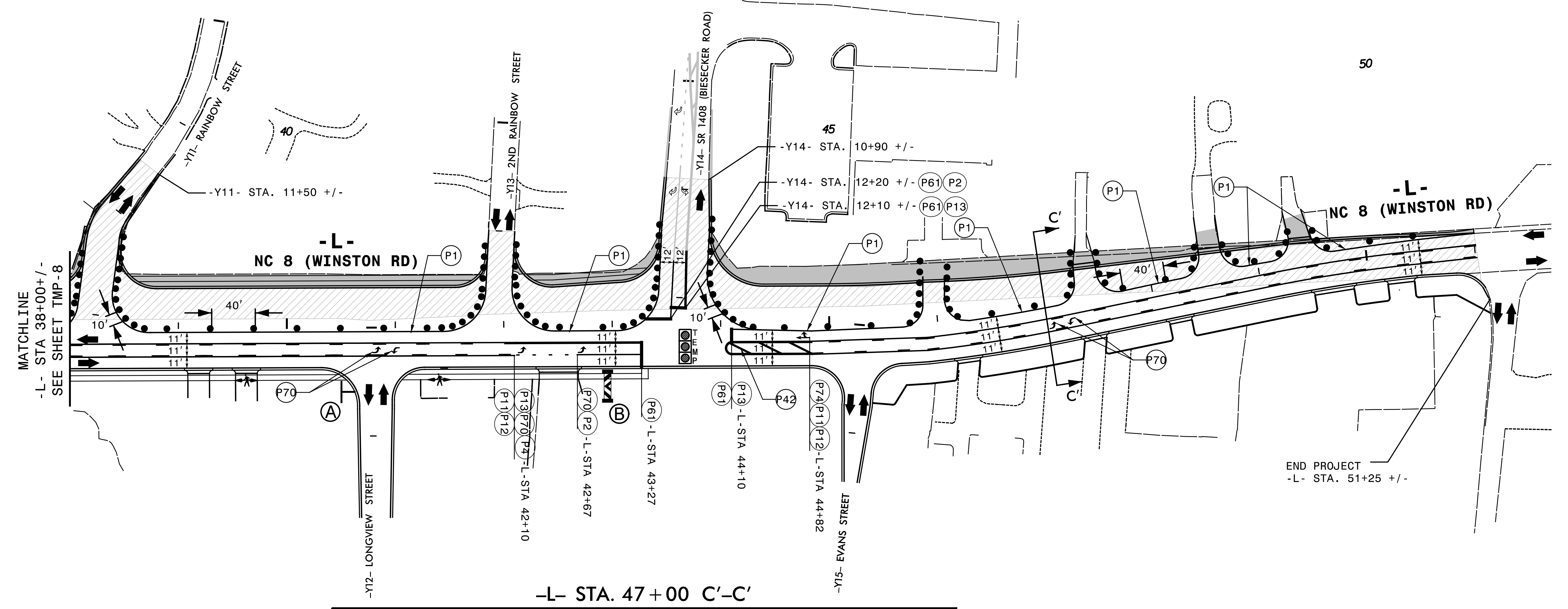
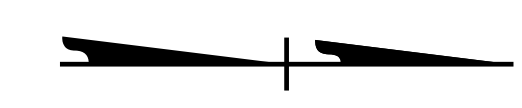
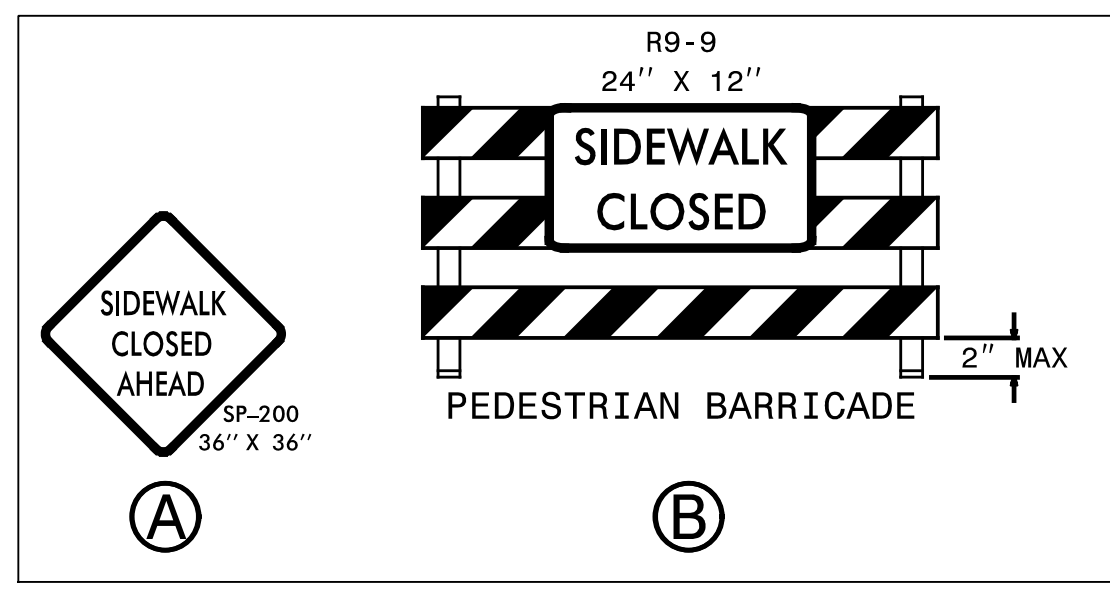

4/24/2024 X:\2015\PL15-010-00\_U-5757\_NC8\_WinstonRd\_widen\_Lexington\TrafficControl\TCP\U-5757\_TC\_TMP\_09.dgn jbauman

**TRANSYSTEMS**  
1 Glenwood Avenue  
Raleigh, NC 27603  
Tel: 919.789.9977  
Fax: 919.789.9591  
License: F-0453

APPROVED: \_\_\_\_\_  
DATE: \_\_\_\_\_

SEAL

**DOCUMENT NOT CONSIDERED FINAL  
UNLESS ALL SIGNATURES COMPLETED**

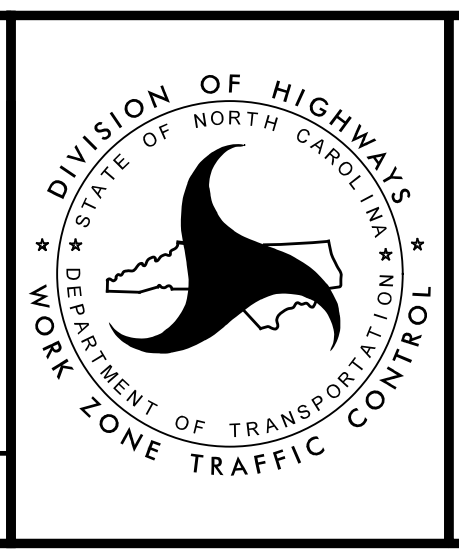

**PHASE II**

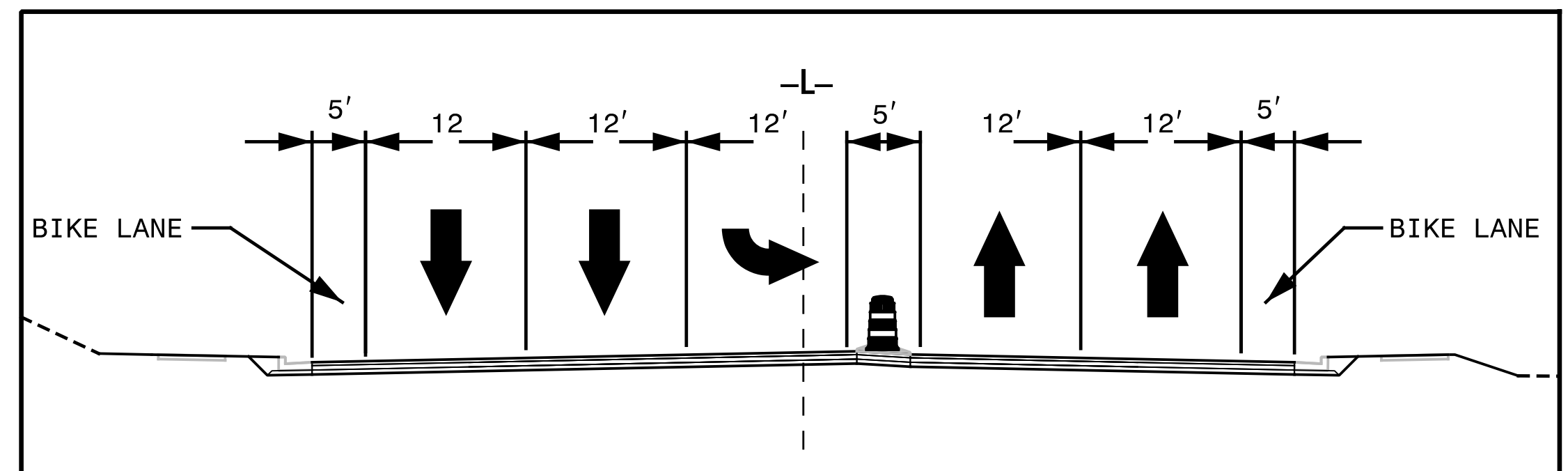
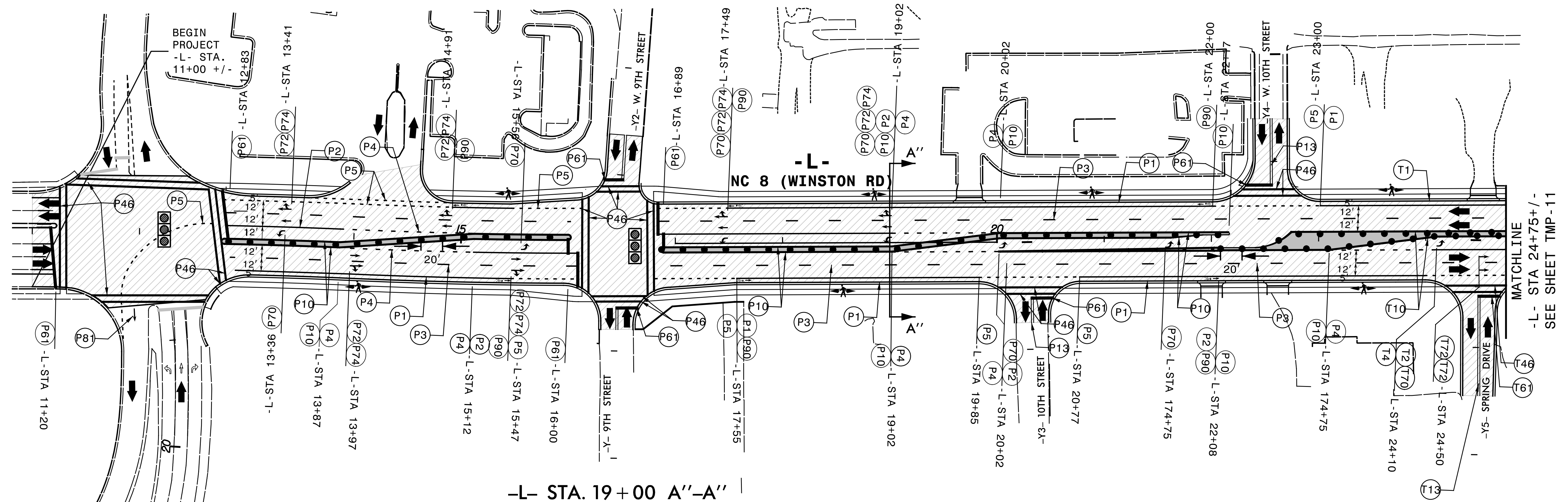

4/24/2024  
 X:\2015\PL15-010-00\_U-5757\_NC8\_WinstonRd\_widen\_Lexington\Traffic\TrafficControl\U-5757-TC\_TMP\_10.dgn  
 jbauman

MATCHLINE  
 -L- STA 24+75 +/-  
 SEE SHEET TMP-11

**TRANSYSTEMS**  
 1 Glenwood Avenue  
 Raleigh, NC 27603  
 Tel: 919.789.9977  
 Fax: 919.789.9591  
 License: F-0453

APPROVED: \_\_\_\_\_

DATE: \_\_\_\_\_

SEAL

**DOCUMENT NOT CONSIDERED FINAL  
UNLESS ALL SIGNATURES COMPLETED**

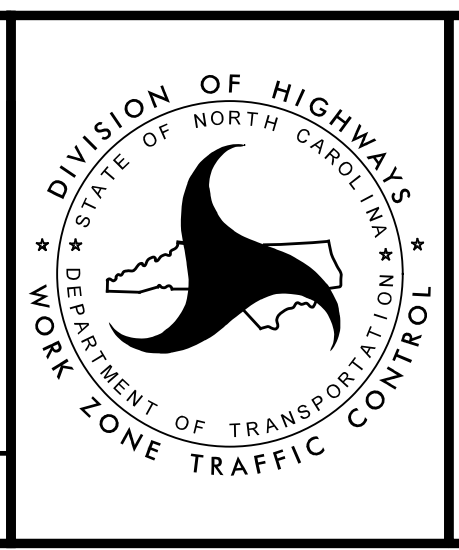

PHASE III

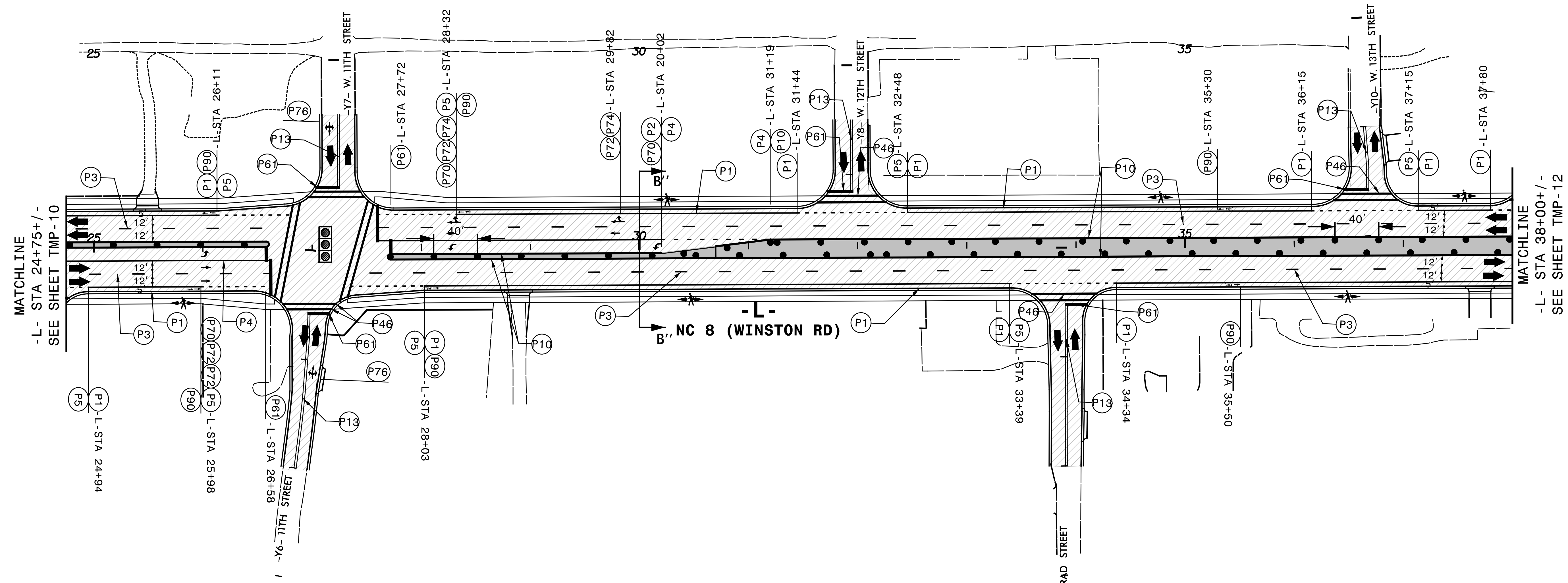

MATCHLINE  
-L- STA 24+75+/-  
SEE SHEET TMP-10

MATCHLINE  
-L- STA 38+00+/-  
SEE SHEET TMP-12

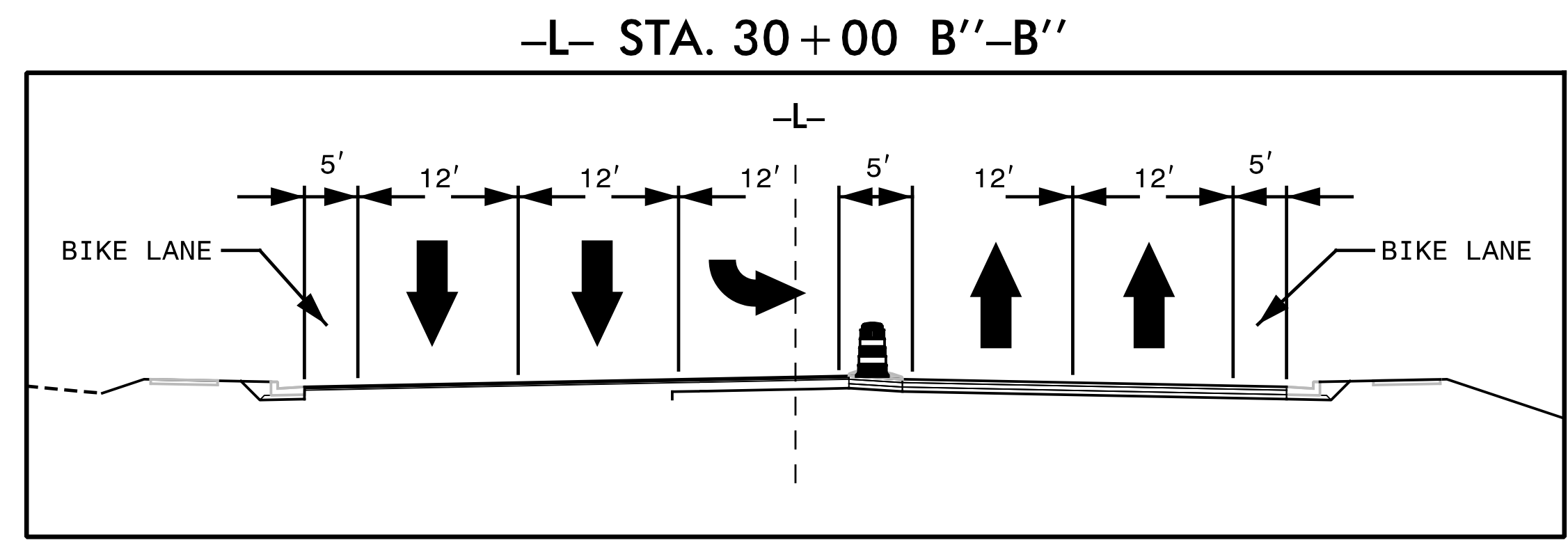

4/24/2024  
 X:\2015\PL15-010-00\_U-5757\_NC8\_WinstonRd\_widen\_Lexington\TrafficControl\TCP\U-5757\_TC\_TMP\_11.dgn  
 jbauman

**TRANSYSTEMS**  
 1 Glenwood Avenue  
 Raleigh, NC 27603  
 Tel: 919.789.9977  
 Fax: 919.789.9591  
 License: F-0453

APPROVED: \_\_\_\_\_  
 DATE: \_\_\_\_\_

SEAL

**DOCUMENT NOT CONSIDERED FINAL  
UNLESS ALL SIGNATURES COMPLETED**

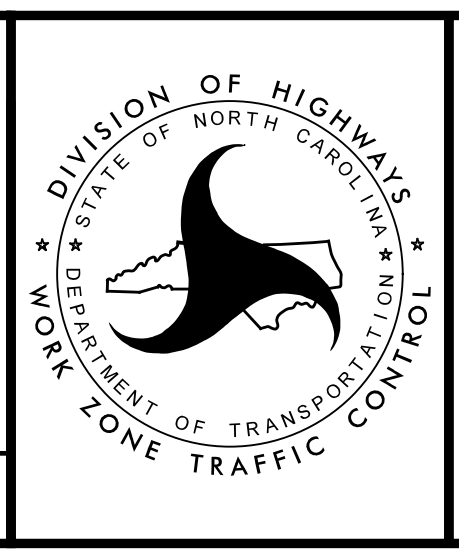

**PHASE III**

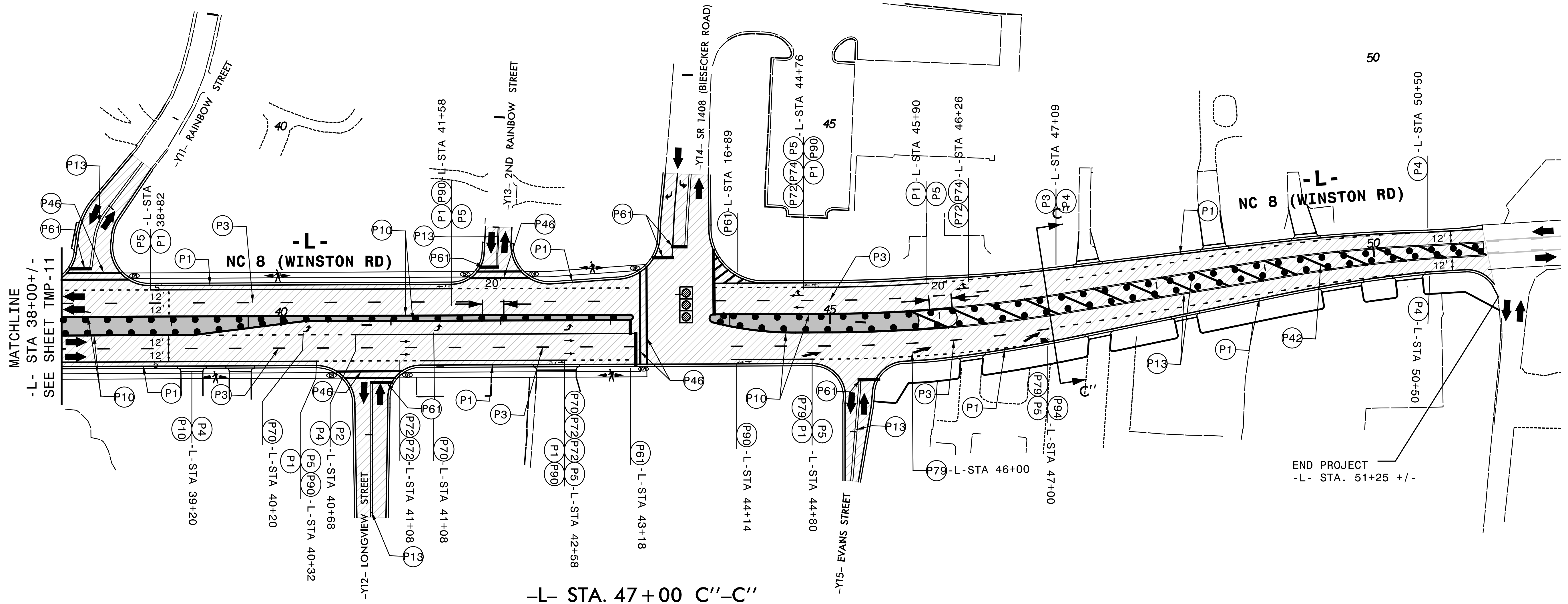

MATCHLINE  
-L- STA 38+00 +/-  
SEE SHEET TMP-11

END PROJECT  
-L- STA. 51+25 +/-

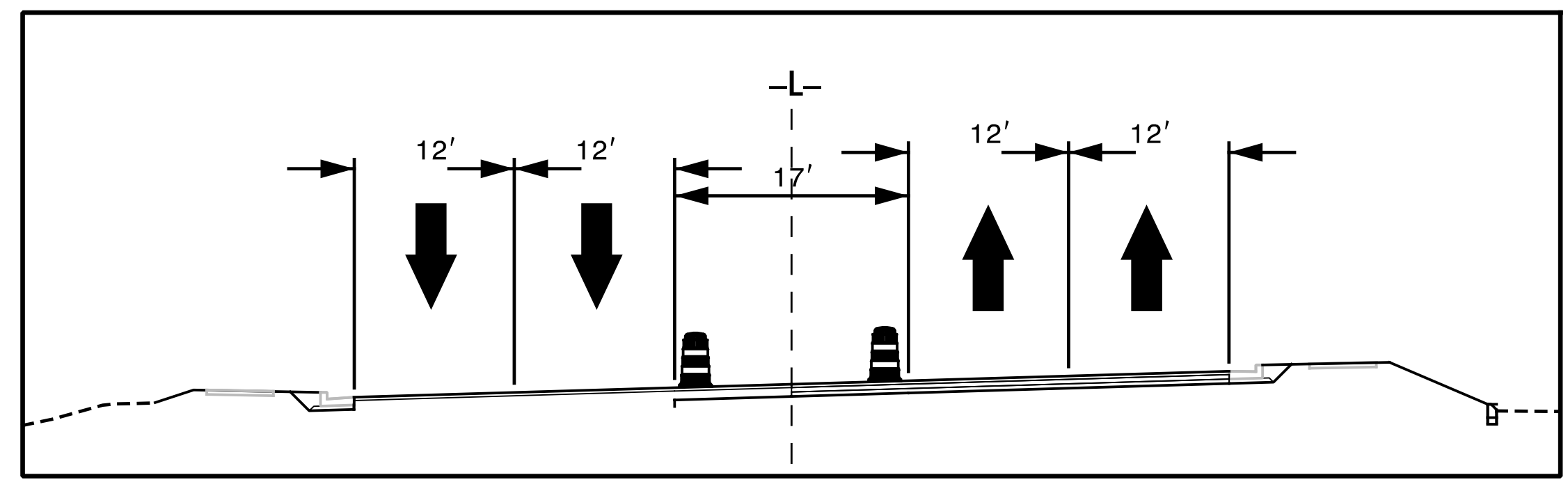

-L- STA. 47+00 C''-C''

4/24/2024  
 X:\2015\PL15-010-00\_U-5757\_NC8\_WinstonRd\_widen\_Lexington\TrafficControl\TCP\U-5757-TC\_TMP\_I2.dgn  
 jbauman

**TRANSYSTEMS**  
 1 Glenwood Avenue  
 Raleigh, NC 27603  
 Tel: 919.789.9977  
 Fax: 919.789.9591  
 License: F-0453

APPROVED: \_\_\_\_\_  
 DATE: \_\_\_\_\_

SEAL

**DOCUMENT NOT CONSIDERED FINAL  
UNLESS ALL SIGNATURES COMPLETED**

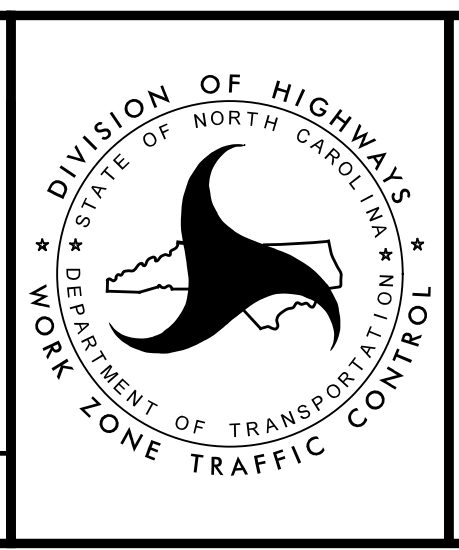

**PHASE III**