

DEFAULT PHASING DIAGRAM

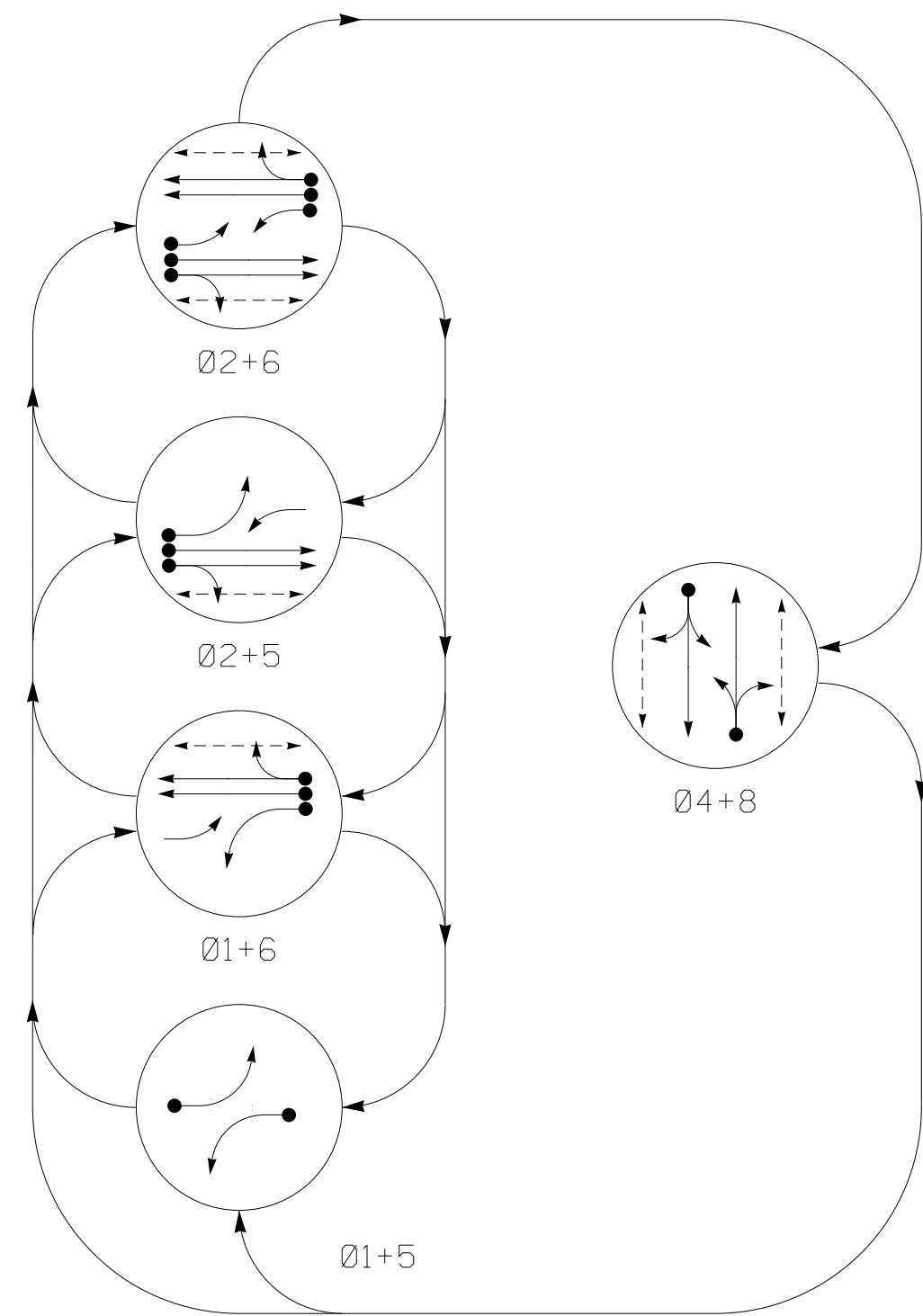

DEFAULT PHASING TABLE OF OPERATION

SIGNAL FACE	PHASE					FLASH
	01+5	01+6	02+5	02+6	04+8	
11	←	←	←	←	←	Y
21,22	R	R	R	R	R	Y
41,42,43	R	R	R	R	R	G
51	←	←	←	←	←	Y
61,62	R	G	R	G	R	Y
81,82,83	R	R	R	R	R	G
P21,P22	DW	DW	W	W	DW	DRK
P41,P42	DW	DW	DW	DW	W	DRK
P61,P62	DW	W	DW	W	DW	DRK
P81,P82	DW	DW	DW	DW	W	DRK

ALTERNATE PHASING DIAGRAM

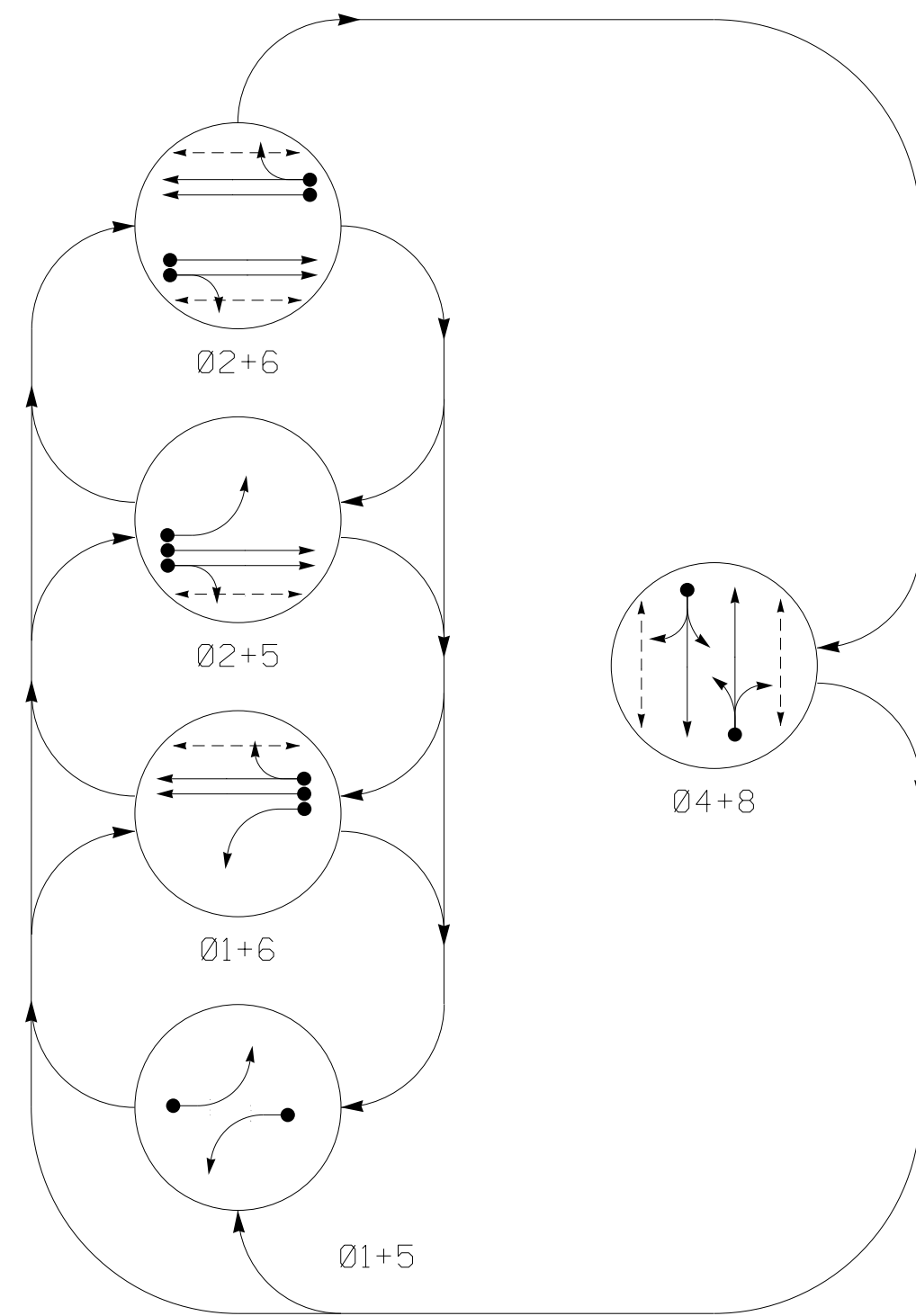

ALTERNATE PHASING TABLE OF OPERATION

SIGNAL FACE	PHASE					FLASH
	01+5	01+6	02+5	02+6	04+8	
11	←	←	←	←	←	Y
21,22	R	R	R	R	R	Y
41,42,43	R	R	R	R	R	G
51	←	←	←	←	←	Y
61,62	R	G	R	G	R	Y
81,82,83	R	R	R	R	R	G
P21,P22	DW	DW	W	W	DW	DRK
P41,P42	DW	DW	DW	DW	W	DRK
P61,P62	DW	W	DW	W	DW	DRK
P81,P82	DW	DW	DW	DW	W	DRK

SIGNAL FACE I.D.

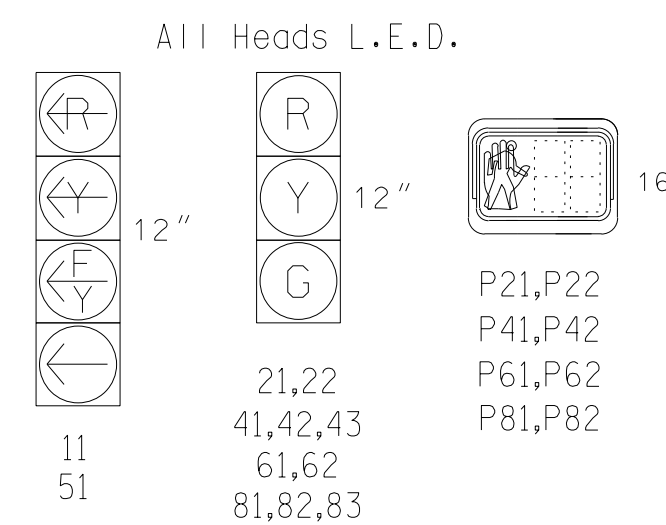

MAXTIME DETECTOR INSTALLATION CHART

LOOP	SIZE (FT)	DISTANCE FROM STOP LINE (FT)	TURNS	NEW LOOP	PROGRAMMING							
					CALL PHASE	DELAY TIME	EXTEND TIME	EXTEND	ADDED INITIAL	CALL	DELAY DURING GREEN	
1A	6X40	0	2-4-2	X	1	15.0**	-	X	-	X	-	X
2A	6X6	200	5	X	2	-	-	X	X	X	-	X
2B	6X6	200	5	X	2	-	-	X	X	X	-	X
4A	6X40	0	2-4-2	X	4	5.0	-	X	-	X	-	X
5A	6X40	0	2-4-2	X	5	15.0**	-	X	-	X	-	X
5B	6X40	0	2-4-2	X	5	-	-	X	-	X	-	X
6A	6X6	200	5	X	6	-	-	X	X	X	-	X
6B	6X6	200	5	X	6	-	-	X	X	X	-	X
8A	6X40	0	2-4-2	X	8	5.0	-	X	-	X	-	X

** Disable delay during alternate phasing operation
Disable phase call for loop(s) during alternate phasing operation

PHASING DIAGRAM DETECTION LEGEND

- ← ● DETECTED MOVEMENT
- ← ○ UNDETECTED MOVEMENT (OVERLAP)
- ← ○ UNSIGNALIZED MOVEMENT
- ← ○ PEDESTRIAN MOVEMENT

5 Phase Fully Actuated NC 8 (Winston Road) CLS Signal System #:D09-19.Lexington

NOTES

- Refer to "Roadway Standard Drawings NCDOT" dated January 2024 and "Standard Specifications for Roads and Structures" dated January 2024.
- Do not program signal for late night flashing operation unless otherwise directed by the Engineer.
- Phase 1 and/or 5 may be lagged.
- Set all detector units to presence mode.
- Omit "WALK" and flashing "DON'T WALK" with no pedestrian calls.
- Program pedestrian heads to countdown the flashing "Don't Walk" time only.
- The Division Traffic Engineer will determine the hours of use for each phasing plan.
- Maximum times shown in timing chart are for free-run operation only. Coordinated signal system timing values supersede these values.
- Traffic Signal Heads and Pedestal Posts will be black color treated. The selected shade of black must be verified and approved by the Engineer and City of Lexington prior to ordering.

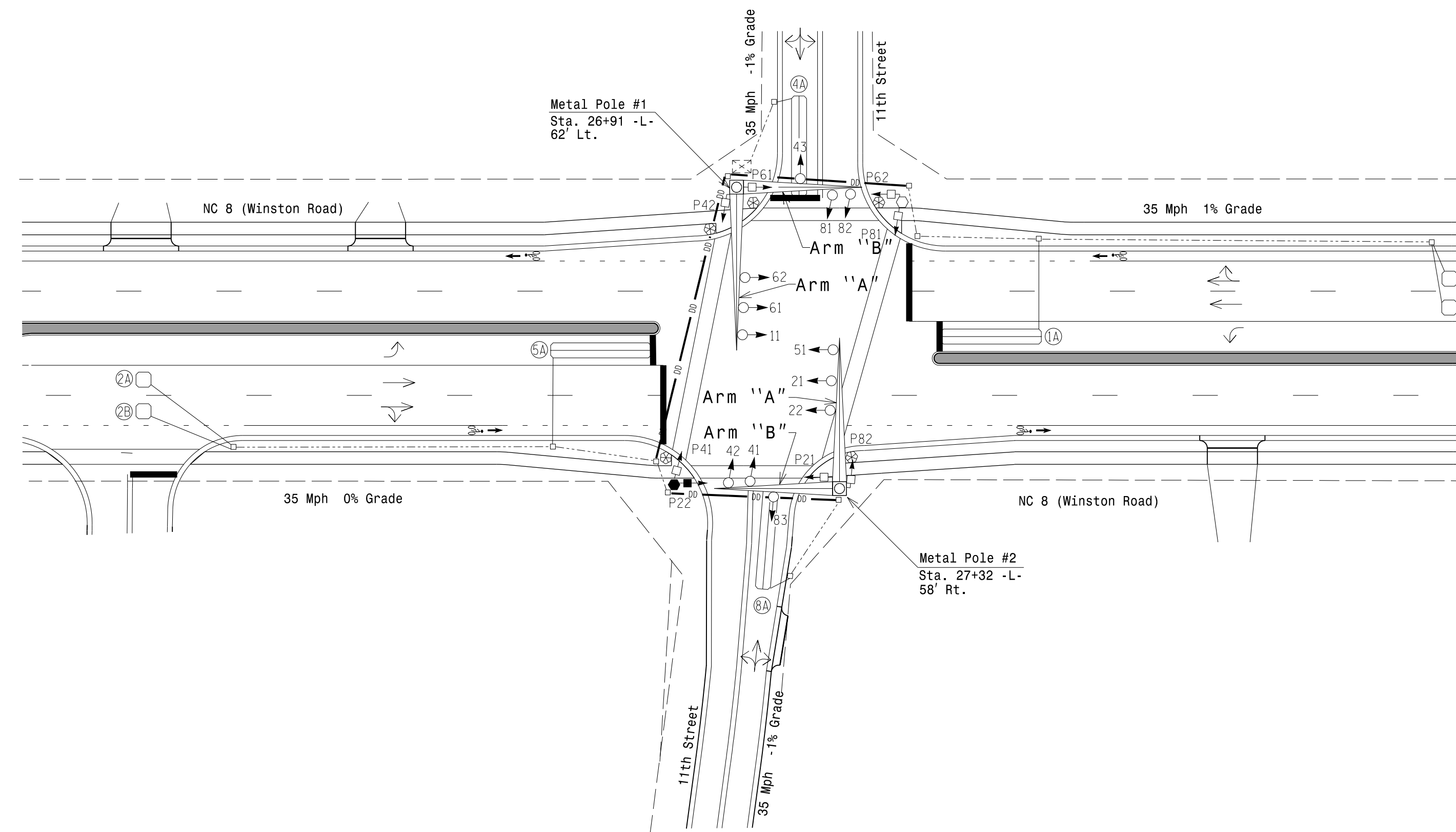

LEGEND

- | PROPOSED | EXISTING |
|--|-----------------------------------|
| ○ → Traffic Signal Head | ● → Traffic Signal Head |
| ○ → Modified Signal Head | ○ → N/A |
| ○ → Pedestrian Signal Head With Push Button & Sign | ○ → N/A |
| ○ → Signal Pole with Guy | ○ → Signal Pole with Sidewalk Guy |
| ○ → Inductive Loop Detector | ○ → Inductive Loop Detector |
| ○ → Controller & Cabinet | ○ → Controller & Cabinet |
| ○ → Junction Box | ○ → Junction Box |
| ○ → 2-in Underground Conduit | ○ → 2-in Underground Conduit |
| ○ → Directional Drill | ○ → N/A |
| ○ → Right of Way | ○ → Right of Way |
| ○ → Directional Arrow | ○ → Directional Arrow |
| ○ → Metal Pole with Mastarm | ○ → Metal Pole with Mastarm |
| ○ → Type I Pushbutton Post | ○ → Type I Pushbutton Post |
| ○ → Type II Signal Pedestal | ○ → Type II Signal Pedestal |

MAXTIME TIMING CHART

FEATURE	PHASE					
	1	2	4	5	6	8
Walk *	-	13	13	-	13	13
Ped Clear *	-	9	22	-	10	22
Min Green *	7	10	7	7	10	7
Passage *	2.0	5.0	2.0	2.0	5.0	2.0
Max 1 *	15	40	15	15	40	15
Yellow Change	3.0	3.8	3.9	3.0	3.8	3.9
Red Clear	3.2	2.4	2.2	3.2	2.4	2.2
Added Initial *	-	1.5	-	-	1.5	-
Maximum Initial *	-	24	-	-	24	-
Time Before Reduction *	-	15	-	-	15	-
Time To Reduce *	-	30	-	-	30	-
Minimum Gap	-	3.0	-	-	3.0	-
Advance Walk	-	6	6	-	6	6
Non Lock Detector	X	-	X	X	-	X
Vehicle Recall	-	MIN RECALL	-	-	MIN RECALL	-
Dual Entry	-	-	X	-	-	X

* These values may be field adjusted. Do not adjust Min Green and Extension times for phases 2 and 6 lower than what is shown. Min Green for all other phases should not be lower than 4 seconds.

Signal Upgrade - Final Design

DOCUMENT NOT CONSIDERED FINAL UNLESS ALL SIGNATURES COMPLETED

Prepared for the Offices of:

NC 8 (Winston Road) at 11th Street
 Division 9 Davidson County Lexington
 PLAN DATE: May 2024 REVIEWED BY: G.G. Murr, Jr.
 PREPARED BY: B.E. Wynn REVIEWED BY:
 REVISIONS INIT. DATE
 SCALE 0 40
 1"=40'

 DocuSigned by: G. Murr, Jr.
 14458851CDD45B
 SIGNATURE DATE
 SIG. INVENTORY NO. 09-0401

TRANSYSTEMS

1 Glenwood Avenue
 Raleigh, NC 27603
 Tel: 919.789.9977
 Fax: 919.789.9591
 License: F-0453