

DEFAULT PHASING DIAGRAM

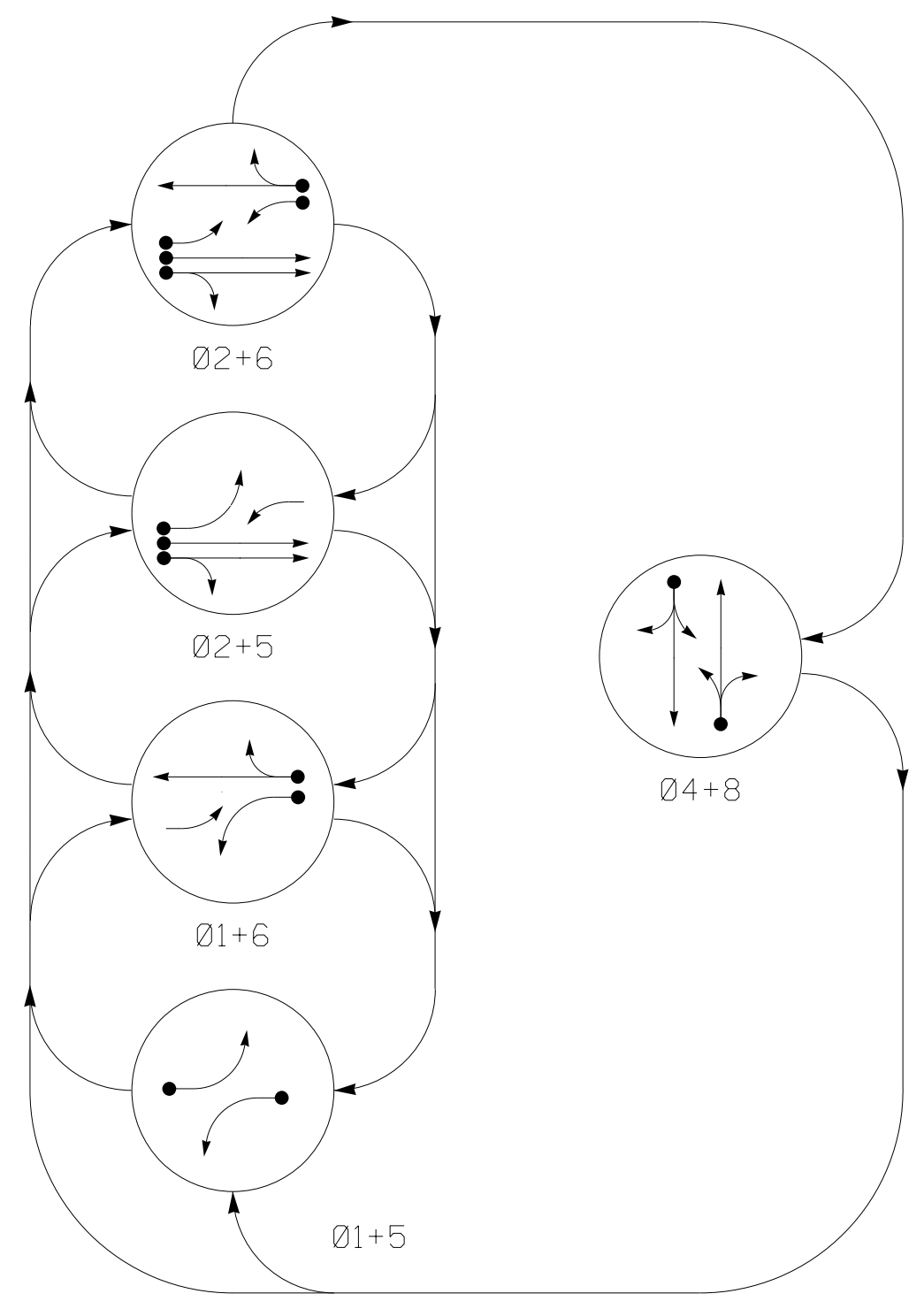

DEFAULT PHASING TABLE OF OPERATION

SIGNAL FACE	PHASE					
	Ø 1 + 5	Ø 1 + 6	Ø 2 + 5	Ø 2 + 6	Ø 4 + 8	HOV 3+
11	←	←	←	←	←	←
21,22	R	R	G	G	R	Y
41,42,43	R	R	R	R	G	R
51	←	←	←	←	←	←
61,62	R	G	R	G	R	Y
81,82,83	R	R	R	R	G	R

ALTERNATE PHASING DIAGRAM

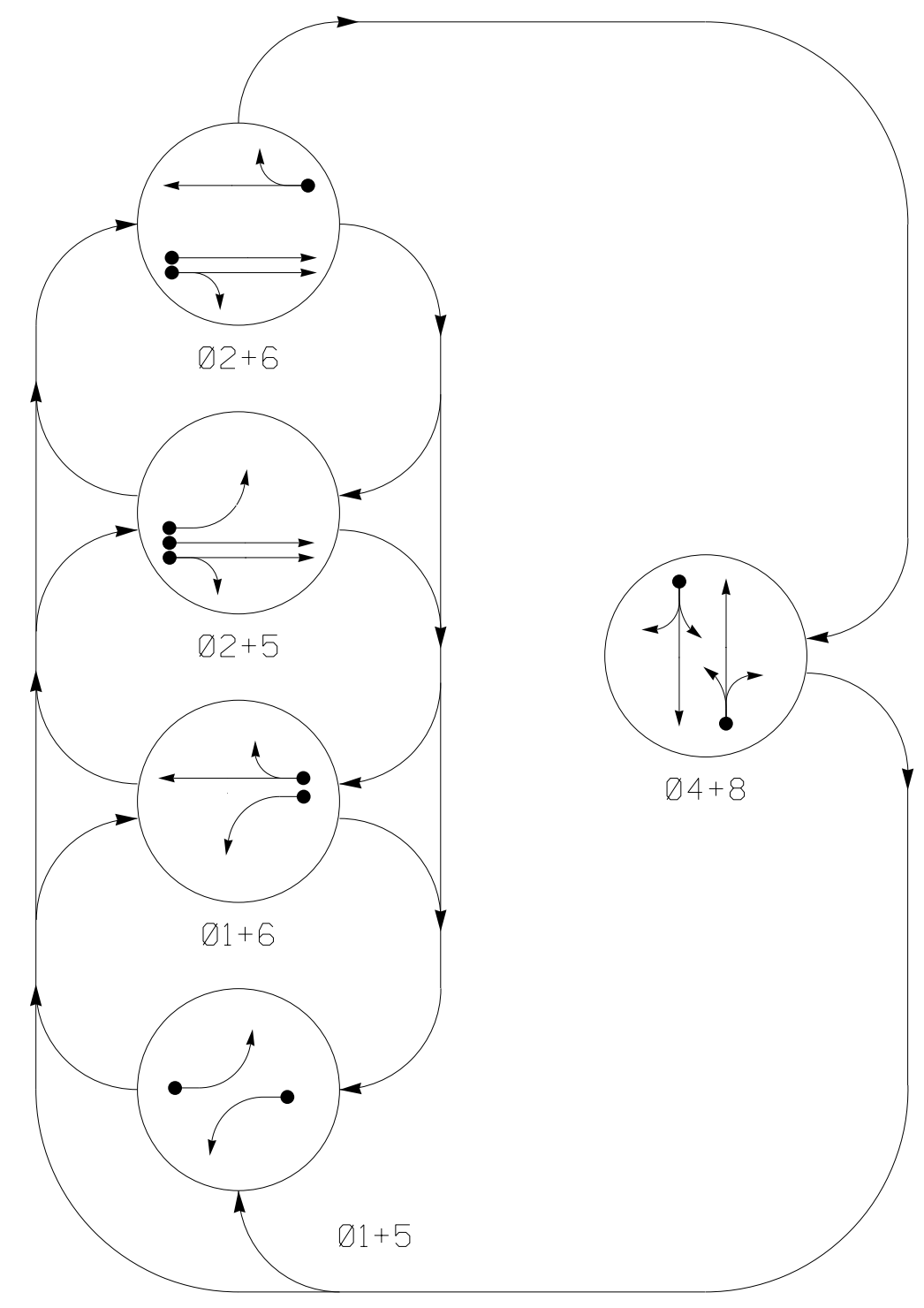

ALTERNATE PHASING TABLE OF OPERATION

SIGNAL FACE	PHASE					
	Ø 1 + 5	Ø 1 + 6	Ø 2 + 5	Ø 2 + 6	Ø 4 + 8	HOV 3+
11	←	←	←	←	←	←
21,22	R	R	G	G	R	Y
41,42,43	R	R	R	R	G	R
51	←	←	←	←	←	←
61,62	R	G	R	G	R	Y
81,82,83	R	R	R	R	G	R

MAXTIME DETECTOR INSTALLATION CHART

ZONE	SIZE (FT)	DISTANCE FROM STOPBAR (FT)	TURNS	NEW ZONE	PROGRAMMING						
					CALL PHASE	DELAY TIME	EXTEND TIME	EXTEND	ADDED INITIAL	CALL DURING GREEN	NEW CARD
1A*	6X40	0	*	*	1 6#	15.0** 3.0	-	-	X	X	-
2A*	6X6	70	*	*	2	-	-	X	X	-	-
2B*	6X6	70	*	*	2	-	-	X	X	-	-
4A*	6X40	0	*	*	4	5.0	-	X	X	-	-
5A*	6X40	0	*	*	5 2#	15.0** 3.0	-	X	X	-	-
5B*	6X40	0	*	*	5	-	-	X	X	-	-
6A*	6X6	70	*	*	6	-	-	X	X	-	-
8A*	6X40	0	*	*	6	5.0	-	X	X	-	-

*Video Detection Zone
 **Disable delay during alternate phasing operation
 # Disable phase call for loop(s) during alternate phasing operation

SIGNAL FACE I.D.

All Heads L.E.D.

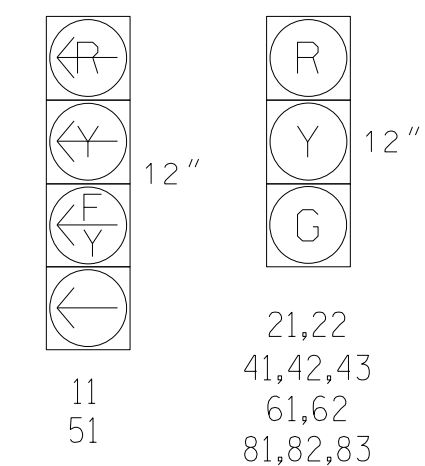

5 Phase Fully Actuated NC 8 (Winston Road) CLS Signal System #:D09-19.Lexington

NOTES

- Refer to "Roadway Standard Drawings NCDOT" dated January 2024 and "Standard Specifications for Roads and Structures" dated January 2024.
- Do not program signal for late night flashing operation unless otherwise directed by the Engineer.
- Phase 1 and/or 5 may be lagged.
- Set all detector units to presence mode.
- Locate new cabinet so as not to obstruct sight distance of vehicles turning right on red.
- This intersection uses video detection. Install detectors according to the manufacturer's instructions to achieve the desired detection.
- The Division Traffic Engineer will determine the hours of use for each phasing plan.
- Maximum times shown in timing chart are for free-run operation only. Coordinated signal system timing values supersede these values.
- Pavement markings are existing.

PHASING DIAGRAM DETECTION LEGEND

- ← ● DETECTED MOVEMENT
- ← UNDETECTED MOVEMENT (OVERLAP)
- ← - - UNSIGNALIZED MOVEMENT
- ← - - - PEDESTRIAN MOVEMENT

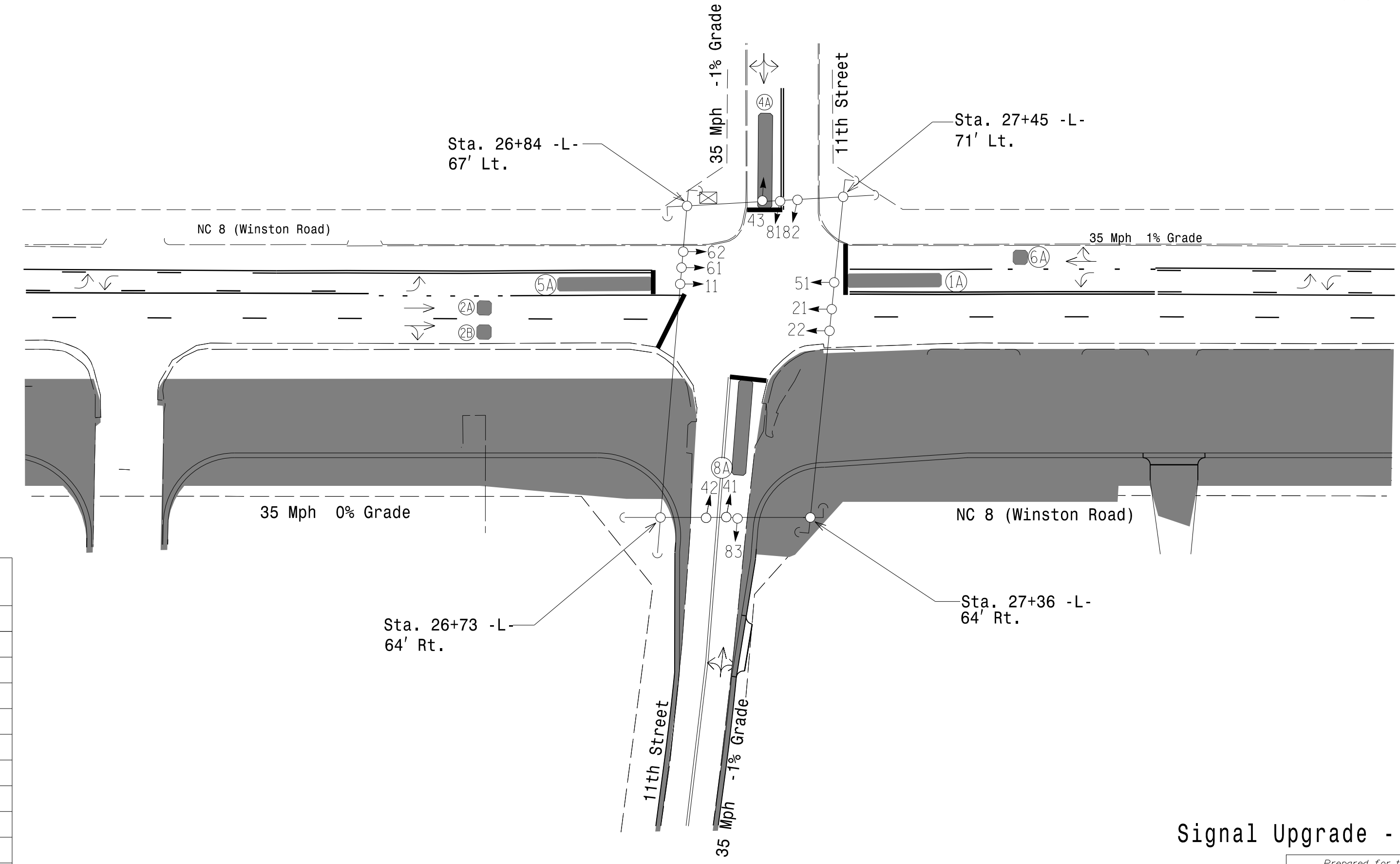

MAXTIME TIMING CHART

FEATURE	PHASE						
	1	2	4	5	6	8	
Walk *	-	-	-	-	-	-	
Ped Clear *	-	-	-	-	-	-	
Min Green *	7	10	7	7	10	7	
Passage *	2.0	3.0	2.0	2.0	3.0	2.0	
Max 1 *	15	40	15	15	40	15	
Yellow Change	3.0	3.8	3.9	3.0	3.8	3.9	
Red Clear	2.1	1.3	1.2	2.1	1.3	1.2	
Added Initial *	-	-	-	-	-	-	
Maximum Initial *	-	-	-	-	-	-	
Time Before Reduction *	-	-	-	-	-	-	
Time To Reduce *	-	-	-	-	-	-	
Minimum Gap	-	-	-	-	-	-	
Advance Walk	-	-	-	-	-	-	
Non Lock Detector	X	-	X	X	-	X	
Vehicle Recall	-	MIN RECALL	-	-	MIN RECALL	-	
Dual Entry	-	-	X	-	-	X	

* These values may be field adjusted. Do not adjust Min Green and Passage times for phases 2 and 6 lower than what is shown. Min Green for all other phases should not be lower than 4 seconds.

LEGEND

- | PROPOSED | EXISTING |
|------------------------------|-----------------------------------|
| ○ → Traffic Signal Head | ● → N/A |
| ● → Modified Signal Head | — Sign |
| ⊥ Pedestrian Signal Head | ⊥ With Push Button & Sign |
| ○ → Signal Pole with Guy | ● → Signal Pole with Sidewalk Guy |
| ⊠ Inductive Loop Detector | ⊠ Controller & Cabinet |
| □ Junction Box | □ |
| --- 2-in Underground Conduit | --- Right of Way |
| → Directional Arrow | → Construction Zone |
| ▬ Video Detection Zone | ▬ N/A |

Signal Upgrade - Temporary Design 1 (TMP Phase I)

DOCUMENT NOT CONSIDERED FINAL UNLESS ALL SIGNATURES COMPLETED

TRANSYSTEMS
 1 Glenwood Avenue
 Raleigh, NC 27603
 Tel: 919.789.9977
 Fax: 919.789.9591
 License: F-0453

Prepared for the Offices of:

 750 N. Greenfield Pkwy, Garner, NC 27529
 SCALE: 0 40
 1" = 40'

NC 8 (Winston Road) at 11th Street
 Division 9 Davidson County Lexington
 PLAN DATE: May 2024 REVIEWED BY: G.G. Murr, Jr.
 PREPARED BY: B.E. Wynn REVIEWED BY:
 REVISIONS: INIT. DATE

SEAL

 GENE G. MURR, JR.
 ENGINEER
 SIGNATURE: DATE: 09-04011