

STATE	STATE PROJECT REFERENCE NO.	SHEET NO.	TOTAL SHEETS
N.C.	BR-0139	RW01	10

STATE OF NORTH CAROLINA
DIVISION OF HIGHWAYS

SURVEY CONTROL, EXISTING CENTERLINES,
RIGHT OF WAY, EASEMENTS AND PROPERTY TIES

BRUNSWICK COUNTY

LOCATION: REPLACE BRIDGE OVER SAND HILL CREEK
ON NC 133 (RIVER RD)



TIP PROJECT: BR-0139

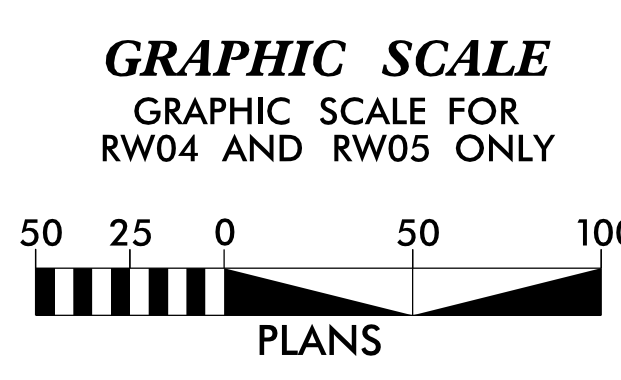
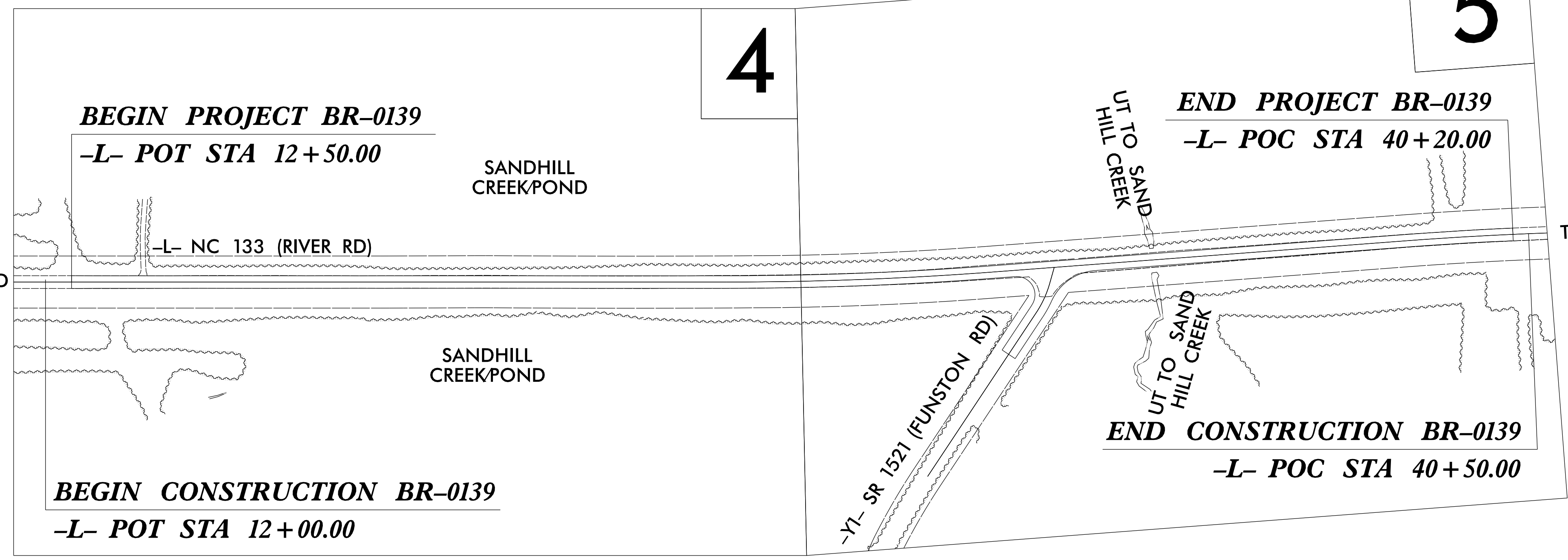
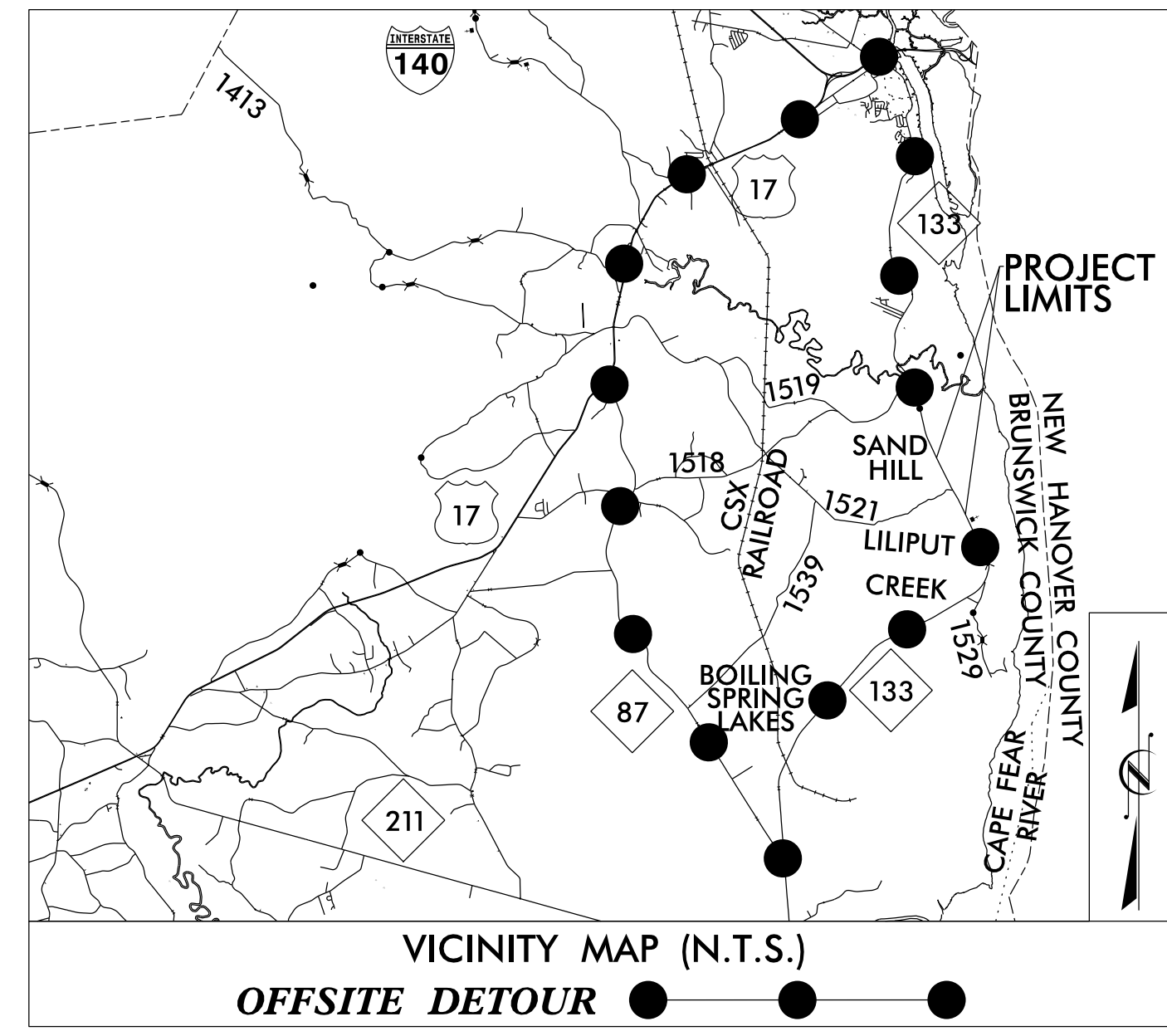

DATUM DESCRIPTION

THE LOCALIZED COORDINATE SYSTEM DEVELOPED FOR THIS PROJECT IS BASED ON THE STATE PLANE COORDINATES ESTABLISHED BY NCGS FOR MONUMENT "GPS2" WITH NAD 83/NSRS 2011 STATE PLANE GRID COORDINATES OF NORTHING: 128,194.280(ft) EASTING: 2,312,445.227(ft) ELEVATION: 15.128(ft) THE AVERAGE COMBINED GRID FACTOR USED ON THIS PROJECT (GROUND TO GRID) IS: 1.0000786326 THE N.C. LAMBERT GRID BEARING AND LOCALIZED HORIZONTAL GROUND DISTANCE FROM "GPS2" TO -L- STATION 10+00.00 IS N 26°32'22.93" W 2051.14(ft) ALL LINEAR DIMENSIONS ARE LOCALIZED HORIZONTAL DISTANCES VERTICAL DATUM USED IS NAVD 88

Prepared in the Office of:
LOCATION AND SURVEYS, DIV 3
5310 BARBADOUS BLVD., SUITE 102
CASTLE HAYNE, N.C., 28429

2024 STANDARD SPECIFICATIONS

RIGHT OF WAY DATE:
APRIL 27, 2023

LETTING DATE:
SEPTEMBER 17, 2024

PROFESSIONAL LAND SURVEYOR



DocuSigned by:
Christopher Sawyer
SIGNATURE

06/25/2024
Date:

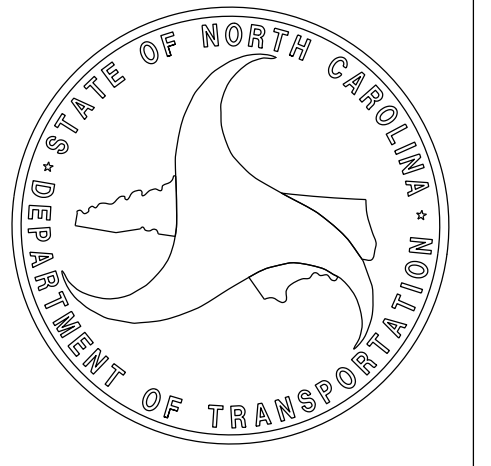

24-JUN-2024 11:40 S:\Units\Div03\Projects\Brunswick\BR-0139\Working\150 series sheets\BR0139-LS-RW01-DATE.dgn Individual AT LS-328725L