

STATE	STATE PROJECT REFERENCE NO.	SHEET NO.	TOTAL SHEETS
N.C.	U-5783	RW01	19

TIP PROJECT: U-5783

STATE OF NORTH CAROLINA
 DIVISION OF HIGHWAYS

SURVEY CONTROL, EXISTING CENTERLINES,
 RIGHT OF WAY, EASEMENTS AND PROPERTY TIES

HENDERSON COUNTY

**US 64 (BREVARD ROAD) FROM SR 1173 (WHITE PINE DRIVE)
 TO SR 1180 (BLYTHE STREET)**

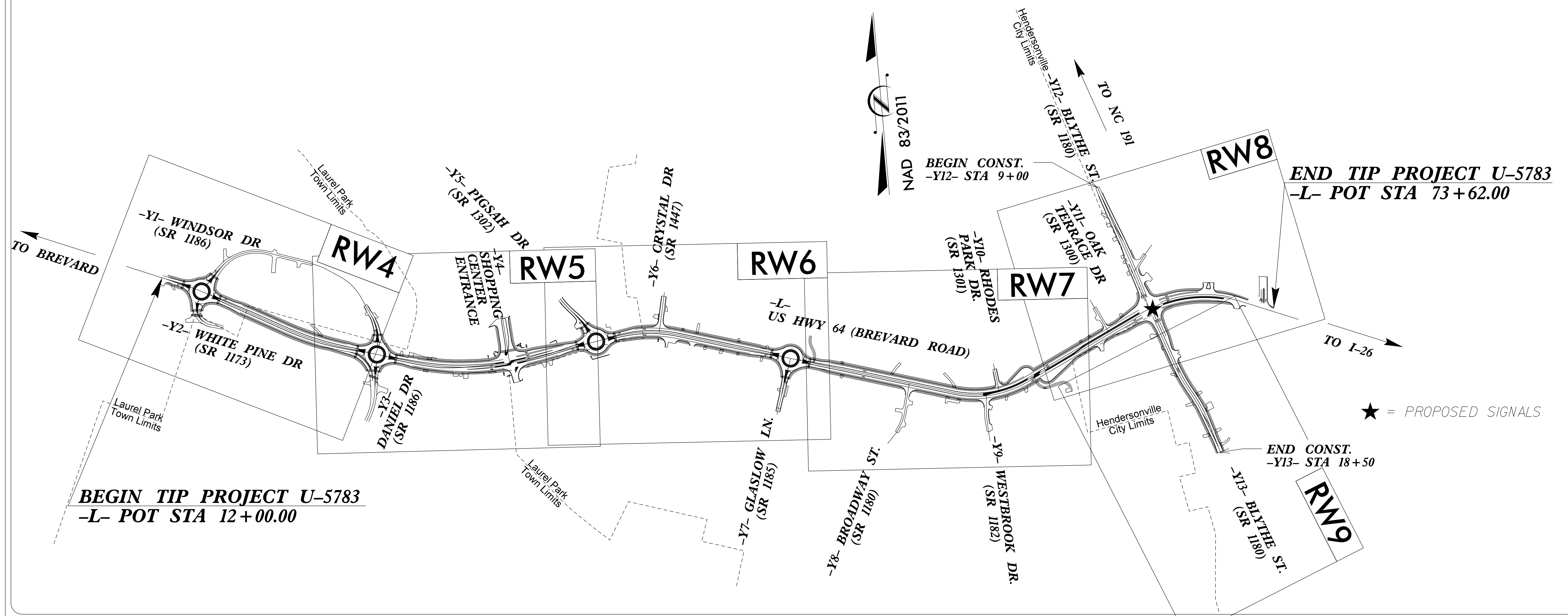

BEGIN TIP PROJECT U-5783
-L- POT STA 12+00.00

END TIP PROJECT U-5783
-L- POT STA 73+62.00

★ = PROPOSED SIGNALS

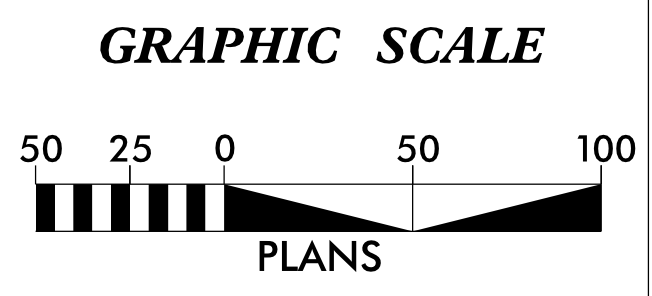

DATUM DESCRIPTION

THE LOCALIZED COORDINATE SYSTEM DEVELOPED FOR THIS PROJECT IS BASED ON THE STATE PLANE COORDINATES ESTABLISHED BY NCDOT FOR MONUMENT "U5783-GPS103" WITH NAD 83/NA 2011 STATE PLANE GRID COORDINATES OF NORTHING: 589788.147(ft) EASTING: 958957.346(ft) ELEVATION: 2203.23(ft)

THE AVERAGE COMBINED GRID FACTOR USED ON THIS PROJECT (GROUND TO GRID) IS: 0.999767218

THE N.C. LAMBERT GRID BEARING AND LOCALIZED HORIZONTAL GROUND DISTANCE FROM "U5783-GPS 103" TO -L- STATION 12+00.00 IS N68°24'25.2"W 1922.74(ft)

ALL LINEAR DIMENSIONS ARE LOCALIZED HORIZONTAL DISTANCES VERTICAL DATUM USED IS NAVD 88

Prepared in the Office of:

Mattern & Craig
 ENGINEERS SURVEYORS

12 BROAD STREET
 ASHEVILLE, NORTH CAROLINA 28801
 (828) 254-2201
 FAX (828) 254-4562
 NC LIC. NO. C-1154

2018 STANDARD SPECIFICATIONS	RIGHT OF WAY DATE: June 29, 2021	LETTING DATE: July 16, 2024
------------------------------	-------------------------------------	--------------------------------

PROFESSIONAL LAND SURVEYOR



DocuSigned by:
 Ron L. Zietlow
 84E55C884005472...
 SIGNATURE: _____ Date: March 29, 2024

