

# SURVEY CONTROL SHEET

W/ EXISTING CENTERLINE ALIGNMENTS PRIOR TO CONSTRUCTION

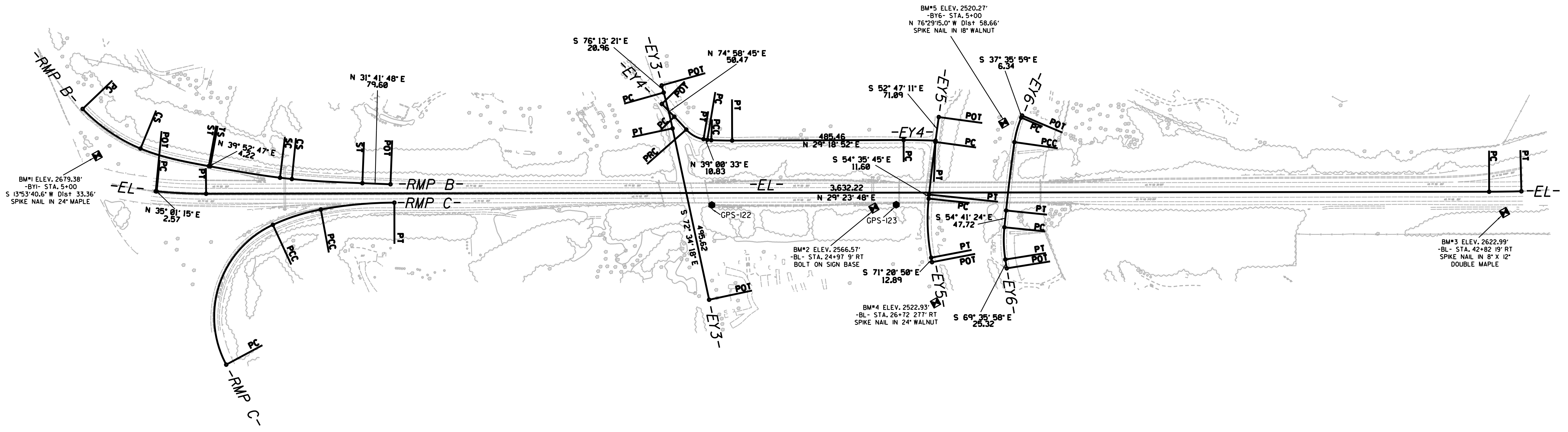
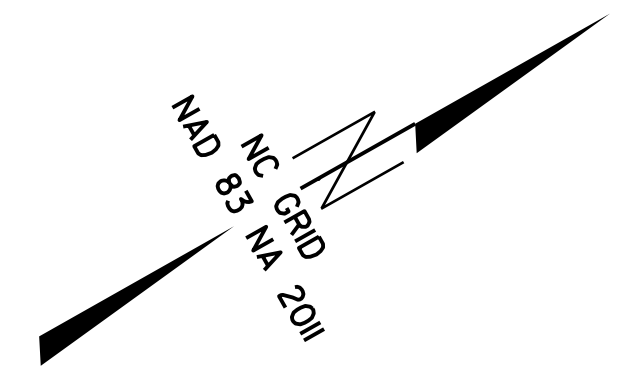

**SEE SHEET RW02C-3  
FOR FURTHER  
ALIGNMENT DETAILS**

- NOTES:**
- PROJECT CONTROL WAS ESTABLISHED USING GNSS, THE GLOBAL NAVIGATION SATELLITE SYSTEM.
  - THE SURVEY CONTROL DATA FOR THIS PROJECT HAS BEEN COMPILED FROM VARIOUS SOURCES. IF FURTHER INFORMATION REGARDING PROJECT CONTROL IS NEEDED, PLEASE CONTACT THE LOCATION AND SURVEYS UNIT.

REVISIONS

6/2/09

30-OCT-2018 09:08  
C:\Users\jll\OneDrive\Documents\2018\31812-12 B-5982 US 74 Bridge\Send\Corrections\b5982-1s-rw02c-1.dgn