

CONCRETE DETAILS

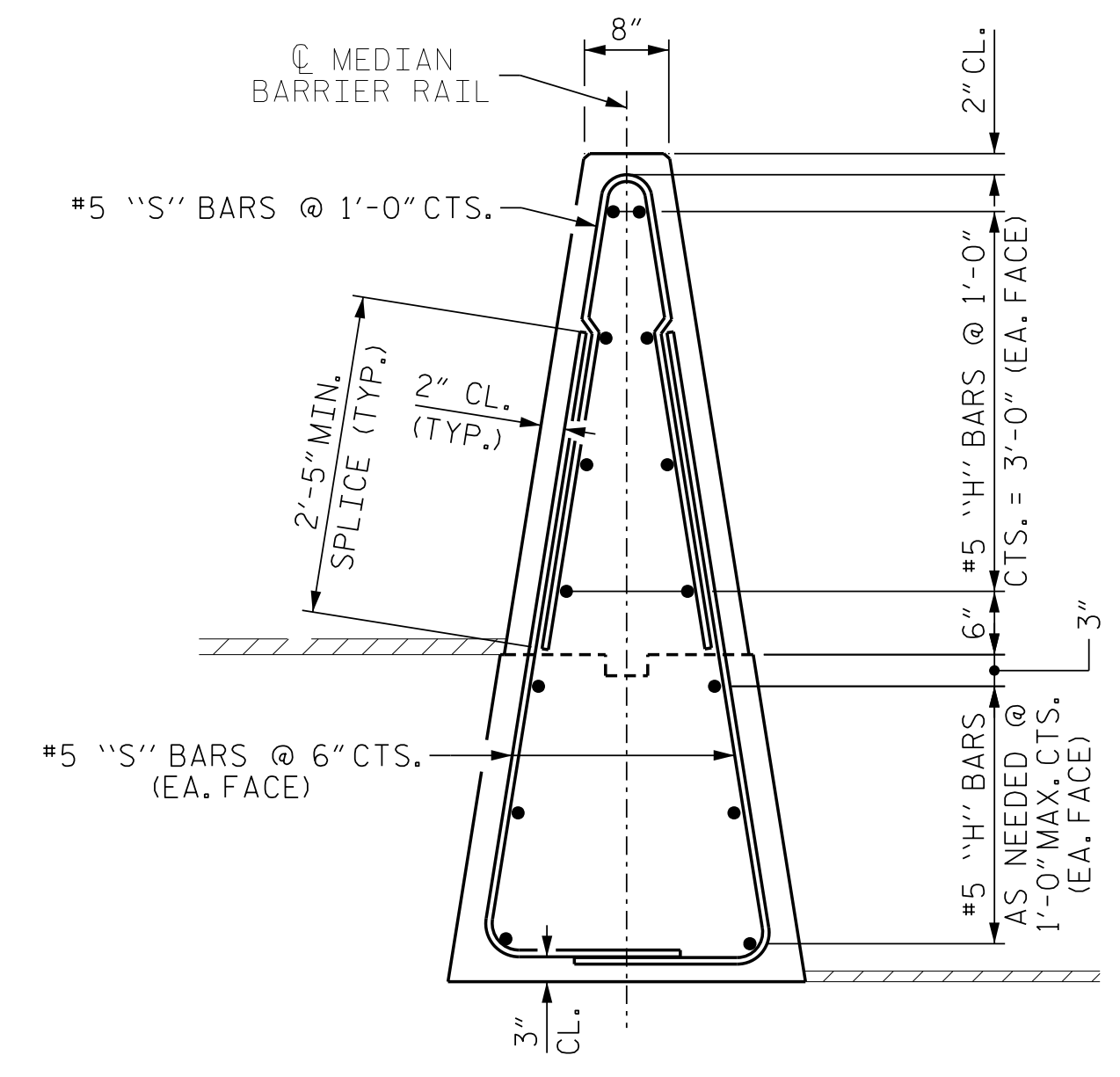

REINFORCEMENT DETAILS

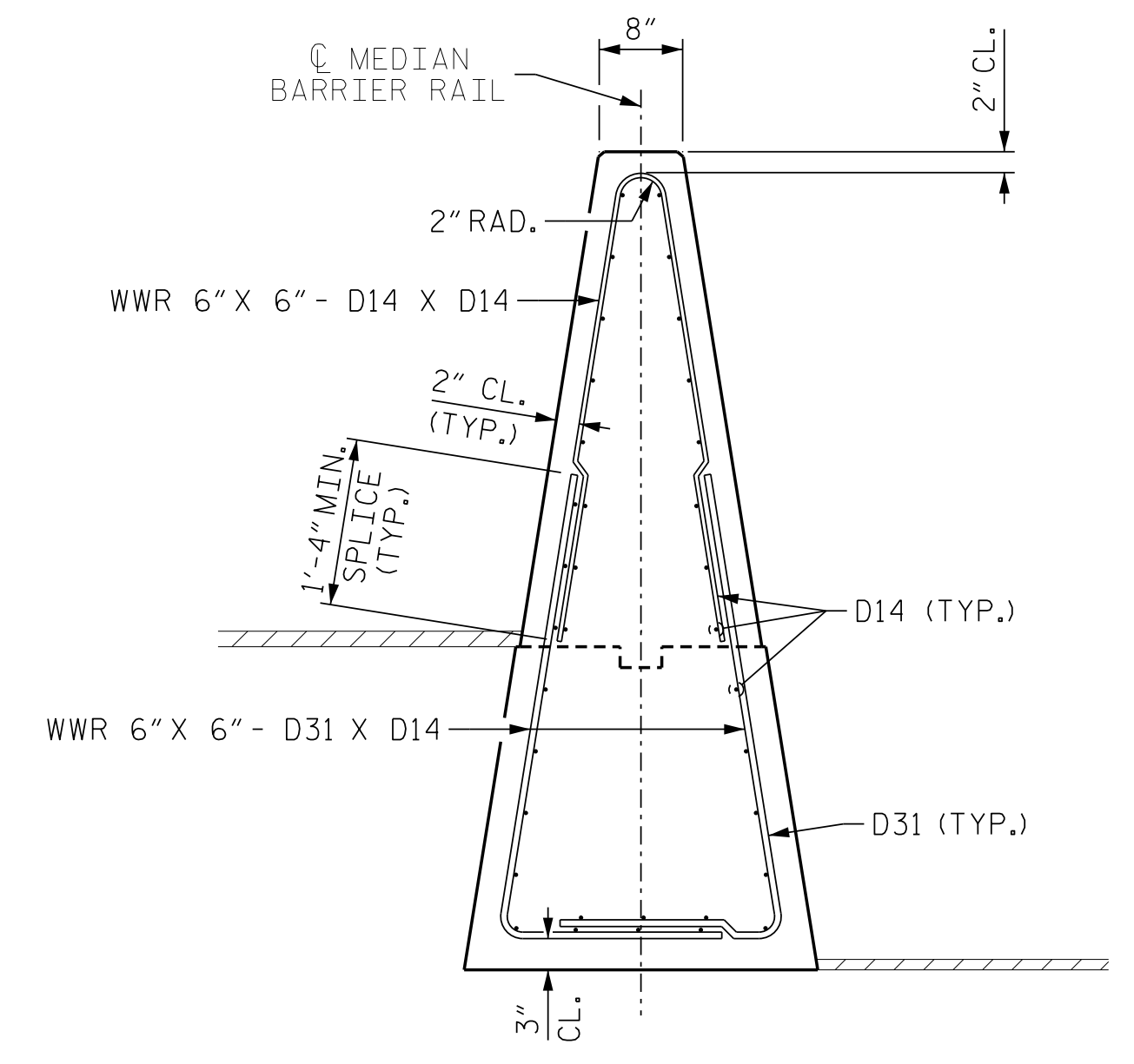

WELDED WIRE FABRIC  
OPTIONAL REINFORCING

## SINGLE SLOPE CONCRETE BARRIER (2'-7" MAX. BIFURCATION)

SECTION SHOWN IS WITH RESPECT TO MAXIMUM 2'-7" BIFURCATION

### GENERAL NOTES:

- ALL MATERIAL AND WORKMANSHIP SHALL BE IN ACCORDANCE WITH THE 2024 "STANDARD SPECIFICATIONS FOR ROADS AND STRUCTURES" OF THE N.C. DEPARTMENT OF TRANSPORTATION
- USE CLASS "AA" CONCRETE.
- ALL EXPOSED CORNERS ON BARRIER SHALL BE CHAMFERED 3/4".
- MAINTAIN 2" CLEAR COVER FOR ALL REINFORCING STEEL AND WELDED WIRE FABRIC UNLESS NOTED OTHERWISE.
- REINFORCING STEEL (REBAR) SHALL MEET THE REQUIREMENTS OF ASTM A615, GRADE 60.
- WELDED WIRE FABRIC SHALL MEET THE REQUIREMENTS OF ASTM A497, GRADE 70. ALL WIRES FOR WELDED WIRE FABRIC SHALL BE DEFORMED.
- #5 "S" BAR SPLICE 2'-5"
- #5 "H" BAR SPLICE 3'-2"
- D14 WELDED WIRE FABRIC SPLICE 1'-4"
- ANY METHOD DEvised BY THE CONTRACTOR AND APPROVED BY THE ENGINEER THAT SHALL ASSURE THAT THE LONGITUDINAL ROADWAY STEEL WILL BE POSITIONED 1/2" ± AS DIMENSIONED ON THE PLANS WILL BE DEEMED SATISFACTORY.
- REFER TO ROADWAY STANDARD DRAWING NO. 854.01 FOR EXPANSION AND CONTRACTION JOINT FILLER AND OTHER SPECIFICATIONS

6/3/2024



DocuSigned by:  
John Arthur Dismore  
021382269228438

**WETHERILL ENGINEERING**  
1223 Jones Franklin Rd.  
Raleigh, N.C. 27606  
License No. F-0377  
Bus: 919 851 8077  
Fax: 919 851 8107

TRANSPORTATION PLANNING/DESIGN - BRIDGE/STRUCTURE DESIGN  
CIVIL/SITE DESIGN - GIS/GPS - CONSTRUCTION OBSERVATION

**DOCUMENT NOT CONSIDERED FINAL  
UNLESS ALL SIGNATURES COMPLETED**

**SINGLE SLOPE  
CONCRETE BARRIER  
(46" MIN. HEIGHT)  
SHEET 1 OF 2**

ORIGINAL BY: _____	DATE: _____
MODIFIED BY: _____	DATE: _____
CHECKED BY: _____	DATE: _____
FILE SPEC.: _____	