

P:\2023\2312801-HB-0003-Structures\DWG\CULVERT_EXT_12-2023\C-3 TO C-5 HB-003_SMU_CU_GENERAL EXT LAYOUT AND REINF PLAN.dgn
5/11/2024 3:10:23 PM

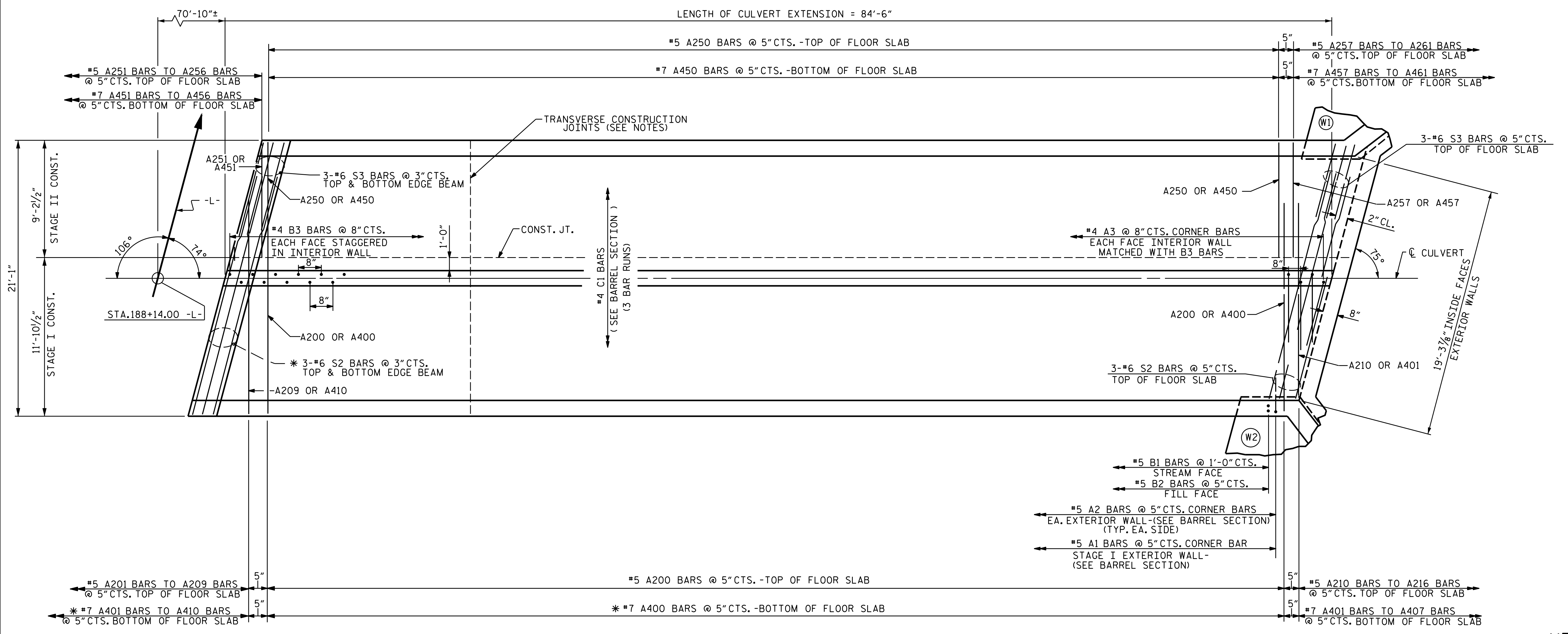

FLOOR SLAB

PROJECT NO. HB-0003
HAYWOOD COUNTY
STATION: 188+14.00 -L-

NOTE: * THE CONTRACTOR HAS THE OPTION TO USE MECHANICAL COUPLERS IN LIEU OF LAP SPLICES IN THE FLOOR SLAB AS NECESSARY TO AVOID POSSIBLE CONFLICTS WITH INSTALLATION OF THE IMPERVIOUS DIKE DURING STAGE I CONSTRUCTION. NO ADDITIONAL PAYMENT WILL BE MADE.

DRAWN BY : J. PENDERGRAFT DATE : 12/4/23
CHECKED BY : J. DILWORTH DATE : 12/4/23

DOCUMENT NOT CONSIDERED FINAL
UNLESS ALL SIGNATURES COMPLETED

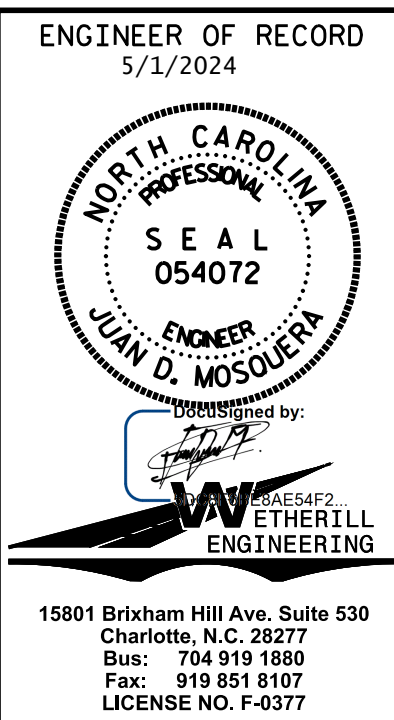

STATE OF NORTH CAROLINA
DEPARTMENT OF TRANSPORTATION
RALEIGH

**DOUBLE
9 FT. X 8 FT.
REINFORCED CONCRETE
BOX CULVERT
EXTENSION**

REVISIONS					
NO.	BY:	DATE:	NO.	BY:	DATE:
1			3		
2			4		

SHEET NO. C-4
TOTAL SHEETS 9

ENGINEER OF RECORD
5/1/2024
15801 Brixham Hill Ave, Suite 530
Charlotte, N.C. 28277
Bus: 704 919 1880
Fax: 919 851 8107
LICENSE NO. F-0377