

CONCRETE DETAILS

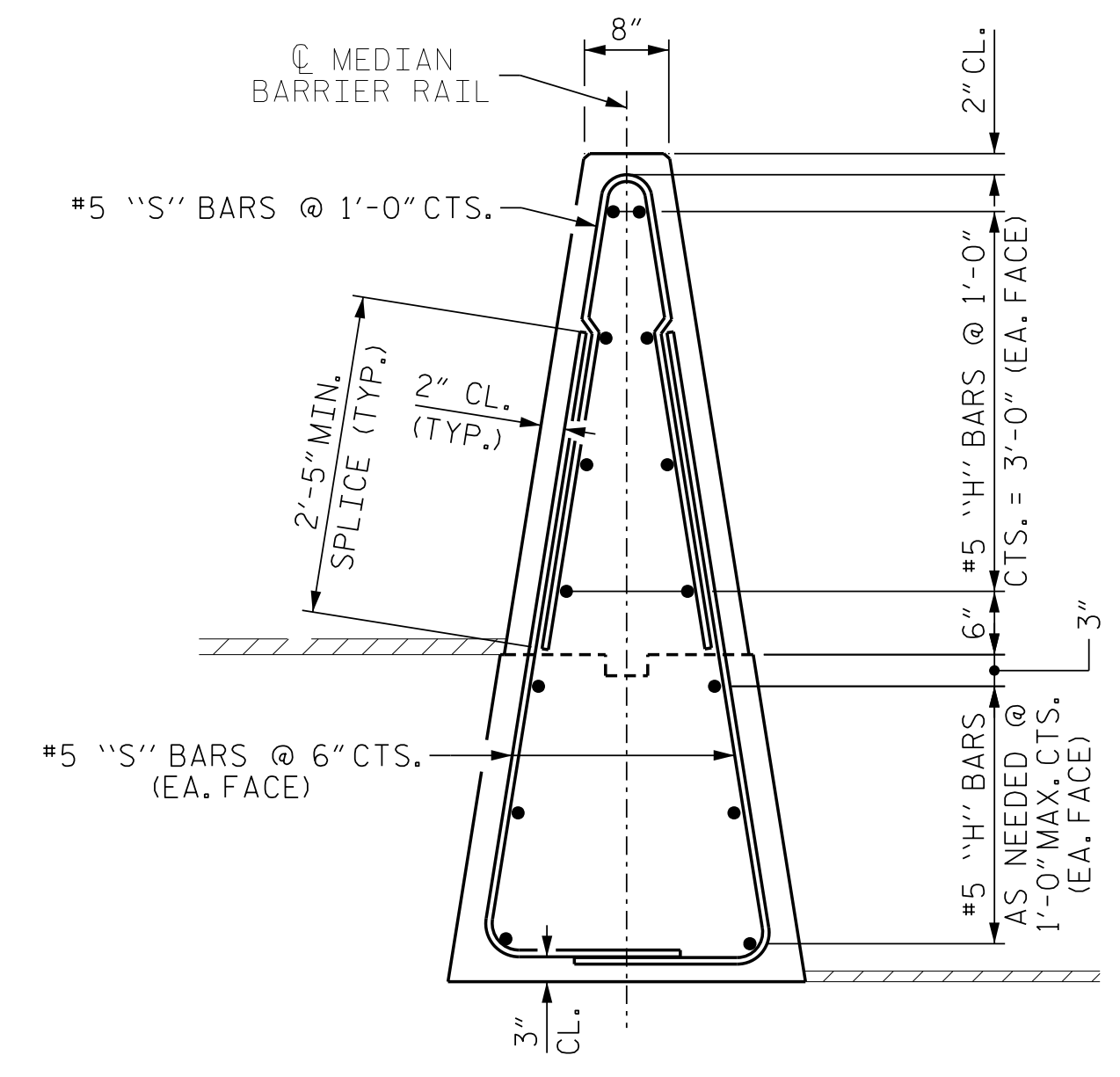

REINFORCEMENT DETAILS

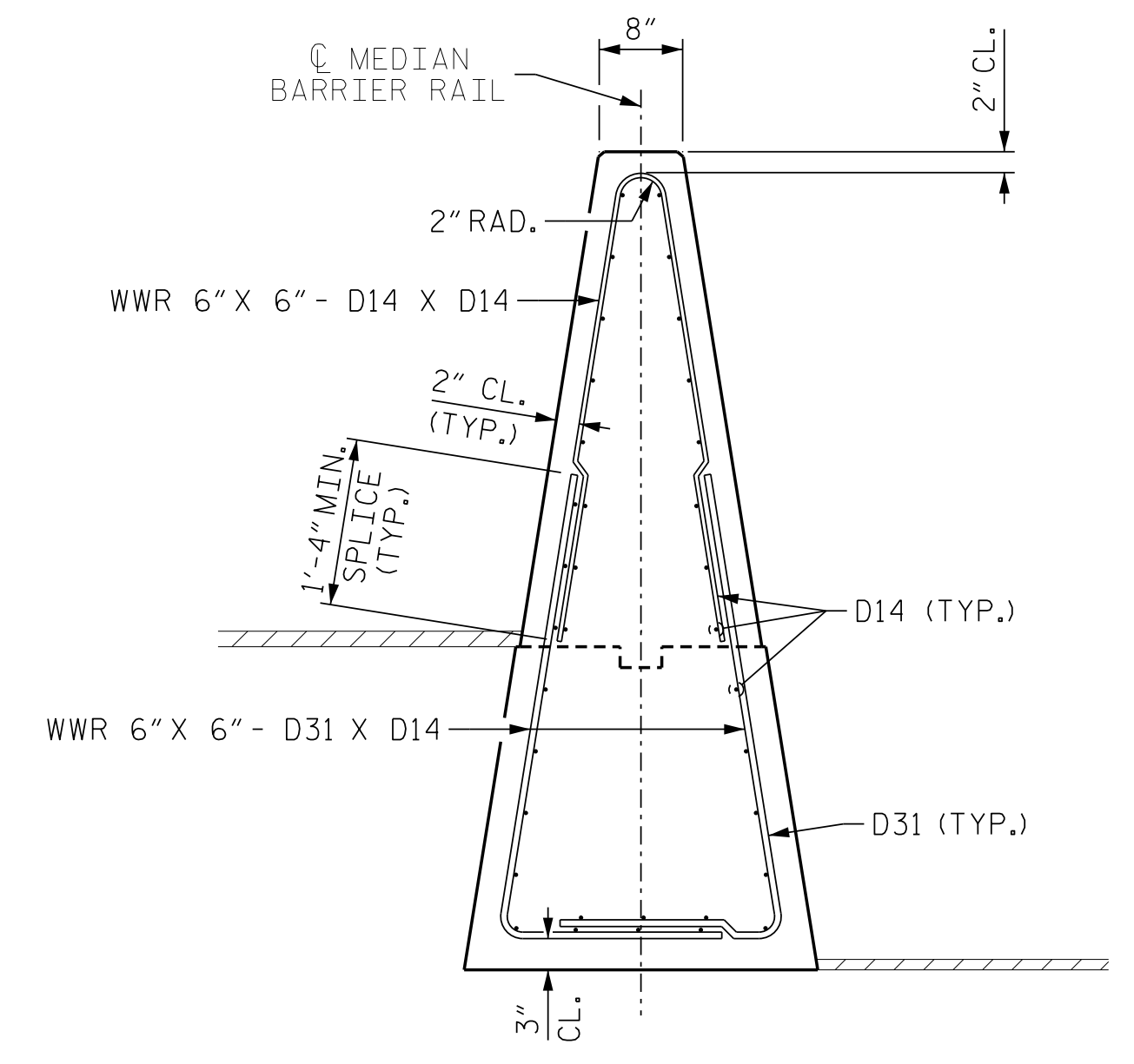

WELDED WIRE FABRIC
OPTIONAL REINFORCING

SINGLE SLOPE CONCRETE BARRIER (2'-7" MAX. BIFURCATION)

SECTION SHOWN IS WITH RESPECT TO MAXIMUM 2'-7" BIFURCATION

GENERAL NOTES:

ALL MATERIAL AND WORKMANSHIP SHALL BE IN ACCORDANCE WITH THE 2024 "STANDARD SPECIFICATIONS FOR ROADS AND STRUCTURES" OF THE N.C. DEPARTMENT OF TRANSPORTATION

USE CLASS "AA" CONCRETE.

ALL EXPOSED CORNERS ON BARRIER SHALL BE CHAMFERED 1/8".

MAINTAIN 2" CLEAR COVER FOR ALL REINFORCING STEEL AND WELDED WIRE FABRIC UNLESS NOTED OTHERWISE.

REINFORCING STEEL (REBAR) SHALL MEET THE REQUIREMENTS OF ASTM A615, GRADE 60.

WELDED WIRE FABRIC SHALL MEET THE REQUIREMENTS OF ASTM A497, GRADE 70. ALL WIRES FOR WELDED WIRE FABRIC SHALL BE DEFORMED.

- #5 "S" BAR SPLICE 2'-5"
- #5 "H" BAR SPLICE 3'-2"
- D14 WELDED WIRE FABRIC SPLICE 1'-4"

ANY METHOD DEvised BY THE CONTRACTOR AND APPROVED BY THE ENGINEER THAT SHALL ASSURE THAT THE LONGITUDINAL ROADWAY STEEL WILL BE POSITIONED 1/2" ± AS DIMENSIONED ON THE PLANS WILL BE DEEMED SATISFACTORY.

REFER TO ROADWAY STANDARD DRAWING NO. 854.01 FOR EXPANSION AND CONTRACTION JOINT FILLER AND OTHER SPECIFICATIONS

6/3/2024



DocuSigned by:
John Arthur Dilworth
021382269228438

WETHERILL ENGINEERING
1223 Jones Franklin Rd.
Raleigh, N.C. 27606
License No. F-0377
Bus: 919 851 8077
Fax: 919 851 8107

TRANSPORTATION PLANNING/DESIGN - BRIDGE/STRUCTURE DESIGN
CIVIL/SITE DESIGN - GIS/GPS - CONSTRUCTION OBSERVATION

**DOCUMENT NOT CONSIDERED FINAL
UNLESS ALL SIGNATURES COMPLETED**

**SINGLE SLOPE
CONCRETE BARRIER
(46" MIN. HEIGHT)
SHEET 1 OF 2**

ORIGINAL BY: _____	DATE: _____
MODIFIED BY: _____	DATE: _____
CHECKED BY: _____	DATE: _____
FILE SPEC.: _____	