

(+) 4.6050% (-) 4.7200%

PVI STA. 21+30.00  
EL. = 2130.72  
VC = 600'

**GRADE DATA -Y5RPA-**

**TOP OF RAIL ELEVATIONS**  
DATE 9/6/2023

TRACK 1		TRACK 2	
STA. -BRSSPUR-	EL.	STA. -BRSRR-	EL.
10+00.00	2093.61	24+00.00	2093.73
10+05.00	2093.53	24+05.00	2093.68
10+10.00	2093.45	24+10.00	2093.62
10+15.00	2093.36	24+15.00	2093.57
10+20.00	2093.27	24+20.00	2093.51
10+25.00	2093.15	24+25.00	2093.45
10+30.00	2093.09	24+30.00	2093.36
10+35.00	2093.03	24+35.00	2093.27
10+40.00	2093.01	24+40.00	2093.19
10+45.00	2092.99	24+45.00	2093.10
10+50.00	2092.91	24+50.00	2093.01
10+55.00	2092.85	24+55.00	2092.93
10+60.00	2092.77	24+60.00	2092.84
10+65.00	2092.68	24+65.00	2092.70
10+70.00	2092.58	24+70.00	2092.60
10+75.00	2092.47	24+75.00	2092.51
10+80.00	2092.34	24+80.00	2092.42
10+85.00	2092.20	24+85.00	2092.34
10+90.00	2092.09	24+90.00	2092.25
10+95.00	2091.96	24+95.00	2092.17
11+00.00	2091.80	25+00.00	2092.08
11+05.00	2091.65	25+05.00	2091.99
11+10.00	2091.50	25+10.00	2091.89
11+15.00	2091.35	25+15.00	2091.79
11+20.00	2091.20	25+20.00	2091.69

**HORIZONTAL CURVE DATA**

PI STA. 18+02.20 -Y5RPA-  
Δ = 4°-44'-02.57" (LT.)  
D = 0°-40'-26.64"  
L = 702.31'  
T = 351.35'  
R = 8500.00'

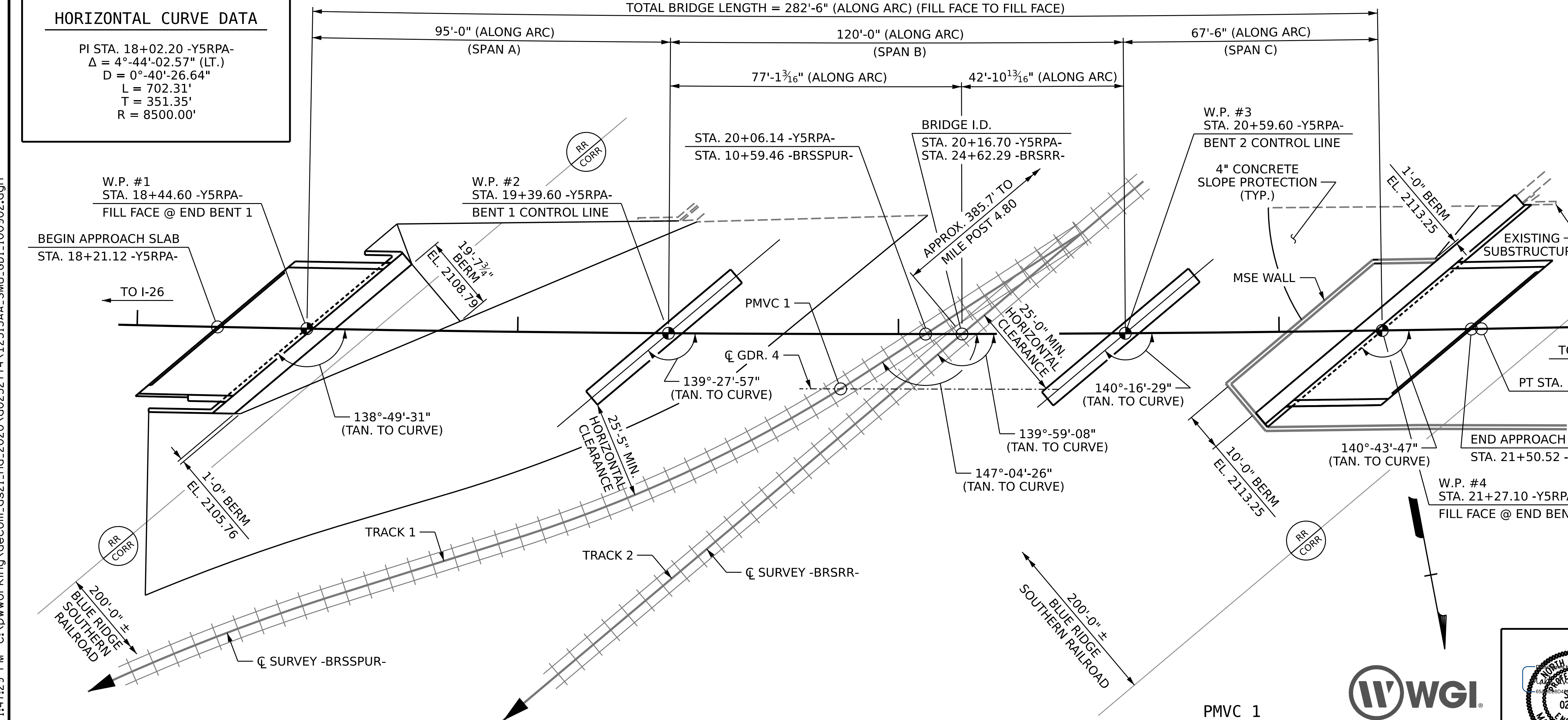

PROJECT NO. I-2513AA/AB  
BUNCOMBE COUNTY  
STATION: 20+16.70 -Y5RPA-

SHEET 1 OF 6 BRIDGE #100902  
MILE POST 4.80

STATE OF NORTH CAROLINA  
DEPARTMENT OF TRANSPORTATION  
RALEIGH

**GENERAL DRAWING**  
FOR BRIDGE ON I-40 RAMP OVER  
BLUE RIDGE SOUTHERN RAILROAD  
BETWEEN I-26 AND ALT. US 74

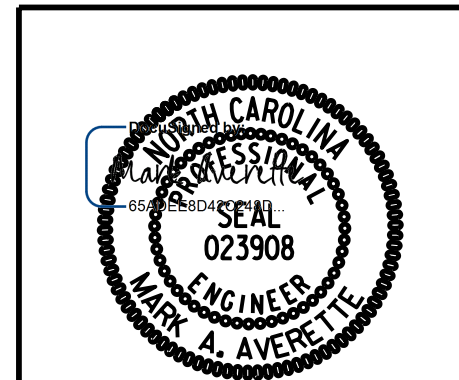

DRAWN BY : S.D. COOPER DATE : 12-23  
CHECKED BY : M.A. AVERETTE DATE : 12-23  
DESIGN ENGINEER OF RECORD: M.A. AVERETTE DATE : 12-23

PMVC 1  
STA. 19+78.46 -Y5RPA-  
OFFSET 15'-5" RT.  
PMVC = POINT OF MINIMUM  
VERTICAL CLEARANCE

REVISIONS

NO.	BY:	DATE:	NO.	BY:	DATE:
1			3		
2			4		

SHEET NO. S-1  
TOTAL SHEETS 49

12/21/2023 11:09 AM  
LICENSURE NO. C-4434  
**DOCUMENT NOT CONSIDERED FINAL  
UNLESS ALL SIGNATURES COMPLETED**

12/21/2023 11:41:29 PM c:\pwworking\cecom\_ds21\_na\_2020\d0252774\_I2513AA\_SMU\_GD1\_100902.dgn