

06/28/99

TIP PROJECT: U-5809

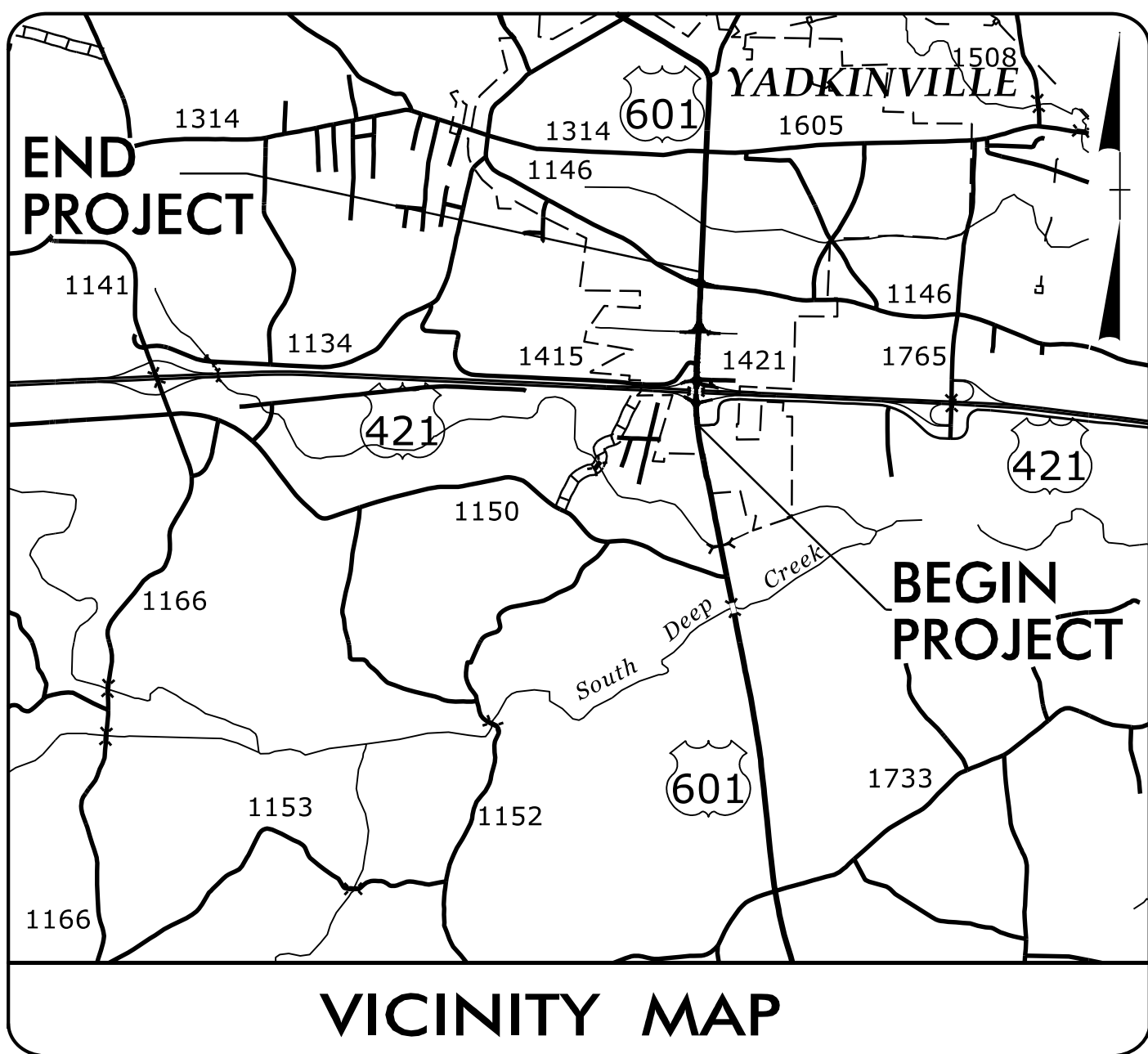

STATE OF NORTH CAROLINA
DIVISION OF HIGHWAYS

**UTILITIES BY OTHERS PLANS
YADKIN COUNTY**

**LOCATION: US 601 FROM SR 1742 (SHARON DR)
TO SR 1146 (LEE AVENUE)**

**TYPE OF WORK: DISTRIBUTION POWER, COMMUNICATIONS,
CATV, GAS**

T.I.P. NO.	SHEET NO.
U-5809	UO-1

NOTE:
ALL UTILITY WORK SHOWN ON THIS SHEET WILL BE DONE BY OTHERS. NO PAYMENT WILL BE MADE TO THE CONTRACTOR FOR UTILITY WORK SHOWN ON THIS SHEET.

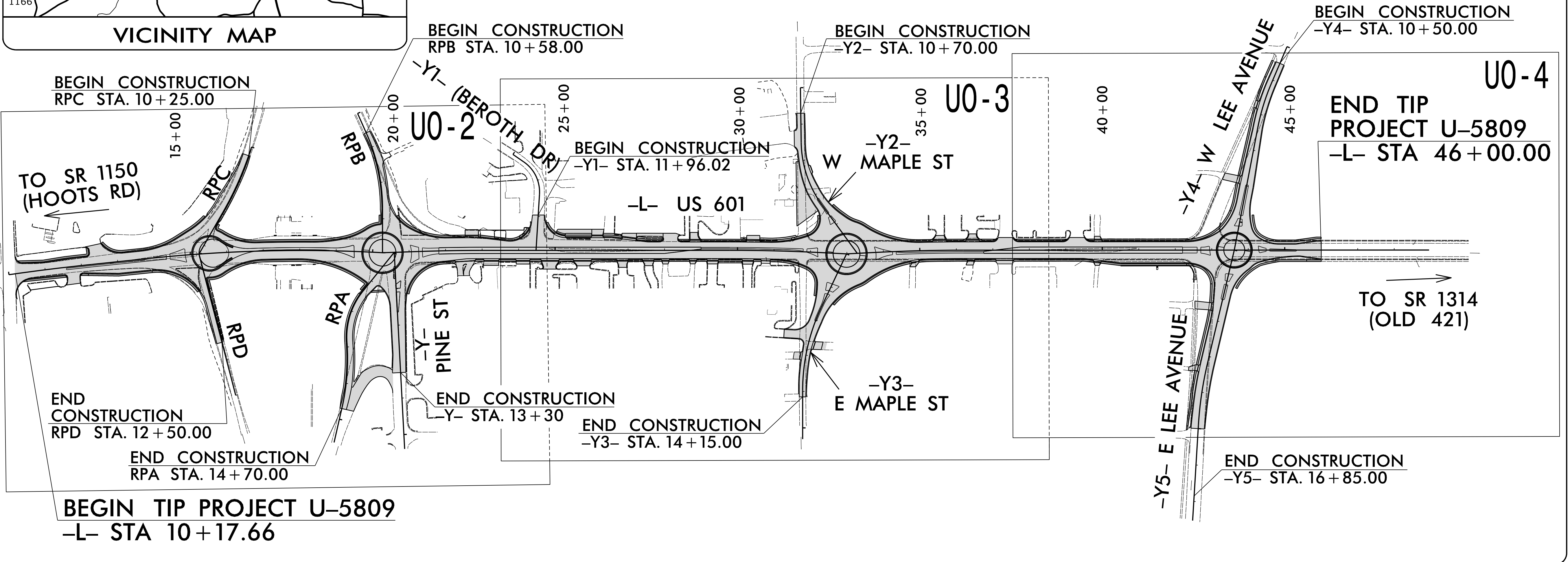
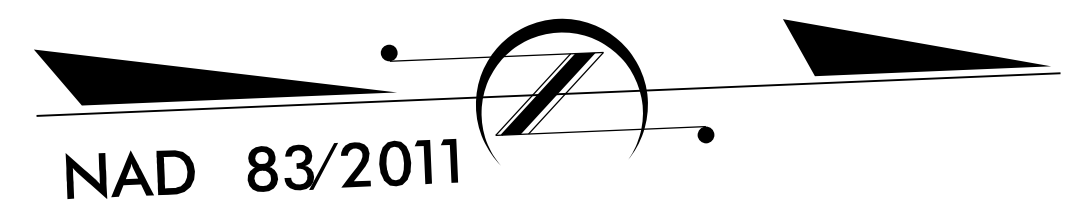

INDEX OF SHEETS

SHEET NO.:	DESCRIPTION:
UO-1	TITLE SHEET
UO-2 THRU UO-4	UBO PLAN SHEETS

UTILITY OWNERS WITH CONFLICTS

(A) DISTRIBUTION POWER - DUKE ENERGY
 (B) COMMUNICATIONS - CENTURYLINK
 (C) COMMUNICATIONS - YADTEL
 (D) COMMUNICATIONS/CATV - SPECTRUM
 (E) GAS - FRONTIER NATURAL GAS

PREPARED IN THE OFFICE OF:

TELICS
 1598 WESTBROOK PLAZA DR.
 SUITE 202
 WINSTON-SALEM, NC 27103
 (336) 705-8844

CORY WOOD UTILITY PROJECT MANAGER
CORY WOOD PROJECT UTILITY COORDINATOR

**DIVISION OF HIGHWAYS
DIVISION II**
 801 STATESVILLE RD
 NORTH WILKESBORO, NC 28659

BRANDON GREER DIVISION UTILITY ENGINEER
SUSAN HUFFMAN DIVISION UTILITY COORDINATOR

17-NOV-2023 2:16
 C:\UBO_FILES\2023\U-5809\UBOs\Utilities\Engineering\UBO\Proj\U-5809_ut_t_sh_U001_psh.dgn
 \$\$\$USERNAME\$\$\$

NAD 83/2011

UTILITIES BY OTHERS

ALL PROPOSED UTILITY WORK SHOWN ON THIS SHEET WILL BE DONE BY OTHERS. NO PAYMENT WILL BE MADE TO THE CONTRACTOR FOR PROPOSED UTILITY WORK SHOWN ON THIS SHEET.

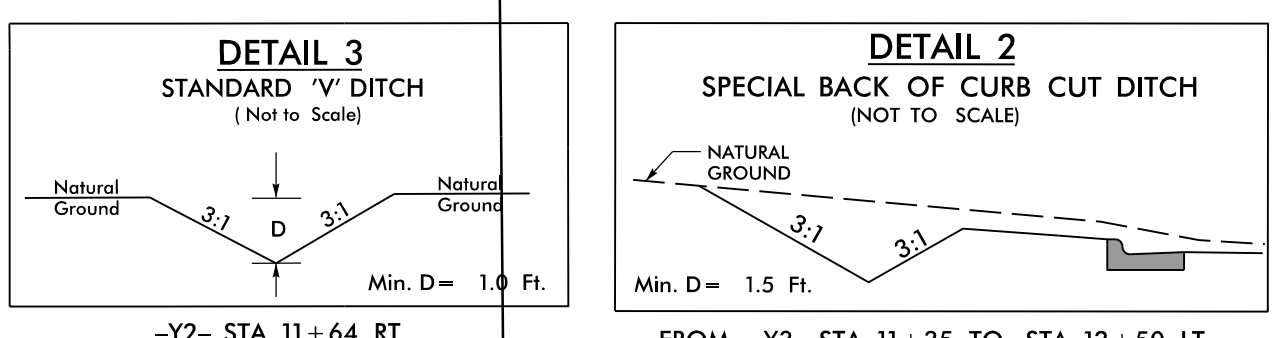
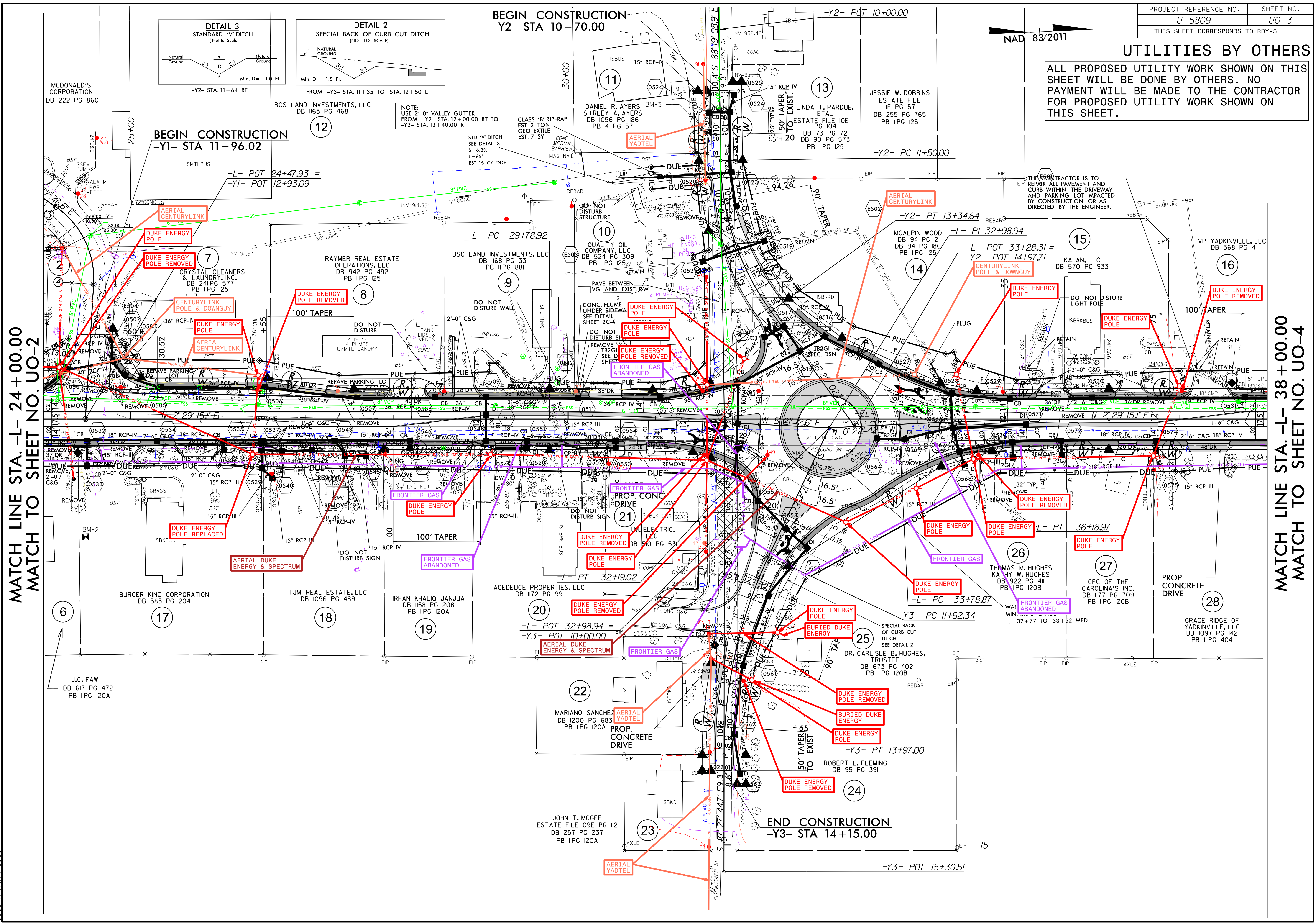

NOTE:
USE 2'-0" VALLEY GUTTER FROM -Y2- STA. 12+00.00 RT TO -Y2- STA. 13+40.00 RT

MATCH LINE STA. -L- 24+00.00
MATCH TO SHEET NO. UO-2

MATCH LINE STA. -L- 38+00.00
MATCH TO SHEET NO. UO-4

16-NOV-2023 2:23
U:\03\Projects\UO3\UO3.dgn
15809\UO3\UO3.dgn
15809\UO3\UO3.dgn

BEGIN CONSTRUCTION
-Y2- STA 10+70.00

END CONSTRUCTION
-Y3- STA 14+15.00

BEGIN CONSTRUCTION
-Y1- STA 11+96.02

-Y2- PC 11+50.00

-L- POT 32+98.94 =
-Y3- POT 10+00.00

-Y3- POT 15+30.51

-L- POT 24+47.93 =
-Y1- POT 12+93.09

-L- PC 29+78.92

-L- PI 32+98.94
-Y2- POT 14+97.71

-L- PT 32+19.02

-L- PC 33+78.87
-Y3- PC 11+62.34

-L- POT 32+98.94 =
-Y3- POT 10+00.00

-Y3- PT 13+97.00

