

LAYOUT FOR COMPUTING AREA OF REINFORCED CONCRETE DECK SLAB  
(SQ. FT. = 9,653)

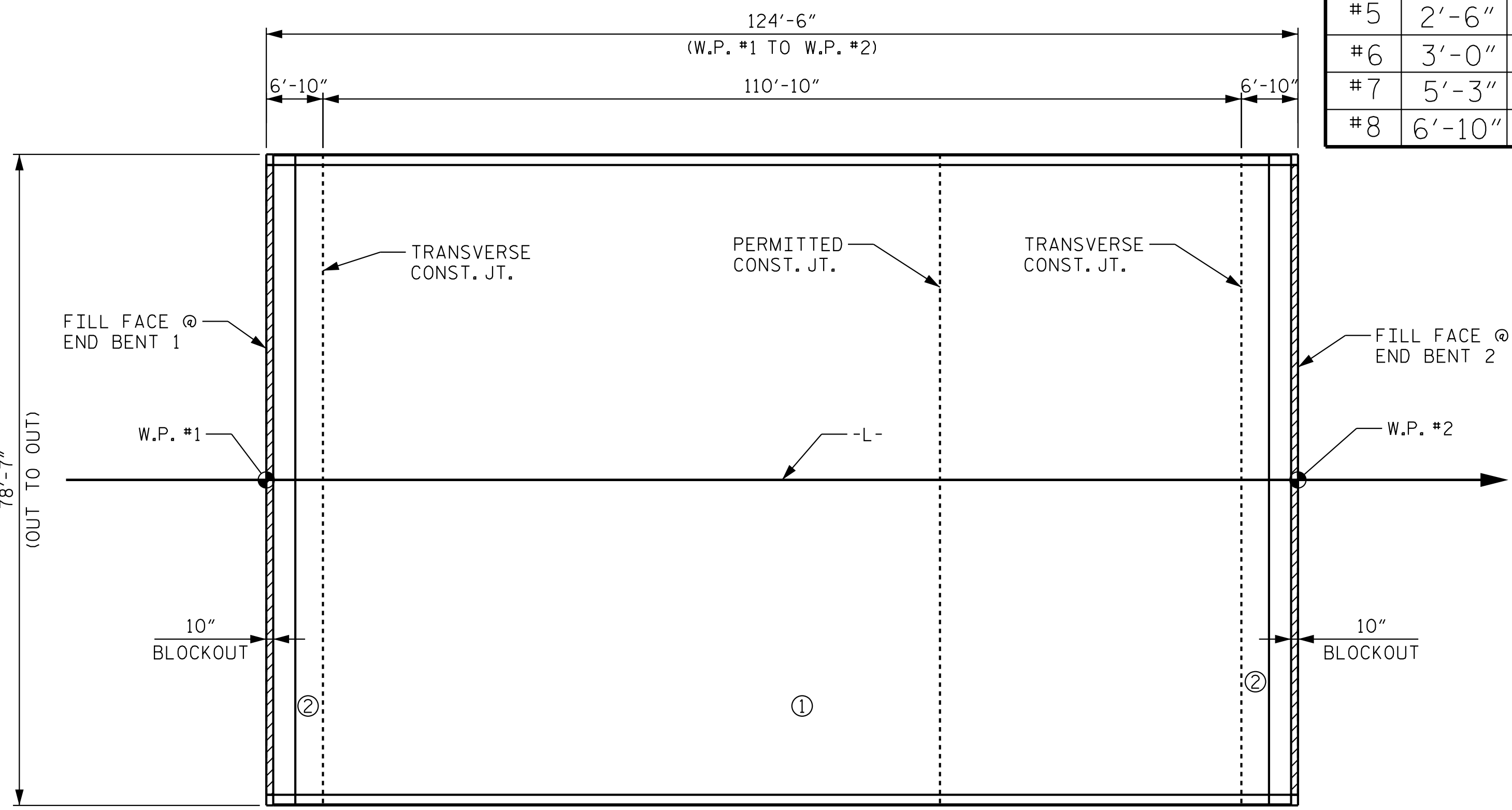

POUR SEQUENCE

| GROOVING BRIDGE FLOORS |        |        |
|------------------------|--------|--------|
| APPROACH SLABS         | 3,100  | SQ.FT. |
| BRIDGE DECK            | 7,616  | SQ.FT. |
| TOTAL                  | 10,716 | SQ.FT. |

| BAR SIZE | SUPERSTRUCTURE EXCEPT APPROACH SLABS, PARAPET, AND BARRIER RAIL |          | APPROACH SLABS |          | PARAPET AND BARRIER RAIL |
|----------|---|----------|----------------|----------|--------------------------|
|          | EPOXY COATED  | UNCOATED | EPOXY COATED   | UNCOATED |                          |
| #4       | 2'-0"   | 1'-9"    | 2'-0"          | 1'-9"    | 2'-9"                    |
| #5       | 2'-6"   | 2'-2"    | 2'-6"          | 2'-2"    | 3'-5"                    |
| #6       | 3'-0"   | 2'-7"    | 3'-10"         | 2'-7"    | 4'-4"                    |
| #7       | 5'-3"   | 3'-6"    |                |          |                          |
| #8       | 6'-10"  | 4'-7"    |                |          |                          |

SUPERSTRUCTURE REINFORCING STEEL LENGTHS ARE BASED ON THE FOLLOWING MINIMUM SPLICE LENGTHS

| BILL OF MATERIAL SUPERSTRUCTURE |     |      |      |         |        |
|---------------------------------|-----|------|------|---------|--------|
| BAR                             | NO. | SIZE | TYPE | LENGTH  | WEIGHT |
| *A1                             | 454 | 5    | STR  | 40'-5"  | 19,138 |
| A2                              | 454 | 5    | STR  | 40'-3"  | 19,059 |
| *B1                             | 159 | 4    | STR  | 27'-8"  | 2,939  |
| *B2                             | 314 | 6    | STR  | 23'-9"  | 11,201 |
| B3                              | 198 | 5    | STR  | 42'-4"  | 8,742  |
| *B4                             | 50  | 4    | STR  | 26'-2"  | 874    |
| *G1                             | 246 | 4    | STR  | 5'-2"   | 849    |
| K1                              | 30  | 4    | STR  | 27'-4"  | 548    |
| K2                              | 20  | 4    | STR  | 3'-9"   | 50     |
| K3                              | 20  | 4    | STR  | 4'-11"  | 66     |
| K4                              | 40  | 4    | STR  | 6'-4"   | 169    |
| K5                              | 20  | 4    | STR  | 4'-6"   | 60     |
| K6                              | 4   | 4    | STR  | 1'-1"   | 3      |
| K7                              | 4   | 4    | STR  | 1'-8"   | 4      |
| K8                              | 8   | 4    | STR  | 2'-5"   | 13     |
| K9                              | 4   | 4    | STR  | 1'-9"   | 5      |
| *S1                             | 84  | 4    | 2    | 11'-11" | 669    |
| *S2                             | 82  | 4    | 2    | 10'-6"  | 575    |
| U1                              | 88  | 4    | 1    | 11'-2"  | 656    |
| *U2                             | 72  | 4    | 1    | 3'-8"   | 176    |

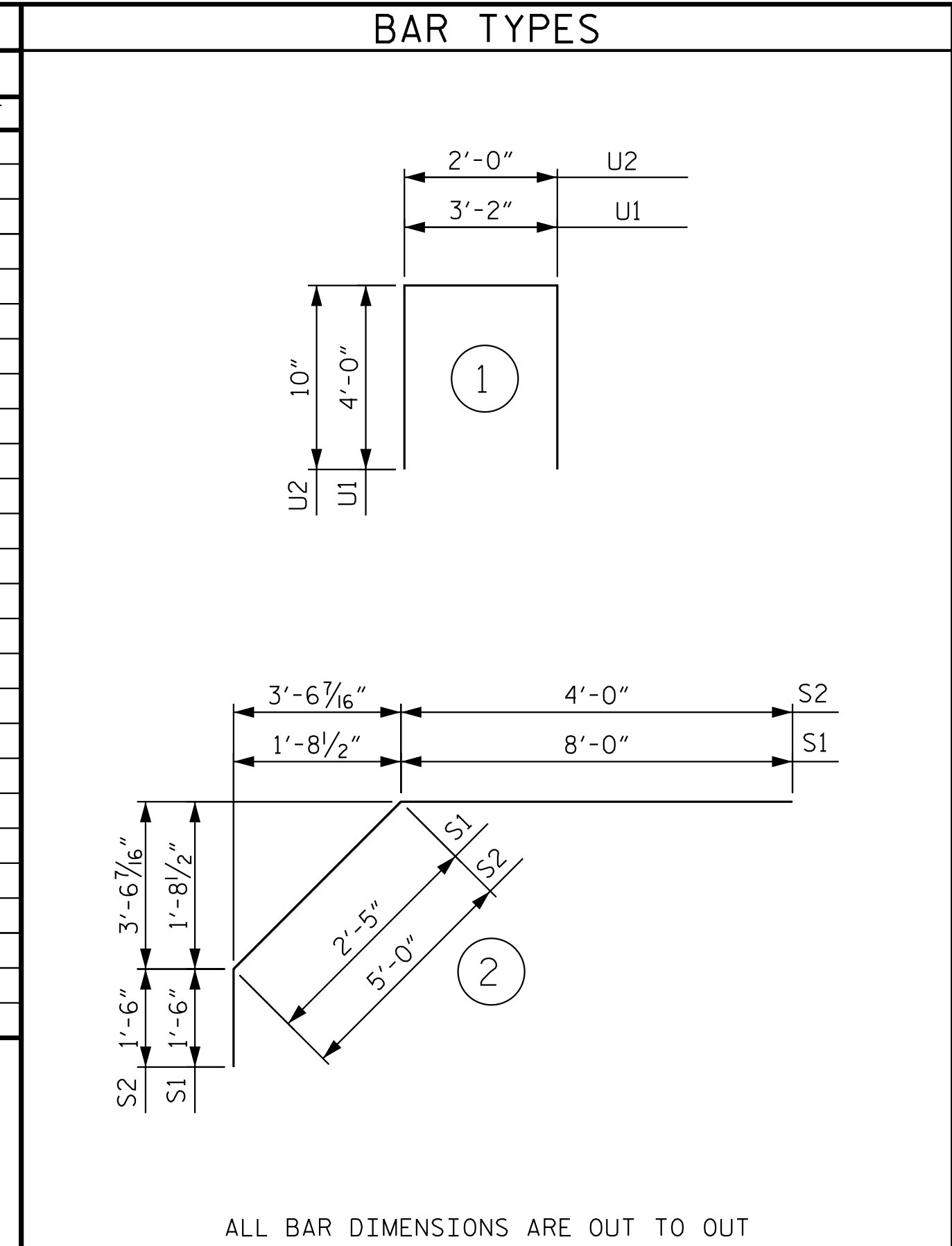

| SUPERSTRUCTURE BILL OF MATERIAL |                              |                          |   |
|---------------------------------|------------------------------|--------------------------|---|
|                                 | CLASS AA CONCRETE (CU. YDS.) | REINFORCING STEEL (LBS.) | * EPOXY COATED REINFORCING STEEL (LBS.) |
| SPAN A                          |                              | 29,375                   | 36,421                                  |
| POUR #1                         | 258.2                        |                          |   |
| POUR #2                         | 108.3                        |                          |   |
| SIDEWALK                        | 30.6                         |                          |   |
| TOTALS **                       | 397.1                        | 29,375                   | 36,421                                  |

\*\*QUANTITIES FOR CONCRETE PARAPETS ARE NOT INCLUDED

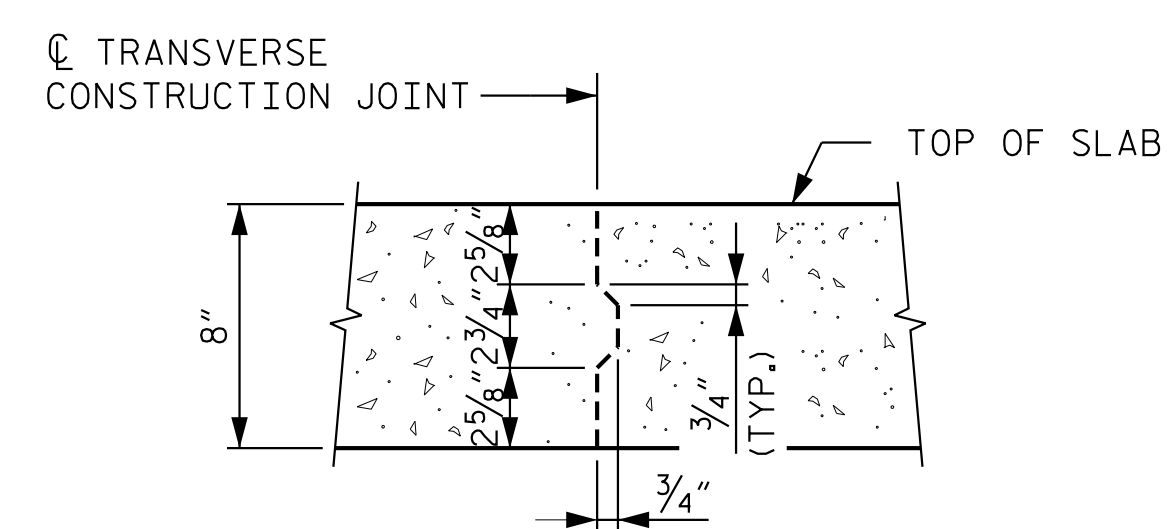

TRANSVERSE CONSTRUCTION JOINT IN DECK SLAB  
REINFORCING STEEL IN SLAB NOT SHOWN, LONGITUDINAL REINFORCING STEEL SHALL BE CONTINUOUS THRU JOINT.

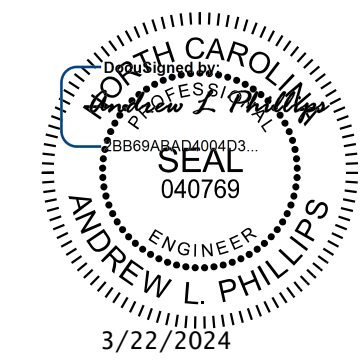

**Kimley»Horn**  
421 Fayetteville Street, Suite 600  
Raleigh, NC 27601-1772  
Phone (919) 677-2000  
NC LICENSE # F-0102

PROJECT NO. P-5720  
WAKE COUNTY  
STATION: 32+23.01 -L-

STATE OF NORTH CAROLINA  
DEPARTMENT OF TRANSPORTATION  
RAI FTGH  
SUPERSTRUCTURE  
BILL OF MATERIAL

| REVISIONS |     |       |     |       | SHEET NO.    |
|-----------|-----|-------|-----|-------|--------------|
| NO.       | BY: | DATE: | NO. | DATE: | S-23         |
| 1         |     |       | 3   |       | TOTAL SHEETS |
| 2         |     |       | 4   |       | 33           |

DOCUMENT NOT CONSIDERED FINAL UNLESS ALL SIGNATURES COMPLETED

K:\DOT\Structure\Bridges\NC\11036002 - P-5720\Code\Drawings\5720\_SML\_BML\_911494.dgn

|                            |                     |
|----------------------------|---------------------|
| ASSEMBLED BY : D.D. LOWERY | DATE : 1/19         |
| CHECKED BY : S.A. DENNEY   | DATE : 1/19         |
| DRAWN BY : JMB 5/87        | REV. 5/1/06 TLA/GM  |
| CHECKED BY : SJD 9/87      | REV. 10/1/11 MAA/GM |
|                            | REV. 12/17 MAA/THC  |