

END VIEW

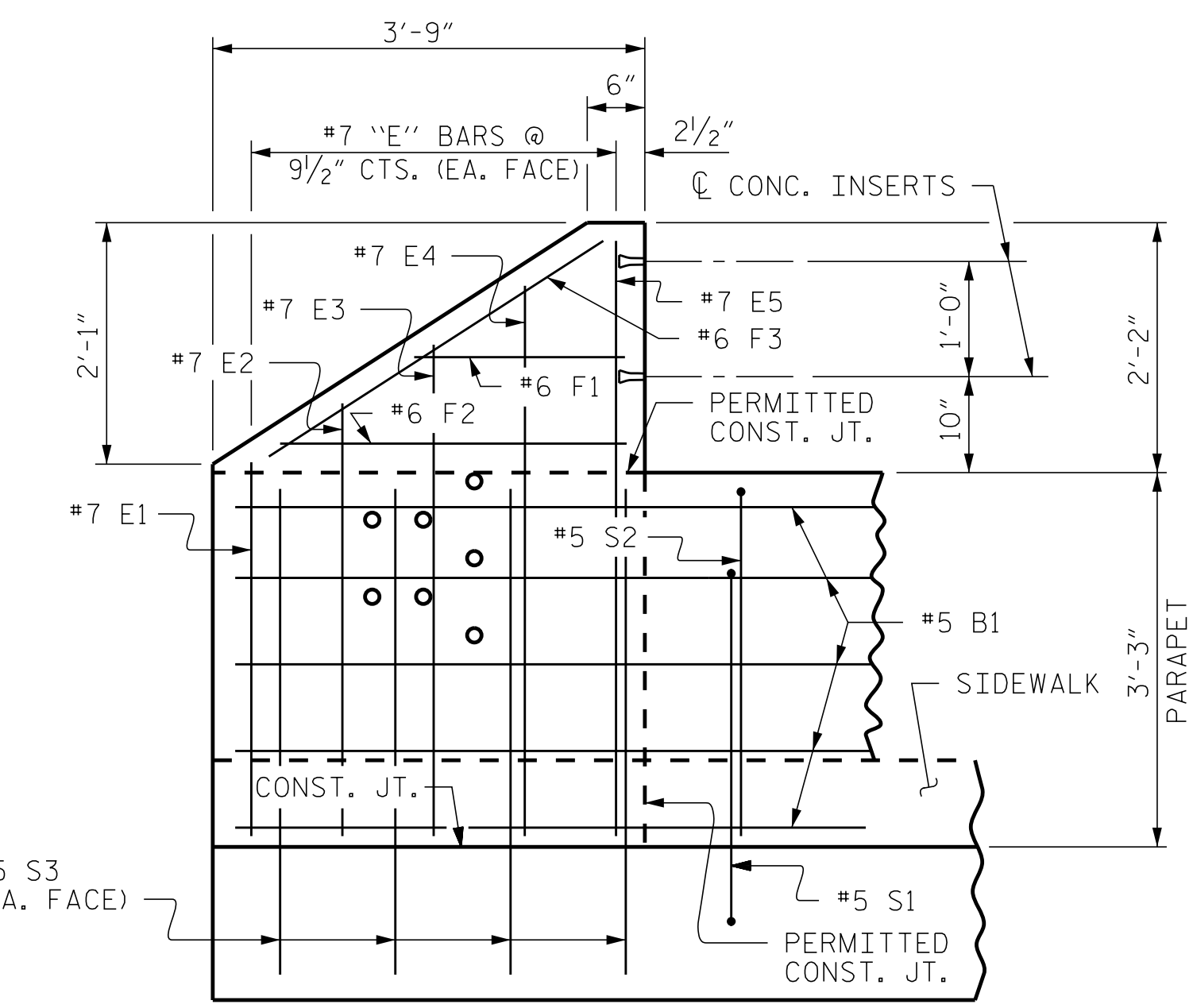

ELEVATION

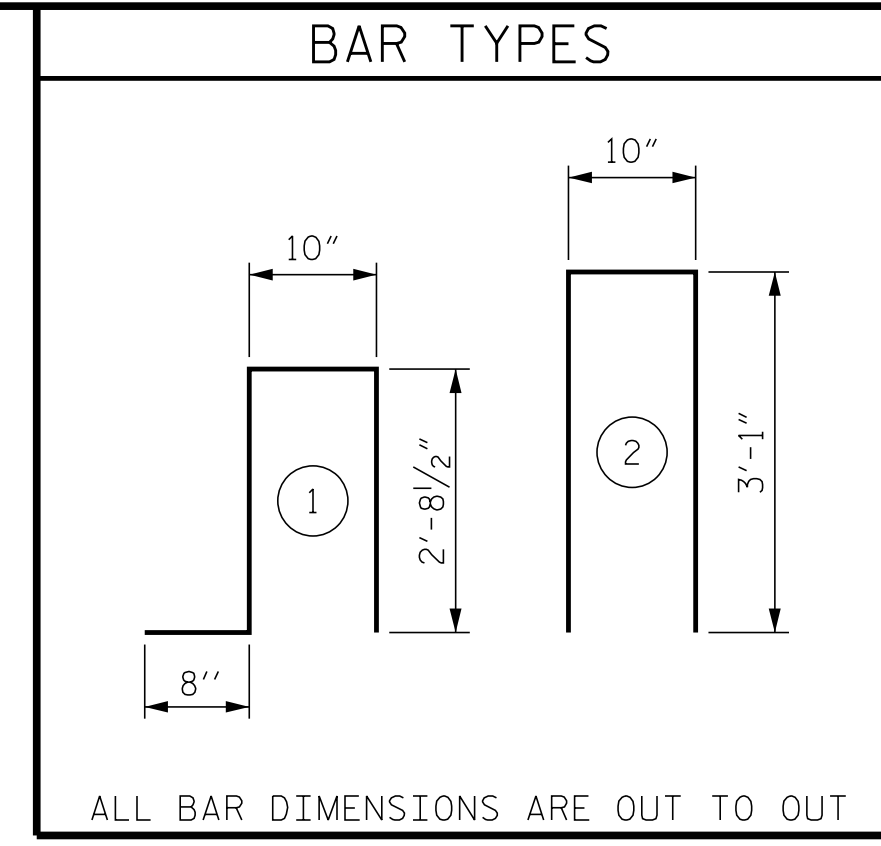

BILL OF MATERIAL					
2 CONCRETE PARAPETS AND 4 END POSTS					
BAR	NO.	SIZE	TYPE	LENGTH	WEIGHT
*B1	40	5	STR	20'-7"	859
*B2	60	5	STR	26'-8"	1,669
*E1	8	7	STR	3'-3"	53
*E2	8	7	STR	3'-9"	61
*E3	8	7	STR	4'-3"	69
*E4	8	7	STR	4'-9"	78
*E5	8	7	STR	5'-1"	83
*F1	8	6	STR	1'-10"	22
*F2	8	6	STR	3'-0"	36
*F3	8	6	STR	3'-5"	41
*S1	230	5	1	6'-11"	1,659
*S2	230	5	2	7'-0"	1,679
*S3	32	5	STR	3'-9"	125
*EPOXY COATED REINFORCING STEEL					6,434 LBS.
CLASS AA CONCRETE					35.3 C.Y.
1'-2" X 3'-3" CONCRETE PARAPET					245.67 LIN. FT.

PARAPET AND END POST FOR TWO BAR RAIL

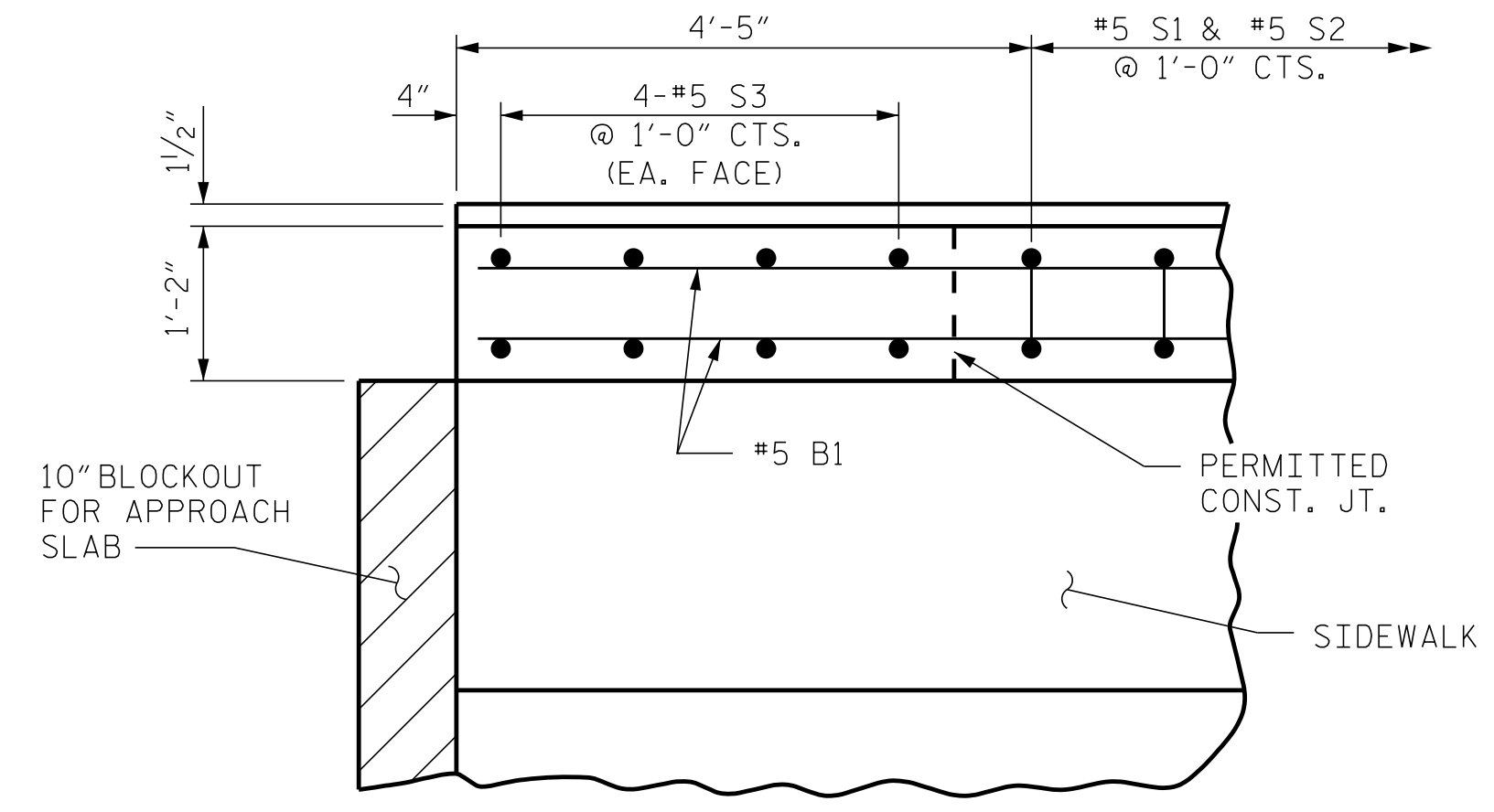

PLAN OF PARAPET

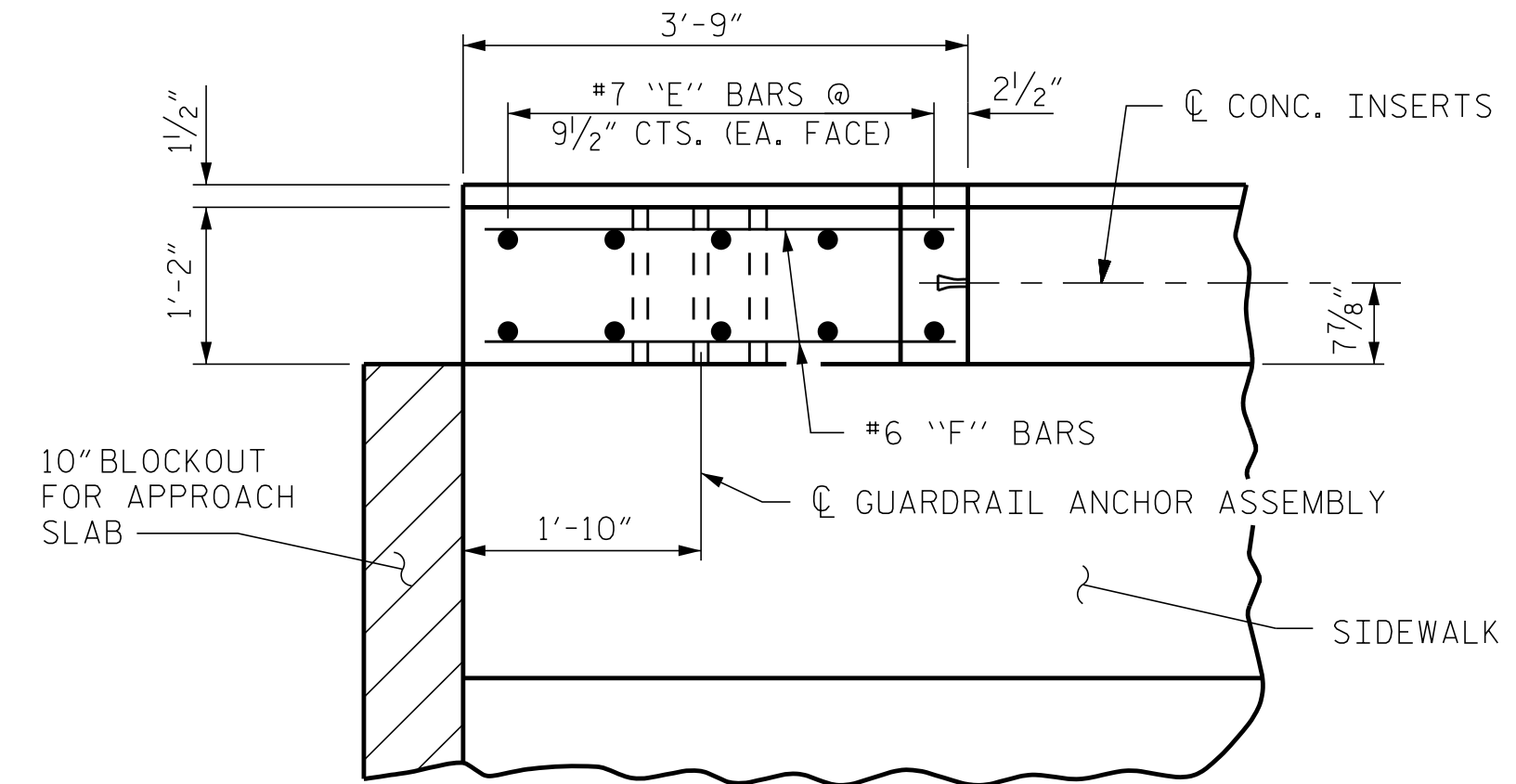

PLAN OF END POST

NOTES

THE PARAPET IN EACH SPAN SHALL NOT BE CAST UNTIL ALL SLAB CONCRETE IN THAT SPAN HAS BEEN CAST AND HAS REACHED A MINIMUM COMPRESSIVE STRENGTH OF 3,000 PSI.

ALL REINFORCING STEEL IN PARAPET AND END POSTS SHALL BE EPOXY COATED.

THE #5 S1 & #5 S2 BARS MAY BE SHIFTED SLIGHTLY IN ORDER TO MAINTAIN A 2" MINIMUM CLEARANCE TO THE 1/2" EXPANSION JOINT MATERIAL IN PARAPET.

FOR DETAILS OF CONCRETE INSERTS IN END POSTS, SEE "RAIL POST SPACINGS AND END OF RAIL DETAILS" SHEET.

FOR DETAILS OF GUARDRAIL ANCHOR ASSEMBLIES, SEE "GUARDRAIL ANCHORAGE DETAILS FOR METAL RAIL" SHEET.

GROOVED CONTRACTION JOINTS, 1/2" IN DEPTH, SHALL BE TOOLED IN ALL EXPOSED FACES OF THE PARAPET AND IN ACCORDANCE WITH ARTICLE 825-10(B) OF THE STANDARD SPECIFICATIONS. A CONTRACTION JOINT SHALL BE LOCATED AT EACH THIRD POINT BETWEEN BARRIER RAIL EXPANSION JOINTS. ONLY ONE CONTRACTION JOINT IS REQUIRED AT MIDPOINT OF BARRIER RAIL SEGMENTS LESS THAN 20 FEET IN LENGTH AND NO CONTRACTION JOINTS ARE REQUIRED FOR THOSE SEGMENTS LESS THAN 10 FEET IN LENGTH.

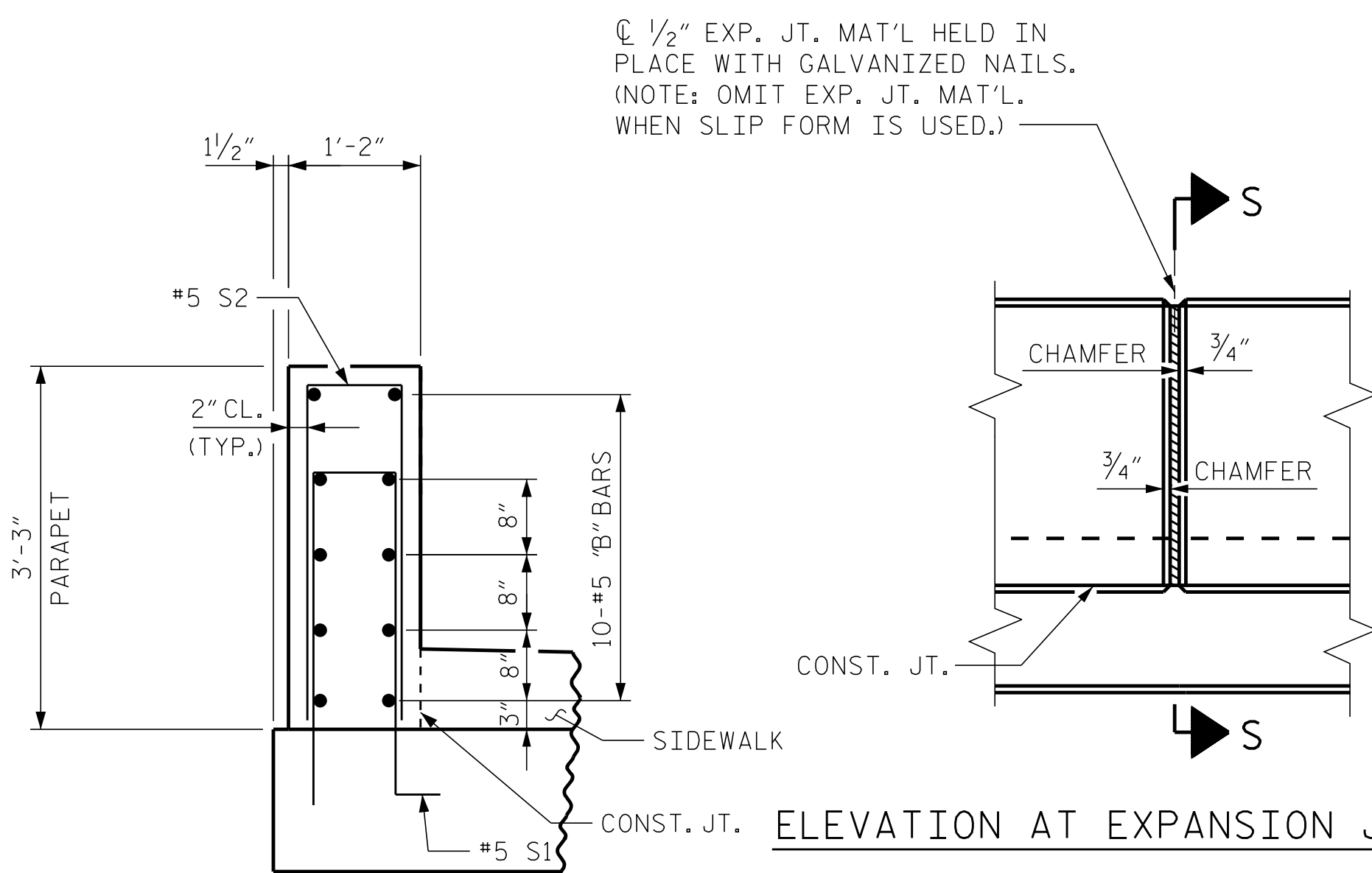

SECTION THRU PARAPET

ELEVATION AT EXPANSION JOINTS

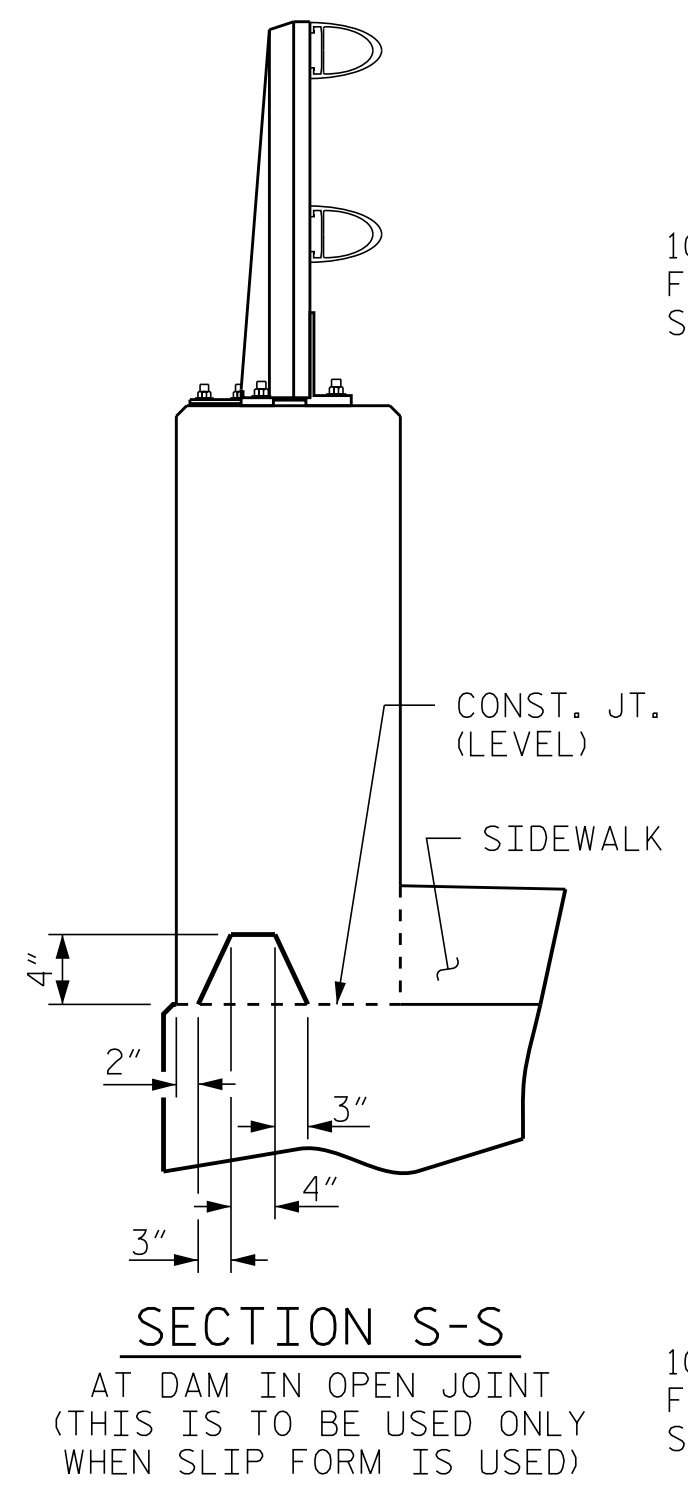

SECTION S-S AT DAM IN OPEN JOINT (THIS IS TO BE USED ONLY WHEN SLIP FORM IS USED)

PROJECT NO. P-5720
 WAKE COUNTY
 STATION: 32+23.01 -L-

SHEET 4 OF 5

STATE OF NORTH CAROLINA
 DEPARTMENT OF TRANSPORTATION
 RALEIGH
 SUPERSTRUCTURE
 CONCRETE PARAPET
 DETAILS



DocuSigned by:
 SETH A. DENNEY
 E8EB15AC0ED410 1/10/2024

Kimley»Horn
 421 Fayetteville Street, Suite 600
 Raleigh, NC 27601-1772
 Phone (919) 677-2000 NC LICENSE # F-0102

**DOCUMENT NOT CONSIDERED FINAL
 UNLESS ALL SIGNATURES COMPLETED**

DRAWN BY: J. I. KIMBLE	DATE: 1/19
CHECKED BY: M. D. MAGEE	DATE: 1/19
DESIGN ENGINEER OF RECORD: S. A. DENNEY	DATE: 1/19

REVISIONS				SHEET NO.
NO.	BY:	DATE:	NO.	DATE:
1			3	
2			4	

TOTAL SHEETS: 33