

PEDESTRIAN CROSSING AT THE INTERSECTION OF DURANT ROAD & CAMP DURANT ROAD.

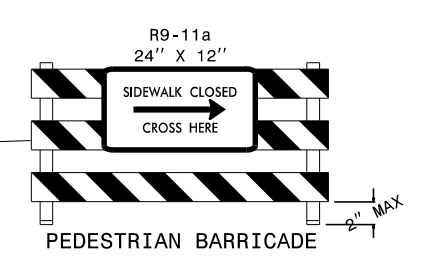

NOTE: INSTALL PEDESTRIAN BARRICADE AT THE INTERSECTION OF DURANT ROAD & CAMP DURANT ROAD TO CLOSE SIDEWALK ON NORTHSIDE.

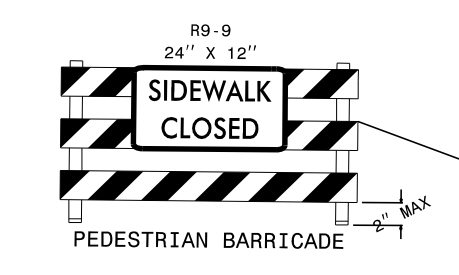

END CONSTRUCTION
-DRW1- POT Sta. 11+55.00

BEGIN TIP PROJECT P-5720
-L- POT Sta. 11+00.00

-L- SR 2006 (DURANT RD)

-L- POT Sta. 12+27.38 =
-Y1- POT Sta. 12+24.40

STA. 14+00+/- -L-

STA. 21+30+/- -L-

STA. 21+00+/- -L-

WATER FILLED BARRIER

-L- SR 2006 (DURANT RD)

BEGIN CONSTRUCTION
-Y1- POT Sta. 11+43.00

-Y1- HAWKSMOOR DR



NOTE: INSTALL PEDESTRIAN DETOUR SIGN (M4-9B) AT THE INTERSECTION OF EXISTING CROSSWALK ACROSS DURANT ROAD AND EXISTING SIDEWALK ON THE SOUTHSIDE OF DURANT ROAD.

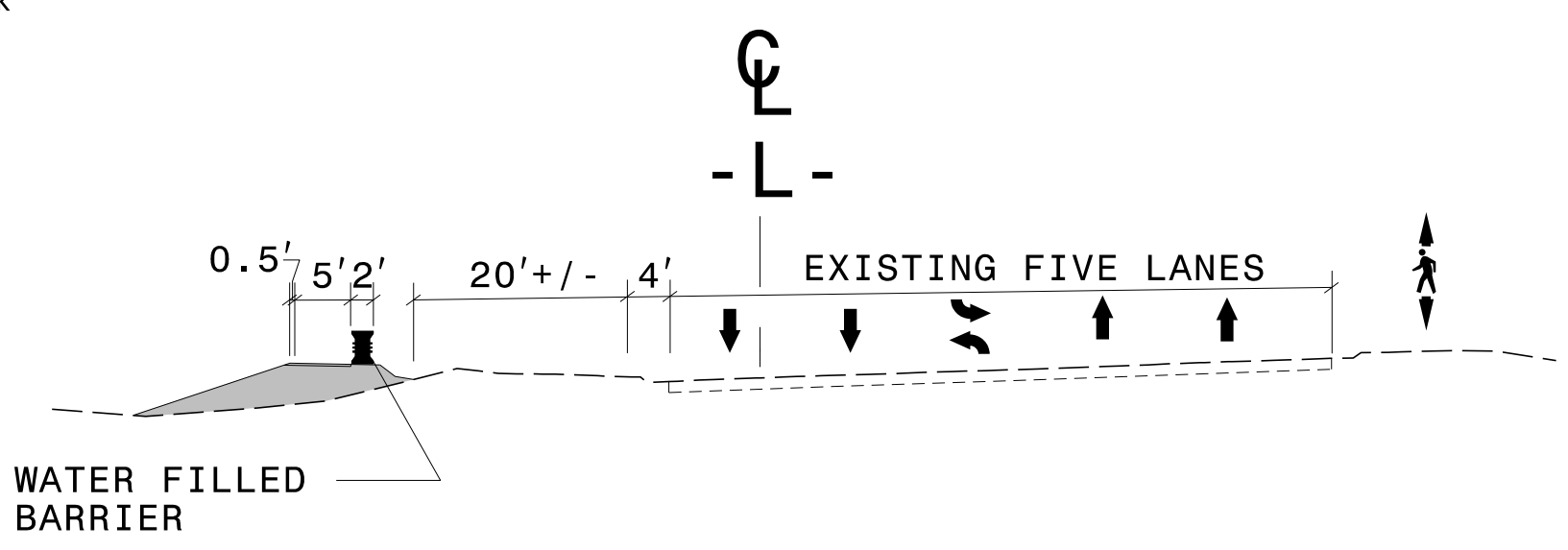

TYPICAL SECTION A-A

STA. 17+00+/-

NOTES: PAVEMENT MARKINGS SHOW ARE EXISTING UNLESS OTHERWISE NOTED. SEE TMP-1A FOR PAVEMENT MARKING SCHEDULE.

DOCUMENT NOT CONSIDERED FINAL
UNLESS ALL SIGNATURES COMPLETED

WETHERILL ENGINEERING

1223 Jones Franklin Rd.
Raleigh, N.C. 27606
License No. F-0377
Bus: 919 851 8077
Fax: 919 851 8107

TRANSPORTATION PLANNING/DESIGN - BRIDGE/STRUCTURE DESIGN
CIVIL/SITE DESIGN - GIS/GPS - CONSTRUCTION OBSERVATION

APPROVED: *Bob A. May*

DATE: 10/16/2018

SEAL

PHASE I