

**TIP PROJECT: BR-0093**

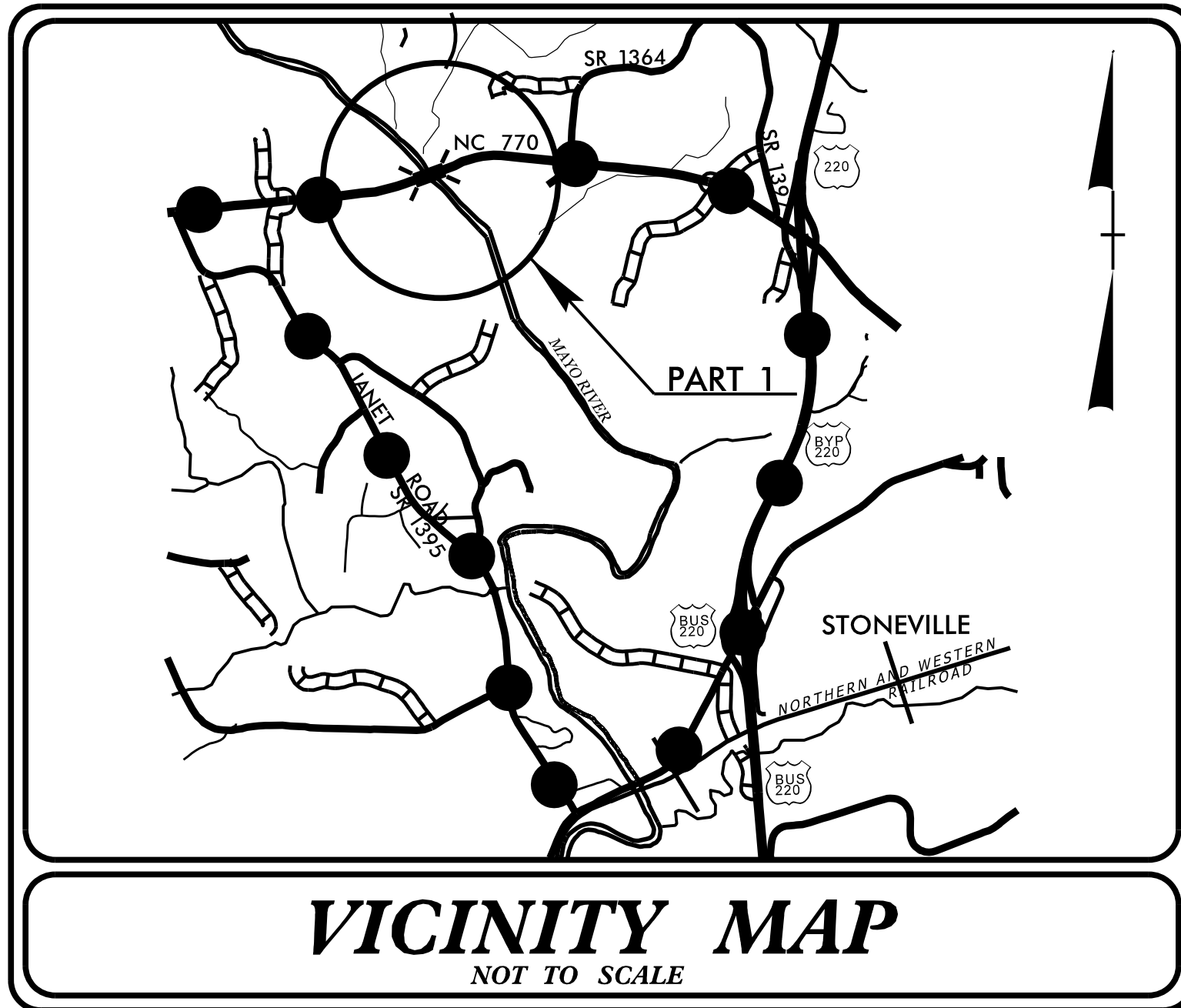

STATE OF NORTH CAROLINA  
 DIVISION OF HIGHWAYS  
 PLAN FOR PROPOSED  
 HIGHWAY EROSION CONTROL  
 ROCKINGHAM COUNTY

LOCATION: Replace Bridge 780035 On NC 770 Over Mayo River and SR 1395 (Janet Road)  
 From US 220 BUS to NC 770  
 TYPE OF WORK: GRADING, PAVING, DRAINAGE AND STRUCTURE

STATE	STATE PROJECT REFERENCE NO.	SHEET NO.	TOTAL SHEETS
N.C.	BR-0093	EC-1	
STATE PROJ. NO.	F.A. PROJ. NO.	DESCRIPTION	

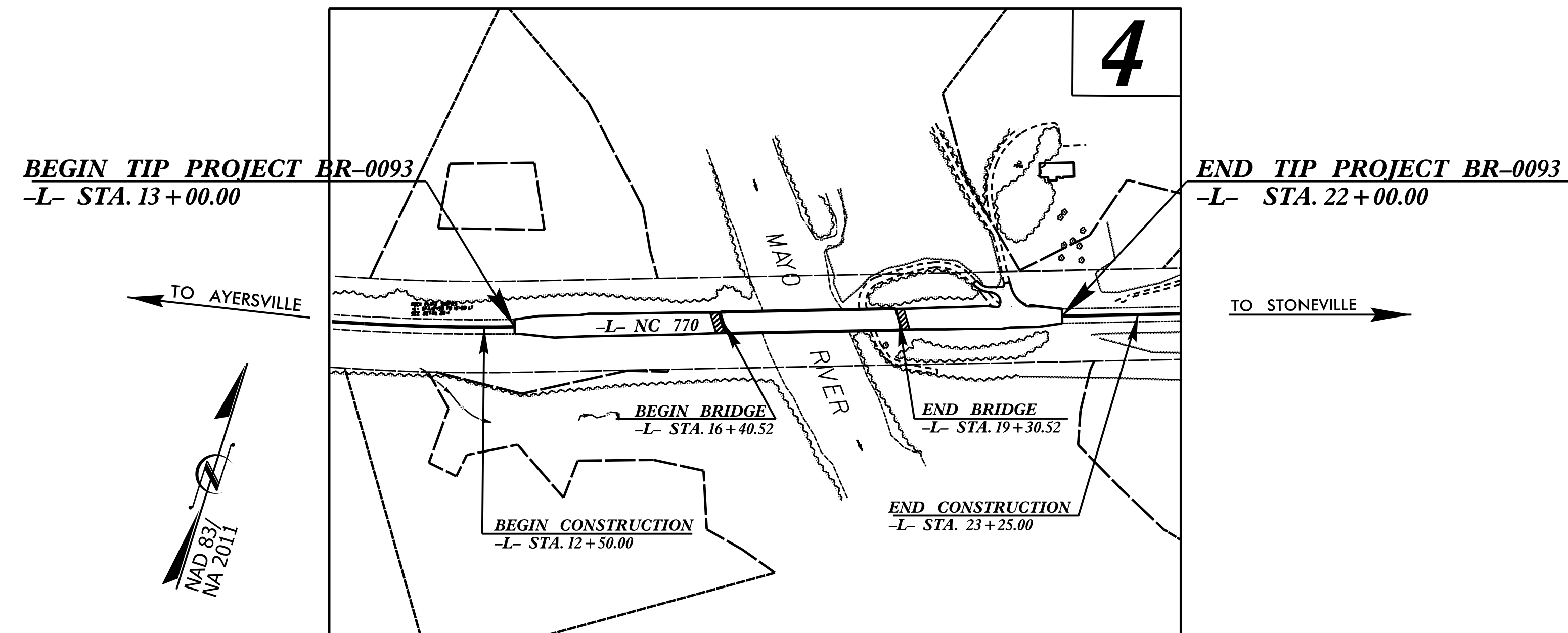

THIS PROJECT CONTAINS EROSION CONTROL PLANS FOR CLEARING AND GRUBBING PHASE OF CONSTRUCTION.

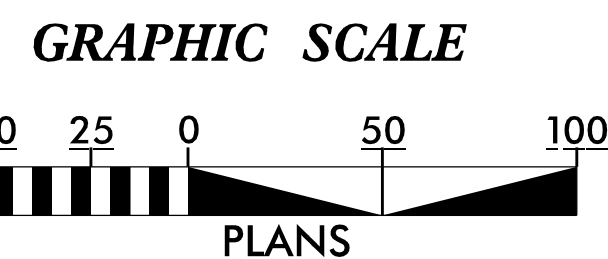

THESE EROSION AND SEDIMENT CONTROL PLANS COMPLY WITH THE REGULATIONS SET FORTH BY THE NCG-010000 GENERAL CONSTRUCTION PERMIT EFFECTIVE APRIL 1, 2019 ISSUED BY THE NORTH CAROLINA DEPARTMENT OF ENVIRONMENT AND NATURAL RESOURCES DIVISION OF WATER QUALITY.

Prepared in the Office of:  
**ROADSIDE ENVIRONMENTAL UNIT**  
 1 South Wilmington St.  
 Raleigh, NC 27611  
**2024 STANDARD SPECIFICATIONS**

Designed by:  
**Noelle Ring** **3456**  
 NAME LEVEL III CERTIFICATION NO.

Roadway Standard Drawings  
 The "Roadway Standard Drawings"- Roadway Design Unit - N. C. Department of Transportation - Raleigh, N. C., dated January 2024 and the latest revision thereto are applicable to this project and by reference hereby are considered a part of these plans.

# DIVISION OF HIGHWAYS STATE OF NORTH CAROLINA

PROJECT REFERENCE NO. <b>BR-0093</b>	SHEET NO. <b>EC-02</b>
ROADWAY DESIGN ENGINEER	HYDRAULICS ENGINEER

## EROSION & SEDIMENT CONTROL LEGEND

Std. #	Description	Symbol	Std. #	Description	Symbol
1605.01	Temporary Silt Fence		1633.01	Temporary Rock Silt Check Type A	
1606.01	Special Sediment Control Fence		1633.02	Temporary Rock Silt Check Type B	
1622.01	Temporary Berms and Slope Drains		1633.03	Temporary Rock Silt Check Type A with Excelsior Matting and Flocculant	
1630.02	Silt Basin Type B		1634.01	Temporary Rock Sediment Dam Type A	
1630.03	Temporary Silt Ditch		1634.02	Temporary Rock Sediment Dam Type B	
1630.04	Stilling Basin		1635.01	Rock Pipe Inlet Sediment Trap Type A	
1630.05	Temporary Diversion		1635.02	Rock Pipe Inlet Sediment Trap Type B	
1630.06	Special Stilling Basin		1636.01	Excelsior Wattle Check	
1630.07	Skimmer Basin		1636.01	Excelsior Wattle Check with Flocculant	
1630.08	Tiered Skimmer Basin		1636.01	Coir Fiber Wattle Check	
1630.09	Earthen Dam with Skimmer		1636.01	Coir Fiber Wattle Check with Flocculant	
	Infiltration Basin		1636.02	Silt Fence Excelsior Wattle Break	
	Rock Inlet Sediment Trap:			Silt Fence Coir Fiber Wattle Break	
1632.01	Type A		1636.03	Excelsior Wattle Barrier	
1632.02	Type B		1636.03	Coir Fiber Wattle Barrier	
1632.03	Type C				

PROJECT REFERENCE NO. <i>BR-0093</i>	SHEET NO. <i>EC-2A</i>
R/W SHEET NO.	
ROADWAY DESIGN ENGINEER	HYDRAULICS ENGINEER

# ONSITE CONCRETE WASHOUT STRUCTURE WITH LINER

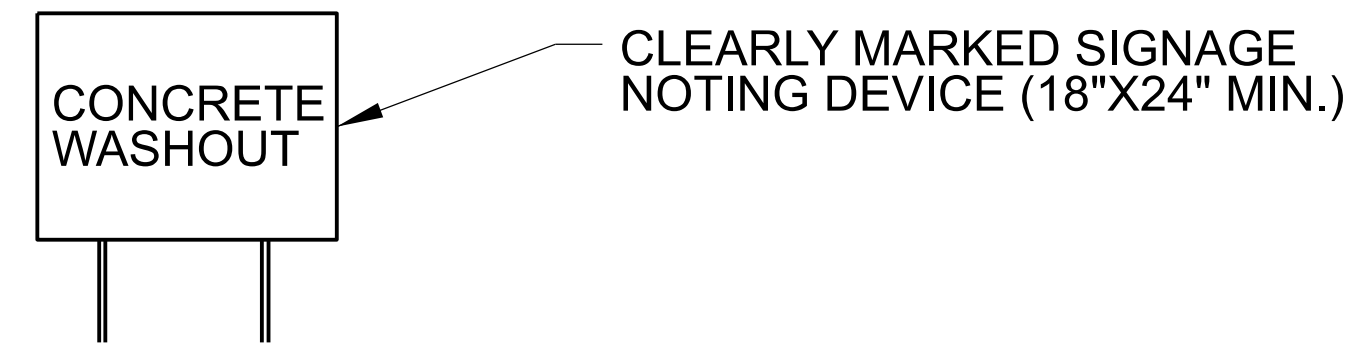
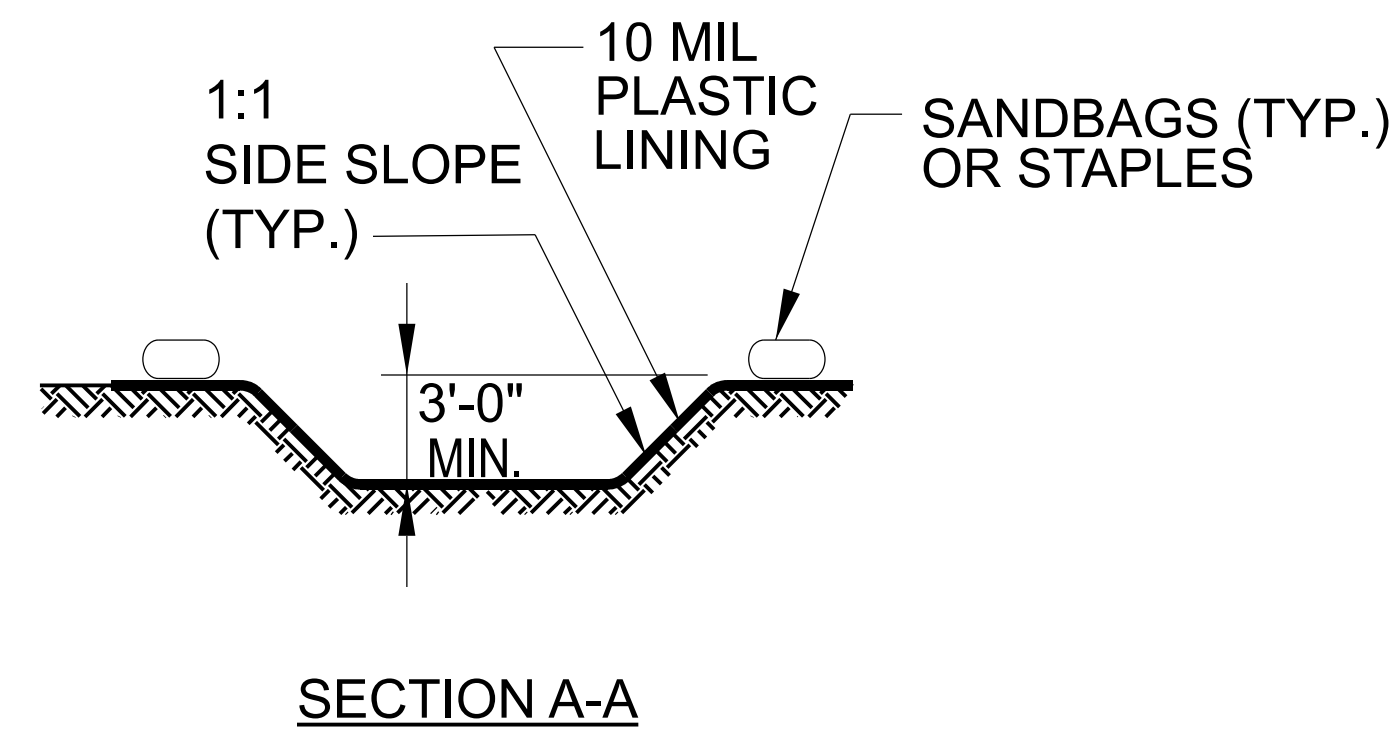
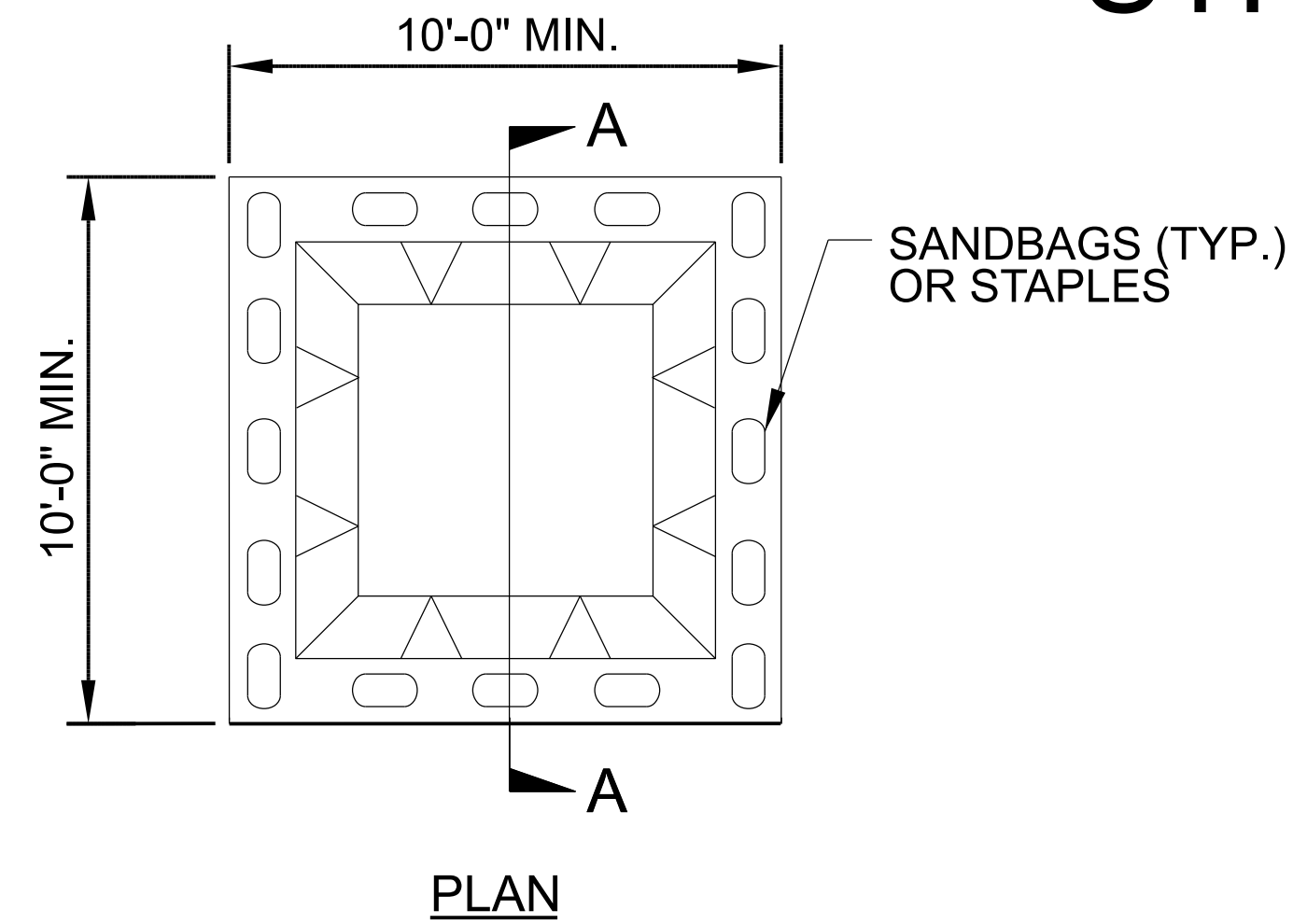

**BELOW GRADE WASHOUT STRUCTURE**  
NOT TO SCALE

- NOTES:**
1. ACTUAL LOCATION DETERMINED IN FIELD
  2. THE CONCRETE WASHOUT STRUCTURES SHALL BE MAINTAINED WHEN THE LIQUID AND/OR SOLID REACHES 75% OF THE STRUCTURES CAPACITY TO PROVIDE ADEQUATE HOLDING CAPACITY WITH A MINIMUM 12 INCHES OF FREEBOARD.
  3. CONCRETE WASHOUT STRUCTURE NEEDS TO BE CLEARLY MARKED WITH SIGNAGE NOTING DEVICE.

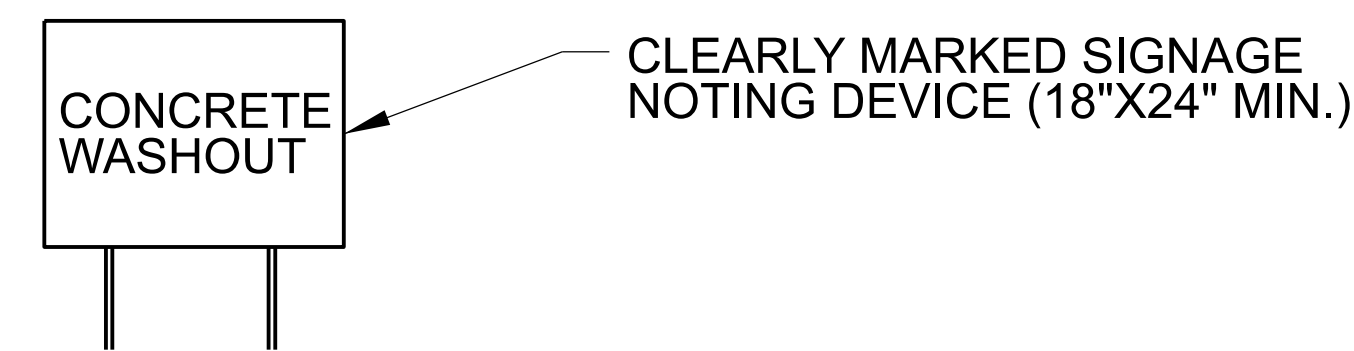
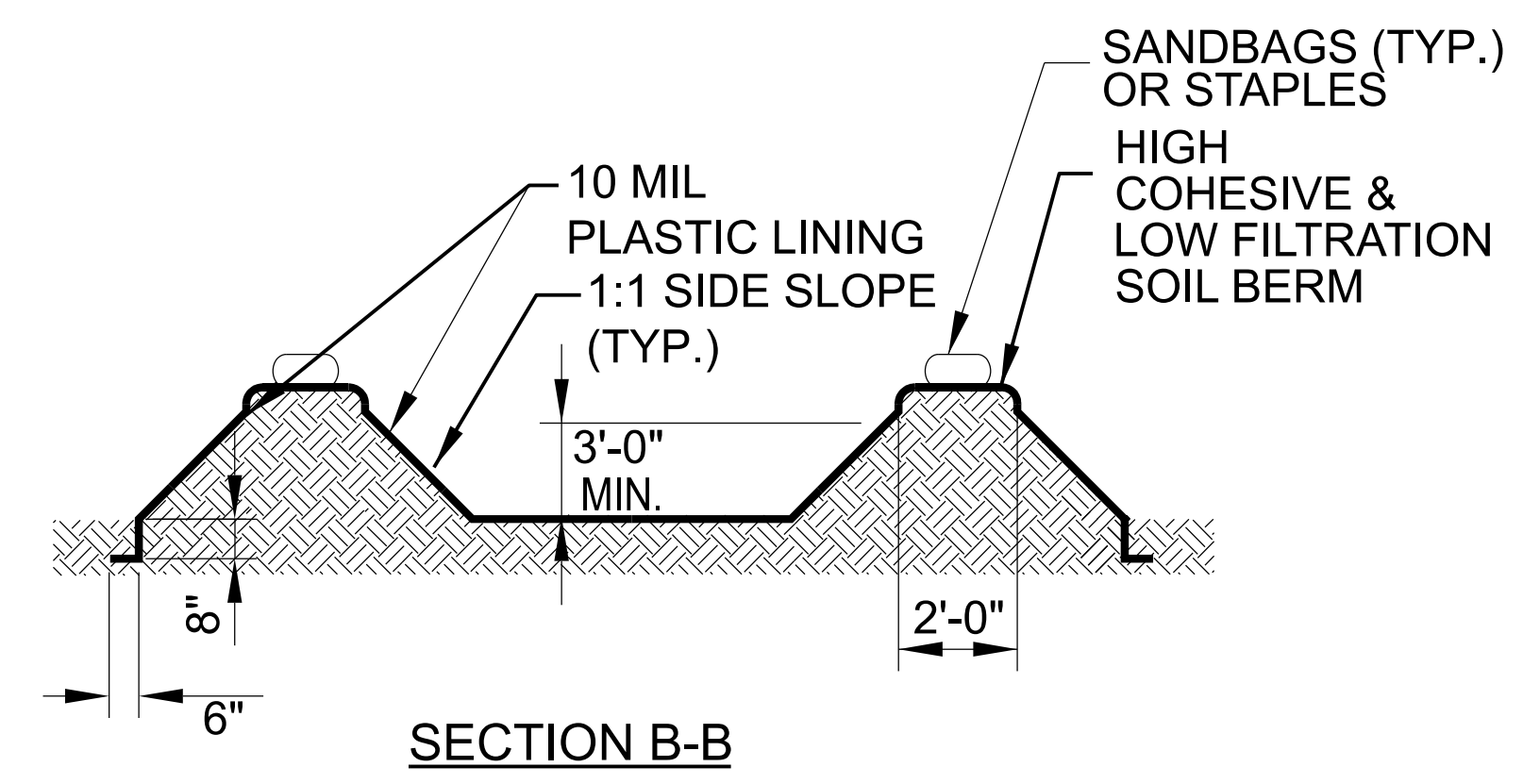
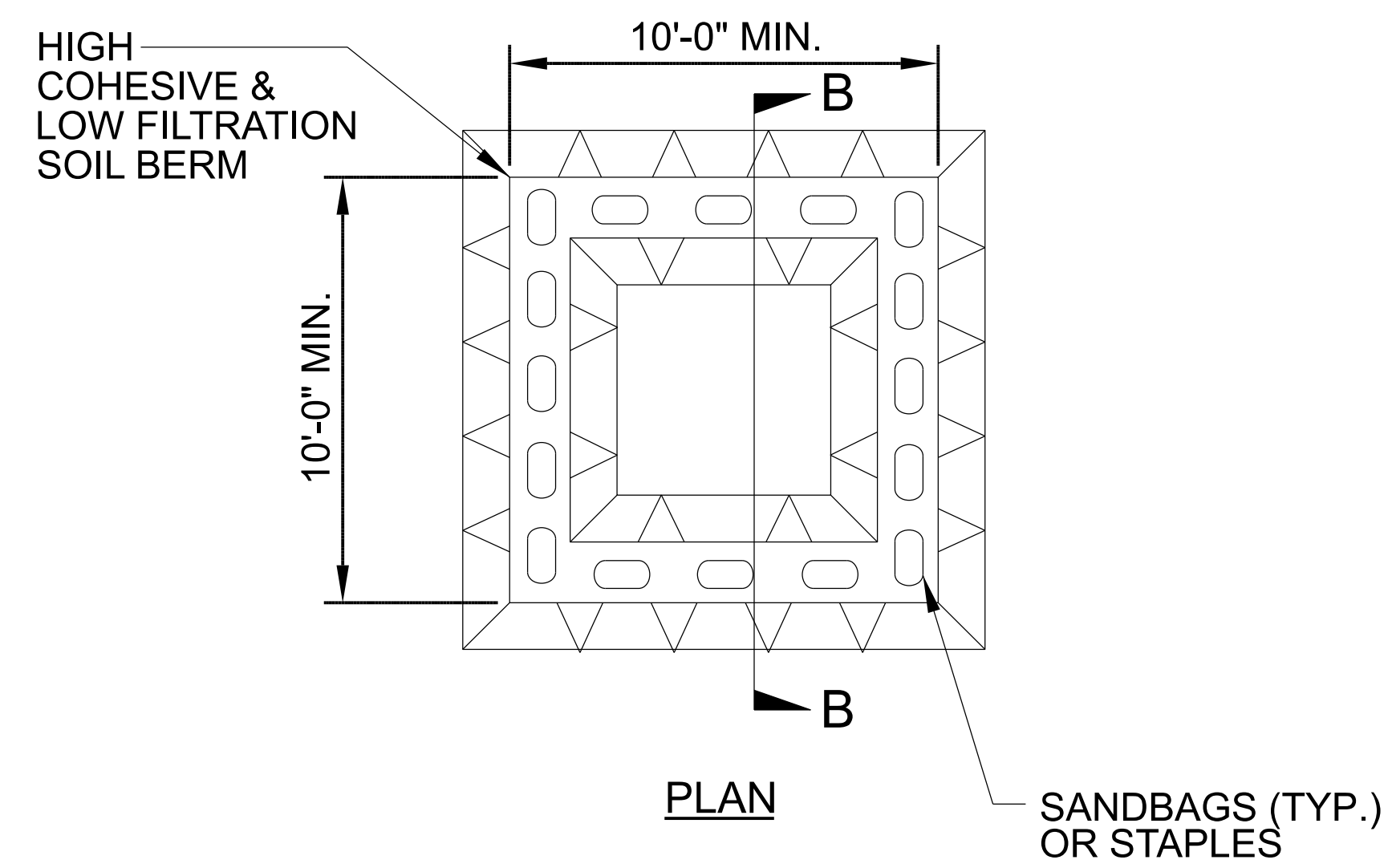

**ABOVE GRADE WASHOUT STRUCTURE**  
NOT TO SCALE

- NOTES:**
1. ACTUAL LOCATION DETERMINED IN FIELD
  2. THE CONCRETE WASHOUT STRUCTURES SHALL BE MAINTAINED WHEN THE LIQUID AND/OR SOLID REACHES 75% OF THE STRUCTURES CAPACITY TO PROVIDE ADEQUATE HOLDING CAPACITY WITH A MINIMUM 12 INCHES OF FREEBOARD.
  3. CONCRETE WASHOUT STRUCTURE NEEDS TO BE CLEARLY MARKED WITH SIGNAGE NOTING DEVICE.



DIVISION OF HIGHWAYS  
STATE OF NORTH CAROLINA

---



---

PROJECT REFERENCE NO.	SHEET NO.
BR-0093	EC-3A
ROADWAY DESIGN ENGINEER	HYDRAULICS ENGINEER

# SOIL STABILIZATION TIMEFRAMES

<i>SITE DESCRIPTION</i>	<i>STABILIZATION TIME</i>	<i>TIMEFRAME EXCEPTIONS</i>
PERIMETER DIKES, SWALES, DITCHES AND SLOPES	7 DAYS	NONE
HIGH QUALITY WATER (HQW) ZONES	7 DAYS	NONE
SLOPES STEEPER THAN 3:1	7 DAYS	IF SLOPES ARE 10' OR LESS IN LENGTH AND ARE NOT STEEPER THAN 2:1, 14 DAYS ARE ALLOWED.
SLOPES 3:1 TO 4:1	14 DAYS	7 DAYS FOR SLOPES GREATER THAN 50' IN LENGTH WITH SLOPES STEEPER THAN 4:1. 7 DAYS FOR PERIMETER DIKES, SWALES, DITCHES PERIMETER SLOPES, AND HQW ZONES
ALL OTHER AREAS WITH SLOPES FLATTER THAN 4:1	14 DAYS	7 DAYS FOR PERIMETER DIKES, SWALES, DITCHES PERIMETER SLOPES, AND HQW ZONES

NOTE:  
 PLACE TEMPORARY ROCK SEDIMENT DAMS TYPE - B  
 AND TEMPORARY ROCK SILT CHECKS TYPE - A AT  
 DRAINAGE OUTLETS.

21 x 10 x 3  
 1.5 inch Skimmer  
 with 0.25 inch  
 Orifice Diameter  
 4 ft. weir  
 ID 4.3

34 x 33 x 3  
 1.5 inch Skimmer  
 with 0.875 inch  
 Orifice Diameter  
 4 ft. weir  
 ID 4.1

39 x 14 x 3  
 1.5 inch Skimmer  
 with 0.5 inch  
 Orifice Diameter  
 4 ft. weir  
 ID 4.2

Temporary Rock  
 Sediment  
 Dam Type A  
 2.5 ft. weir height

CLEARING AND GRUBBING  
 EROSION CONTROL FOR  
 CONSTRUCTION SHEET 4

NOTE:  
 UTILIZE TEMPORARY SEDIMENT BASIN OR SPECIAL STILLING  
 BASIN(S) AS STILLING BASIN WHERE APPLICABLE.

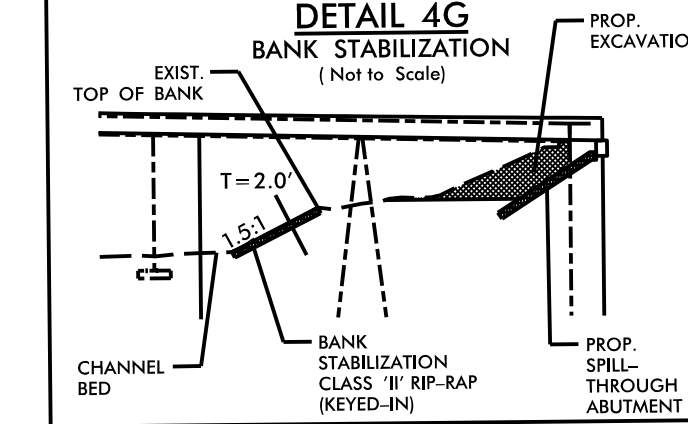
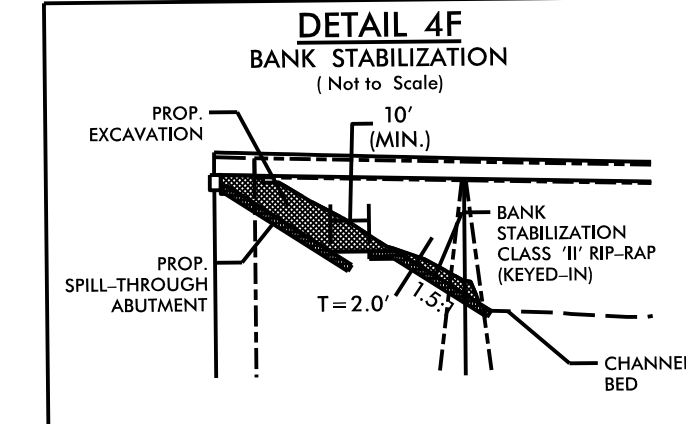
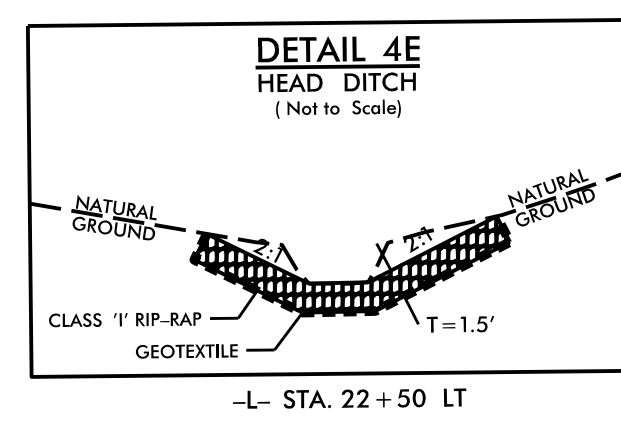
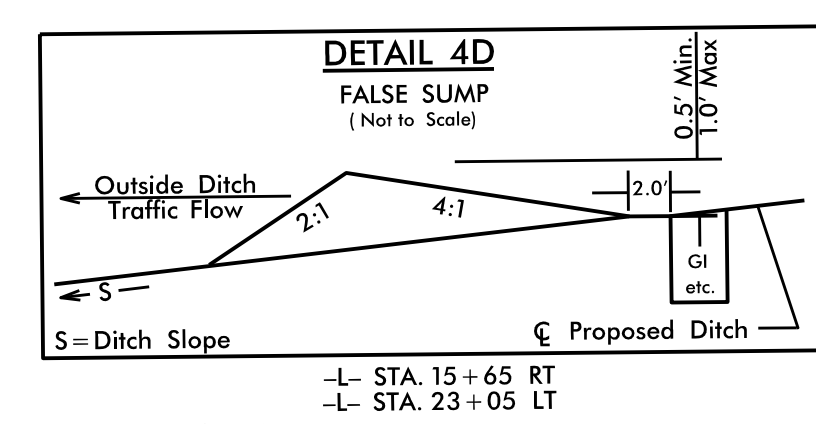
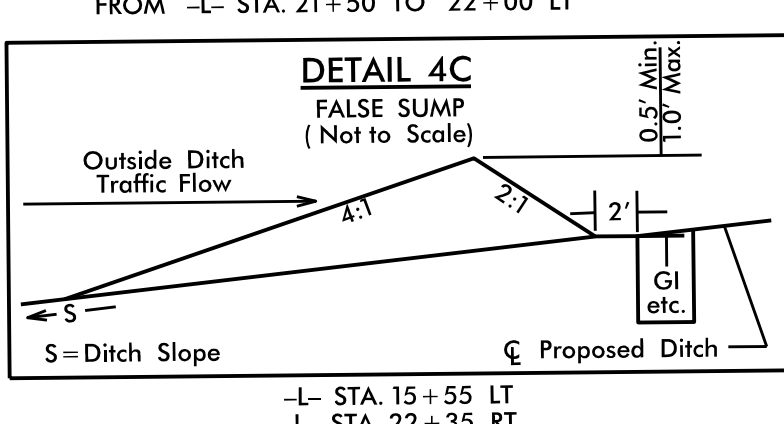
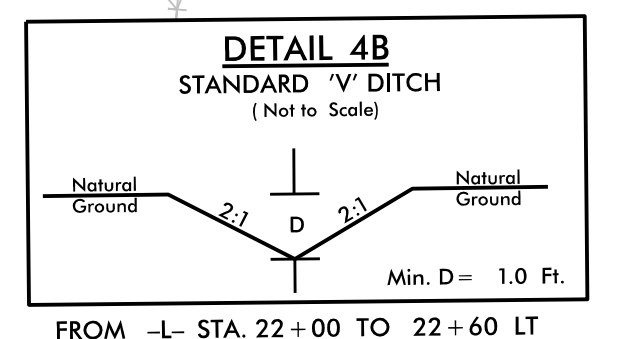
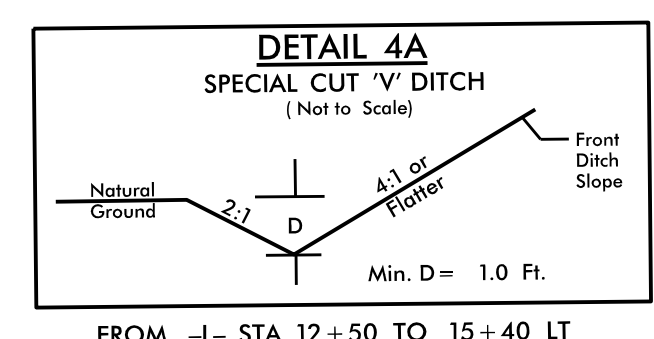
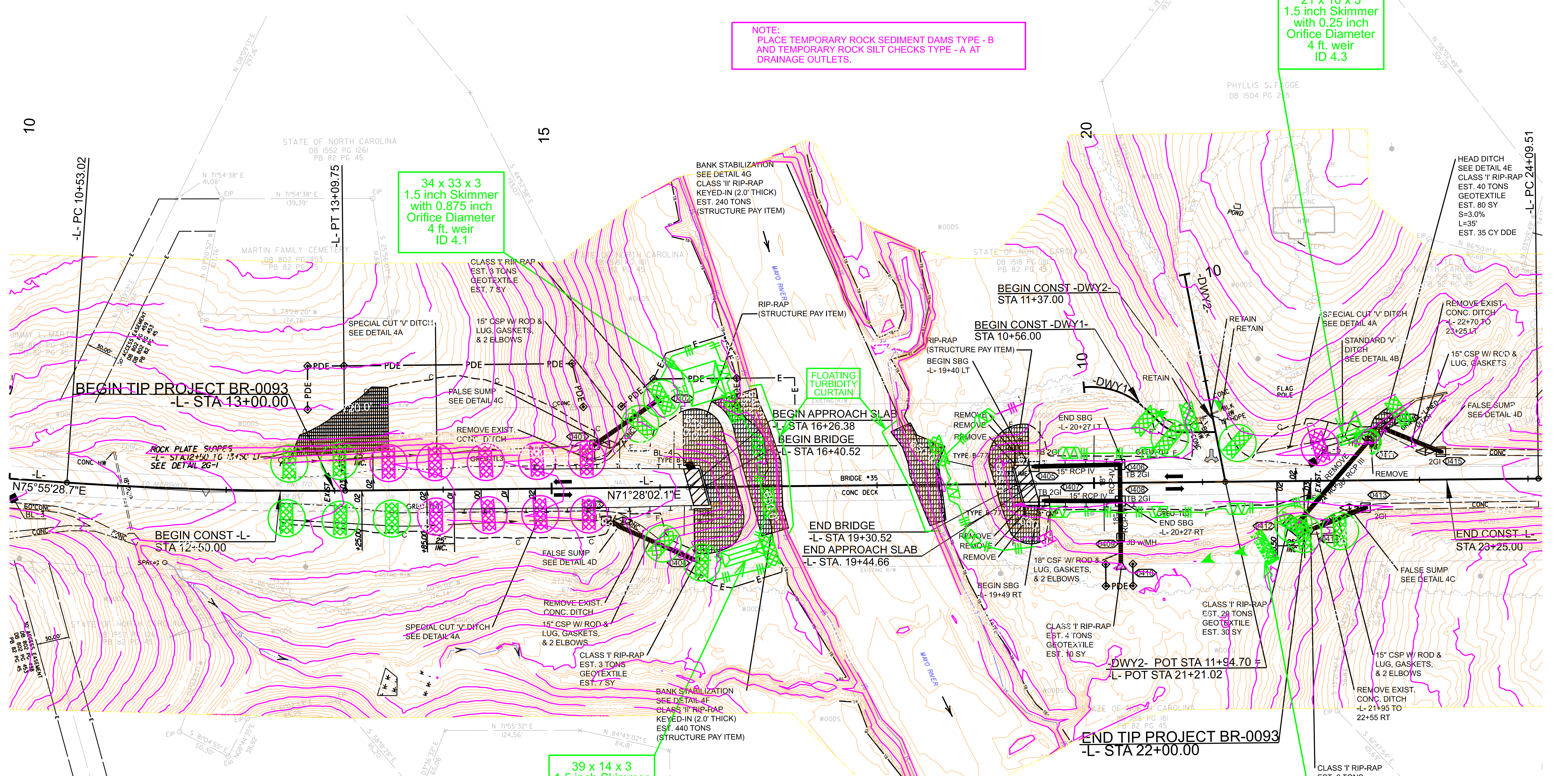

REVISIONS

For Slopes Excavated Greater Than 10 feet  
 Install Matting for Erosion Control on  
 Entire Slope as Work Allows.

Note: Reforestation provided for revegetation of areas  
 after basin removal as needed and as directed by the engineer.

21 x 10 x 3  
 1.5 inch Skimmer  
 with 0.25 inch  
 Orifice Diameter  
 4 ft. weir  
 ID 4.3

34 x 33 x 3  
 1.5 inch Skimmer  
 with 0.875 inch  
 Orifice Diameter  
 4 ft. weir  
 ID 4.1

39 x 14 x 3  
 1.5 inch Skimmer  
 with 0.5 inch  
 Orifice Diameter  
 4 ft. weir  
 ID 4.2

Temporary Rock  
 Sediment  
 Dam Type A  
 2.5 ft. weir height

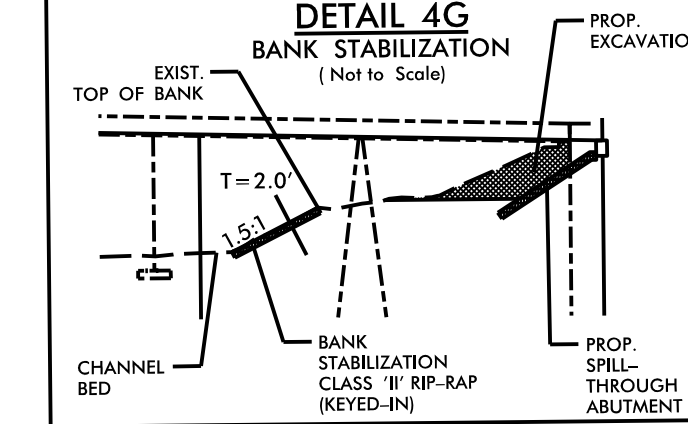
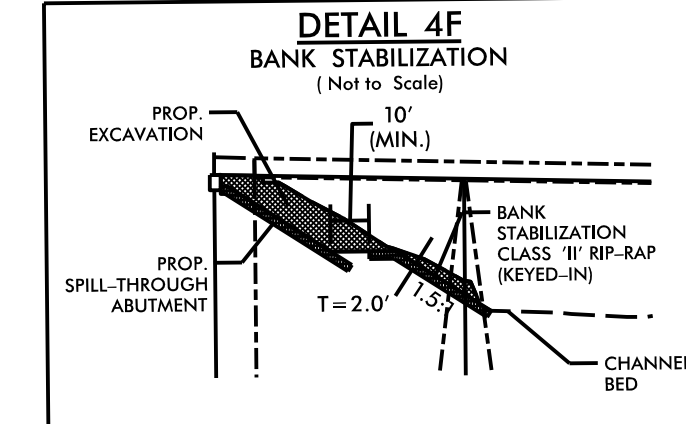
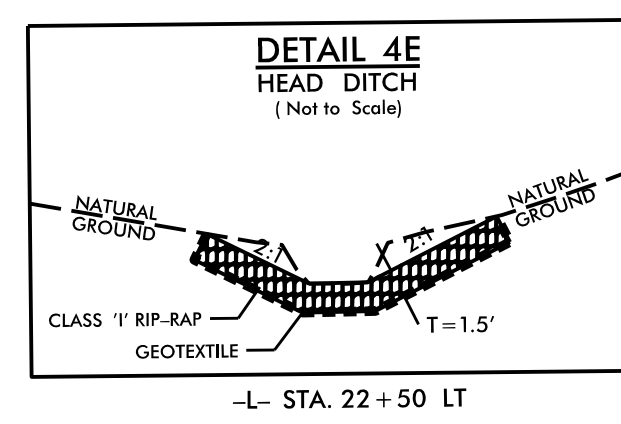
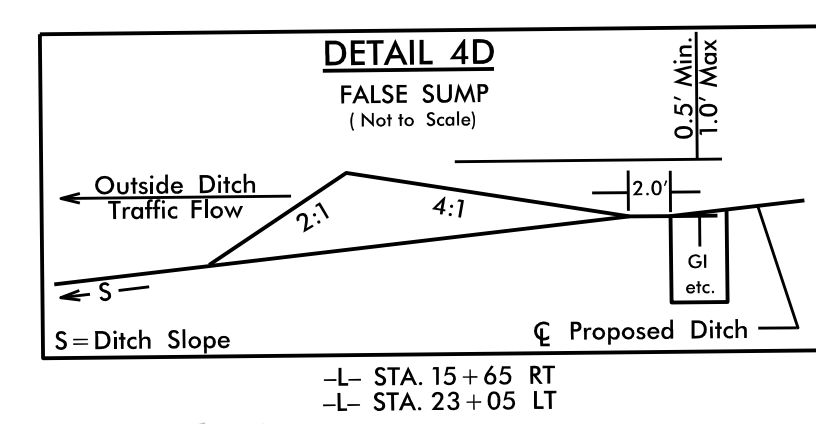
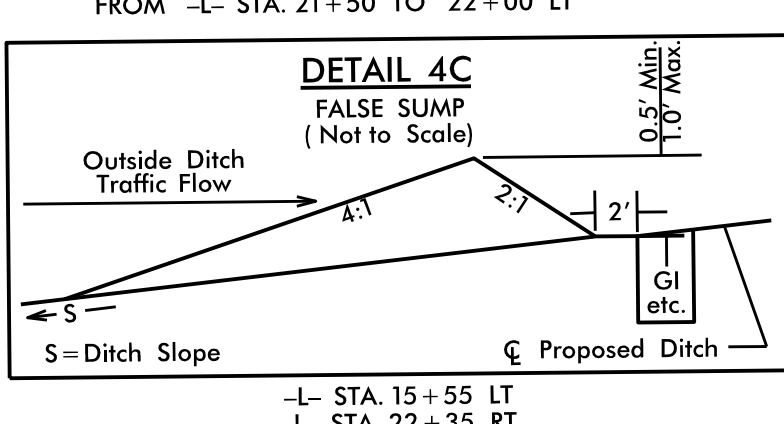
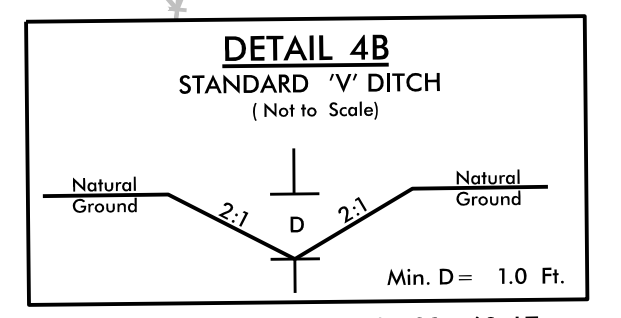
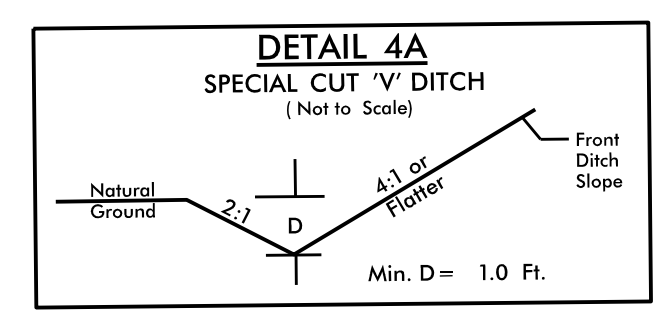
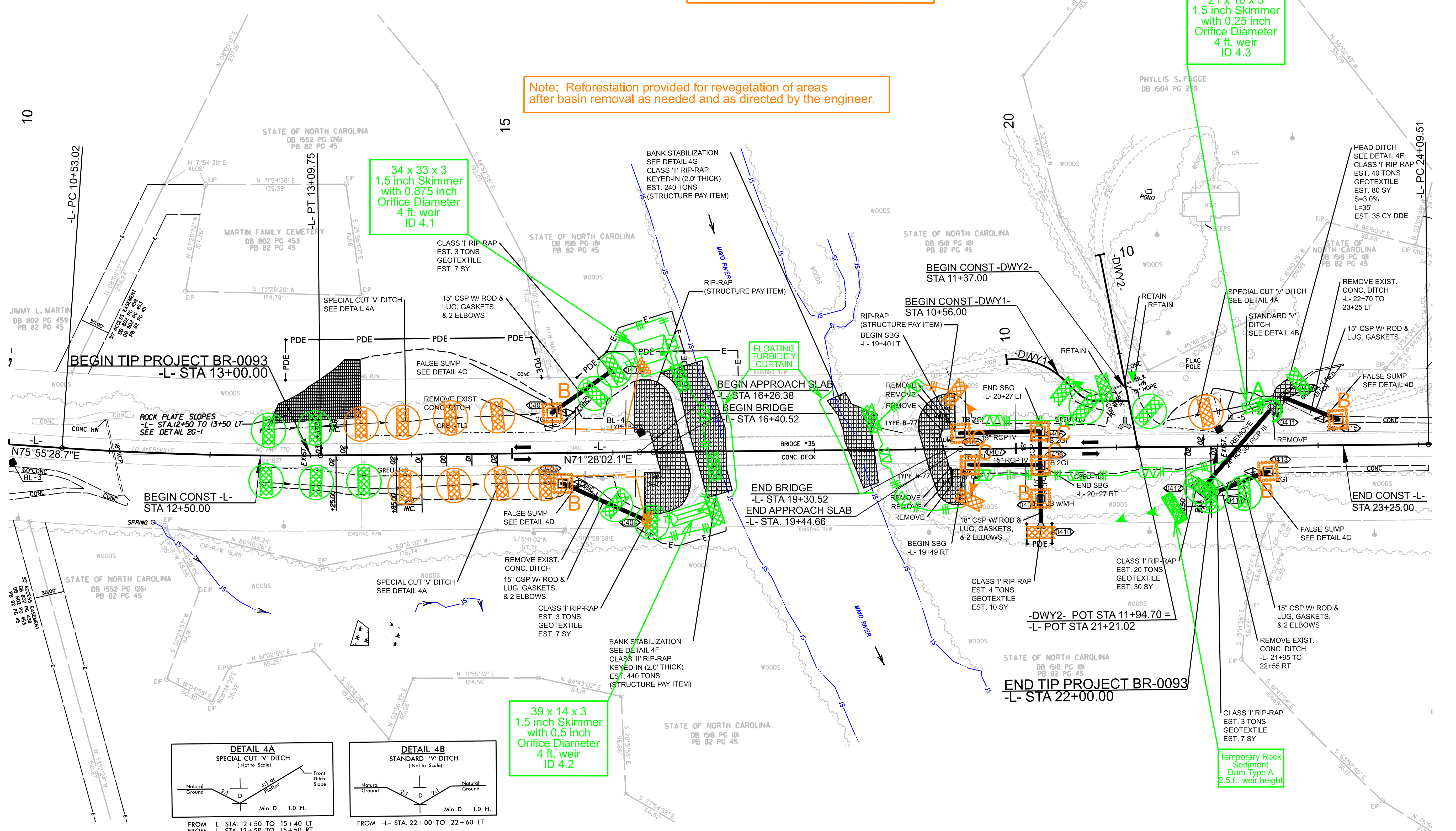

NOTE:  
 UTILIZE TEMPORARY SEDIMENT BASIN OR SPECIAL STILLING  
 BASIN(S) AS STILLING BASIN WHERE APPLICABLE.

REVISIONS