

△ SEE SHEET 1 OF 2 FOR NOTES

TYPICAL SECTION
(SHOWING INTEGRAL END BENT DIAPHRAGM)

- INDICATES NON-CONTINUOUS REINFORCING STEEL OVER END BENTS.
- INDICATES CONTINUOUS REINFORCING STEEL FROM END BENT 1 TO END BENT 2.

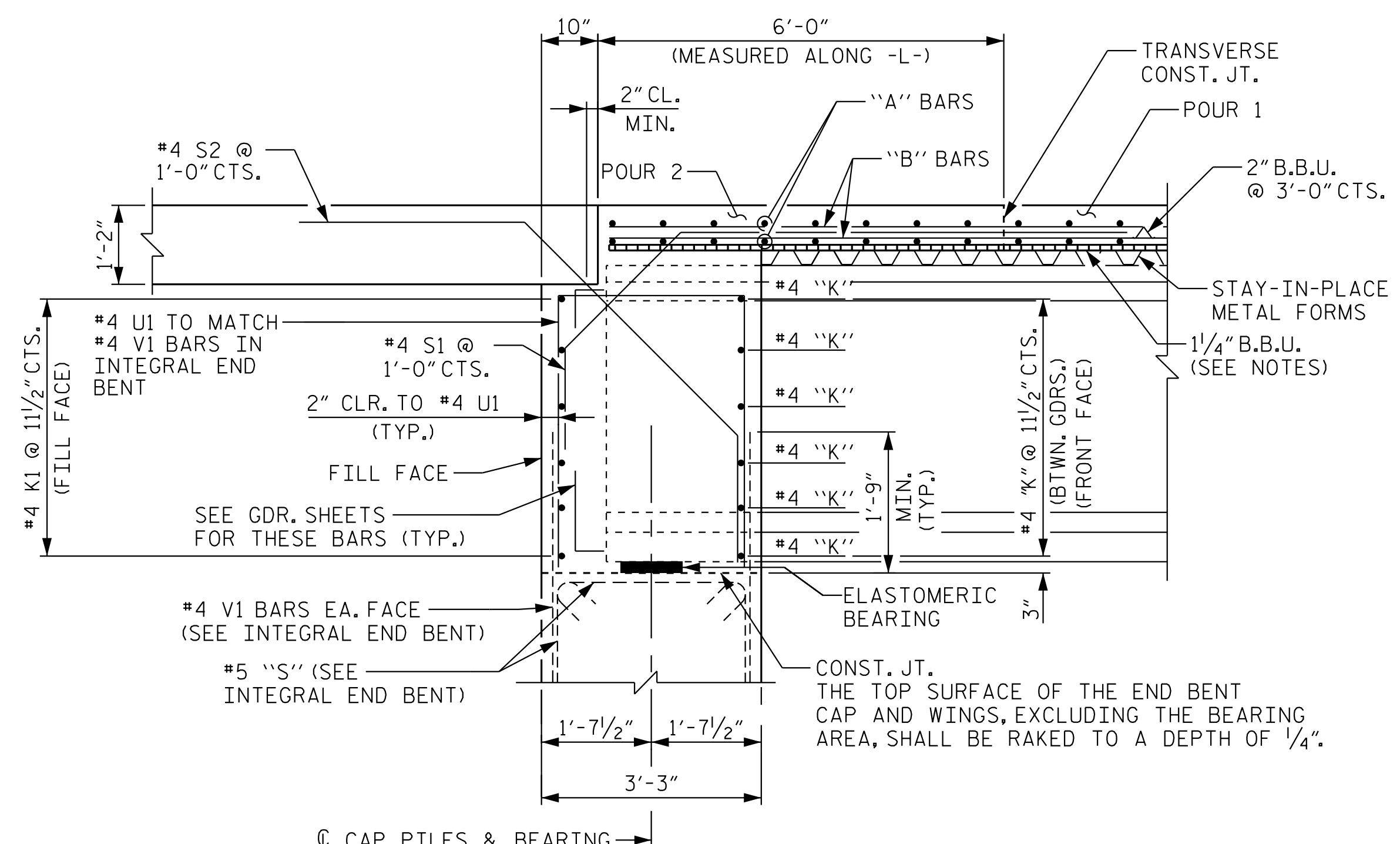

SECTION THRU INTEGRAL END BENT
(END BENT 1 SHOWN, END BENT 2 SIMILAR)

PROJECT NO. U-5108
MECKLENBURG COUNTY
 STATION: 74+01.00 -L-

SHEET 2 OF 2

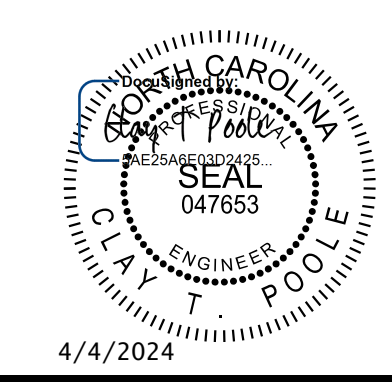

Kimley»Horn
 421 Fayetteville Street, Suite 600
 Raleigh, NC 27601-1772
 Phone (919) 677-2000
 NC LICENSE # F-0102

STATE OF NORTH CAROLINA					
DEPARTMENT OF TRANSPORTATION					
RALEIGH					
SUPERSTRUCTURE					
TYPICAL SECTION					
REVISIONS					
NO.	BY:	DATE:	NO.	BY:	DATE:
1			3		
2			4		

SHEET NO.		S-7
TOTAL SHEETS		33

DRAWN BY: J. I. KIMBLE DATE: 10/2023
 CHECKED BY: T. H. ORR DATE: 10/2023
 DESIGN ENGINEER OF RECORD: C. T. POOLE DATE: 10/2023

DOCUMENT NOT CONSIDERED FINAL
UNLESS ALL SIGNATURES COMPLETED

This document, together with the concepts and designs presented herein, is an integral part of the project. It is not to be used for any other project without written authorization and approval by Kimley-Horn and Associates, Inc. It shall be without liability to Kimley-Horn and Associates, Inc. Copyright Kimley-Horn and Associates, Inc. 2024

K:\BIDI-Structures\Bridges\NC\01036359 - U-5108\Cad\Drawings\08_SMU_152_591403.dgn 2/28/2024