

CLEARING AND GRUBBING
EROSION CONTROL FOR
CONSTRUCTION SHEET 9

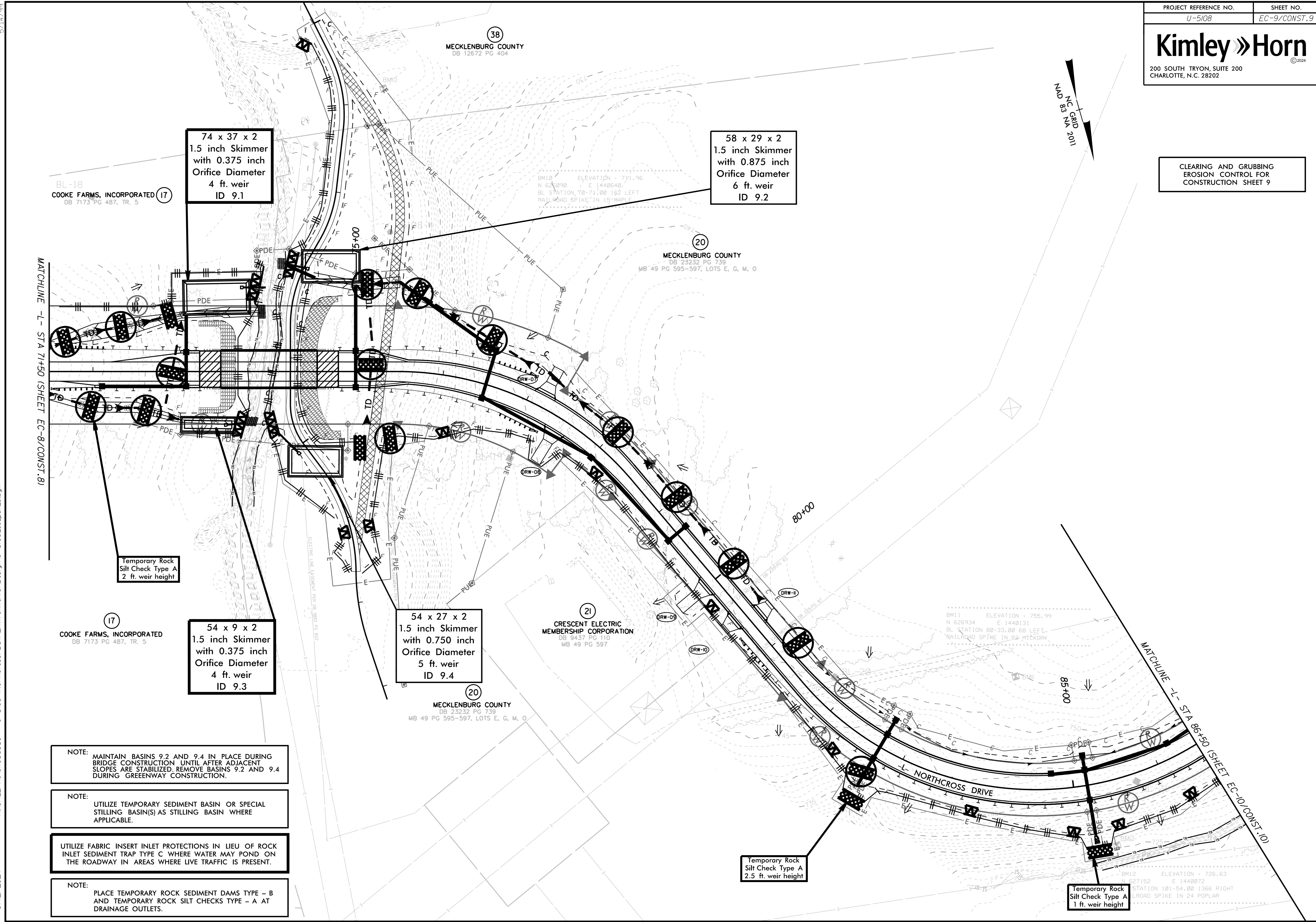

74 x 37 x 2
1.5 inch Skimmer
with 0.375 inch
Orifice Diameter
4 ft. weir
ID 9.1

58 x 29 x 2
1.5 inch Skimmer
with 0.875 inch
Orifice Diameter
6 ft. weir
ID 9.2

Temporary Rock
Silt Check Type A
2 ft. weir height

54 x 9 x 2
1.5 inch Skimmer
with 0.375 inch
Orifice Diameter
4 ft. weir
ID 9.3

54 x 27 x 2
1.5 inch Skimmer
with 0.750 inch
Orifice Diameter
5 ft. weir
ID 9.4

Temporary Rock
Silt Check Type A
2.5 ft. weir height

Temporary Rock
Silt Check Type A
1 ft. weir height

NOTE: MAINTAIN BASINS 9.2 AND 9.4 IN PLACE DURING BRIDGE CONSTRUCTION UNTIL AFTER ADJACENT SLOPES ARE STABILIZED. REMOVE BASINS 9.2 AND 9.4 DURING GREENWAY CONSTRUCTION.

NOTE: UTILIZE TEMPORARY SEDIMENT BASIN OR SPECIAL STILLING BASIN(S) AS STILLING BASIN WHERE APPLICABLE.

UTILIZE FABRIC INSERT INLET PROTECTIONS IN LIEU OF ROCK INLET SEDIMENT TRAP TYPE C WHERE WATER MAY POND ON THE ROADWAY IN AREAS WHERE LIVE TRAFFIC IS PRESENT.

NOTE: PLACE TEMPORARY ROCK SEDIMENT DAMS TYPE - B AND TEMPORARY ROCK SILT CHECKS TYPE - A AT DRAINAGE OUTLETS.

5/14/99
K:\CHL_PR\01036359 - U-5108 (Northcross)\DS\Environmental\Design\U-5108.ec_psh_9.dgn
3/12/2024