

1 1/2" Ø FORMED HOLE. SEE (SHEET 4 OF 4) FOR LOCATION.

**DEBONDING LEGEND**  
 • FULLY BONDED STRANDS

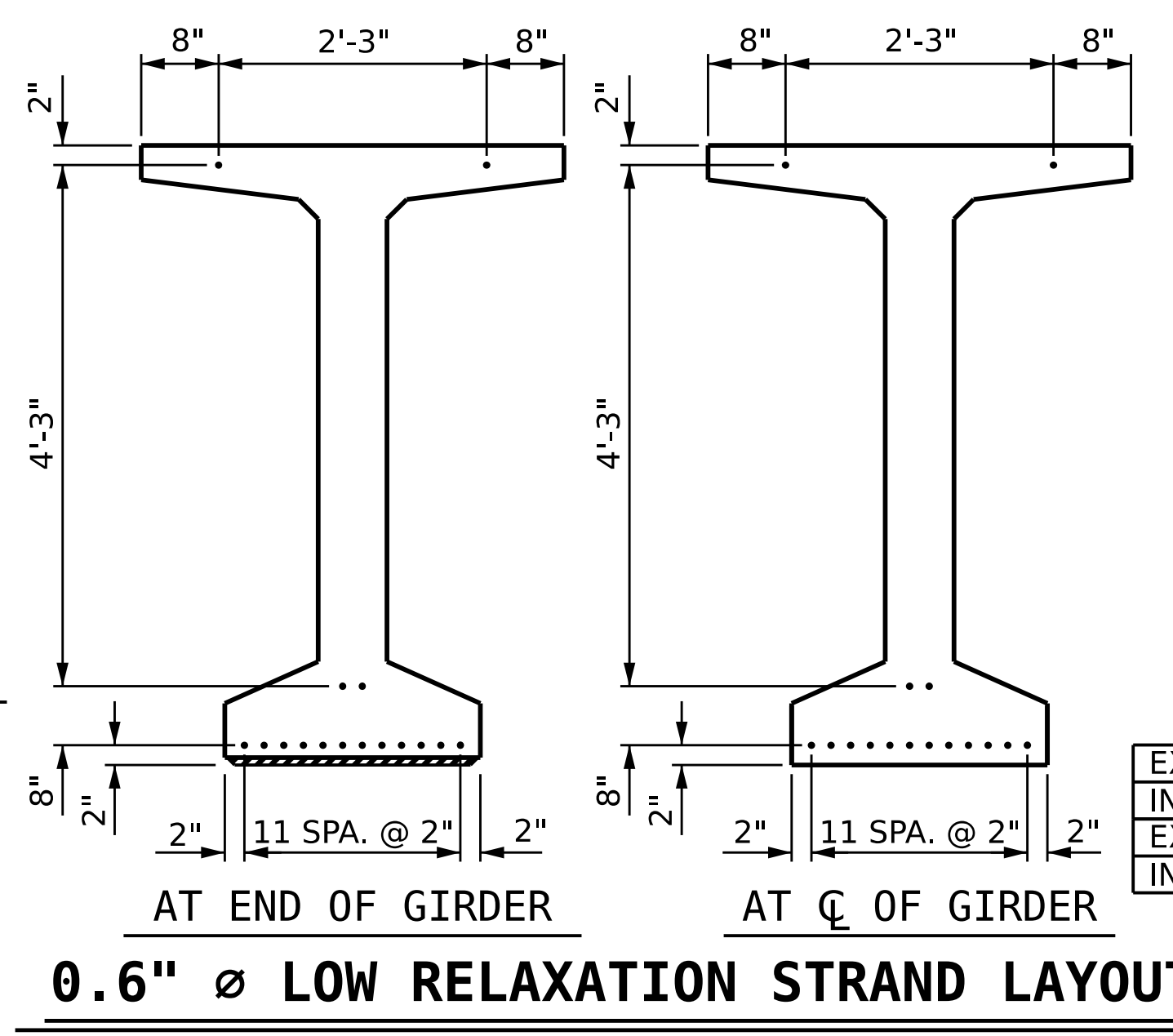

0.6" Ø L.R. GRADE 270 STRANDS		
AREA (SQ. INCHES)	ULTIMATE STRENGTH (LBS. PER STRAND)	APPLIED PRESTRESS (LBS. PER STRAND)
0.217	58,600	43,950

REINFORCING STEEL FOR ONE GDR					
BAR NUMBER	SIZE	TYPE	LENGTH	WEIGHT	
S1	#4		6'-2"	404	
S2	#5		6'-2"	116	
S3	#4		8'-5"	67	
S4	#4		3'-0"	152	
S5	#5		9'-10"	21	
S6	#5		4'-5"	534	
S8	#5		9'-0"	19	
S9	#5	STR	3'-3"	92	
EXTERIOR S11	#5		10'-0"	146	
INTERIOR S11	#5		10'-0"	188	
EXTERIOR S12	#4	STR	8'-0"	43	
INTERIOR S13	#4	STR	19'-11"	106	

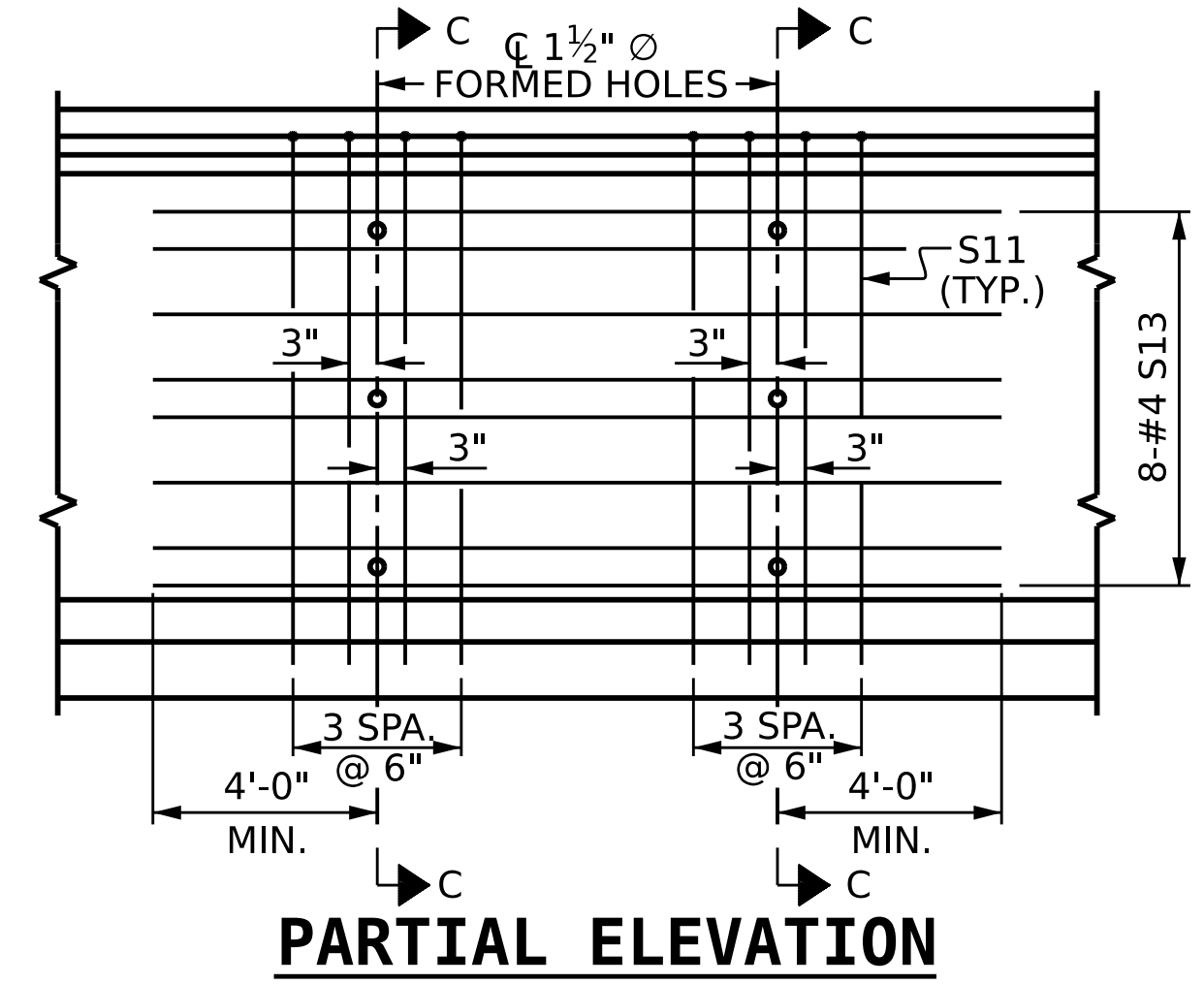
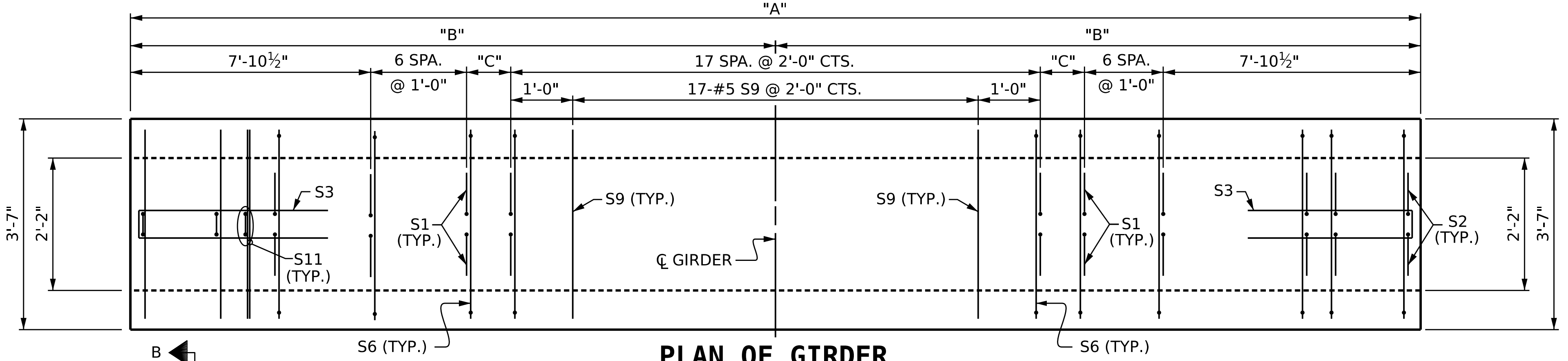
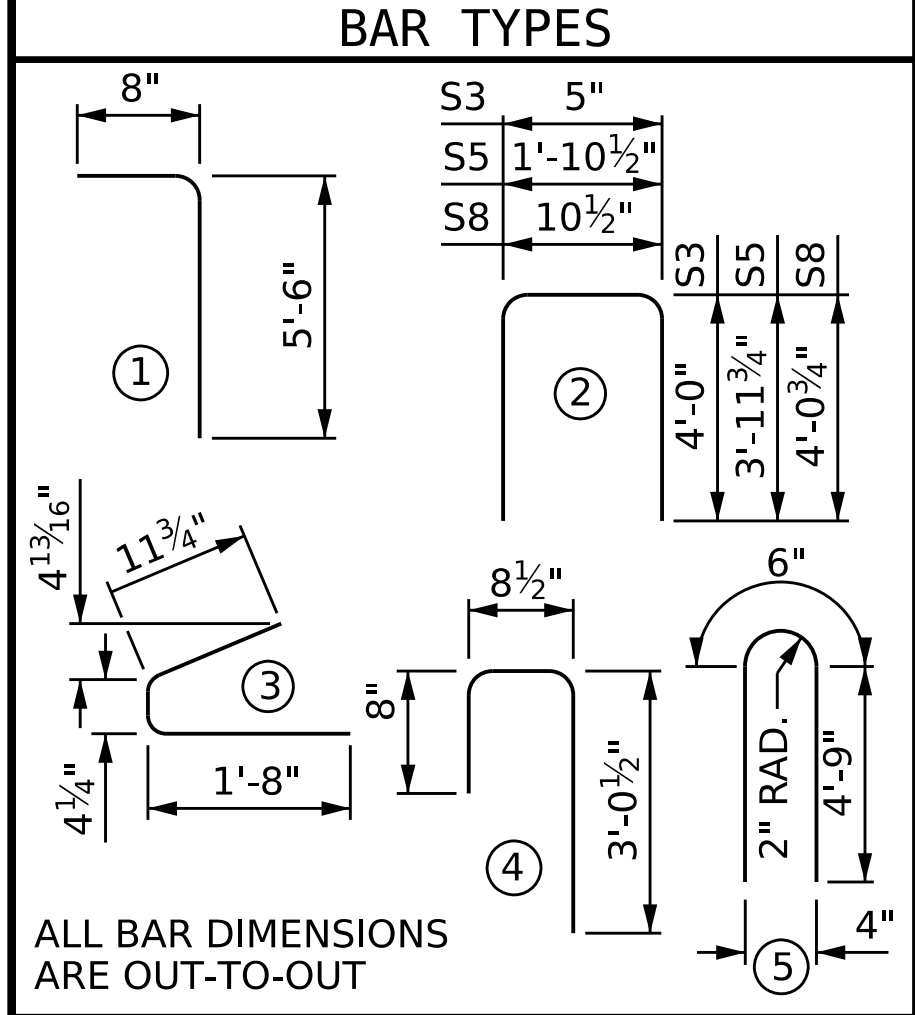

QUANTITIES FOR ONE GIRDER			
GIRDERS	REINFORCING STEEL	6000 PSI CONCRETE	0.6" Ø L.R. STRANDS
	LB.	C.Y.	No.
INTERIOR	1,699	*	16
EXTERIOR	1,594	*	16

GIRDERS REQUIRED		
NUMBER	LENGTH	TOTAL LENGTH
4	VARIES	251.67

\* SEE "GIRDER DIMENSION" TABLE ON SHEET 4 OF 4.

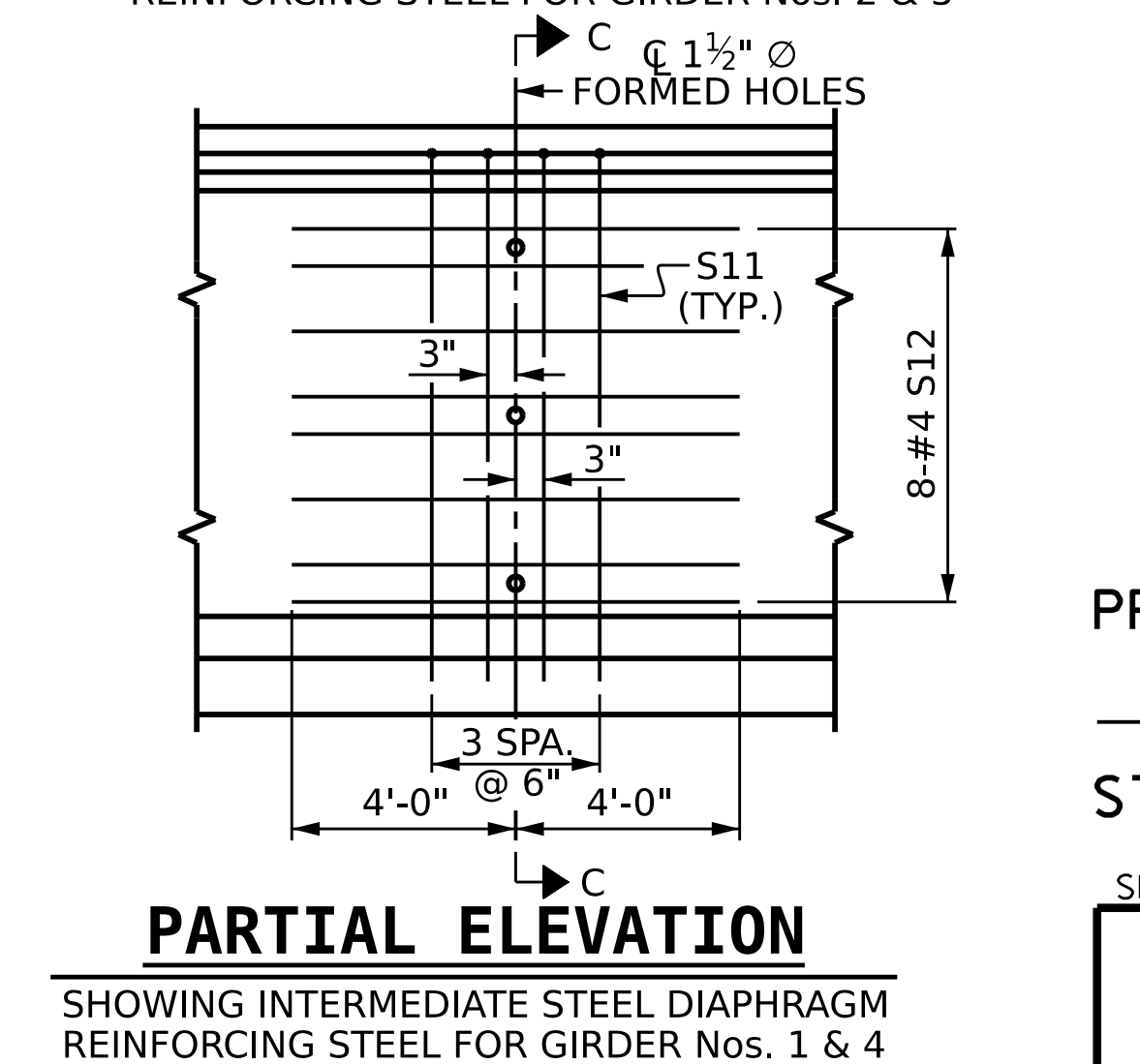
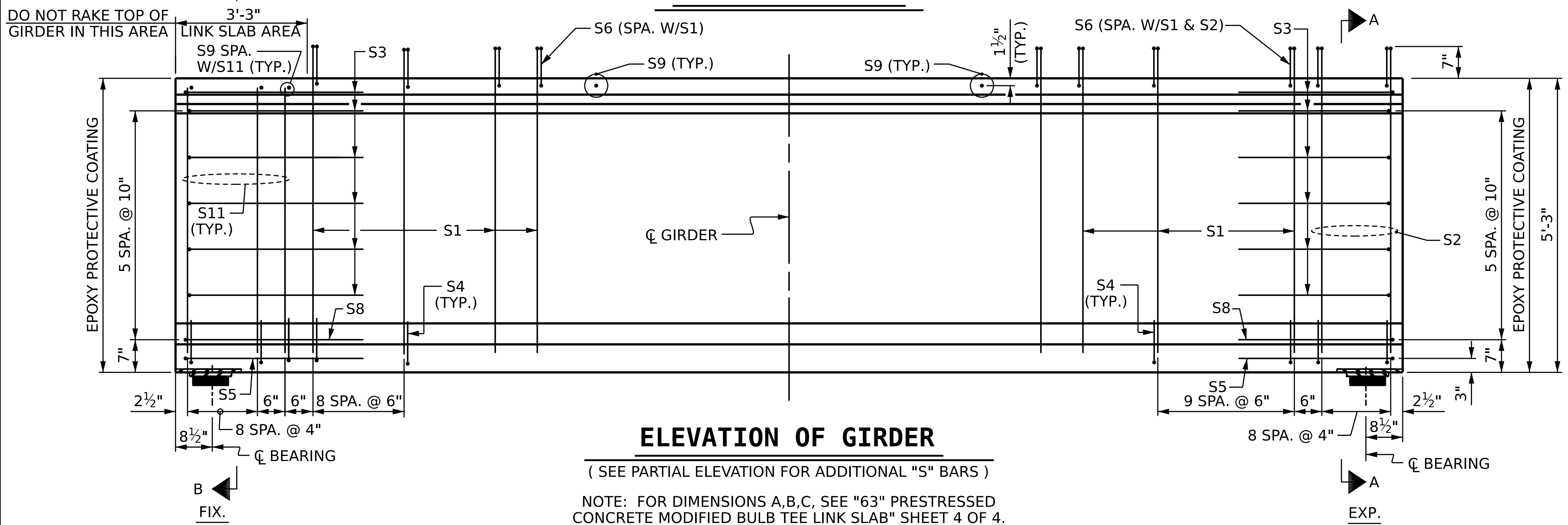

PROJECT NO. I-2513AA/AB  
 BUNCOMBE COUNTY  
 STATION: 20+16.70 -Y5RPA-

SHEET 3 OF 4

STATE OF NORTH CAROLINA  
 DEPARTMENT OF TRANSPORTATION  
 RALEIGH  
 SUPERSTRUCTURE

**63" PRESTRESSED CONCRETE MODIFIED BULB TEE**

SPAN C



DRAWN BY : S.D. COOPER      DATE : 12-23  
 CHECKED BY : M.A. AVERETTE      DATE : 12-23  
 DESIGN ENGINEER OF RECORD: M.A. AVERETTE      DATE : 12-23

REVISIONS					
NO.	BY:	DATE:	NO.	BY:	DATE:
1			3		
2			4		

DOCUMENT NOT CONSIDERED FINAL UNLESS ALL SIGNATURES COMPLETED

12/21/2023 1:48:29 PM c:\pwworking\cecom\_ds21\_na\_2020\d0252774\I2513AA\_SMU\_G3\_100902.dgn