

EXISTING CCTV-22 GPS COORDINATES
35.559515° N
82.638694° W

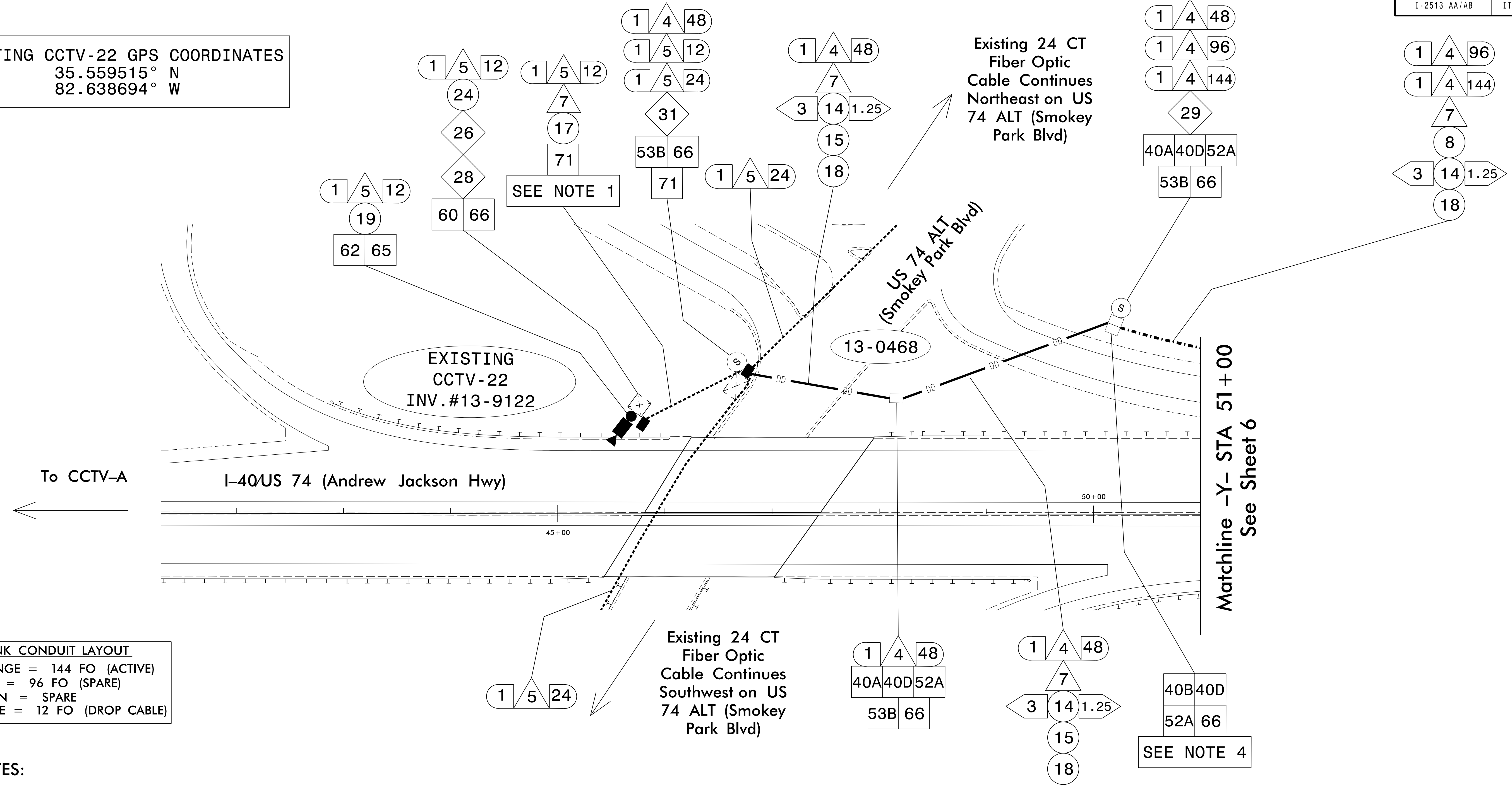

TRUNK CONDUIT LAYOUT
ORANGE = 144 FO (ACTIVE)
BLUE = 96 FO (SPARE)
GREEN = SPARE
WHITE = 12 FO (DROP CABLE)

- NOTES:
1. BACKPULL EXISTING DROP CABLE AND REROUTE TO THE NEW SPLICE ENCLOSURE AS SHOWN.
 2. USE 144 FIBER IN ORANGE DUCT FOR ALL DEVICES ON THIS PROJECT.
 3. MAINTAIN CAMERA FUNCTIONALITY THROUGHOUT THE LIFE OF THE PROJECT.
 4. WHEN SPLITTING CONDUIT BUNDLES ROUTE BLUE AND ORANGE CONDUITS INTO ITS JUNCTION BOX AND ROUTE GREEN CONDUIT INTO COMMERCIALIZATION JUNCTION BOX.

1/19/2024 10:44:00 AM C:\Users\paw_bentl\ey-com\AECOM\B21_NA_2020\Documents\60646756-1-2513AA\00-CAD_0154910-CAD\70-NC001-TIP\Invel\igen\Transportation Systems\AA_AB\I-2513AA_AB_ITS_PS1005.dgn T:\ndm

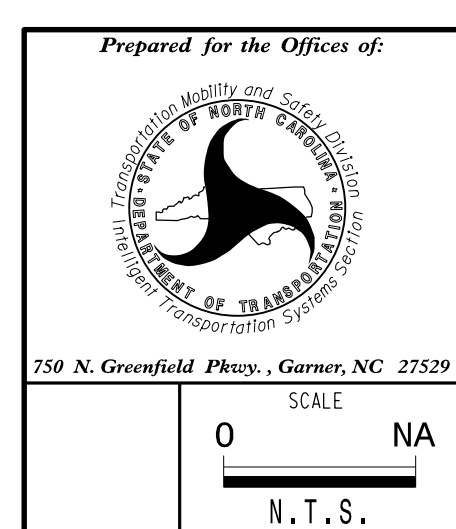

ITS Communication Cable and Conduit Routing Plans

DIVISION 13 BUNCOMBE CO. ASHEVILLE

PLAN DATE: January 2024 REVIEWED BY: M. Cavanaugh

PREPARED BY: M. Tindal REVIEWED BY: R. Garrett

REVISIONS	INIT.	DATE

DocuSigned by:
Rachelle Garrett 1/19/2024

DOCUMENT NOT CONSIDERED FINAL UNLESS ALL SIGNATURES COMPLETED