

NOTES

DESIGN DATA:

SPECIFICATIONS ----- A.A.S.H.T.O. (CURRENT)

MATERIAL AND WORKMANSHIP:

EXCEPT AS MAY OTHERWISE BE SPECIFIED ON PLANS OR IN THE SPECIAL PROVISIONS, ALL MATERIAL AND WORKMANSHIP SHALL BE IN ACCORDANCE WITH THE 2018 "STANDARD SPECIFICATIONS FOR ROADS AND STRUCTURES" OF THE N.C. DEPARTMENT OF TRANSPORTATION.

ALL CONCRETE SHALL BE CLASS A; f'c = 3000 psi

CONCRETE CHAMFERS:

UNLESS OTHERWISE NOTED ON THE PLANS, ALL EXPOSED CORNERS ON STRUCTURES SHALL BE CHAMFERED 3/4".

REINFORCED STEEL:

ALL REINFORCING STEEL SHALL BE DEFORMED. DIMENSIONS RELATIVE TO PLACEMENT OF REINFORCING ARE TO CENTERS OF BARS UNLESS OTHERWISE INDICATED IN THE PLANS. DIMENSIONS ON BAR DETAILS ARE TO CENTERS OF BARS OR ARE OUT TO OUT AS INDICATED ON PLANS.

WIRE BAR SUPPORTS SHALL BE PROVIDED FOR REINFORCING STEEL WHERE INDICATED ON THE PLANS. WHEN BAR SUPPORT PIECES ARE PLACED IN CONTINUOUS LINES, THEY SHALL BE SO PLACED THAT THE ENDS OF THE SUPPORTING WIRES SHALL BE LAPPED TO LOCK LEGS ON ADJOINING PIECES.

REMOVAL NOTES

1) THE CONTRACTOR SHALL TAKE ALL NECESSARY MEASURES TO PROTECT THE EXISTING STRUCTURE DURING THE REMOVAL OF THE 1'-0" PORTION OF THE EXISTING CONCRETE HEADWALL. PHASE OF THE PROJECT, THE CONTRACTOR SHALL BE RESPONSIBLE FOR ANY DAMAGE TO THE EXISTING CONCRETE HEADWALL AND CORRUGATED METAL PIPES DURING THE REMOVAL. CONSTRUCTION OF THE STRUCTURE SHALL BE THE CONTRACTORS RESPONSIBILITY, AT NO ADDITIONAL COST TO THE PROJECT.

2) THE CONTRACTOR SHALL SUBMIT A WORK PLAN FOR REVIEW AND APPROVAL BY THE ENGINEER ON THE EQUIPMENT AND PROCEDURES TO BE USED FOR REMOVAL OF PORTION OF EXISTING CONCRETE HEADWALL, PRIOR TO THE COMMENCEMENT OF THE REMOVAL OPERATION.

3) THE COST OF MATERIALS AND LABOR NECESSARY TO REMOVE THE 1'-0" PORTION OF THE EXISTING CONCRETE HEADWALL SHALL BE INCIDENTAL TO THE COST OF THE CONCRETE HEADWALL EXTENSION AND NO SEPERATE PAYMENT SHALL BE MADE.

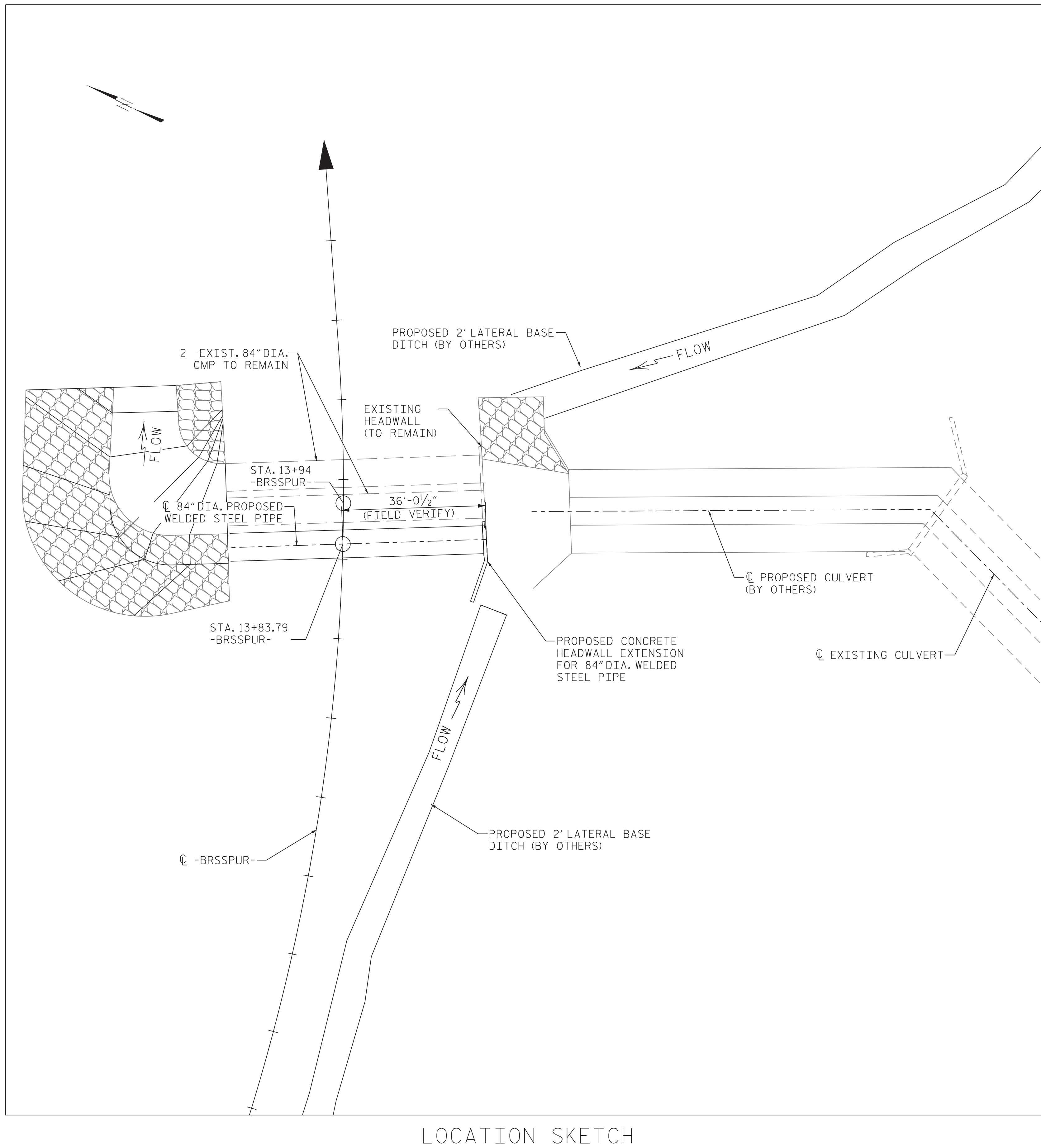

LOCATION SKETCH

PROJECT NO. I-2513 AA/AB
BUNCOMBE COUNTY
 STATION: 13+94-BRSSPUR-

ENGINEER OF RECORD

DocuSigned by:
Juan D. Mosquera
 2/8/2024
 ETHERILL
 5DC8F08E8AE54F2, INEERING

15801 Brixham Hill Ave, Suite 530
 Charlotte, N.C. 28277
 Bus: 704 919 1880
 Fax: 919 851 8107
 LICENSE NO. F-0377

STATE OF NORTH CAROLINA
 DEPARTMENT OF TRANSPORTATION
 RALEIGH

RENFORCED CONCRETE HEADWALL EXTENSION FOR 84" DIA. WELDED STEEL PIPE

REVISIONS						SHEET NO.
NO.	BY:	DATE:	NO.	BY:	DATE:	2D-9
1			3			TOTAL SHEETS
2			4			2

DRAWN BY : B. GONZALEZ DATE : 9-5-2023
 CHECKED BY : D. MOSQUERA DATE : 9-5-2023

P:\2023\121328\09_I-2513A\Structures\DWG\Pipe Headwall\I-2513AA_General Layout_2C-3.dgn
 1/23/2024 11:03:24 AM