

6/2/2024

PROJECT REFERENCE NO. 1-2513AA/AB	SHEET NO. 2A-5
ROADWAY DESIGN ENGINEER Barry Smith 2/8/2024	PAVEMENT DESIGN ENGINEER Joseph T. Holladay 8/2024
DOCUMENT NOT CONSIDERED FINAL UNLESS ALL SIGNATURES COMPLETED	
 KCI ASSOCIATES OF N.C., P.A. 4505 Falls of Neuse Road, Suite 400 Raleigh, NC 27609-4270 Phone (919) 783-9214 NC Firm License No. C-0764	

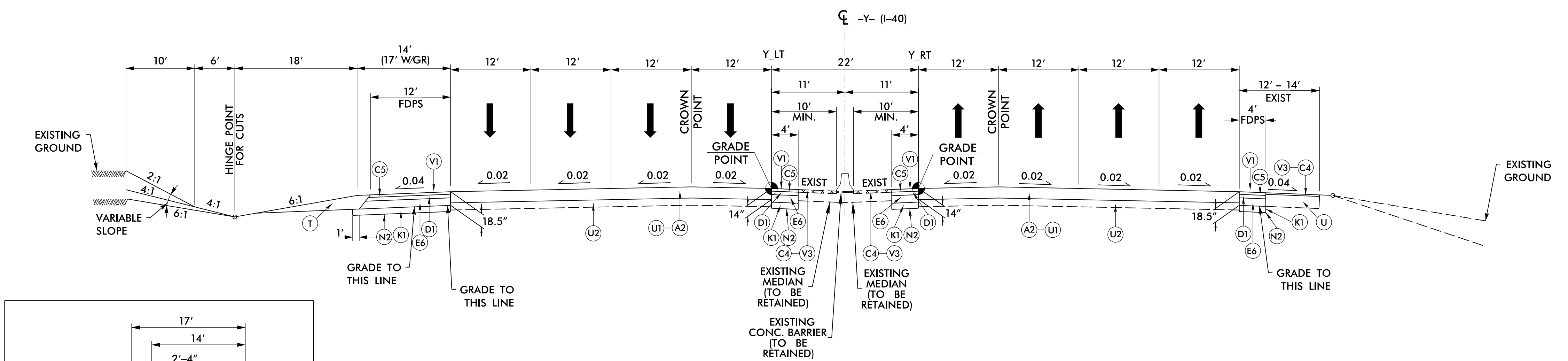

TYPICAL SECTION NO. 10
 -Y_LT- STA. 55+92.12 (APPR. SLAB) TO 65+78.08
 -Y_RT- STA. 55+65.43 (APPR. SLAB) TO 63+61.68 (NW5A)

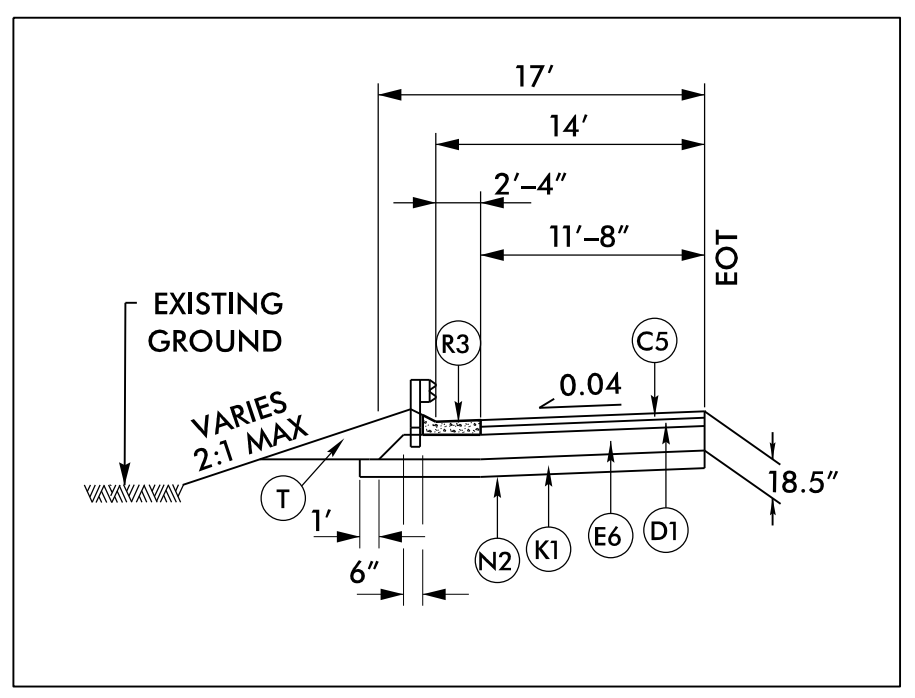

INSET NO. 2D
 USE IN CONJUNCTION WITH TYPICAL SECTION NO. 10A
 -Y_LT- STA. 65+78.08 TO 76+90.00
 -Y_RT- STA. 86+60.00 TO 92+44.00

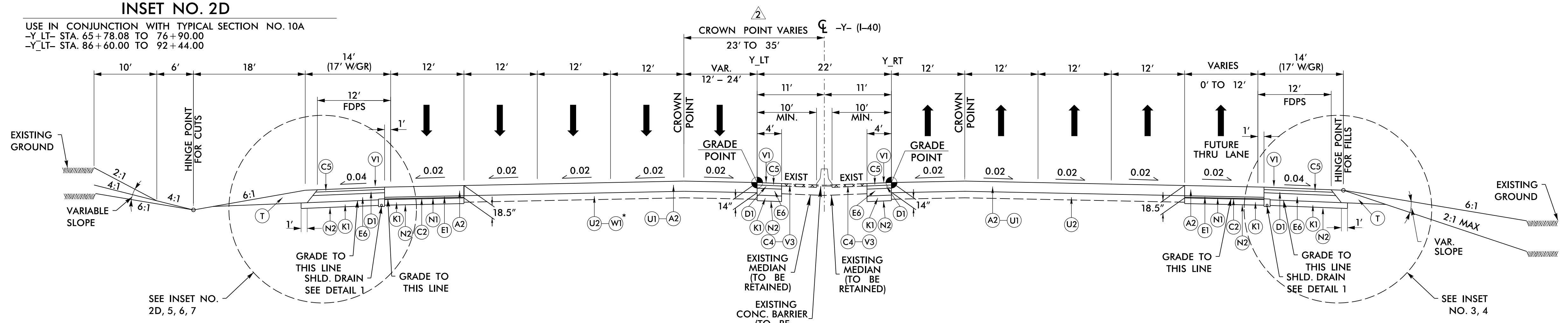

TYPICAL SECTION NO. 10A
 -Y_LT- STA. 65+78.08 TO 92+44.00
 -Y_RT- STA. 63+61.68 (NW5A) TO 92+44.00

▲ CROWN POINT TAPER
 FROM 79+30.00 TO 86+50.00
 * NOTE: USE WEDGE DETAIL W1
 FROM 79+30.00 TO 92+44.00

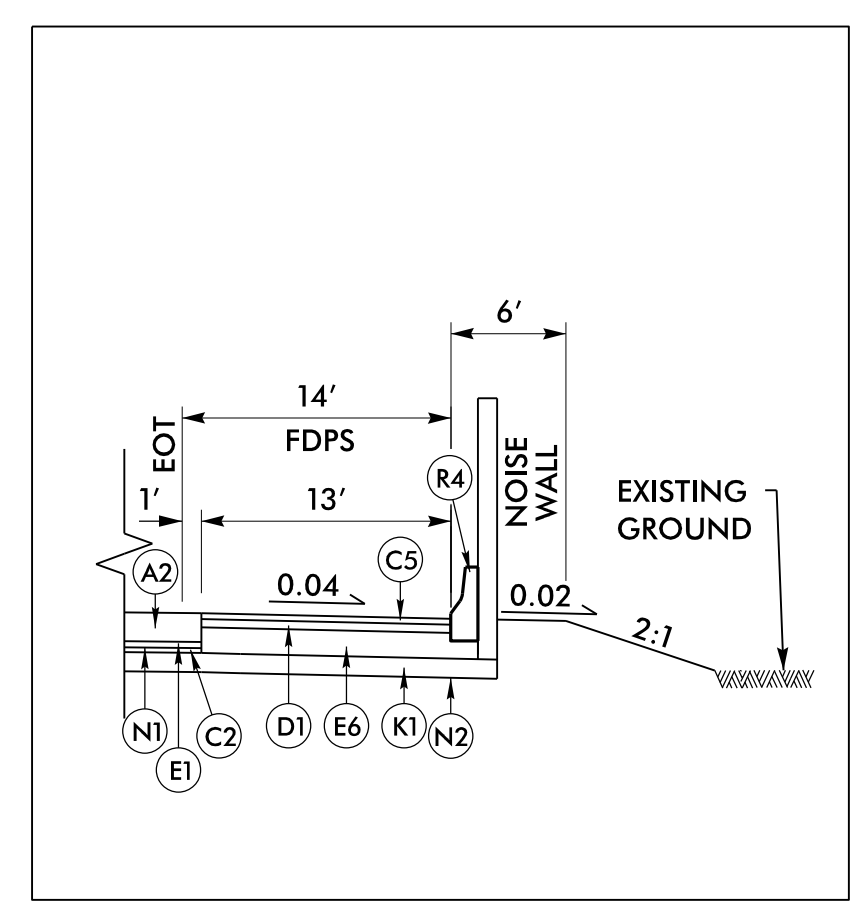

INSET NO. 3
 USE IN CONJUNCTION WITH TYPICAL SECTION NO. 10A
 -Y_RT- STA. 63+61.68 TO 77+80.27
 -Y_RT- STA. 89+66.00 TO 93+44.02

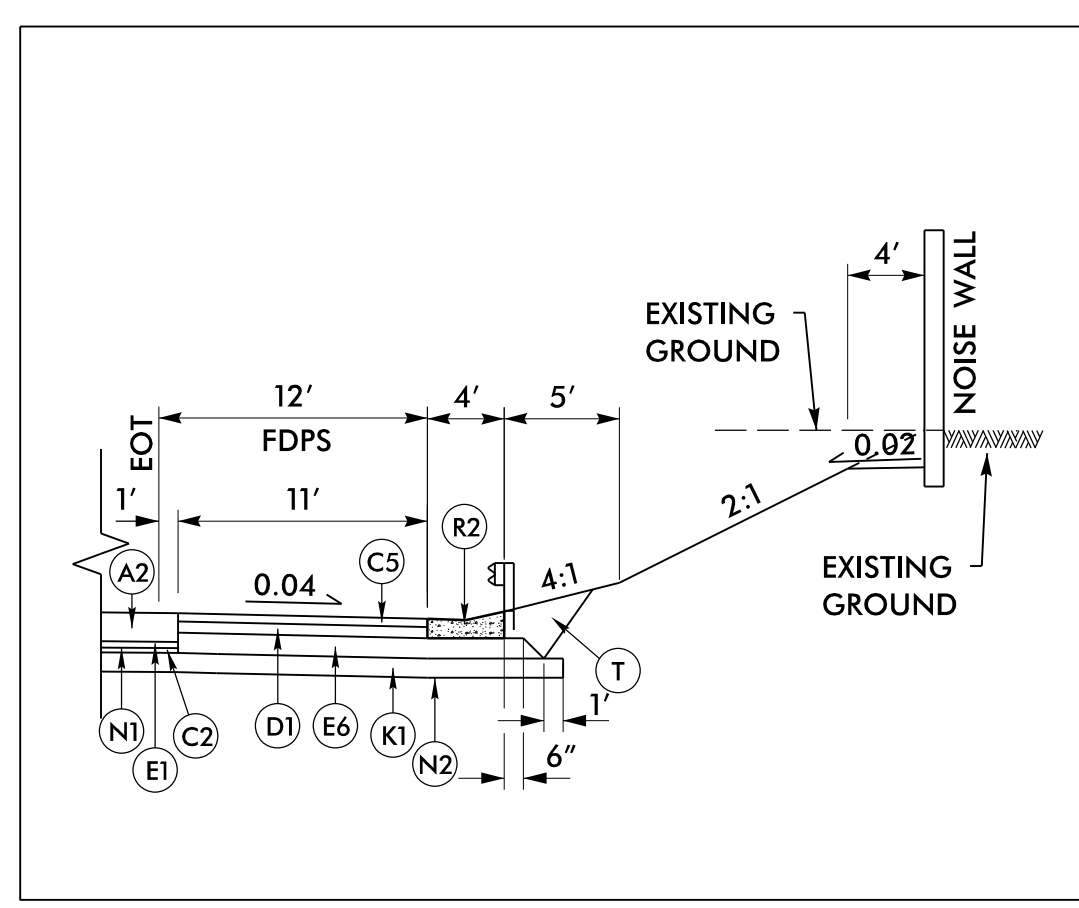

INSET NO. 4
 USE IN CONJUNCTION WITH TYPICAL SECTION NO. 10A
 -Y_RT- STA. 77+80.27 TO 89+66.00

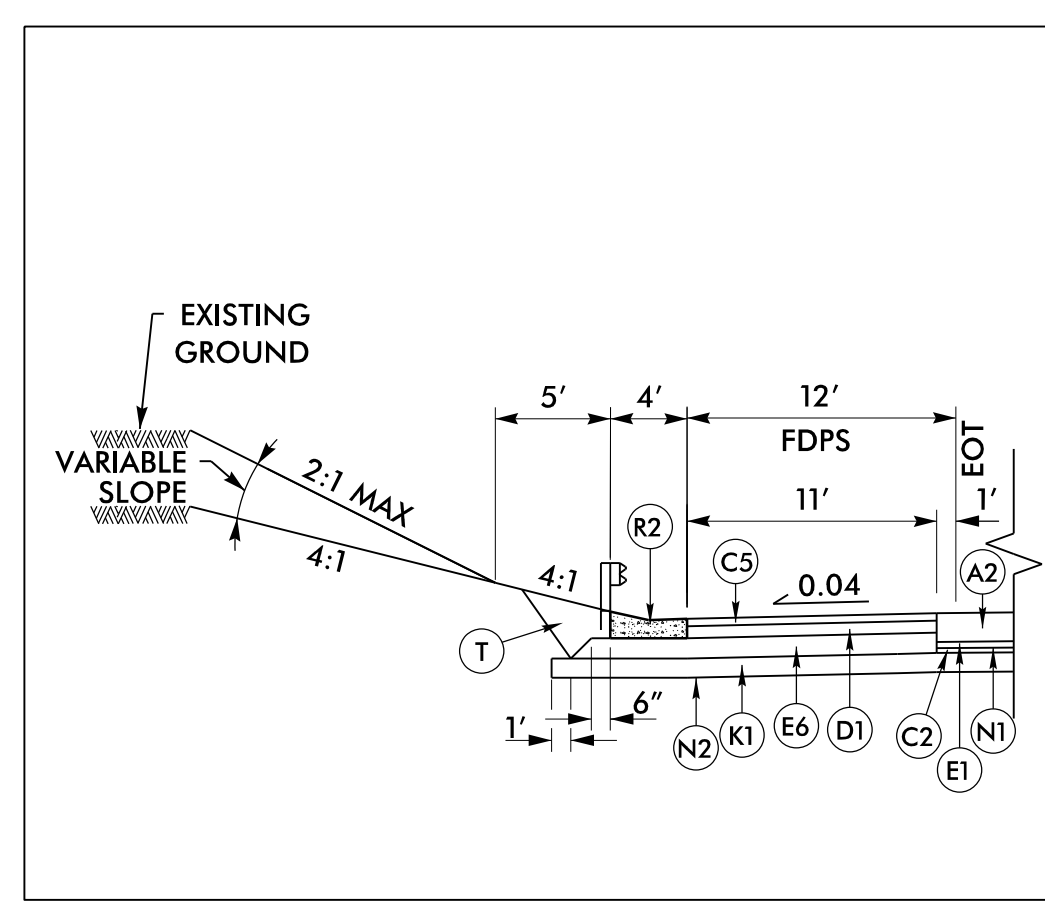

INSET NO. 5
 USE IN CONJUNCTION WITH TYPICAL SECTION NO. 10A
 -Y_LT- STA. 76+90.00 TO 86+60.00

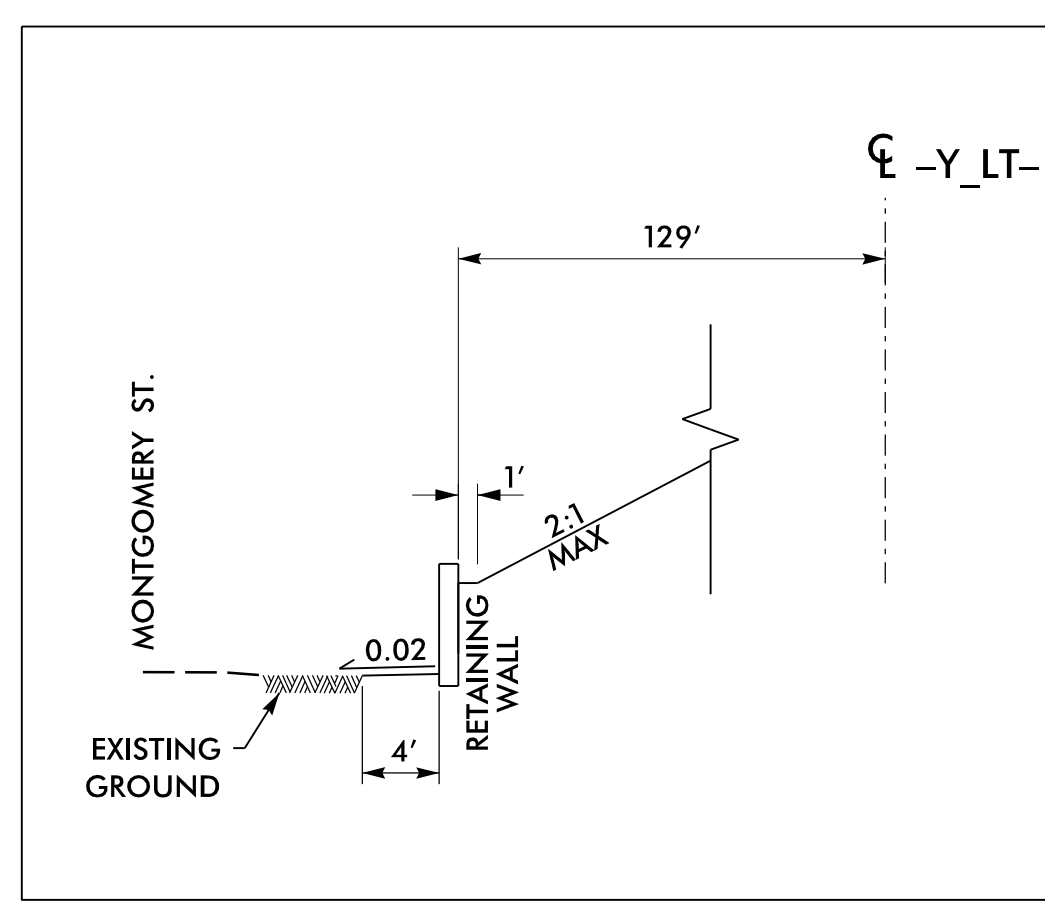

INSET NO. 6 (MONTGOMERY ST.)
 USE IN CONJUNCTION WITH TYPICAL SECTION NO. 10A
 -Y_LT- STA. 66+46.00 TO 68+05.00
 -Y_LT- STA. 73+57.00 TO 74+55.00

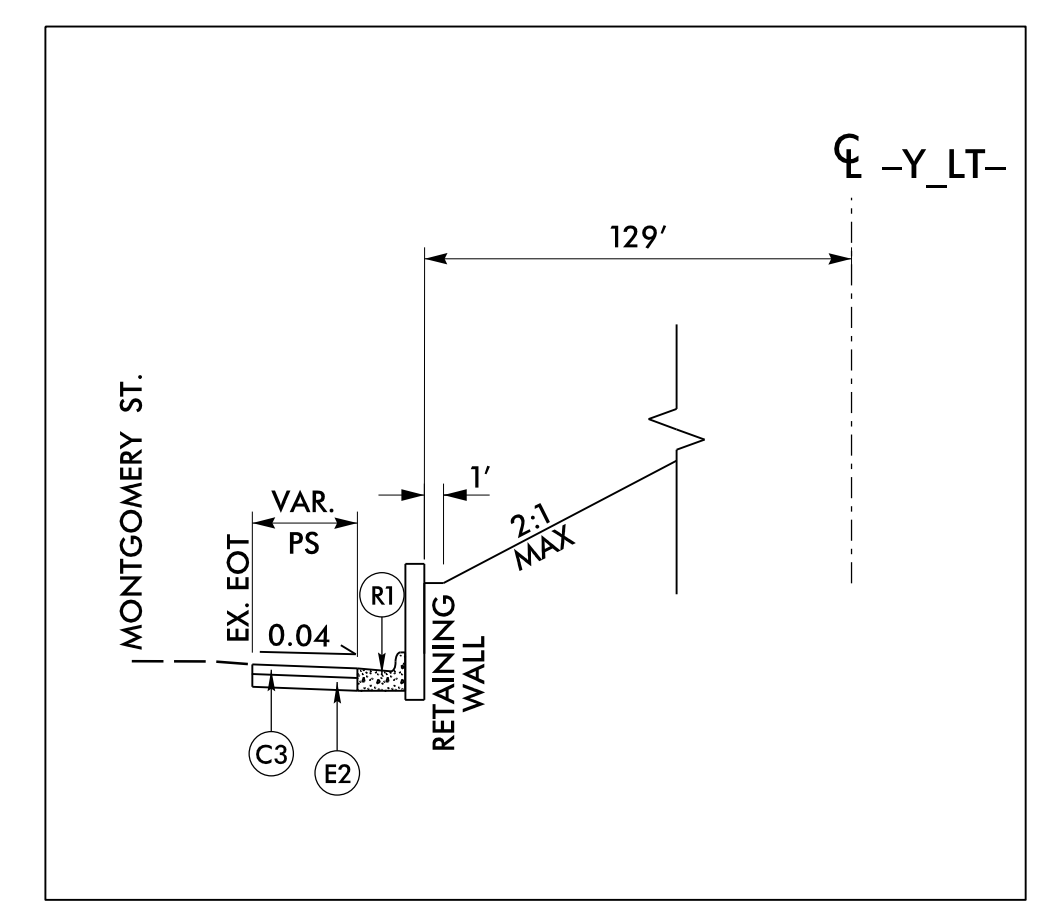

INSET NO. 7 (MONTGOMERY ST.)
 USE IN CONJUNCTION WITH TYPICAL SECTION NO. 10A
 -Y_LT- STA. 68+05.00 TO 73+57.00

A1	12" PCC PAVE.
A2	14" CONC. PAVE.
C1	1 1/4" S9.5B
C2	1 1/2" S9.5B
C3	3" S9.5B
C4	1 1/2" S9.5C
C5	3" S9.5C
C6	1 1/2" S9.5D
C7	3" S9.5D
C8	VAR. S9.5D
D1	4" I19.0C
D2	VAR. I19.0C
D3	2 1/2" I19.0C
E1	3" B25.0C
E2	4" B25.0C
E3	6.5" B25.0C
E4	7" B25.0C
E5	9" B25.0C
E6	11.5" B25.0C
E7	VAR. B25.0C
F1	5/8" ULTRA-THIN
J1	8" ABC
J2	10" ABC
K1	8" CL IV SUB. STAB.
N1	NONWOVEN GEO.
N2	GEO. SUB. STAB.
P1	PRIME COAT
R1	2'-6" C&G
R2	EXPRESS. GUTTER
R3	SH. BERM GUTTER
R4	PRECAST BARRIER
R5	4" CONC. COVER
T	EARTH MATERIAL
U	EXIST. PVMT.
U1	EXIST. C. PVMT.
U2	EXIST. A. PVMT.
V1	RUMBLE STRIPS
V2	1 1/2" MILLING
V3	VAR. MILLING
W1	WEDGING DET.#1
W2	WEDGING DET.#2

12/1/2023 12:51:36 PM - du_tj.p.dgn