

TIP PROJECT: I-2513AA/AB

CONTRACT: C204878

See Sheet 1A For Index of Sheets
See Sheet 1B For Conventional Symbols

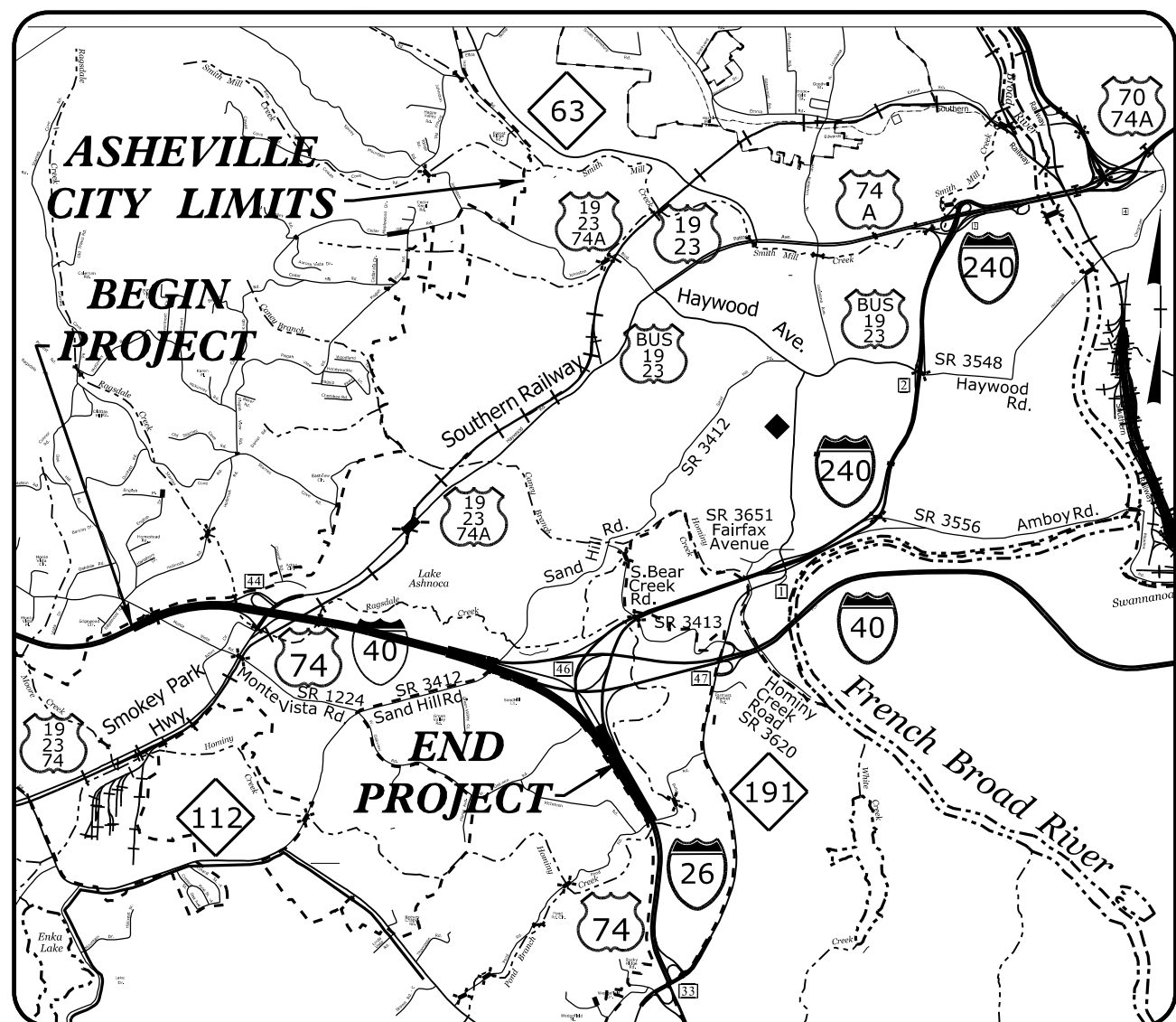

VICINITY MAP

STATE OF NORTH CAROLINA
DIVISION OF HIGHWAYS

BUNCOMBE COUNTY

LOCATION: I-40 FROM EAST OF SR 1224 (MONTE VISTA RD) TO WEST OF SR 3412 (SAND HILL RD) AND I-40 AT I-26 AND US 19/23 INTERCHANGES.

TYPE OF WORK: GRADING, DRAINAGE, PAVING, STRUCTURES, CULVERTS, WALLS, AND SIGNALS

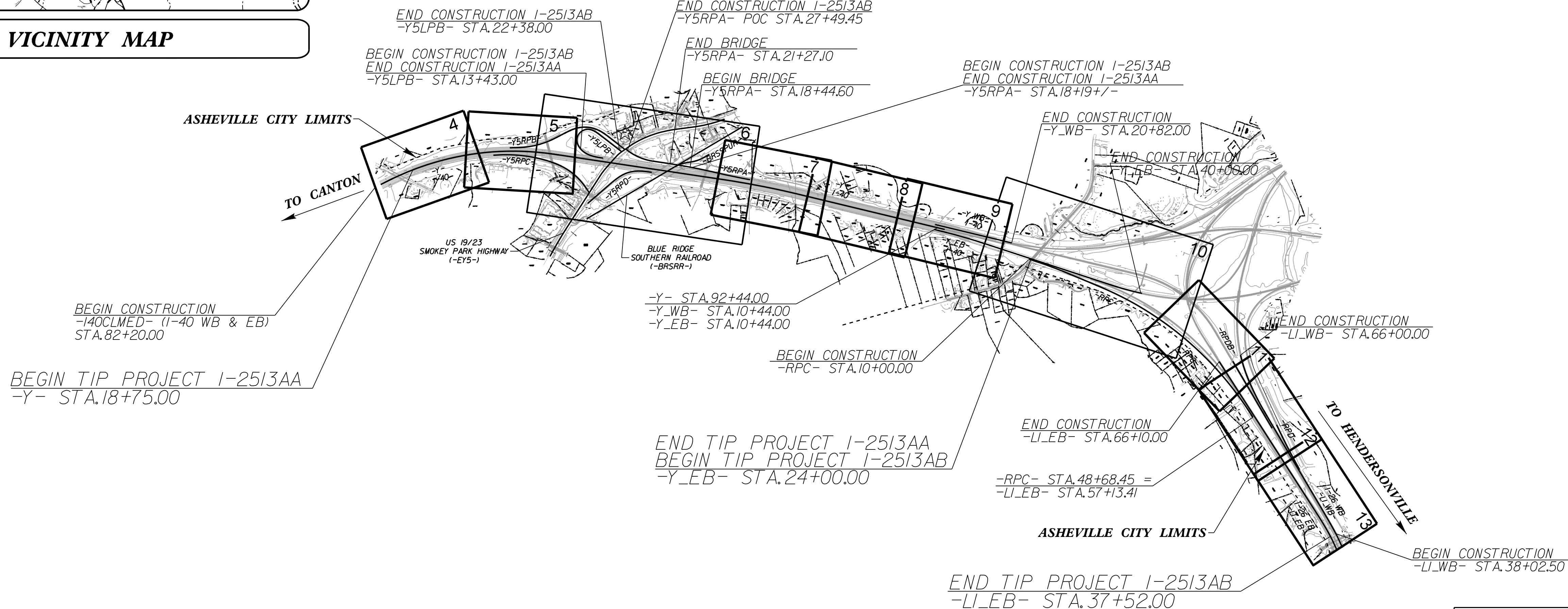

THIS IS A CONTROLLED-ACCESS PROJECT WITH ACCESS BEING LIMITED TO INTERCHANGES

★ REVISED SIGNAL

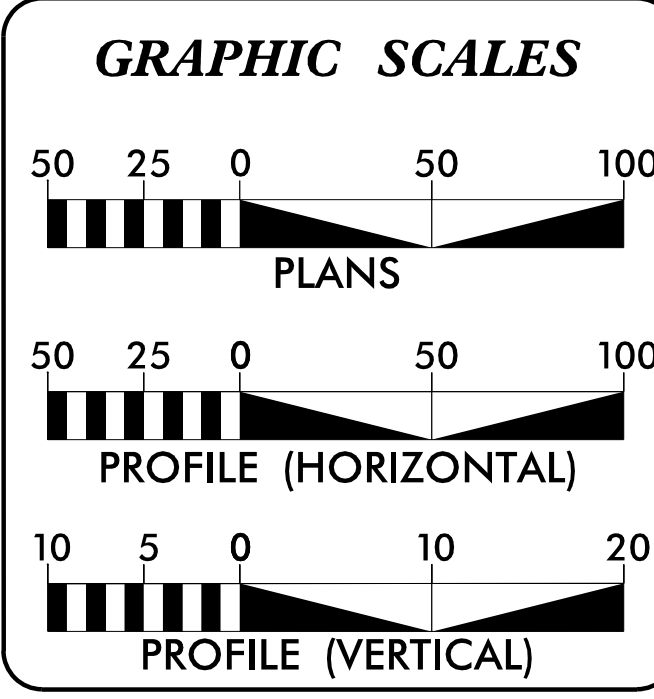

DESIGN DATA

ADT 2024	=	95,100
ADT 2044	=	124,800
K	=	9 %
D	=	55 %
T	=	11 % *
V	=	60 MPH
* TTST = 8% DUAL 3%		
FUNC CLASS = INTERSTATE		
STATEWIDE TIER		

PROJECT LENGTH

LENGTH ROADWAY TIP PROJECT I-2513AA	=	1.652 MI
LENGTH ROADWAY TIP PROJECT I-2513AB	=	1.098 MI
TOTAL LENGTH TIP PROJECT I-2513AA/AB	=	2.750 MI

KCI ASSOCIATES OF N.C., P.A.
4505 Falls of Neuse Road, Suite 400
Raleigh, NC 27609
Phone (919) 783-9214
NC Firm License No: C-0764

2024 STANDARD SPECIFICATIONS

RIGHT OF WAY DATE:
NOVEMBER 18, 2022

LETTING DATE:
JULY 16, 2024

CHARLES L. FLOWE, P.E.
PROJECT ENGINEER

BARRY C. SMITH, P.E.
PROJECT DESIGN ENGINEER

KEVIN E. MOORE, P.E.
NCDOT CONTACT

HYDRAULICS ENGINEER

DocuSigned by:
Matthew Harvey
08419C2087B94EE

SIGNATURE: _____

ROADWAY DESIGN ENGINEER

DocuSigned by:
Barry Smith
8271041D8676493

SIGNATURE: _____

DOCUMENT NOT CONSIDERED FINAL UNLESS ALL SIGNATURES COMPLETED

WETHERILL ENGINEERING
1223 Jones Franklin Rd.
Raleigh, N.C. 27606
License No. F-0377
Bus: 919 851 8077
Fax: 919 851 8107

TRANSPORTATION PLANNING/DESIGN - BRIDGE/STRUCTURE DESIGN
CIVIL/SITE DESIGN - GIS/GPS - CONSTRUCTION OBSERVATION