

EROSION CONTROL NOTES:

CONTRACTOR SHALL PROVIDE GROUND COVER ON EXPOSED SLOPES IN ACCORDANCE WITH THE "SOIL STABILIZATION TIMEFRAMES", SEE EC-1.

PROVIDE CONCRETE WASHOUT STRUCTURE IN ACCORDANCE WITH EROSION CONTROL SPECIAL PROVISION AND SPECIAL DETAIL "ONSITE CONCRETE WASHOUT STRUCTURE WITH LINER". SEE EC-2.

INSTALL EROSION CONTROL MEASURES IN ACCORDANCE WITH EROSION CONTROL DETAIL AND AS DIRECTED BY ENGINEER. SEE EC-3.

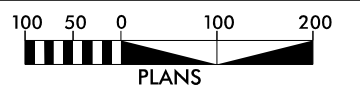
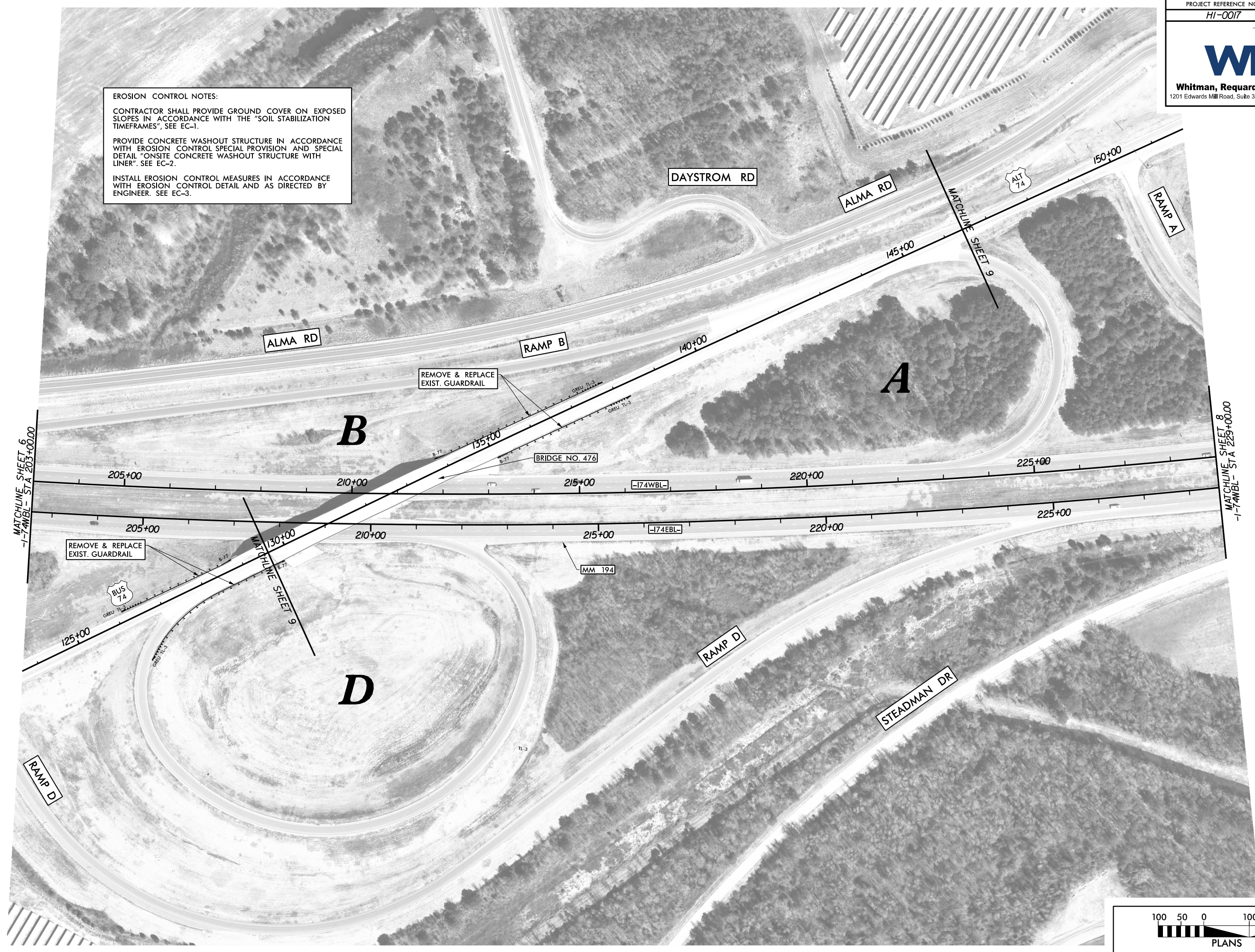

8/17/99
 I:\27_37_AM\2002\CADD\NCDOT\Roadway\Proj\HI-0017\HI-0017_RDY_PSH-07.dgn
 11/11/11



Whitman, Reardon & Associates, LLP
 1201 Edwards Mill Road, Suite 320, Raleigh, North Carolina 27606

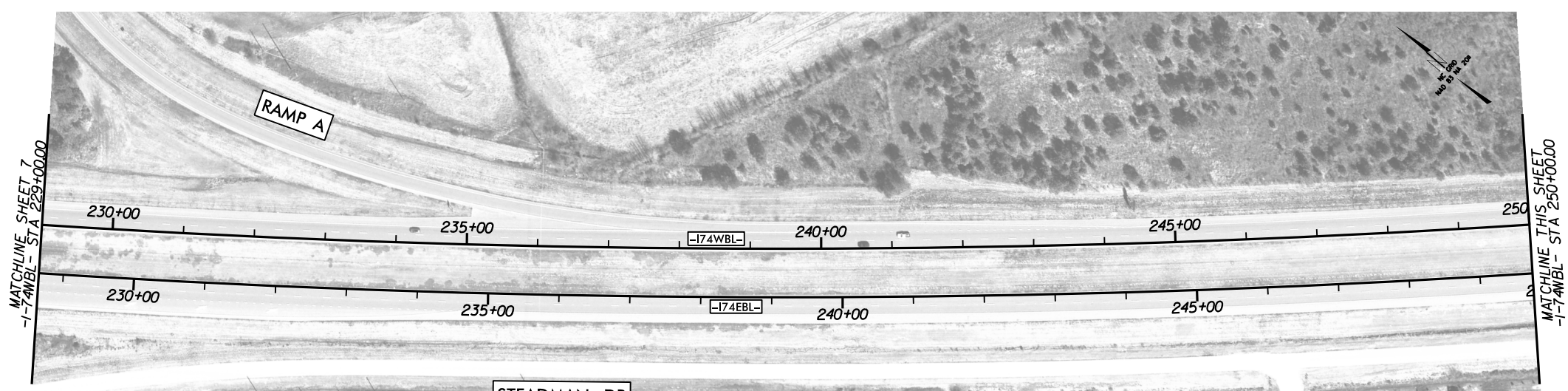

EROSION CONTROL NOTES:
 CONTRACTOR SHALL PROVIDE GROUND COVER ON EXPOSED SLOPES IN ACCORDANCE WITH THE "SOIL STABILIZATION TIMEFRAMES", SEE EC-1.
 PROVIDE CONCRETE WASHOUT STRUCTURE IN ACCORDANCE WITH EROSION CONTROL SPECIAL PROVISION AND SPECIAL DETAIL "ONSITE CONCRETE WASHOUT STRUCTURE WITH LINER". SEE EC-2.
 INSTALL EROSION CONTROL MEASURES IN ACCORDANCE WITH EROSION CONTROL DETAIL AND AS DIRECTED BY ENGINEER. SEE EC-3.

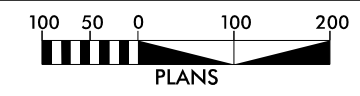
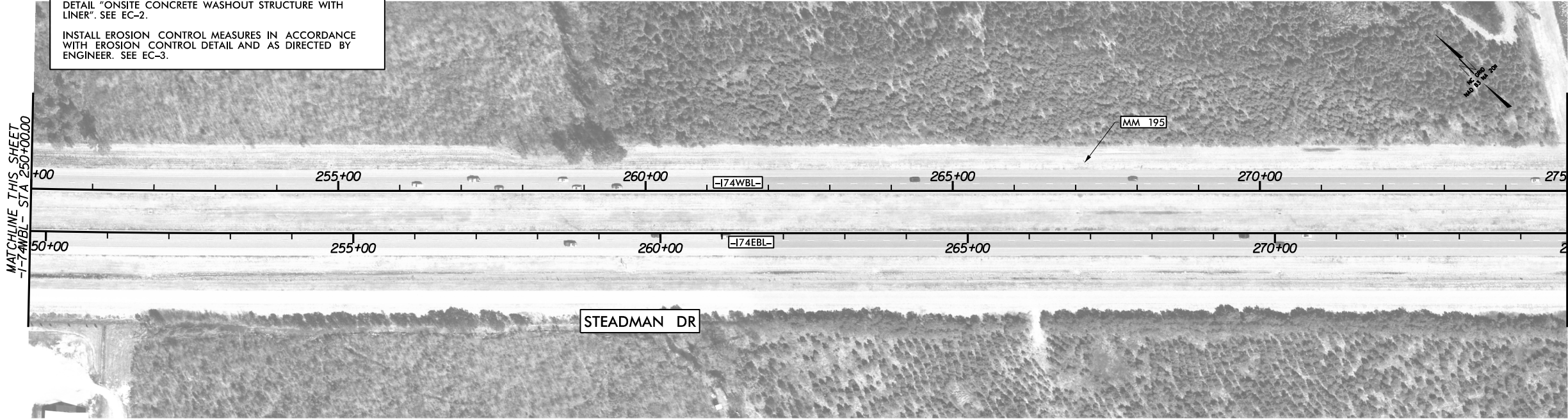

B.17/99
 I:\2813 AM 11-28-06\002\CADD\NCDOT\Roadway\Proj\HI-0017\HI-0017_RDY_PSH-08.dgn

8/17/99

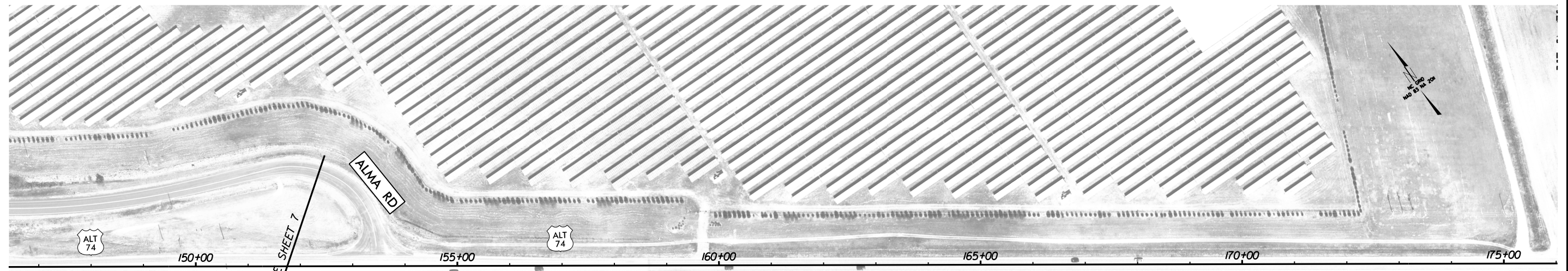

EROSION CONTROL NOTES:

CONTRACTOR SHALL PROVIDE GROUND COVER ON EXPOSED SLOPES IN ACCORDANCE WITH THE "SOIL STABILIZATION TIMEFRAMES", SEE EC-1.

PROVIDE CONCRETE WASHOUT STRUCTURE IN ACCORDANCE WITH EROSION CONTROL SPECIAL PROVISION AND SPECIAL DETAIL "ONSITE CONCRETE WASHOUT STRUCTURE WITH LINER". SEE EC-2.

INSTALL EROSION CONTROL MEASURES IN ACCORDANCE WITH EROSION CONTROL DETAIL AND AS DIRECTED BY ENGINEER. SEE EC-3.

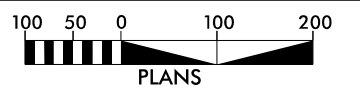

10:29:42 AM
N:\2006\06-002\CADD\NCDOT\Roadway\Proj\HI-0017\HI-0017_RDY_PSH-09.dgn