

STATE OF NORTH CAROLINA
DIVISION OF HIGHWAYS

TRANSPORTATION MANAGEMENT PLAN

LENOIR COUNTY

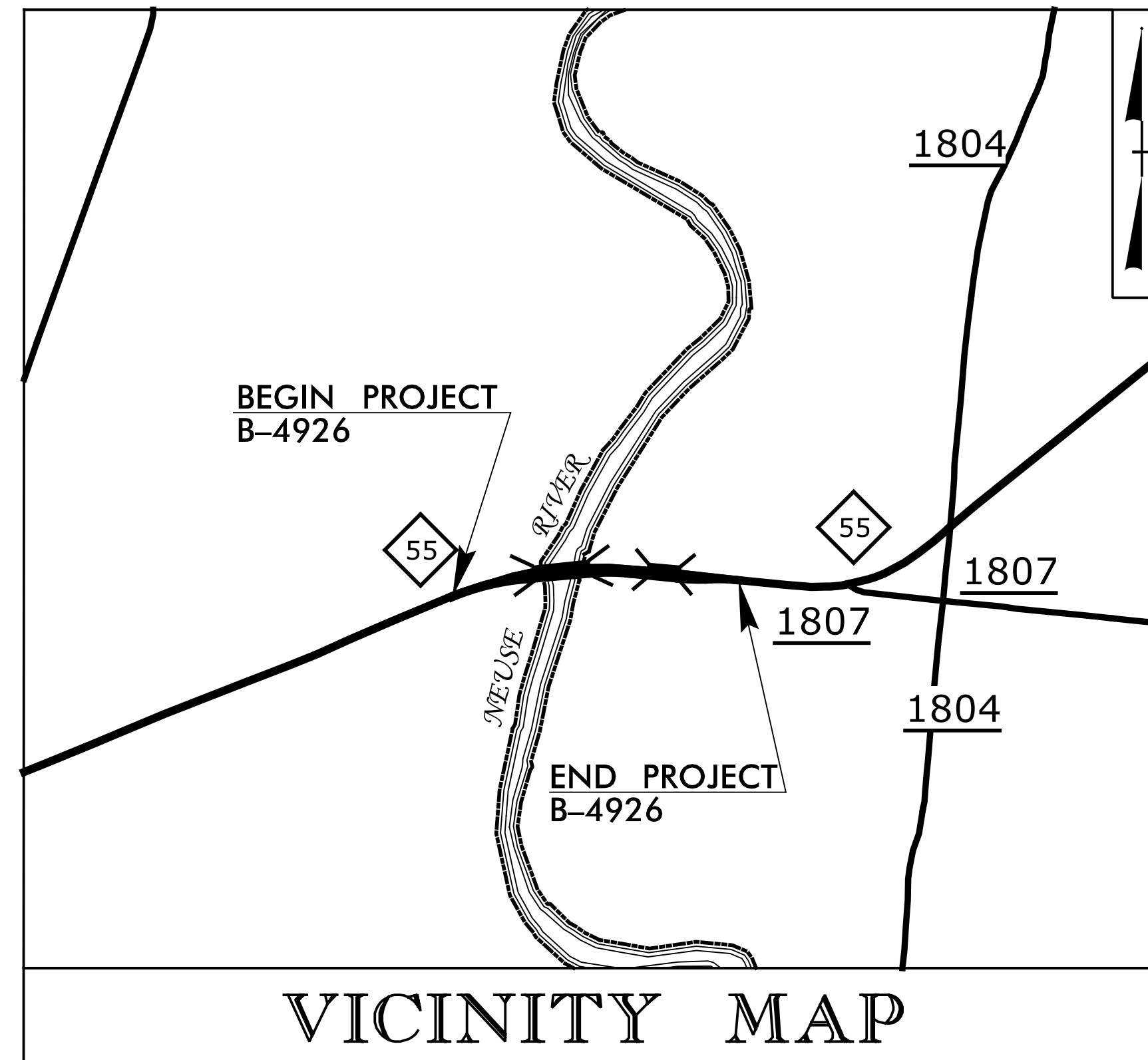
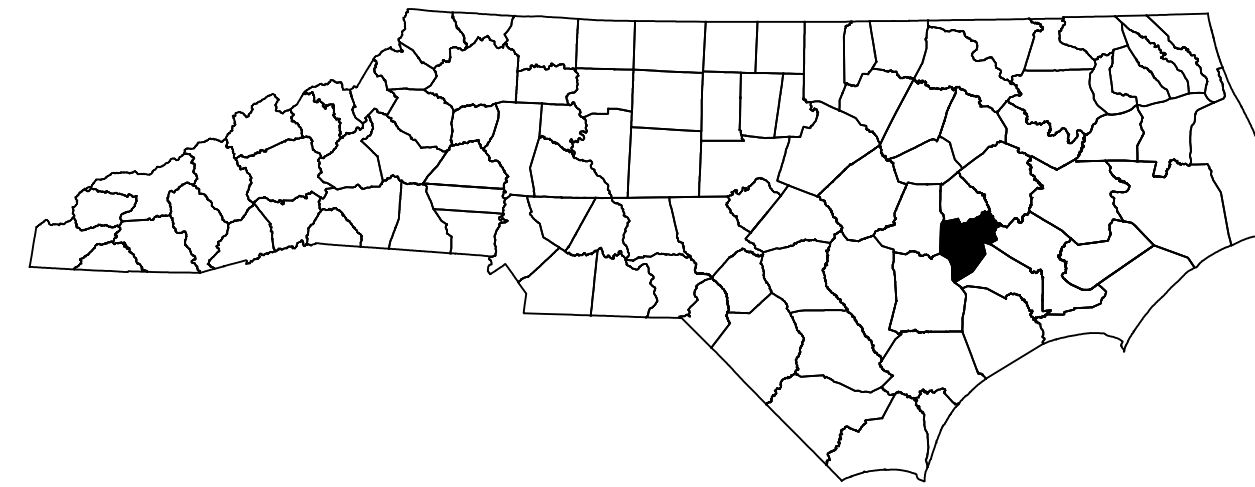

LOCATION: BRIDGE NO. 20 AND BRIDGE NO. 34 ON NC 55 OVER THE NEUSE RIVER

TYPE OF WORK: GRADING, DRAINAGE, PAVING, AND STRUCTURES

VICINITY MAP

INDEX OF SHEETS

SHEET NO.	TITLE
TMP-1	TITLE SHEET, VICINITY MAP, AND INDEX OF SHEETS
TMP-1A	LIST OF APPLICABLE ROADWAY STANDARD DRAWINGS, LEGEND, AND TEMPORARY PAVEMENT MARKING SCHEDULE
TMP-1B	PORTABLE CONCRETE BARRIER AT TEMPORARY SHORING LOCATIONS
TMP-1C	TEMPORARY SHORING NOTES
TMP-2	TRANSPORTATION OPERATIONS PLAN: (MANAGEMENT STRATEGIES AND GENERAL NOTES)
TMP-3	PHASING
TMP-4-5	PHASE I
TMP-6-7	PHASE II

SHEET NO.
TMP-1

PROJECT: B-4926

CONTRACT: C204861

04/04/24 DATE SUBMITTED
SUBMITTAL:
 STAGING CONCEPT
 MIDPOINT
 PRE-FINAL
 FINAL
DO NOT USE FOR CONSTRUCTION

DOCUMENT NOT CONSIDERED FINAL UNLESS ALL SIGNATURES COMPLETED

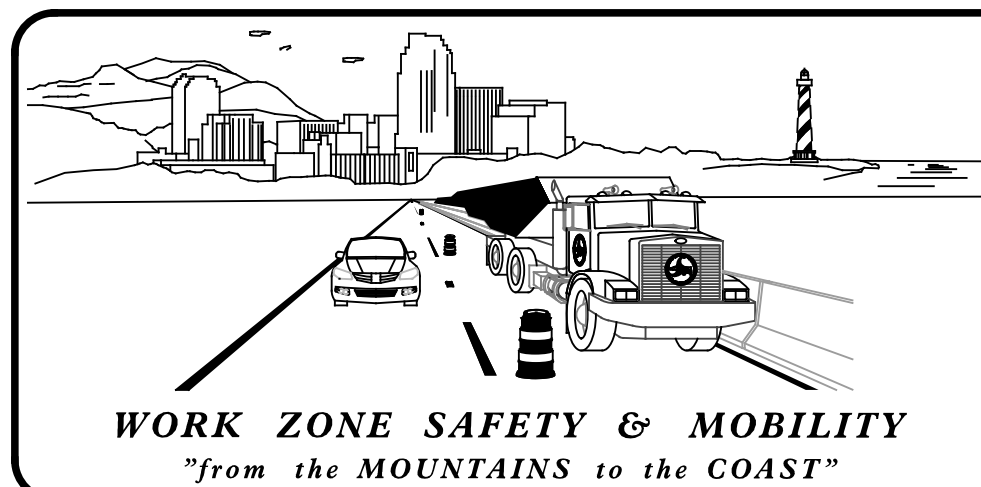

PLANS PREPARED BY:
JOHN BAUMAN, P.E.
STEVE MILLER, P.E.

NCDOT CONTACTS:
CASEY K. WHITLEY, P.E., P.L.S.
PROJECT ENGINEER

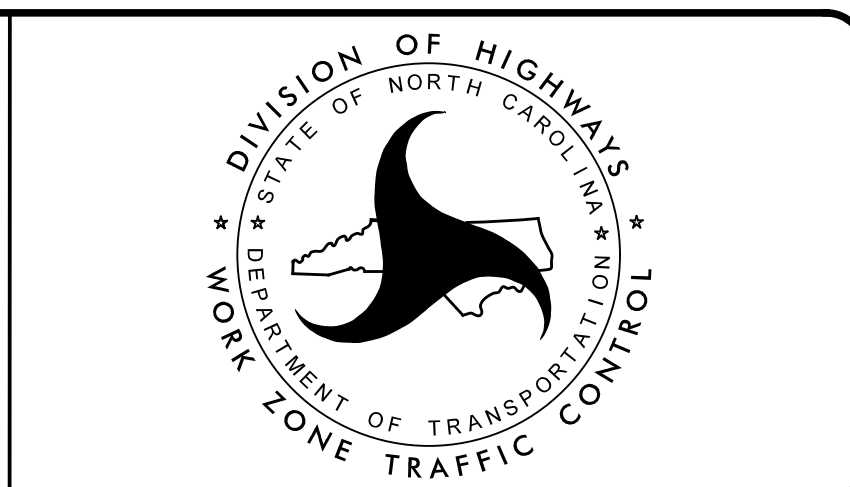

TRANSYSTEMS
1 Glenwood Avenue
Raleigh, NC 27603
Tel: 919.789.9977
Fax: 919.789.9591
License: F-0453

APPROVED: _____
DATE: _____
SEAL

4/4/2024 10:20:08 AM C:\EIB\015_00_B-4926\TP\Traffic\TMP\B-4926_TMP-1.dgn

ROADWAY STANDARD DRAWINGS

THE FOLLOWING ROADWAY STANDARDS AS SHOWN IN "ROADWAY STANDARD DRAWINGS" - PROJECT SERVICES UNIT - N.C. DEPARTMENT OF TRANSPORTATION - RALEIGH, N.C., DATED JANUARY 2024 ARE APPLICABLE TO THIS PROJECT AND BY REFERENCE HEREBY ARE CONSIDERED A PART OF THESE PLANS:

STD. NO.	TITLE
1101.01	WORK ZONE ADVANCE WARNING SIGNS
1101.02	TEMPORARY LANE CLOSURES
1101.04	TEMPORARY SHOULDER CLOSURES
1101.05	WORK ZONE VEHICLE ACCESSES
1101.11	TRAFFIC CONTROL DESIGN TABLES
1110.01	STATIONARY WORK ZONE SIGNS
1110.02	PORTABLE WORK ZONE SIGNS
1130.01	DRUMS
1135.01	CONES
1145.01	BARRICADES - TYPE III
1150.01	FLAGGERS
1180.01	SKINNY DRUMS
1205.01	PAVEMENT MARKINGS - LINE TYPES AND OFFSETS
1205.02	PAVEMENT MARKINGS - TWO LANE AND MULTILANE ROADWAYS
1205.12	PAVEMENT MARKINGS - BRIDGES
1250.01	RAISED PAVEMENT MARKERS - INSTALLATION SPACING
1251.01	RAISED PAVEMENT MARKERS - PERMANENT AND TEMPORARY

LEGEND

GENERAL

- DIRECTION OF TRAFFIC FLOW
- DIRECTION OF PEDESTRIAN TRAFFIC FLOW
- EXIST. PVMT.
- NORTH ARROW
- PROPOSED PVMT.
- TEMP. SHORING (LOCATION PURPOSES ONLY)

- WORK AREA
- REMOVAL
- CONSTRUCTION UNDER TRAFFIC
- TEMPORARY PAVEMENT

SIGNALS

- EXISTING
- PROPOSED
- TEMPORARY

PAVEMENT MARKINGS

- EXISTING LINES
- TEMPORARY LINES

TRAFFIC CONTROL DEVICES

- BARRICADE (TYPE III)
- CONE
- DRUM
- SKINNY DRUM
- TUBULAR MARKER
- TEMPORARY CRASH CUSHION
- FLASHING ARROW BOARD
- FLAGGER
- LAW ENFORCEMENT
- TRUCK MOUNTED ATTENUATOR (TMA)
- CHANGEABLE MESSAGE SIGN

TEMPORARY SIGNING

- PORTABLE SIGN
- STATIONARY SIGN
- STATIONARY OR PORTABLE SIGN

PAVEMENT MARKERS

- CRYSTAL/CRYSTAL
- CRYSTAL/RED
- YELLOW/YELLOW

PAVEMENT MARKING SYMBOLS

- PAVEMENT MARKING SYMBOLS

TEMPORARY PAVEMENT MARKING SCHEDULE

SYMBOL	DESCRIPTION
	PAINT (4")
P1	WHITE EDGELINE
P13	YELLOW DOUBLE CENTER

4/4/2024 X:\2018\SEI6\015.00_B-4926\TP\Traffic\TMP\B-4926_TMP-1A.dgn jbauman

TRANSYSTEMS
1 Glenwood Avenue
Raleigh, NC 27603
Tel: 919.789.9977
Fax: 919.789.9591
License: F-0453

APPROVED: _____
DATE: _____
SEAL

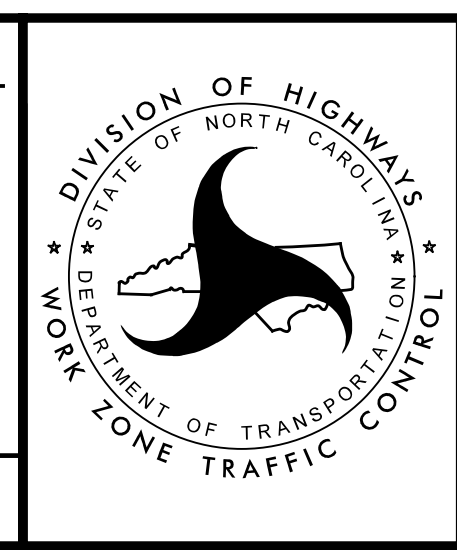

ROADWAY STANDARD DRAWINGS & LEGEND

DOCUMENT NOT CONSIDERED FINAL UNLESS ALL SIGNATURES COMPLETED

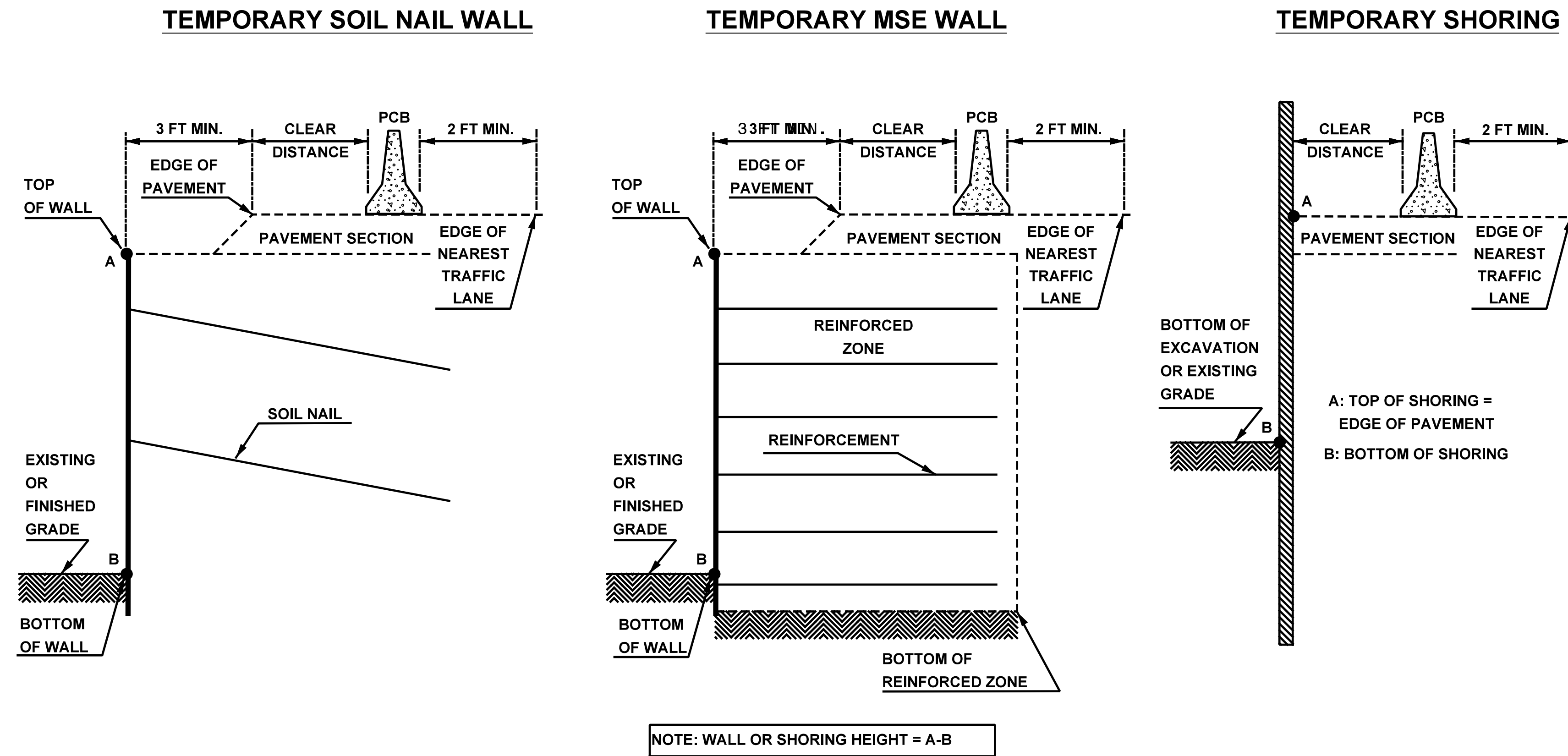

FIGURE A

NOTES

- 1- REFER TO THE TRAFFIC CONTROL PLANS FOR TEMPORARY SHORING LOCATIONS AND NOTES.
- 2- REFER TO THE "TEMPORARY SHORING" STANDARD PROVISION FOR INFORMATION ABOUT TEMPORARY SHORING AND PORTABLE CONCRETE BARRIER (PCB).
- 3- PCB IS REQUIRED IF TEMPORARY SHORING/WALL IS LOCATED WITHIN THE CLEAR ZONE IN ACCORDANCE WITH THE AASHTO ROADSIDE DESIGN GUIDE. DO NOT PLACE BARRIER DIRECTLY ON ANY SURFACE OTHER THAN ASPHALT OR CONCRETE. (CONTACT NCDOT PAVEMENT MANAGEMENT FOR APPLICABLE PAVEMENT DESIGN).
- 4- BASED ON THE CLEAR DISTANCE, OFFSET, DESIGN SPEED AND PAVEMENT TYPE, CHOOSE AN UNANCHORED OR ANCHORED PCB FROM THE TABLE SHOWN IN FIGURE B. CLEAR DISTANCE IS DEFINED AS SHOWN IN FIGURE A AND OFFSET IS DEFINED AS SHOWN IN FIGURE B.
- 5- AT THE CONTRACTOR'S OPTION OR IF THE MINIMUM REQUIRED CLEAR DISTANCE IS NOT AVAILABLE, SET PCB NEXT TO AND UP AGAINST THE TRAFFIC SIDE OF THE TEMPORARY SHORING/WALLS EXCEPT FOR BARRIER ABOVE TEMPORARY WALLS. PCB WITH THE MINIMUM REQUIRED CLEAR DISTANCE IS REQUIRED ABOVE TEMPORARY WALLS.
- 6- USE NCDOT PORTABLE CONCRETE BARRIER (PCB) IN ACCORDANCE WITH ROADWAY STANDARD DRAWING NO. 1170.01 AND SECTION 1170 OF THE STANDARD SPECIFICATIONS.
- 7- SET PCB WITH A MINIMUM HORIZONTAL DISTANCE OF 2 FT BETWEEN THE FRONT FACE OF THE BARRIER AND THE EDGE OF THE NEAREST TRAFFIC LANE AS SHOWN IN FIGURE A UNLESS OTHERWISE SHOWN IN THE PLANS OR APPROVED BY THE ENGINEER.
- 8- FOR PCB ABOVE AND BEHIND TEMPORARY WALLS, PROVIDE A MINIMUM DISTANCE OF 3 FT BETWEEN THE EDGE OF PAVEMENT AND THE WALL FACE AS SHOWN IN FIGURE A. IF THIS MINIMUM REQUIRED DISTANCE IS NOT AVAILABLE, CONTACT THE ENGINEER.
- 9- TABLE SHOWN IN FIGURE B IS BASED ON NCDOT RESEARCH PROJECT NO. 2005-010 WITH VEHICLE TYPE USED FOR NCHRP 350 CRASH TESTS.

MINIMUM REQUIRED CLEAR DISTANCE, inches

Barrier Type	Pavement Type	Offset * ft	Design Speed, mph					
			<30	31-40	41-50	51-60	61-70	71-80
Unanchored PCB	Asphalt	<8	24	26	29	32	36	40
		8-14	26	28	31	35	38	42
		14-20	27	29	34	36	39	43
		20-26	28	31	35	38	40	44
		26-32	29	32	36	39	42	45
		32-38	30	34	38	41	43	46
		38-44	31	34	41	43	45	48
	44-50	31	35	41	43	46	49	
	50-56	32	36	42	44	47	50	
	>56	32	36	42	45	47	51	
	Concrete	<8	17	18	21	22	25	26
		8-14	19	20	23	25	26	29
		14-20	22	22	24	26	28	31
		20-26	23	24	26	27	30	34
26-32		24	25	27	28	32	35	
32-38		24	26	27	30	33	36	
38-44		25	26	28	30	34	37	
44-50	26	26	28	32	35	37		
50-56	26	26	28	32	35	38		
>56	26	27	29	32	36	38		
Anchored PCB	Asphalt	All Offsets	24 for All Design Speeds					
Anchored PCB	Concrete (including bridge approach slabs)	All Offsets	12 for All Design Speeds					

* See Figure Below

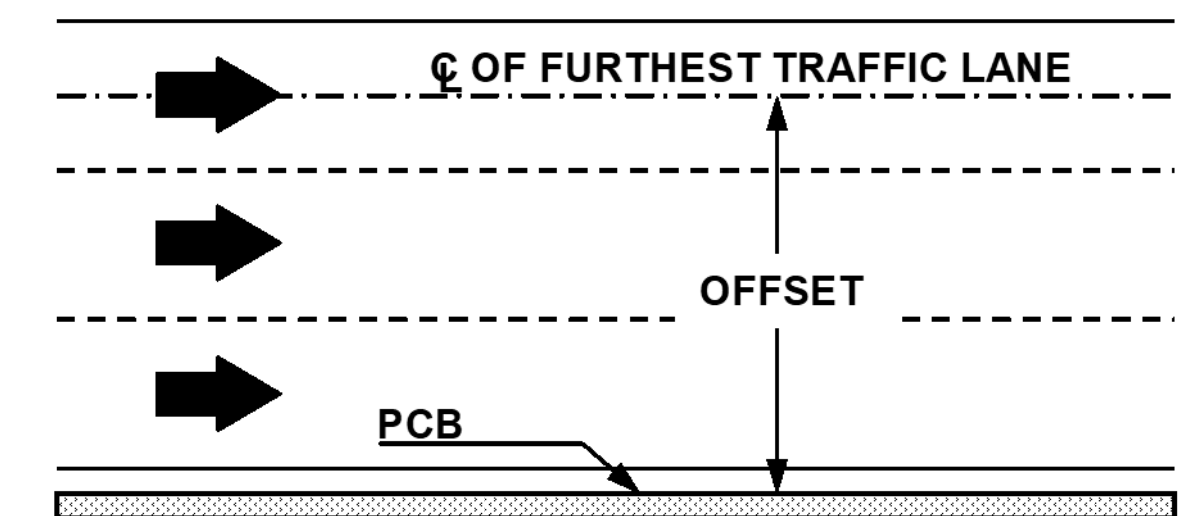
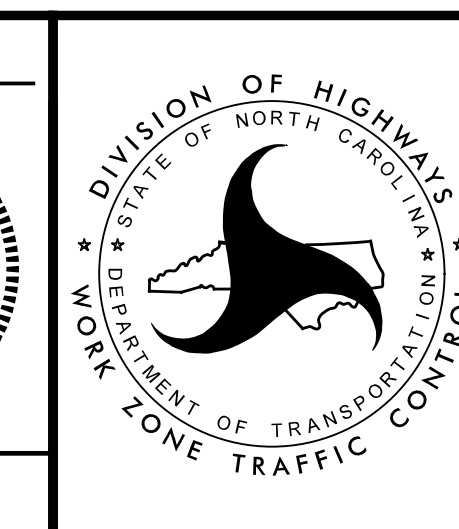

FIGURE B

4/4/2024 X:\2018\SEIB.015.00.B-4926\TP\Traffic\TMP\B-4926_TMP-1B.dgn jbauman

TRANSYSTEMS
1 Glenwood Avenue
Raleigh, NC 27603
Tel: 919.789.9377
Fax: 919.789.9591
License: F-0453

APPROVED: _____
DATE: _____
SEAL



PORTABLE CONCRETE BARRIER AT TEMPORARY SHORING LOCATIONS

DOCUMENT NOT CONSIDERED FINAL UNLESS ALL SIGNATURES COMPLETED

TEMPORARY SHORING NOTES

TEMPORARY SHORING NO. 1 (QUANTITY=1480 SF)

FOR TEMPORARY SHORING AND POSITIVE PROTECTION FOR TEMPORARY SHORING, SEE PLANS AND TEMPORARY SHORING PROVISION.

DESIGN TEMPORARY SHORING FROM -L- STATION 17+50 OFFSET 12 FT LT TO -L- STATION 21+20 OFFSET 19 FT LT FOR THE FOLLOWING ASSUMED SOIL PARAMETERS AND GROUNDWATER ELEVATION:

UNIT WEIGHT OF SOIL ABOVE WATER TABLE, $\gamma = 120$ PCF
 UNIT WEIGHT OF SOIL BELOW WATER TABLE, $\gamma' = 60$ PCF
 FRICTION ANGLE, $\phi = 30$
 COHESION, $c = 0$ PSF
 GROUNDWATER ELEVATION = 18 FT. +/-

BEFORE BEGINNING TEMPORARY SHORING DESIGN OR CONSTRUCTION, SURVEY EXISTING GROUND ELEVATIONS IN THE VICINITY OF SHORING LOCATIONS TO DETERMINE ACTUAL SHORING HEIGHTS.

LIMITED SUBSURFACE INFORMATION IS AVAILABLE IN THE VICINITY OF THE TEMPORARY SHORING FROM -L- STATION 17+50 OFFSET 12 FT LT TO -L- STATION 21+20 OFFSET 19 FT LT. THE INFORMATION PROVIDED FOR DESIGN WAS ASSUMED AND MAY NOT BE APPLICABLE TO THE ACTUAL SITE CONDITIONS ENCOUNTERED DURING CONSTRUCTION.

AT THE CONTRACTOR'S OPTION, USE STANDARD TEMPORARY SHORING FOR TEMPORARY SHORING FROM -L- STATION 17+50 OFFSET 12 FT LT TO -L- STATION 21+20 OFFSET 19 FT LT. SEE STANDARD DETAIL NO. 1801.02 FOR STANDARD TEMPORARY WALL.

TEMPORARY SHORING NO. 2 (QUANTITY= 160 SF)

FOR TEMPORARY SHORING AND POSITIVE PROTECTION FOR TEMPORARY SHORING, SEE PLANS AND TEMPORARY SHORING PROVISION.

DESIGN TEMPORARY SHORING FROM -L- STATION 33+85 OFFSET 23 FT LT TO -L- STATION 34+05 OFFSET 23 FT LT FOR THE FOLLOWING ASSUMED SOIL PARAMETERS AND GROUNDWATER ELEVATION:

UNIT WEIGHT OF SOIL ABOVE WATER TABLE, $\gamma = 120$ PCF
 UNIT WEIGHT OF SOIL BELOW WATER TABLE, $\gamma' = 60$ PCF
 FRICTION ANGLE, $\phi = 30$
 COHESION, $c = 0$ PSF
 GROUNDWATER ELEVATION = 18 FT. +/-

BEFORE BEGINNING TEMPORARY SHORING DESIGN OR CONSTRUCTION, SURVEY EXISTING GROUND ELEVATIONS IN THE VICINITY OF SHORING LOCATIONS TO DETERMINE ACTUAL SHORING HEIGHTS.

LIMITED SUBSURFACE INFORMATION IS AVAILABLE IN THE VICINITY OF THE TEMPORARY SHORING FROM -L- STATION 33+85 OFFSET 23 FT LT TO -L- STATION 34+05 OFFSET 23 FT LT. THE INFORMATION PROVIDED FOR DESIGN WAS ASSUMED AND MAY NOT BE APPLICABLE TO THE ACTUAL SITE CONDITIONS ENCOUNTERED DURING CONSTRUCTION.

AT THE CONTRACTOR'S OPTION, USE STANDARD TEMPORARY SHORING FOR TEMPORARY SHORING FROM -L- STATION 33+85 OFFSET 23 FT LT TO -L- STATION 34+05 OFFSET 23 FT LT. SEE STANDARD DETAIL NO. 1801.01 FOR STANDARD TEMPORARY SHORING.

TEMPORARY SHORING NO. 3 (QUANTITY= 120 SF)

FOR TEMPORARY SHORING AND POSITIVE PROTECTION FOR TEMPORARY SHORING, SEE PLANS AND TEMPORARY SHORING PROVISION.

DESIGN TEMPORARY SHORING FROM -L- STATION 36+00 OFFSET 23 FT LT TO -L- STATION 36+15 OFFSET 23 FT LT FOR THE FOLLOWING ASSUMED SOIL PARAMETERS AND GROUNDWATER ELEVATION:



UNIT WEIGHT OF SOIL ABOVE WATER TABLE, $\gamma = 120$ PCF
 UNIT WEIGHT OF SOIL BELOW WATER TABLE, $\gamma' = 60$ PCF
 FRICTION ANGLE, $\phi = 30$
 COHESION, $c = 0$ PSF
 GROUNDWATER ELEVATION = 18 FT. +/-

BEFORE BEGINNING TEMPORARY SHORING DESIGN OR CONSTRUCTION, SURVEY EXISTING GROUND ELEVATIONS IN THE VICINITY OF SHORING LOCATIONS TO DETERMINE ACTUAL SHORING HEIGHTS.

LIMITED SUBSURFACE INFORMATION IS AVAILABLE IN THE VICINITY OF THE TEMPORARY SHORING FROM -L- STATION 36+00 OFFSET 23 FT LT TO -L- STATION 36+15 OFFSET 23 FT LT. THE INFORMATION PROVIDED FOR DESIGN WAS ASSUMED AND MAY NOT BE APPLICABLE TO THE ACTUAL SITE CONDITIONS ENCOUNTERED DURING CONSTRUCTION.

AT THE CONTRACTOR'S OPTION, USE STANDARD TEMPORARY SHORING FOR TEMPORARY SHORING FROM -L- STATION 36+00 OFFSET 23 FT LT TO -L- STATION 36+15 OFFSET 23 FT LT. SEE STANDARD DETAIL NO. 1801.01 FOR STANDARD TEMPORARY SHORING.

THE TEMPORARY SHORING NOTES SHOWN ON THIS SHEET WERE PROVIDED THROUGH A SEALED DOCUMENT FROM WOOD ENVIRONMENTAL AND INFRASTRUCTURE SOLUTIONS, INC.. THE DOCUMENT WAS SUBMITTED TO SEPI, INC. ON JUNE 18, 2019 AND SEALED BY A PROFESSIONAL ENGINEER, BON LIEN, Ph.D., P.E. LICENSE # 030132

APPROVED: _____ DATE: _____ <div style="text-align: center;">  SEAL </div>		<h2 style="margin: 0;">TEMPORARY SHORING NOTES</h2>
DOCUMENT NOT CONSIDERED FINAL UNLESS ALL SIGNATURES COMPLETED		

4/15/2024
 X:\2018\SEB\015.00.B-4926\TP\Traffic\TMP\B-4926_TMP-1D.dgn
 jbauman

GENERAL NOTES

CHANGES MAY BE REQUIRED WHEN PHYSICAL DIMENSIONS IN THE DETAIL DRAWINGS, STANDARD DETAILS, AND ROADWAY DETAILS ARE NOT ATTAINABLE TO MEET FIELD CONDITIONS OR RESULT IN DUPLICATE OR UNDESIRED OVERLAPPING OF DEVICES. MODIFICATION MAY INCLUDE: MOVING, SUPPLEMENTING, COVERING, OR REMOVAL OF DEVICES AS DIRECTED BY THE ENGINEER.

THE FOLLOWING GENERAL NOTES APPLY AT ALL TIMES FOR THE DURATION OF THE CONSTRUCTION PROJECT EXCEPT WHEN OTHERWISE NOTED IN THE PLAN OR DIRECTED BY THE ENGINEER.

TIME RESTRICTIONS

A) DO NOT CLOSE OR NARROW TRAVEL LANES AS FOLLOWS:

ROAD NAME:	DAY AND TIME RESTRICTIONS
NC 55	MONDAY-FRIDAY 6:00 A.M.-8:00 A.M. 4:00 P.M.-6:00 P.M.

TIME RESTRICTIONS

B) DO NOT CLOSE OR NARROW TRAVEL LANES DURING HOLIDAYS AND SPECIAL EVENTS AS FOLLOWS:

ROAD NAME: NC 55

HOLIDAY

1. FOR ANY UNEXPECTED OCCURRENCE THAT CREATES UNUSUALLY HIGH TRAFFIC VOLUMES, AS DIRECTED BY THE ENGINEER.
2. FOR NEW YEAR'S, BETWEEN THE HOURS OF 6:00 A.M. DECEMBER 31ST TO 6:00 P.M. JANUARY 2ND. IF NEW YEAR'S DAY IS ON A FRIDAY, SATURDAY, SUNDAY, OR MONDAY THEN UNTIL 6:00 P.M. THE FOLLOWING TUESDAY.
3. FOR EASTER, BETWEEN THE HOURS OF 6:00 A.M. THURSDAY AND 6:00 P.M. MONDAY.
4. FOR MEMORIAL DAY, BETWEEN THE HOURS OF 6:00 A.M. FRIDAY TO 6:00 P.M. TUESDAY.
5. FOR INDEPENDENCE DAY, BETWEEN THE HOURS OF 6:00 A.M. THE DAY BEFORE INDEPENDENCE DAY AND 6:00 P.M. THE DAY AFTER INDEPENDENCE DAY.

IF INDEPENDENCE DAY IS ON A FRIDAY, SATURDAY, SUNDAY OR MONDAY THEN BETWEEN THE HOURS OF 6:00 A.M. THE THURSDAY BEFORE INDEPENDENCE DAY AND 6:00 P.M. THE TUESDAY AFTER INDEPENDENCE DAY.
6. FOR LABOR DAY, BETWEEN THE HOURS OF 6:00 A.M. FRIDAY AND 6:00 P.M. TUESDAY.
7. FOR THANKSGIVING DAY, BETWEEN THE HOURS OF 6:00 A.M. TUESDAY TO 6:00 P.M. MONDAY.
8. FOR CHRISTMAS, BETWEEN THE HOURS OF 6:00 A.M. THE FRIDAY BEFORE THE WEEK OF CHRISTMAS DAY AND 6:00 P.M. THE FOLLOWING TUESDAY AFTER THE WEEK OF CHRISTMAS.

LANE AND SHOULDER CLOSURE REQUIREMENTS

- C) REMOVE LANE CLOSURE DEVICES FROM THE LANE WHEN WORK IS NOT BEING PERFORMED BEHIND THE LANE CLOSURE OR WHEN A LANE CLOSURE IS NO LONGER NEEDED OR AS DIRECTED BY THE ENGINEER.
- D) WHEN PERSONNEL AND/OR EQUIPMENT ARE WORKING WITHIN 15 FT OF AN OPEN TRAVEL LANE, CLOSE THE NEAREST OPEN SHOULDER USING ROADWAY STANDARD DRAWING NO. 1101.04 UNLESS THE WORK AREA IS PROTECTED BY BARRIER OR GUARDRAIL OR A LANE CLOSURE IS INSTALLED.

E) WHEN PERSONNEL AND/OR EQUIPMENT ARE WORKING ON THE SHOULDER ADJACENT TO AN UNDIVIDED FACILITY AND WITHIN 5 FT OF AN OPEN TRAVEL LANE, CLOSE THE NEAREST OPEN TRAVEL LANE USING ROADWAY STANDARD DRAWING NO. 1101.02 UNLESS THE WORK AREA IS PROTECTED BY BARRIER OR GUARDRAIL.

WHEN PERSONNEL AND/OR EQUIPMENT ARE WORKING ON THE SHOULDER ADJACENT TO A DIVIDED FACILITY AND WITHIN 10 FT OF AN OPEN TRAVEL LANE, CLOSE THE NEAREST OPEN TRAVEL LANE USING ROADWAY STANDARD DRAWING NO. 1101.02 UNLESS THE WORK AREA IS PROTECTED BY BARRIER OR GUARDRAIL.

F) WHEN PERSONNEL AND/OR EQUIPMENT ARE WORKING WITHIN A LANE OF TRAVEL OF AN UNDIVIDED OR DIVIDED FACILITY, CLOSE THE LANE ACCORDING TO THE TRAFFIC CONTROL PLANS, ROADWAY STANDARD DRAWINGS, OR AS DIRECTED BY THE ENGINEER. CONDUCT THE WORK SO THAT ALL PERSONNEL AND/OR EQUIPMENT REMAIN WITHIN THE CLOSED TRAVEL LANE.

G) DO NOT WORK SIMULTANEOUSLY WITHIN 15 FT ON BOTH SIDES OF AN OPEN TRAVELWAY, RAMP, OR LOOP WITHIN THE SAME LOCATION UNLESS PROTECTED WITH GUARDRAIL OR BARRIER.

PAVEMENT EDGE DROP OFF REQUIREMENTS

H) BACKFILL AT A 6:1 SLOPE UP TO THE EDGE AND ELEVATION OF EXISTING PAVEMENT IN AREAS ADJACENT TO AN OPENED TRAVEL LANE THAT HAS AN EDGE OF PAVEMENT DROP-OFF AS FOLLOWS:

BACKFILL DROP-OFFS THAT EXCEED 2 INCHES ON ROADWAYS WITH POSTED SPEED LIMITS OF 45 MPH OR GREATER.

BACKFILL DROP-OFFS THAT EXCEED 3 INCHES ON ROADWAYS WITH POSTED SPEED LIMITS LESS THAN 45 MPH.

BACKFILL WITH SUITABLE COMPACTED MATERIAL, AS APPROVED BY THE ENGINEER, AT NO EXPENSE TO THE DEPARTMENT.

I) DO NOT EXCEED A DIFFERENCE OF 2 INCHES IN ELEVATION BETWEEN OPEN LANES OF TRAFFIC FOR NOMINAL LIFTS OF 1.5 INCHES. INSTALL ADVANCE WARNING "UNEVEN LANES" SIGNS (WB-11) 200 FEET IN ADVANCE AND A MINIMUM OF EVERY HALF MILE THROUGHOUT THE UNEVEN AREA.

TRAFFIC PATTERN ALTERATIONS

J) NOTIFY THE ENGINEER ONE MONTH PRIOR TO ANY TRAFFIC PATTERN ALTERATION.

SIGNING

K) INSTALL ADVANCE WORK ZONE WARNING SIGNS NO MORE THAN THREE (3) DAYS PRIOR TO THE BEGINNING OF CONSTRUCTION.

L) ENSURE ALL NECESSARY SIGNING IS IN PLACE PRIOR TO ALTERING ANY TRAFFIC PATTERN.

TRAFFIC CONTROL DEVICES

M) WHEN LANE CLOSURES ARE NOT IN EFFECT SPACE CHANNELIZING DEVICES IN WORK AREAS NO GREATER IN FEET THAN TWICE THE POSTED SPEED LIMIT EXCEPT, 10 FT ON-CENTER IN RADII, AND 3 FT OFF THE EDGE OF AN OPEN TRAVELWAY. REFER TO STANDARD SPECIFICATIONS FOR ROADS AND STRUCTURES SECTIONS 1130 (DRUMS), 1135 (CONES) AND 1180 (SKINNY DRUMS) FOR ADDITIONAL REQUIREMENTS.

N) PLACE TYPE III BARRICADES, WITH "ROAD CLOSED" SIGN R11-2 ATTACHED, OF SUFFICIENT LENGTH TO CLOSE ENTIRE ROADWAY.

PAVEMENT MARKINGS AND MARKERS

O) INSTALL TEMPORARY PAVEMENT MARKINGS AND TEMPORARY PAVEMENT MARKERS ON INTERIM LAYERS OF PAVEMENT AS FOLLOWS:

ROAD NAME	MARKING	MARKER
NC 55	PAINT	TEMPORARY

P) PLACE ONE APPLICATION OF PAINT FOR TEMPORARY TRAFFIC PATTERNS. PLACE A SECOND APPLICATION OF PAINT SIX (6) MONTHS AFTER THE INITIAL APPLICATION AND EVERY SIX MONTHS AS DIRECTED BY THE ENGINEER.

Q) TIE PROPOSED PAVEMENT MARKING LINES TO EXISTING PAVEMENT MARKING LINES.

R) REMOVE/REPLACE ANY CONFLICTING/DAMAGED PAVEMENT MARKINGS AND MARKERS BY THE END OF EACH DAY'S OPERATION.

S) AS DIRECTED BY THE ENGINEER, PLACE TEMPORARY PAVEMENT MARKERS AT 20 FEET SPACING, A MINIMUM OF 120 FEET PRIOR TO AND THROUGH TEMPORARY TRAFFIC SHIFTS AND PLACE TEMPORARY MARKERS PRIOR TO CONSTRUCTION THROUGHOUT PROJECT LIMITS.

MANAGEMENT STRATEGIES

- LOCAL ACCESS TO ALL RESIDENCES AND BUSINESSES WILL BE MAINTAINED DURING CONSTRUCTION.
- PROVIDE ONE MONTH NOTICE TO THE ENGINEER, LENOIR COUNTY EMERGENCY SERVICES, AND LENOIR COUNTY SCHOOL OFFICIALS PRIOR TO ROAD CLOSURE.

4/4/2024 X:\2018\SEB\015.00_B-4926\TP\Traffic\TMP\B-4926_TMP-2.dgn jbauman



APPROVED: _____

DATE: _____

SEAL

DOCUMENT NOT CONSIDERED FINAL UNLESS ALL SIGNATURES COMPLETED

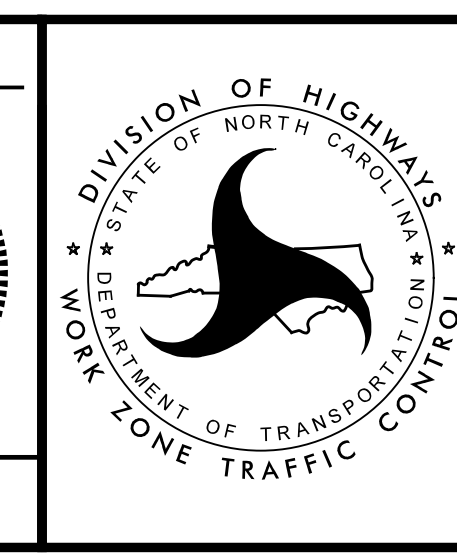

TRANSPORTATION OPERATIONS PLAN

PHASING

PHASE I

- STEP 1: USING ROADWAY STANDARD DRAWING (RSD) 1101.01 SHEET 3 OF 3, PLACE ADVANCE WARNING SIGNS ON NC 55.
- STEP 2: USING RSD 1101.02 SHEET 1 OF 19 AND RSD 1101.04 SHEET 1 OF 2, PLACE TEMPORARY PAVEMENT FROM -L- STA. 14+78 TO 22+46 AS SHOWN IN THE INSET ON TMP-4. PLACE TEMPORARY MARKINGS, TRAFFIC CONTROL DEVICES, AND PCB AS SHOWN ON TMP-4 AND SHIFT TRAFFIC ONTO THE TEMPORARY PAVEMENT.
- STEP 3: USING RSD 1101.02 SHEET 1 OF 19 AND RSD 1101.04 SHEET 1 OF 2, PLACE PERMANENT SHORING 1 AND TEMPORARY SHORING 2 AND 3 AS SHOWN ON TMP-4 AND TMP-5 AND BEGIN CONSTRUCTION AWAY FROM TRAFFIC UP TO BUT NOT INCLUDING THE FINAL LAYER OF SURFACE COURSE.
- STEP 4: USING RSD 1101.02 SHEET 1 OF 19 AND RSD 1101.04 SHEET 1 OF 2, COMPLETE BRIDGES.
- STEP 5: USING RSD 1101.02 SHEETS 1 AND 17 OF 19 AND RSD 1101.04 SHEET 1 OF 2, PERFORM THE FOLLOWING IN A CONTINUOUS MANNER:
- USE WEDGING TO CREATE TIE-IN FROM THE EXISTING PATTERN TO THE PHASE II PATTERN.
 - USE PORTABLE SIGNALS TO CONSTRUCT FROM -L- STA. 29+67 OFF 18' L TO -L- STA. 33+37 OFF 19' L AND FROM -L- STA. 36+22 OFF 19' L TO -L- STA. 38+22 OFF 20' L
 - REMOVE TEMPORARY SHORING.
 - RESET PCB TO LOCATION AS SHOWN ON TMP-6.
 - PLACE TRAFFIC CONTROL DEVICES AND TEMPORARY MARKINGS AS SHOWN ON TMP-6 AND TMP-7 AND SHIFT TRAFFIC INTO THE PHASE II PATTERN.

PHASE II

- STEP 1: USING RSD 1101.02 SHEET 1 OF 19 AND RSD 1101.04 SHEET 1 OF 2, COMPLETE GUARDRAIL INSTALLATION.
- STEP 2: USING RSD 1101.02 SHEET 1 OF 19 AND RSD 1101.04 SHEET 1 OF 2, REMOVE EXISTING STRUCTURE, REMOVE PAVEMENT, AND COMPLETE CONSTRUCTION UP TO BUT NOT INCLUDING THE FINAL LAYER OF SURFACE COURSE.
- STEP 3: USING RSD 1101.02 SHEET 1 OF 19 AND RSD 1101.04 SHEET 1 OF 2, REMOVE PCB, PLACE THE FINAL LAYER OF SURFACE COURSE AND FINAL PAVEMENT MARKINGS ACCORDING TO THE PAVEMENT MARKING PLAN. SHIFT TRAFFIC INTO FINAL PATTERN.
- STEP 4: REMOVE ALL REMAINING WORK ZONE TRAFFIC CONTROL DEVICES.

4/4/2024 X:\2018\SE16\015.00_B-4926\TP\Traffic\TMP\B-4926_TMP-3.dgn jbauman



APPROVED: _____

DATE: _____

SEAL

**DOCUMENT NOT CONSIDERED FINAL
UNLESS ALL SIGNATURES COMPLETED**

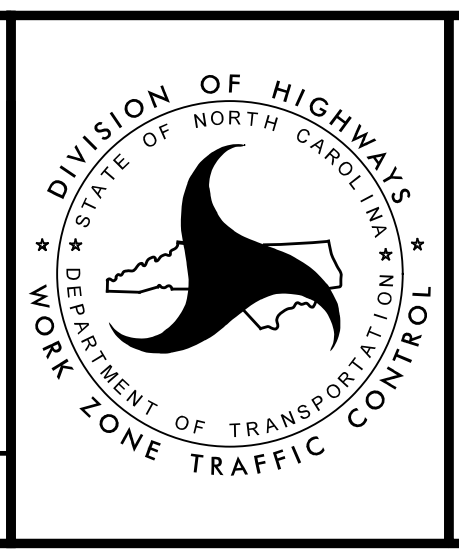

PHASING

① TEMPORARY SHORING TO REMAIN IN PLACE -L- STA. 17+50 OFF 12' L TO -L- STA. 21+20 OFF 19' L
 AVERAGE HEIGHT: 4', QUANTITY = 1480 SF

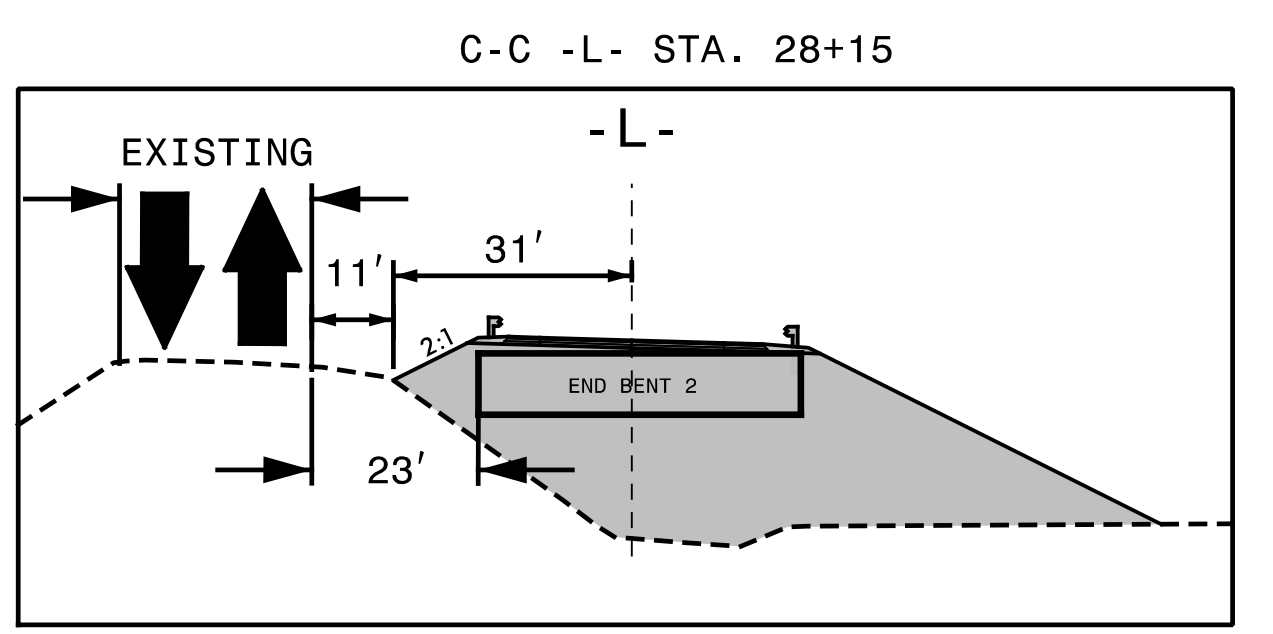
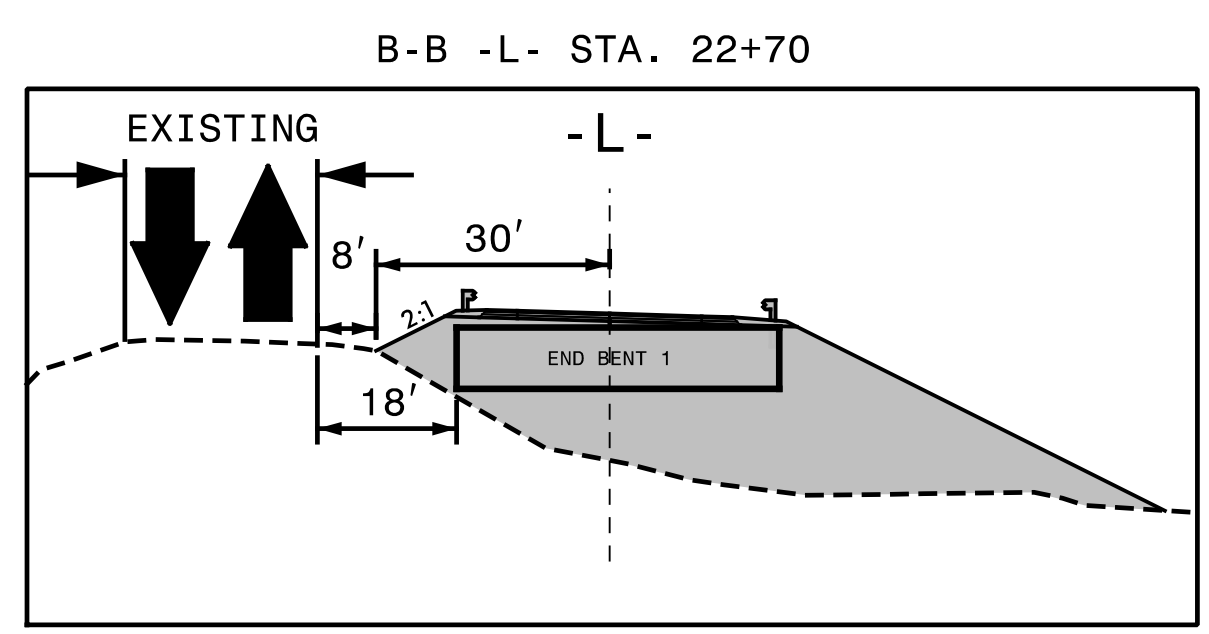
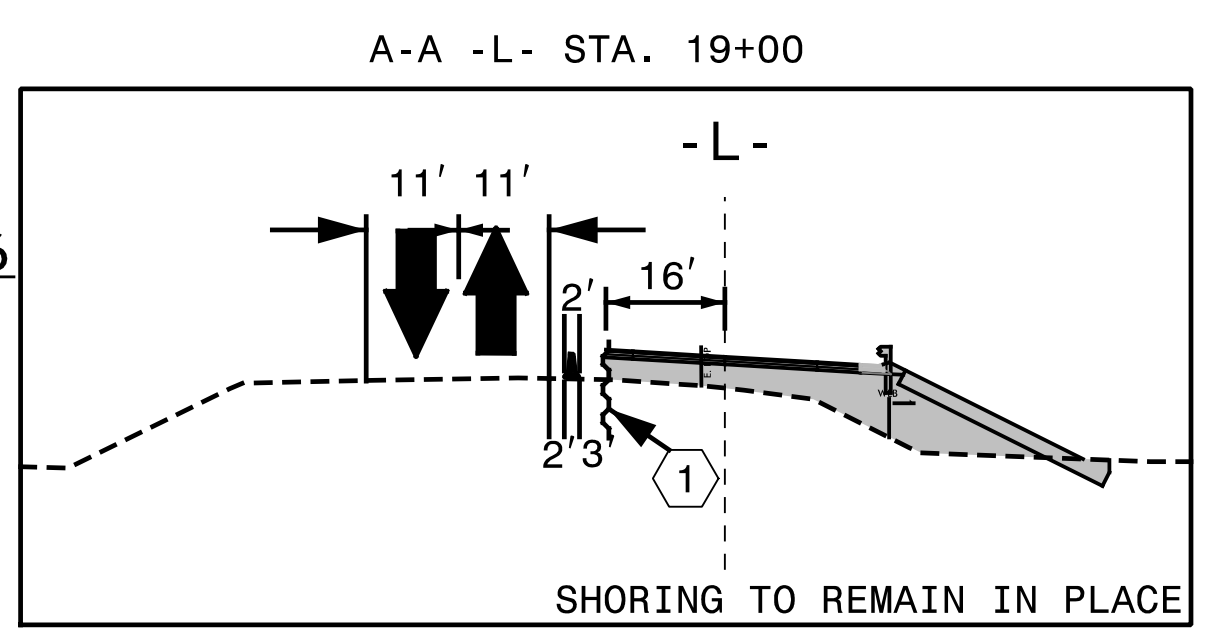
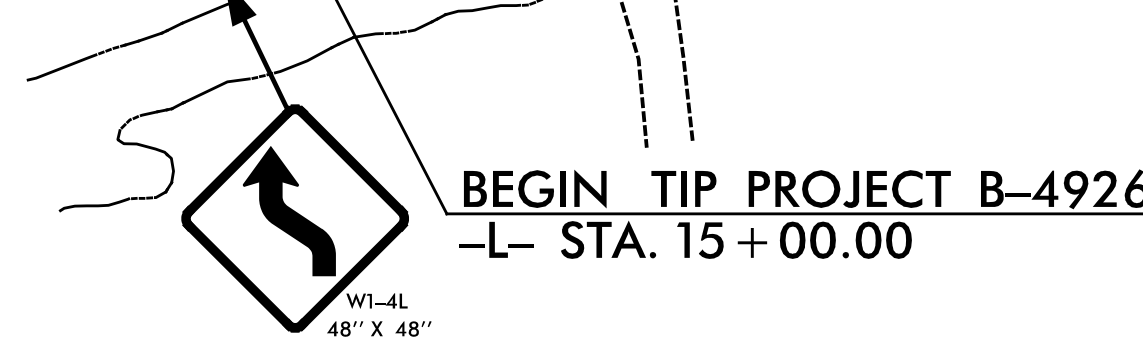
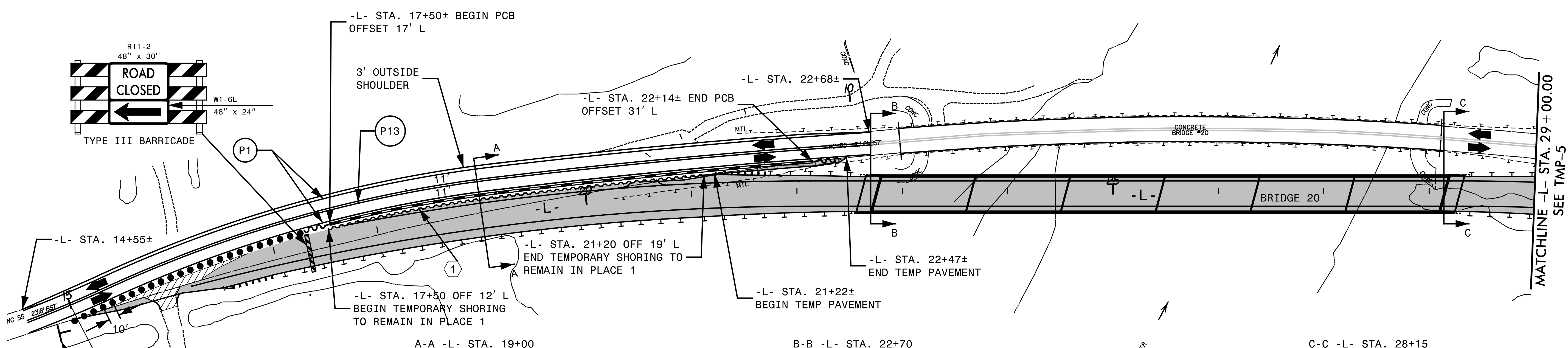
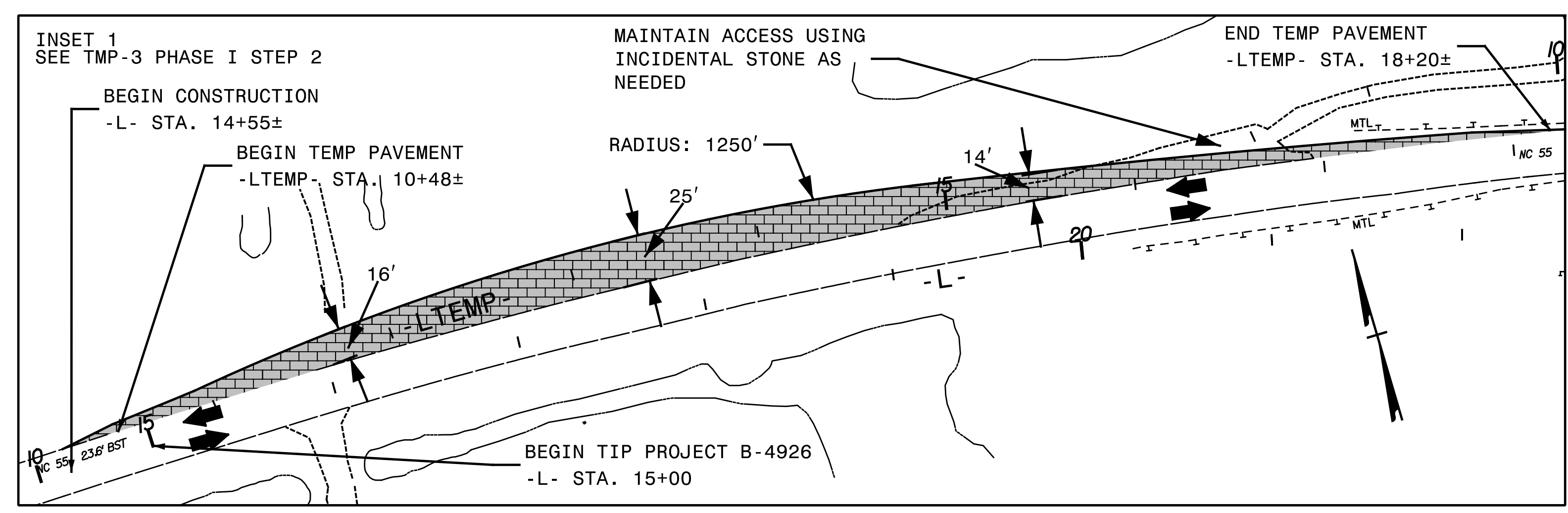

4/15/2024 10:08:08 AM S:\E\B\015.00.B-4926\TP\Traffic\TMP\B-4926-TMP-4.dgn

APPROVED: _____
 DATE: _____
 SEAL

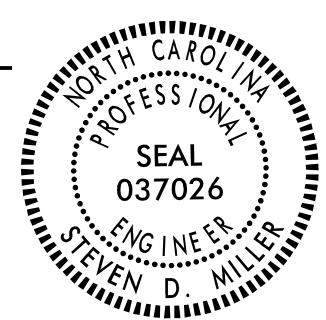

PHASE I

TRANSYSTEMS

1 Glenwood Avenue
 Raleigh, NC 27603
 Tel: 919.789.9977
 Fax: 919.789.9591
 License: F-0453

**DOCUMENT NOT CONSIDERED FINAL
 UNLESS ALL SIGNATURES COMPLETED**

- ② TEMP SHORING -L- STA. 33+85 OFF 23' L TO -L- STA. 34+05 OFF 23' L 8' DEEP
AVERAGE HEIGHT: 8', QUANTITY = 160 SF
- ③ TEMP SHORING -L- STA. 36+00 OFF 23' L TO -L- STA. 36+15 OFF 23' L 8' DEEP
AVERAGE HEIGHT: 8', QUANTITY = 120 SF

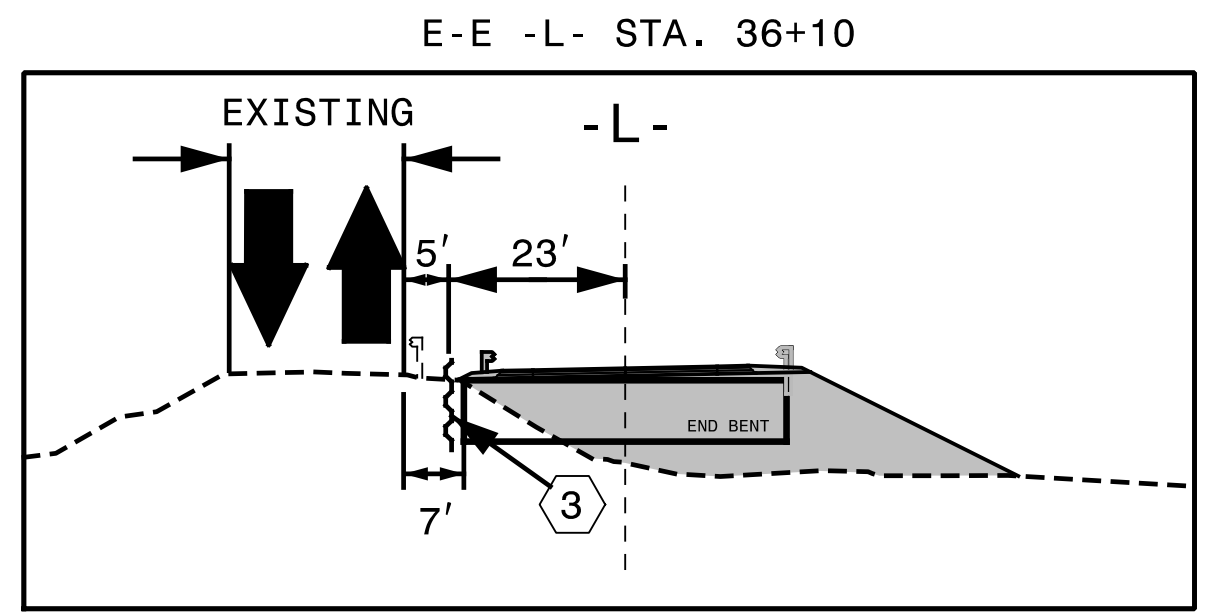
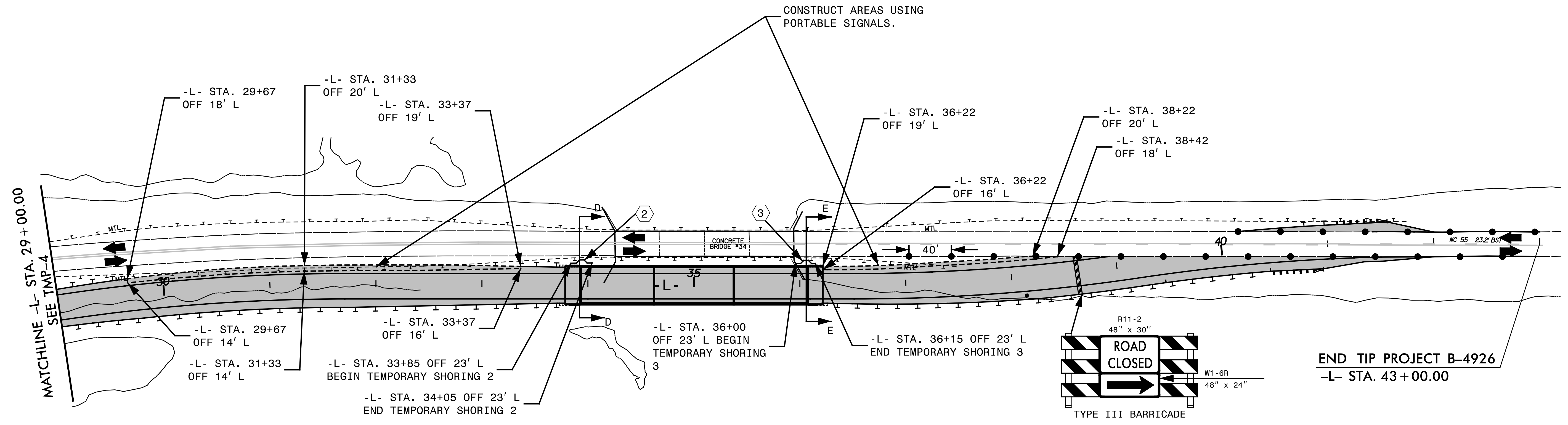
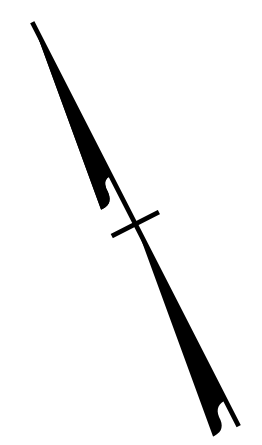

4/4/2004 10:08:58 EB:015.00.B-4926.TP\Traffic\TMP\B-4926.TMP-5.dgn

TRANSYSTEMS
 1 Glenwood Avenue
 Raleigh, NC 27603
 Tel: 919.789.9977
 Fax: 919.789.9591
 License: F-0453

APPROVED: _____
 DATE: _____
 SEAL

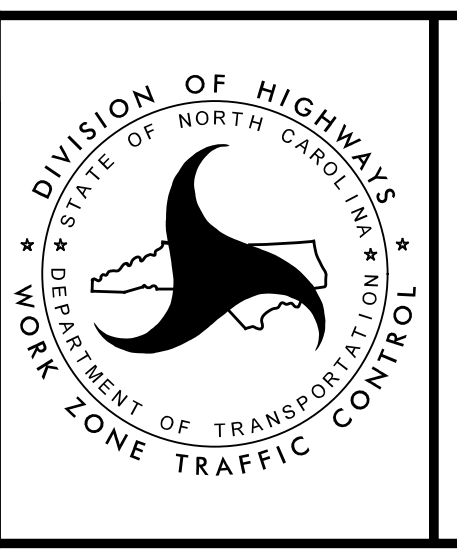

PHASE I

**DOCUMENT NOT CONSIDERED FINAL
 UNLESS ALL SIGNATURES COMPLETED**

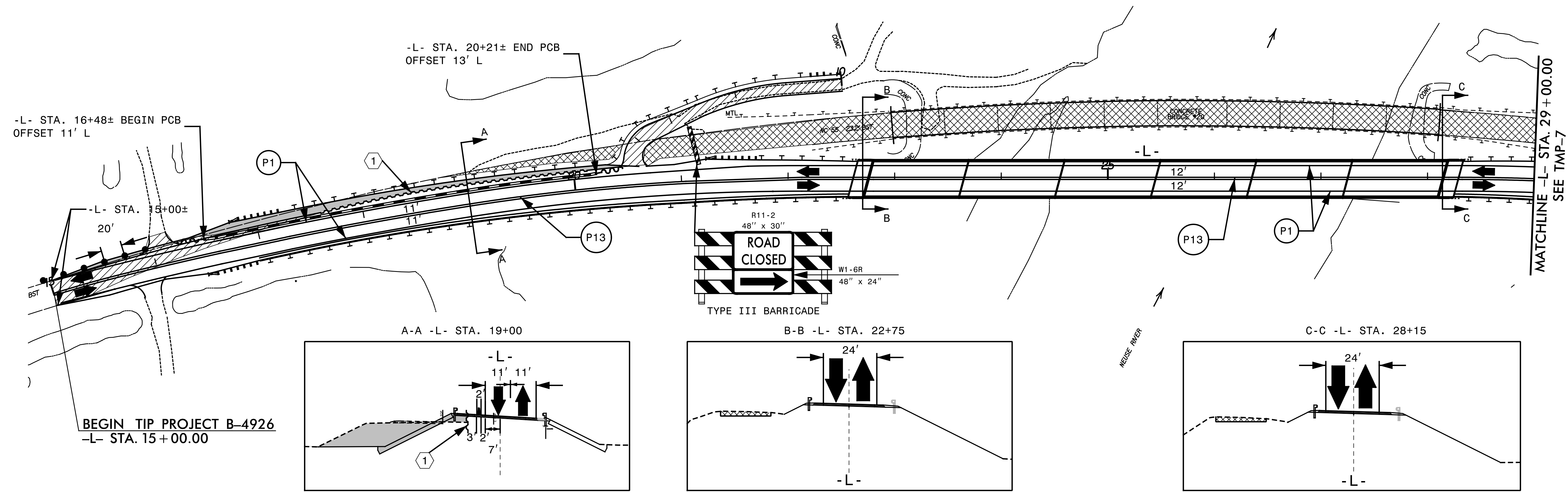
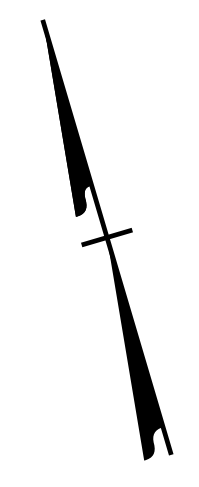

4/4/2004
C:\08\SEB\015.00_B-4926\TP\Traffic\TMP\B-4926_TMP-6.dgn
SEB

APPROVED: _____
DATE: _____

SEAL

**DOCUMENT NOT CONSIDERED FINAL
UNLESS ALL SIGNATURES COMPLETED**

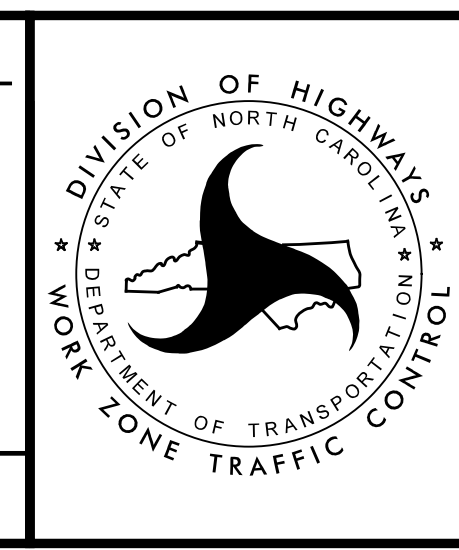

PHASE II

TRANSYSTEMS
1 Glenwood Avenue
Raleigh, NC 27603
Tel: 919.789.9977
Fax: 919.789.9591
License: F-0453

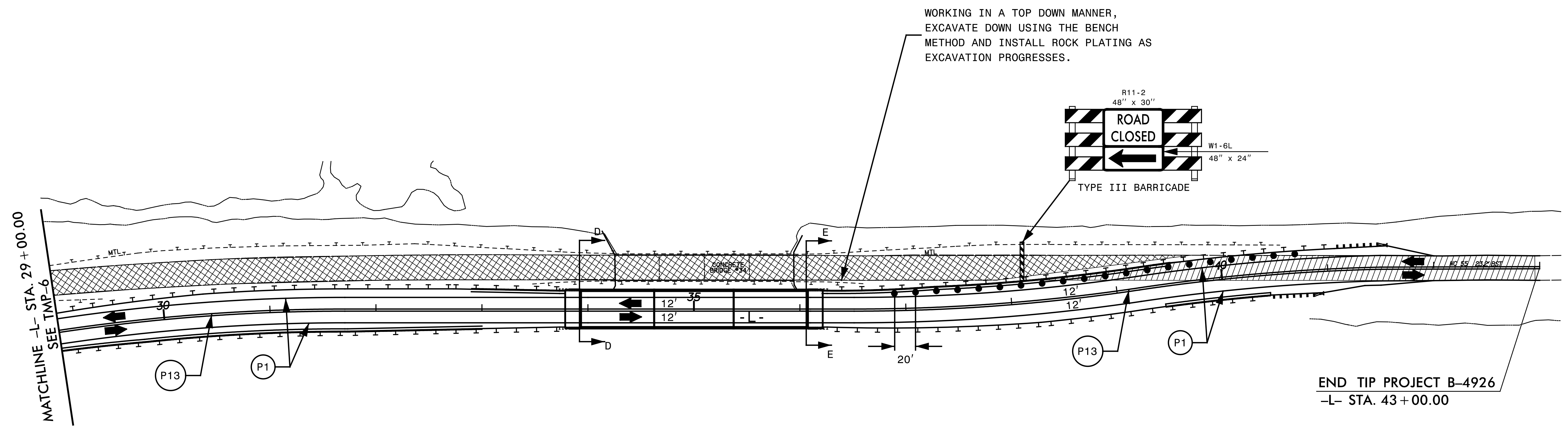
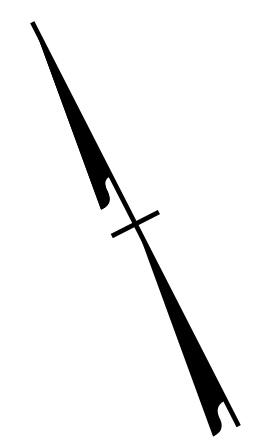

MATCHLINE -L- STA. 29+00.00
SEE TMP-6

END TIP PROJECT B-4926
-L- STA. 43+00.00

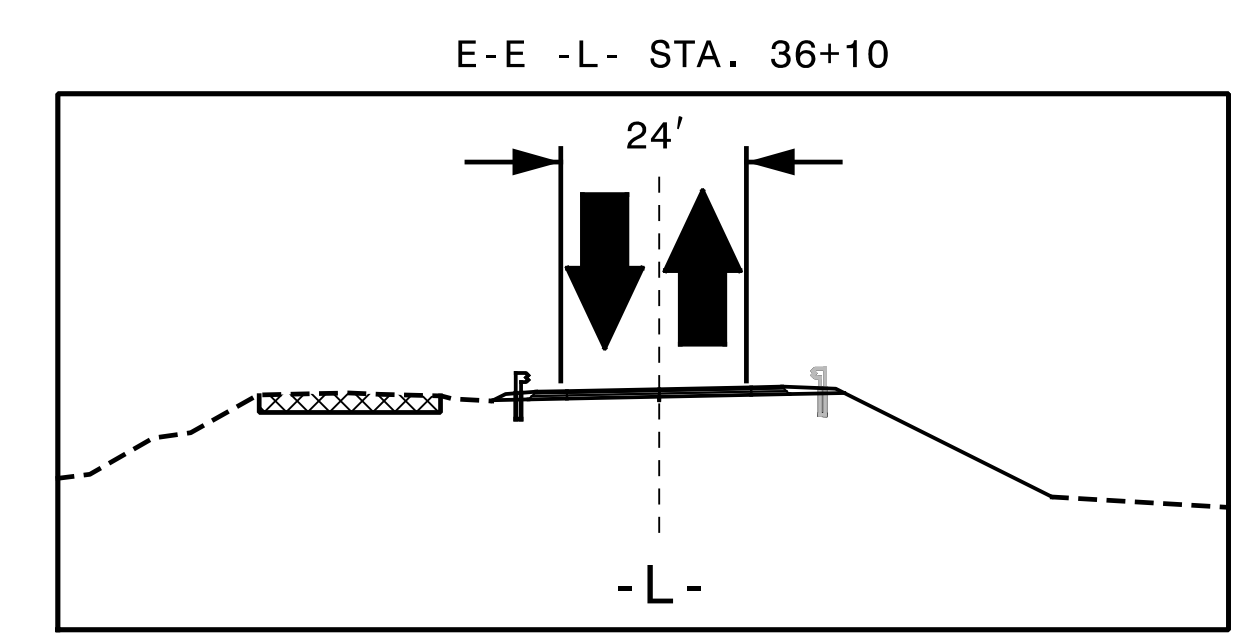
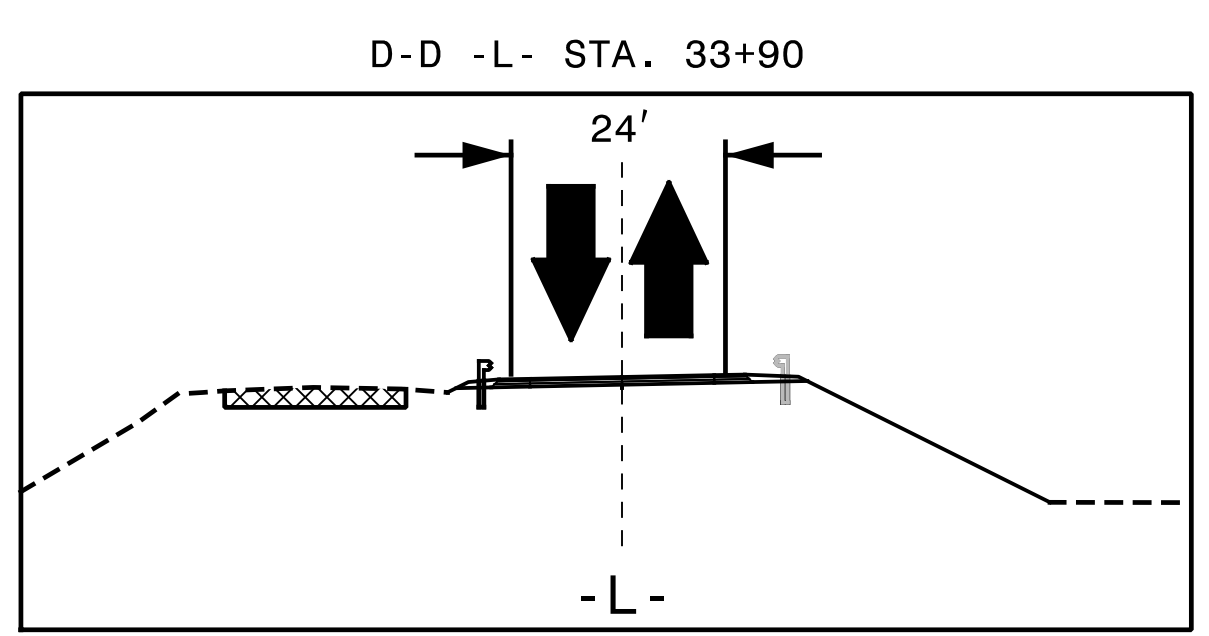

4/4/2004
C:\08\SEB\015.00.B-4926\TP\Traffic\TMPAB-4926.TMP-7.dgn
dbourman

TRANSYSTEMS
1 Glenwood Avenue
Raleigh, NC 27603
Tel: 919.789.9977
Fax: 919.789.9591
License: F-0453

APPROVED: _____
DATE: _____
SEAL

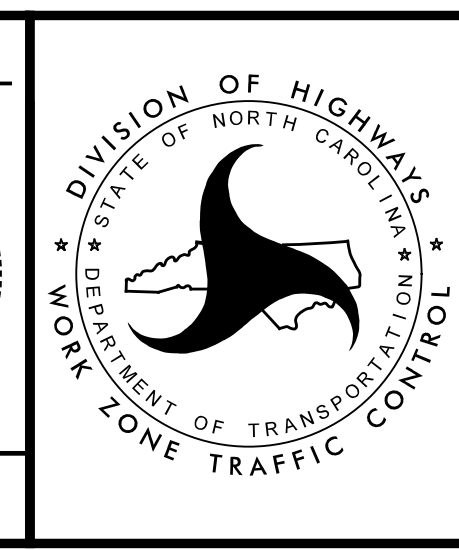

PHASE II

**DOCUMENT NOT CONSIDERED FINAL
UNLESS ALL SIGNATURES COMPLETED**