

2/7/2024 B-4926-Rdy\_psh.dgn

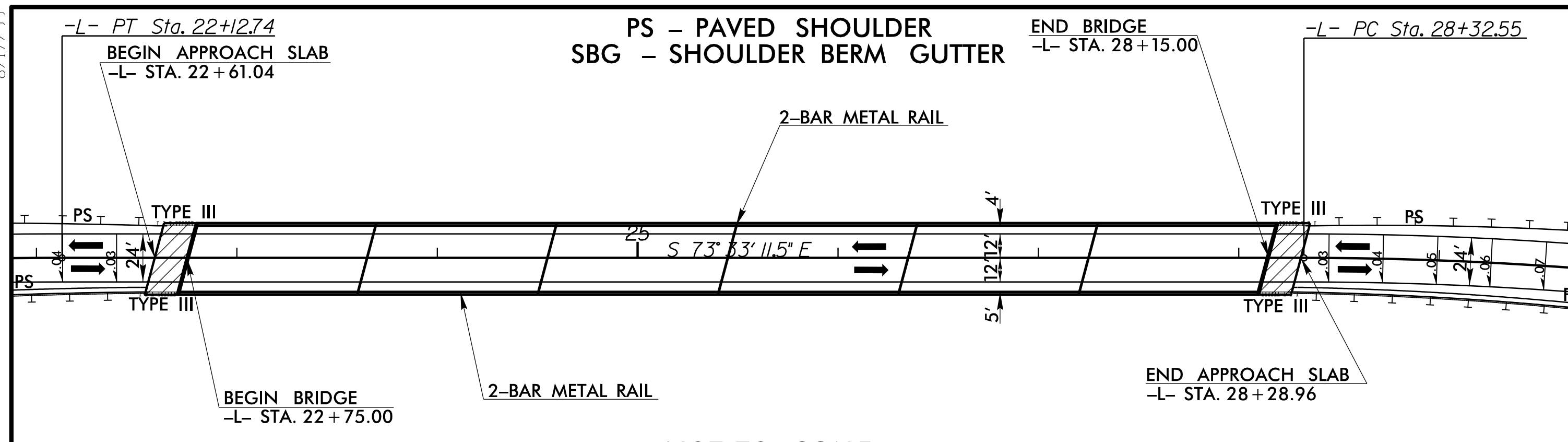

**NOT TO SCALE**  
 Sketch showing Dimensions of Pavement and Shoulder in Relation to Proposed Bridge Width

NOTE: PAVE -DRV- FROM STA. 12+15.00 TO STA. 12+29.88  
 ALL RIP RAP TO BE GRANITE MATERIAL.

-L-	
PI Sta 18+59.98 Δ = 17° 33' 45.4" (RT) D = 2' 28' 10.7" L = 711.4' T = 358.38' R = 2,320.00' SE = .06 RO = 162'	PI Sta 30+02.07 Δ = 10° 38' 32.4" (RT) D = 3' 08' 53.2" L = 338.05' T = 169.51' R = 1,820.00' SE = .07 RO = 189'
-DRV-	
PI Sta 10+95.74 Δ = 19° 45' 49.7" (LT) D = 22' 55' 05.9" L = 86.24' T = 43.55' R = 250.00' SE = SEE PLANS	PI Sta 12+07.18 Δ = 69° 46' 54.4" (LT) D = 190' 59' 09.4" L = 36.54' T = 20.92' R = 30.00' SE = SEE PLANS

**TRANSYSTEMS**  
 1 Glenwood Avenue  
 Raleigh, NC 27603  
 Tel: 919.789.9977  
 Fax: 919.789.9561  
 License: F-0453

PROJECT REFERENCE NO. B-4926	SHEET NO. 4
RW SHEET NO.	HYDRAULICS ENGINEER
ROADWAY DESIGN ENGINEER	PROFESSIONAL SEAL 033871 DAVID W. GARDNER, JR.
	PROFESSIONAL SEAL 035621 ANDREW M. HOWELL
DOCUMENT NOT CONSIDERED FINAL UNLESS ALL SIGNATURES COMPLETED	

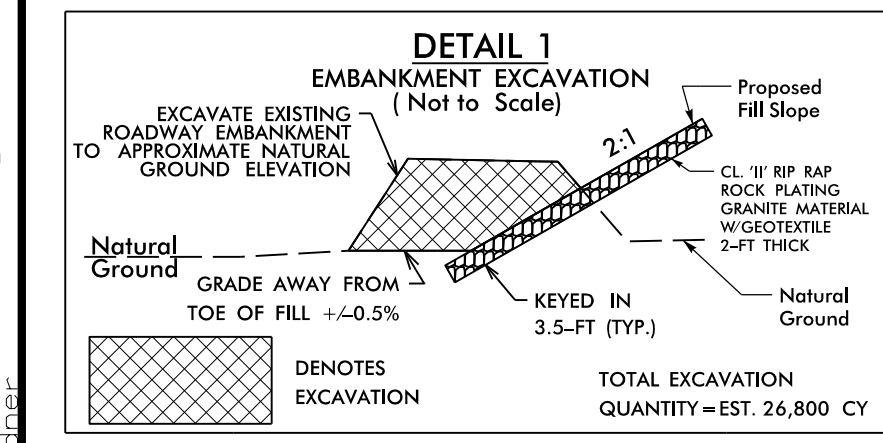
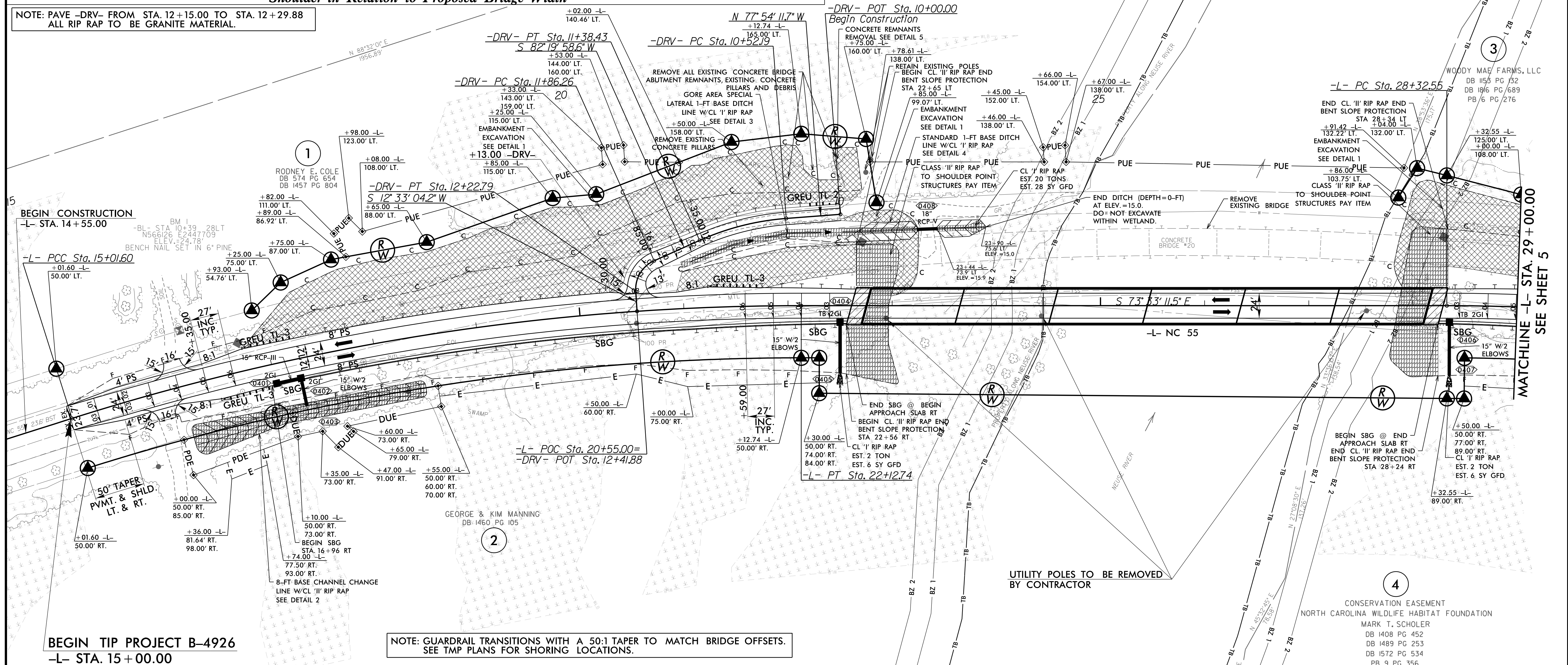

FROM STA. 17+00 TO STA. 23+25 -L- LT  
 FROM STA. 27+81 TO STA. 34+27 -L- LT  
 FROM STA. 35+92 TO STA. 40+00 -L- LT  
 FROM STA. 10+00 TO STA. 12+18 -DRV- LT  
 FROM STA. 10+00 TO STA. 12+18 -DRV- RT

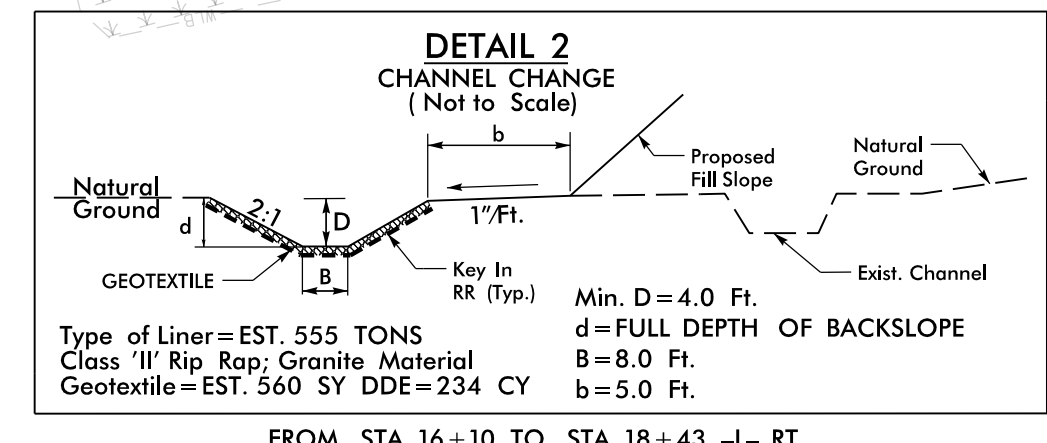

FROM STA. 16+10 TO STA. 18+43 -L- RT

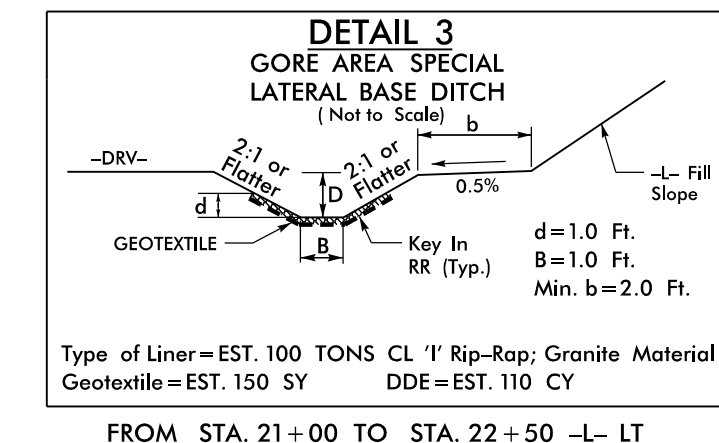

FROM STA. 21+00 TO STA. 22+50 -L- LT

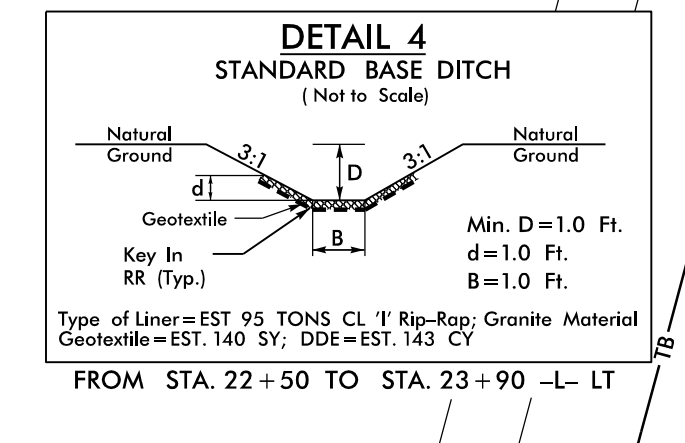

FROM STA. 22+50 TO STA. 23+90 -L- LT

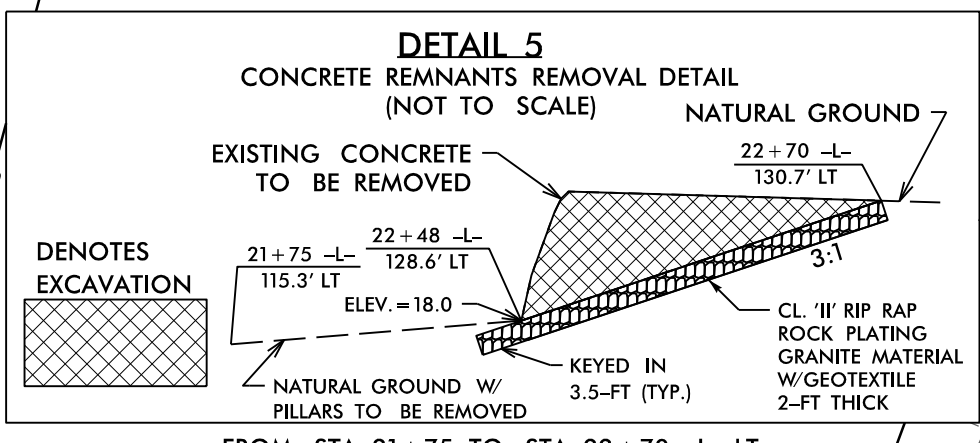

FROM STA. 21+75 TO STA. 22+70 -L- LT

PROVIDE CLASS 'II' RIP RAP ROCK PLATING (GRANITE) ON ALL SLOPES STEEPER THAN 3:1 OR AS INDICATED ON THE PLANS. 2-FT THICK TO SHOULDER POINT. REFER TO STANDARD ROCK PLATING DETAIL (STD 275.01)

SEE SHEET 6 FOR -L- PROFILE  
 SEE SHEET 7 FOR -DRV- PROFILE  
 SEE SHEETS S1-1 THRU S1-49 FOR STRUCTURE PLANS

MATCHLINE -L- STA. 29+00.00  
SEE SHEET 5

**4**  
 CONSERVATION EASEMENT  
 NORTH CAROLINA WILDLIFE HABITAT FOUNDATION  
 MARK T. SCHOLER  
 DB 1408 PG 452  
 DB 1489 PG 253  
 DB 1572 PG 534  
 PB 9 PG 356