



NC DEPARTMENT OF TRANSPORTATION
 DIVISION OF HIGHWAYS
 STRUCTURE MANAGEMENT UNIT

ATTENTION:

TEMPORARY REPAIRS (CAPS) CLEARANCES
 CHECKED

Structure Safety Report

Routine Element Inspection

COUNTY: HAYWOOD STRUCTURE NUMBER: 430248 FREQUENCY: 24 MONTHS

FACILITY CARRIED: I-40 EBL MILE POST: 32.4

LOCATION: 1.1 M.I.E.JCT.NC215

FEATURE INTERSECTED: SR1613

LATITUDE: 35° 33' 20.53" LONGITUDE: 82° 49' 50.99"

REINF. CONCRETE FLOOR ON I-BEAMS(LATEX MODIFIED CONC.OVERLAY)

SUPERSTRUCTURE: REINF. CONCRETE FLOOR ON I-BEAMS(LAYTEX MODIFIED CONC.OVERLAY)

SUBSTRUCTURE: E.BTS:RC CAPS/H-PILES;INT.BTS:RCP&B/PILE FTGS.

SPANS: 1 @ 52'-1.1875,1 @ 60'-6.0625,1 @ 61'-.5625

FRACTURE CRITICAL TEMPORARY SHORING SCOUR CRITICAL SCOUR PLAN OF ACTION

PRESENT CONDITION: Fair INSPECTION DATE: 04/25/2017

POSTED SV: Not Posted POSTED TTST: Not Posted

OTHER SIGNS PRESENT: NONE



| Sign noticed issued for | Number Required |
|---------------------------|-----------------|
| <u>NO</u> WEIGHT LIMIT | <u>0</u> |
| <u>NO</u> DELINEATORS | <u>0</u> |
| <u>NO</u> NARROW BRIDGE | <u>0</u> |
| <u>NO</u> ONE LANE BRIDGE | <u>0</u> |
| <u>NO</u> LOW CLEARANCE | <u>0</u> |

DIRECTION OF INSPECTION W-E

DIRECTION MATCHES PLANS _____

WEST APPROACH LOOKING EAST

| | | |
|------------------------------|---------------|-------------------------------|
| INSPECTED BY DELVIN ADAMS | SIGNATURE | ASSISTED BY JOE HUNTSINGER |
|------------------------------|---------------|-------------------------------|

Structure Element Scoring

Structure Number: 430248

Inspection Date 4/25/2017

| Element Number | Parent Number | Element Name | Location | Total Quantity | Level 1 Quantity | Level 2 Quantity | Level 3 Quantity | Level 4 Quantity |
|----------------|---------------|--------------------------------------|-------------------|----------------|------------------|------------------|------------------|------------------|
| 12 | 0 | Reinforced Concrete Deck | Deck | 5458 | 2338 | 3100 | 20 | 0 |
| 107 | 0 | Steel Open Girder/Beam | Beam | 696 | 0 | 696 | 0 | 0 |
| 515 | 107 | Steel Protective Coating | Beam | 6336 | 4946 | 696 | 574 | 120 |
| 205 | 0 | Reinforced Concrete Column | Piles and Columns | 4 | 4 | 0 | 0 | 0 |
| 215 | 0 | Reinforced Concrete Abutment | Abutments | 84 | 84 | 0 | 0 | 0 |
| 220 | 0 | Reinforced Concrete Pile Cap/Footing | Footing | 22 | 22 | 0 | 0 | 0 |
| 225 | 0 | Steel Pile | Piles and Columns | 12 | 12 | 0 | 0 | 0 |
| 234 | 0 | Reinforced Concrete Pier Cap | Caps | 137 | 108 | 27 | 2 | 0 |
| 302 | 0 | Compression Joint Seal | Expansion Joints | 144 | 144 | 0 | 0 | 0 |
| 311 | 0 | Movable Bearing | Bearing Device | 12 | 0 | 12 | 0 | 0 |
| 515 | 311 | Steel Protective Coating | Bearing Device | 12 | 0 | 0 | 12 | 0 |
| 313 | 0 | Fixed Bearing | Bearing Device | 12 | 0 | 12 | 0 | 0 |
| 515 | 313 | Steel Protective Coating | Bearing Device | 12 | 0 | 0 | 12 | 0 |
| 321 | 0 | Reinforced Concrete Approach Slabs | Approaches | 560 | 520 | 40 | 0 | 0 |
| 333 | 0 | Other Bridge Railing | Bridge Rail | 352 | 176 | 176 | 0 | 0 |
| 515 | 333 | Steel Protective Coating | Bridge Rail | 352 | 352 | 0 | 0 | 0 |
| 510 | 0 | Wearing Surface | Wearing Surfaces | 4864 | 4384 | 480 | 0 | 0 |

Summary of Maintenance Needs

Maintenance By Defect

Structure Number: 430248

Inspection Date: 04/25/2017

| MMS Code | Element Name | Defect Name | Recommended Quantity |
|----------|------------------------------|---|----------------------|
| 3348 | Reinforced Concrete Pier Cap | Patched Area | 2 Feet |
| 3318 | Other Bridge Railing | Damage | 115 Feet |
| 2816 | Wearing Surface | Crack (Wearing Surface) | 450 Square Feet |
| 3342 | Steel Protective Coating | Peeling/Bubbling/Cracking (steel Protective Coatings) | 120 Square Feet |
| 3342 | Steel Protective Coating | Effectiveness (Steel Protective Coatings) | 1294 Square Feet |

Element Structure Maintenance Quantities

Structure Number: 430248

Inspection Date 04/25/2017

| Location | MMS Code | Description | Maint Quantity | Total Quantity | Severe Quantity | Poor Quantity | Fair Quantity | Good Quantity |
|-------------------|----------|---|----------------|----------------|-----------------|---------------|---------------|---------------|
| Abutments | 3350 | Maintenance of Concrete Wings and Wall | 0 | 84 | 0 | 0 | 0 | 84 |
| Approaches | 3353 | Maintenance of Concrete Bridge Approach Slabs | 0 | 560 | 0 | 0 | 40 | 520 |
| Beam | 3314 | Maintenance Steel Superstructure Components | 0 | 696 | 0 | 0 | 696 | 0 |
| Beam | 3342 | Clean and Paint Steel | 1390 | 6336 | 120 | 574 | 696 | 4946 |
| Bearing Device | 3334 | Bridge Bearing | 0 | 24 | 0 | 0 | 24 | 0 |
| Bearing Device | 3342 | Clean and Paint Steel | 24 | 24 | 0 | 24 | 0 | 0 |
| Bridge Rail | 3318 | Maintenance of Concrete Bridge Rail | 115 | 352 | 0 | 0 | 176 | 176 |
| Bridge Rail | 3342 | Clean and Paint Steel | 0 | 352 | 0 | 0 | 0 | 352 |
| Caps | 3348 | Maintenance of Concrete Substructure | 2 | 137 | 0 | 2 | 27 | 108 |
| Deck | 3326 | Maintenance of Concrete Deck | 3120 | 5458 | 0 | 20 | 3100 | 2338 |
| Expansion Joints | 3310 | Maintenance of Standard Bridge Expansion Joints | 0 | 144 | 0 | 0 | 0 | 144 |
| Footing | 3348 | Maintenance of Concrete Substructure | 0 | 22 | 0 | 0 | 0 | 22 |
| Piles and Columns | 3348 | Maintenance of Concrete Substructure | 0 | 4 | 0 | 0 | 0 | 4 |
| Piles and Columns | 3354 | Maintenance of Steel Substructure Components | 0 | 12 | 0 | 0 | 0 | 12 |
| Wearing Surfaces | 2816 | Asphalt Surface Repair | 450 | 4864 | 0 | 0 | 480 | 4384 |

Element Condition and Maintenance Data

Structure Number: 430248

Inspection Date: 04/25/2017

Span 1 **Deck**
Reinforced Concrete Deck

| Element Number | Element Name | Total Qty | CS1 Qty | CS2 Qty | CS3 Qty | CS4 Qty | |
|----------------|--------------------------|-----------|---------|---------|---------|---------|-------------|
| 12 | Reinforced Concrete Deck | 1,637 | 731 | 900 | 6 | 0 | Square Feet |

| Element Number | Defect Type | Defect Description | CS | CS Qty | Maint Qty | |
|------------------|-------------|--------------------|----|--------|-----------|--|
| General Comments | | | | | | |

Span 1 **Beam 1**
Plate Girder

| Element Number | Element Name | Total Qty | CS1 Qty | CS2 Qty | CS3 Qty | CS4 Qty | |
|----------------|--------------------------|-----------|---------|---------|---------|---------|-------------|
| 107 | Steel Open Girder/Beam | 52 | 0 | 52 | 0 | 0 | Feet |
| 515 | Steel Protective Coating | 474 | 370 | 0 | 104 | 0 | Square Feet |

| Element Number | Defect Type | Defect Description | CS | CS Qty | Maint Qty | |
|------------------|---|---|----|--------|-----------|-------------|
| 107 | Corrosion | LOSS OF PAINT ALONG THE TOP OF THE BOTTOM FLANGE ALLOWING 1/16" PITTING ALONG THE FLANGE AND LOWER WEB. | 2 | 52 | | Feet |
| 515 | Effectiveness (Steel Protective Coatings) | LOSS OF PAINT ALONG THE TOP OF THE BOTTOM FLANGE ALLOWING 1/16" PITTING ALONG THE FLANGE AND LOWER WEB. | 3 | 104 | 104 | Square Feet |
| General Comments | | | | | | |

Span 1 **Beam 2**
Plate Girder

| Element Number | Element Name | Total Qty | CS1 Qty | CS2 Qty | CS3 Qty | CS4 Qty | |
|----------------|--------------------------|-----------|---------|---------|---------|---------|-------------|
| 107 | Steel Open Girder/Beam | 52 | 0 | 52 | 0 | 0 | Feet |
| 515 | Steel Protective Coating | 474 | 370 | 104 | 0 | 0 | Square Feet |

| Element Number | Defect Type | Defect Description | CS | CS Qty | Maint Qty | |
|------------------|---|--|----|--------|-----------|-------------|
| 107 | Corrosion | FRECKLED RUST ALONG THE BOTTOM FLANGE AND LOWER 2" OF THE WEB. | 2 | 52 | | Feet |
| 515 | Effectiveness (Steel Protective Coatings) | FRECKLED RUST ALONG THE BOTTOM FLANGE AND LOWER 2" OF THE WEB. | 2 | 104 | 104 | Square Feet |
| General Comments | | | | | | |

Span 1 **Beam 3**
Plate Girder

| Element Number | Element Name | Total Qty | CS1 Qty | CS2 Qty | CS3 Qty | CS4 Qty | |
|----------------|--------------------------|-----------|---------|---------|---------|---------|-------------|
| 107 | Steel Open Girder/Beam | 52 | 0 | 52 | 0 | 0 | Feet |
| 515 | Steel Protective Coating | 474 | 370 | 104 | 0 | 0 | Square Feet |

| Element Number | Defect Type | Defect Description | CS | CS Qty | Maint Qty | |
|----------------|-------------|--|----|--------|-----------|------|
| 107 | Corrosion | FRECKLED RUST ALONG THE BOTTOM FLANGE AND LOWER 2" OF THE WEB. | 2 | 52 | | Feet |

| | | | | | | |
|------------------|---|--|---|-----|-----|-------------|
| 515 | Effectiveness (Steel Protective Coatings) | FRECKLED RUST ALONG THE BOTTOM FLANGE AND LOWER 2" OF THE WEB. | 2 | 104 | 104 | Square Feet |
| General Comments | | | | | | |

Span 1 Beam 4

Plate Girder

| Element Number | Element Name | Total Qty | CS1 Qty | CS2 Qty | CS3 Qty | CS4 Qty |
|----------------|--------------------------|-----------|---------|---------|---------|---------------|
| 107 | Steel Open Girder/Beam | 52 | 0 | 52 | 0 | 0 Feet |
| 515 | Steel Protective Coating | 474 | 370 | 0 | 104 | 0 Square Feet |

| Element Number | Defect Type | Defect Description | CS | CS Qty | Maint Qty |
|----------------|---|---|----|--------|-----------------|
| 107 | Corrosion | LOSS OF PAINT ALONG THE TOP OF THE BOTTOM FLANGE ALLOWING 1/16" PITTING ALONG THE FLANGE AND LOWER WEB. | 2 | 52 | Feet |
| 515 | Effectiveness (Steel Protective Coatings) | LOSS OF PAINT ALONG THE TOP OF THE BOTTOM FLANGE ALLOWING 1/16" PITTING ALONG THE FLANGE AND LOWER WEB. | 3 | 104 | 104 Square Feet |

General Comments

Span 1 Left Bridge Rail

Concrete and Metal Railing

| Element Number | Element Name | Total Qty | CS1 Qty | CS2 Qty | CS3 Qty | CS4 Qty |
|----------------|--------------------------|-----------|---------|---------|---------|---------------|
| 333 | Other Bridge Railing | 53 | 0 | 53 | 0 | 0 Feet |
| 515 | Steel Protective Coating | 53 | 53 | 0 | 0 | 0 Square Feet |

| Element Number | Defect Type | Defect Description | CS | CS Qty | Maint Qty |
|----------------|-------------|---|----|--------|-----------|
| 333 | Damage | THE LEFT RAIL HAS MINOR SCRAPE DAMAGE, WITH SOME TEARS IN THE STEEL FOR THE FULL LENGTH IN ALL SPANS. | 2 | 53 | 53 Feet |

General Comments

Span 1 Near Bearing

Fixed Bearing

| Element Number | Element Name | Total Qty | CS1 Qty | CS2 Qty | CS3 Qty | CS4 Qty |
|----------------|--------------------------|-----------|---------|---------|---------|---------------|
| 313 | Fixed Bearing | 1 | 0 | 1 | 0 | 0 Each |
| 515 | Steel Protective Coating | 1 | 0 | 0 | 1 | 0 Square Feet |

| Element Number | Defect Type | Defect Description | CS | CS Qty | Maint Qty |
|----------------|---|---|----|--------|---------------|
| 313 | Corrosion | LOSS OF PAINT ALLOWING SURFACE CORROSION ON THE BEARING PLATES. | 2 | 1 | Each |
| 515 | Effectiveness (Steel Protective Coatings) | LOSS OF PAINT ALLOWING SURFACE CORROSION ON THE BEARING PLATES. | 3 | 1 | 1 Square Feet |

General Comments

Span 1 Far Bearing
Movable Bearing

| Element Number | Element Name | Total Qty | CS1 Qty | CS2 Qty | CS3 Qty | CS4 Qty | |
|----------------|--------------------------|-----------|---------|---------|---------|---------|-------------|
| 311 | Movable Bearing | 1 | 0 | 1 | 0 | 0 | Each |
| 515 | Steel Protective Coating | 1 | 0 | 0 | 1 | 0 | Square Feet |

| Element Number | Defect Type | Defect Description | CS | CS Qty | Maint Qty | |
|----------------|---|---|----|--------|-----------|-------------|
| 311 | Corrosion | LOSS OF PAINT ALLOWING SURFACE CORROSION ON THE BEARING PLATES. | 2 | 1 | | Each |
| 515 | Effectiveness (Steel Protective Coatings) | LOSS OF PAINT ALLOWING SURFACE CORROSION ON THE BEARING PLATES. | 3 | 1 | 1 | Square Feet |

General Comments

Span 1 Near Bearing
Fixed Bearing

| Element Number | Element Name | Total Qty | CS1 Qty | CS2 Qty | CS3 Qty | CS4 Qty | |
|----------------|--------------------------|-----------|---------|---------|---------|---------|-------------|
| 313 | Fixed Bearing | 1 | 0 | 1 | 0 | 0 | Each |
| 515 | Steel Protective Coating | 1 | 0 | 0 | 1 | 0 | Square Feet |

| Element Number | Defect Type | Defect Description | CS | CS Qty | Maint Qty | |
|----------------|---|---|----|--------|-----------|-------------|
| 313 | Corrosion | LOSS OF PAINT ALLOWING SURFACE CORROSION ON THE BEARING PLATES. | 2 | 1 | | Each |
| 515 | Effectiveness (Steel Protective Coatings) | LOSS OF PAINT ALLOWING SURFACE CORROSION ON THE BEARING PLATES. | 3 | 1 | 1 | Square Feet |

General Comments

Span 1 Far Bearing
Movable Bearing

| Element Number | Element Name | Total Qty | CS1 Qty | CS2 Qty | CS3 Qty | CS4 Qty | |
|----------------|--------------------------|-----------|---------|---------|---------|---------|-------------|
| 311 | Movable Bearing | 1 | 0 | 1 | 0 | 0 | Each |
| 515 | Steel Protective Coating | 1 | 0 | 0 | 1 | 0 | Square Feet |

| Element Number | Defect Type | Defect Description | CS | CS Qty | Maint Qty | |
|----------------|---|---|----|--------|-----------|-------------|
| 311 | Corrosion | LOSS OF PAINT ALLOWING SURFACE CORROSION ON THE BEARING PLATES. | 2 | 1 | | Each |
| 515 | Effectiveness (Steel Protective Coatings) | LOSS OF PAINT ALLOWING SURFACE CORROSION ON THE BEARING PLATES. | 3 | 1 | 1 | Square Feet |

General Comments

Span 1 Near Bearing
Fixed Bearing

| Element Number | Element Name | Total Qty | CS1 Qty | CS2 Qty | CS3 Qty | CS4 Qty | |
|----------------|--------------------------|-----------|---------|---------|---------|---------|-------------|
| 313 | Fixed Bearing | 1 | 0 | 1 | 0 | 0 | Each |
| 515 | Steel Protective Coating | 1 | 0 | 0 | 1 | 0 | Square Feet |

| Element Number | Defect Type | Defect Description | CS | CS Qty | Maint Qty | |
|----------------|-------------|---|----|--------|-----------|------|
| 313 | Corrosion | LOSS OF PAINT ALLOWING SURFACE CORROSION ON THE BEARING PLATES. | 2 | 1 | | Each |

| | | | | | | |
|------------------|---|---|---|---|---|-------------|
| 515 | Effectiveness (Steel Protective Coatings) | LOSS OF PAINT ALLOWING SURFACE CORROSION ON THE BEARING PLATES. | 3 | 1 | 1 | Square Feet |
| General Comments | | | | | | |

Span 1 Far Bearing
Movable Bearing

| Element Number | Element Name | Total Qty | CS1 Qty | CS2 Qty | CS3 Qty | CS4 Qty |
|----------------|--------------------------|-----------|---------|---------|---------|---------------|
| 311 | Movable Bearing | 1 | 0 | 1 | 0 | 0 Each |
| 515 | Steel Protective Coating | 1 | 0 | 0 | 1 | 0 Square Feet |

| Element Number | Defect Type | Defect Description | CS | CS Qty | Maint Qty |
|------------------|---|---|----|--------|---------------|
| 311 | Corrosion | LOSS OF PAINT ALLOWING SURFACE CORROSION ON THE BEARING PLATES. | 2 | 1 | Each |
| 515 | Effectiveness (Steel Protective Coatings) | LOSS OF PAINT ALLOWING SURFACE CORROSION ON THE BEARING PLATES. | 3 | 1 | 1 Square Feet |
| General Comments | | | | | |

Span 1 Near Bearing
Fixed Bearing

| Element Number | Element Name | Total Qty | CS1 Qty | CS2 Qty | CS3 Qty | CS4 Qty |
|----------------|--------------------------|-----------|---------|---------|---------|---------------|
| 313 | Fixed Bearing | 1 | 0 | 1 | 0 | 0 Each |
| 515 | Steel Protective Coating | 1 | 0 | 0 | 1 | 0 Square Feet |

| Element Number | Defect Type | Defect Description | CS | CS Qty | Maint Qty |
|------------------|---|---|----|--------|---------------|
| 313 | Corrosion | LOSS OF PAINT ALLOWING SURFACE CORROSION ON THE BEARING PLATES. | 2 | 1 | Each |
| 515 | Effectiveness (Steel Protective Coatings) | LOSS OF PAINT ALLOWING SURFACE CORROSION ON THE BEARING PLATES. | 3 | 1 | 1 Square Feet |
| General Comments | | | | | |

Span 1 Far Bearing
Movable Bearing

| Element Number | Element Name | Total Qty | CS1 Qty | CS2 Qty | CS3 Qty | CS4 Qty |
|----------------|--------------------------|-----------|---------|---------|---------|---------------|
| 311 | Movable Bearing | 1 | 0 | 1 | 0 | 0 Each |
| 515 | Steel Protective Coating | 1 | 0 | 0 | 1 | 0 Square Feet |

| Element Number | Defect Type | Defect Description | CS | CS Qty | Maint Qty |
|------------------|---|---|----|--------|---------------|
| 311 | Corrosion | LOSS OF PAINT ALLOWING SURFACE CORROSION ON THE BEARING PLATES. | 2 | 1 | Each |
| 515 | Effectiveness (Steel Protective Coatings) | LOSS OF PAINT ALLOWING SURFACE CORROSION ON THE BEARING PLATES. | 3 | 1 | 1 Square Feet |
| General Comments | | | | | |

Span 1

Latex Modified Concrete Wearing Surface

Concrete Wearing Surface

| Element Number | Element Name | Total Qty | CS1 Qty | CS2 Qty | CS3 Qty | CS4 Qty | |
|----------------|-----------------|-----------|---------|---------|---------|---------|-------------|
| 510 | Wearing Surface | 1,459 | 1,279 | 180 | 0 | 0 | Square Feet |

| Element Number | Defect Type | Defect Description | CS | CS Qty | Maint Qty | |
|----------------|--|---|----|--------|-----------|-------------|
| 510 | Crack (Wearing Surface) | WEARING SURFACE HAS SCATTERED MAP CRACKS UP TO 1/16" WIDE. | 2 | 150 | 150 | Square Feet |
| 510 | Patched Area/Pothole (Wearing Surface) | RIGHT LANE HAS A 5' WIDE X 6' LONG PATCH IN GOOD CONDITION. | 2 | 30 | | Square Feet |

General Comments

Span 2

Deck

Reinforced Concrete Deck

| Element Number | Element Name | Total Qty | CS1 Qty | CS2 Qty | CS3 Qty | CS4 Qty | |
|----------------|--------------------------|-----------|---------|---------|---------|---------|-------------|
| 12 | Reinforced Concrete Deck | 1,902 | 794 | 1,100 | 8 | 0 | Square Feet |

| Element Number | Defect Type | Defect Description | CS | CS Qty | Maint Qty | |
|----------------|-------------|--------------------|----|--------|-----------|--|
|----------------|-------------|--------------------|----|--------|-----------|--|

General Comments

Span 2

Beam 1

Plate Girder

| Element Number | Element Name | Total Qty | CS1 Qty | CS2 Qty | CS3 Qty | CS4 Qty | |
|----------------|--------------------------|-----------|---------|---------|---------|---------|-------------|
| 107 | Steel Open Girder/Beam | 61 | 0 | 61 | 0 | 0 | Feet |
| 515 | Steel Protective Coating | 555 | 433 | 0 | 122 | 0 | Square Feet |

| Element Number | Defect Type | Defect Description | CS | CS Qty | Maint Qty | |
|----------------|---|---|----|--------|-----------|-------------|
| 107 | Corrosion | LOSS OF PAINT ALONG THE TOP OF THE BOTTOM FLANGE ALLOWING 1/16" PITTING ALONG THE FLANGE AND LOWER WEB. | 2 | 61 | | Feet |
| 515 | Effectiveness (Steel Protective Coatings) | LOSS OF PAINT ALONG THE TOP OF THE BOTTOM FLANGE ALLOWING 1/16" PITTING ALONG THE FLANGE AND LOWER WEB. | 3 | 122 | 122 | Square Feet |

General Comments

Span 2

Beam 2

Plate Girder

| Element Number | Element Name | Total Qty | CS1 Qty | CS2 Qty | CS3 Qty | CS4 Qty | |
|----------------|--------------------------|-----------|---------|---------|---------|---------|-------------|
| 107 | Steel Open Girder/Beam | 61 | 0 | 61 | 0 | 0 | Feet |
| 515 | Steel Protective Coating | 555 | 433 | 122 | 0 | 0 | Square Feet |

| Element Number | Defect Type | Defect Description | CS | CS Qty | Maint Qty | |
|----------------|---|--|----|--------|-----------|-------------|
| 107 | Corrosion | FRECKLED RUST ALONG THE BOTTOM FLANGE AND LOWER 2" OF THE WEB. | 2 | 61 | | Feet |
| 515 | Effectiveness (Steel Protective Coatings) | FRECKLED RUST ALONG THE BOTTOM FLANGE AND LOWER 2" OF THE WEB. | 2 | 122 | 122 | Square Feet |

General Comments

Span 2 **Beam 3**
Plate Girder

| Element Number | Element Name | Total Qty | CS1 Qty | CS2 Qty | CS3 Qty | CS4 Qty | |
|----------------|--------------------------|-----------|---------|---------|---------|---------|-------------|
| 107 | Steel Open Girder/Beam | 61 | 0 | 61 | 0 | 0 | Feet |
| 515 | Steel Protective Coating | 555 | 433 | 122 | 0 | 0 | Square Feet |

| Element Number | Defect Type | Defect Description | CS | CS Qty | Maint Qty | |
|----------------|---|--|----|--------|-----------|-------------|
| 107 | Corrosion | FRECKLED RUST ALONG THE BOTTOM FLANGE AND LOWER 2" OF THE WEB. | 2 | 61 | | Feet |
| 515 | Effectiveness (Steel Protective Coatings) | FRECKLED RUST ALONG THE BOTTOM FLANGE AND LOWER 2" OF THE WEB. | 2 | 122 | 122 | Square Feet |

General Comments

Span 2 **Beam 4**
Plate Girder

| Element Number | Element Name | Total Qty | CS1 Qty | CS2 Qty | CS3 Qty | CS4 Qty | |
|----------------|--------------------------|-----------|---------|---------|---------|---------|-------------|
| 107 | Steel Open Girder/Beam | 61 | 0 | 61 | 0 | 0 | Feet |
| 515 | Steel Protective Coating | 555 | 433 | 0 | 122 | 0 | Square Feet |

| Element Number | Defect Type | Defect Description | CS | CS Qty | Maint Qty | |
|----------------|---|---|----|--------|-----------|-------------|
| 107 | Corrosion | LOSS OF PAINT ALONG THE TOP OF THE BOTTOM FLANGE ALLOWING 1/16" PITTING ALONG THE FLANGE AND LOWER WEB. | 2 | 61 | | Feet |
| 515 | Effectiveness (Steel Protective Coatings) | LOSS OF PAINT ALONG THE TOP OF THE BOTTOM FLANGE ALLOWING 1/16" PITTING ALONG THE FLANGE AND LOWER WEB. | 3 | 122 | 122 | Square Feet |

General Comments

Span 2 **Left Bridge Rail**
Concrete and Metal Railing

| Element Number | Element Name | Total Qty | CS1 Qty | CS2 Qty | CS3 Qty | CS4 Qty | |
|----------------|--------------------------|-----------|---------|---------|---------|---------|-------------|
| 333 | Other Bridge Railing | 61 | 0 | 61 | 0 | 0 | Feet |
| 515 | Steel Protective Coating | 61 | 61 | 0 | 0 | 0 | Square Feet |

| Element Number | Defect Type | Defect Description | CS | CS Qty | Maint Qty | |
|----------------|-------------|---|----|--------|-----------|------|
| 333 | Damage | THE LEFT RAIL HAS MINOR SCRAPE DAMAGE, WITH SOME TEARS IN THE STEEL FOR THE FULL LENGTH IN ALL SPANS. | 2 | 61 | | Feet |

General Comments

Span 2 **Near Bearing**
Fixed Bearing

| Element Number | Element Name | Total Qty | CS1 Qty | CS2 Qty | CS3 Qty | CS4 Qty | |
|----------------|--------------------------|-----------|---------|---------|---------|---------|-------------|
| 313 | Fixed Bearing | 1 | 0 | 1 | 0 | 0 | Each |
| 515 | Steel Protective Coating | 1 | 0 | 0 | 1 | 0 | Square Feet |

| Element Number | Defect Type | Defect Description | CS | CS Qty | Maint Qty | |
|----------------|-------------|--------------------|----|--------|-----------|--|
|----------------|-------------|--------------------|----|--------|-----------|--|

| | | | | | |
|-----|---|---|---|---|---------------|
| 313 | Corrosion | LOSS OF PAINT ALLOWING SURFACE CORROSION ON THE BEARING PLATES. | 2 | 1 | Each |
| 515 | Effectiveness (Steel Protective Coatings) | LOSS OF PAINT ALLOWING SURFACE CORROSION ON THE BEARING PLATES. | 3 | 1 | 1 Square Feet |

General Comments

Span 2 Far Bearing

Movable Bearing

| Element Number | Element Name | Total Qty | CS1 Qty | CS2 Qty | CS3 Qty | CS4 Qty |
|----------------|--------------------------|-----------|---------|---------|---------|---------------|
| 311 | Movable Bearing | 1 | 0 | 1 | 0 | 0 Each |
| 515 | Steel Protective Coating | 1 | 0 | 0 | 1 | 0 Square Feet |

| Element Number | Defect Type | Defect Description | CS | CS Qty | Maint Qty |
|----------------|---|---|----|--------|---------------|
| 311 | Corrosion | LOSS OF PAINT ALLOWING SURFACE CORROSION ON THE BEARING PLATES. | 2 | 1 | Each |
| 515 | Effectiveness (Steel Protective Coatings) | LOSS OF PAINT ALLOWING SURFACE CORROSION ON THE BEARING PLATES. | 3 | 1 | 1 Square Feet |

General Comments

Span 2 Near Bearing

Fixed Bearing

| Element Number | Element Name | Total Qty | CS1 Qty | CS2 Qty | CS3 Qty | CS4 Qty |
|----------------|--------------------------|-----------|---------|---------|---------|---------------|
| 313 | Fixed Bearing | 1 | 0 | 1 | 0 | 0 Each |
| 515 | Steel Protective Coating | 1 | 0 | 0 | 1 | 0 Square Feet |

| Element Number | Defect Type | Defect Description | CS | CS Qty | Maint Qty |
|----------------|---|---|----|--------|---------------|
| 313 | Corrosion | LOSS OF PAINT ALLOWING SURFACE CORROSION ON THE BEARING PLATES. | 2 | 1 | Each |
| 515 | Effectiveness (Steel Protective Coatings) | LOSS OF PAINT ALLOWING SURFACE CORROSION ON THE BEARING PLATES. | 3 | 1 | 1 Square Feet |

General Comments

Span 2 Far Bearing

Movable Bearing

| Element Number | Element Name | Total Qty | CS1 Qty | CS2 Qty | CS3 Qty | CS4 Qty |
|----------------|--------------------------|-----------|---------|---------|---------|---------------|
| 311 | Movable Bearing | 1 | 0 | 1 | 0 | 0 Each |
| 515 | Steel Protective Coating | 1 | 0 | 0 | 1 | 0 Square Feet |

| Element Number | Defect Type | Defect Description | CS | CS Qty | Maint Qty |
|----------------|---|---|----|--------|---------------|
| 311 | Corrosion | LOSS OF PAINT ALLOWING SURFACE CORROSION ON THE BEARING PLATES. | 2 | 1 | Each |
| 515 | Effectiveness (Steel Protective Coatings) | LOSS OF PAINT ALLOWING SURFACE CORROSION ON THE BEARING PLATES. | 3 | 1 | 1 Square Feet |

General Comments

Span 2 Near Bearing
Fixed Bearing

| Element Number | Element Name | Total Qty | CS1 Qty | CS2 Qty | CS3 Qty | CS4 Qty | |
|----------------|--------------------------|-----------|---------|---------|---------|---------|-------------|
| 313 | Fixed Bearing | 1 | 0 | 1 | 0 | 0 | Each |
| 515 | Steel Protective Coating | 1 | 0 | 0 | 1 | 0 | Square Feet |

| Element Number | Defect Type | Defect Description | CS | CS Qty | Maint Qty | |
|----------------|---|---|----|--------|-----------|-------------|
| 313 | Corrosion | LOSS OF PAINT ALLOWING SURFACE CORROSION ON THE BEARING PLATES. | 2 | 1 | | Each |
| 515 | Effectiveness (Steel Protective Coatings) | LOSS OF PAINT ALLOWING SURFACE CORROSION ON THE BEARING PLATES. | 3 | 1 | 1 | Square Feet |

General Comments

Span 2 Far Bearing
Movable Bearing

| Element Number | Element Name | Total Qty | CS1 Qty | CS2 Qty | CS3 Qty | CS4 Qty | |
|----------------|--------------------------|-----------|---------|---------|---------|---------|-------------|
| 311 | Movable Bearing | 1 | 0 | 1 | 0 | 0 | Each |
| 515 | Steel Protective Coating | 1 | 0 | 0 | 1 | 0 | Square Feet |

| Element Number | Defect Type | Defect Description | CS | CS Qty | Maint Qty | |
|----------------|---|---|----|--------|-----------|-------------|
| 311 | Corrosion | LOSS OF PAINT ALLOWING SURFACE CORROSION ON THE BEARING PLATES. | 2 | 1 | | Each |
| 515 | Effectiveness (Steel Protective Coatings) | LOSS OF PAINT ALLOWING SURFACE CORROSION ON THE BEARING PLATES. | 3 | 1 | 1 | Square Feet |

General Comments

Span 2 Near Bearing
Fixed Bearing

| Element Number | Element Name | Total Qty | CS1 Qty | CS2 Qty | CS3 Qty | CS4 Qty | |
|----------------|--------------------------|-----------|---------|---------|---------|---------|-------------|
| 313 | Fixed Bearing | 1 | 0 | 1 | 0 | 0 | Each |
| 515 | Steel Protective Coating | 1 | 0 | 0 | 1 | 0 | Square Feet |

| Element Number | Defect Type | Defect Description | CS | CS Qty | Maint Qty | |
|----------------|---|---|----|--------|-----------|-------------|
| 313 | Corrosion | LOSS OF PAINT ALLOWING SURFACE CORROSION ON THE BEARING PLATES. | 2 | 1 | | Each |
| 515 | Effectiveness (Steel Protective Coatings) | LOSS OF PAINT ALLOWING SURFACE CORROSION ON THE BEARING PLATES. | 3 | 1 | 1 | Square Feet |

General Comments

Span 2 Far Bearing
Movable Bearing

| Element Number | Element Name | Total Qty | CS1 Qty | CS2 Qty | CS3 Qty | CS4 Qty | |
|----------------|--------------------------|-----------|---------|---------|---------|---------|-------------|
| 311 | Movable Bearing | 1 | 0 | 1 | 0 | 0 | Each |
| 515 | Steel Protective Coating | 1 | 0 | 0 | 1 | 0 | Square Feet |

| Element Number | Defect Type | Defect Description | CS | CS Qty | Maint Qty | |
|----------------|-------------|---|----|--------|-----------|------|
| 311 | Corrosion | LOSS OF PAINT ALLOWING SURFACE CORROSION ON THE BEARING PLATES. | 2 | 1 | | Each |

| | | | | | |
|-----|---|---|---|---|---------------|
| 515 | Effectiveness (Steel Protective Coatings) | LOSS OF PAINT ALLOWING SURFACE CORROSION ON THE BEARING PLATES. | 3 | 1 | 1 Square Feet |
|-----|---|---|---|---|---------------|

General Comments

Span 2 Latex Modified Concrete Wearing Surface

Concrete Wearing Surface

| Element Number | Element Name | Total Qty | CS1 Qty | CS2 Qty | CS3 Qty | CS4 Qty | |
|----------------|-----------------|-----------|---------|---------|---------|---------|-------------|
| 510 | Wearing Surface | 1,695 | 1,545 | 150 | 0 | 0 | Square Feet |

| Element Number | Defect Type | Defect Description | CS | CS Qty | Maint Qty | |
|----------------|-------------------------|--|----|--------|-----------|-------------|
| 510 | Crack (Wearing Surface) | WEARING SURFACE HAS SCATTERED MAP CRACKS UP TO 1/16" WIDE. | 2 | 150 | 150 | Square Feet |

General Comments

Span 3 Deck

Reinforced Concrete Deck

| Element Number | Element Name | Total Qty | CS1 Qty | CS2 Qty | CS3 Qty | CS4 Qty | |
|----------------|--------------------------|-----------|---------|---------|---------|---------|-------------|
| 12 | Reinforced Concrete Deck | 1,919 | 813 | 1,100 | 6 | 0 | Square Feet |

| Element Number | Defect Type | Defect Description | CS | CS Qty | Maint Qty | |
|----------------|-------------|--------------------|----|--------|-----------|--|
|----------------|-------------|--------------------|----|--------|-----------|--|

General Comments

Span 3 Beam 1

Plate Girder

| Element Number | Element Name | Total Qty | CS1 Qty | CS2 Qty | CS3 Qty | CS4 Qty | |
|----------------|--------------------------|-----------|---------|---------|---------|---------|-------------|
| 107 | Steel Open Girder/Beam | 61 | 0 | 61 | 0 | 0 | Feet |
| 515 | Steel Protective Coating | 555 | 433 | 0 | 122 | 0 | Square Feet |

| Element Number | Defect Type | Defect Description | CS | CS Qty | Maint Qty | |
|----------------|---|---|----|--------|-----------|-------------|
| 107 | Corrosion | LOSS OF PAINT ALONG THE TOP OF THE BOTTOM FLANGE ALLOWING 1/16" PITTING ALONG THE FLANGE AND LOWER WEB. | 2 | 61 | | Feet |
| 515 | Effectiveness (Steel Protective Coatings) | LOSS OF PAINT ALONG THE TOP OF THE BOTTOM FLANGE ALLOWING 1/16" PITTING ALONG THE FLANGE AND LOWER WEB. | 3 | 122 | 122 | Square Feet |

General Comments

Span 3 Beam 2

Plate Girder

| Element Number | Element Name | Total Qty | CS1 Qty | CS2 Qty | CS3 Qty | CS4 Qty | |
|----------------|--------------------------|-----------|---------|---------|---------|---------|-------------|
| 107 | Steel Open Girder/Beam | 61 | 0 | 61 | 0 | 0 | Feet |
| 515 | Steel Protective Coating | 555 | 433 | 122 | 0 | 0 | Square Feet |

| Element Number | Defect Type | Defect Description | CS | CS Qty | Maint Qty | |
|----------------|-------------|--|----|--------|-----------|------|
| 107 | Corrosion | FRECKLED RUST ALONG THE BOTTOM FLANGE AND LOWER 2" OF THE WEB. | 2 | 61 | | Feet |

| | | | | | | |
|------------------|---|--|---|-----|-----|-------------|
| 515 | Effectiveness (Steel Protective Coatings) | FRECKLED RUST ALONG THE BOTTOM FLANGE AND LOWER 2" OF THE WEB. | 2 | 122 | 122 | Square Feet |
| General Comments | | | | | | |

Span 3 **Beam 3**
Plate Girder

| Element Number | Element Name | Total Qty | CS1 Qty | CS2 Qty | CS3 Qty | CS4 Qty |
|----------------|--------------------------|-----------|---------|---------|---------|---------------|
| 107 | Steel Open Girder/Beam | 61 | 0 | 61 | 0 | 0 Feet |
| 515 | Steel Protective Coating | 555 | 433 | 122 | 0 | 0 Square Feet |

| Element Number | Defect Type | Defect Description | CS | CS Qty | Maint Qty |
|------------------|---|--|----|--------|-----------------|
| 107 | Corrosion | FRECKLED RUST ALONG THE BOTTOM FLANGE AND LOWER 2" OF THE WEB. | 2 | 61 | Feet |
| 515 | Effectiveness (Steel Protective Coatings) | FRECKLED RUST ALONG THE BOTTOM FLANGE AND LOWER 2" OF THE WEB. | 2 | 122 | 122 Square Feet |
| General Comments | | | | | |

Span 3 **Beam 4**
Plate Girder

| Element Number | Element Name | Total Qty | CS1 Qty | CS2 Qty | CS3 Qty | CS4 Qty |
|----------------|--------------------------|-----------|---------|---------|---------|-----------------|
| 107 | Steel Open Girder/Beam | 61 | 0 | 61 | 0 | 0 Feet |
| 515 | Steel Protective Coating | 555 | 435 | 0 | 0 | 120 Square Feet |

| Element Number | Defect Type | Defect Description | CS | CS Qty | Maint Qty |
|------------------|---|---|----|--------|-----------------|
| 107 | Corrosion | PEELING PAINT ALLOWING SURFACE CORROSION ON THE EXTERIOR OF THE WEB. | 2 | 61 | Feet |
| 515 | Peeling/Bubbling/Cracking (steel Protective Coatings) | PEELING PAINT ALLOWING SURFACE CORROSION ON THE EXTERIOR FACE OF THE WEB. | 4 | 120 | 120 Square Feet |
| General Comments | | | | | |

Span 3 **Left Bridge Rail**
Concrete and Metal Railing

| Element Number | Element Name | Total Qty | CS1 Qty | CS2 Qty | CS3 Qty | CS4 Qty |
|----------------|--------------------------|-----------|---------|---------|---------|---------------|
| 333 | Other Bridge Railing | 62 | 0 | 62 | 0 | 0 Feet |
| 515 | Steel Protective Coating | 62 | 62 | 0 | 0 | 0 Square Feet |

| Element Number | Defect Type | Defect Description | CS | CS Qty | Maint Qty |
|------------------|-------------|---|----|--------|-----------|
| 333 | Damage | THE LEFT RAIL HAS MINOR SCRAPE DAMAGE, WITH SOME TEARS IN THE STEEL FOR THE FULL LENGTH IN ALL SPANS. | 2 | 62 | 62 Feet |
| General Comments | | | | | |

Span 3 Near Bearing
Movable Bearing

| Element Number | Element Name | Total Qty | CS1 Qty | CS2 Qty | CS3 Qty | CS4 Qty | |
|----------------|--------------------------|-----------|---------|---------|---------|---------|-------------|
| 311 | Movable Bearing | 1 | 0 | 1 | 0 | 0 | Each |
| 515 | Steel Protective Coating | 1 | 0 | 0 | 1 | 0 | Square Feet |

| Element Number | Defect Type | Defect Description | CS | CS Qty | Maint Qty | |
|----------------|---|---|----|--------|-----------|-------------|
| 311 | Corrosion | LOSS OF PAINT ALLOWING SURFACE CORROSION ON THE BEARING PLATES. | 2 | 1 | | Each |
| 515 | Effectiveness (Steel Protective Coatings) | LOSS OF PAINT ALLOWING SURFACE CORROSION ON THE BEARING PLATES. | 3 | 1 | 1 | Square Feet |

General Comments

Span 3 Far Bearing
Fixed Bearing

| Element Number | Element Name | Total Qty | CS1 Qty | CS2 Qty | CS3 Qty | CS4 Qty | |
|----------------|--------------------------|-----------|---------|---------|---------|---------|-------------|
| 313 | Fixed Bearing | 1 | 0 | 1 | 0 | 0 | Each |
| 515 | Steel Protective Coating | 1 | 0 | 0 | 1 | 0 | Square Feet |

| Element Number | Defect Type | Defect Description | CS | CS Qty | Maint Qty | |
|----------------|---|---|----|--------|-----------|-------------|
| 313 | Corrosion | LOSS OF PAINT ALLOWING SURFACE CORROSION ON THE BEARING PLATES. | 2 | 1 | | Each |
| 515 | Effectiveness (Steel Protective Coatings) | LOSS OF PAINT ALLOWING SURFACE CORROSION ON THE BEARING PLATES. | 3 | 1 | 1 | Square Feet |

General Comments

Span 3 Near Bearing
Movable Bearing

| Element Number | Element Name | Total Qty | CS1 Qty | CS2 Qty | CS3 Qty | CS4 Qty | |
|----------------|--------------------------|-----------|---------|---------|---------|---------|-------------|
| 311 | Movable Bearing | 1 | 0 | 1 | 0 | 0 | Each |
| 515 | Steel Protective Coating | 1 | 0 | 0 | 1 | 0 | Square Feet |

| Element Number | Defect Type | Defect Description | CS | CS Qty | Maint Qty | |
|----------------|---|---|----|--------|-----------|-------------|
| 311 | Corrosion | LOSS OF PAINT ALLOWING SURFACE CORROSION ON THE BEARING PLATES. | 2 | 1 | | Each |
| 515 | Effectiveness (Steel Protective Coatings) | LOSS OF PAINT ALLOWING SURFACE CORROSION ON THE BEARING PLATES. | 3 | 1 | 1 | Square Feet |

General Comments

Span 3 Far Bearing
Fixed Bearing

| Element Number | Element Name | Total Qty | CS1 Qty | CS2 Qty | CS3 Qty | CS4 Qty | |
|----------------|--------------------------|-----------|---------|---------|---------|---------|-------------|
| 313 | Fixed Bearing | 1 | 0 | 1 | 0 | 0 | Each |
| 515 | Steel Protective Coating | 1 | 0 | 0 | 1 | 0 | Square Feet |

| Element Number | Defect Type | Defect Description | CS | CS Qty | Maint Qty | |
|----------------|-------------|---|----|--------|-----------|------|
| 313 | Corrosion | LOSS OF PAINT ALLOWING SURFACE CORROSION ON THE BEARING PLATES. | 2 | 1 | | Each |

| | | | | | | |
|------------------|---|---|---|---|---|-------------|
| 515 | Effectiveness (Steel Protective Coatings) | LOSS OF PAINT ALLOWING SURFACE CORROSION ON THE BEARING PLATES. | 3 | 1 | 1 | Square Feet |
| General Comments | | | | | | |

Span 3 Near Bearing

Movable Bearing

| Element Number | Element Name | Total Qty | CS1 Qty | CS2 Qty | CS3 Qty | CS4 Qty |
|----------------|--------------------------|-----------|---------|---------|---------|---------------|
| 311 | Movable Bearing | 1 | 0 | 1 | 0 | 0 Each |
| 515 | Steel Protective Coating | 1 | 0 | 0 | 1 | 0 Square Feet |

| Element Number | Defect Type | Defect Description | CS | CS Qty | Maint Qty |
|------------------|---|---|----|--------|---------------|
| 311 | Corrosion | LOSS OF PAINT ALLOWING SURFACE CORROSION ON THE BEARING PLATES. | 2 | 1 | Each |
| 515 | Effectiveness (Steel Protective Coatings) | LOSS OF PAINT ALLOWING SURFACE CORROSION ON THE BEARING PLATES. | 3 | 1 | 1 Square Feet |
| General Comments | | | | | |

Span 3 Far Bearing

Fixed Bearing

| Element Number | Element Name | Total Qty | CS1 Qty | CS2 Qty | CS3 Qty | CS4 Qty |
|----------------|--------------------------|-----------|---------|---------|---------|---------------|
| 313 | Fixed Bearing | 1 | 0 | 1 | 0 | 0 Each |
| 515 | Steel Protective Coating | 1 | 0 | 0 | 1 | 0 Square Feet |

| Element Number | Defect Type | Defect Description | CS | CS Qty | Maint Qty |
|------------------|---|---|----|--------|---------------|
| 313 | Corrosion | LOSS OF PAINT ALLOWING SURFACE CORROSION ON THE BEARING PLATES. | 2 | 1 | Each |
| 515 | Effectiveness (Steel Protective Coatings) | LOSS OF PAINT ALLOWING SURFACE CORROSION ON THE BEARING PLATES. | 3 | 1 | 1 Square Feet |
| General Comments | | | | | |

Span 3 Near Bearing

Movable Bearing

| Element Number | Element Name | Total Qty | CS1 Qty | CS2 Qty | CS3 Qty | CS4 Qty |
|----------------|--------------------------|-----------|---------|---------|---------|---------------|
| 311 | Movable Bearing | 1 | 0 | 1 | 0 | 0 Each |
| 515 | Steel Protective Coating | 1 | 0 | 0 | 1 | 0 Square Feet |

| Element Number | Defect Type | Defect Description | CS | CS Qty | Maint Qty |
|------------------|---|---|----|--------|---------------|
| 311 | Corrosion | LOSS OF PAINT ALLOWING SURFACE CORROSION ON THE BEARING PLATES. | 2 | 1 | Each |
| 515 | Effectiveness (Steel Protective Coatings) | LOSS OF PAINT ALLOWING SURFACE CORROSION ON THE BEARING PLATES. | 3 | 1 | 1 Square Feet |
| General Comments | | | | | |

Span 3 Far Bearing

Fixed Bearing

| Element Number | Element Name | Total Qty | CS1 Qty | CS2 Qty | CS3 Qty | CS4 Qty | |
|----------------|--------------------------|-----------|---------|---------|---------|---------|-------------|
| 313 | Fixed Bearing | 1 | 0 | 1 | 0 | 0 | Each |
| 515 | Steel Protective Coating | 1 | 0 | 0 | 1 | 0 | Square Feet |

| Element Number | Defect Type | Defect Description | CS | CS Qty | Maint Qty | |
|----------------|---|---|----|--------|-----------|-------------|
| 313 | Corrosion | LOSS OF PAINT ALLOWING SURFACE CORROSION ON THE BEARING PLATES. | 2 | 1 | | Each |
| 515 | Effectiveness (Steel Protective Coatings) | LOSS OF PAINT ALLOWING SURFACE CORROSION ON THE BEARING PLATES. | 3 | 1 | 1 | Square Feet |

General Comments

Span 3 Latex Modified Concrete Wearing Surface

Concrete Wearing Surface

| Element Number | Element Name | Total Qty | CS1 Qty | CS2 Qty | CS3 Qty | CS4 Qty | |
|----------------|-----------------|-----------|---------|---------|---------|---------|-------------|
| 510 | Wearing Surface | 1,710 | 1,560 | 150 | 0 | 0 | Square Feet |

| Element Number | Defect Type | Defect Description | CS | CS Qty | Maint Qty | |
|----------------|-------------------------|--|----|--------|-----------|-------------|
| 510 | Crack (Wearing Surface) | WEARING SURFACE HAS SCATTERED MAP CRACKS UP TO 1/16" WIDE. | 2 | 150 | 150 | Square Feet |

General Comments

End Bent 1 Steel Pile 1

Steel Pile

| Element Number | Element Name | Total Qty | CS1 Qty | CS2 Qty | CS3 Qty | CS4 Qty | |
|----------------|--------------|-----------|---------|---------|---------|---------|------|
| 225 | Steel Pile | 1 | 1 | 0 | 0 | 0 | Each |

| Element Number | Defect Type | Defect Description | CS | CS Qty | Maint Qty | |
|----------------|-------------|--------------------|----|--------|-----------|--|
| | | | | | | |

General Comments

END BENT PILES ARE NOT VISIBLE

Bent 1 Reinforced Concrete Footing 1

Reinforced Concrete Footing

| Element Number | Element Name | Total Qty | CS1 Qty | CS2 Qty | CS3 Qty | CS4 Qty | |
|----------------|--------------------------------------|-----------|---------|---------|---------|---------|------|
| 220 | Reinforced Concrete Pile Cap/Footing | 11 | 11 | 0 | 0 | 0 | Feet |

| Element Number | Defect Type | Defect Description | CS | CS Qty | Maint Qty | |
|----------------|-------------|--------------------|----|--------|-----------|--|
| | | | | | | |

General Comments

NOT VISIBLE

Bent 1 Reinforced Concrete Pier Cap 1**Reinforced Concrete Pier Cap**

| Element Number | Element Name | Total Qty | CS1 Qty | CS2 Qty | CS3 Qty | CS4 Qty |
|----------------|------------------------------|-----------|---------|---------|---------|---------|
| 234 | Reinforced Concrete Pier Cap | 30 | 20 | 8 | 2 | 0 Feet |

| Element Number | Defect Type | Defect Description | CS | CS Qty | Maint Qty |
|----------------|--------------|---|----|--------|-----------|
| 234 | Patched Area | PATCH ON THE EAST FACE UNDER BEAM 1 HAS H/L CRACKING. | 3 | 2 | 2 Feet |
| 234 | Patched Area | FACES OF CAP HAVE SEVERAL PATCHES IN GOOD CONDITION. | 2 | 8 | Feet |

General Comments

Bent 2 Reinforced Concrete Footing 1**Reinforced Concrete Footing**

| Element Number | Element Name | Total Qty | CS1 Qty | CS2 Qty | CS3 Qty | CS4 Qty |
|----------------|--------------------------------------|-----------|---------|---------|---------|---------|
| 220 | Reinforced Concrete Pile Cap/Footing | 11 | 11 | 0 | 0 | 0 Feet |

| Element Number | Defect Type | Defect Description | CS | CS Qty | Maint Qty |
|----------------|-------------|--------------------|----|--------|-----------|
|----------------|-------------|--------------------|----|--------|-----------|

General Comments

NOT VISIBLE

Bent 2 Reinforced Concrete Pier Cap 1**Reinforced Concrete Pier Cap**

| Element Number | Element Name | Total Qty | CS1 Qty | CS2 Qty | CS3 Qty | CS4 Qty |
|----------------|------------------------------|-----------|---------|---------|---------|---------|
| 234 | Reinforced Concrete Pier Cap | 30 | 22 | 8 | 0 | 0 Feet |

| Element Number | Defect Type | Defect Description | CS | CS Qty | Maint Qty |
|----------------|--------------|--|----|--------|-----------|
| 234 | Patched Area | FACES OF CAP HAVE SEVERAL PATCHES IN GOOD CONDITION. | 2 | 8 | Feet |

General Comments

End Bent 2 Reinforced Concrete Pier Cap 1**Reinforced Concrete Pier Cap**

| Element Number | Element Name | Total Qty | CS1 Qty | CS2 Qty | CS3 Qty | CS4 Qty |
|----------------|------------------------------|-----------|---------|---------|---------|---------|
| 234 | Reinforced Concrete Pier Cap | 39 | 28 | 11 | 0 | 0 Feet |

| Element Number | Defect Type | Defect Description | CS | CS Qty | Maint Qty |
|----------------|--------------|---|----|--------|-----------|
| 234 | Patched Area | 11' LONG X 2' HIGH PATCH ON THE RIGHT END OF THE END BENT CAP IS IN GOOD CONDITION. | 2 | 11 | Feet |

General Comments

Elements Verified

| Location | Name | Component | Element Name | Amount |
|----------|---|----------------------------|--------------------------|--------|
| Span 1 | Deck | Reinforced Concrete Deck | Reinforced Concrete Deck | 1637 |
| Span 1 | Beam 1 | Plate Girder | Steel Open Girder/Beam | 52 |
| Span 1 | Beam 2 | Plate Girder | Steel Open Girder/Beam | 52 |
| Span 1 | Beam 3 | Plate Girder | Steel Open Girder/Beam | 52 |
| Span 1 | Beam 4 | Plate Girder | Steel Open Girder/Beam | 52 |
| Span 1 | Left Bridge Rail | Concrete and Metal Railing | Other Bridge Railing | 53 |
| Span 1 | Right Bridge Rail | Concrete and Metal Railing | Other Bridge Railing | 53 |
| Span 1 | Expansion Joint | Compression Seal | Compression Joint Seal | 36 |
| Span 1 | Latex Modified Concrete Wearing Surface | Concrete Wearing Surface | Wearing Surface | 1459 |
| Span 1 | Near Bearing | Fixed Bearing | Fixed Bearing | 1 |
| Span 1 | Far Bearing | Movable Bearing | Movable Bearing | 1 |
| Span 1 | Far Bearing | Movable Bearing | Movable Bearing | 1 |
| Span 1 | Near Bearing | Fixed Bearing | Fixed Bearing | 1 |
| Span 1 | Far Bearing | Movable Bearing | Movable Bearing | 1 |
| Span 1 | Near Bearing | Fixed Bearing | Fixed Bearing | 1 |
| Span 1 | Far Bearing | Movable Bearing | Movable Bearing | 1 |
| Span 1 | Near Bearing | Fixed Bearing | Fixed Bearing | 1 |
| Span 2 | Deck | Reinforced Concrete Deck | Reinforced Concrete Deck | 1902 |
| Span 2 | Beam 1 | Plate Girder | Steel Open Girder/Beam | 61 |
| Span 2 | Beam 2 | Plate Girder | Steel Open Girder/Beam | 61 |
| Span 2 | Beam 3 | Plate Girder | Steel Open Girder/Beam | 61 |
| Span 2 | Beam 4 | Plate Girder | Steel Open Girder/Beam | 61 |
| Span 2 | Left Bridge Rail | Concrete and Metal Railing | Other Bridge Railing | 61 |
| Span 2 | Right Bridge Rail | Concrete and Metal Railing | Other Bridge Railing | 61 |
| Span 2 | Latex Modified Concrete Wearing Surface | Concrete Wearing Surface | Wearing Surface | 1695 |
| Span 2 | Near Bearing | Fixed Bearing | Fixed Bearing | 1 |
| Span 2 | Far Bearing | Movable Bearing | Movable Bearing | 1 |
| Span 2 | Near Bearing | Fixed Bearing | Fixed Bearing | 1 |
| Span 2 | Far Bearing | Movable Bearing | Movable Bearing | 1 |
| Span 2 | Far Bearing | Movable Bearing | Movable Bearing | 1 |
| Span 2 | Near Bearing | Fixed Bearing | Fixed Bearing | 1 |
| Span 2 | Near Bearing | Fixed Bearing | Fixed Bearing | 1 |
| Span 2 | Far Bearing | Movable Bearing | Movable Bearing | 1 |
| Span 3 | Deck | Reinforced Concrete Deck | Reinforced Concrete Deck | 1919 |
| Span 3 | Beam 1 | Plate Girder | Steel Open Girder/Beam | 61 |
| Span 3 | Beam 2 | Plate Girder | Steel Open Girder/Beam | 61 |
| Span 3 | Beam 3 | Plate Girder | Steel Open Girder/Beam | 61 |
| Span 3 | Beam 4 | Plate Girder | Steel Open Girder/Beam | 61 |
| Span 3 | Left Bridge Rail | Concrete and Metal Railing | Other Bridge Railing | 62 |
| Span 3 | Right Bridge Rail | Concrete and Metal Railing | Other Bridge Railing | 62 |
| Span 3 | Latex Modified Concrete Wearing Surface | Concrete Wearing Surface | Wearing Surface | 1710 |
| Span 3 | Far Bearing | Fixed Bearing | Fixed Bearing | 1 |
| Span 3 | Near Bearing | Movable Bearing | Movable Bearing | 1 |
| Span 3 | Near Bearing | Movable Bearing | Movable Bearing | 1 |

Elements Verified

| Location | Name | Component | Element Name | Amount |
|------------|--------------|------------------------------|------------------------------|--------|
| Span 3 | Far Bearing | Fixed Bearing | Fixed Bearing | 1 |
| Span 3 | Near Bearing | Movable Bearing | Movable Bearing | 1 |
| Span 3 | Far Bearing | Fixed Bearing | Fixed Bearing | 1 |
| Span 3 | Near Bearing | Movable Bearing | Movable Bearing | 1 |
| Span 3 | Far Bearing | Fixed Bearing | Fixed Bearing | 1 |
| Bent 1 | | Reinforced Concrete Pier Cap | Reinforced Concrete Pier Cap | 30 |
| Bent 1 | | Reinforced Concrete Column | Reinforced Concrete Column | 1 |
| Bent 1 | | Reinforced Concrete Column | Reinforced Concrete Column | 1 |
| End Bent 1 | | Reinforced Concrete Pier Cap | Reinforced Concrete Pier Cap | 38 |
| End Bent 1 | | Reinforced Concrete Abutment | Reinforced Concrete Abutment | 42 |
| Bent 2 | | Reinforced Concrete Pier Cap | Reinforced Concrete Pier Cap | 30 |
| Bent 2 | | Reinforced Concrete Column | Reinforced Concrete Column | 1 |
| Bent 2 | | Reinforced Concrete Column | Reinforced Concrete Column | 1 |
| End Bent 2 | | Reinforced Concrete Pier Cap | Reinforced Concrete Pier Cap | 39 |
| End Bent 2 | | Reinforced Concrete Abutment | Reinforced Concrete Abutment | 42 |

General Inspection Notes

Bent 1

END BENT PILES ARE NOT VISIBLE

Bent 1

NOT VISIBLE

Bent 2

END BENT PILES ARE NOT VISIBLE.

Bent 2

NOT VISIBLE

National Bridge and NC Inspection Items

Structure Number: 430248

Inspection Date: 04/25/2017

National Bridge Inventory Items

| Item | Grade Scale | Grade |
|---|-------------|-------|
| Item 58: Deck | 0 - 9 , N | 7 |
| Item 59: Superstructure | 0 - 9 , N | 7 |
| Item 60: Substructure | 0 - 9 , N | 6 |
| Item 61: Channel and Channel Protection | 0 - 9 , N | N |
| Item 62: Culvert | 0 - 9 , N | N |
| Item 71: Waterway Adequacy | 0 - 9 , N | N |
| Item 72: Approach Roadway Alignment | 0 - 9 , N | 8 |

Note: If NBI Inspection Item is not present, code NBI item with "N"

NC SMU Inspection Items

| Item | Grade Scale | Grade | Maint. Qty. | Maint. Code |
|---------------------------|---------------|-------|-------------|-------------|
| Deck Debris | G, F, P, or C | G | 0 | 3376 |
| Drainage System | G, F, P, or C | G | 0 | 3332 |
| Utilities | G, F, P, or C | | | |
| Slope Protection | G, F, P, or C | | 0 | 3352 |
| Scour | G, F, P, or C | | | |
| Wingwall | G, F, P, or C | | | |
| Field Scour Evaluation | | | | |
| Drift | G, F, P, or C | | | |
| Fender System | G, F, P, or C | | | |
| Movable Span Machinery | G, F, P, or C | | | |
| Response to Live Load | G, F, P, or C | G | | |
| Estimated Remaining Life | 0 - 100 Years | 20 | | |
| Superstructure Paint Code | | A | | |

Note: If NC SMU Inspection Item is not present, leave NC SMU item blank

Inspection Information

| Item | Grade Scale | Grade |
|--|-------------|-------|
| Regulatory Sign Noticed Issued | YES/NO | N |
| Priority Maintenance Request Submitted | YES/NO | N |
| Inspection Time | Hours | 5 |
| Traffic Control Time | Hours | |
| Snooper Time | Hours | |
| Ladder Used | YES/NO | Y |
| Bucket Truck Used | YES/NO | N |
| Boat Used | YES/NO | N |
| Other Equipment Used | YES/NO | N |

National Bridge and NC SMU Inspection Item Details

Structure Number: 430248

Inspection Date: 04/25/2017

| | | | | |
|------|------------------------|---------|------------|--------|
| Item | Substructure - Item 60 | Grade 6 | Maint Code | Qty. 0 |
|------|------------------------|---------|------------|--------|

Details TEMPORARY REPAIRS (CAPS)

| | | | | |
|------|--------------------------------------|---------|------------|--------|
| Item | Approach Roadway Alignment - Item 72 | Grade 8 | Maint Code | Qty. 0 |
|------|--------------------------------------|---------|------------|--------|

Details WEST APPROACH ASPHALT WEARING SURFACE IS BREAKING UP IN A 3' WIDE X 9' LONG AREA ALONG THE C/L.



Span 3 Beam 4: PEELING PAINT ALLOWING SURFACE CORROSION ON THE EXTERIOR OF THE WEB.



Span 3 Beam 2: FRECKLED RUST ALONG THE BOTTOM FLANGE AND LOWER 2" OF THE WEB.



Span 3 Beam 1: LOSS OF PAINT ALONG THE TOP OF THE BOTTOM FLANGE ALLOWING 1/16" PITTING ALONG THE FLANGE AND LOWER WEB.



Approach 2: THE EAST APPROACH WEARING SURFACE AND APPROACH SLAB ARE PATCHED IN THE RIGHT LANE. PATCHES ARE IN GOOD CONDITION.



Span 3 Left Bridge Rail: THE LEFT RAIL HAS MINOR SCRAPE DAMAGE, WITH SOME TEARS IN THE STEEL FOR THE FULL LENGTH IN ALL SPANS.



Span 3 Latex Modified Concrete Wearing Surface: WEARING SURFACE HAS SCATTERED MAP CRACKS UP TO 1/16" WIDE.



Span 1 Latex Modified Concrete Wearing Surface: RIGHT LANE HAS A 5' WIDE X 6' LONG PATCH IN GOOD CONDITION.



Approach 1: THE EAST APPROACH WEARING SURFACE AND APPROACH SLAB ARE PATCHED IN THE RIGHT LANE. PATCHES ARE IN GOOD CONDITION.



WEST APPROACH ASPHALT WEARING SURFACE IS BREAKING UP IN A 3' WIDE X 9' LONG AREA ALONG THE C/L.



Bent 1 Cap 1: PATCH ON THE EAST FACE UNDER BEAM 1 HAS H/L CRACKING.



Span 1 Beam 2 Far Bearing: LOSS OF PAINT ALLOWING SURFACE CORROSION ON THE BEARING PLATES.



NORTH PROFILE



BENT 2



DECK UNDERSIDE



BENT 1



TYPICAL BEARING



SOUTH PROFILE



END BENT 2



EAST APPROACH LOOKING WEST



TRI-BEAM RAIL WAS INSTALLED INSIDE OF THE ORIGINAL CONCRETE RAIL.



TYPICAL BASE FOR TRI-BEAM RETROFIT RAIL.



TYPICAL JOINT



GUARDRAIL LOOKING EAST



LOOKING SOUTH FROM THE STRUCTURE



LOOKING NORTH FROM THE STRUCTURE



GUARDRAIL LOOKING WEST



BRIDGE PLATE IS OBSCURED BY THE GUARDRAIL AND DIRT.



WEST APPROACH LOOKING EAST



END BENT 1

| IDENTIFICATION | | | | CLASSIFICATION | | | |
|--|-----------------------|----------------|---|--|---------------------------|------|---------------|
| (1) STATE NAME -NORTH CAROLINA | BRIDGE | 430248 | | SUFFICIENCY RATING = | | | 76.54 |
| (8) STRUCTURE NUMBER(FEDERAL) | | 00000000870248 | | STATUS = | Functionally Obsolete | | |
| (5) INVENTORY ROUTE (ON/UNDER) - ON | | 11000400 | | | | | |
| (2) STATE HIGHWAY DEPARTMENT DISTRICT | | 2 | | | | | |
| (3) COUNTY CODE | 87 | (4) PLACE CODE | 0 | (112)NBIS BRIDGE SYSTEM - | | | YES |
| (6) FEATURE INTERSECTED - SR1613 | | | | (104)HIGHWAY SYSTEM | Is on the NHS | | 1 |
| (7) FACILITY CARRIED I-40 EBL | | | | (26) FUNCTIONAL CLASS - | Arterial - Interstate | | 01 |
| (9) LOCATION 1.1 M.I.E.JCT.NC215 | | | | (100)STRAHNET HIGHWAY - | Interstate STRAHNET Route | | 1 |
| (11)MILEPOINT | | 32.4 | | (101)PARALLEL STRUCTURE - | Right Parallel Structure | | R |
| (16)LAT 35° 33' 20.53" | (17)LONG | 82° 49' 50.99" | | (102)DIRECTION OF TRAFFIC - | 1-way Traffic | | 1 |
| (98)BORDER BRIDGE STATE CODE | | PCT SHARE | | (103)TEMPORARY STRUCTURE - | | | |
| (99)BORDER BRIDGE STRUCTURE NO | | | | (110)DESIGNATED NATIONAL NETWORK - | On the National Network | | 1 |
| | | | | (20) TOLL | On Free Road | | 3 |
| | | | | (31) MAINTAIN - | State Highway Agency | | 01 |
| | | | | (22) OWNER - | State Highway Agency | | 01 |
| | | | | (37) HISTORICAL SIGNIFICANCE - | Not Eligible | | 5 |
| STRUCTURE TYPE AND MATERIAL | | | | CONDITION | | | |
| (43) STRUCTURE TYPE MAIN: Steel | | | | (58) DECK | | | 7 |
| TYPE - Stringer Mutlibeam or Girder | | CODE 302 | | (59) SUPERSTRUCTURE | | | 7 |
| (44) STRUCTURE TYPE APPR : | | | | (60) SUBSTRUCTURE | | | 6 |
| TYPE - | | CODE 000 | | (61) CHANNEL & CHANNEL PROTECTION | | | N |
| (45) NUMBER OF SPANS IN MAIN UNIT | | 3 | | (62) CULVERTS | | | N |
| (46) NUMBER OF APPROACH SPANS | | | | | | | |
| (107)DECK STRUCTURE TYPE - 1 | | CODE | | LOAD RATING AND POSTING | | | |
| (108)WEARING SURFACE / PROTECTIVE SYSTEM : | | | | (31) DESIGN LOAD | HS 20 + MOD | | 6 |
| (A) TYPE OF WEARING SURFACE - | | CODE | | (63) OPERATING RATING METHOD - | Load Factor | | 1 |
| (B) TYPE OF MEMBRANE - | | CODE | | (64) OPERATING RATING - | HS-51 | | 91 |
| (C) TYPE OF DECK PROTECTION - | | CODE | | (65) INVENTORY RATING METHOD - | Load Factor | | 1 |
| | | | | (66) INVENTORY RATING - | HS-30 | | 54 |
| | | | | (70) BRIDGE POSTING - | No Posting Required | | 5 |
| | | | | (41) STRUCTURE OPEN, POSTED ,OR CLOSED | | | A |
| | | | | DESCRIPTION - | Open, No Restriction | | |
| AGE AND SERVICE | | | | APPRAISAL | | | |
| (27) YEAR BUILT | | 1961 | | (67) STRUCTURAL EVALUATION | | | 6 |
| (106)YEAR RECONSTRUCTED | | 2011 | | (68) DECK GEOMETRY | | | 2 |
| (42) TYPE OF SERVICE : ON - Highway | | | | (69) UNDERCLEARANCES,VERTI & HORIZ | | | 6 |
| UNDER - Highway | | CODE 11 | | (71) WATERWAY ADEQUACY | | | N |
| (28) LANES: ON STRUCTURE 2 UNDER STRUCTURE | | 2 | | (72) APPROACH ROADWAY ALIGNMENT | | | 8 |
| (29) AVERAGE DAILY TRAFFIC | | 25500 | | (36) TRAFFIC SAFETY FEATURES | | | 1111 |
| (30) YEAR OF ADT 2015 | (109) TRUCK ADT PCT | 23% | | (113)SCOUR CRITICAL BRIDGES | | | N |
| (19) BYPASS OR DETOUR LENGTH | | 1 MI | | PROPOSED IMPROVEMENTS | | | |
| GEOMETRIC DATA | | | | (75) TYPE OF WORK - | | | CODE |
| (48) LENGTH OF MAXIMUM SPAN | | 60 FT | | (76) LENGTH OF STRUCTURE IMPROVEMENT | | | |
| (49) STRUCTURE LENGTH | | 174 FT | | (94) BRIDGE IMPROVEMENT COST | | | |
| (50)CURB OR SIDEWALK: LEFT 0 FT RIGHT 0 FT | | | | (95) ROADWAY IMPROVEMENT COST | | | |
| (51) BRIDGE ROADWAY WIDTH CURB TO CURB | | 28 FT | | (96) TOTAL PROJECT COST | | | |
| (52) DECK WIDTH OUT TO OUT | | 31.417 FT | | (97) YEAR OF IMPROVEMENT COST ESTIMATE | | | |
| (32) APPROACH ROADWAY WIDTH (W/SHOULDERS) | | 41 FT | | (114)FUTURE ADT 51000 | (115) YEAR FUTURE ADT | 2025 | |
| (33) BRIDGE MEDIAN - No Median | | CODE 1 | | INSPECTIONS | | | |
| (34) SKEW 30° | (35) STRUCTURE FLARED | 0 | | (90) INSPECTION DATE | | | 04/25/2017 |
| (10) INVENTORY ROUTE MIN VERT CLEAR | | 999.9 FT | | (92) CRITICAL FEATURE INSPECTION : | | | (93) CFI DATE |
| (47) INVENTORY ROUTE TOTAL HORIZ CLEAR | | 28 FT | | A) FRACTURE CRIT DETAIL - | NO | | A) |
| (53) MIN VERT CLEAR OVER BRIDGE RDWY | | 999.9 FT | | B) UNDERWATER INSP - | NO | | B) |
| (54) MIN VERT UNDERCLEAR REF Highway | | 14.833 FT | | C) OTHER SPECIAL INSP | NO | | C) |
| (55) MIN LAT UNDERCLEAR RT REF Highway | | 12.5 FT | | SCOUR | | | |
| (56) MIN LAT UNDERCLEAR LT REF - | | 0 FT | | | | | |
| NAVIGATION DATA | | | | | | | |
| (38) NAVIGATION CONTROL - Not Applicable | | CODE N | | | | | |
| (111)PIER PROTECTION - | | CODE | | | | | |
| (39) NAVIGATION VERTICAL CLEARANCE | | 0 | | | | | |
| (116)VERT - LIFT BRIDGE NAV MIN VERT CLEAR | | FT | | | | | |
| (40) NAVIGATION HORIZONTAL CLEARANCE | | 0 FT | | | | | |

Structure No: 430248

County: HAYWOOD

Run Date:

| Span Number | Feature Intersected | Inventory Route | Minimum Maximum Vertical Clearance | Milepoint | Base Highway Network | LRS Inventory Route | Toll | Functional Classification | Nuner of Lanes | Average Daily Traffic | Year of Average Daily Traffic | Total Horizontal Clearance | See Note 1 | | | | | | | |
|-------------|---------------------|-----------------|------------------------------------|-----------|----------------------|---------------------|------|---------------------------|----------------|-----------------------|-------------------------------|----------------------------|-------------------|---------------------------------|------------------------------|-----------------------------|--------------------------------|-----------------------------|----------------------|-------------------------|
| | | | | | | | | | | | | | Reference Feature | Minimum Vertical Underclearance | Right Lateral Underclearance | Left Lateral Underclearance | Underclearance Appraisal Grade | STRAHNET Highway Designator | Direction of Traffic | Highway System of Route |
| | 6 | 5 | 10 | 11 | 12 | 13 | 20 | 26 | 28 | 29 | 30 | 47 | 54A | 54 | 55 | 56 | 69 | 100 | 102 | 104 |
| 2 | SR 1613 | 31016130 | 15.52 | | 0 | | | 19 | 2 | 2400 | 2014 | 49.7 | H | 14.83 | 12.5 | | 9 | 0 | 2 | 0 |

Note 1: Items 54, 55, and 56 are not reported FHWA under route data points but are collected for each under route to determine the minimum value for Underclearance Appraisal Item 69. The under route that generates the lowest Underclearance Appraisal value will be reported on the Facility Carried record.

BRIDGE MANAGEMENT UNIT

DATA ON EXISTING STRUCTURE

Run Date: 11/29/2017

COUNTY : HAYWOOD DIVISION : 14 DISTRICT : 2 STRUCTURE NUMBER : 430248 LENGTH : 174 FEET

ROUTE CARRIED : I-40 EBL FEATURE INTERSECTED : SR1613

LOCATED : 1.1 MI.E.JCT.NC215 BRIDGE NAME : CITY :

FUNC. CLASS : 01 SYST.ON : FA SYST.UNDER : NFA ADT & YR : 25500 2015 RAIL TYPE : LT 333 RT 333

BUILT : 1961 BY : SHC PROJ : 8.19431 FED.AID PROJ : I-40-1(8)34 DESIGN LOAD : HS 20 + MOD

REHAB : 2011 BY : DOH PROJ : 8.1940205 ALIGNMENT : RT SKEW : 60 LANES : ON 2 UNDER 2

NAVIGATION : VC 0 FT HC 0 FT HT. CRN. TO BED : 0 FT WATER DEPTH : 0 FT

SUPERSTRUCTURE : REINF. CONCRETE FLOOR ON I-BEAMS(LAYTEX MODIFIED CONC.OVERLAY)

SUBSTRUCTURE : E.BTS:RC CAPS/H-PILES;INT.BTS:RCP&B/PILE FTGS.

SPANS : 1 @ 52'-1.1875, 1 @ 60'-6.0625, 1 @ 61'-.5625

BEAMS OR GIRDERS : 4 LINES 33 I-BEAMS @ 8' CENTERS

FLOOR : 9 RC/NO AWS ENCROACHMENT : DECK (OUT TO OUT) : 31.417 FT

CLEAR ROADWAY : 28 FT BETWEEN RAILS : 28 FT SIDEWALK OR CURB : LT 0 FT RT 0 FT

VERT.CL.OVER : 999.9 FT

INV.RTG. : HS-30 OPE.RTG. : HS-51 CONTR.MEMBER : Int.bms POSTED : SV TTST DATE

SYSTEM : Primary Interstate GREEN LINE ROUTE : Y

UNDER ROUTES AND CLEARANCES

| Span | Route Description | Vertical Clearances | | Horizontal Clearances | | |
|------|-------------------|---------------------|---------|-----------------------|------|-------|
| | | MMVC | MVC | Total | Left | Right |
| 2 | SR 1613 | 15.5170 | 14.8330 | 49.70 | 0 | 12.50 |

Note: All measurements are in feet.

REMARKS :

Structure Data Worksheet

Spans

County: HAYWOOD Structure No: 430248 Date: 04/25/2017 Inspected By: DJA

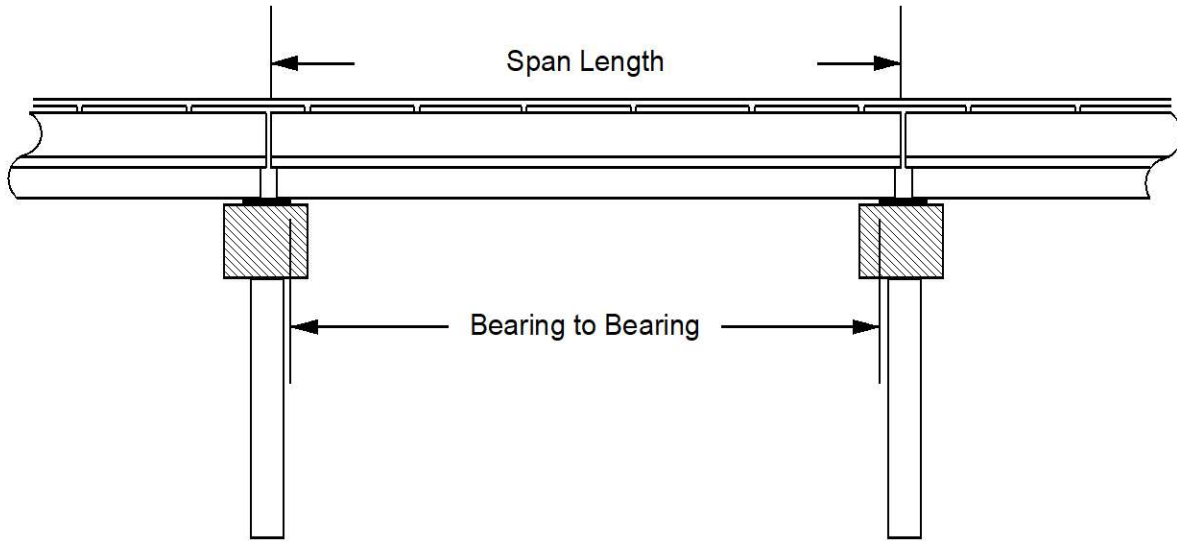

| Span No | Span Length | Bearing to Bearing | Comments |
|---------|--------------|--------------------|----------------|
| 0 | 0 | 0 | 0 |
| 1 | 52'- 1 3/16" | 49' 8" | |
| 2 | 60'- 6 1/16" | 59' 6" | |
| 3 | 61'- 0 9/16" | 58' 9" | NBIS = 166'-7" |

Bridge Inspection Field Sketch

| | | | |
|----------------------------------|----------|-----------------------|---------|
| Deck Width/Out to Out | 31.417ft | Wearing Surface | |
| Between Rails | 28.000ft | Median Width | |
| Curb Height | 0.750ft | Median Height | |
| Top Rail to Deck/Wearing Surface | 2.667ft | Left Guardrail Width | |
| Clear Roadway | 28.000ft | Right Guardrail Width | |
| Left Bridge Rail | Type 33 | Right Bridge Rail | Type 33 |



| | | | |
|-------------------------------|-------|----------------|-------|
| Measurements for Span # | 1 | | |
| Deck Thickness | 0.750 | Left Overhang | 3.667 |
| Top of Rail to Bottom of Beam | 8.083 | Right Overhang | 3.667 |

| Beam No | Beam Type | Spacing |
|----------|--------------|---------|
| 1 thru 4 | Steel I Beam | 8.000ft |

BEAMS (NON-TAPERED FLANGES)

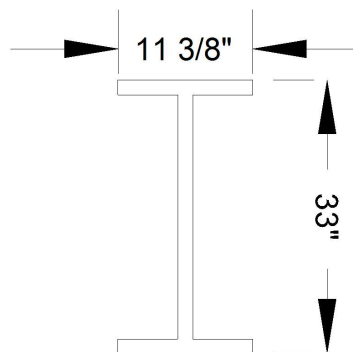

FLANGES = 7/8"

WEB = 5/8"

4-25-2017 DELVIN ADAMS

Title

Typical Section

Description

Data Worksheet

Bridge No: 430248

Drawn By: Roy W. Shook

Date: 07/29/2005

File Name: S0106000222

Bridge Inspection Field Sketch

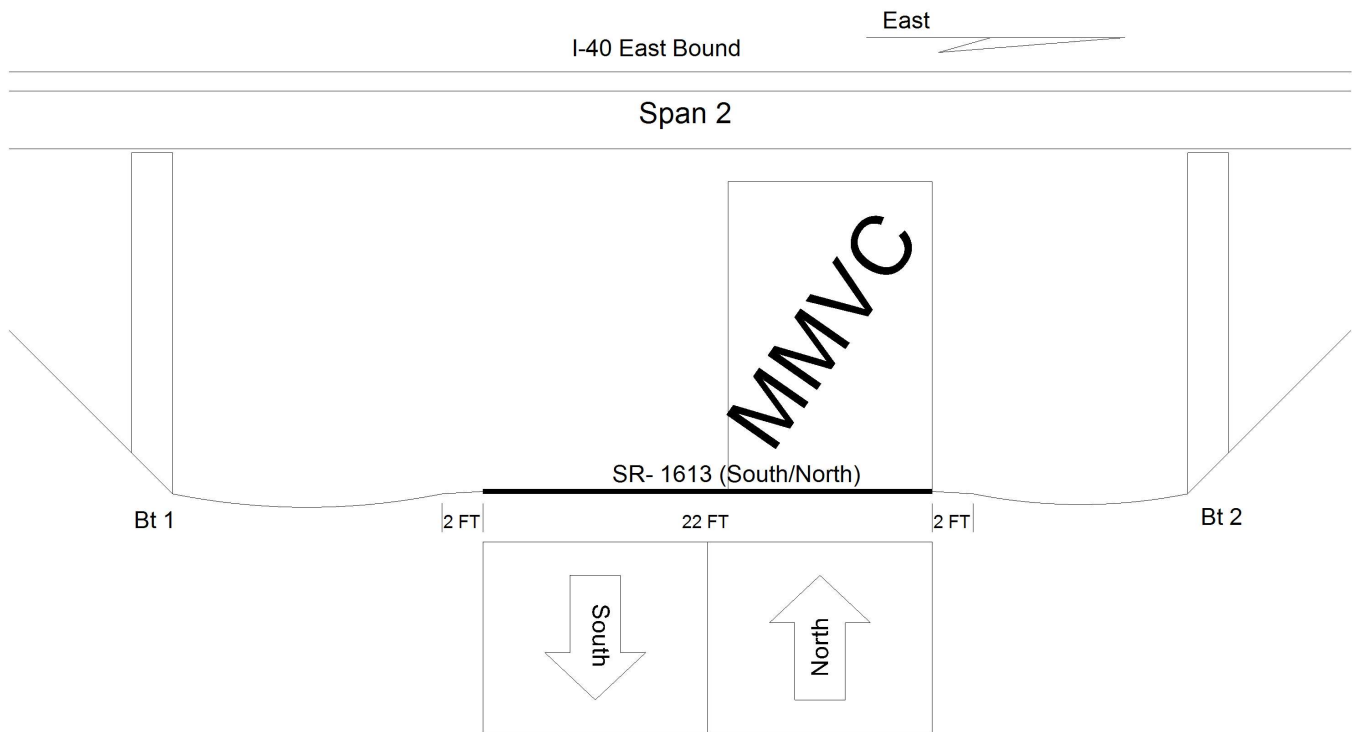

| | | | |
|--------------------------------|---|------------------------|-------------|
| Roadway 1 | | Direction of Traffic | North South |
| Distance to Left Rail | | Distance to Right Rail | |
| Distance to Left Toe of Slope | 15.2FT | Distance to Left Bent | 15.2FT |
| Distance to Right Toe of Slope | 12.5FT | Distance to Right Bent | 12.5FT |
| MMVC | 15.517 Ft at Beam 4, 10 FT from Right Edge of Roadway | | |
| MVC | 14.833 Ft at Beam 4, 0.1 FT from Left Edge of Roadway | | |

CLEARANCES CHANGED 4-22-2013

4-25-2017 DELVIN ADAMS

| | | | |
|--------------------------|-------------------------------|-------------------------|-------------------------------|
| Title | | Description | |
| Underclearance | | Data Worksheet | |
| Bridge No: 430248 | Drawn By: Roy W. Shook | Date: 07/29/2005 | File Name: S0106000223 |

Bridge Inspection Field Sketch



| | | | |
|-----------------|------------------|---------------|---------------|
| Roadway | 24ft Wide | 2 Paved Lanes | Looking East |
| Left Shoulder | 7ft Wide | 7.0ft Paved | |
| Right Shoulder | 10.1ft Wide | 9.8ft Paved | 0.3ft Unpaved |
| Left Guardrail | 7.0ft from road | | |
| Right Guardrail | 10.1ft from road | | |

4-25-2017 DELVIN ADAMS

| | | | |
|----------------------------------|-------------------------------|--------------------------------------|-------------------------------|
| Title Approach Roadway | | Description Data Worksheet | |
| Bridge No: 430248 | Drawn By: Roy W. Shook | Date: 07/29/2005 | File Name: S0106000221 |

Bridge Inspection Field Sketch

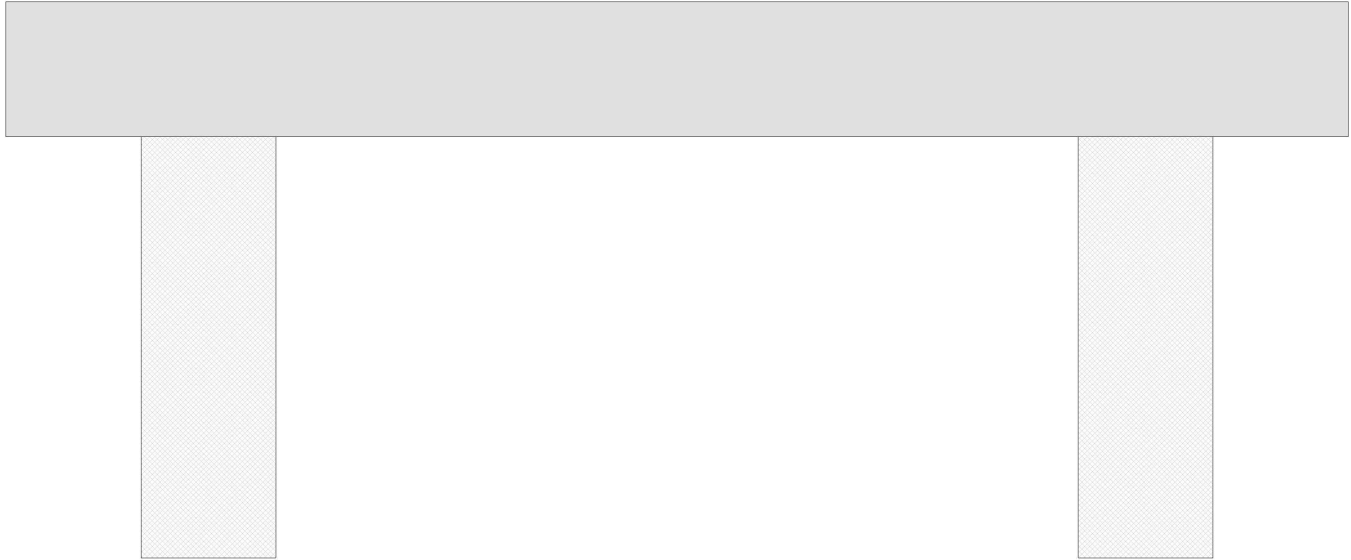

| Cap Information | | | Material Cast-in-Place Concrete | | | | | | | |
|---------------------------|-----------|------------|--|----------------|--------------------------|---------------------------|---------|--------------|----------|---------|
| Length | Width | Height | Left Overhang | Right Overhang | Left Beam to End of Cap. | Right Beam to End of Cap. | | | | |
| 29.833 ft. | 3.000 ft. | 3.000 ft. | 4.500 ft. | 4.500 ft. | 1.833 ft. | 1.833 ft. | | | | |
| Subcap Information | | | Material | | | | | | | |
| Length | Width | Height | Left Overhang | Right Overhang | Left Pile to Splice. | | | | | |
| | | | | | | | | | | |
| Sill Information | | | Material | | | | | | | |
| Length | Width | Height | | | | | | | | |
| | | | | | | | | | | |
| Pile # | Material | Spacing | Width/Dia. | Height | Length | Orientation | Driven? | Replacement? | Removed? | Collar? |
| 1 | Concrete | 20.833 ft. | 3 ft. | 3 ft. | | Vertical | No | No | No | No |
| 2 | Concrete | | 3 ft. | 3 ft. | | Vertical | No | No | No | No |
| | | | | | | | | | | |
| Bent/Abutment #: 1 | | | Similar Bents: 2 | | | | | | | |

| | | | | | | | |
|-------------------------------------|------------------------------------|--|--|------------------------|-------------------------------|--|--|
| Title 4-25-2017 DELVIN ADAMS | | | | Description | | | |
| INTERIOR BENTS | | | | SUBSTRUCTURE DETAILS | | | |
| Bridge No: 430248 | Drawn By: JOE C. HUNTSINGER | | | Date: 4/22/2013 | File Name: S0106001610 | | |

Bridge Inspection Field Sketch

DIAPHRAGM DETAILS

LOCATED AT THE 1/3 POINTS OF ALL SPANS

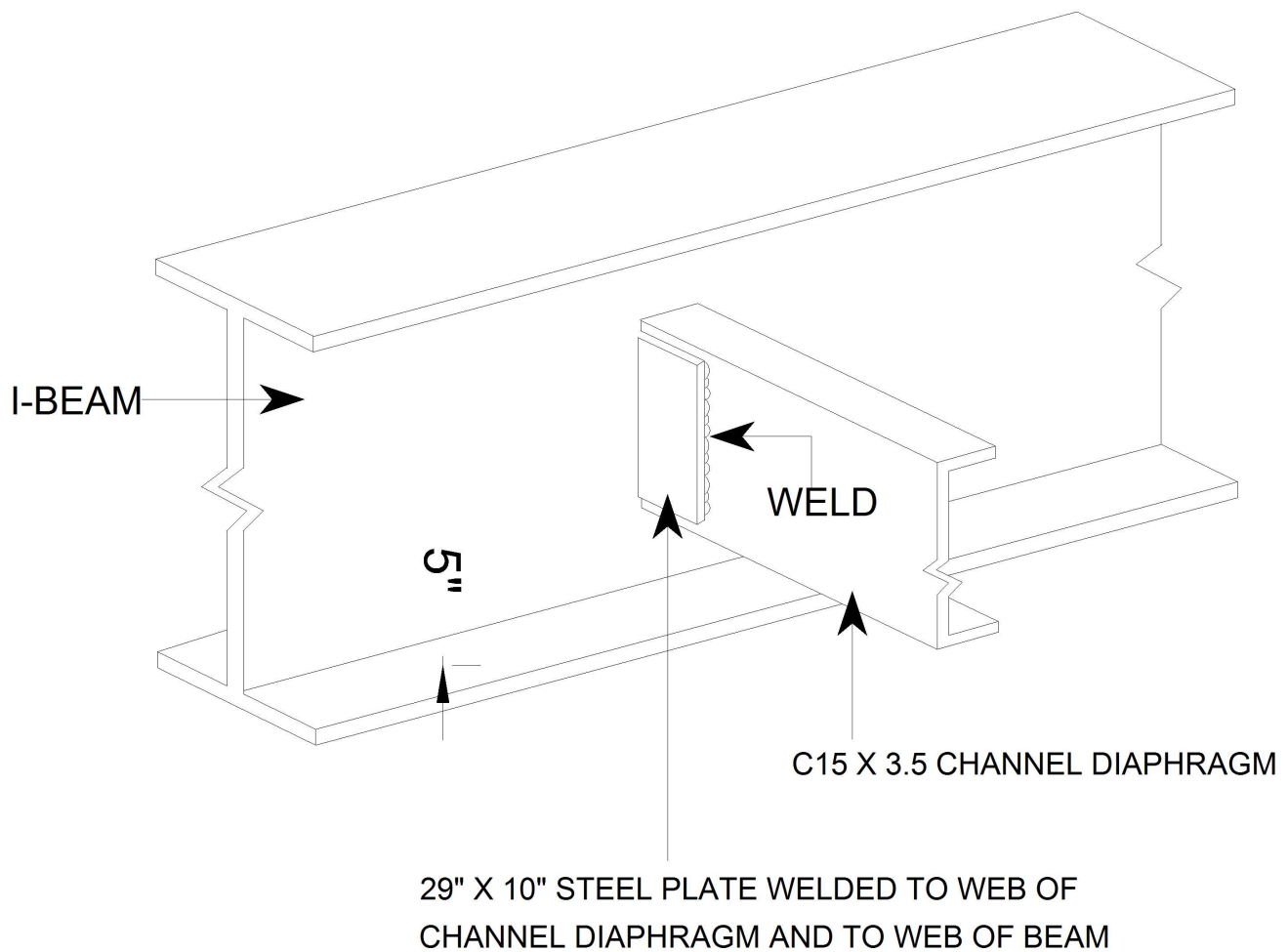

4-25-2017 DELVIN ADAMS

Title

INTERMEDIATE DIAPHRAGMS

Description

SUPERSTRUCTURE DETAILS

Bridge No: 430248

Drawn By: JOE C. HUNTSINGER

Date: 4/22/2013

File Name: S0106001613