

STATE OF NORTH CAROLINA
RAIL DIVISION

TRANSPORTATION MANAGEMENT PLAN

GUILFORD COUNTY

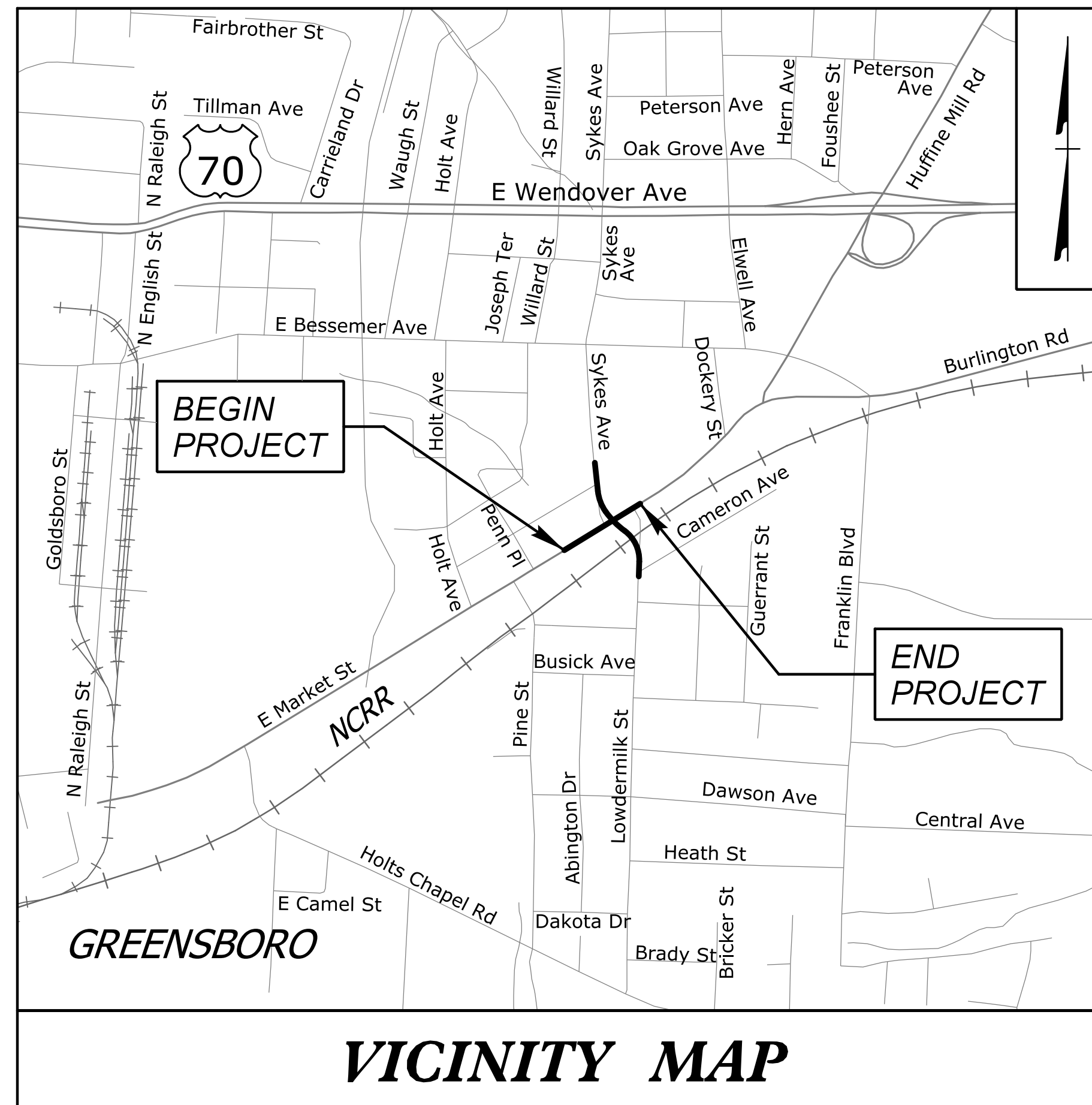
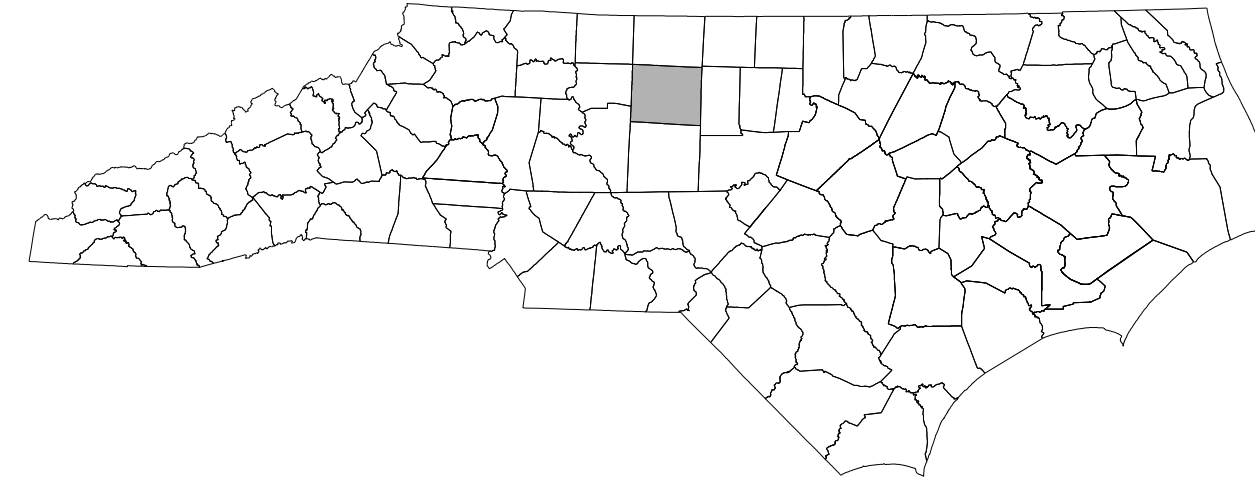

LOCATION: MARKET STREET FROM PINE STREET TO LOWDERMILK STREET

INDEX OF SHEETS

SHEET NO.	TITLE
TMP-1	TITLE SHEET, VICINITY MAP AND INDEX OF SHEETS
TMP-1A	ROADWAY STANDARD DRAWINGS AND LEGEND
TMP-1B	TRANSPORTATION OPERATIONS PLAN: (MANAGEMENT STRATEGIES, GENERAL NOTES AND LOCAL NOTES)
TMP-2	SPECIAL SIGN DESIGN
TMP-3	TEMPORARY TRAFFIC CONTROL PHASING
TMP-4	TEMPORARY TRAFFIC CONTROL PHASE I DETAIL
TMP-5	TEMPORARY TRAFFIC CONTROL PHASE II DETAIL
TMP-6	TEMPORARY TRAFFIC CONTROL PHASE III DETAIL
TMP-7	TEMPORARY TRAFFIC CONTROL PHASE IV OFFSITE DETOUR ROUTE
TMP-8	TEMPORARY TRAFFIC CONTROL PHASE IV DETAIL
TMP-9	TEMPORARY TRAFFIC CONTROL PHASE V DETAIL

SHEET NO.

TMP-1

Y-4807B

TIP PROJECT:

**DOCUMENT NOT CONSIDERED FINAL
UNLESS ALL SIGNATURES COMPLETED**

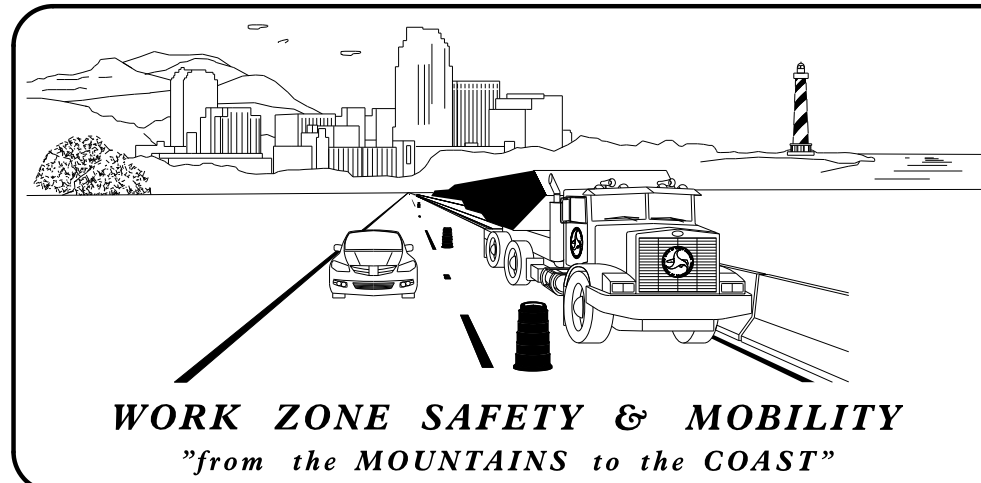

PLANS PREPARED BY:
NIKKI T. HONEYCUTT, PE
TRAFFIC CONTROL PROJECT ENGINEER
MAAMOON K. ABDELAZIZ
TRAFFIC CONTROL DESIGNER

NCDOT CONTACTS:
JOSEPH HUMMER, PE
PROJECT ENGINEER

PROJECT DESIGN ENGINEER

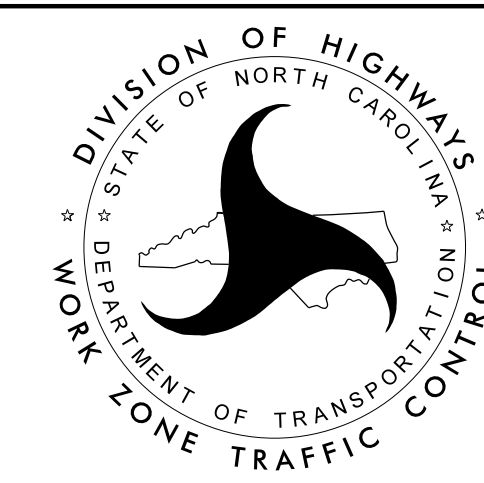

stv STV Engineers, Inc.
900 West Trade St., Suite 715
Charlotte, NC 28202
NC License Number F-0991

APPROVED: _____
DATE: 3/6/2024

SEAL

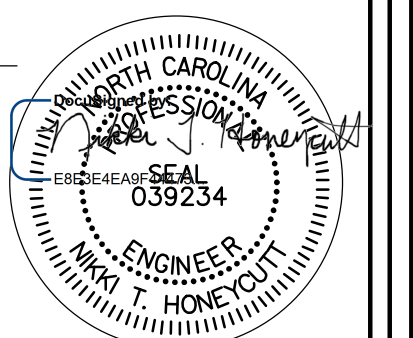

3/5/2024 10:00:41 AM C:\projects\trcficcontrol\top\tcp_sht\Y4807B_TMP_sht-01.dgn mabdelaziz

ROADWAY STANDARD DRAWINGS

THE FOLLOWING ROADWAY STANDARDS AS SHOWN IN "ROADWAY STANDARD DRAWINGS" - PROJECT SERVICES UNIT - N.C. DEPARTMENT OF TRANSPORTATION - RALEIGH, N.C., DATED JAN 2024 ARE APPLICABLE TO THIS PROJECT AND BY REFERENCE HEREBY ARE CONSIDERED A PART OF THESE PLANS:

STD.NO.	TITLE
1101.01	WORK ZONE ADVANCE WARNING SIGNS
1101.02	TEMPORARY LANE CLOSURES
1101.03	TEMPORARY ROAD CLOSURES
1101.05	WORK ZONE VEHICLE ACCESSES
1101.11	TRAFFIC CONTROL DESIGN TABLES
1110.01	STATIONARY WORK ZONE SIGNS
1110.02	PORTABLE WORK ZONE SIGNS
1115.01	FLASHING ARROW BOARDS
1130.01	DRUMS
1135.01	CONES
1145.01	BARRICADES - TYPE III
1150.01	FLAGGERS
1180.01	SKINNY DRUM
1205.01	PAVEMENT MARKINGS - LINE TYPES & OFFSETS
1205.04	PAVEMENT MARKINGS - INTERSECTIONS
1205.08	PAVEMENT MARKINGS - SYMBOLS & WORD MESSAGES
1205.11	PAVEMENT MARKINGS - RAILROAD CROSSINGS

LEGEND

GENERAL

- DIRECTION OF TRAFFIC FLOW
- DIRECTION OF PEDESTRIAN TRAFFIC FLOW
- EXIST. PVMT.
- NORTH ARROW
- PROPOSED PVMT.
- TEMPORARY CURB RAMPS
- WORK AREA
- REMOVAL/BREAKING OF PAVEMENT
- WEDGING AREA

SIGNALS

- EXISTING
- PROPOSED
- TEMPORARY

PAVEMENT MARKINGS

- EXISTING LINES
- TEMPORARY LINES

TEMPORARY CURB RAMPS

CR No.	ALIGN.	STATION	OFFSET	CURB TYPE
TCR-1	L	7+53±	29.33 RT	STD 848.06
TCR-2	L	7+52±	30.47 LT	STD 848.06
TCR-3	L	29+32±	29.20 RT	STD 848.06
TCR-4	L	29+32±	27.58 LT	STD 848.06

TRAFFIC CONTROL DEVICES

- BARRICADE (TYPE III)
- CONE
- DRUM SKINNY DRUM TUBULAR MARKER
- TEMPORARY CRASH CUSHION
- FLASHING ARROW PANEL (TYPE C)
- FLAGGER
- LAW ENFORCEMENT
- TRUCK MOUNTED IMPACT ATTENUATOR (TMIA)
- CHANGEABLE MESSAGE SIGN
- WATER FILLED BARRIER

TEMPORARY SIGNING

- PORTABLE SIGN
- STATIONARY SIGN
- STATIONARY OR PORTABLE SIGN

PAVEMENT MARKERS

- CRYSTAL/CRYSTAL
- CRYSTAL/RED
- YELLOW/YELLOW

PAVEMENT MARKING SYMBOLS

- PAVEMENT MARKING SYMBOLS

TEMPORARY PAVEMENT MARKING

- P2 WHITE SOLID LANE LINE (4")
- P3 10' WHITE SKIP (4")
- P4 3FT. - 9FT. / SP WHITE MINISKIP
- P10 YELLOW EDGELINE (4")
- P13 YELLOW DOUBLE CENTER (4")
- P42 YELLOW DIAGONAL (8")
- P46 WHITE CROSSWALK (8")
- P61 WHITE STOPBAR (24")
- P62 WHITE CROSSWALK LINE (24")
- P70 LEFT TURN ARROW
- P71 RIGHT TURN ARROW
- P74 COMBO STRAIGHT / RIGHT
- P103 YIELD LINE TRIANGLE (24")

3/5/2024 R:\TrafficControl\Tcr\Tcr.dgn

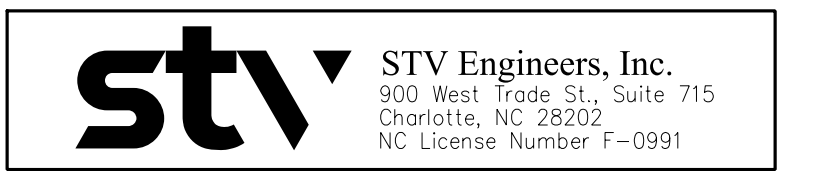

APPROVED: _____ DATE: 3/6/2024 SEAL		ROADWAY STANDARD DRAWINGS & LEGEND
DOCUMENT NOT CONSIDERED FINAL UNLESS ALL SIGNATURES COMPLETED		

MANAGEMENT STRATEGIES

TRAFFIC WILL BE MAINTAINED ON THE EXISTING ROADWAYS, AS THE NEW ALIGNMENT AND WIDENING IS CONSTRUCTED. COORDINATION WITH THE RAILROAD WILL BE NEEDED TO CONSTRUCT THE NEW CROSSING AND REMOVE THE EXISTING.

A TEMPORARY DETOUR WILL BE USED DURING THE CLOSURE OF LOWDERMILK STREET.

A FLAGGING OPERATION WILL BE USED TO CONSTRUCT WEDGING, TIE-INS, AND THE FINAL PAVEMENT MARKINGS.

LOCAL NOTES

- CONTACT GUILFORD COUNTY EMERGENCY SERVICES AND SCHOOLS AT LEAST ONE MONTH PRIOR TO CONSTRUCTION.
- THE CONTRACTOR SHALL BUILD AS MUCH AS POSSIBLE AWAY FROM TRAFFIC.

GENERAL NOTES

CHANGES MAY BE REQUIRED WHEN PHYSICAL DIMENSIONS IN THE DETAIL DRAWINGS, STANDARD DETAILS, AND ROADWAY DETAILS ARE NOT ATTAINABLE TO MEET FIELD CONDITIONS OR RESULT IN DUPLICATE OR UNDESIRED OVERLAPPING OF DEVICES. MODIFICATION MAY INCLUDE: MOVING, SUPPLEMENTING, COVERING, OR REMOVAL OF DEVICES AS DIRECTED BY THE ENGINEER.

THE FOLLOWING GENERAL NOTES APPLY AT ALL TIMES FOR THE DURATION OF THE CONSTRUCTION PROJECT EXCEPT WHEN OTHERWISE NOTED IN THE PLAN OR DIRECTED BY THE ENGINEER.

TIME RESTRICTIONS

- A) DO NOT CLOSE OR NARROW TRAVEL LANES AS FOLLOWS:

ROAD NAME	DAY AND TIME RESTRICTIONS
ANY ROADS	MONDAY - FRIDAY 7 AM - 9 AM 4 PM - 6 PM

HOLIDAY

- FOR ANY UNEXPECTED OCCURENCE THAT CREATES UNUSUALLY HIGH TRAFFIC VOLUME, AS DIRECTED BY THE ENGINEER.
- FOR NEW YEAR'S, BETWEEN THE HOURS OF 7:00 A.M. DECEMBER 31ST TO 6:00 P.M. JANUARY 2ND. IF NEW YEAR'S DAY IS ON A FRIDAY, SATURDAY, SUNDAY, OR MONDAY THEN UNTIL 6:00 P.M. THE FOLLOWING TUESDAY.
- FOR EASTER, BETWEEN THE HOURS OF 7:00 A.M. THURSDAY AND 6:00 P.M. MONDAY.
- FOR MEMORIAL DAY, BETWEEN THE HOURS OF 7:00 A.M. FRIDAY TO 6:00 P.M. TUESDAY.
- FOR INDEPENDENCE DAY, BETWEEN THE HOURS OF 7:00 A.M. THE DAY BEFORE INDEPENDENCE DAY AND 6:00 P.M. THE DAY AFTER. IF INDEPENDENCE DAY IS ON A FRIDAY, SATURDAY, SUNDAY, OR MONDAY THEN BETWEEN THE HOURS OF 7:00 A.M. THE THURSDAY BEFORE INDEPENDENCE DAY AND 6:00 P.M. THE TUESDAY AFTER.
- FOR LABOR DAY, BETWEEN THE HOURS OF 7:00 A.M. FRIDAY AND 6:00 P.M. TUESDAY.
- FOR THANKSGIVING DAY, BETWEEN THE HOURS OF 7:00 A.M. TUESDAY TO 6:00 P.M. MONDAY.
- FOR CHRISTMAS, BETWEEN THE HOURS OF 7:00 A.M. THE FRIDAY BEFORE THE WEEK OF CHRISTMAS DAY AND 6:00 P.M. THE FOLLOWING TUESDAY AFTER THE WEEK OF CHRISTMAS.
- NO LANE CLOSURES WILL BE ALLOWED DURING ANY HOME FOOTBALL GAMES OR GRADUATION CEREMONIES, OCCURRING AT NORTH CAROLINA AGRICULTURAL AND TECHNICAL STATE UNIVERSITY STARTING FOUR HOURS BEFORE THE START AND LASTING FOUR HOURS AFTER THE END OF THE EVENT. CONTRACTOR SHALL COORDINATE WITH NCA&T TO CONFIRM DATES AND TIMES.

2024 HOME FOOTBALL GAMES:
SEPTEMBER 7
SEPTEMBER 14
OCTOBER 19 (HOMECOMING GAME)
NOVEMBER 2
NOVEMBER 23

2024 GRADUATION SCHEDULE:
MAY 10
MAY 11

LANE AND SHOULDER CLOSURE REQUIREMENTS

- B) REMOVE LANE CLOSURE DEVICES FROM THE LANE WHEN WORK IS NOT BEING PERFORMED BEHIND THE LANE CLOSURE OR WHEN A LANE CLOSURE IS NO LONGER NEEDED OR AS DIRECTED BY THE ENGINEER.
- C) WHEN PERSONNEL AND/OR EQUIPMENT ARE WORKING ON THE SHOULDER ADJACENT TO AN UNDIVIDED FACILITY AND WITHIN 5 FT OF AN OPEN TRAVEL LANE, CLOSE THE NEAREST OPEN TRAVEL LANE USING ROADWAY STANDARD DRAWING NO. 1101.02 UNLESS THE WORK AREA IS PROTECTED BY BARRIER OR GUARDRAIL.

WHEN PERSONNEL AND/OR EQUIPMENT ARE WORKING ON THE SHOULDER ADJACENT TO A DIVIDED FACILITY AND WITHIN 10 FT OF AN OPEN TRAVEL LANE, CLOSE THE NEAREST OPEN TRAVEL LANE USING ROADWAY STANDARD DRAWING NO. 1101.02 UNLESS THE WORK AREA IS PROTECTED BY BARRIER OR GUARDRAIL.

- D) WHEN PERSONNEL AND/OR EQUIPMENT ARE WORKING WITHIN A LANE OF TRAVEL OF AN UNDIVIDED OR DIVIDED FACILITY, CLOSE THE LANE ACCORDING TO THE TRAFFIC CONTROL PLANS, ROADWAY STANDARD DRAWINGS, OR AS DIRECTED BY THE ENGINEER. CONDUCT THE WORK SO THAT ALL PERSONNEL AND/OR EQUIPMENT REMAIN WITHIN THE CLOSED TRAVEL LANE.

- E) DO NOT WORK SIMULTANEOUSLY WITHIN 15 FT ON BOTH SIDES OF AN OPEN TRAVELWAY, RAMP, OR LOOP WITHIN THE SAME LOCATION UNLESS PROTECTED WITH GUARDRAIL OR BARRIER.

PAVEMENT EDGE DROP OFF REQUIREMENTS

- F) BACKFILL AT A 6:1 SLOPE UP TO THE EDGE AND ELEVATION OF EXISTING PAVEMENT IN AREAS ADJACENT TO AN OPENED TRAVEL LANE THAT HAS AN EDGE OF PAVEMENT DROP-OFF AS FOLLOWS:

BACKFILL DROP-OFFS THAT EXCEED 2 INCHES ON ROADWAYS WITH POSTED SPEED LIMITS OF 45 MPH OR GREATER.

BACKFILL DROP-OFFS THAT EXCEED 3 INCHES ON ROADWAYS WITH POSTED SPEED LIMITS LESS THAN 45 MPH.

BACKFILL WITH SUITABLE COMPACTED MATERIAL, AS APPROVED BY THE ENGINEER, AT NO EXPENSE TO THE DEPARTMENT.

- G) DO NOT EXCEED A DIFFERENCE OF 2 INCHES IN ELEVATION BETWEEN OPEN LANES OF TRAFFIC FOR NOMINAL LIFTS OF 1.5 INCHES. INSTALL ADVANCE WARNING "UNEVEN LANES" SIGNS (W8-11) 350 ft IN ADVANCE AND A MINIMUM OF EVERY HALF MILE THROUGHOUT THE UNEVEN AREA.

TRAFFIC PATTERN ALTERATIONS

- H) NOTIFY THE ENGINEER TWENTY ONE (30) CALENDAR DAYS PRIOR TO ANY TRAFFIC PATTERN ALTERATION.

SIGNING

- I) INSTALL ADVANCE WORK ZONE WARNING SIGNS WHEN WORK IS WITHIN 40 FT FROM THE EDGE OF TRAVEL LANE AND NO MORE THAN THREE (3) DAYS PRIOR TO THE BEGINNING OF CONSTRUCTION.

- J) PROVIDE SIGNING AND DEVICES REQUIRED TO CLOSE THE ROAD ACCORDING TO THE ROADWAY STANDARD DRAWINGS AND TRAFFIC CONTROL PLANS.

PROVIDE SIGNING REQUIRED FOR THE OFF-SITE DETOUR ROUTE AS SHOWN IN THE TRAFFIC CONTROL PLANS.

- K) COVER OR REMOVE ALL SIGNS AND DEVICES REQUIRED TO CLOSE THE ROAD WHEN ROAD CLOSURE IS NOT IN OPERATION.

COVER OR REMOVE ALL SIGNS AND DEVICES REQUIRED FOR THE OFF-SITE DETOUR WHEN THE DETOUR IS NOT IN OPERATION.

- L) ENSURE ALL NECESSARY SIGNING IS IN PLACE PRIOR TO ALTERING ANY TRAFFIC PATTERN.

TRAFFIC CONTROL DEVICES

- M) WHEN LANE CLOSURES ARE NOT IN EFFECT SPACE CHANNELIZING DEVICES IN WORK AREAS NO GREATER IN FEET THAN TWICE THE POSTED SPEED LIMIT (MPH) EXCEPT, 10 FT ON-CENTER IN RADII, AND 3 FT OFF THE EDGE OF AN OPEN TRAVELWAY. REFER TO STANDARD SPECIFICATIONS FOR ROADS AND STRUCTURES SECTIONS 1130 (DRUMS), 1135 (CONES) AND 1180 (SKINNY DRUMS) FOR ADDITIONAL REQUIREMENTS.

- N) PLACE TYPE III BARRICADES, WITH "ROAD CLOSED" SIGN R11-2 ATTACHED, OF SUFFICIENT LENGTH TO CLOSE ENTIRE ROADWAY.

- O) PLACE ADDITIONAL SETS OF THREE CHANNELIZING DEVICES PERPENDICULAR TO THE EDGE OF TRAVELWAY ON 500 FT CENTERS WHEN OPENED LANES ARE CLOSED TO TRAFFIC.

PAVEMENT MARKINGS AND MARKERS

- P) INSTALL TEMPORARY PAVEMENT MARKINGS AND TEMPORARY PAVEMENT MARKERS ON INTERIM LAYERS OF PAVEMENT AS FOLLOWS:

ROAD NAME	MARKING	MARKER
ANY ROADS	PAINT	NONE

- Q) PLACE ONE APPLICATION OF PAINT FOR TEMPORARY TRAFFIC PATTERNS. PLACE A SECOND APPLICATION OF PAINT SIX (6) MONTHS AFTER THE INITIAL APPLICATION AND EVERY SIX MONTHS AS DIRECTED BY THE ENGINEER.

- R) TIE PROPOSED PAVEMENT MARKING LINES TO EXISTING PAVEMENT MARKING LINES.

- S) REMOVE/REPLACE ANY CONFLICTING/DAMAGED PAVEMENT MARKINGS AND MARKERS BY THE END OF EACH DAY'S OPERATION.

MISCELLANEOUS

- T) IN THE EVENT A TIE-IN CANNOT BE MADE IN ONE DAY'S TIME, BRING THE TIE-IN AREA TO AN APPROPRIATE ROADWAY ELEVATION AS DETERMINED BY THE ENGINEER. PLACE BLACK ON ORANGE "LOOSE GRAVEL" SIGNS (W8-7) AND BLACK ON ORANGE "PAVEMENT ENDS" SIGNS (W8-3) 100 FT AND 200 FT RESPECTIVELY IN ADVANCE OF THE UNEVEN AREAS. USE DRUMS TO DELINEATE THE EDGE OF ROADWAY ALONG UNPAVED AREAS.

- U) ALL CURB RAMP LOCATIONS SHALL BE DERIVED FROM STATIONING SHOWN ON PAVEMENT MARKING PLANS OR AS DIRECTED BY THE ENGINEER IN COORDINATION WITH THE SIGNING AND DELINEATION UNIT.

- V) CONTRACTOR SHALL MAINTAIN SIDEWALK ACCESS AT ALL TIMES AS STATED IN THE PHASING. CONTRACTOR SHALL BE RESPONSIBLE TO PROVIDE TEMPORARY SIDEWALKS (CONCRETE, ASPHALT, OR OTHER SUITABLE MATERIAL AS APPROVED BY THE ENGINEER) AT ALL LOCATIONS WHERE THE OPEN PEDSTRIAN TRAVELWAY HAS BEEN REMOVED FOR THE CONSTRUCTION OPERATIONS (UTILITIES, DRAINAGE, ETC.).



APPROVED: _____ DATE: 3/6/2024 SEAL			GENERAL NOTES
DOCUMENT NOT CONSIDERED FINAL UNLESS ALL SIGNATURES COMPLETED			

NOTES

THE CONTRACTOR MUST AND RETURN TRAFFIC TO THE EXISTING TRAFFIC PATTERN AT THE END OF EACH WORK DAY UNLESS OTHERWISE NOTED IN THE PHASING BELOW OR DIRECTED BY THE ENGINEER.

MAINTAIN VEHICULAR ACCESS TO ALL RESIDENCES AND BUSINESSES DURING THE LIFE OF THE CONTRACT UNLESS NOTED IN THE PHASING OR DIRECTED BY THE ENGINEER.

COMPLETE ANY PROPOSED WIDENING IN SUCH A MANNER THAT PONDING OF WATER WILL NOT OCCUR IN THE TRAVEL LANE. THIS MAY REQUIRE INSTALLATION OF PROPOSED PIPES, TEMPORARY PIPES, STEEL PLATES, AND TEMPORARY DITCHES.

COORDINATE WITH NCRR/NSR FOR THE INSTALLATION OF CROSSING SURFACE, SIGNALS, GATES AND REMOVAL OF EXISTING CROSSING SURFACE, SIGNAL AND GATES.

MAINTAIN PEDESTRIAN ACCESS UNLESS OTHERWISE NOTED IN THE PLANS OR DIRECTED BY THE ENGINEER.

PHASE I

REFER TO TMP-4

- STEP 1: INSTALL ADVANCED WORK ZONE WARNING SIGNS ON ALL ROADWAYS WITHIN THE PROJECT LIMITS IN ACCORDANCE WITH NCDOT RSD. 1101.01, SHEET 1 THRU 3.
- STEP 2: USING RSD 1101.02 (SHEET 1,3 OF 19) FLAGGERS AS NEEDED, CONSTRUCT TEMPORARY CROSSWALKS AND ACCESSIBLE RAMPS AT HOLT AVENUE / E. MARKET STREET AND DOCKERY STREET / E. MARKET STREET INTERSECTIONS.
INSTALL ADA COMPLIANT PEDESTRIAN DETOUR BARRICADES AND SIGNAGE TO CLOSE THE EXISTING SIDEWALK ON THE NORTH SIDE OF E. MARKET STREET FROM -L- STATION 7+50 +/- TO STATION 29+40 +/- . SHIFT PEDESTRIAN TRAFFIC TO DETOUR ALONG THE SOUTH SIDE OF E. MARKET STREET AND CLOSE THE EXISTING SIDEWALK.
- STEP 3: AWAY FROM TRAFFIC CONSTRUCT NEW ALIGNMENT OF SYKES AVENUE FROM -Y1- STATION 10+34 +/- TO STATION 14+37 +/-, UP TO BUT NOT INCLUDING THE FINAL SURFACE LAYER OF SURFACE COURSE AND PLACE TEMPORARY PAVEMENT MARKINGS. WHEN WORK IS WITHIN 5' OF AN OPEN LANE, MAINTAIN TRAFFIC USING RDS 1101.02 (SHEET 1,3 OF 19) AS NEEDED AT TIE IN LOCATIONS.
- STEP 4: MAINTAINING TRAFFIC USING RDS 1101.02 (SHEET 1 OF 19) AS NEEDED, CONSTRUCT WIDENING AND SIDEWALK ALONG CALUMET PLACE, UP TO BUT NOT INCLUDING THE FINAL SURFACE LAYER OF SURFACE COURSE.

PHASE II

REFER TO TMP-5

- STEP 1: UTILIZING THE PEDESTRIAN DETOUR FROM PHASE I, CLOSE THE EXISTING SIDEWALK ALONG THE NORTH SIDE OF E. MARKET STREET FROM -L- STATION 7+50 +/- TO STATION 29+40 +/- .

USING RSD 1101.02 (SHEET 1, 3 OF 19) FLAGGERS AS NEEDED, CONSTRUCT ANY TIE-IN WORK, PLACE TEMPORARY PAVEMENT MARKINGS, AND SHIFT TRAFFIC TO THE NEW ALIGNMENT OF SYKES AVENUE.
- STEP 2: CONSTRUCT CURB AND GUTTER, SIDEWALK, DRIVEWAY, AND REMOVE EXISTING PAVEMENT FROM -Y1- STATION 12+44 +/- TO STATION 14+12 +/- .

PHASE III

REFER TO TMP-6

CONTRACTOR SHALL BE RESPONSIBLE FOR PROVIDING FLAGGER SERVICES. CONTRACTOR SHALL DIRECT HIRE FLAGGERS FROM ONE OF NORFOLK SOUTHERN'S APPROVED VENDORS.

- STEP 1: USING RSD 1101.02 (SHEET 1, 3 OF 19) FLAGGERS AS NEEDED, INSTALL ADA COMPLIANT PEDESTRIAN DETOUR BARRICADES AND SIGNAGE TO CLOSE THE EXISTING SIDEWALK ALONG THE SOUTH SIDE OF E. MARKET STREET FROM -L- STATION 7+50 +/- TO STATION 29+40 +/- . SHIFT PEDESTRIAN TRAFFIC TO DETOUR ALONG THE NORTH SIDE OF E. MARKET STREET AND CLOSE THE EXISTING SIDEWALK.
- STEP 2: COORDINATE WITH NORFOLK SOUTHERN RAILROAD TO SCHEDULE THE RAILROAD FLAGGER. AWAY FROM TRAFFIC, CONSTRUCT NEW ALIGNMENT OF LOWDERMILK STREET FROM -Y1- STATION 14+94 +/- TO STATION 17+37 +/-, UP TO BUT NOT INCLUDING THE FINAL SURFACE LAYER OF SURFACE COURSE. COORDINATE WITH THE RAILROAD TO DETERMINE SCHEDULE FOR THE CONSTRUCTION OF THE NEW TRACK CROSSING. THE CONTRACTOR IS TO PROVIDE GRADING, FILL, DRAINAGE, AND PAVEMENT TIE IN TO THE NEW CROSSING SURFACE. THE RAILROAD WILL CONSTRUCT THE CROSSING SURFACE. WHEN WORK IS WITHIN 5' OF AN OPEN LANE, MAINTAIN TRAFFIC USING RDY 1101.02 (SHEET 1 OF 19) AS NEEDED AT TIE IN LOCATIONS.
- STEP 3: USING RSD 1101.02 (SHEET 1 OF 19), CONSTRUCT DRIVEWAY ON CAMERON AVE. -Y3- STATION 11+40 +/- .

PHASE IV

COMPLETE THE WORK OF PHASE IV WITHIN 45 CALENDAR DAYS FROM PHASE COMMENCEMENT.
SEE INTERMEDIATE CONTRACT TIME AND LIQUIDATED DAMAGES.

REFER TO TMP-7 & TMP-8

- STEP 1: INSTALL OFFSITE DETOUR SIGNAGE AND BARRICADES AND IN ACCORDANCE WITH RSD 1101.03, SHEET 1 OF 9, CLOSING LOWDERMILK STREET TO THRU TRAFFIC.
- STEP 2: UTILIZE THE PEDESTRIAN DETOUR FROM PHASE III CLOSING THE EXISTING SIDEWALK ALONG THE SOUTH SIDE OF E. MARKET STREET FROM -L- STATION 7+50 +/- TO STATION 29+40 +/- .

CONSTRUCT PROPOSED IMPROVEMENTS ALONG LOWDERMILK STREET, -Y1- STATION 16+53 +/- TO STATION 20+40 +/- UP THROUGH THE FINAL PAVEMENT SURFACE AND INSTALL FINAL PAVEMENT MARKINGS.

MAINTAIN LOCAL TRAFFIC TO CAMERON AVENUE.
- STEP 3: USING TEMPORARY LANE CLOSURES ROADWAY STANDARD DRAWING 1101.02, CONSTRUCT WEDGING ALONG -L- UP TO BUT NOT INCLUDING THE FINAL LAYER OF SURFACE COURSE.
- STEP 4: INSTALL NEW SIGNAL POLES AND SIGNALS AT THE LOWDERMILK STREET / SYKES AVENUE INTERSECTION PER THE FINAL SIGNAL PLANS. APPLY TEMPORARY PAVEMENT MARKINGS ACCORDING TO THE FINAL PAVEMENT MARKING PLANS ALONG SYKES AVENUE AND E. MARKET STREET. AFTER THE NEW TRAFFIC SIGNAL AND RAILROAD CROSSING SIGNALS ARE ACTIVE, REMOVE ALL DETOUR SIGNS AND DEVICES, AND OPEN -Y1- LOWDERMILK STREET TO TRAFFIC IN THE FINAL TRAFFIC PATTERN.

PHASE V

REFER TO TMP-9

- STEP 1: UTILIZE THE PEDESTRIAN DETOUR FROM PHASE III CLOSING THE EXISTING SIDEWALK ALONG THE SOUTH SIDE OF E. MARKET STREET FROM -L- STATION 7+50 +/- TO STATION 29+40 +/- .
- STEP 2: CONSTRUCT PROPOSED IMPROVEMENTS ALONG PINE STREET, -DR2- STATION 10+27 +/- TO STATION 13+10 +/- UP THROUGH THE FINAL PAVEMENT SURFACE. WHEN WORK IS WITHIN 5' OF AN OPEN LANE, MAINTAIN TRAFFIC USING RDS 1101.02 (SHEET 1 OF 19) AS NEEDED AT TIE IN LOCATIONS.
- STEP 3: CONSTRUCT PROPOSED IMPROVEMENTS ALONG (OLD) LOWDERMILK STREET, -DR1- STATION 10+28 +/- TO STATION 11+05 +/- UP THROUGH THE FINAL PAVEMENT SURFACE. WHEN WORK IS WITHIN 5' OF AN OPEN LANE, MAINTAIN TRAFFIC USING RDS 1101.02 (SHEET 1 OF 19) AS NEEDED AT TIE IN LOCATIONS.

PHASE VI

- STEP 1: USING ROADWAY STANDARD DRAWING 1101.02 SHEETS 1,2 AND 3 OF 19, PLACE FINAL LAYER OF PAVEMENT SURFACE COURSE AND FINAL PAVEMENT MARKINGS ALONG E. MARKET STREET (-L-), CALUMET PLACE (-Y2-) AND SYKES AVENUE (-Y1-).
- STEP 2: REMOVE TEMPORARY CROSSWALKS AT HOLT AVENUE, DOCKERY STREET AND E. MARKET STREET.
- STEP 3: REMOVE ALL TEMPORARY TRAFFIC CONTROL DEVICES AND OPEN ALL ROADS TO TRAFFIC.

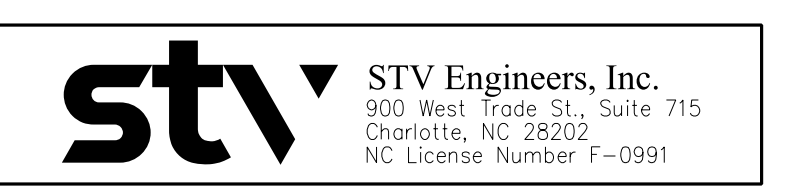

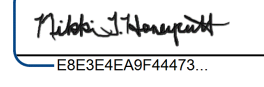
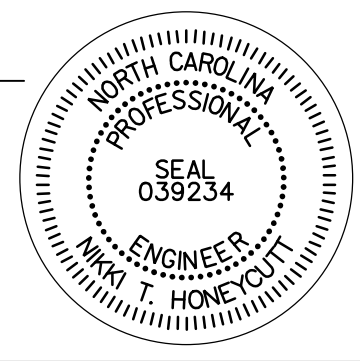
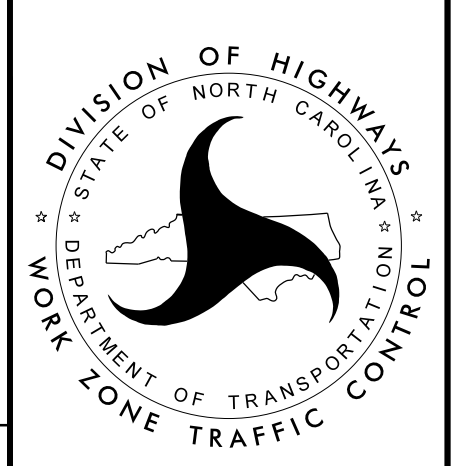
APPROVED:  DATE: 3/20/2024 SEAL			<h2 style="margin: 0;">PHASING</h2>
DOCUMENT NOT CONSIDERED FINAL UNLESS ALL SIGNATURES COMPLETED			

3/20/2024 1:14:11 PM F:\Traffic\TrafficControl\Tcpt\sh1\Y4807B_TMP_sht-03.dgn

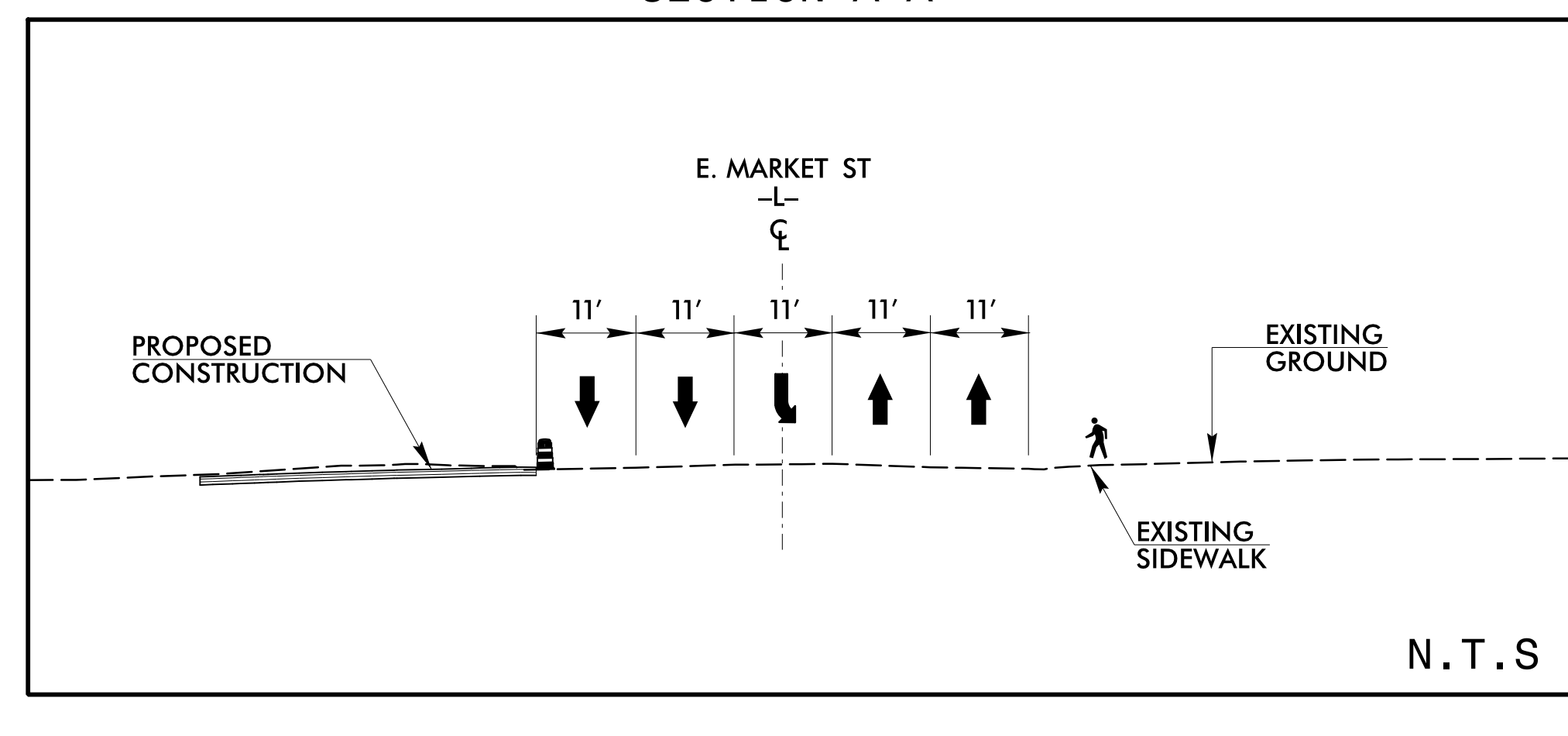
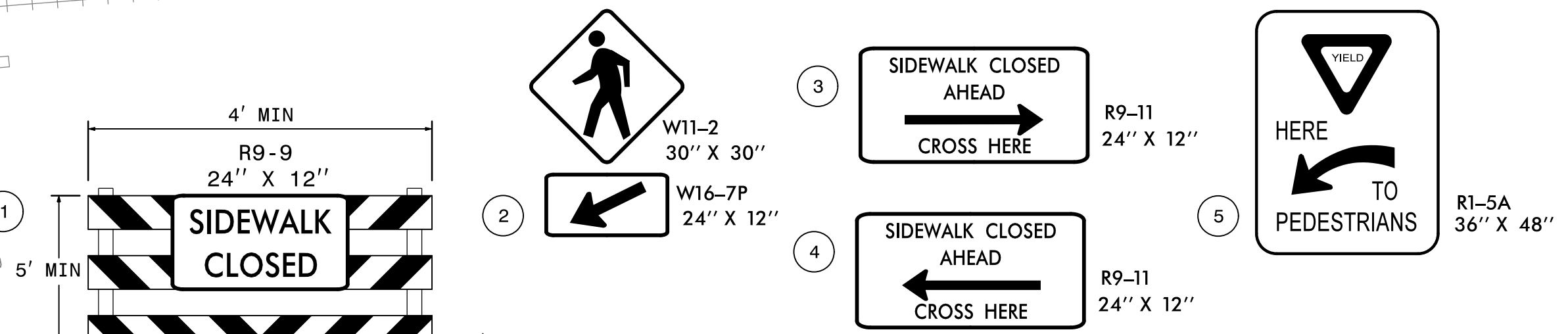
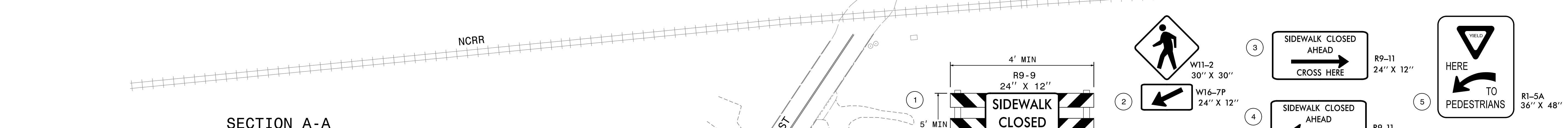
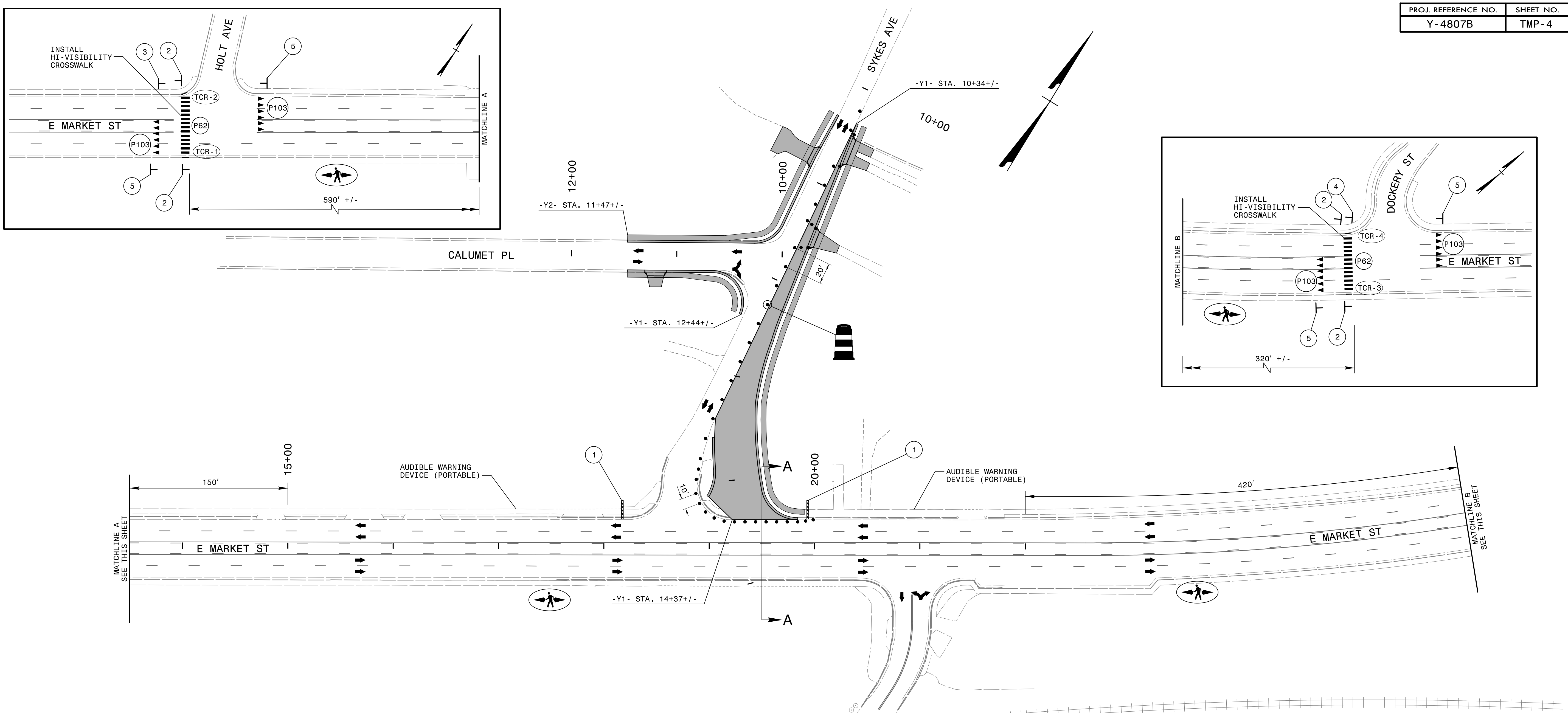

SEE SHEET TMP-1A FOR TEMPORARY PAVEMENT MARKING LEGEND
AUDIBLE WARNING DEVICE TO BE ADDED 100' BEFORE EACH PEDESTRIAN BARRICADE.

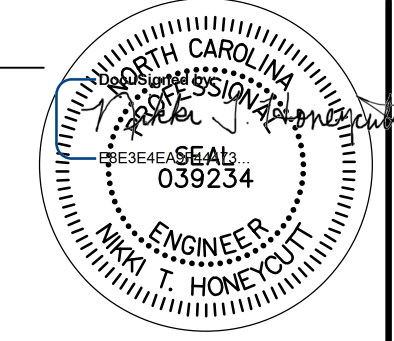
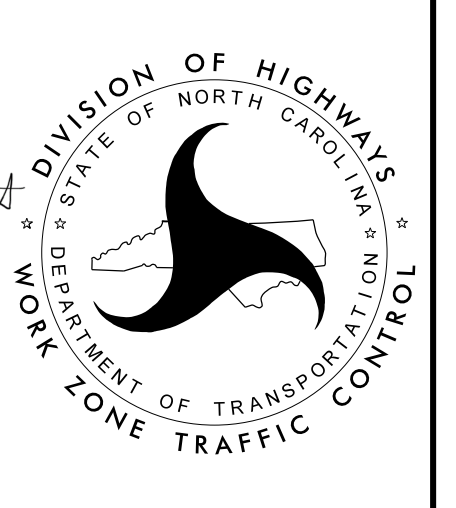
APPROVED: _____ DATE: 3/6/2024 SEAL 		PHASE I DETAIL
<p>DOCUMENT NOT CONSIDERED FINAL UNLESS ALL SIGNATURES COMPLETED</p>		

3/5/2024
c:\projects\trafficcontrol\tcp_sht\Y4807B_TMP_sht-04.dgn
mdd@stvi.com

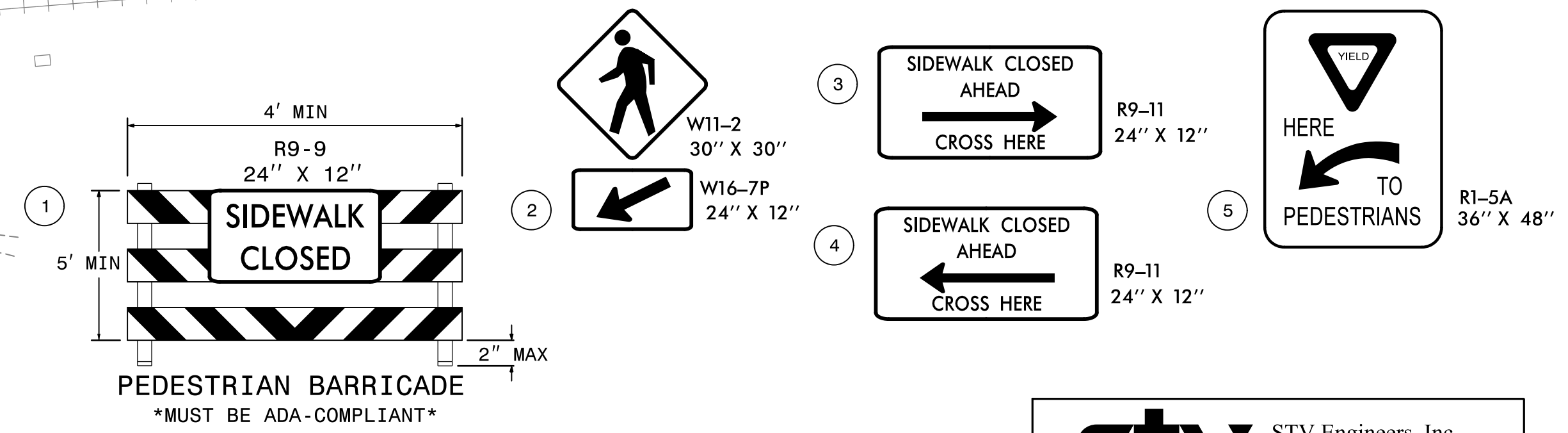
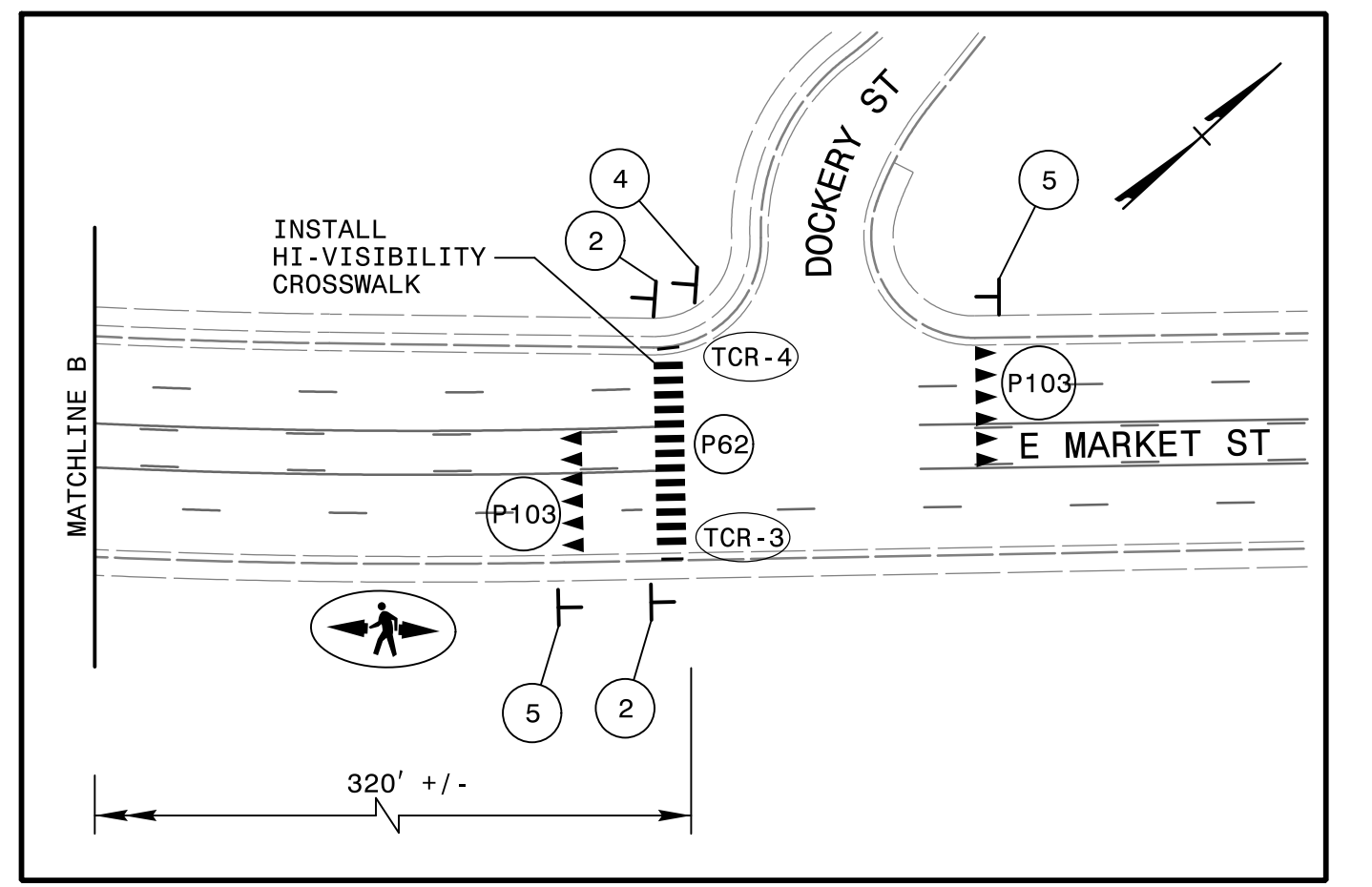
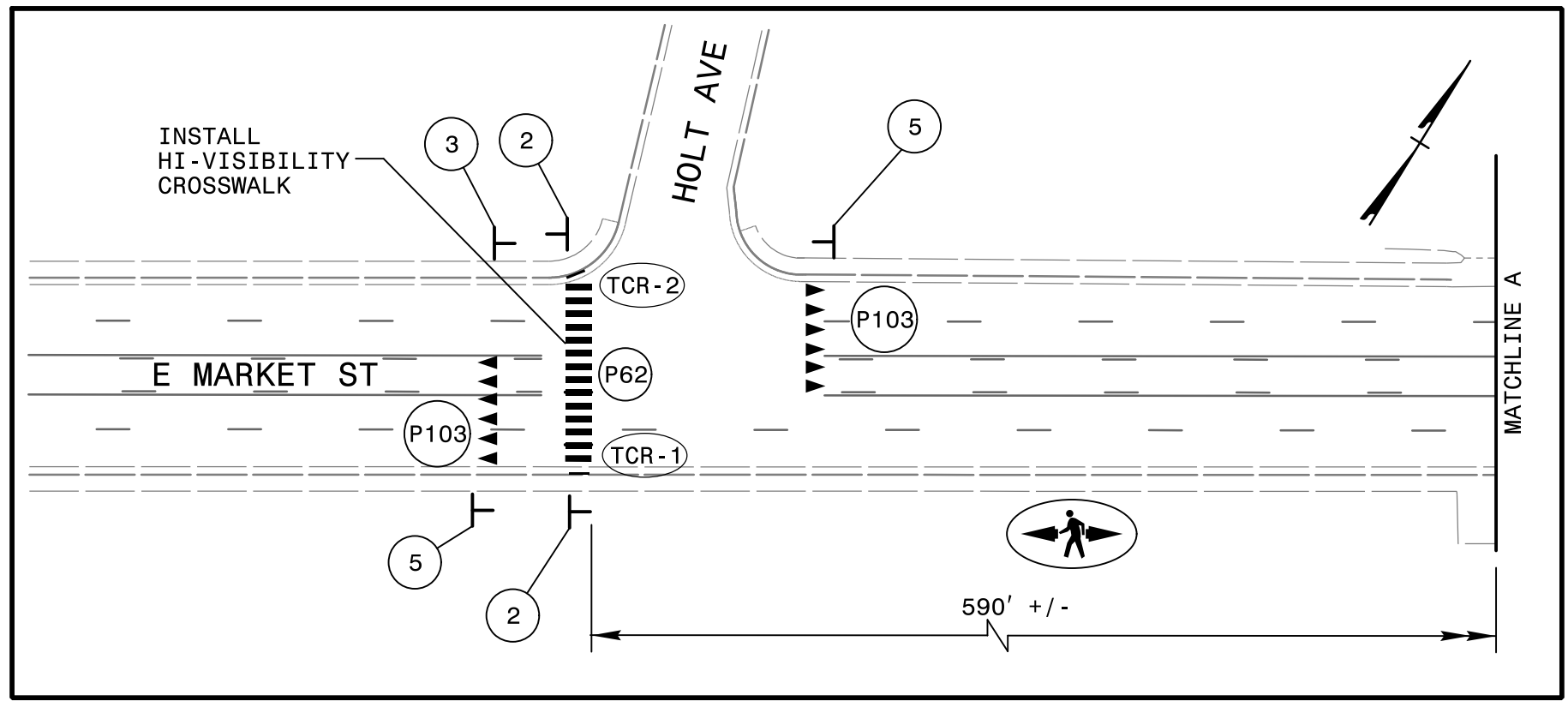
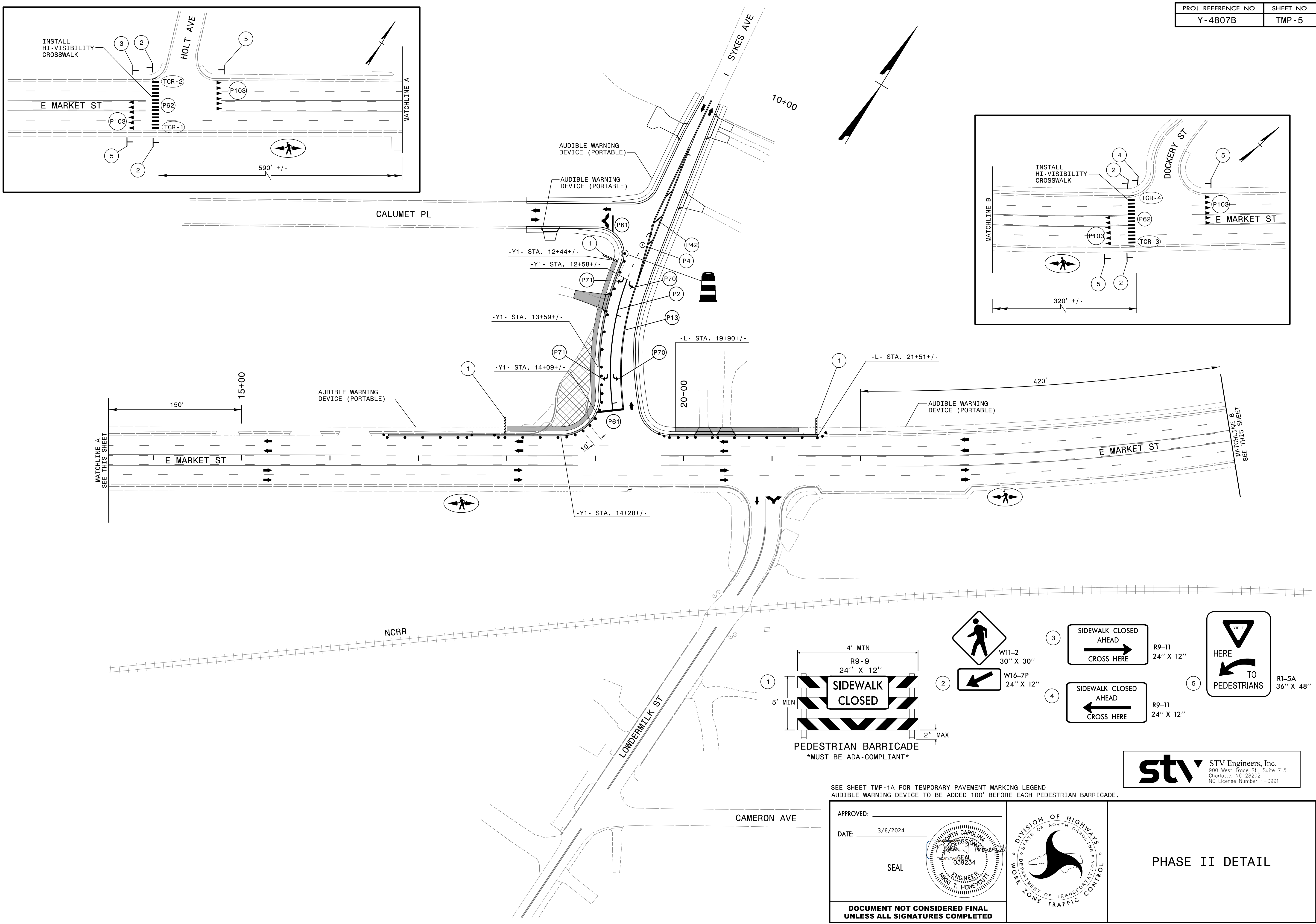

SEE SHEET TMP-1A FOR TEMPORARY PAVEMENT MARKING LEGEND
AUDIBLE WARNING DEVICE TO BE ADDED 100' BEFORE EACH PEDESTRIAN BARRICADE.

APPROVED: _____
DATE: 3/6/2024

SEAL

**DOCUMENT NOT CONSIDERED FINAL
UNLESS ALL SIGNATURES COMPLETED**

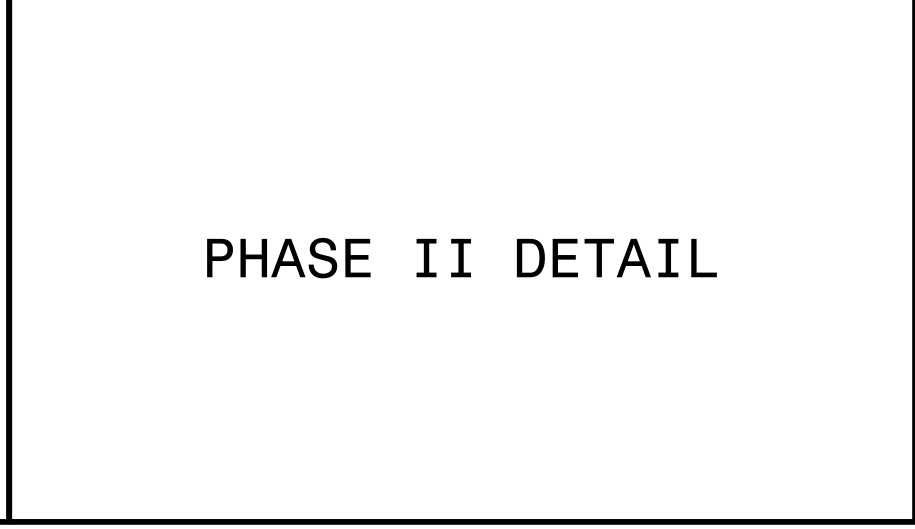
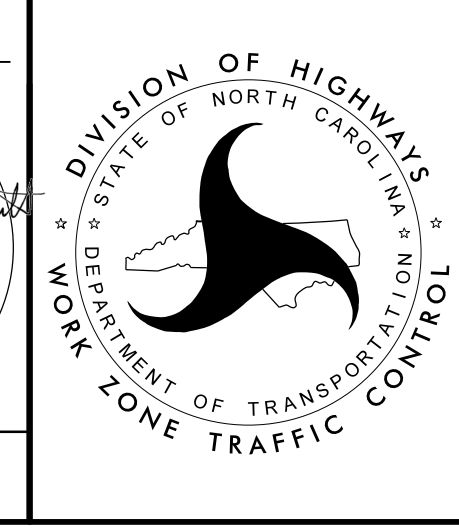

stv STV Engineers, Inc.
900 West Trade St., Suite 715
Charlotte, NC 28202
NC License Number F-0991

3/5/2024
c:\projects\trafficcontrol\tcp_sht\Y4807B_TMP_sht-05.dgn
madd@stv.com

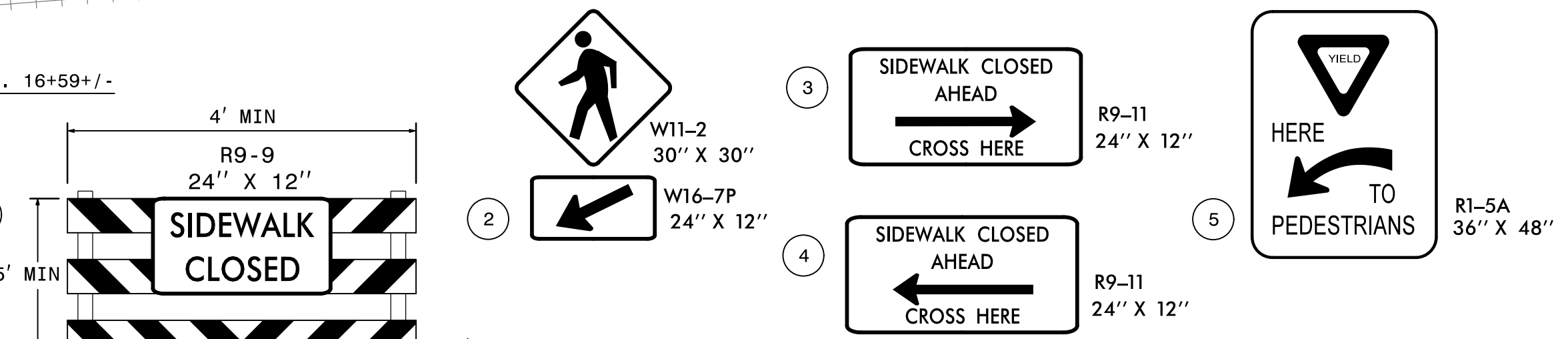
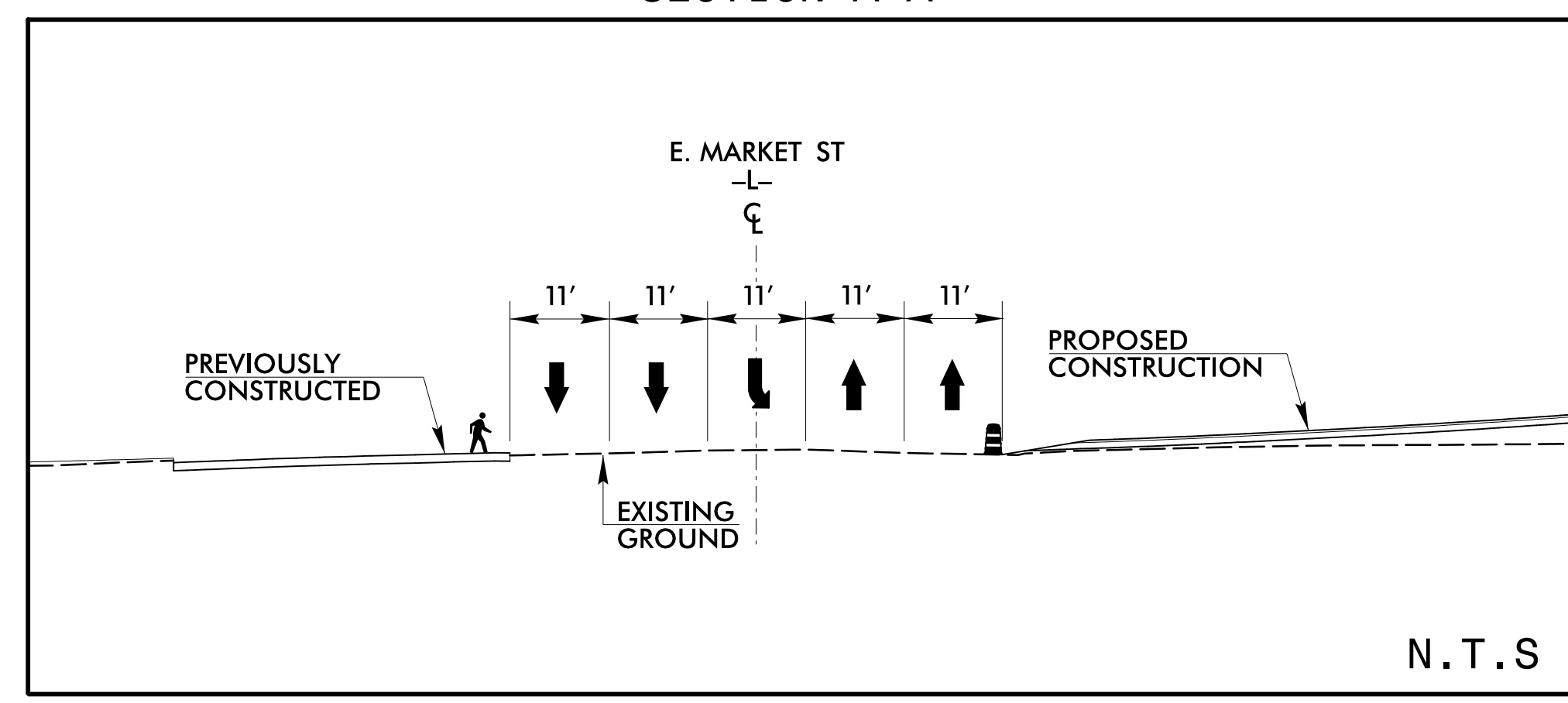
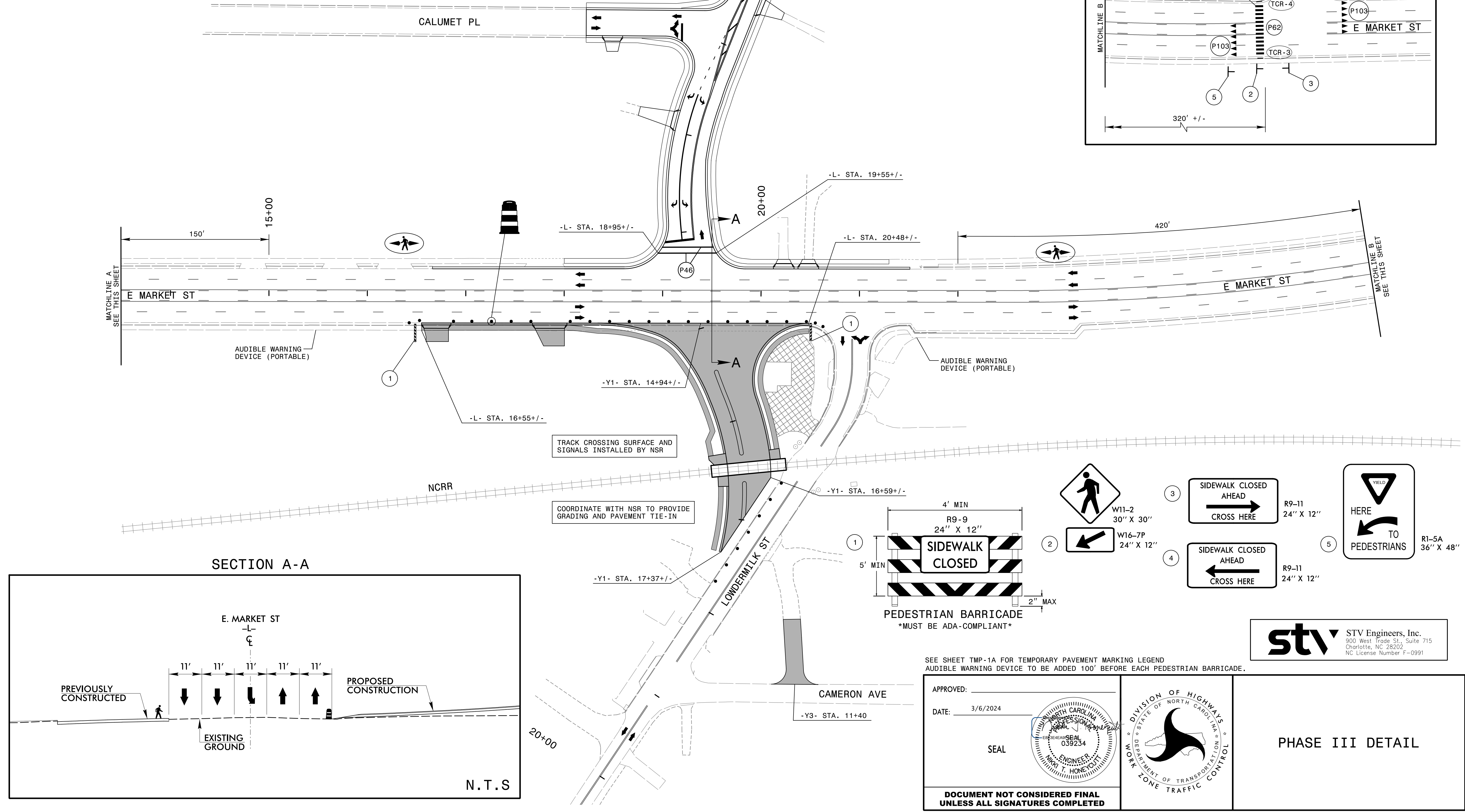
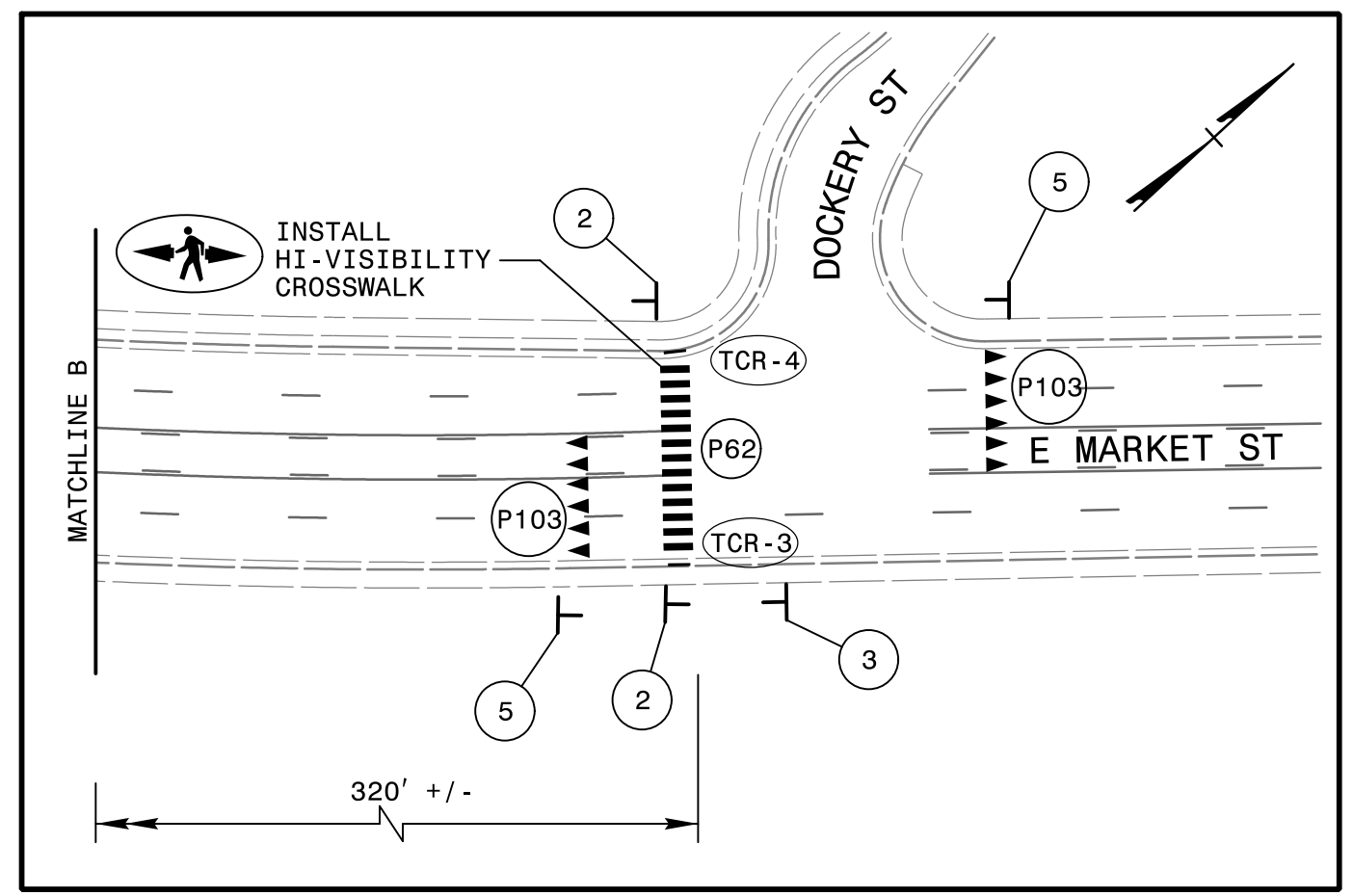
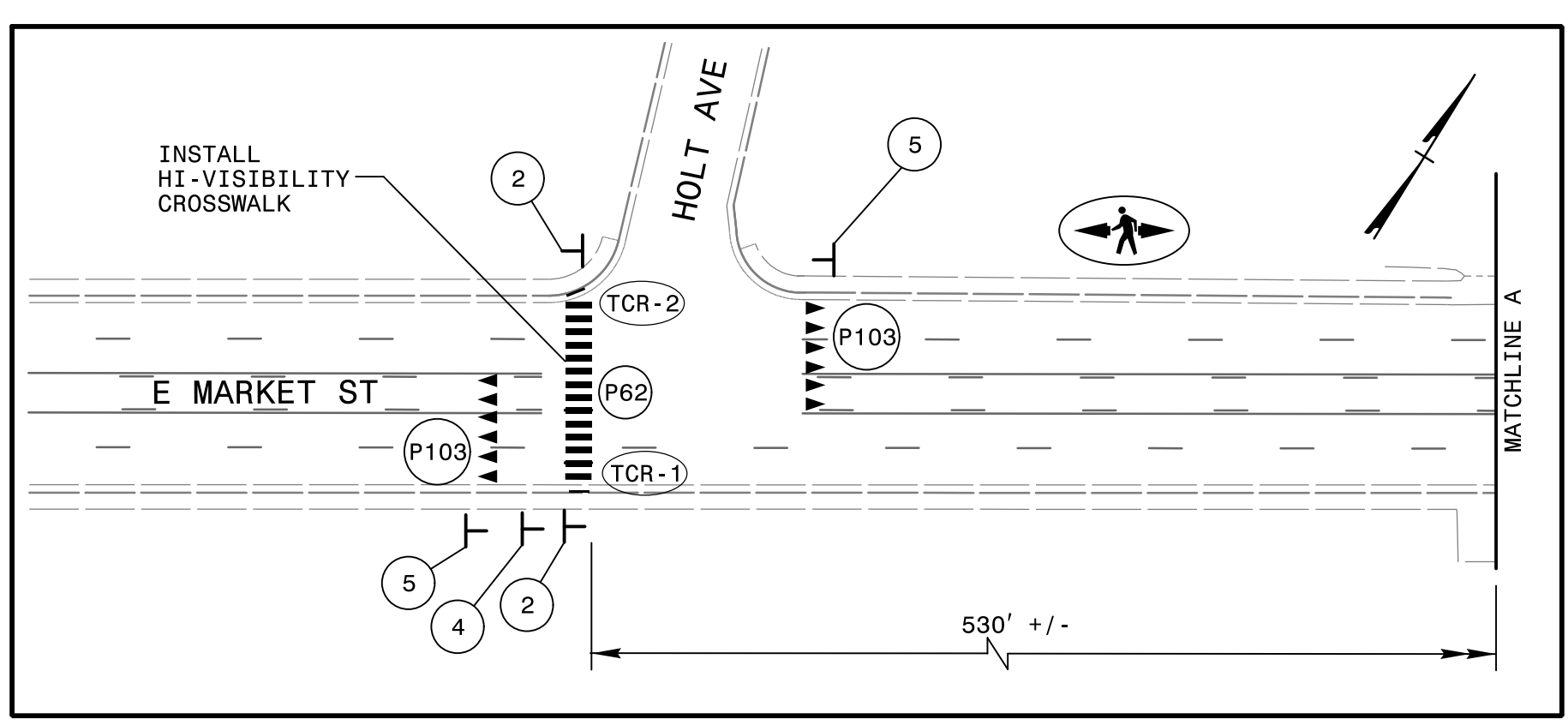

SEE SHEET TMP-1A FOR TEMPORARY PAVEMENT MARKING LEGEND
 AUDIBLE WARNING DEVICE TO BE ADDED 100' BEFORE EACH PEDESTRIAN BARRICADE.

APPROVED: _____
 DATE: 3/6/2024

SEAL

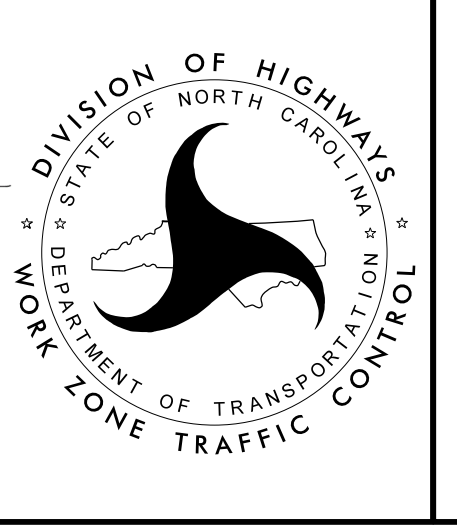

stv STV Engineers, Inc.
 900 West Trade St., Suite 715
 Charlotte, NC 28202
 NC License Number F-0991

PHASE III DETAIL

3/5/2024
 r:\projects\trafficcontrol\tcp_sht\Y4807B_TMP_sht-06.dgn
 mdd@stviz.com

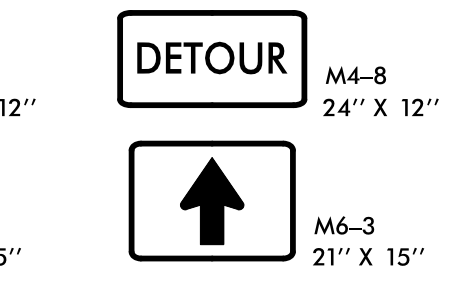
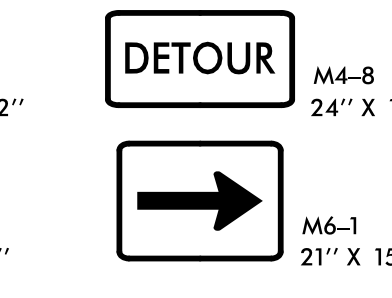
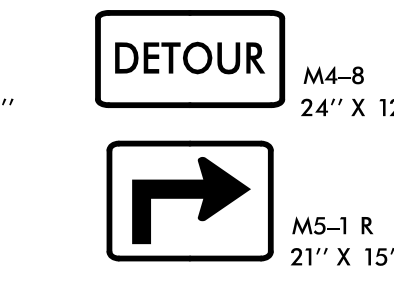
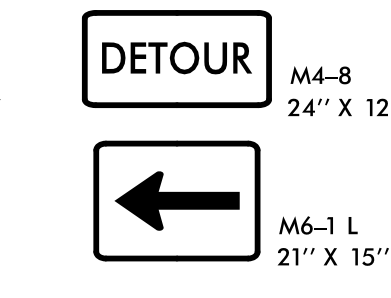
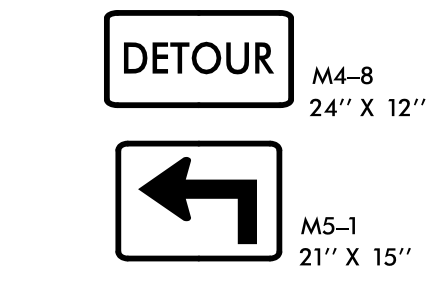
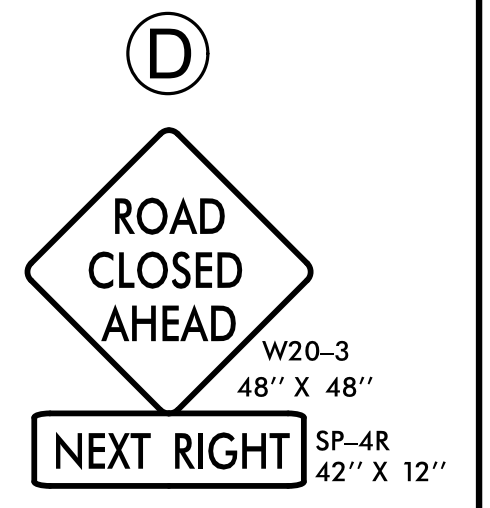
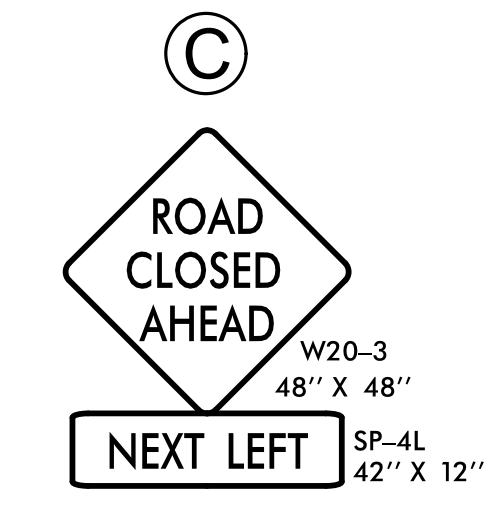
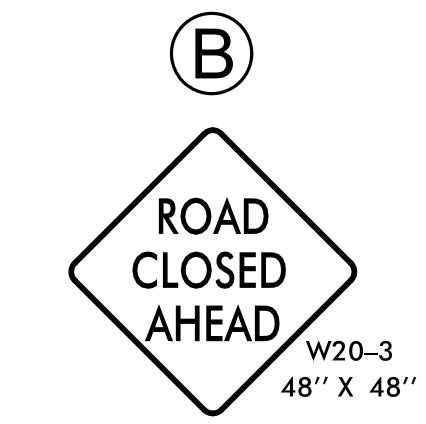
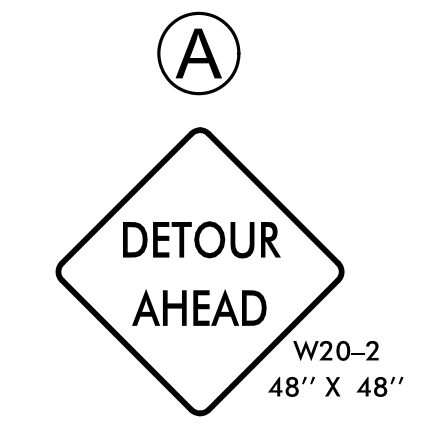
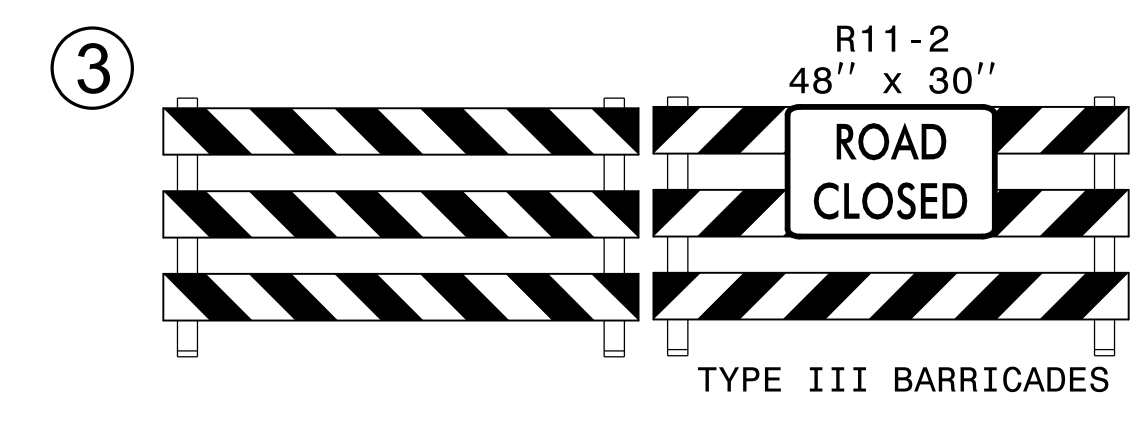
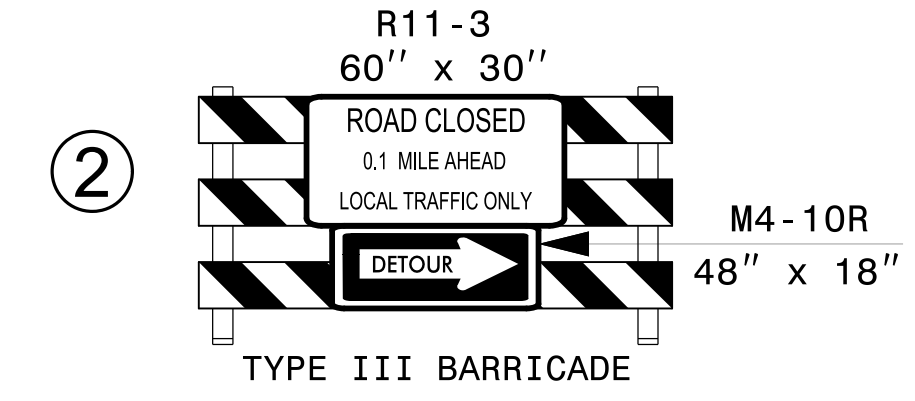
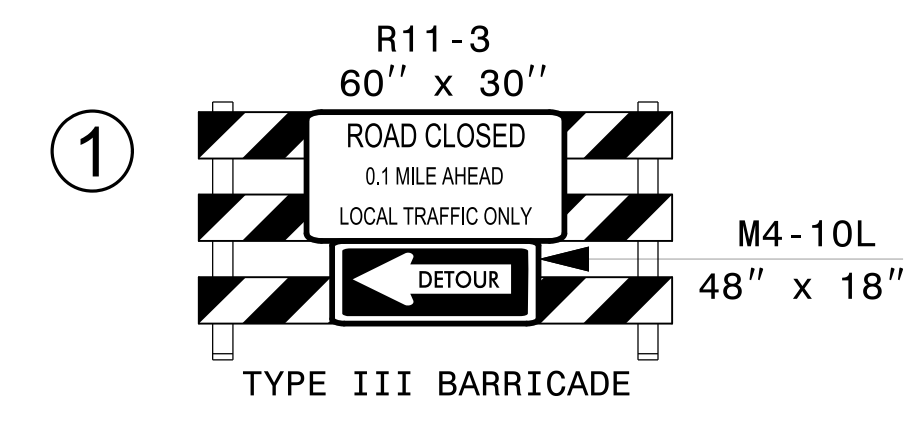
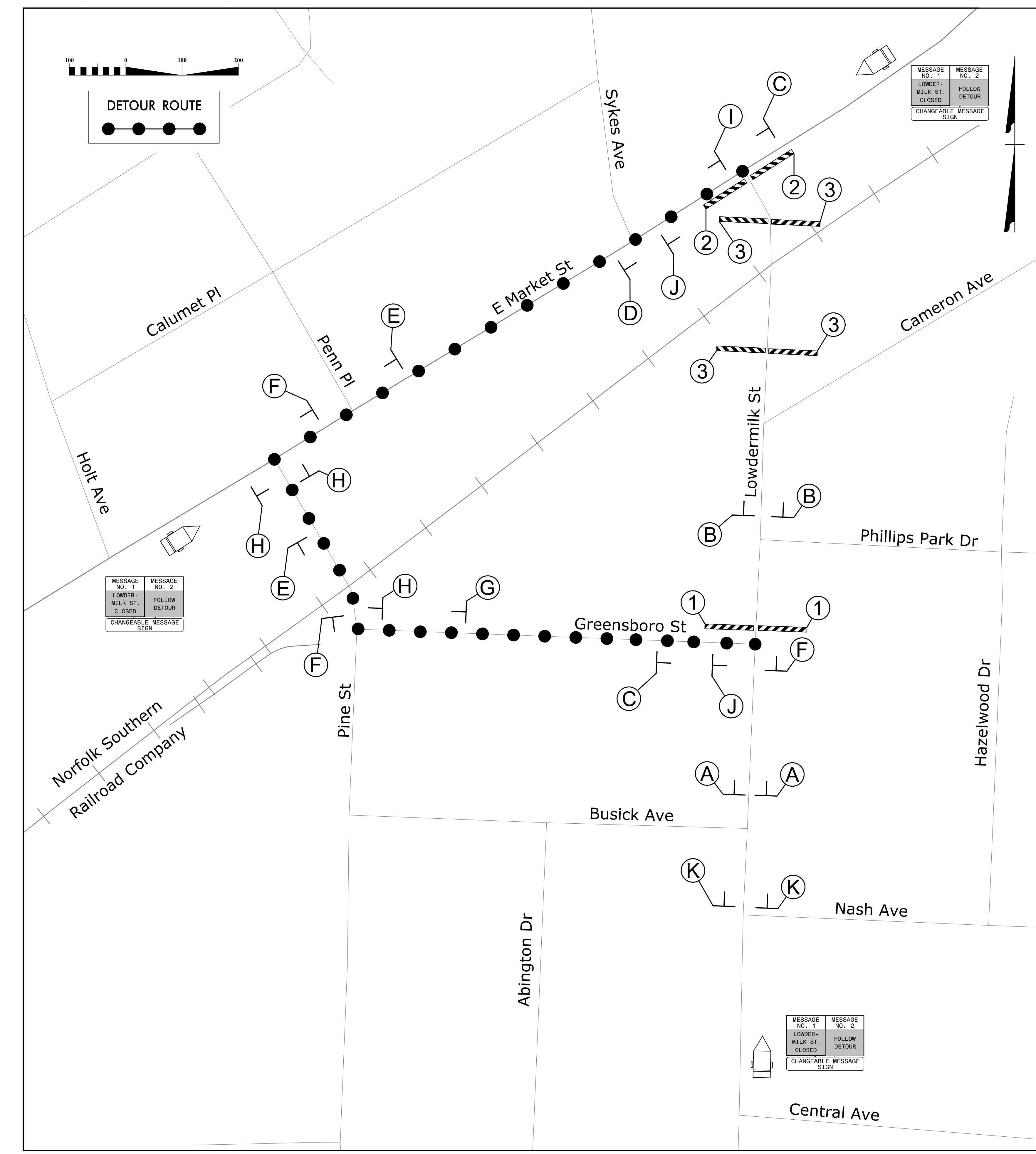

NOTES:
 TRAFFIC CONTROL DEVICES ① THRU ③ AND ① A THRU ① D & ① K SHALL BE INSTALLED PER NCDOT RSD. 1101.03 SHEETS 1 & 2 OF 9.
 TRAFFIC CONTROL DEVICES ① E THRU ① J SHALL BE INSTALLED PER ENGINEER'S INSTRUCTIONS.

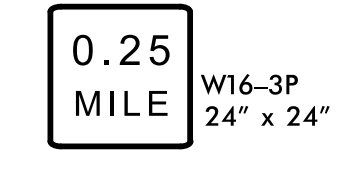
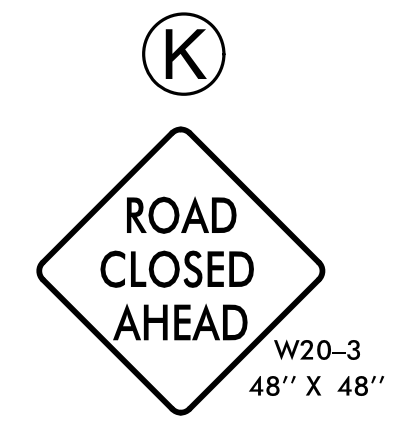
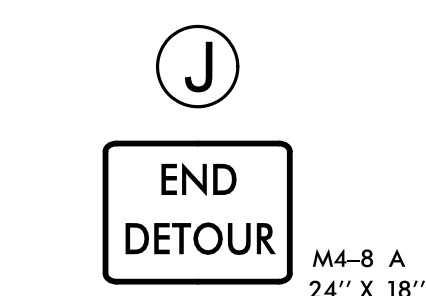

APPROVED: _____
 DATE: 3/6/2024

SEAL

DOCUMENT NOT CONSIDERED FINAL UNLESS ALL SIGNATURES COMPLETED

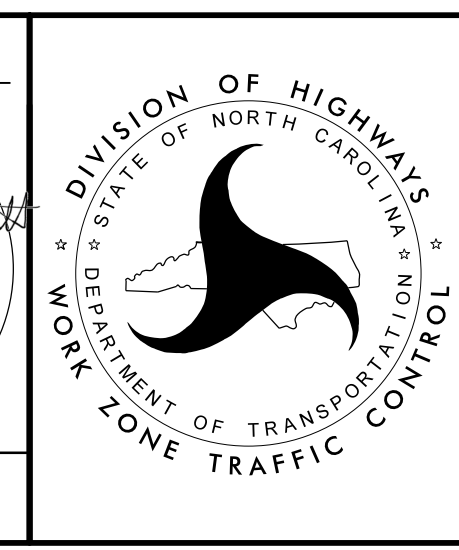

OFF-SITE DETOUR ROUTE
 PHASE IV

3/5/2024 r:\projects\trafficcontrol\tcp_sht\Y4807B_TMP_sht-07.dgn mdd@stv.com

NOTES:
SEE SHEET TMP-7 FOR DETOUR ROUTE AND
SIGNING FOR LOWDERMILK STREET CLOSURE

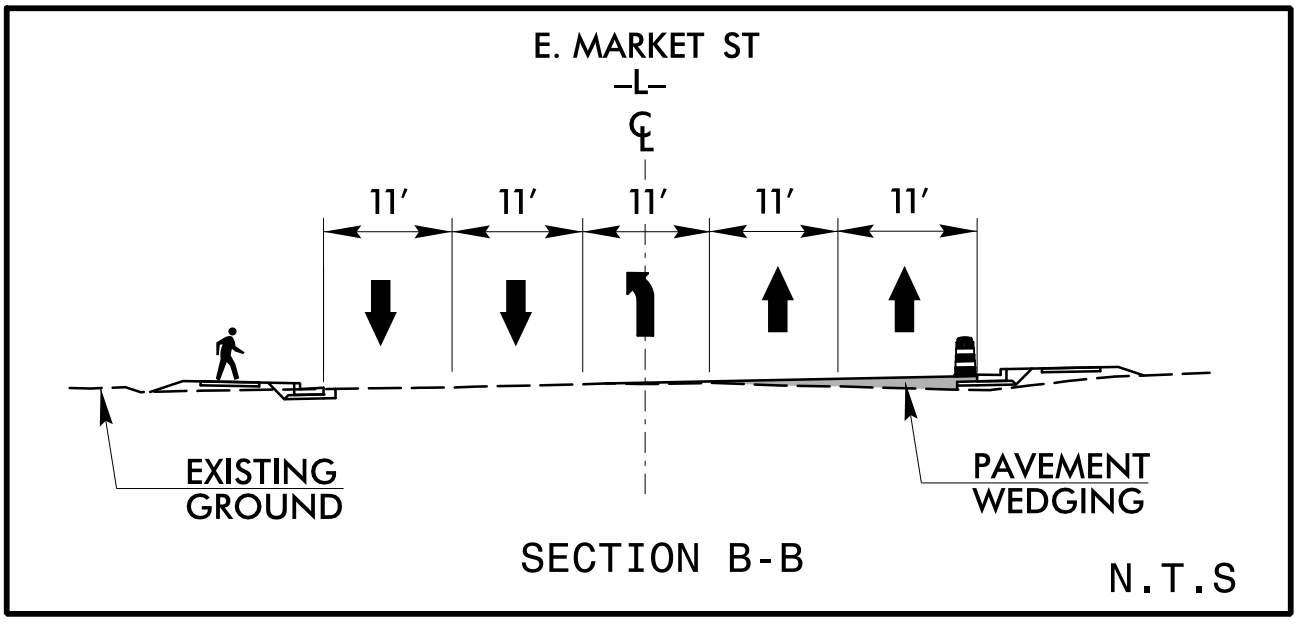

CHANGEABLE MESSAGE SIGN

MESSAGE NO. 1	MESSAGE NO. 2
LOWDER-MILK ST. CLOSED	USE PINE ST. DETOUR

CHANGEABLE MESSAGE SIGN

MESSAGE NO. 1	MESSAGE NO. 2
LOWDER-MILK ST. CLOSED	FOLLOW DETOUR

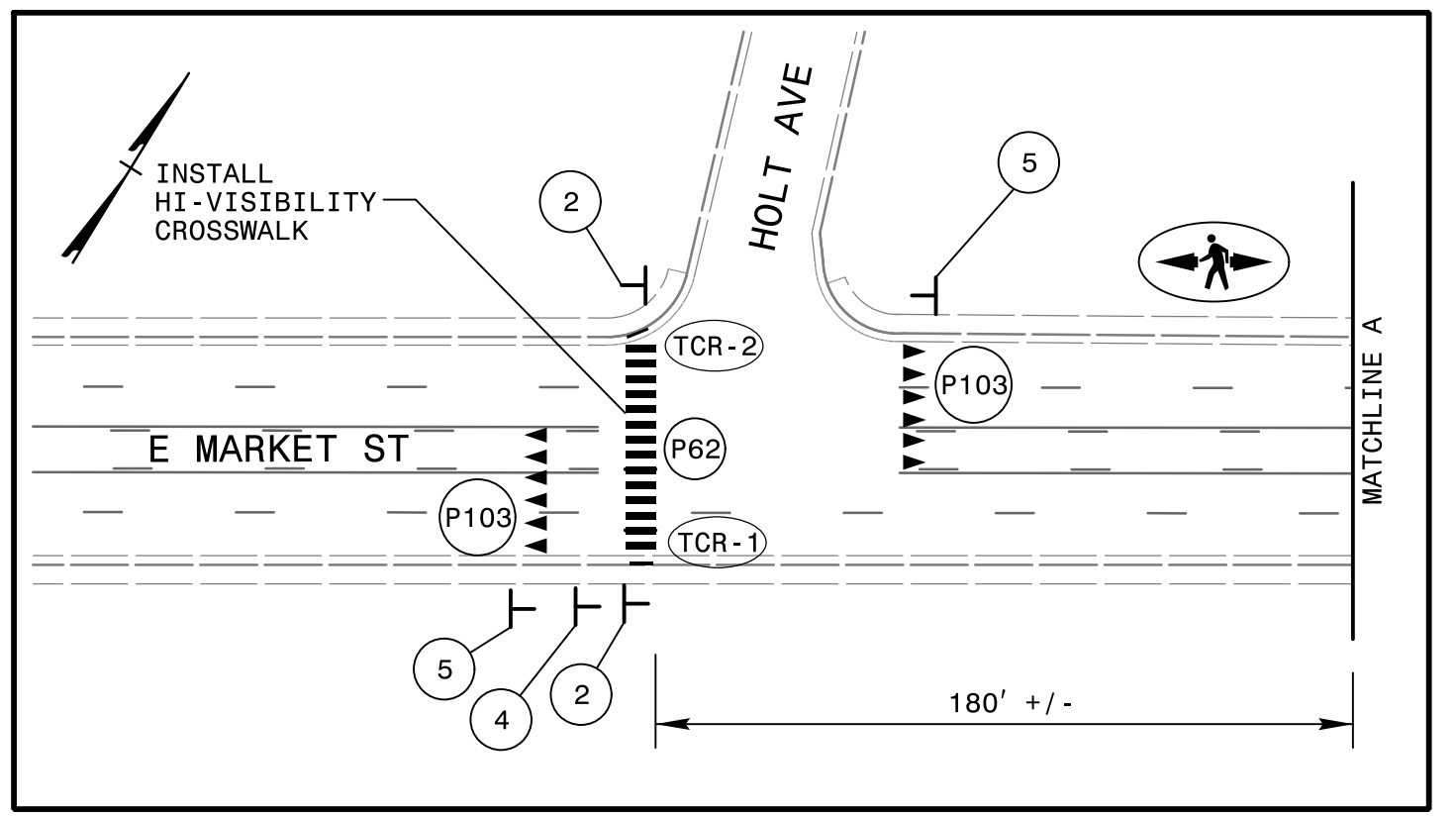
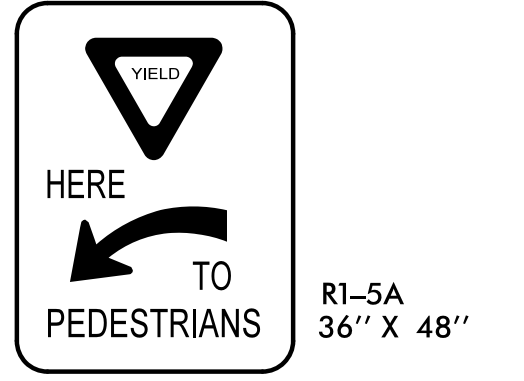
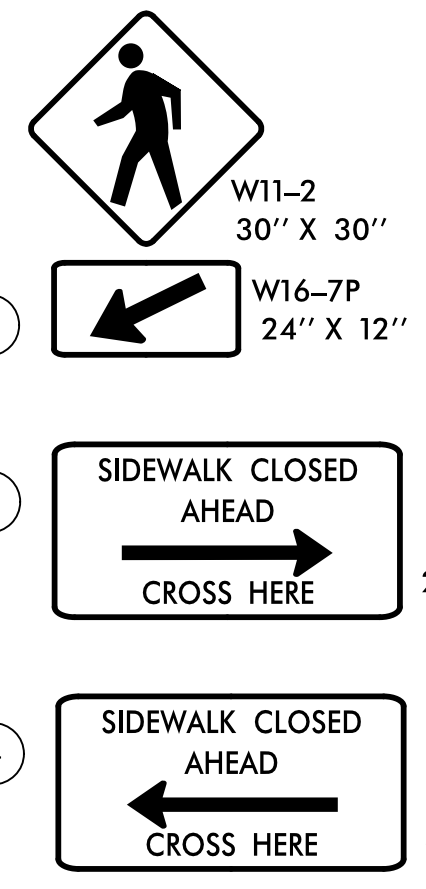
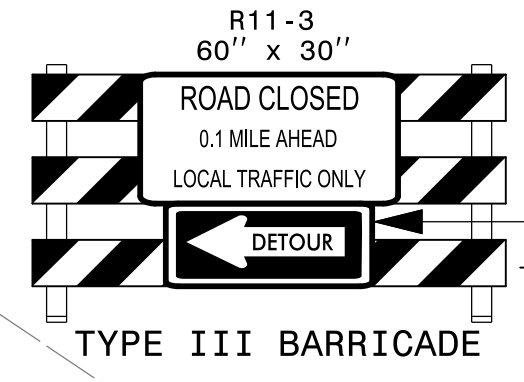
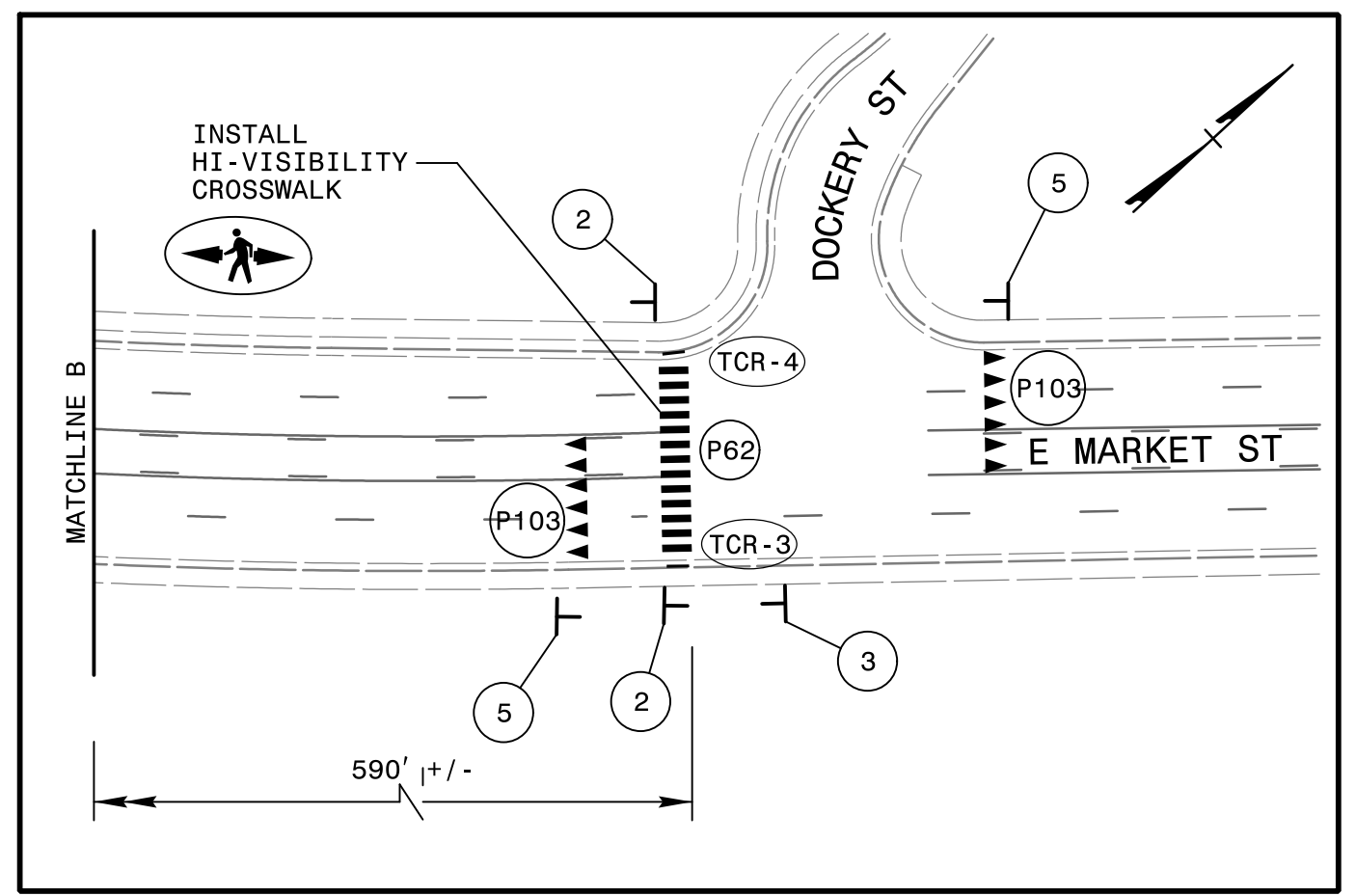
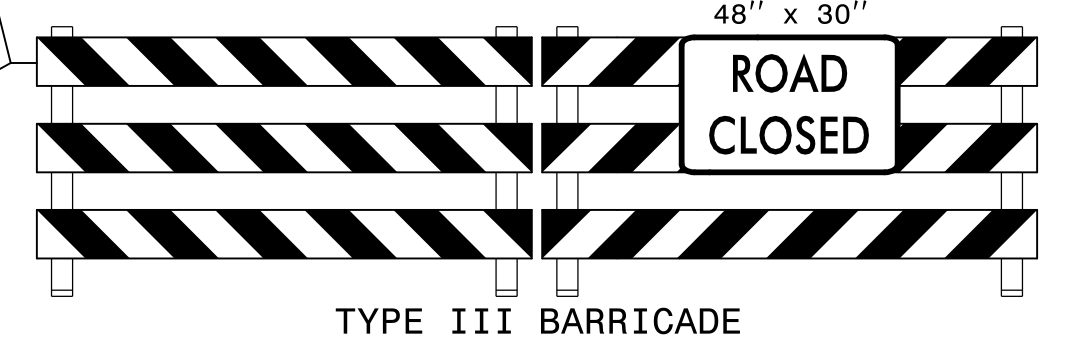
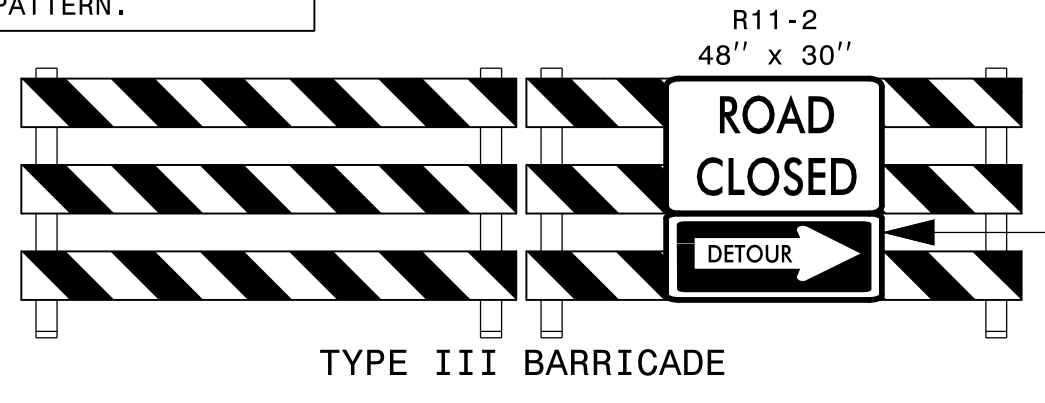

SEE SHEET TMP-1A FOR TEMPORARY PAVEMENT MARKING LEGEND
AUDIBLE WARNING DEVICE TO BE ADDED 100' BEFORE EACH PEDESTRIAN BARRICADE.

APPROVED: _____
DATE: 3/6/2024

SEAL

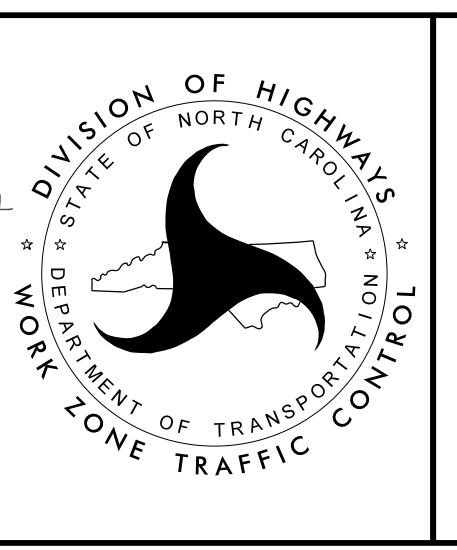

stv STV Engineers, Inc.
900 West Trade St., Suite 715
Charlotte, NC 28202
NC License Number F-0991

PHASE IV DETAIL

3/5/2024
c:\projects\trafficcontrol\tpc_sht\y4807b_tmp_sht-08.dgn
mdd@stviz

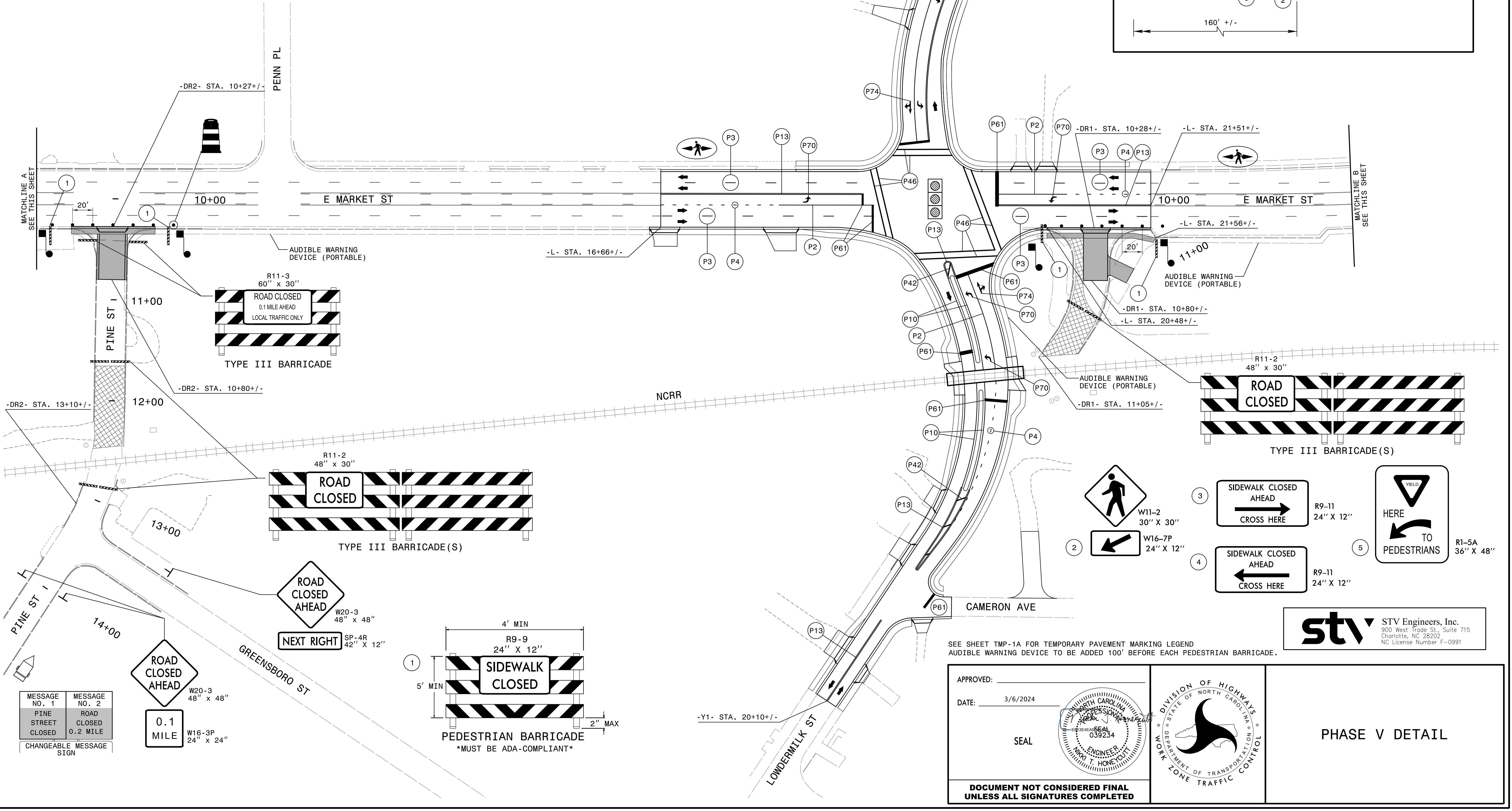
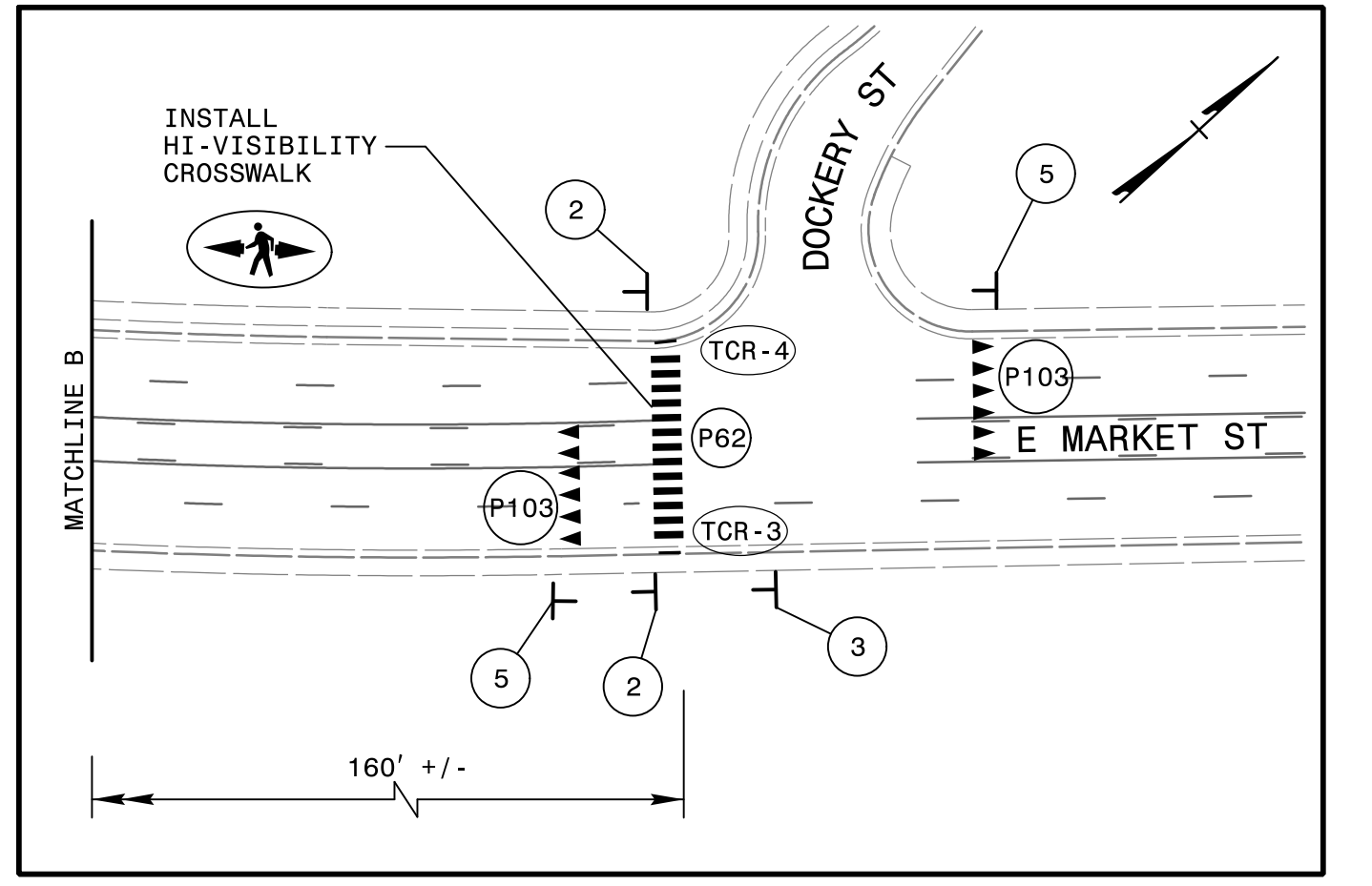
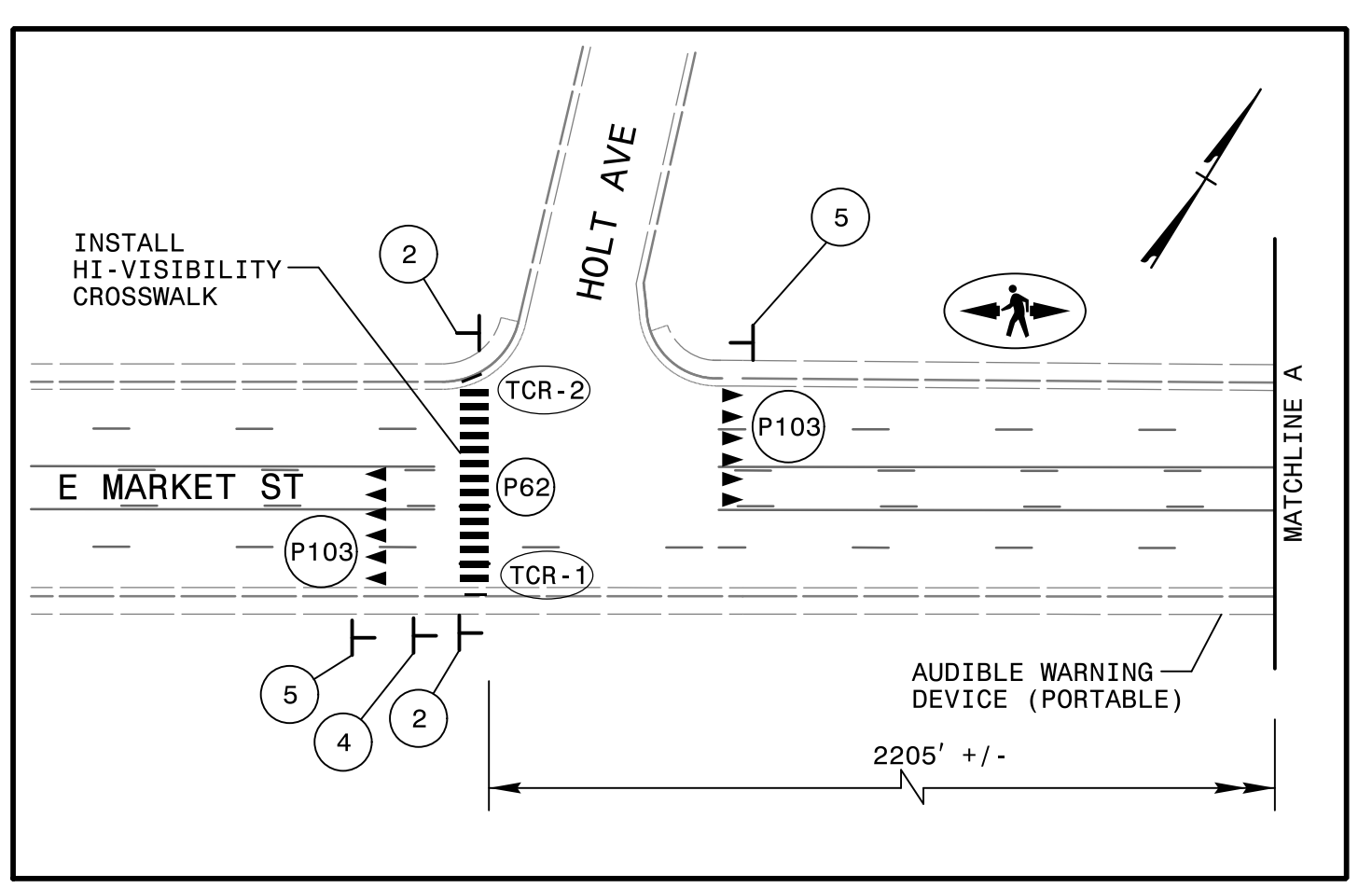

MESSAGE NO. 1	MESSAGE NO. 2
PINE STREET CLOSED	ROAD CLOSED 0.2 MILE
CHANGEABLE MESSAGE SIGN	

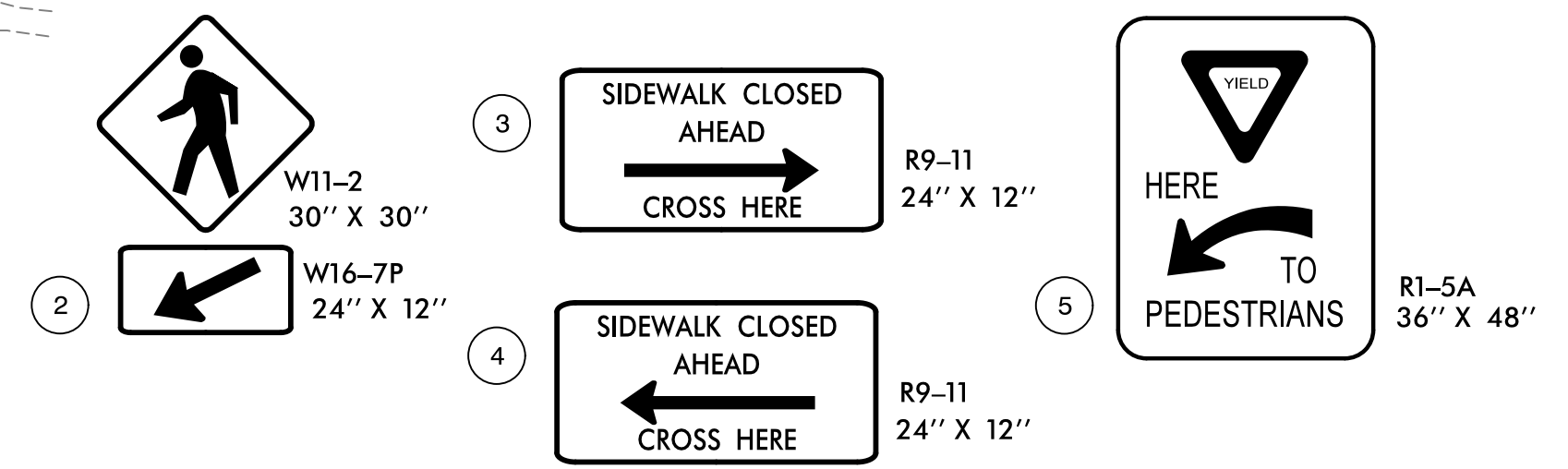
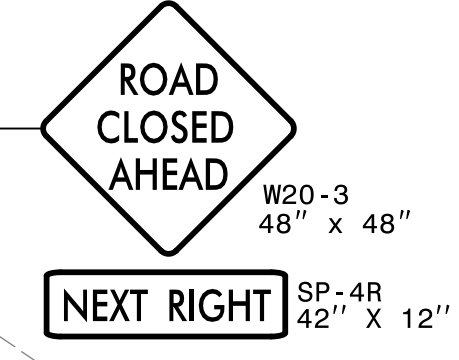
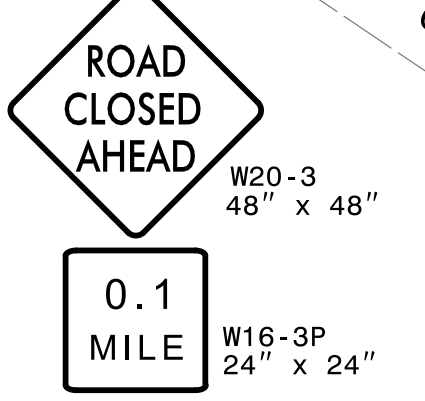

SEE SHEET TMP-1A FOR TEMPORARY PAVEMENT MARKING LEGEND
AUDIBLE WARNING DEVICE TO BE ADDED 100' BEFORE EACH PEDESTRIAN BARRICADE.

APPROVED: _____
DATE: 3/6/2024

SEAL

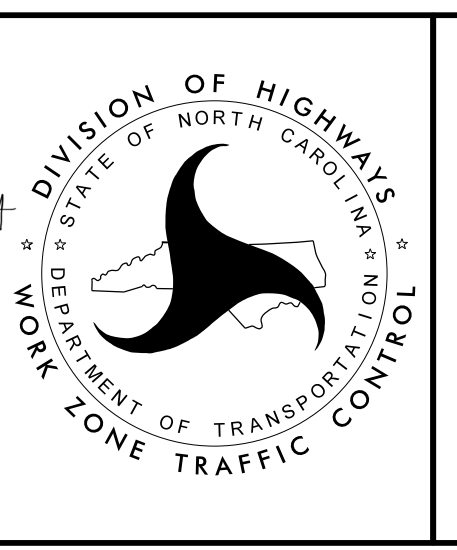

stv STV Engineers, Inc.
900 West Trade St., Suite 715
Charlotte, NC 28202
NC License Number F-0991

PHASE V DETAIL

DOCUMENT NOT CONSIDERED FINAL
UNLESS ALL SIGNATURES COMPLETED

3/5/2024
c:\projects\trafficcontrol\tpc_sht\4807B_TMP_sht-09.dgn
mddg@stviz