

PROJECT REFERENCE NO. Y-4807B		SHEET NO. 2A-2	
RW SHEET NO.			
ROADWAY DESIGN ENGINEER [Stamp]		PAVEMENT DESIGN ENGINEER [Stamp]	
3/22/2024			
DOCUMENT NOT CONSIDERED FINAL UNLESS ALL SIGNATURES COMPLETED			
STV Engineers, Inc. 900 West Trade St., Suite 715 Charlotte, NC 28202 NC License Number F-0991			

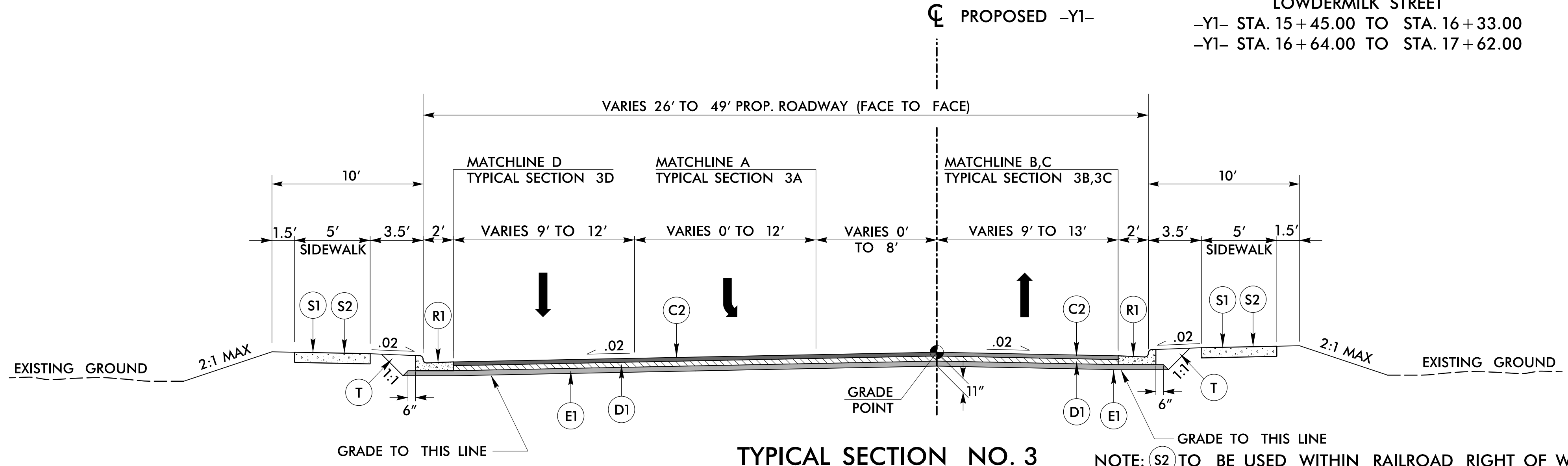

NOTE: (S2) TO BE USED WITHIN RAILROAD RIGHT OF WAY.
 -Y1- STA. 15+40.00 TO 16+43.29
 -Y1- STA. 16+53.29 TO 17+61.00
 * NOTE: (R1) TO END AT THE FOLLOWING STATIONS:
 -Y1- STA. 16+34.10 LT.
 -Y1- STA. 16+30.78 RT.
 ** NOTE: (R1) TO BEGIN AT THE FOLLOWING STATIONS:
 -Y1- STA. 16+62.55 LT.
 -Y1- STA. 16+65.98 RT.

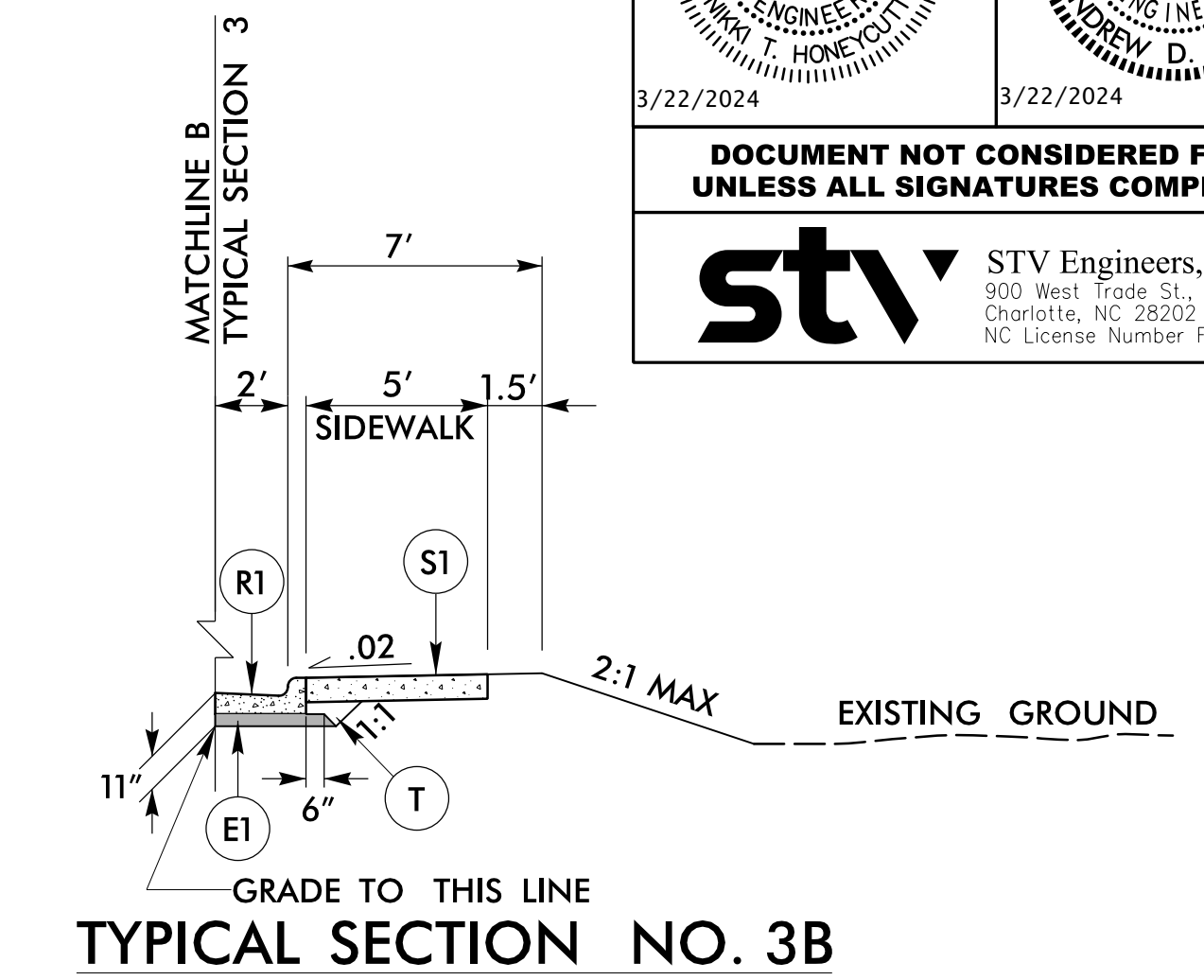
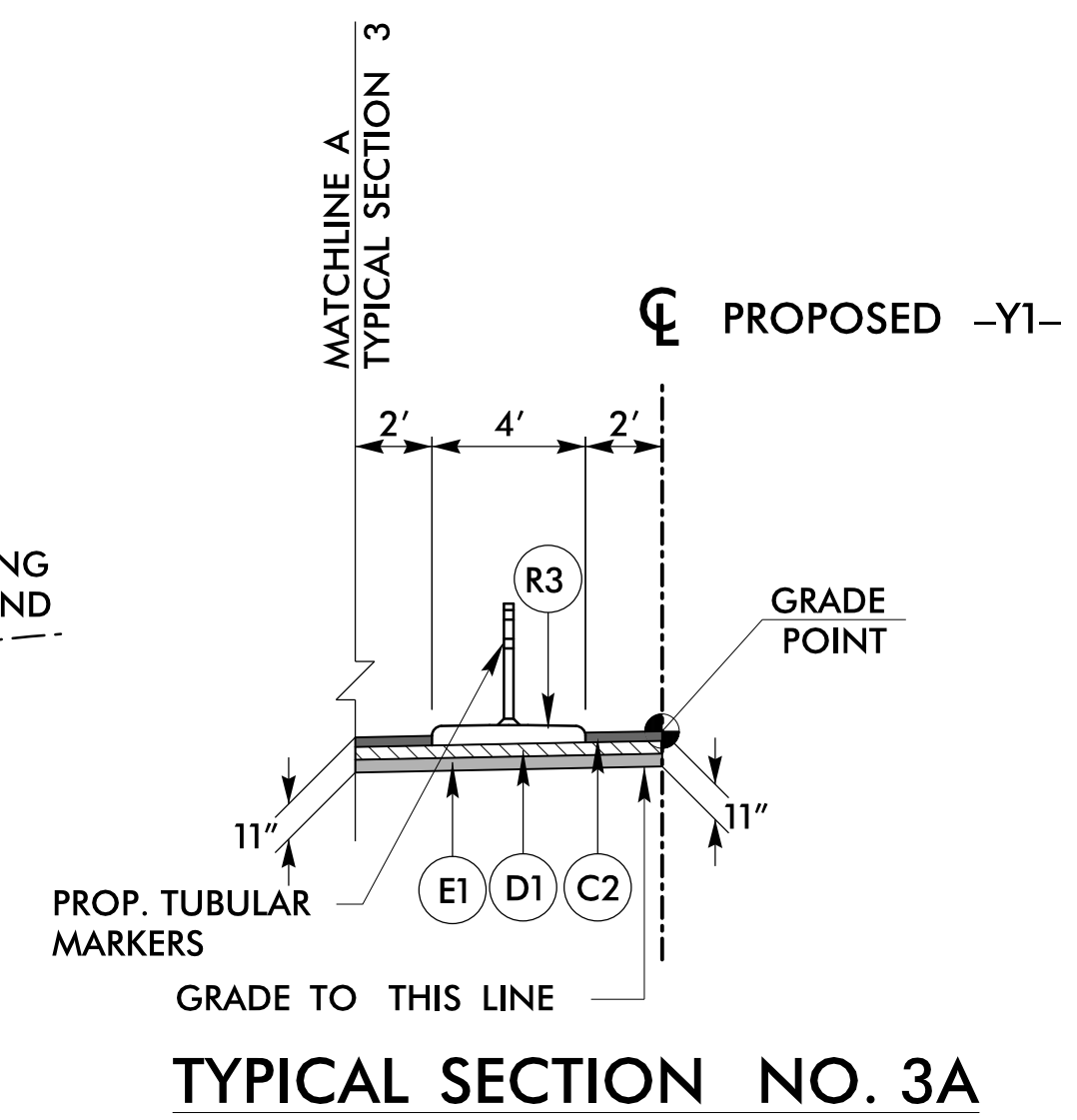
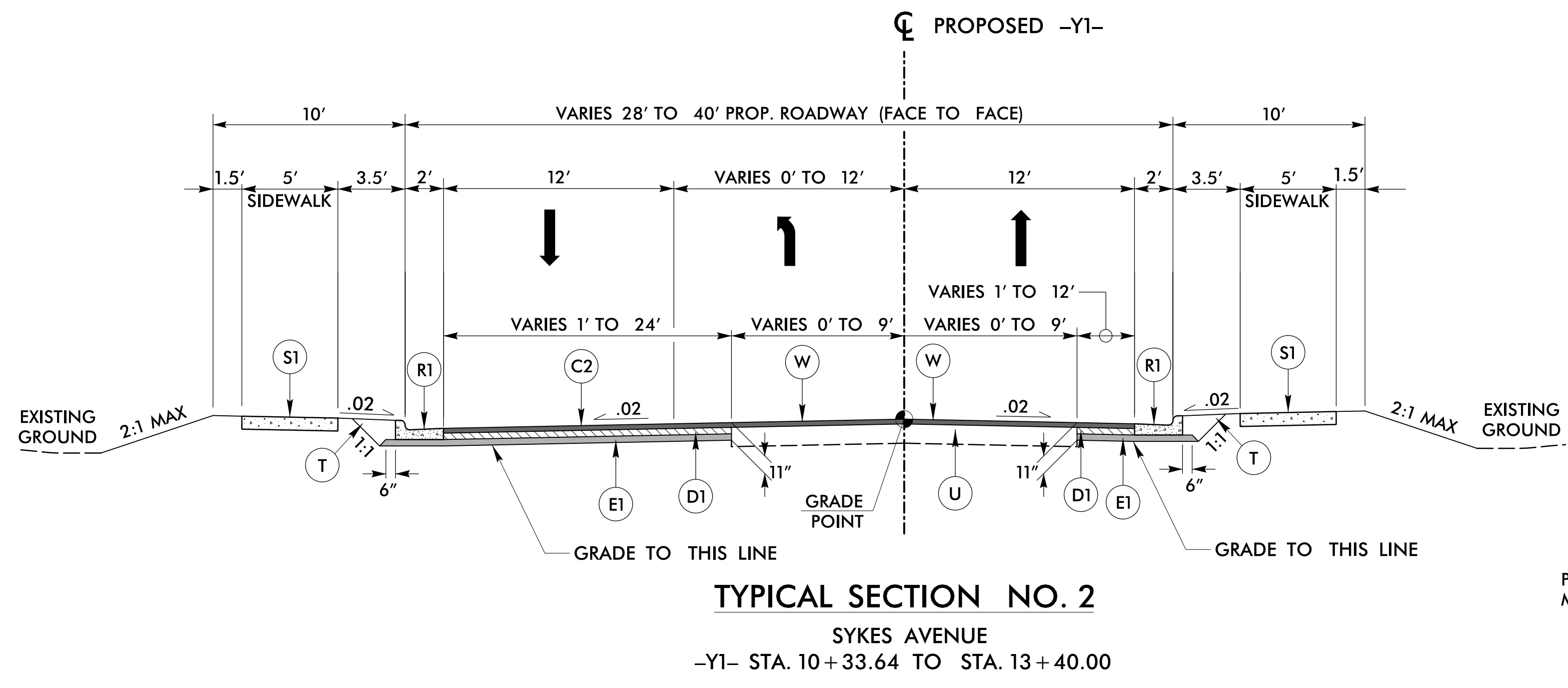
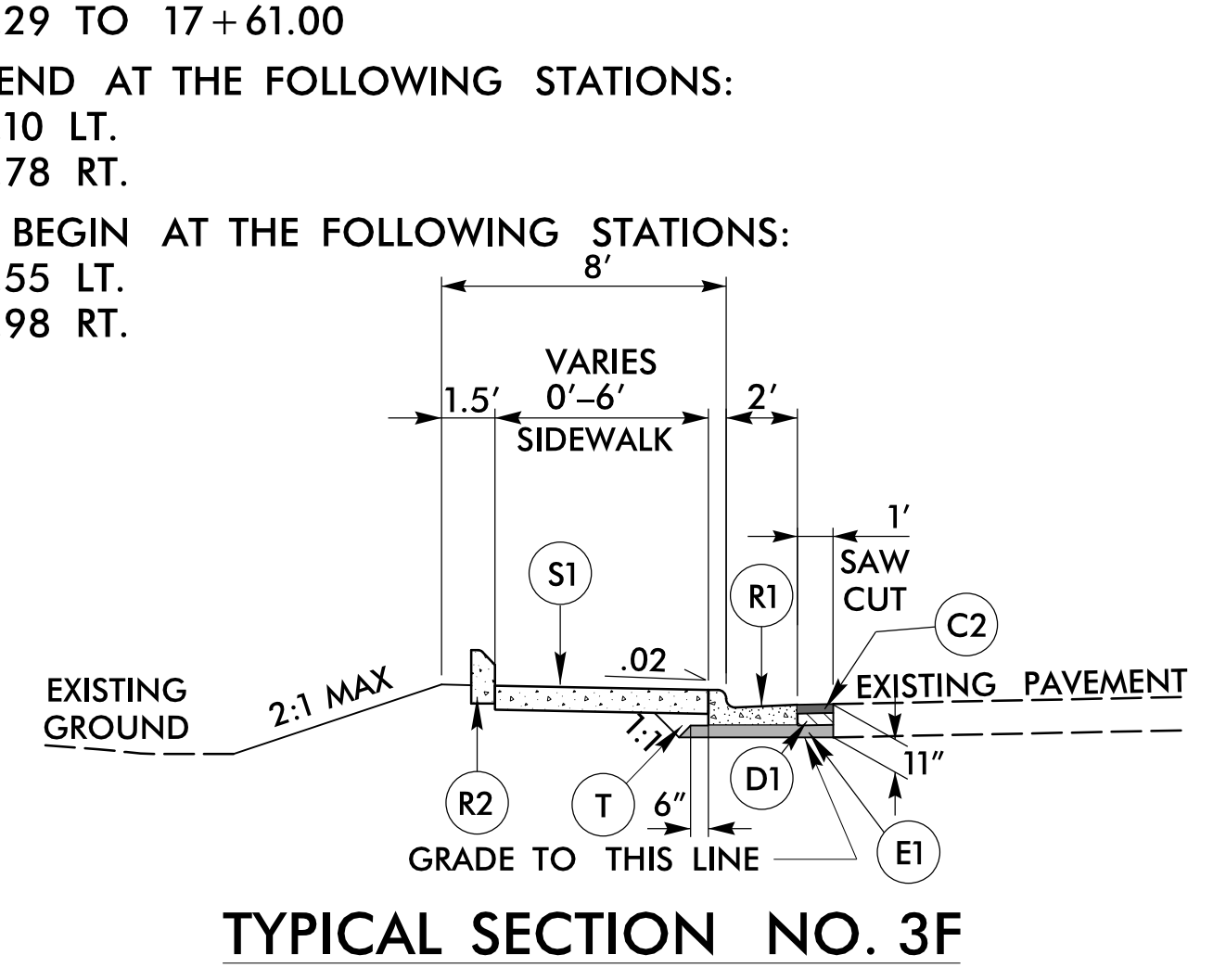
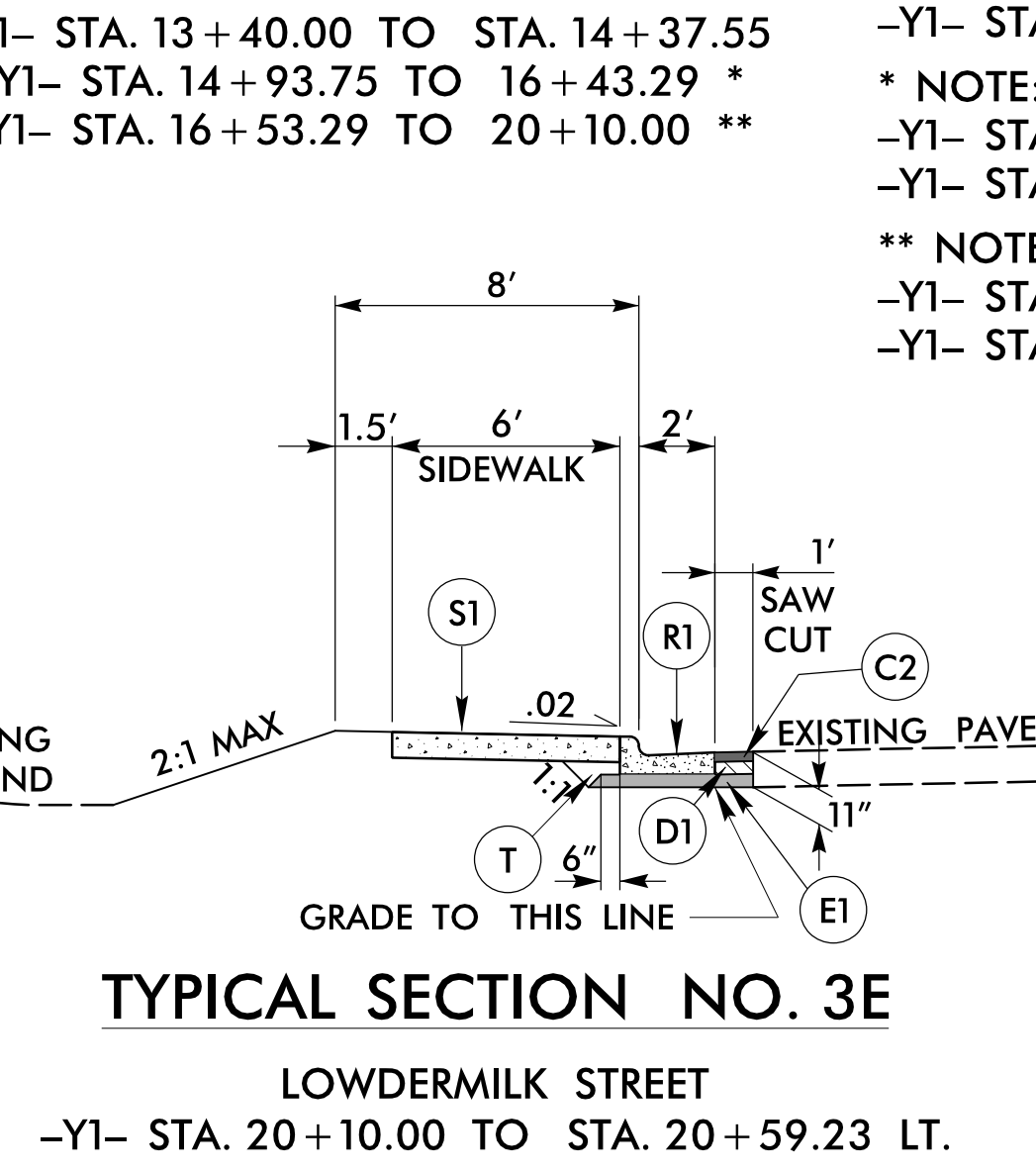
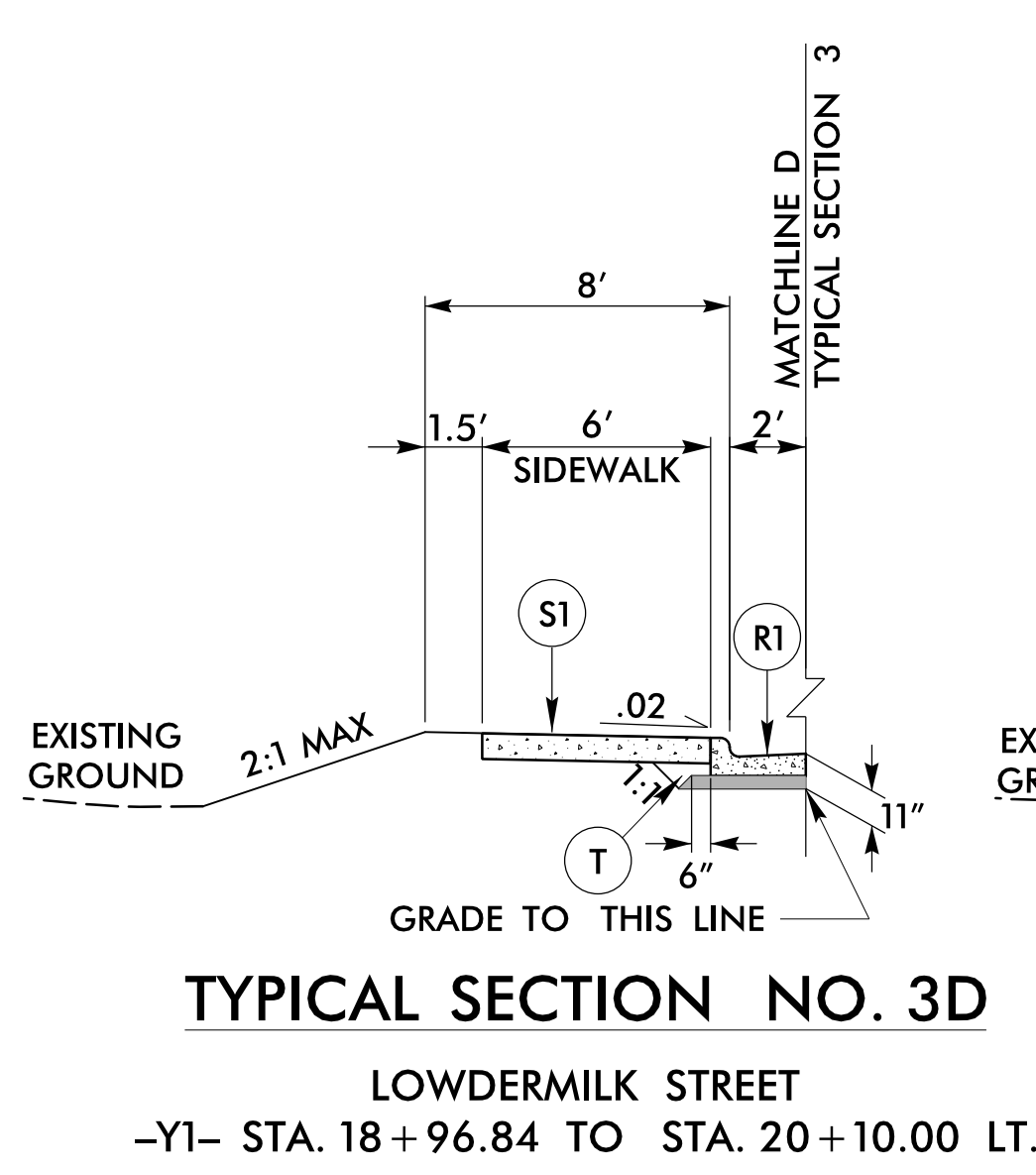
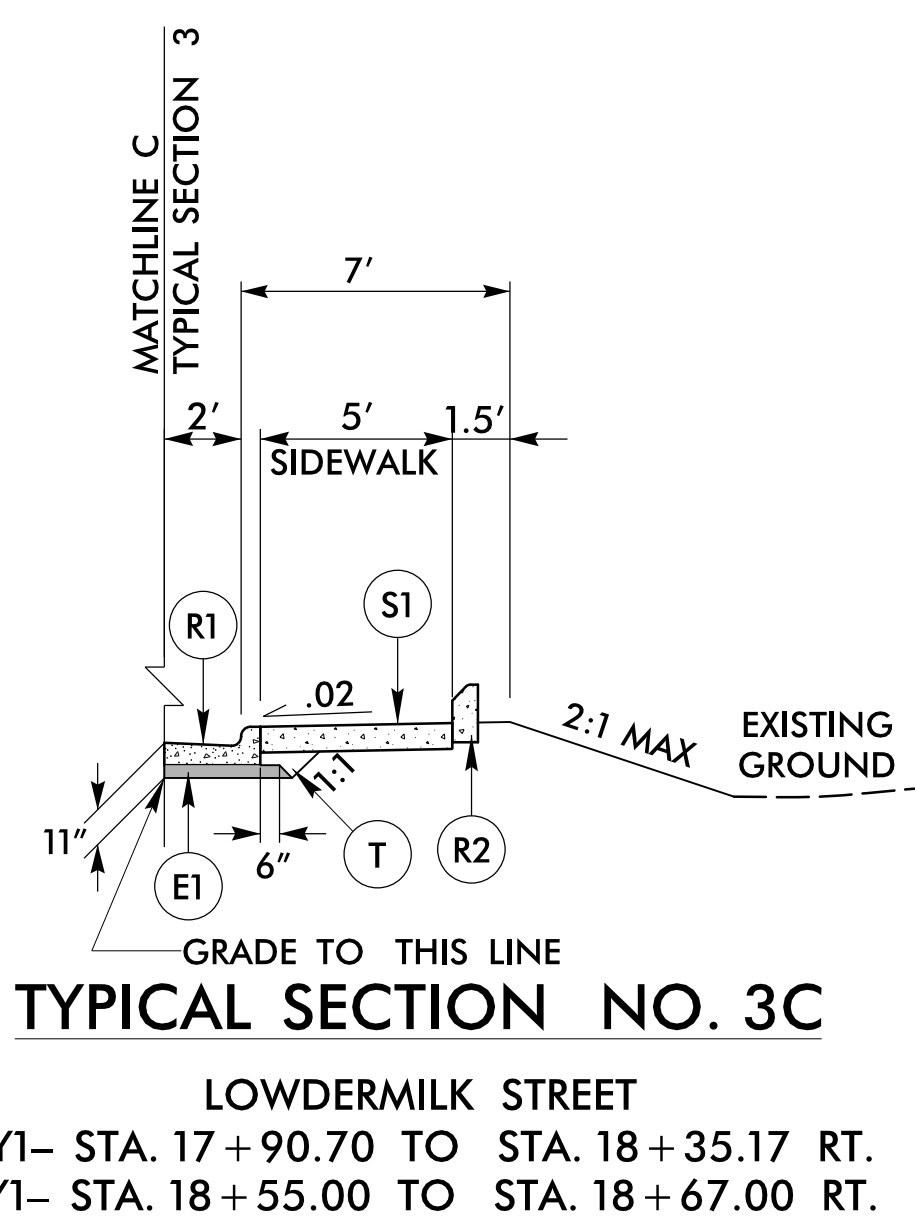

FINAL PAVEMENT SCHEDULE	
C1	1.5" S9.5B
C2	3" S9.5B
C3	VAR. DEPTH S9.5B
D1	4" I19.0C
D2	VAR. DEPTH I19.0C
E1	4" B25.0C
E2	VAR. DEPTH B25.0C
K	12" CLASS IV
N	GEOTEXTILE
R1	2'-6" CONCRETE CURB AND GUTTER
R2	8" X 18" CONCRETE CURB
R3	5" MONO. CONC. ISLAND (KEYED-IN)
S1	4" CONCRETE SIDEWALK
S2	8" REINFORCED CONCRETE SIDEWALK
T	EARTH MATERIAL
U	EXISTING PAVEMENT
W	WEDGING

ALL PAVEMENT SLOPES 1:1 UNLESS NOTED OTHERWISE

3/22/2024 R:\Roadway\Proj\SH\Y4807B_rdy_psh02A-L_Typ.dgn mabdelaziz