

DOCUMENT NOT CONSIDERED FINAL UNLESS ALL SIGNATURES COMPLETED

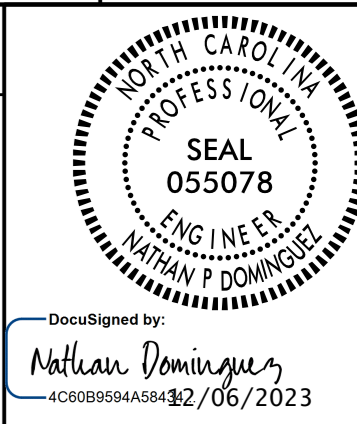

PLANS AND DETAILS FOR PROPOSED LIGHTING /ELECTRICAL CONSTRUCTION

NOTES

- 1 AT THESE LOCATIONS, PROVIDE ELECTRICAL DUCT IN ACCORDANCE WITH NEC REQUIREMENTS FOR AN APPROVED RACEWAY FOR ELECTRICAL CIRCUITS. SEE TABLE "B".
- 2 INSTALL ALL BORE PITS OUTSIDE THE CLEAR ZONE, AS DEFINED BY THE 2011 AASHTO ROADSIDE DESIGN GUIDE OR AS DIRECTED BY THE ENGINEER.
- 3 LOCATE ALL JUNCTION BOXES OUTSIDE CLEAR ZONE AND IN AN AREA UNLIKELY TO BE USED BY TRAFFIC.
- 4 LOCATE PROPOSED CONTROL SYSTEM IN AN AREA ACCESSIBLE FOR MAINTENANCE VEHICLES AND OUTSIDE OF CLEAR ZONE AS DEFINED BY THE 2011 AASHTO ROADSIDE DESIGN GUIDE.
- 5 INSTALL RIGID GALVANIZED CONDUIT (RGC) ABOVE GROUND, AND POLYVINYL CHLORIDE (PVC) SCHEDULE 40 CONDUIT UNDERGROUND, EXCEPT AS MODIFIED ON THESE PLANSHEETS OR IN APPLICABLE SECTIONS OF THE ROADWAY STANDARD DRAWINGS FOR THIS PROJECT.
- 6 ALL IN GROUND JUNCTION BOXES SHALL BE 18" HIGH AND ALL BARRIER RAIL AND SIDEWALK JUNCTION BOXES SHALL BE 6" HIGH, UNLESS OTHERWISE NOTED.
- 7 CONTRACTOR SHALL RECORD THE GPS COORDINATES OF EACH JUNCTION BOX WITHIN 3' ACCURACY, IN THE JUNCTION BOX SUMMARY, TABLE "C". PROVIDE A COPY OF THE JUNCTION BOX SUMMARY WITH THESE COORDINATES TO THE LIGHTING ENGINEER DURING PROJECT INSPECTION.
- 8 POLE NUMBERING CONVENTION: CONTROL SYSTEM-POLE #-CKT # (A-3-2).
- 9 JUNCTION BOXES SHOWN NEAR LIGHT STANDARDS (LSJB & HMJB) ARE SHOWN FOR CLARITY. THESE JUNCTION BOXES ARE TO BE USED AS A TEE POINT FOR CIRCUITRY TO THE STANDARD, AND SHALL BE INSTALLED FOR BEST ALIGNMENT OF CIRCUITRY WHILE MAINTAINING THE OFFSETS SHOWN IN TABLE "C". SEE STANDARD DRAWINGS 1401.01 AND 1406.01 FOR INSTALLATION DETAILS.
- 10 SERVICE POLE SHALL NOT BE INSTALLED PRIOR TO COORDINATION WITH THE LOCAL UTILITY. PROVIDE PROOF OF COORDINATION AND PROOF OF NEED TO THE ENGINEER AFTER CONSULTING WITH THE LOCAL UTILITY. THE SERVICE POLE MAY BE DELETED FROM THE CONTRACT IF NOT REQUIRED. REFER TO ARTICLE 1407-3 OF THE 2024 NCDOT STANDARD SPECIFICATIONS FOR ROADS AND BRIDGES.
- 11 WHERE A CURRENT TRANSFORMER (CT) CABINET IS REQUIRED, THE CT CABINET AND ASSOCIATED HARDWARE ARE INCIDENTAL TO THE PAY ITEM FOR THE LIGHTING CONTROL PANEL.

SCOPE OF WORK

PLACE ROADWAY LIGHTING SYSTEM INTO SERVICE BY PROVIDING AND INSTALLING LIGHT STANDARDS WITH LIGHT EMITTING DIODE LUMINAIRES, UNDERGROUND CIRCUITRY, CONTROL SYSTEM AND JUNCTION BOXES.

DESIGN CRITERIA

- 0.8 AVERAGE FOOTCANDLE ON TRAVEL LANES
- 4:1 AVERAGE TO MINIMUM UNIFORMITY RATIO ON TRAVEL LANES
- 2018 AASHTO ROADWAY LIGHTING DESIGN GUIDE
- 2013 AASHTO STANDARD SPECIFICATIONS FOR STRUCTURAL SUPPORTS FOR HIGHWAY SIGNS, LUMINAIRES, AND TRAFFIC SIGNALS, 6TH EDITION AND LATEST INTERIM SPECIFICATIONS VALID AT THE TIME OF LETTING (HANDHOLE SHAFT DIAMETER REQUIREMENT AND HANDHOLE PLACEMENT REQUIREMENT WAIVED)
- FATIGUE CATEGORY II SHALL BE USED IN DESIGN
- DESIGN HIGH MOUNT SUPPORT FOR BASIC WIND SPEED OF 90 MPH
- DESIGN HIGH MOUNT STANDARD FOUNDATION FOR BASIC WIND SPEED OF 110 MPH. ANY CONTRACTOR-DESIGNED SITE SPECIFIC FOUNDATION DESIGN SHALL BE DESIGNED FOR THE SAME WIND SPEED
- 2020 NATIONAL ELECTRICAL CODE
- 2011 AASHTO ROADSIDE DESIGN GUIDE

ROADWAY STANDARDS

THE FOLLOWING ROADWAY ENGLISH STANDARDS AS APPEAR IN "NCDOT ROADWAY STANDARD DRAWINGS", ROADWAY DESIGN UNIT-N.C. DEPARTMENT OF TRANSPORTATION RALEIGH, N.C., DATED JANUARY 2024 ARE APPLICABLE TO THIS PROJECT AND BY REFERENCE HEREBY ARE CONSIDERED A PART OF THESE PLANS:

STD NO.	TITLE
1401.01	HIGH MOUNT STANDARD
1402.01	HIGH MOUNT FOUNDATION
1403.01	HIGH MOUNT LED LUMINAIRES
1404.01	LIGHT STANDARDS
1405.01	STANDARD FOUNDATION
1406.01	LIGHT STANDARD LUMINAIRES
1407.01	ELECTRIC SERVICE POLE AND LATERAL
1408.01	LIGHT CONTROL SYSTEM
1409.01	ELECTRICAL DUCT
1410.01	FEEDER CIRCUITS
1411.01	ELECTRICAL JUNCTION BOXES

ALL WORK SHALL BE IN CONFORMANCE WITH DIVISION 14 OF THE STANDARD SPECIFICATIONS FOR ROADS AND STRUCTURES, DATED JANUARY 2024.

LEGEND

- PROPOSED 120' HIGH MAST STANDARD W/ HM FOUNDATION, JUNCTION BOX & 8 HM LED LUMINAIRES. 560W MAX, 54,000 MIN. MAINTAINED DELIVERED LUMENS, TYPE V. MAXIMUM BUG RATING 5-0-5.
- PROPOSED LIGHT STANDARD TYPE MTLT 45' WITH 15' SINGLE ARM. INCLUDES STANDARD FOUNDATION TYPE R1 OR R2, JUNCTION BOX & 285W MAX LED ROADWAY LUMINAIRE. IES DISTRIBUTION: TYPE II OR III AS REQUIRED. MAXIMUM BUG RATING 3-0-3.
- PROPOSED CONTROL SYSTEM WITH JUNCTION BOX. SEE PLANS FOR BREAKER SIZES.
- PROPOSED ELECTRICAL JUNCTION BOX. SEE TABLE C, SHEET E-1A, FOR DETAILS AND TYPE.
- REFERENCE TO CORRESPONDING NOTE AS NUMBERED.
- PROPOSED FEEDER CIRCUIT. CONTROL SYSTEM (A), CIRCUIT NUMBER (1) PLAN SYMBOL (8). SEE TABLE A, THIS SHEET.
- PROPOSED 30' CLASS 4 SERVICE POLE AND LATERAL 3 #1/0 USE CONDUCTORS 2" CONDUIT
- PROPOSED ELECTRICAL DUCT SIZE 2", 3" OR 4" TYPE (TL) OR (BD) LOCATION: SEE TABLE B, SHEET E1-A.

PLAN SYMBOL	DESCRIPTION	CONTRACT ITEM
8	2 #8 Ø 1 #10G 1.5" P	2 AWG SIZE 8 CONDUCTOR (BK & RD) 1 AWG SIZE 10 GROUNDING CONDUCTOR 1.5" PVC CONDUIT
*8	2 #8 Ø 1 #10G	2 AWG SIZE 8 CONDUCTOR (BK & RD) 1 AWG SIZE 10 GROUNDING CONDUCTOR
6	2 #6 Ø 1 #8G 1.5" P	2 AWG SIZE 6 CONDUCTOR (BK & RD) 1 AWG SIZE 8 GROUNDING CONDUCTOR 1.5" PVC CONDUIT
*6	2 #6 Ø 1 #10G	2 AWG SIZE 6 CONDUCTOR (BK & RD) 1 AWG SIZE 8 GROUNDING CONDUCTOR
4	2 #4 Ø 1 #6G 1.5" P	2 AWG SIZE 4 CONDUCTOR (BK & RD) 1 AWG SIZE 6 GROUNDING CONDUCTOR 1.5" PVC CONDUIT
*4	2 #4 Ø 1 #6G	2 AWG SIZE 4 CONDUCTOR (BK & RD) 1 AWG SIZE 6 GROUNDING CONDUCTOR
2	2 #2 Ø 1 #4G 1.5" P	2 AWG SIZE 2 CONDUCTOR (BK & RD) 1 AWG SIZE 4 GROUNDING CONDUCTOR 1.5" PVC CONDUIT
*2	2 #2 Ø 1 #4G	2 AWG SIZE 2 CONDUCTOR (BK & RD) 1 AWG SIZE 4 GROUNDING CONDUCTOR

BD	BURIED	PVC	PVC SCHEDULE 40 CONDUIT
LT	LIGHT	RGC	RIGID GALVANIZED STEEL CONDUIT
TL	TRENCHLESS	C	CONDUIT
MH	MOUNTING HEIGHT	CKT	CIRCUIT
Ø	PHASE	N	NEUTRAL
SER LAT	SERVICE LATERAL	G	GROUND
IGJB	IN GROUND JUNCTION BOX	HM	HIGH MAST
LED	LIGHT EMITTING DIODE	LSJB	LIGHT STANDARD JUNCTION BOX
HMJB	HIGH MAST JUNCTION BOX	CSJB	CONTROL SYSTEM JUNCTION BOX

COMPUTED BY: SAM DATE: 10/1/23
CHECKED BY: RGH DATE: 10/1/23

06-NOV-2023 08:27 R:\Lighting\Electrical\Lighting Design\Fresh Start 103123\R-2577A-LE_PSH-E1.dgn

02/03/98

06-NOV-2023 08:30
 R:\Lighting\Electrical\Lighting Design\Fresh Start 103123\AR-2577A\LE_PSH_EI.dgn
 some1.k1 AT RD-328813L

TABLE "C"
 JUNCTION BOX SUMMARY

SHEET	LABEL	LOCATION AND OFFSET	CONTROL SYSTEM "A"													GPS LOCATION 
			TYPE, PAY ITEM & SIZE													
			IN GROUND			LIGHT STANDARD			HIGH MAST			CONTROL SYSTEM	BARRIER RAIL	SIDE WALK		
IG18 18"X12"	IG30 30"X17"	IG36 36"X24"	LS18 18"X12"	LS30 30"X17"	LS36 36"X24"	HM18 18"X12"	HM30 30"X17"	HM36 36"X24"	CS36 36"X24"	BR18 18"X12"	SW18 18"X12"	LAT/LONG				
E-2	JBA1	-Y1LPA- STA 19+84, 25' LT	X													
E-2	JBA2	-L- STA 484+31, 109' LT	X													
E-2	JBA3	-L- STA 484+31, 112' RT	X													
E-2	SA A-1JB	5' FROM SA LIGHT STANDARD A-1				X										
E-2	SA A-2JB	5' FROM SA LIGHT STANDARD A-2						X								
E-2	SA A-3JB	5' FROM SA LIGHT STANDARD A-3				X										
E-2	SA A-4JB	5' FROM SA LIGHT STANDARD A-4				X										
E-2	SA A-5JB	5' FROM SA LIGHT STANDARD A-5				X										
E-2	SA A-6JB	5' FROM SA LIGHT STANDARD A-6				X										
E-3	SA A-7JB	5' FROM SA LIGHT STANDARD A-7				X										
E-3	SA A-8JB	5' FROM SA LIGHT STANDARD A-8				X										
E-3	SA A-9JB	5' FROM SA LIGHT STANDARD A-9				X										
E-3	SA A-10JB	5' FROM SA LIGHT STANDARD A-10				X										
E-3	SA A-11JB	5' FROM SA LIGHT STANDARD A-11				X										
E-3	SA A-12JB	5' FROM SA LIGHT STANDARD A-12				X										
E-3	SA A-13JB	5' FROM SA LIGHT STANDARD A-13				X										
E-3	SA A-14JB	5' FROM SA LIGHT STANDARD A-14				X										
E-2	SA A-15JB	5' FROM SA LIGHT STANDARD A-15				X										
E-2	SA A-16JB	5' FROM SA LIGHT STANDARD A-16				X										
E-2	SA A-17JB	5' FROM SA LIGHT STANDARD A-17				X										
E-2	SA A-18JB	5' FROM SA LIGHT STANDARD A-18				X										
E-2	SA A-19JB	5' FROM SA LIGHT STANDARD A-19				X										
E-2	SA A-20JB	5' FROM SA LIGHT STANDARD A-20				X										
E-2	SA A-21JB	5' FROM SA LIGHT STANDARD A-21				X										
E-2	HM A-22JB	10' FROM HIGH MAST HMA-22							X							
E-2	HM A-23JB	10' FROM HIGH MAST HMA-23							X							
E-2	CSAJB	2' FROM CONTROL SYSTEM "A"									X					
CSA TOTALS			3			20			1	2			1			

DOCUMENT NOT CONSIDERED FINAL
 UNLESS ALL SIGNATURES COMPLETED

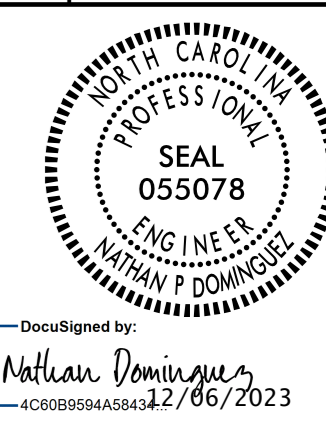
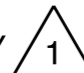
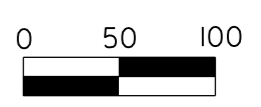

TABLE "B"
 ELECTRICAL DUCT SUMMARY
 (ESTIMATED LENGTH IN FEET)

LOCATION	RACEWAY 	SHEET	TYPE									
			TRENCHLESS (TL) FEET				BURIED (BD) FEET					
			SIZE 2"	SIZE 3"	SIZE 4"	SIZE 6"	SIZE 2"	SIZE 3"	SIZE 4"	SIZE 6"		
-Y1RPA- STA 29+08	SA A-2JB - JBA1				120			150				
-L- STA 484+31	--			220								
-Y1RPD- STA 14+76				270								
--												
--												
--	--											
--	--											
--	--											
--	--											
--	--											
--	--											
--	--											
CSA TOTALS				490	120		150					

SEE SHEET "E-1" FOR
 LEGEND & △ NOTES

USE FOR LIGHTING CONSTRUCTION ONLY



DOCUMENT NOT CONSIDERED FINAL UNLESS ALL SIGNATURES COMPLETED

LOAD SCHEDULE					
CS LOCATION: NE CORNER OF 74W EXIT RAMP					
1Ø, 3W, 240/480 VAC					
			CONTROL SYSTEM "A"		
CIRCUIT ID	SINGLE ARM 1 @ 285W MAX LED LUMINAIRE	120' HIGH MAST W/ 8 560W MAX. LED LUMINAIRES	AMPS @ 480V	KW LOAD	BREAKER SIZE (AMPS)
A1	A-11 TO A-21	--	6.6	3.2	50
A2	--	HM-A-22	9.3	4.5	50
A3	--	HM-A-23	9.3	4.5	50
A4	A-1 TO A-10	--	6.0	2.9	50
SPARE	--	--	--	--	50
TOTAL	21 ON 21 SA POLES	16 ON 2 HM POLES	31.2	15.1	

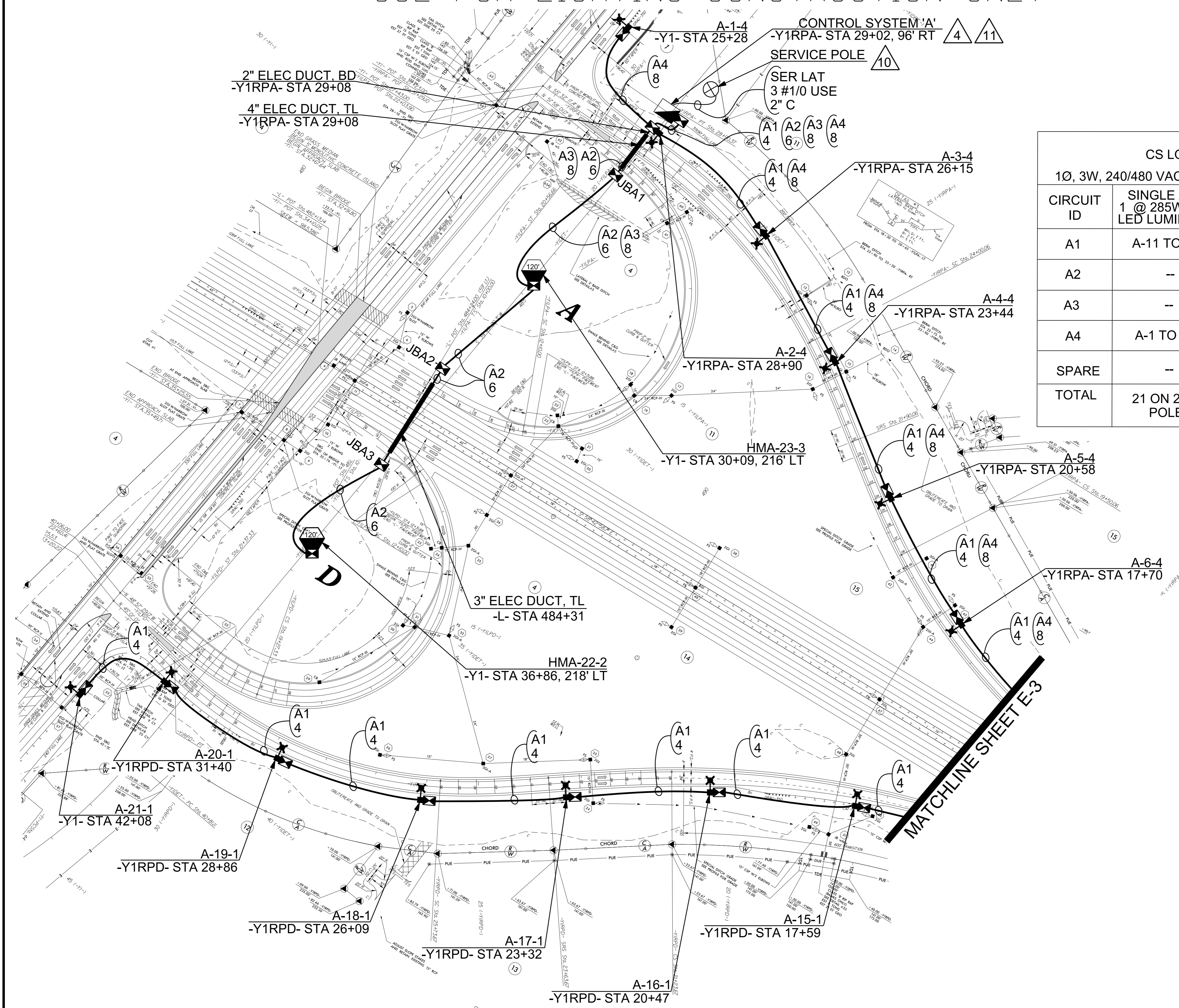

06-NOV-2023 08:43
 R:\Lighting Design\Fresh Start 103123\R-2577A\LE_PSH.E2.dgn
 somehtk AT RD-328813L

SEE SHEET "E-1" FOR LEGEND & △ NOTES

2			
1			
Rev.	Date	Description	Approved
NORTH CAROLINA DEPARTMENT OF TRANSPORTATION ROADWAY DESIGN LIGHTING/ELECTRICAL SECTION			
LIGHTING LAYOUT US 158/I-74 INTERCHANGE			
FORSYTH COUNTY			
Drawn By:	SAM	Approved By:	RGH
Dwg No.:			

USE FOR LIGHTING CONSTRUCTION ONLY

PROJECT REFERENCE NO. R-2577A SHEET NO. E-3

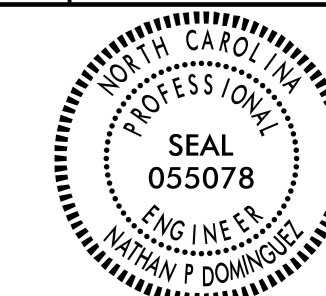

DocuSigned by:
Nathan Dominguez
12/06/2023

**DOCUMENT NOT CONSIDERED FINAL
UNLESS ALL SIGNATURES COMPLETED**

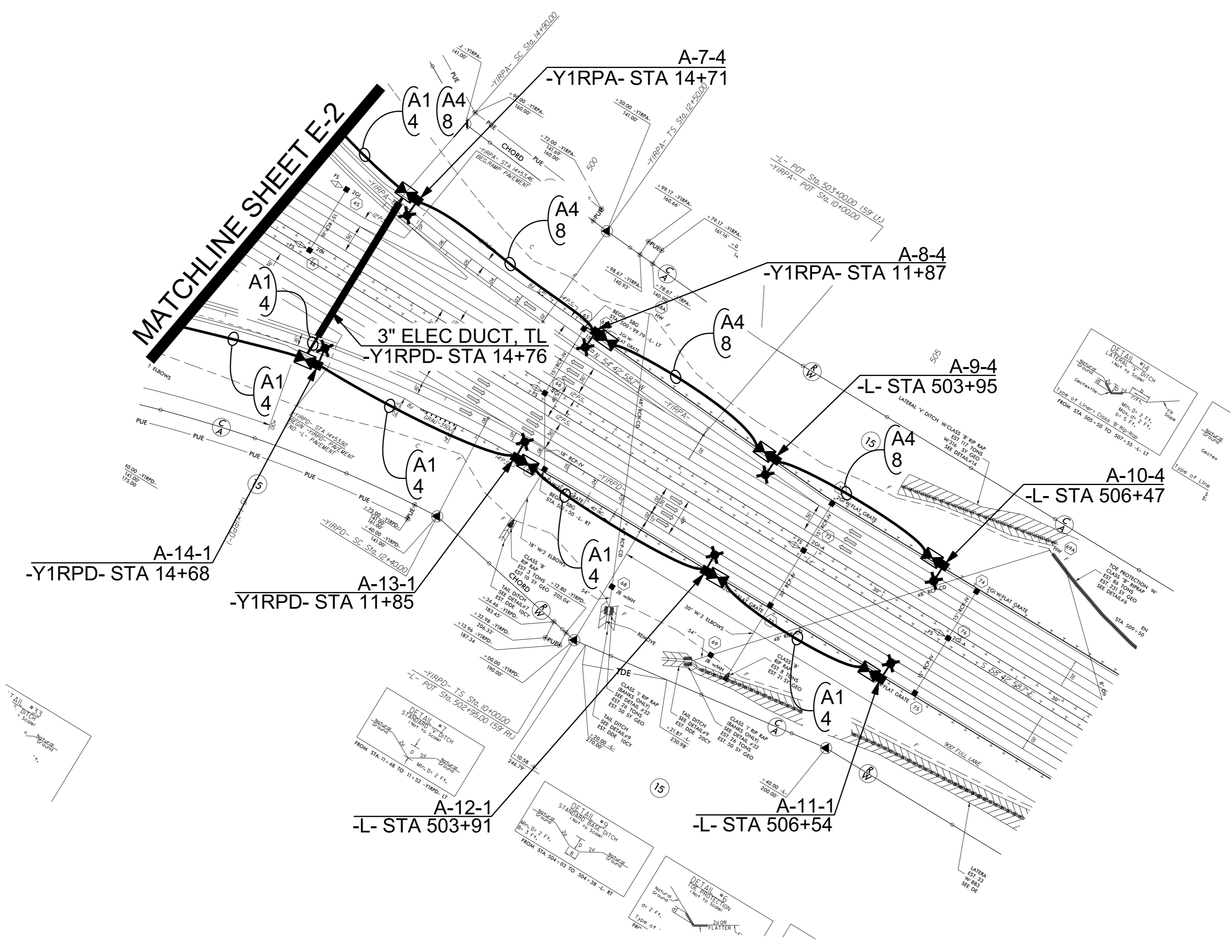
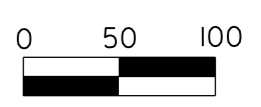

SEE SHEET "E-1" FOR
LEGEND & △ NOTES

2			
1			
Rev.	Date	Description	Approved

**NORTH CAROLINA
DEPARTMENT OF TRANSPORTATION**
ROADWAY DESIGN LIGHTING/ELECTRICAL SECTION

**LIGHTING LAYOUT
US 158/I-74 INTERCHANGE**

FORSYTH COUNTY

Drawn By: SAM Approved By: RGH Dwg No.:

06-NOV-2023 08:57
 R:\Lighting\Lighting Design\Fresh Start 103123\R-2577A\LE_PSH.E3.dgn
 somehtk AT RD-328813L