

DATE: 1/19/2023
TIME: 10:23:59 AM

USER: rmeach
DIR: \\vnc\comnet\comnet\sa\AMEFA\raleigh\USRAL3\Legacy\Projects\60436195-B-465A\00_L\Ker\K910\CAD\YO_MCDOT_TIP\Structures\04 Drawings\2022 Updates\400_71_S36_B4654_S1U_EBI_4.dgn

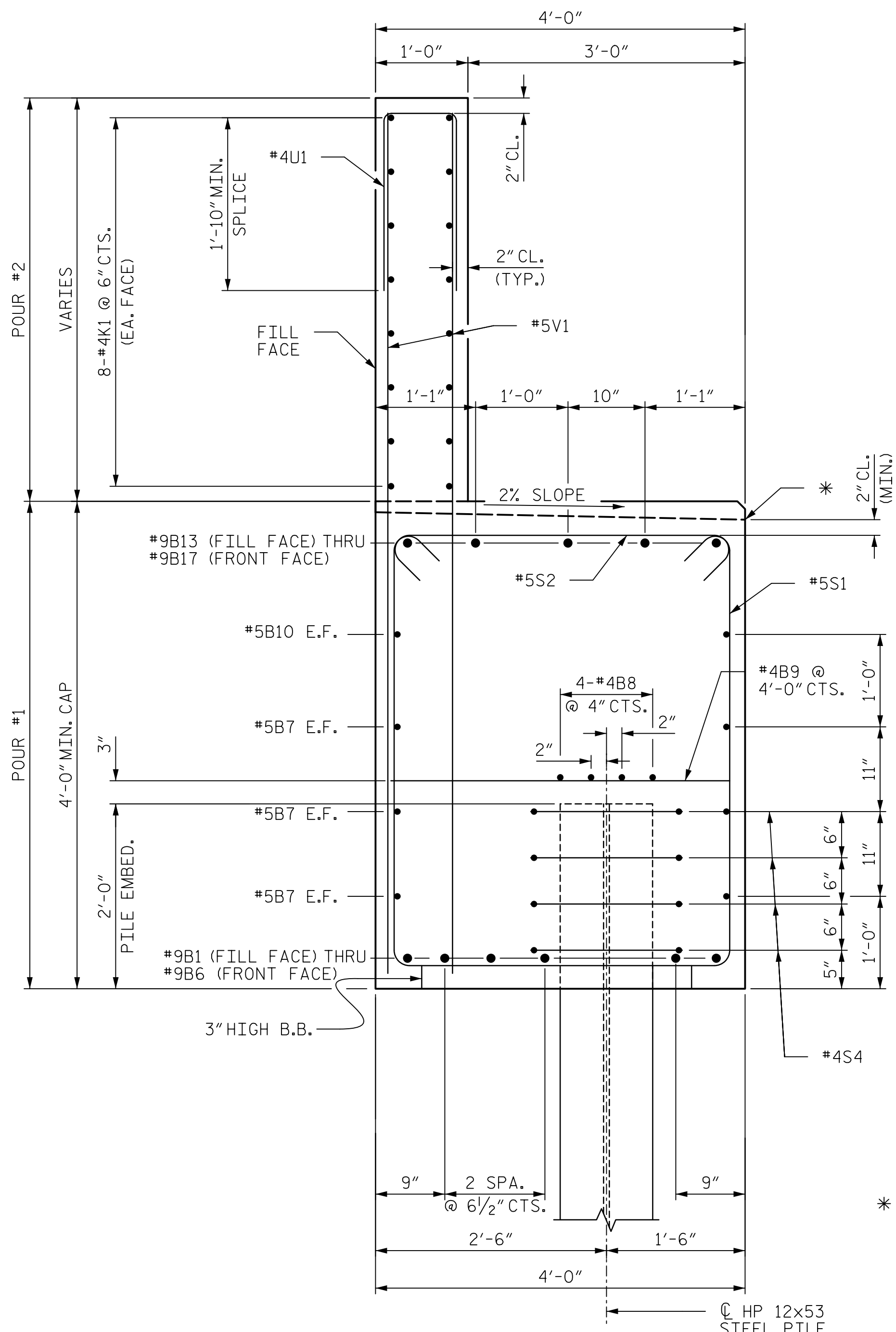

SECTION A-A

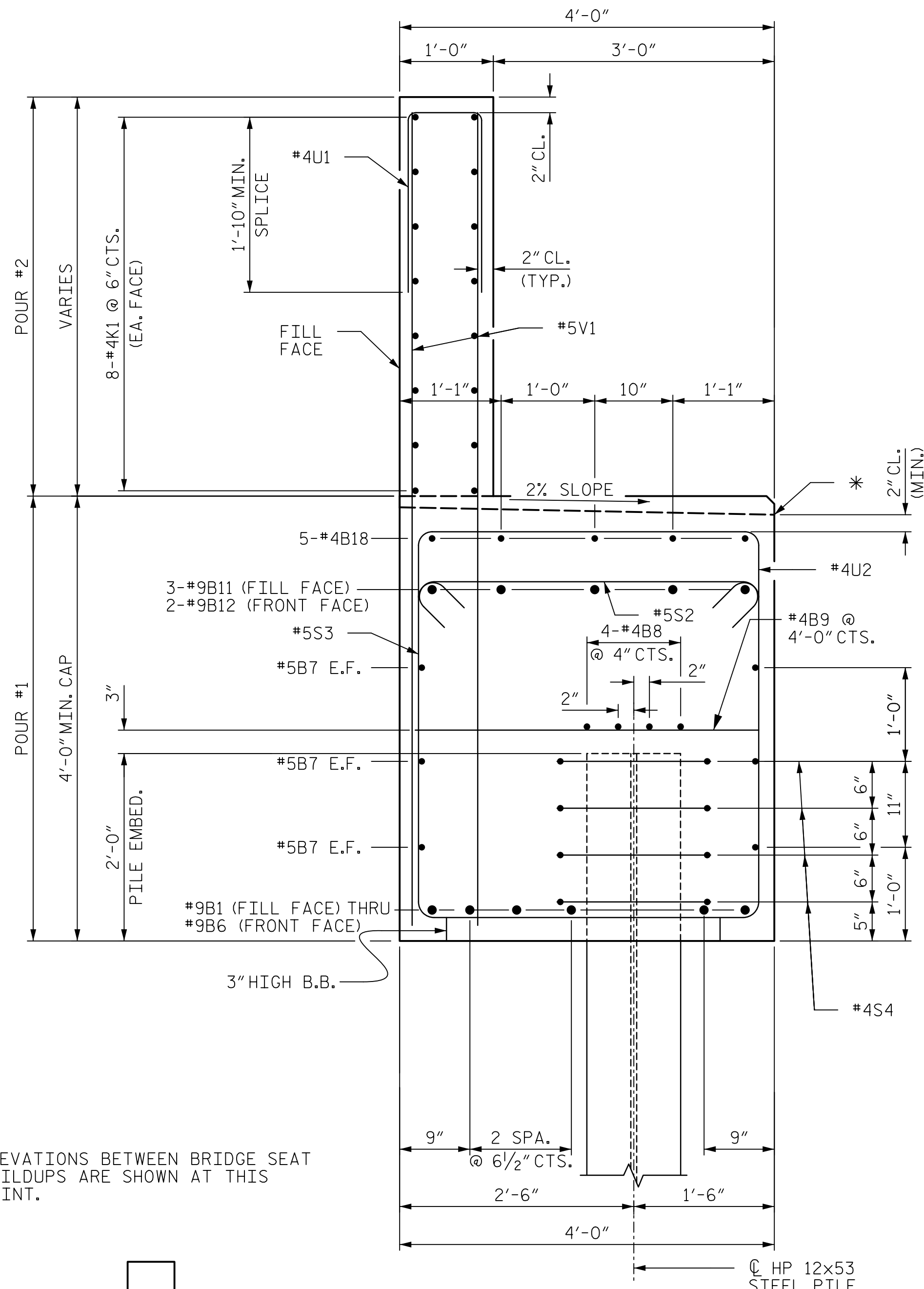

SECTION B-B

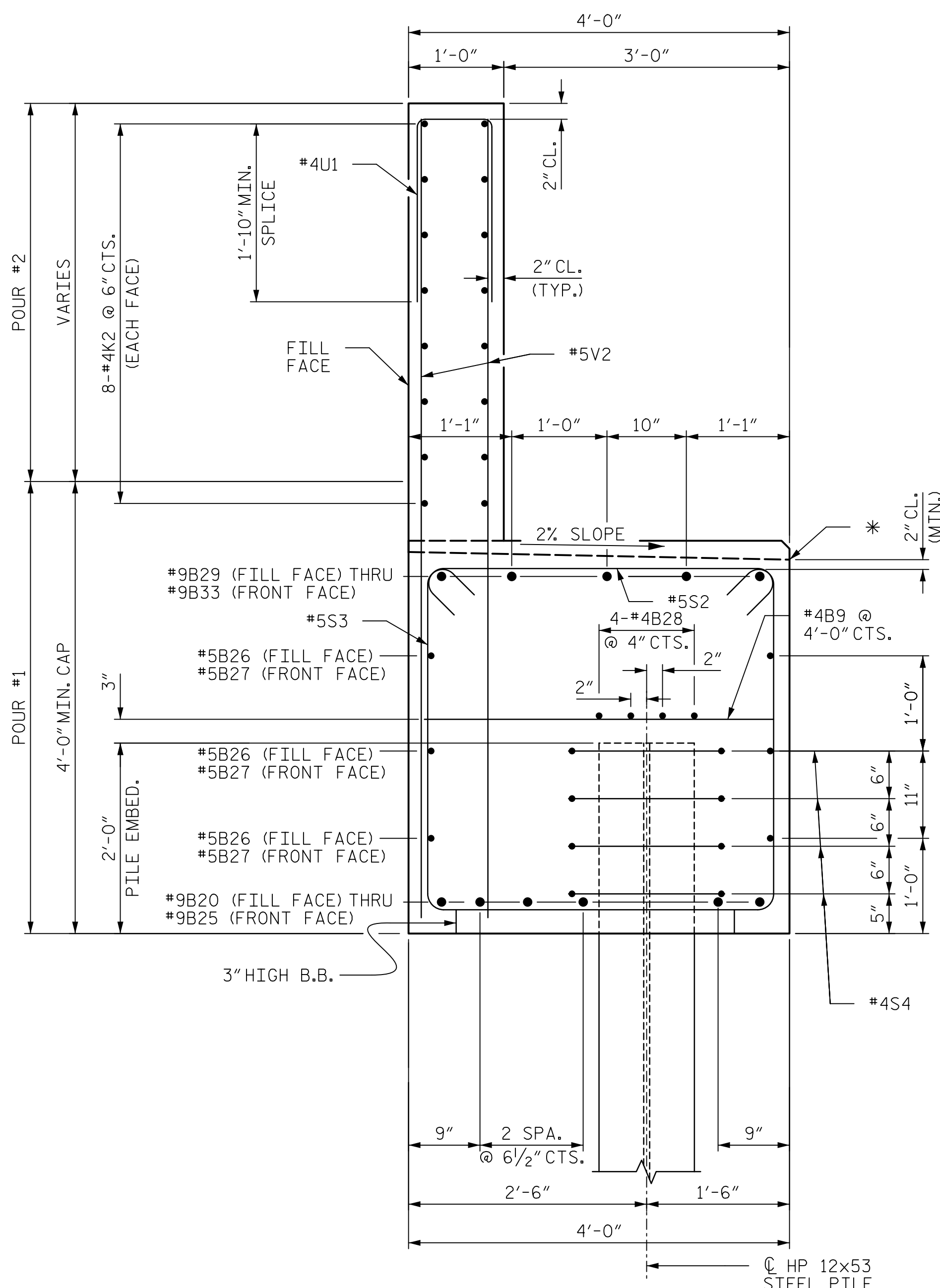

SECTION C-C

* ELEVATIONS BETWEEN BRIDGE SEAT BUILDUPS ARE SHOWN AT THIS POINT.

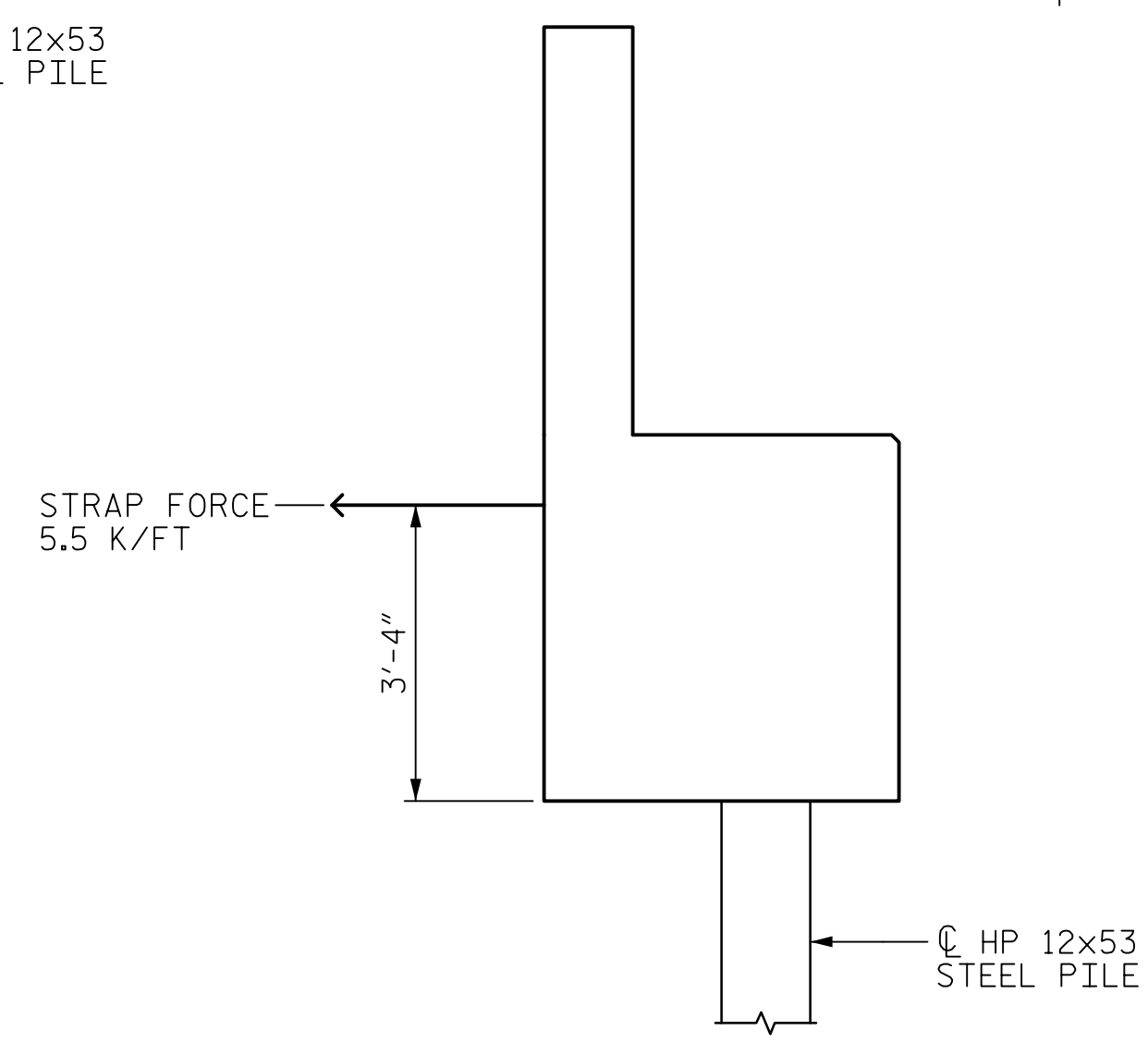

STRAP FORCE

NOTES:
THE TOP SURFACE OF THE CAP, EXCEPT THE BRIDGE SEAT BUILD-UPS SHALL BE SLOPED TRANSVERSELY FROM THE FILL FACE TO THE FRONT FACE AT THE RATE OF 2%.

PROJECT NO. B-4654
WAKE COUNTY
STATION: 22+71.80 -L-

SHEET 4 OF 5

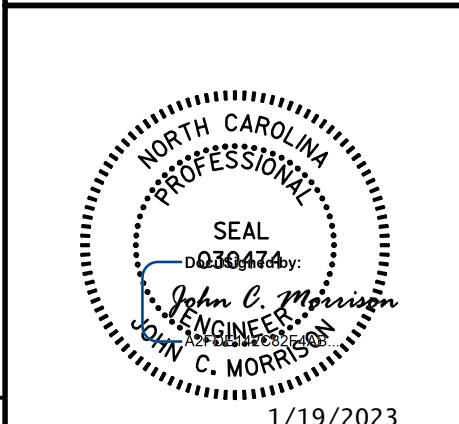

STATE OF NORTH CAROLINA
DEPARTMENT OF TRANSPORTATION
RALEIGH
SUBSTRUCTURE

END BENT 1
SECTION AND DETAILS

DRAWN BY : T.B. STUMP	DATE : 01/2019
CHECKED BY : J.C. MORRISON	DATE : 01/2019
DESIGNED BY : T.B. STUMP	DATE : 01/2019
DESIGN CHECKED BY : J.C. MORRISON	DATE : 01/2019

DOCUMENT NOT CONSIDERED FINAL UNLESS ALL SIGNATURES COMPLETED

REVISIONS						SHEET NO. S-36 TOTAL SHEETS 49
NO.	BY:	DATE:	NO.	BY:	DATE:	
1			3			
2			4			