

SEE TMP-06 FOR OFF-SITE DETOUR TO PLACE GIRDERS AND REMOVE EXISTING BRIDGE

SEE TMP-12A FOR SECTION DETAILS.

SEE TMP-14 FOR OFF-SITE DETOUR FOR RAMP D CLOSURE

* PLACE PCB WITHOUT DRAINAGE SLOTS ON BRIDGE FROM STA. 21+56 TO 23+88

PLACE SIGNS DURING RAMP D CONSTRUCTION

ROAD CLOSED
W20-3
48" X 48"
SF-4R
42" X 12"
PLACE SIGNS DURING RAMP D CONSTRUCTION

NEXT RIGHT
W20-3
48" X 48"
SF-4R
42" X 12"

ROAD CLOSED
W20-3
48" X 48"
SF-4L
42" X 12"
NEXT LEFT

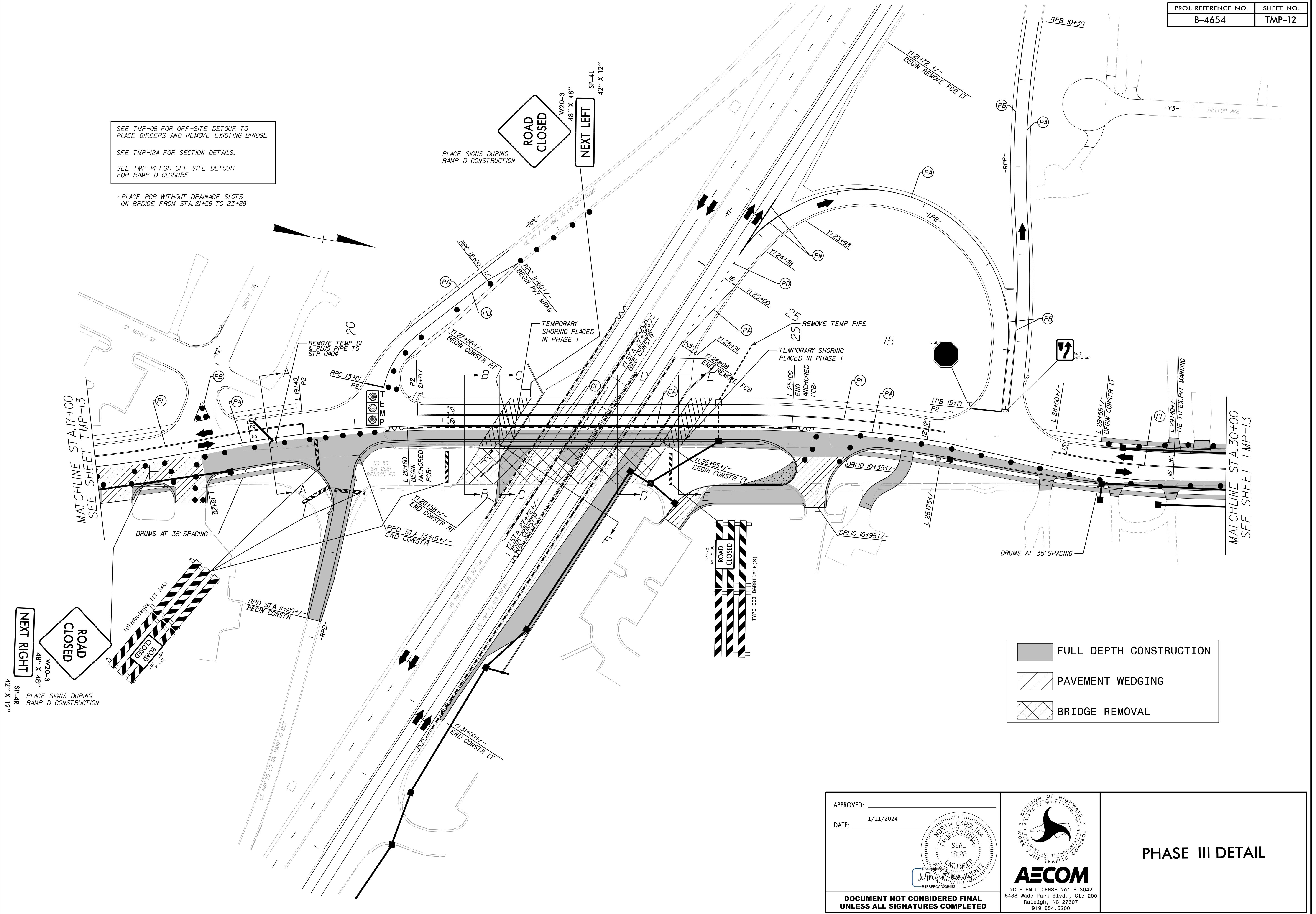

	FULL DEPTH CONSTRUCTION
	PAVEMENT WEDGING
	BRIDGE REMOVAL

APPROVED: _____

DATE: 1/11/2024

DOCUMENT NOT CONSIDERED FINAL UNLESS ALL SIGNATURES COMPLETED

DIVISION OF HIGHWAYS
STATE OF NORTH CAROLINA
DEPARTMENT OF TRANSPORTATION
WORK ZONE TRAFFIC CONTROL

AECOM
NC FIRM LICENSE No: F-3042
5438 Wade Park Blvd., Ste 200
Raleigh, NC 27607
919.854.6200

PHASE III DETAIL

1/11/2024
 L:\Legacy\Projects\60436695-B-4654\900_CAD\70_NGD01_TIP\TrafficControl\TP\current_files\B4654_TC_TMP_12_PhaseIII.dgn
 pattrick.mcpherson