

LONGITUDINAL TOP AND BOTTOM OF SLAB REINFORCING IS SYMMETRICAL ABOUT -L-

NOTES:  
FOR NOTES SEE "PLAN OF SPAN" SHEET 2 OF 4.

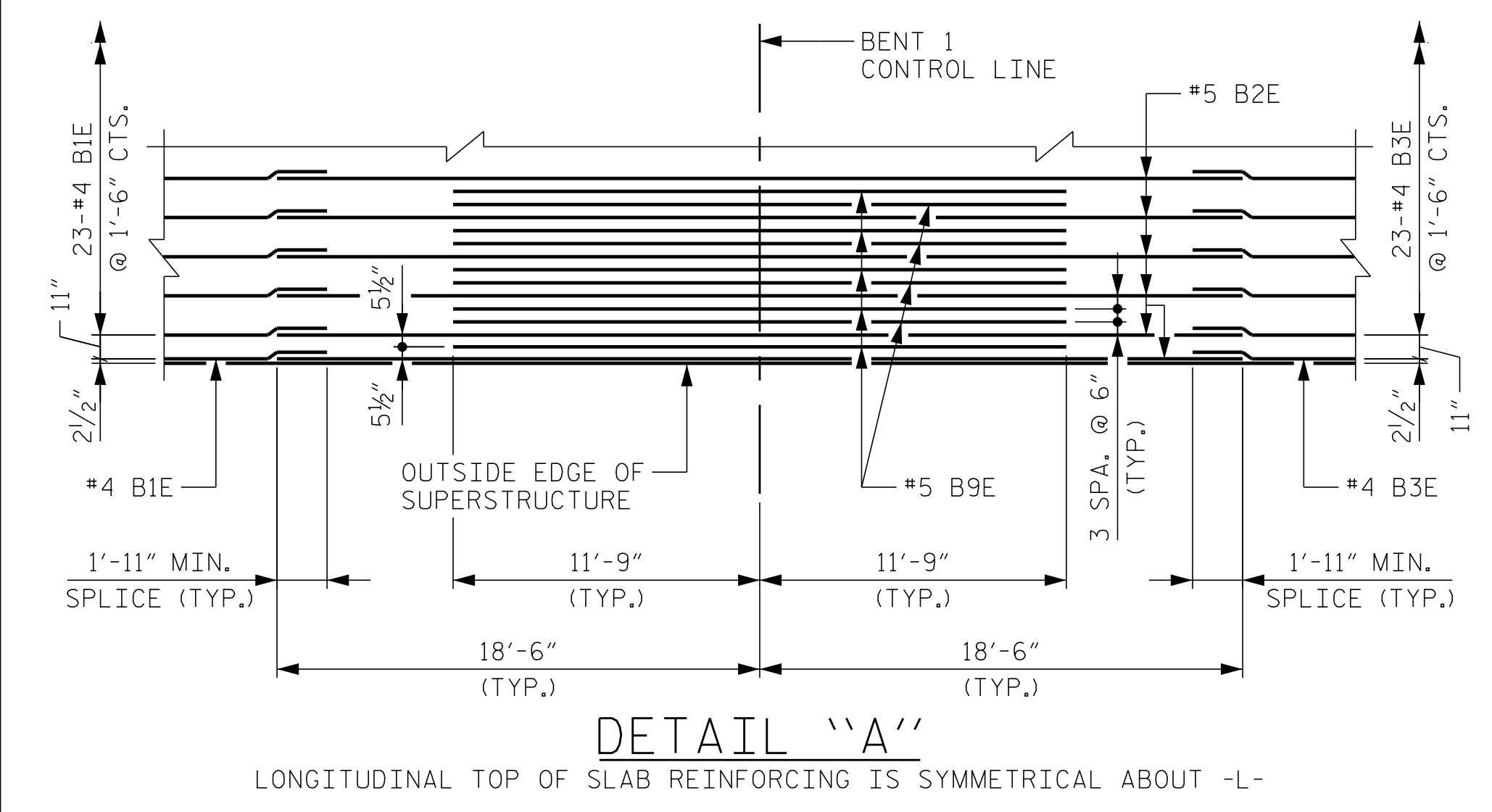

LONGITUDINAL TOP OF SLAB REINFORCING IS SYMMETRICAL ABOUT -L-

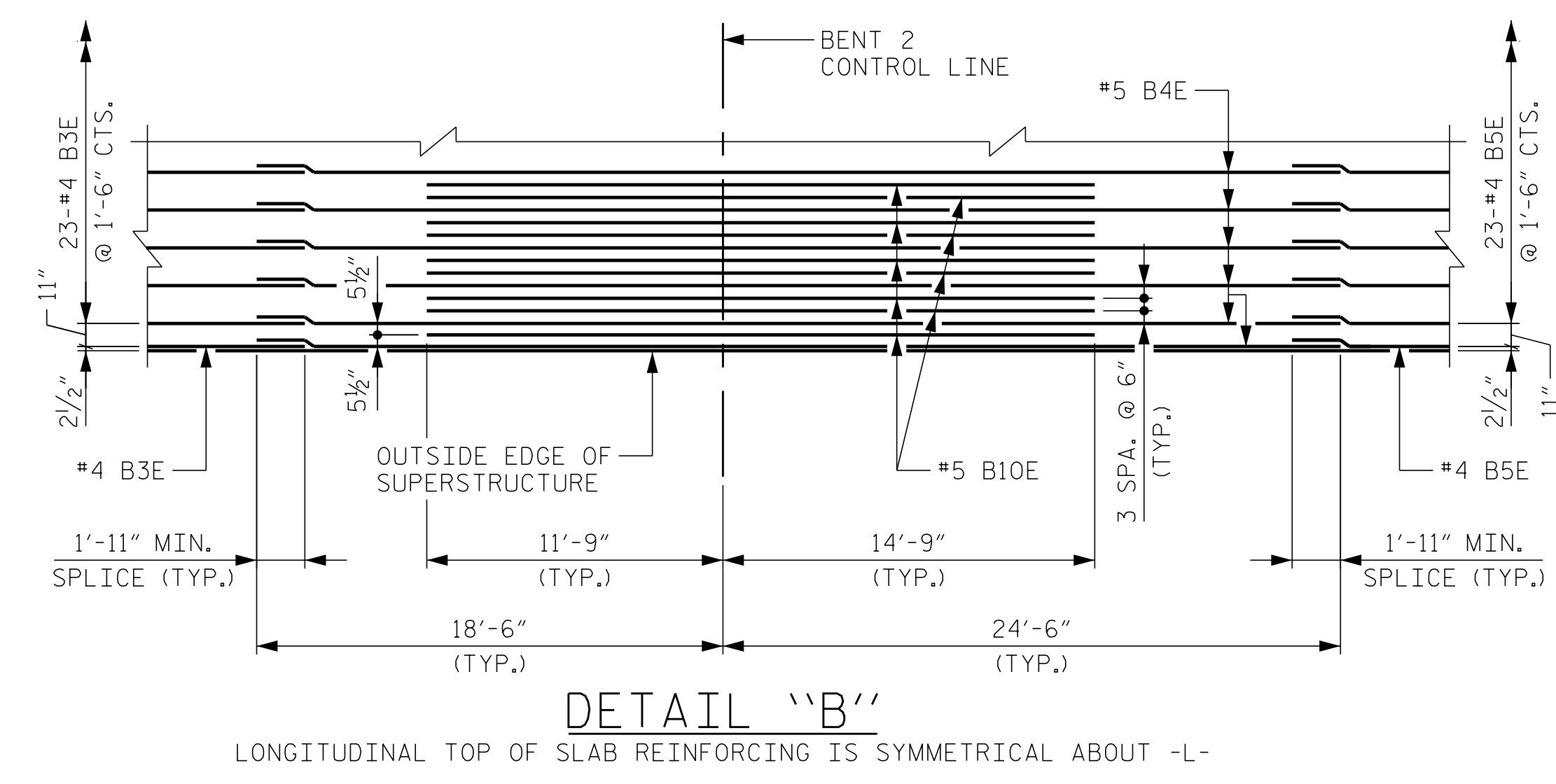

LONGITUDINAL TOP OF SLAB REINFORCING IS SYMMETRICAL ABOUT -L-

Seal of North Carolina Professional Engineer C. T. POOLE, No. 047653, dated 1/10/2024.

**Kimley»Horn**  
 421 Fayetteville Street, Suite 600  
 Raleigh, NC 27601-1772  
 Phone (919) 677-2000 NC LICENSE # F-0102

PROJECT NO. B-5156  
PENDER COUNTY  
 STATION: 22+90.50 -L-

SHEET 1 OF 6

REVISIONS						SHEET NO.
NO.	BY:	DATE:	NO.	BY:	DATE:	S-9
1			3			TOTAL SHEETS
2			4			45

DRAWN BY: D. D. LOWERY DATE: 03/2023  
 CHECKED BY: A. L. PHILLIPS DATE: 03/2023  
 DESIGN ENGINEER OF RECORD: C. T. POOLE DATE: 03/2023

**DOCUMENT NOT CONSIDERED FINAL  
 UNLESS ALL SIGNATURES COMPLETED**

This document, together with the concepts and designs presented herein, is an integral part of the project. It is intended only for the specific purpose and site for which it was prepared. No other use or application of this document without written authorization and approval by Kimley-Horn and Associates, Inc. shall be without liability to Kimley-Horn and Associates, Inc.  
 Copyright Kimley-Horn and Associates, Inc., 2024