

| STATE | STATE PROJECT REFERENCE NO. | SHEET NO. | TOTAL SHEETS |
|-------|-----------------------------|-----------|--------------|
| N.C.  | B-5156                      | RW01      | 6            |

STATE OF NORTH CAROLINA  
DIVISION OF HIGHWAYS

---

SURVEY CONTROL, EXISTING CENTERLINES,  
RIGHT OF WAY, EASEMENTS AND PROPERTY TIES

---

**PENDER COUNTY**

---

BRIDGE NO. 28 OVER LONG CREEK ON NC 210

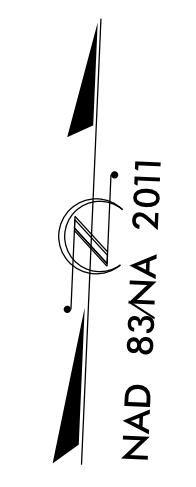
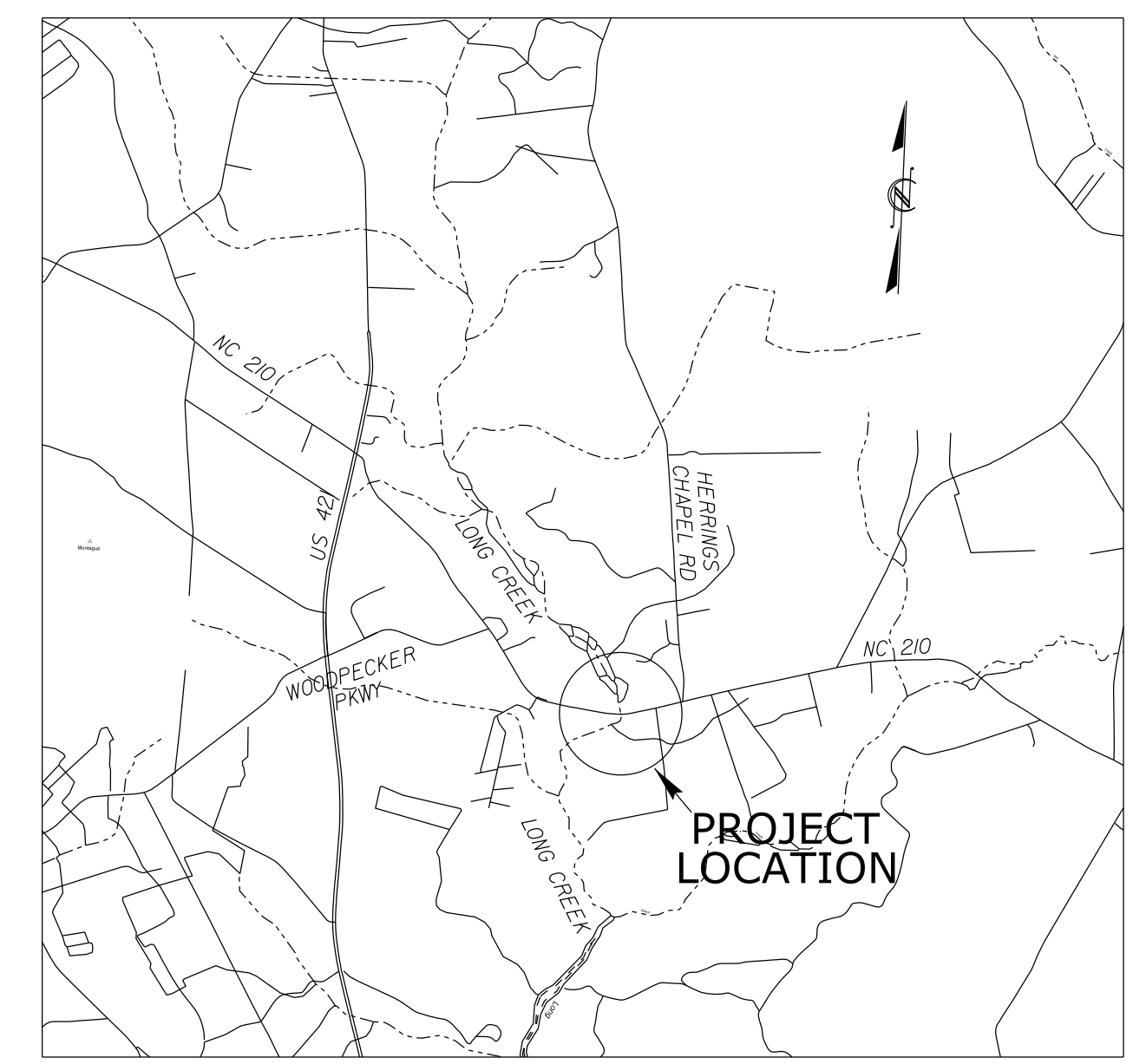

**TIP PROJECT: B-5156**

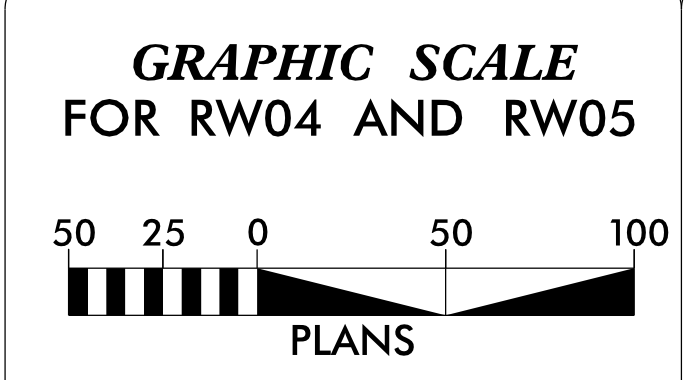
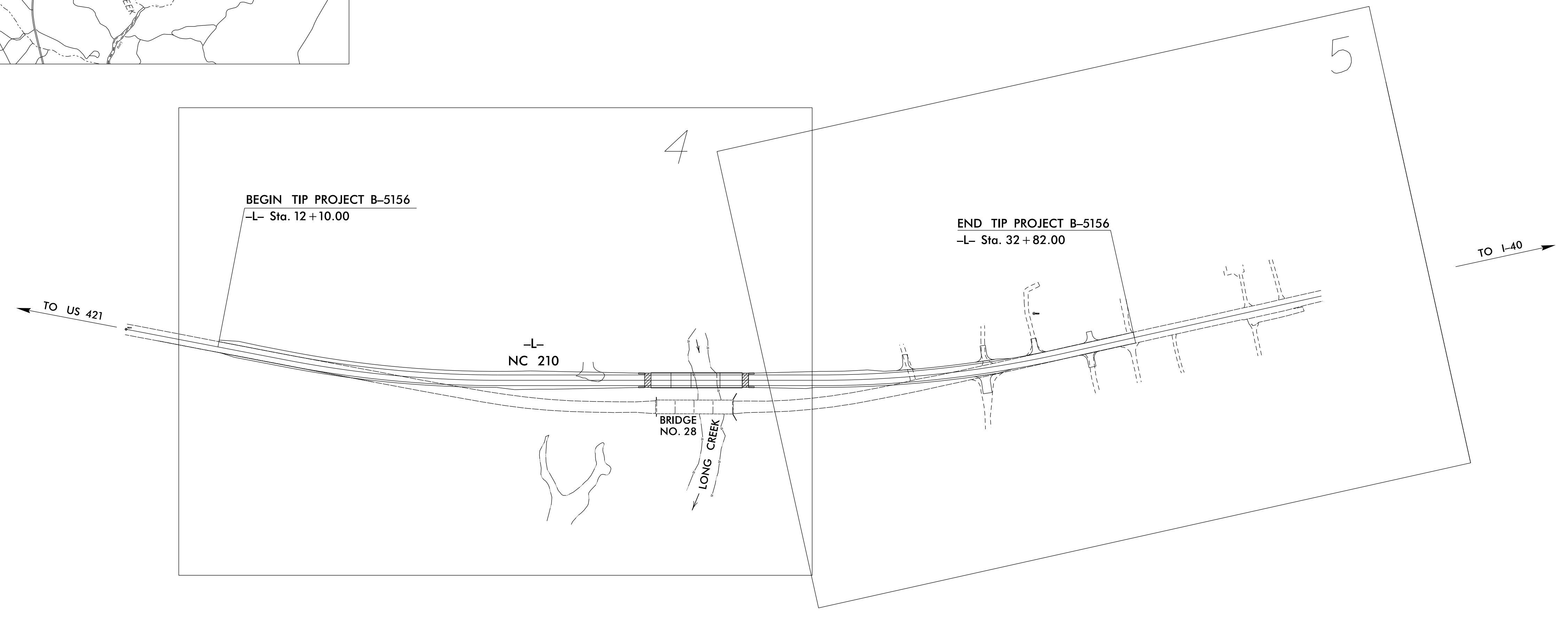

**DATUM DESCRIPTION**

THE LOCALIZED COORDINATE SYSTEM DEVELOPED FOR THIS PROJECT IS BASED ON THE STATE PLANE COORDINATES ESTABLISHED BY NCGS FOR MONUMENT "B5156-2" WITH NAD 83/NA 2011 STATE PLANE GRID COORDINATES OF  
NORTHING: 252680.919(ft) EASTING: 2295286.023(ft)  
ELEVATION: 20.206(ft)

THE AVERAGE COMBINED GRID FACTOR USED ON THIS PROJECT (GROUND TO GRID) IS: 0.999976799

THE N.C. LAMBERT GRID BEARING AND LOCALIZED HORIZONTAL GROUND DISTANCE FROM "B5156-2" TO -L- STATION 10+00.00 IS  
S 84-37'00.1" W 2,892.28(ft)

ALL LINEAR DIMENSIONS ARE LOCALIZED HORIZONTAL DISTANCES  
VERTICAL DATUM USED IS NAVD 88

*Prepared in the Office of:*

**LOCATION AND SURVEYS UNIT  
DIVISION 3  
5310 BARBADOS BLVD, SUITE 102  
CASTLE HAYNE, NORTH CAROLINA 28429**

---

2018 STANDARD SPECIFICATIONS

|   |   |
|---|---|
| <b>RIGHT OF WAY DATE:</b><br><u>AUGUST 28, 2019</u> | <b>LETTING DATE:</b><br><u>SEPTEMBER 19, 2023</u> |
|---|---|

**PROFESSIONAL LAND  
SURVEYOR**

DocuSigned by:  
Christopher J. Sawyer 06/09/2023

SIGNATURE: \_\_\_\_\_ Date: \_\_\_\_\_

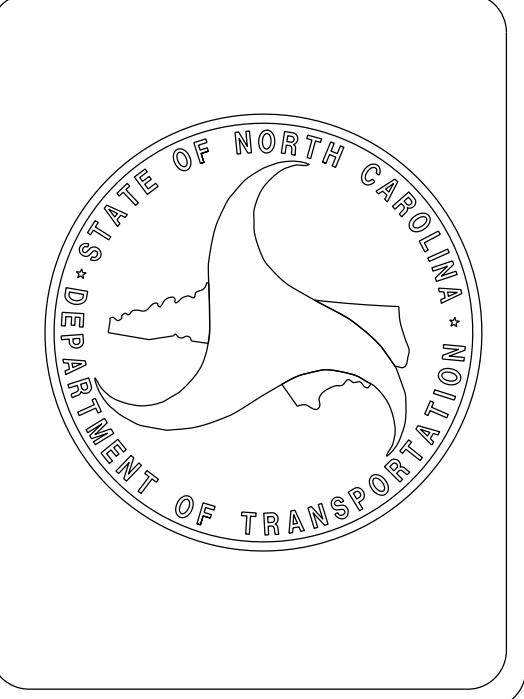

07-JUN-2023 10:42  
S:\Units\Div03\Projects\Pender\B5156-LongCreek\Working\150 series sheets\B5156\_ls\_rw01.dgn  
midval AT LS-328725L