

09/08/19

**TIP PROJECT: B-5156**

**CONTRACT: C204724**

STATE OF NORTH CAROLINA  
DIVISION OF HIGHWAYS  
**PENDER COUNTY**

STATE	STATE PROJECT REFERENCE NO.	SHEET NO.	TOTAL SHEETS
N.C.	B-5156	1	
STATE PROJ. NO.	F.A. PROJ. NO.	DESCRIPTION	
42331.1.2		P.E.	
42331.2.1		RIGHT OF WAY	
42331.2.1		UTILITIES	
42331.3.1		CONSTRUCTION	

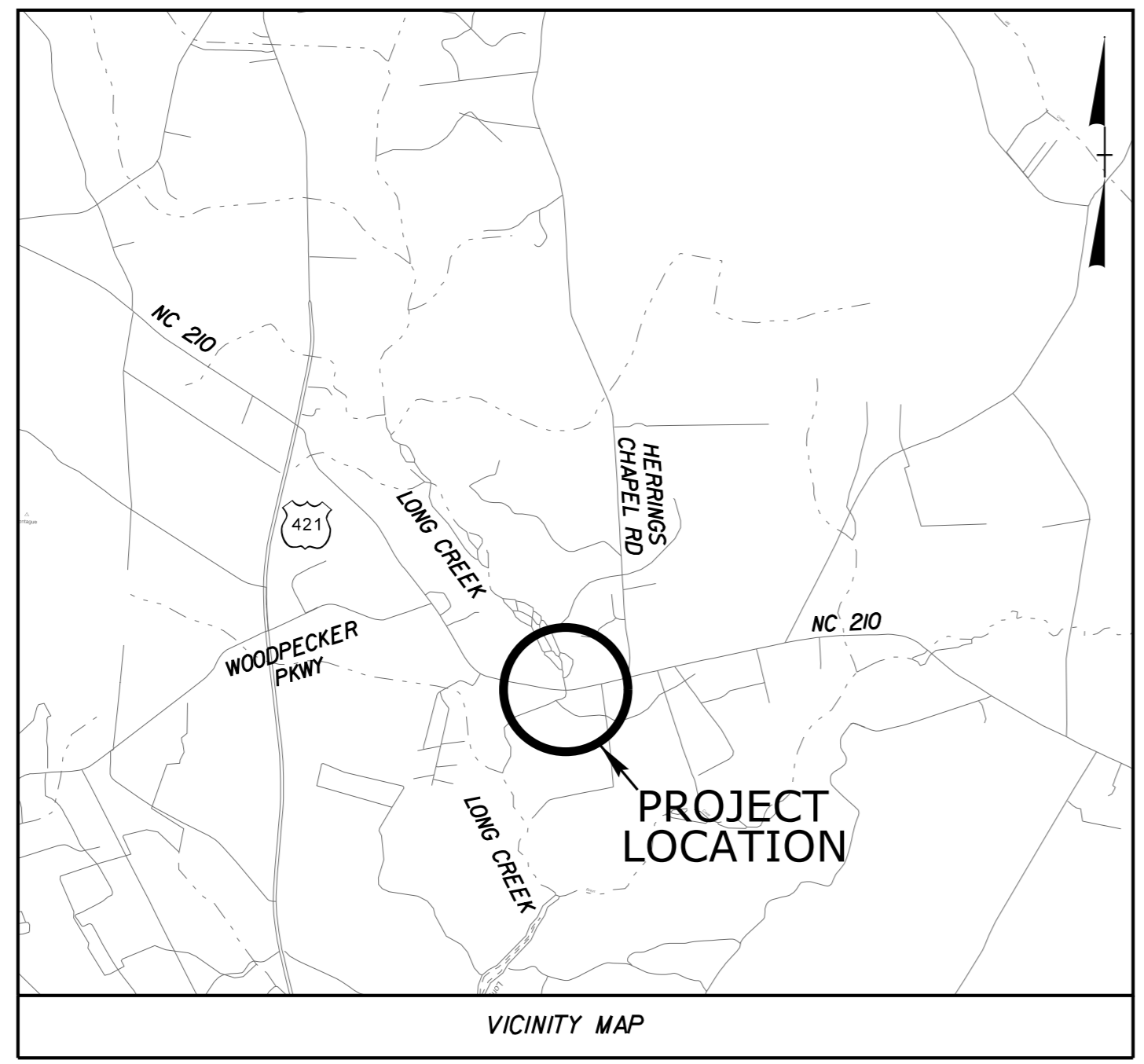

**LOCATION: BRIDGE 28 OVER LONG CREEK ON NC 210**  
**TYPE OF WORK: GRADING, DRAINAGE, PAVING, AND STRUCTURES**

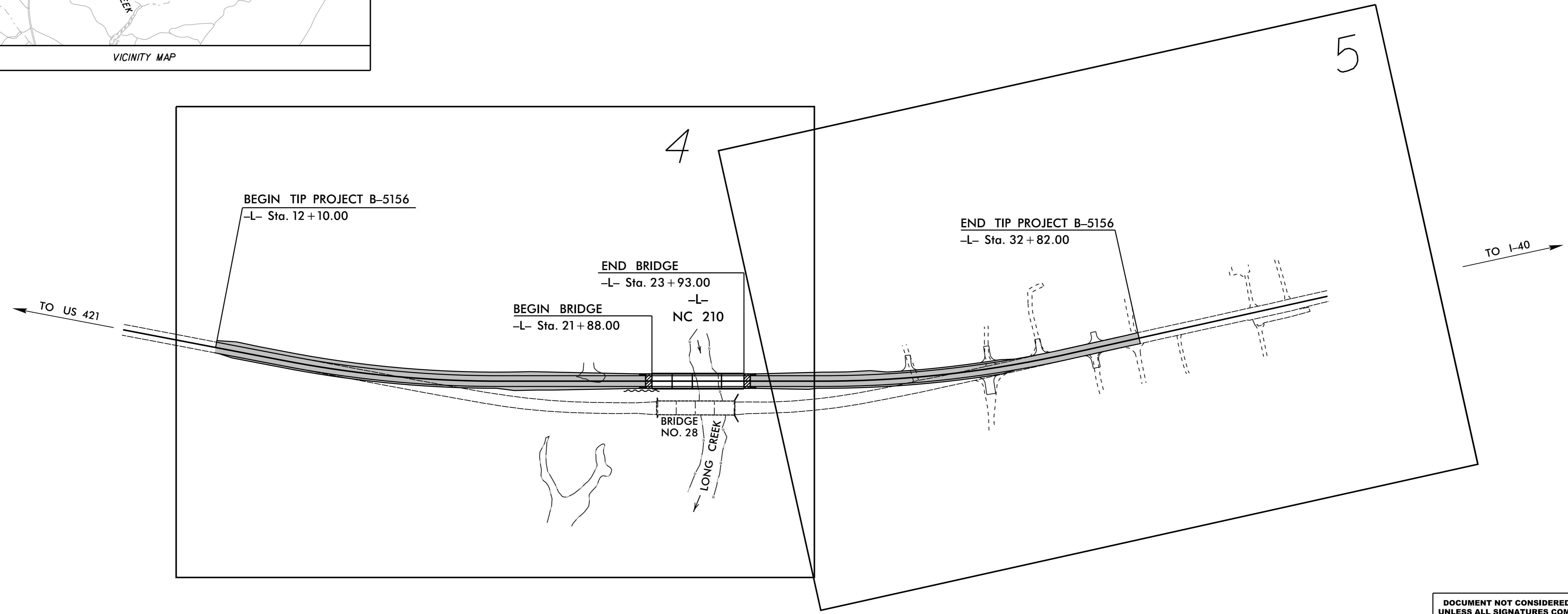
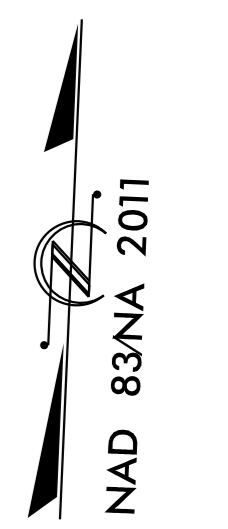

DOCUMENT NOT CONSIDERED FINAL  
UNLESS ALL SIGNATURES COMPLETED

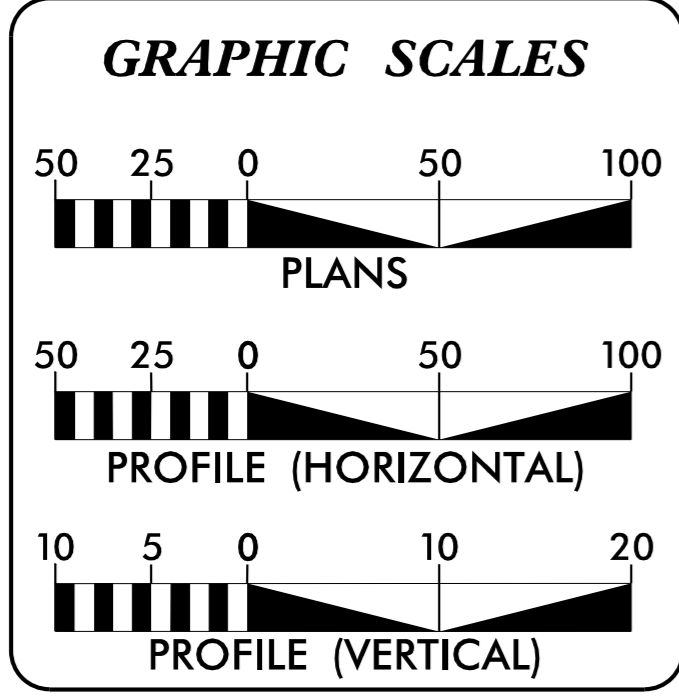

**DESIGN DATA**

AADT 2020 =	3,000
AADT 2040 =	3,600
K =	10%
D =	55%
T =	12%*
V =	60 MPH
* (TTST 4% + DUAL 8%)	
FUNCTIONAL CLASSIFICATION:	RURAL MAJOR COLLECTOR
REGIONAL TIER	

**PROJECT LENGTH**

LENGTH ROADWAY TIP PROJECT B-5156	=	0.353 MILES
LENGTH STRUCTURES TIP PROJECT B-5156	=	0.039 MILES
TOTAL LENGTH TIP PROJECT B-5156	=	0.392 MILES

PLANS PREPARED FOR THE NCDOT BY:

2024 STANDARD SPECIFICATIONS

**Kimley » Horn**

**JEFFREY W. MOORE, P.E.**  
PROJECT ENGINEER

**SETH DENNEY, P.E.**  
PROJECT DESIGN ENGINEER

**DAVID STUTTS, P.E.**  
STRUCTURES MANAGEMENT UNIT  
PROJECT ENGINEER -  
PEPROGRAM MANAGEMENT

**RIGHT OF WAY DATE:**  
AUGUST 28, 2019

**LETTING DATE:**  
APRIL 16, 2024

**HYDRAULICS ENGINEER**

DocuSigned by:  
David Pursey 7/2024  
SIGNATURE:

**ROADWAY DESIGN ENGINEER**

DocuSigned by:  
Jeffrey W. Moore 7/2024  
SIGNATURE:

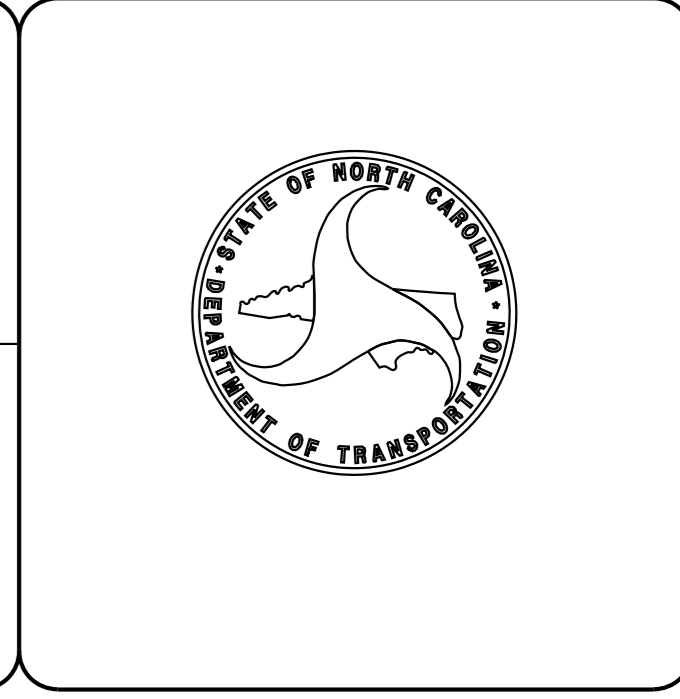

3/7/2024