

09/08/99

STATE OF NORTH CAROLINA
DIVISION OF HIGHWAYS

STATE	STATE PROJECT REFERENCE NO.	SHEET NO.
N.C.	2024CPT.01.06.10271, ETC.	1
STATE PROJ. NO.	F.A. PROJ. NO.	DESCRIPTION
2024CPT.01.06.10271		PE, CONST

CURRITUCK COUNTY

LOCATION: MAP 1 - NC 12 FROM DARE CO. TO SR 1437 N. BEACH ACCESS RD

**TYPE OF WORK: MILLING, RESURFACING, SHOULDER RECONSTRUCTION,
& LONG-LIFE PAVEMENT MARKINGS**

WBS NO.: 2024CPT.01.06.10271, ETC.

CONTRACT: C204932

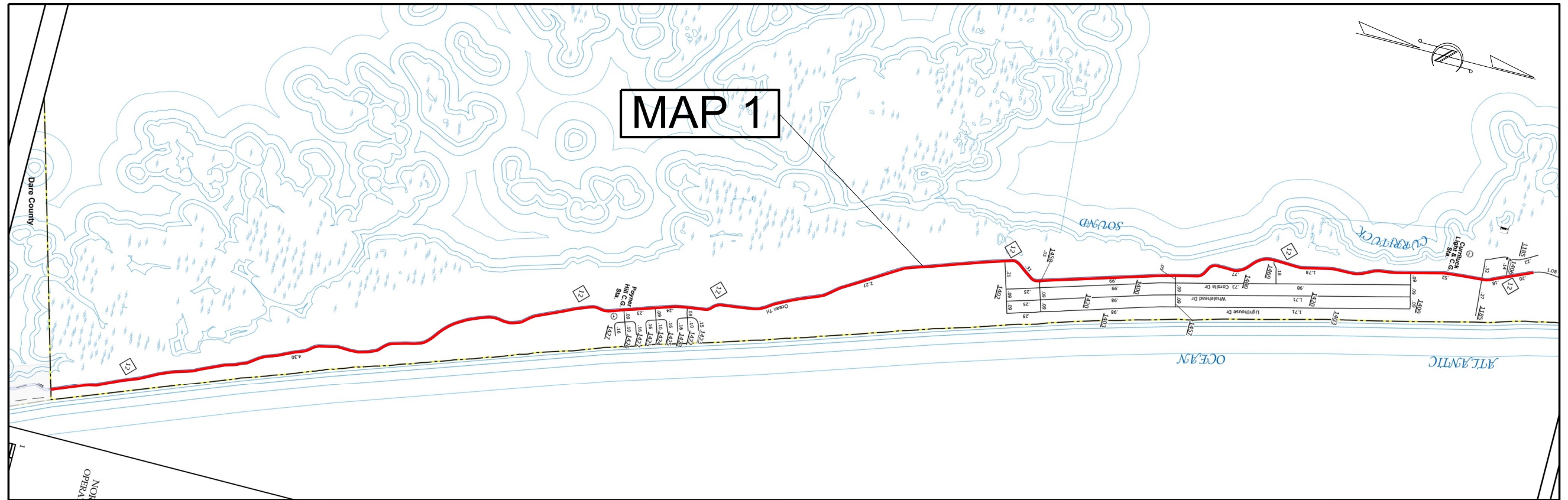

REV 01/11/24
D.H. STALLINGS

GRAPHIC SCALES

NTS

MAP LENGTH

MAP 1 = 11.11 MILES

Prepared in the Office of:
DIVISION 1
DIVISION OF HIGHWAYS
113 AIRPORT DR., EDENTON NC, 27932

2024 STANDARD SPECIFICATIONS

B. N. BRASWELL, PE
DIVISION PROJECT DEVELOPMENT ENGINEER

CHRIS SLACHTA
DIVISION CONTRACT ENGINEER

D. H. STALLINGS
DIVISION DESIGN ENGINEER

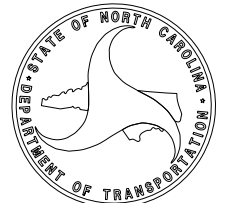

\$\$\$\$\$SYTIME\$\$\$\$\$
\$\$\$\$\$Y\$\$\$\$\$DGN\$\$\$\$\$
\$\$\$\$\$USERNAME\$\$\$\$\$