

STATE	STATE PROJECT REFERENCE NO.	SHEET NO.	TOTAL SHEETS
N.C.	R-5963D	RW01	08

TIP PROJECT: R-5963D

STATE OF NORTH CAROLINA
 DIVISION OF HIGHWAYS

SURVEY CONTROL, EXISTING CENTERLINES,
 RIGHT OF WAY, EASEMENTS AND PROPERTY TIES

CHATHAM COUNTY

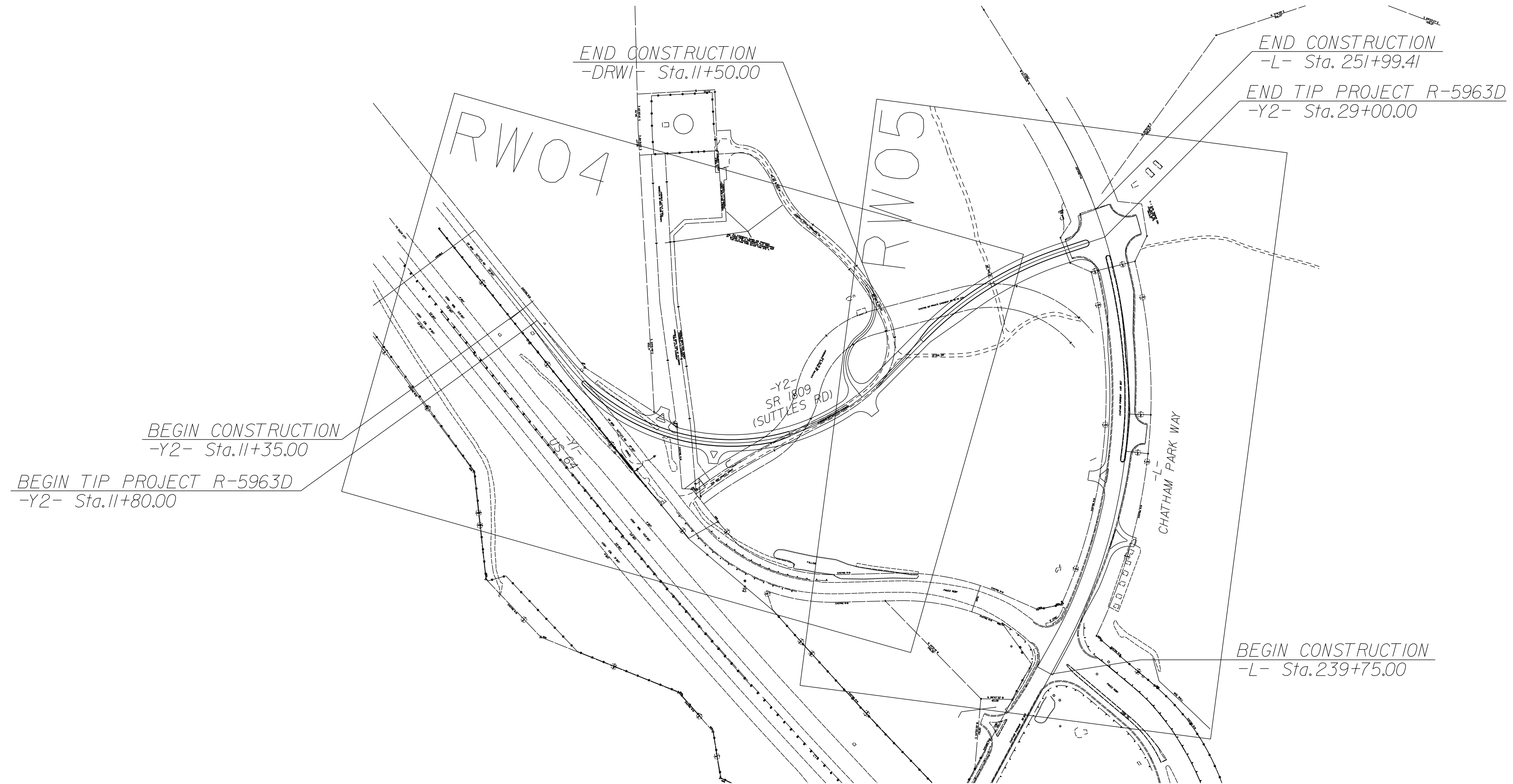

CHATHAM PARK WAY IS A PARTIAL CONTROLLED-ACCESS PROJECT WITH ACCESS LIMITED TO POINTS AS SHOWN ON THE PLANS

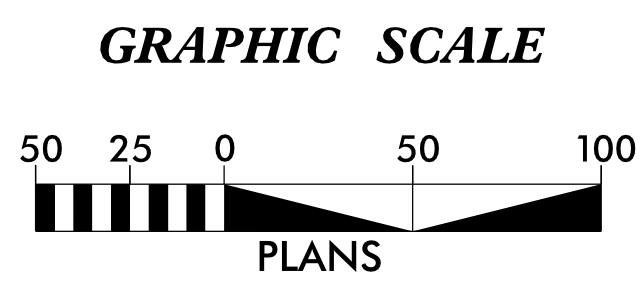

DATUM DESCRIPTION

THE LOCALIZED COORDINATE SYSTEM DEVELOPED FOR THIS PROJECT IS BASED ON THE STATE PLANE COORDINATES ESTABLISHED BY NCGS FOR MONUMENT "R5930-1" WITH NAD 83/NA 2011 STATE PLANE GRID COORDINATES OF NORTHING: 721,723.517(ft) EASTING: 1,956,011.320(ft) ELEVATION: 539.764(ft)

THE AVERAGE COMBINED GRID FACTOR USED ON THIS PROJECT (GROUND TO GRID) IS: 0.999886829

THE N.C. LAMBERT GRID BEARING AND LOCALIZED HORIZONTAL GROUND DISTANCE FROM "R5930-1" TO -L- STATION 239+75.00 IS N 31°-34'34.8" E 775.23(ft)

ALL LINEAR DIMENSIONS ARE LOCALIZED HORIZONTAL DISTANCES VERTICAL DATUM USED IS NAVD 88 - GEOID 12B

Prepared in the Office of:



2018 STANDARD SPECIFICATIONS

RIGHT OF WAY DATE:
06/28/2023

LETTING DATE:
04/16/2024

PROFESSIONAL LAND SURVEYOR

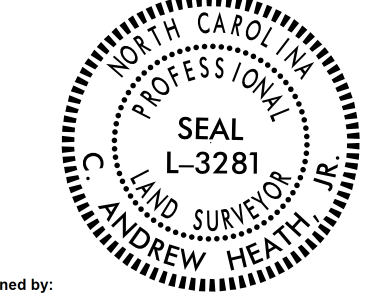

DocuSigned by:
C. Andrew Heath Jr.
 SIGNATURE: _____

Date: 2/1/2024

