

STATE OF NORTH CAROLINA  
DIVISION OF HIGHWAYS

**TRANSPORTATION MANAGEMENT PLAN**

**UNION COUNTY**

**LOCATION: SR 1357 (POTTER ROAD) FROM AZTECA DRIVE TO SR 1099 (OLD MONROE ROAD), AND SR 1364 (PLEASANT PLAINS ROAD) FROM AURORA BOULEVARD TO LAKEWOOD DRIVE; CONSTRUCT LEFT AND RIGHT TURN LANES ON EXISTING LOCATION**

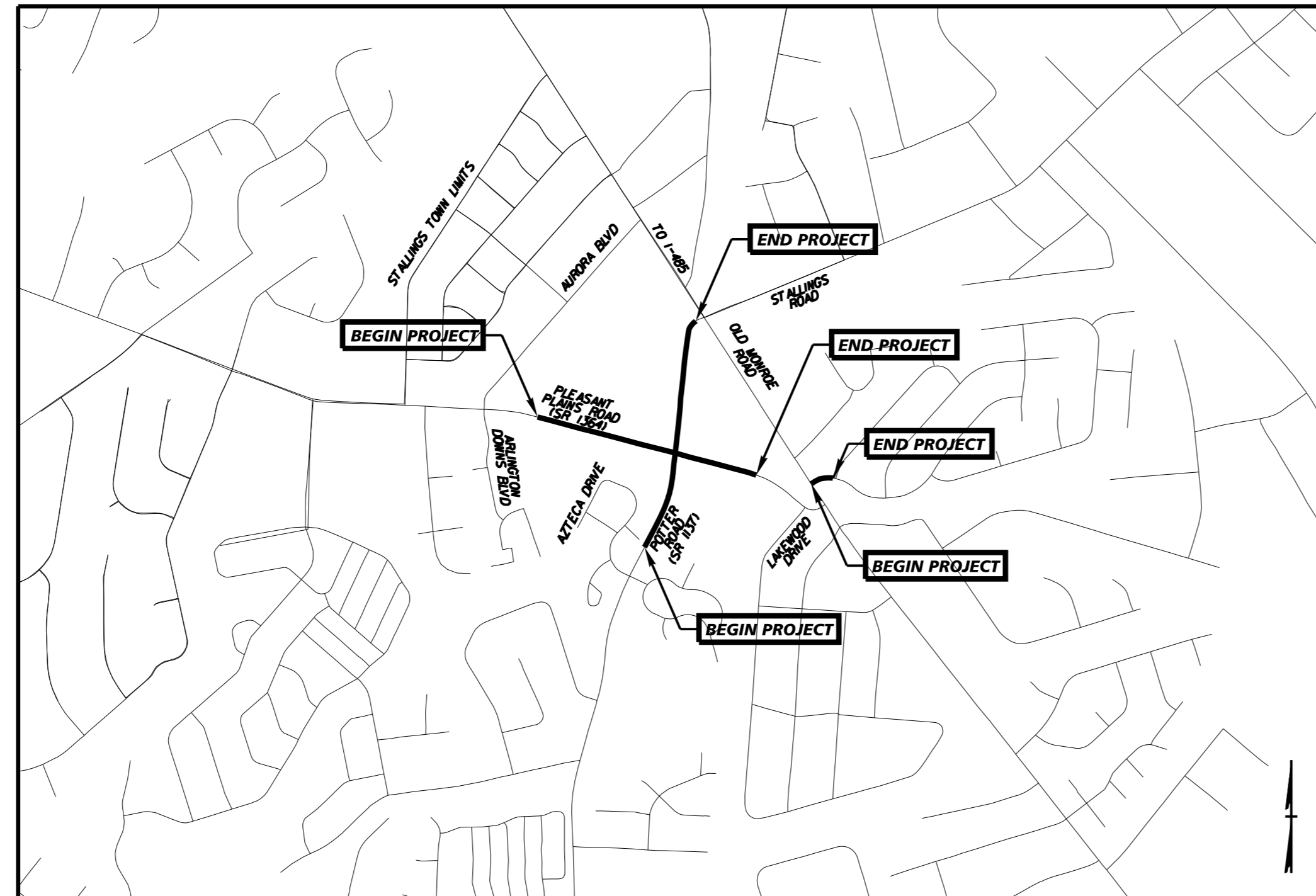
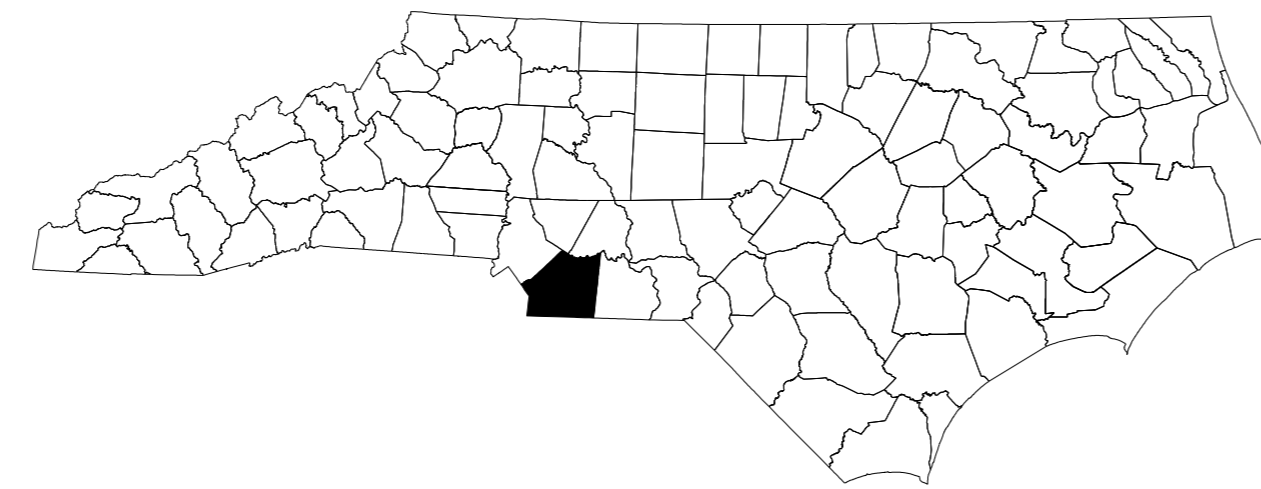

VICINITY MAP

<b>INDEX OF SHEETS</b>	
SHEET NO.	TITLE
TMP-1	TITLE SHEET, VICINITY MAP, AND INDEX OF SHEETS
TMP-1A THRU TMP-1C	LIST OF APPLICABLE ROADWAY STANDARD DRAWINGS, LEGEND, TEMPORARY PAVEMENT MARKINGS, MANAGEMENT STRATEGIES, AND GENERAL NOTES
TMP-2	CONSTRUCTION PHASING
TMP-2A	DETOUR SHEET
TMP-3 THRU TMP-4	PHASE 1
TMP-5 THRU TMP-6	PHASE 2
TMP-7	PHASE 3
TMP-8	PHASE 3A

**Kimley»Horn**

FRANK MASTERSON, P.E. TRAFFIC CONTROL PROJECT ENGINEER

ANDREW WEEKS, E.I. TRAFFIC CONTROL PROJECT DESIGN ENGINEER

APPROVED: 

DATE: 1/31/2024

SEAL

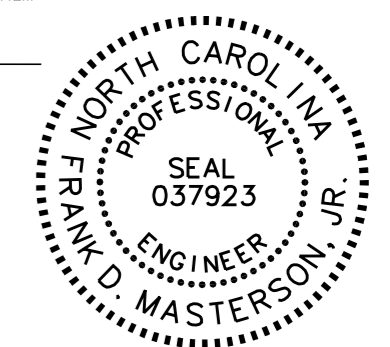

K:\CHL\_P\PRJ\01036720 - U-5112 (P3 Intersection)\TrafficControl\CP\Sheets\U-5112\_rdy\_imp\_ldgn 1/30/2024



PLANS PREPARED BY:

FRANK MASTERSON, PE  
PROJECT ENGINEER

ANDREW WEEKS, EI  
PROJECT DESIGN ENGINEER

NCDOT CONTACTS:

TRAVIS PRESLAR, PE  
DIVISION 10 - TEAM LEAD

YANWEI MA, PE  
DMSTIP - PROJECT MANAGER

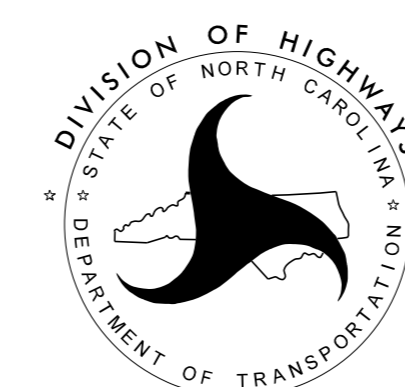

U-5112

TIP PROJECT:

SHEET NO.  
TMP-1

# ROADWAY STANDARD DRAWINGS

THE FOLLOWING ROADWAY STANDARDS AS SHOWN IN "ROADWAY STANDARD DRAWINGS" - N.C. DEPARTMENT OF TRANSPORTATION - RALEIGH, N.C., DATED JANUARY 2024 ARE APPLICABLE TO THIS PROJECT AND BY REFERENCE HEREBY ARE CONSIDERED A PART OF THESE PLANS:

STD. NO.	TITLE
1101.01	WORK ZONE ADVANCE WARNING SIGNS
1101.02	TEMPORARY LANE CLOSURES
1101.03	TEMPORARY ROAD CLOSURES
1101.11	TRAFFIC CONTROL DESIGN TABLES
1150.01	FLAGGERS
1110.01	STATIONARY WORK ZONE SIGNS
1110.02	PORTABLE WORK ZONE SIGNS
1115.01	FLASHING ARROW BOARDS
1180.01	SKINNY DRUMS
1130.01	DRUMS
1145.01	BARRICADES
1205.01	PAVEMENT MARKINGS - LINE TYPES AND OFFSETS
1205.02	PAVEMENT MARKINGS - TWO-LANE AND MULTI-LANE ROADWAYS
1205.04	PAVEMENT MARKINGS - INTERSECTIONS
1205.05	PAVEMENT MARKINGS - TURN LANES
1205.07	PAVEMENT MARKINGS - PEDESTRIAN CROSSWALKS
1205.08	PAVEMENT MARKINGS - SYMBOLS AND WORD MESSAGES
1205.09	PAVEMENT MARKINGS - PAINTED ISLANDS

# LEGEND

## GENERAL

- DIRECTION OF TRAFFIC FLOW
- DIRECTION OF PEDESTRIAN TRAFFIC FLOW
- EXIST. PVMT.
- NORTH ARROW
- PROPOSED PVMT.
- TEMP. SHORING (LOCATION PURPOSES ONLY)

- WORK AREA
- REMOVAL
- WEDGING
- TEMPORARY PAVEMENT

## SIGNALS

- EXISTING
- PROPOSED
- TEMPORARY
- PORTABLE

## PAVEMENT MARKINGS

- EXISTING LINES
- TEMPORARY LINES

## TRAFFIC CONTROL DEVICES

- BARRICADE (TYPE III)
- CONE
- DRUM SKINNY DRUM TUBULAR MARKER
- TEMPORARY CRASH CUSHION
- FLASHING ARROW BOARD
- FLAGGER
- LAW ENFORCEMENT
- TRUCK MOUNTED ATTENUATOR (TMA)
- CHANGEABLE MESSAGE SIGN

## TEMPORARY SIGNING

- PORTABLE SIGN
- STATIONARY SIGN
- STATIONARY OR PORTABLE SIGN

## PAVEMENT MARKERS

- CRYSTAL/CRYSTAL
- CRYSTAL/RED
- YELLOW/YELLOW

## PAVEMENT MARKING SYMBOLS

- PAVEMENT MARKING SYMBOLS

## TEMPORARY PAVEMENT MARKING

### PAVEMENT MARKING LINES

- P1 - PAINT (4" WHITE, 2X) EDGELINE
- P4 - PAINT (4" WHITE, 2X) 3' x 9' MINISKIP
- P13 - PAINT (4" YELLOW, 2X) DOUBLE CENTER LINE
- P61 - PAINT (24" WHITE, 2X) STOP BAR

### PAVEMENT MARKING SYMBOLS

- P73 - PAINT 2X (COMBINATION STRAIGHT & LEFT TURN ARROW)
- P76 - PAINT 2X (COMBINATION STRAIGHT, RIGHT, & LEFT TURN ARROW)

K:\CHL\_PR\01036720 - U-5112 (P3 Intersections)\TrafficControl\CP\Sheets\U-5112\_rdy\_imp\_1Adgn 1/30/2024

APPROVED:  DATE: 1/31/2024 SEAL 		ROADWAY STANDARD DRAWINGS & LEGEND
--	--	------------------------------------



## MANAGEMENT STRATEGIES

THE POTTER/PLEASANT PLAINS ROAD IMPROVEMENTS WILL BE CONSTRUCTED AT NIGHT USING DETOURS, TEMPORARY TRAFFIC PATTERNS DESIGNATED BY TEMPORARY PAVEMENT MARKINGS AND SIGNING. TEMPORARY LANE AND SHOULDER CLOSURES WILL BE USED AS NECESSARY TO COMPLETE CONSTRUCTION. THE CONTRACTOR WILL BE REQUIRED TO COORDINATE WORK IMPACTING THE INTERSECTION VEHICULAR AND PEDESTRIAN TRAFFIC.

### GENERAL NOTES

CHANGES MAY BE REQUIRED WHEN PHYSICAL DIMENSIONS IN THE DETAIL DRAWINGS, STANDARD DETAILS, AND ROADWAY DETAILS ARE NOT ATTAINABLE TO MEET FIELD CONDITIONS OR RESULT IN DUPLICATE OR UNDESIRE OVERLAPPING OF DEVICES. MODIFICATION MAY INCLUDE: MOVING, SUPPLEMENTING, COVERING, OR REMOVAL OF DEVICES AS DIRECTED BY THE ENGINEER.

THE FOLLOWING GENERAL NOTES APPLY AT ALL TIMES FOR THE DURATION OF THE CONSTRUCTION PROJECT EXCEPT WHEN OTHERWISE NOTED IN THE PLAN OR DIRECTED BY THE ENGINEER.

### TIME RESTRICTIONS

A) DO NOT CLOSE OR NARROW TRAVEL LANES AS FOLLOWS:

ROAD NAME	DAY AND TIME RESTRICTIONS
POTTER ROAD PLEASANT PLAINS ROAD KERRY GREENS DRIVE	6:00 AM TO 8:00 PM MONDAY THRU FRIDAY

B) DO NOT CLOSE OR NARROW TRAVEL LANES DURING HOLIDAYS AND SPECIAL EVENTS AS FOLLOWS:

ROAD NAME
POTTER ROAD PLEASANT PLAINS ROAD KERRY GREENS DRIVE

#### HOLIDAY

- FOR ANY UNEXPECTED OCCURRENCE THAT CREATES UNUSUALLY HIGH TRAFFIC VOLUMES, AS DIRECTED BY THE ENGINEER.
- FOR NEW YEAR'S, BETWEEN THE HOURS OF 6:00 A.M. DECEMBER 31st TO 8:00 P.M. JANUARY 2ND. IF NEW YEAR'S DAY IS ON A FRIDAY, SATURDAY, SUNDAY, OR MONDAY THEN UNTIL 8:00 P.M. THE FOLLOWING TUESDAY.
- FOR EASTER, BETWEEN THE HOURS OF 6:00 A.M. THURSDAY AND 8:00 P.M. MONDAY.
- FOR MEMORIAL DAY, BETWEEN THE HOURS OF 6:00 A.M. FRIDAY TO 8:00 P.M. TUESDAY.
- FOR INDEPENDENCE DAY, BETWEEN THE HOURS OF 6:00 A.M. THE DAY BEFORE INDEPENDENCE DAY AND 8:00 P.M. THE DAY AFTER INDEPENDENCE DAY.

IF INDEPENDENCE DAY IS ON A FRIDAY, SATURDAY, SUNDAY OR MONDAY, THEN BETWEEN THE HOURS OF 6:00 A.M. THE THURSDAY BEFORE INDEPENDENCE DAY AND 8:00 P.M. THE DAY AFTER INDEPENDENCE DAY.

- FOR LABOR DAY, BETWEEN THE HOURS OF 6:00 A.M. FRIDAY AND 8:00 P.M. TUESDAY.

### TIME RESTRICTIONS (CONT.)

- FOR THANKSGIVING DAY, BETWEEN THE HOURS OF 6:00 A.M. TUESDAY TO 8:00 P.M. MONDAY.
- FOR CHRISTMAS, BETWEEN THE HOURS OF 6:00 A.M. THE FRIDAY BEFORE THE WEEK OF CHRISTMAS DAY AND 8:00 P.M. THE FOLLOWING TUESDAY AFTER THE WEEK OF CHRISTMAS.

C) DO NOT CLOSE ROADS AS FOLLOWS:

ROAD NAME	DAY AND TIME RESTRICTIONS
POTTER ROAD PLEASANT PLAINS ROAD KERRY GREENS DRIVE	ANYTIME UNLESS OTHERWISE DIRECTED BY THE ENGINEER

D) DO NOT STOP TRAFFIC AS FOLLOWS, OR AS OTHERWISE DIRECTED BY THE ENGINEER:

ROAD NAME	DAY AND TIME RESTRICTIONS	DURATION AND OPERATION
POTTER ROAD PLEASANT PLAINS ROAD KERRY GREENS DRIVE	6:00 AM TO 8:00 PM MONDAY THRU FRIDAY	20 MINUTES FOR TRAFFIC SHIFTS, PAVEMENT TIE-INS, AND PAVEMENT MARKING TIE-INS.

E) DO NOT CONDUCT ANY HAULING OPERATIONS AGAINST THE FLOW OF TRAFFIC OF AN OPEN TRAVELWAY UNLESS THE HAULING OPERATION IS PROTECTED BY BARRIER OR GUARDRAIL OR AS DIRECTED BY THE ENGINEER.

### LANE AND SHOULDER CLOSURE REQUIREMENTS

- REMOVE LANE CLOSURE DEVICES FROM THE LANE WHEN WORK IS NOT BEING PERFORMED BEHIND THE LANE CLOSURE OR WHEN A LANE CLOSURE IS NO LONGER NEEDED OR AS DIRECTED BY THE ENGINEER.
- WHEN PERSONNEL AND/OR EQUIPMENT ARE WORKING WITHIN 15 FT OF AN OPEN TRAVEL LANE, CLOSE THE NEAREST OPEN SHOULDER USING ROADWAY STANDARD DRAWING NO. 1101.04 UNLESS THE WORK AREA IS PROTECTED BY BARRIER OR GUARDRAIL OR A LANE CLOSURE IS INSTALLED.
- WHEN PERSONNEL AND/OR EQUIPMENT ARE WORKING ON THE SHOULDER ADJACENT TO AN UNDIVIDED FACILITY AND WITHIN 5 FT OF AN OPEN TRAVEL LANE, CLOSE THE NEAREST OPEN TRAVEL LANE USING ROADWAY STANDARD DRAWING NO. 1101.02 UNLESS THE WORK AREA IS PROTECTED BY BARRIER OR GUARDRAIL.

WHEN PERSONNEL AND/OR EQUIPMENT ARE WORKING ON THE SHOULDER ADJACENT TO A DIVIDED FACILITY AND WITHIN 10 FT OF AN OPEN TRAVEL LANE, CLOSE THE NEAREST OPEN TRAVEL LANE USING ROADWAY STANDARD DRAWING NO. 1101.02 UNLESS THE WORK AREA IS PROTECTED BY BARRIER OR GUARDRAIL.

- DO NOT WORK SIMULTANEOUSLY WITHIN 15 FT ON BOTH SIDES OF AN OPEN TRAVELWAY, RAMP, OR LOOP WITHIN THE SAME LOCATION UNLESS PROTECTED WITH GUARDRAIL OR BARRIER.

### PAVEMENT EDGE DROP OFF REQUIREMENTS

J) BACKFILL AT A 6:1 SLOPE UP TO THE EDGE AND ELEVATION OF EXISTING PAVEMENT IN AREAS ADJACENT TO AN OPENED TRAVEL LANE THAT HAS AN EDGE OF PAVEMENT DROP-OFF AS FOLLOWS:

BACKFILL DROP-OFFS THAT EXCEED 2 INCHES ON ROADWAYS WITH POSTED SPEED LIMITS OF 45 MPH OR GREATER.

BACKFILL DROP-OFFS THAT EXCEED 3 INCHES ON ROADWAYS WITH POSTED SPEED LIMITS LESS THAN 45 MPH.



BACKFILL WITH SUITABLE COMPACTED MATERIAL, AS APPROVED BY THE ENGINEER, AT NO EXPENSE TO THE DEPARTMENT.

K) DO NOT EXCEED A DIFFERENCE OF 2 INCHES IN ELEVATION BETWEEN OPEN LANES OF TRAFFIC FOR NOMINAL LIFTS OF 1.5 INCHES. INSTALL ADVANCE WARNING "UNEVEN LANES" SIGNS (W8-11) 500 FT IN ADVANCE AND A MINIMUM OF EVERY HALF MILE THROUGHOUT THE UNEVEN AREA.

### TRAFFIC PATTERN ALTERATIONS

L) NOTIFY THE ENGINEER THIRTY (30) CALENDAR DAYS PRIOR TO ANY TRAFFIC PATTERN ALTERATION.

K:\CHL\_PR\01036720 - U-5112 (P3) Intersection\Traffic\Control\CP\Sheets\U-5112\_rdy\_imp\_1Adgn 1/30/2024

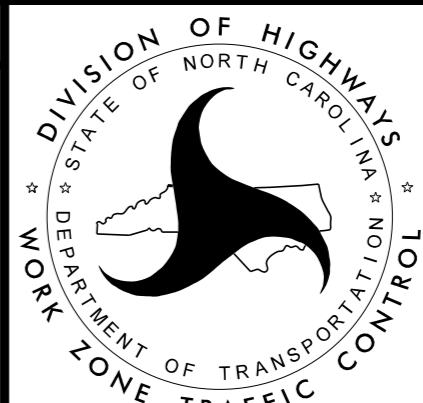
APPROVED:  DATE: 1/31/2024 SEAL 		<h2 style="margin: 0;">TRANSPORTATION MANAGEMENT PLAN</h2>
--	---	--



## GENERAL NOTES (CONT.)

### SIGNING

- M) INSTALL ADVANCE WORK ZONE WARNING SIGNS WHEN WORK IS WITHIN 40 FT FROM THE EDGE OF TRAVEL LANE AND NO MORE THAN THREE (3) DAYS PRIOR TO THE BEGINNING OF CONSTRUCTION.
- N) PROVIDE SIGNING AND DEVICES REQUIRED TO CLOSE THE ROAD ACCORDING TO THE ROADWAY STANDARD DRAWINGS AND TRAFFIC CONTROL PLANS.
- O) COVER OR REMOVE ALL SIGNS AND DEVICES REQUIRED TO CLOSE THE ROAD WHEN ROAD CLOSURE IS NOT IN OPERATION.
- P) ENSURE ALL NECESSARY SIGNING IS IN PLACE PRIOR TO ALTERING ANY TRAFFIC PATTERN.
- Q) INSTALL BLACK ON ORANGE "DIP" SIGNS (W8-2) AND/OR "BUMP" SIGNS (W8-1) 500 FT IN ADVANCE OF THE UNEVEN AREA, OR AS DIRECTED BY THE ENGINEER.

### TRAFFIC CONTROL DEVICES

- R) WHEN LANE CLOSURES ARE NOT IN EFFECT SPACE CHANNELIZING DEVICES IN WORK AREAS NO GREATER IN FEET THAN TWICE THE POSTED SPEED LIMIT (MPH) EXCEPT, 10 FT ON-CENTER IN RADII, AND 3 FT OFF THE EDGE OF AN OPEN TRAVELWAY. REFER TO STANDARD SPECIFICATIONS FOR ROADS AND STRUCTURES SECTIONS 1130 (DRUMS), 1135 (CONES) AND 1180 (SKINNY DRUMS) FOR ADDITIONAL REQUIREMENTS.
- S) PLACE TYPE III BARRICADES, WITH "ROAD CLOSED" SIGN R11-2 ATTACHED, OF SUFFICIENT LENGTH TO CLOSE ENTIRE ROADWAY.
- T) PLACE ADDITIONAL SETS OF THREE CHANNELIZING DEVICES DRUMS PERPENDICULAR TO THE EDGE OF TRAVELWAY ON 500 FT CENTERS WHEN UNOPENED LANES ARE CLOSED TO TRAFFIC.

### PAVEMENT MARKINGS AND MARKERS

- U) INSTALL TEMPORARY PAVEMENT MARKINGS AND TEMPORARY PAVEMENT MARKERS ON INTERIM LAYERS OF PAVEMENT AS FOLLOWS:



ROAD NAME	MARKING	MARKER
ALL ROADS	PAINT	NONE

- V) PLACE ONE APPLICATION OF PAINT FOR TEMPORARY TRAFFIC PATTERNS. PLACE A SECOND APPLICATION OF PAINT SIX (6) MONTHS AFTER THE INITIAL APPLICATION AND EVERY SIX MONTHS AS DIRECTED BY THE ENGINEER.
- W) TIE PROPOSED PAVEMENT MARKING LINES TO EXISTING PAVEMENT MARKING LINES.
- X) REMOVE/REPLACE ANY CONFLICTING/DAMAGED PAVEMENT MARKINGS AND MARKERS BY THE END OF EACH DAY'S OPERATION.
- Y) TRACE THE PROPOSED MONOLITHIC ISLAND AND PEDESTRIAN REFUGE ISLAND LOCATIONS WITH PROPER COLOR PAVEMENT MARKINGS PRIOR TO REMOVAL AND INSTALLATION. PLACE DRUMS TO DELINEATE ANY EXISTING AND PROPOSED MONOLITHIC ISLANDS AFTER REMOVAL AND BEFORE INSTALLATION

### MISCELLANEOUS

- Z) LAW ENFORCEMENT MAY BE USED TO MAINTAIN TRAFFIC THROUGH THE WORK AREA AND/OR INTERSECTIONS AS DIRECTED BY THE ENGINEER.
- AA) IN THE EVENT A TIE-IN CANNOT BE MADE IN ONE DAY'S TIME, BRING THE TIE-IN AREA TO AN APPROPRIATE ROADWAY ELEVATION AS DETERMINED BY THE ENGINEER. PLACE BLACK ON ORANGE "LOOSE GRAVEL" SIGNS (W8-7) AND BLACK ON ORANGE "PAVEMENT ENDS" SIGNS (W8-3) AND RESPECTIVELY IN ADVANCE OF THE UNEVEN AREAS. USE DRUMS TO DELINEATE THE EDGE OF ROADWAY ALONG UNPAVED AREAS.
- AB) CONTRACTOR SHALL MAINTAIN SIDEWALK ACCESS AT ALL TIMES AS STATED IN THE PHASING CONTRACTOR SHALL BE RESPONSIBLE TO PROVIDE TEMPORARY SIDEWALKS (CONCRETE, ASPHALT, OR OTHER SUITABLE MATERIAL AS APPROVED BE THE ENGINEER) AT ALL LOCATIONS WHERE THE OPEN PEDESTRIAN TRAVELWAY HAS BEEN REMOVED FOR CONSTRUCTION OPERATIONS (UTILITIES, DRAINAGE, ETC.)
- AC) CONTRACTOR SHALL ACCOMMODATE PEDESTRIAN TRAFFIC ACCORDING TO ADA COMPLIANCE.

K:\CHL\_PR\01036720 - U-5112 (P3) Intersections\Traffic\TrafficControl\TCP\Sheets\U-5112\_rdy\_imp\_1Adgn 1/30/2024

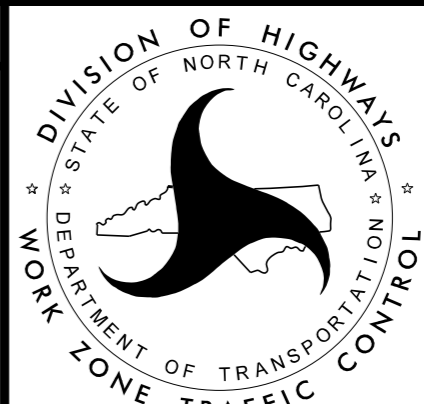
APPROVED:  DATE: 1/31/2024 SEAL 		<h2 style="margin: 0;">TRANSPORTATION MANAGEMENT PLAN</h2>
--	---	--



PRIOR TO BEGINNING ANY CONSTRUCTION THE CONTRACTOR SHALL INSTALL WORK ZONE ADVANCE WARNING SIGNS AS SHOWN IN THE NCDOT ROADWAY STANDARD DRAWING NO. 1101.01

PROPOSED IMPROVEMENTS ALONG -L- POTTER ROAD AND, -Y1- PLEASANT PLAINS ROAD WILL AND -Y3- KERRY GREENS DR. BE CONSTRUCTED AT NIGHT WITH USING TEMPORARY LANE AND ROAD CLOSURES.

CONTRACTOR TO COVER OPEN CUTS WITH STEEL PLATES AND RETURN TRAFFIC TO EXISTING PATTERN OUTSIDE OF WORKING HOURS.

### PHASE I

**STEP 1:**

- AWAY FROM TRAFFIC, AND USING LANE CLOSURES AS NECESSARY, WHILE MAINTAINING EXISTING TRAFFIC PATTERNS AND ACCESS TO ALL PROPERTIES, CONSTRUCT THE FOLLOWING FROM STA. -L- 10+50.00 TO STA. -L- 25+45.00, STA. -Y1- 11+47.00 TO STA. -Y1- 27+98.51 AND -Y3- KERRY GREENS DR. STA 10+00 TO STA. 12+50:
- CONSTRUCT JACK & BORE ACROSS STA. 12+50 TO TO MANHOLE STA. 10+00 KERRY GREEN DR. SEE UC PLAN THIS SET.
- INSTALL TEMPORARY SIGNAL AT THE INTERSECTION OF -L- POTTER AND -Y1- PLEASANT PLAINS ROAD. SEE SIGNAL PLANS FOR LOCATION AND DETAILS ON TEMPORARY SIGNAL.
- INSTALL TEMPORARY PAVEMENT MARKINGS AND SHIFT TRAFFIC ONTO TEMPORARY PATTERN - ACTIVATE TEMPORARY SIGNAL.
- INSTALL AND COVER DETOUR AND CLOSURE SIGNS AS SHOWN ON SHEET TMP-2A.
- CONTRACTOR SHALL COMPLETE WORK IN PHASE 1, STREP 2.1 IN 30 CONSECUTIVE CALENDAR DAYS. SEE INTERMEDIATE CONTRACT TIMES AND LIQUIDATED DAMAGES.

**STEP 2:**

- WHILE MAINTAINING EXISTING TRAFFIC ON POTTER ROAD AND DRIVEWAYS, USING NCDOT ROADWAY STANDARD DRAWING NO. 1101.02 FOR TEMPORARY LANE CLOSURES AND PROVIDING WEDGING AS NECESSARY TO ENSURE POSITIVE DRAINAGE AND SMOOTH TRANSITIONS FROM NEW TO EXISTING PAVEMENT, CONSTRUCT PROPOSED IMPROVEMENTS ALONG THE FOLLOWING AS SHOWN ON SHEETS TMP-3 AND TMP-4, UP TO, BUT NOT INCLUDING FINAL LIFT. PHASE THE CONSTRUCTION OF THE INTERSECTION AS FOLLOWS:

COMPLETE STEP 2.1 PRIOR TO PROCEEDING TO STEP 2.2

UNCOVER DETOUR SIGNS, CLOSE PLEASANT PLAINS RD. -Y1- STA. 22+50 - STA. 28+00 AND:

- 2.1 CONSTRUCT -L- POTTER ROAD STA.10+00 TO STA. 18+00 (RT), -Y1- PLEASANT PLAINS ROAD STA. 22+50.00 TO -Y1- STA. 28+00.00. INCLUDING SOUTHEAST QUADRANT OF POTTER AND PLEASANT PLAINS ROAD. SEE INSET SHEET TMP-4 FOR PEDESTRIAN DETOUR 1, FOR MAINTAINING PEDESTRIAN ACCESS. APPLY TEMPORARY PAINT MARKINGS. REMOVE DETOUR, AND OPEN TO TRAFFIC.
- 2.2 -L- POTTER ROAD STA 18+30 TO 22+65 (RIGHT SIDE), INCLUDING NORTHEAST QUADRANT OF POTTER AND PLEASANT PLAINS ROAD. SEE INSET 2, SHEET TMP 4 FOR MAINTAINING PEDESTRIAN ACCESS.

COMPLETE STEP 2.2 PRIOR TO PROCEEDING TO STEP 2.3

- 2.3 -Y1- DRAINAGE FROM OUTFALL AT -Y1- STA 18+45 PLEASANT PLAINS ROAD. OUTFALL 811 TO CB 506. BRICK UP STORM TO PREVENT CONVEYANCE ON PLEASANT PLAINS ROAD.

COMPLETE STEP 2.3 PRIOR TO PROCEEDING TO STEP 2.4

- 2.4 CONSTRUCT SOUTHWEST QUADRANT OF INTERSECTION OF POTTER AND PLEASANT PLAINS ROAD, AND -Y1- PLEASANT PLAINS ROAD (RIGHT SIDE) STA. 11+47 TO STA. 22+00 (INTERSECTION). USE INSET 3 FOR MAINTAINING EXISTING PEDESTRIAN ACCESS, SHEET TMP-4.

AND ALL ASSOCIATE DRAINAGE SHOWN ON TMP-3 AND TMP-4

PROVIDE WEDGING ALONG THE FOLLOWING AS REQUIRED TO ACCOMODATE FOR POSITIVE DRAINAGE AND SMOOTH TRANSITIONS BETWEEN EXISTING AND PROPOSED GRADES:

- L- POTTER ROAD STA. 10+50 TO 22+65 (RT)
- Y1- PLEASANT PLAINS ROAD STA. 11+47 TO 22+00 (RT) (INTERSECTION)

PROVIDE TEMPORARY PAVEMENT ALONG THE FOLLOWING:

- L- STA. 19+97 TO STA. 21+60.

-L- POTTER ROAD (IN AREAS OF THE LANDSCAPED MEDIANS) SEE ROADWAY SHEET 2A-3 FOR DETAIL W1 SHOWING METHOD OF WEDGING.

BRICK UP STORM TO PREVENT CONVEYANCE ON POTTER & PLEASANT PLAINS ROAD UNTIL LATERALS ARE CONSTRUCTED. SEE TMP-3 THRU TMP-4.

### PHASE 2

**STEP 1:**

- REMOVE TEMPORARY MARKINGS FROM PHASE 1 THAT CONFLICT WITH PHASE 2 CONFIGURATION. INSTALL NEW TEMPORARY PAVEMENT MARKINGS AND SHIFT TRAFFIC ONTO NEW PATTERN.
- ADJUST TEMPORARY SIGNAL FROM PHASE 1 FOR PHASE 2 CONFIGURATION.

**STEP 2:**

- CONSTRUCT TEMPORARY PEDESTRIAN CROSSING AND TEMPRARY 4' PEDESTRIAN PATH -L- STA. 10+65 (RT) TO STA. 17+36 (RT) SHOWN ON TMP-06. CONSTRUCT TEMPORARY PEDESTRIAN PATH @ -Y1- STA 21+36

**STEP 3:**

- WHILE MAINTAINING EXISTING TRAFFIC ON PLEASANT PLAINS ROAD ALL INTERSECTING ROADWAYS AND DRIVEWAYS, USING NCDOT ROADWAY STANDARD DRAWING NO. 1101.02 FOR TEMPORARY LANE CLOSURES AND PROVIDING WEDGING AS NECESSARY TO ENSURE POSITIVE DRAINAGE AND SMOOTH TRANSITIONS FROM NEW TO EXISTING PAVEMENT, CONSTRUCT PROPOSED IMPROVEMENTS , INCLUDING PAVEMENT, UP TO, BUT NOT INCLUDING FINAL LIFT, AND PAVEMENT REMOVAL ALONG THE FOLLOWING AS SHOWN ON SHEETS TMP-5 AND TMP-6. PHASE THE CONSTRUCTION OF THE INTERSECTION AS FOLLOWS:

1. -L- POTTER ROAD STA. 10+50 TO STA. 17+91 (LEFT SIDE, SOUTH OF INTERSECTION)
2. -L- POTTER ROAD STA . 18+88 TO STA. 25+65 (LEFT SIDE, NORTH OF INTERSECTION), INCLUDING NORTHWEST QUADRANT OF POTTER AND PLEASANT PLAINS INTERSECTION.

COMPLETE 1 & 2 PRIOR TO PROCEEDING TO 3

3. -Y1- PLEASANT PLAINS ROAD STA. 10+50 TO 22+07 (WEST OF NTERSECTION). SEE INSET SHEET TMP-5 FOR PEDESTRIAN DETOUR 1, FOR MAINTAINING PEDESTRIAN ACCESS.

AND ALL ASSOCIATE DRAINAGED SHOWN ON TMP-5 AND TMP-6

### PHASE 3

**STEP 1:**

- REMOVE TEMPORAY MARKINGS FROM PHASE 2 THAT CONFLICT WITH PHASE 3 CONFIGURATION. INSTALL NEW TEMPORARY PAVEMENT MARKINGS IN FINAL TRAFFIC CONFIGURATION AND SHIFT TRAFFIC ONTO NEW TRAFFIC PATTERN.
- ADJUST TEMPORARY SIGNAL FROM PHASE 2 FOR PHASE 3 CONFIGURATION.

**STEP 2:**

- WHILE MAINTAINING EXISTING TRAFFIC ON PLEASANT PLAINS ROAD ALL INTERSECTING ROADWAYS AND DRIVEWAYS, USING NCDOT ROADWAY STANDARD DRAWING NO. 1101.02 FOR TEMPORARY LANE CLOSURES AND PROVIDING WEDGING AS NECESSARY TO ENSURE POSITIVE DRAINAGE AND SMOOTH TRANSITIONS FROM NEW TO EXISTING PAVEMENT, CONSTRUCT PROPOSED IMPROVEMENTS ALONG THE FOLLOWING AS SHOWN ON SHEETS TMP-7 AND TMP-8:

- L- POTTER ROAD (MEDIAN) STA. 14+00.00 TO STA. -L- 17+75.00:

### PHASE 3A

**STEP 1:**



- WHILE MAINTAINING EXISTING TRAFFIC ON PLEASANT PLAINS ROAD ALL INTERSECTING ROADWAYS AND DRIVEWAYS, USING NCDOT ROADWAY STANDARD DRAWING NO. 1101.02 FOR TEMPORARY LANE CLOSURES AND PROVIDING WEDGING AS NECESSARY TO ENSURE POSITIVE DRAINAGE AND SMOOTH TRANSITIONS FROM NEW TO EXISTING PAVEMENT, CONSTRUCT PROPOSED IMPROVEMENTS ALONG THE FOLLOWING AS SHOWN ON SHEETS TMP-7 AND TMP-8:

- L- POTTER ROAD (MEDIAN) STA. 18+75.00 TO STA. -L- 23+75.00

**STEP 2:**

- INSTALL FINAL PAVEMENT COURSE AND FINAL PAVEMENT MARKINGS, AND OPEN TO FINAL TRAFFIC.
- REMOVE ALL TRAFFIC CONTROL DEVICES

K:\CHL\PR\01036720 - U-5112 (P3 Intersection)\Traffic\TrafficControl\CP\Sheets\U-5112\_rdy\_imp\_2.dgn 1/30/2024

APPROVED:  DATE: 1/31/2024 SEAL 		<h2>TRANSPORTATION MANAGEMENT PLAN</h2>
--	---	---



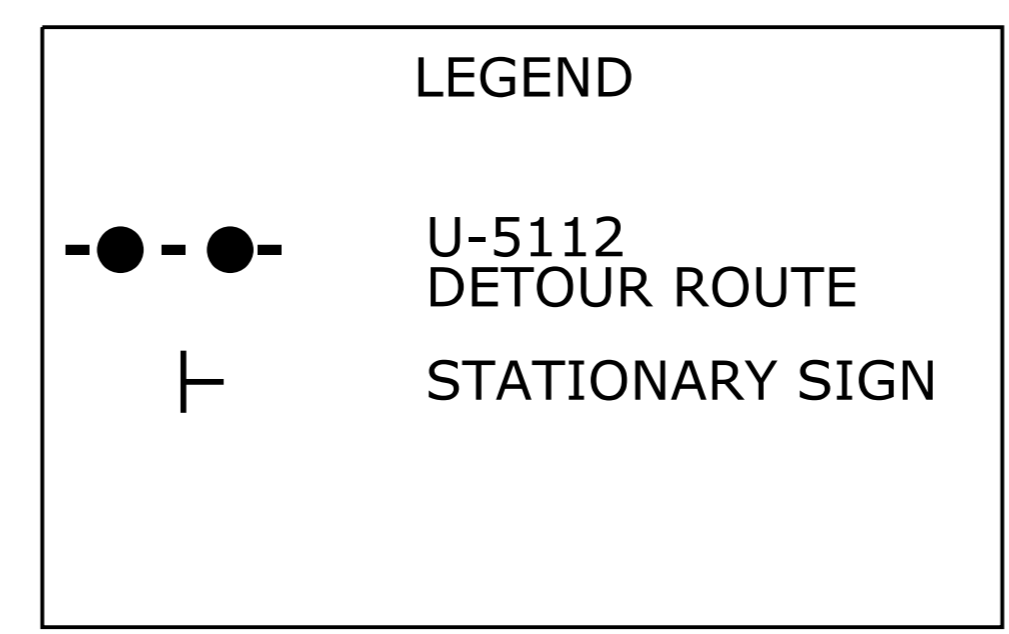
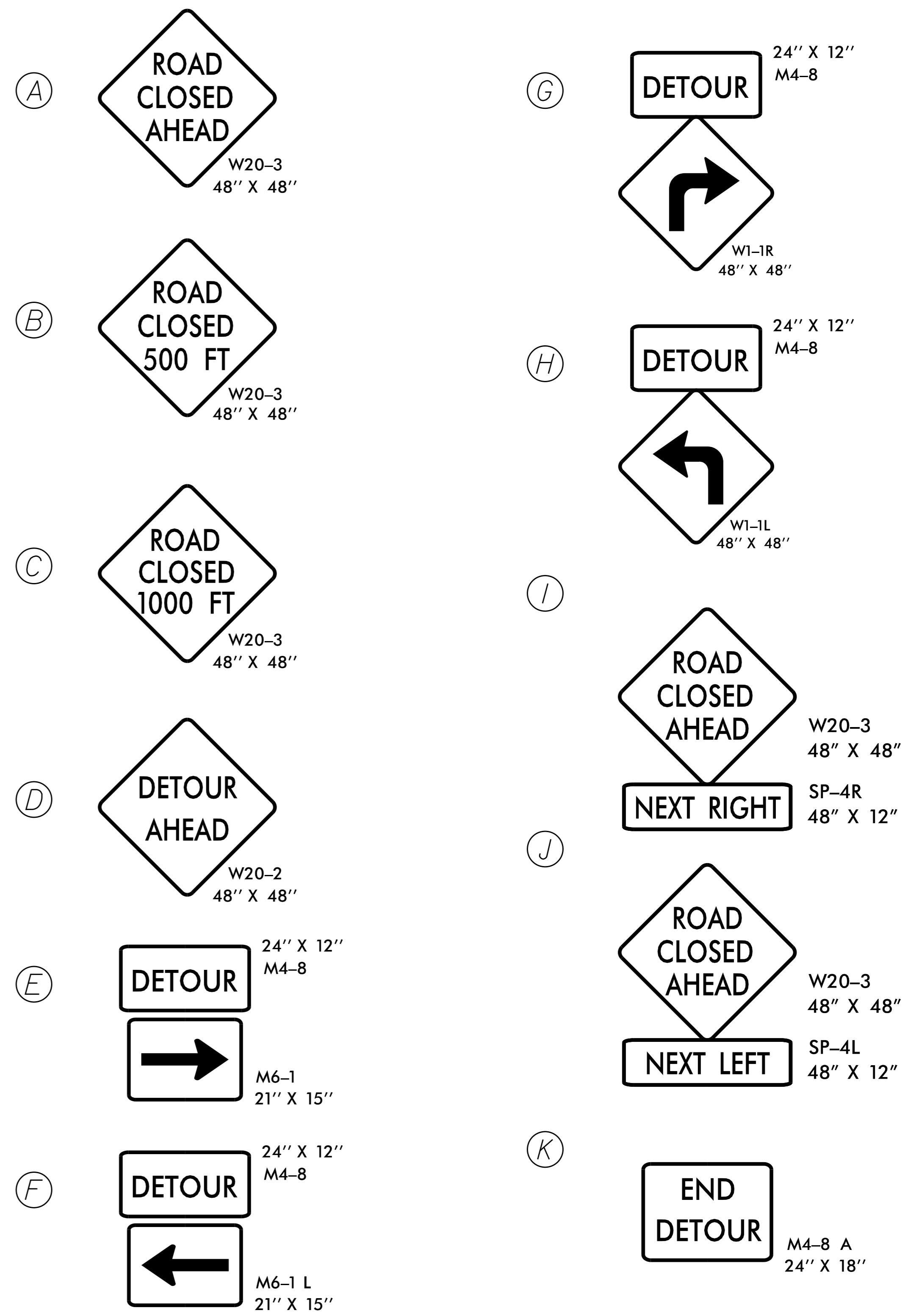
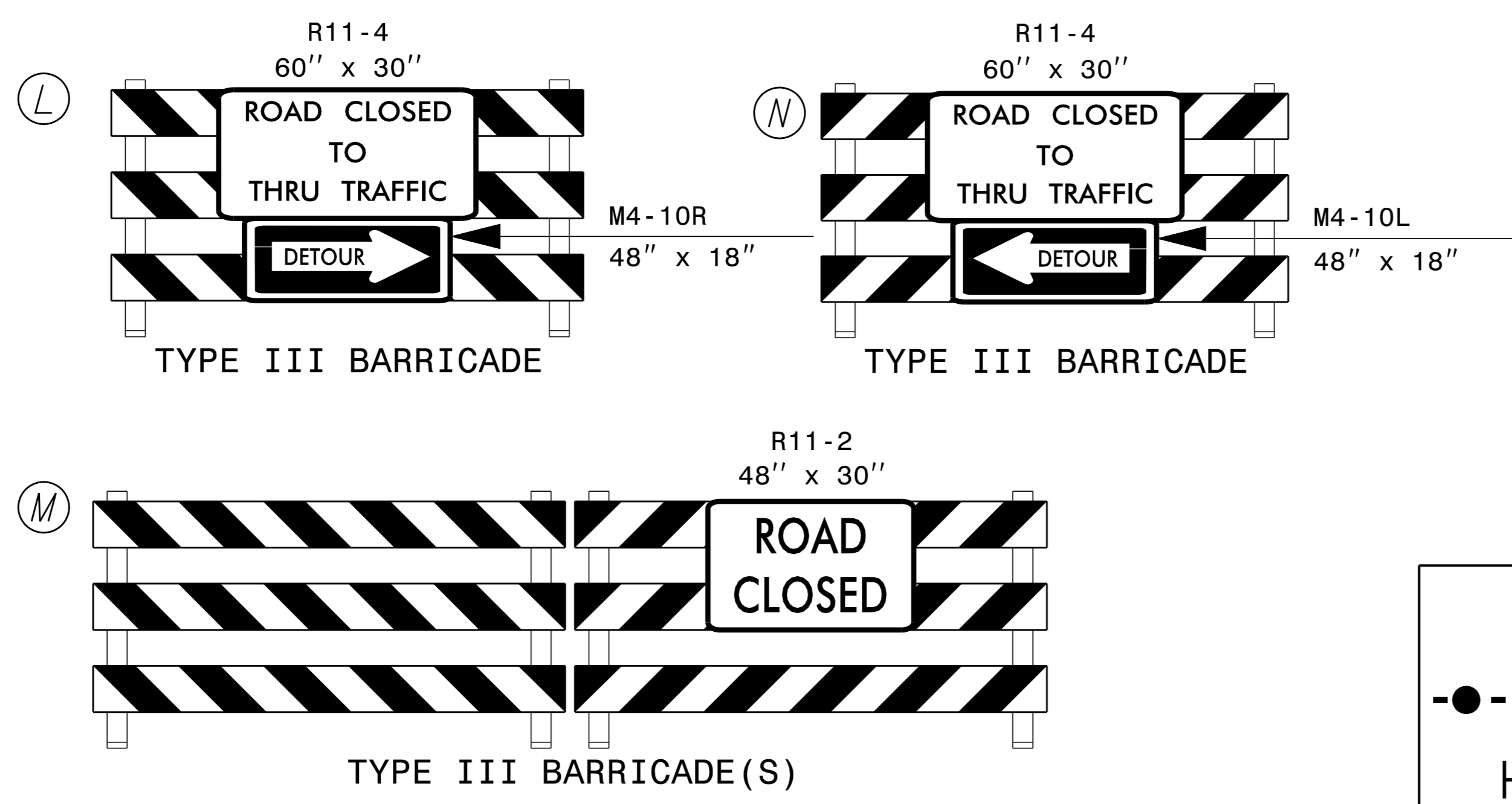
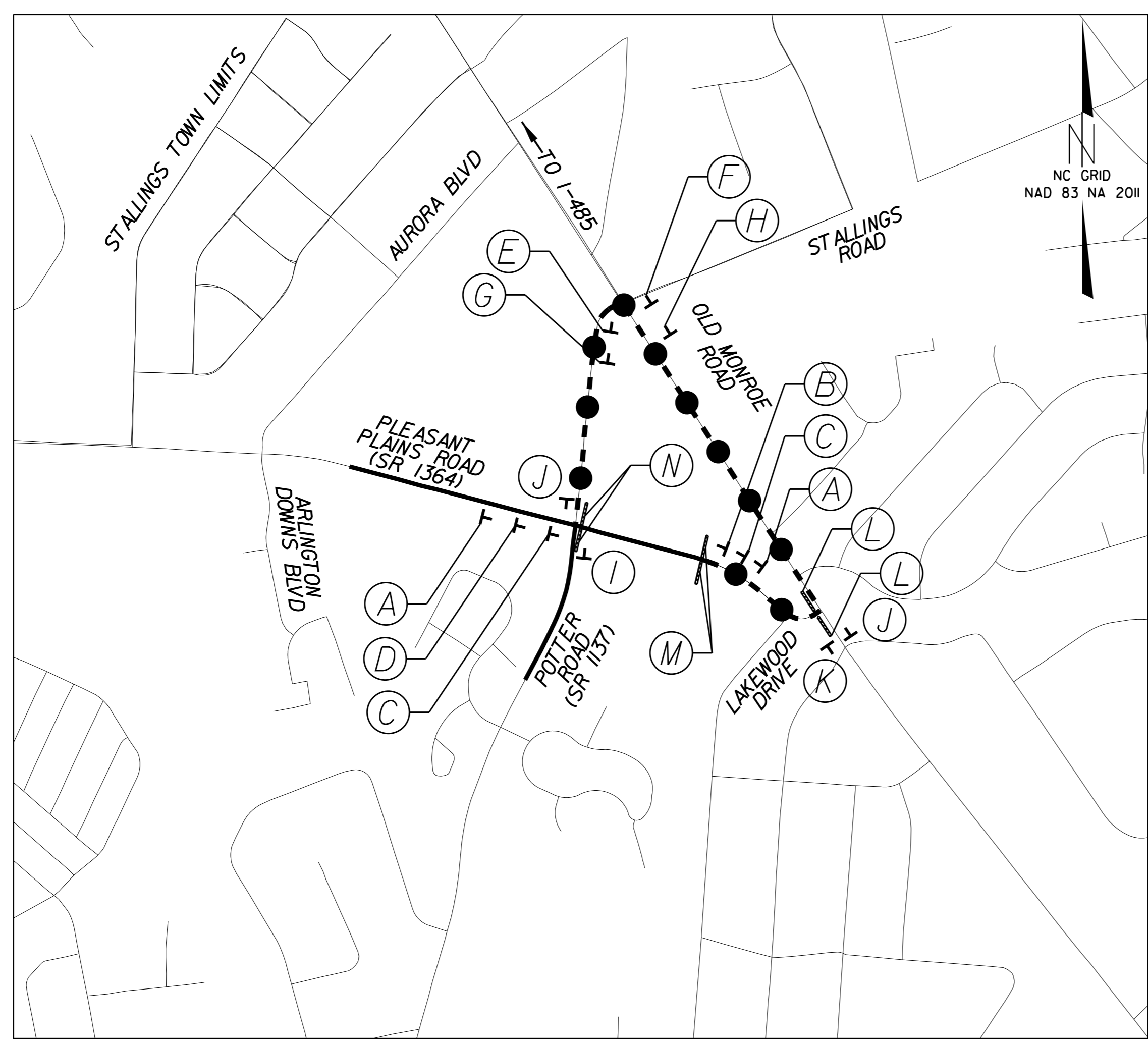

APPROVED: *Frank Masterson* DATE: 1/31/2024

FRANK D. MASTERSON, JR.  
 PROFESSIONAL ENGINEER  
 SEAL 037923  
 NORTH CAROLINA

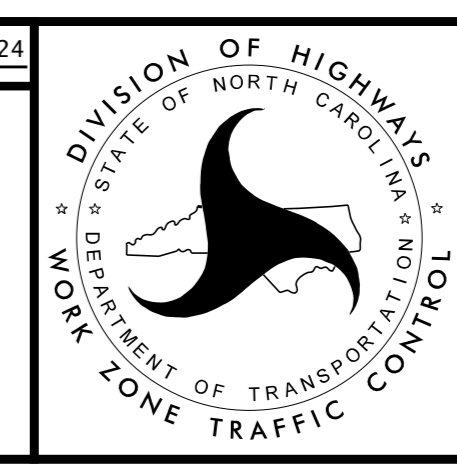

**Kimley»Horn**

DETOUR SHEET  
 PHASE 1

1/30/2024 K:\CHL\PRJ\01036720 - U-5112 (P3) Inter section\TrafficControl\CP\Sheets\U-5112\_rdy\_imp\_detour.dgn

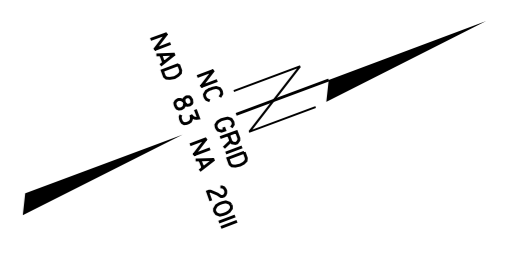

PHASE I

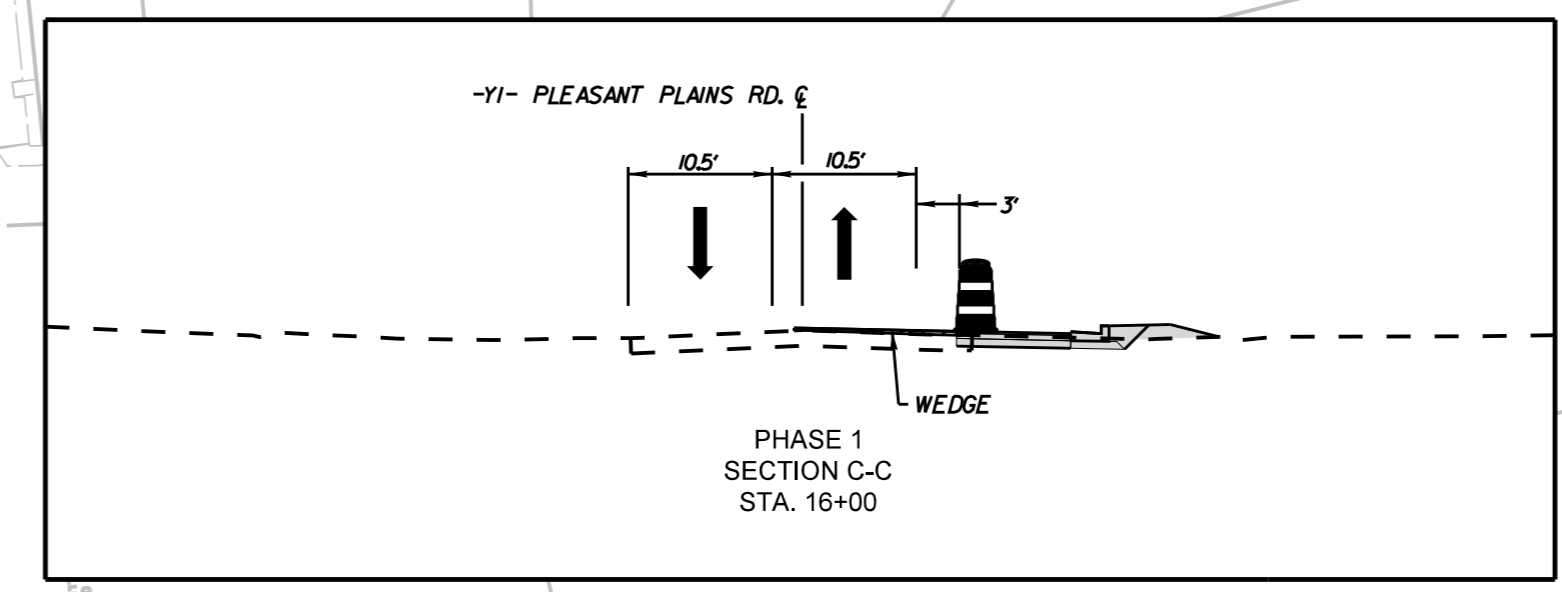
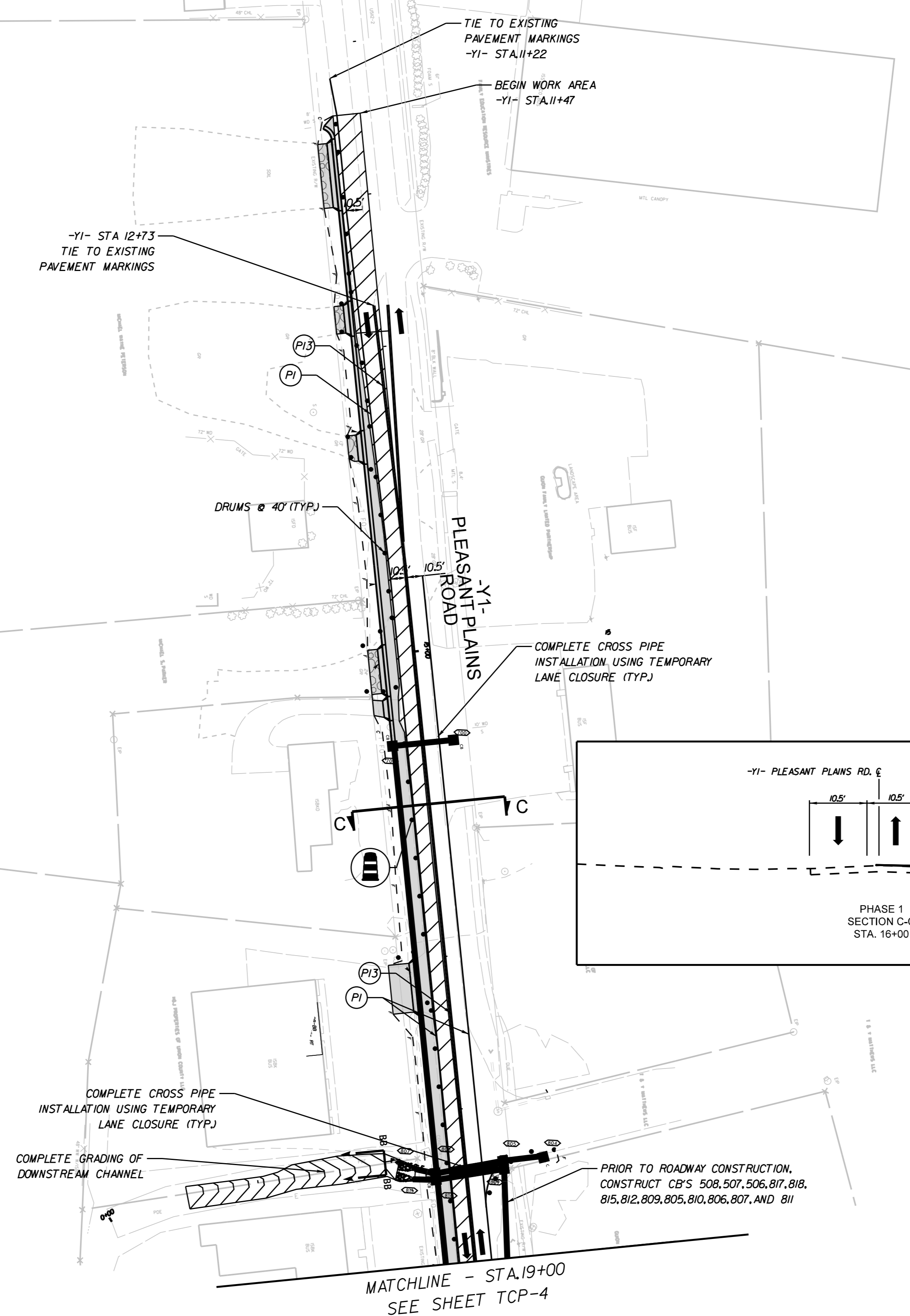

(ENGLISH)

- PAVEMENT REMOVAL
- WEDGING
- WORK AREA

K:\CHL\PRJ\01036720 - U-5112 (P3) Intersection\Traffic\Control\TCP\Sheets\U-5112\_rdy\_imp\_3.dgn 1/30/2024

APPROVED: *Frank D. Masters, Jr.* DATE: 1/31/2024

SEAL

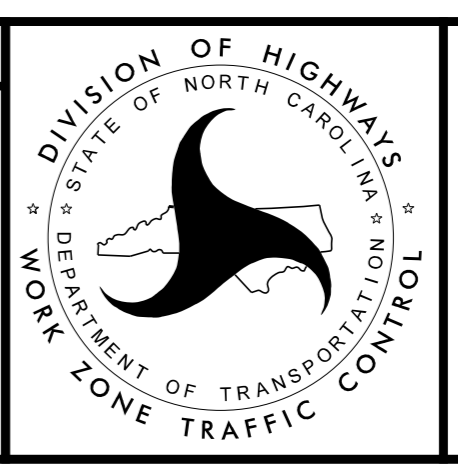

# TRANSPORTATION MANAGEMENT PLAN



PHASE I

MATCHLINE - STA.19+00  
SEE SHEET TCP-3

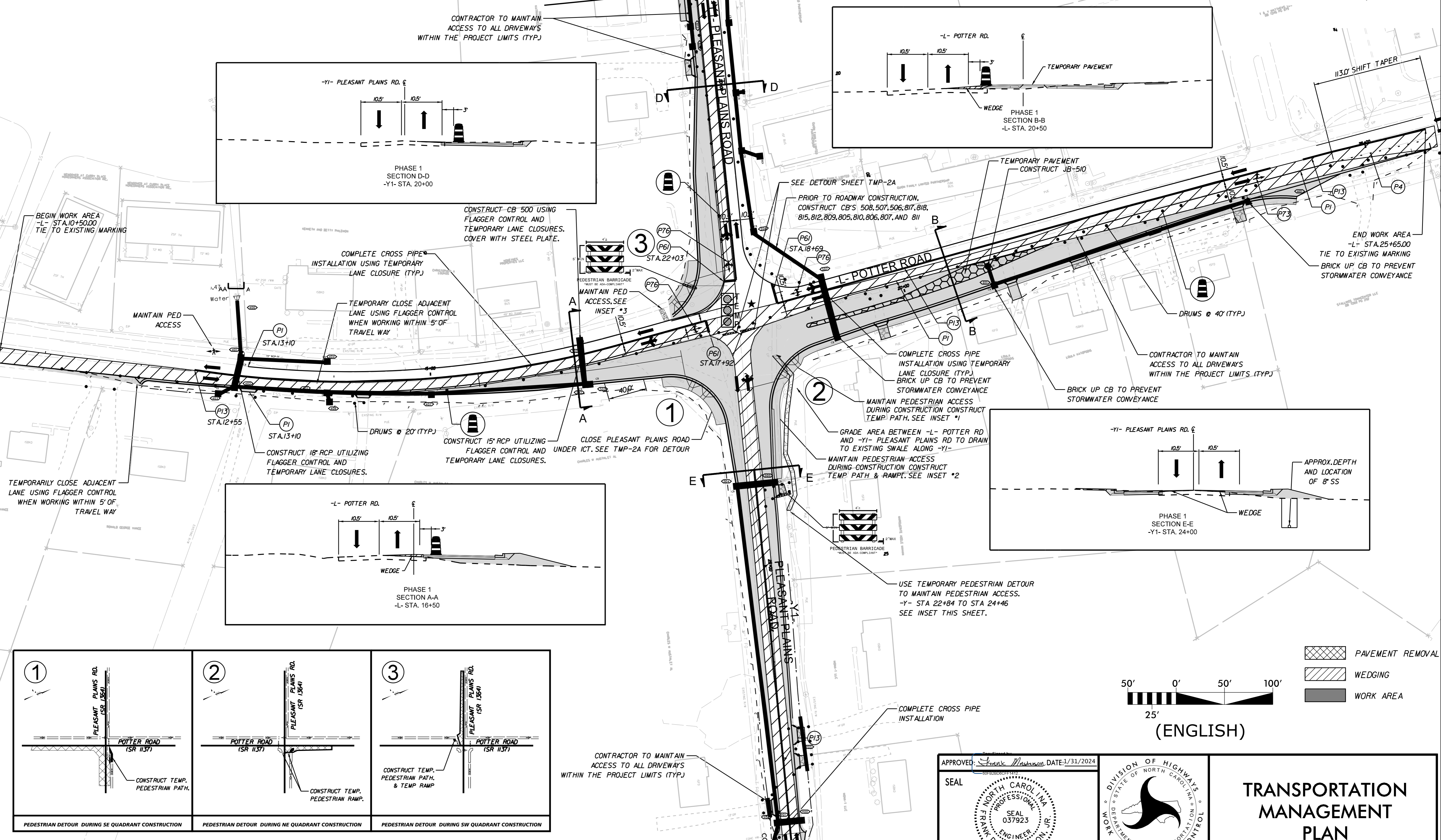
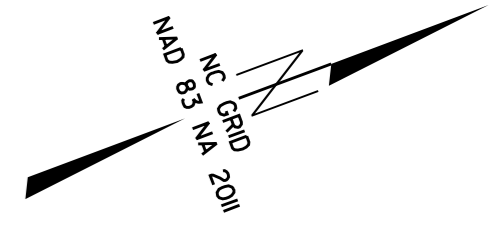

(ENGLISH)

- PAVEMENT REMOVAL
- WEDGING
- WORK AREA

APPROVED: *Frank Masterson*, DATE: 1/31/2024

SEAL

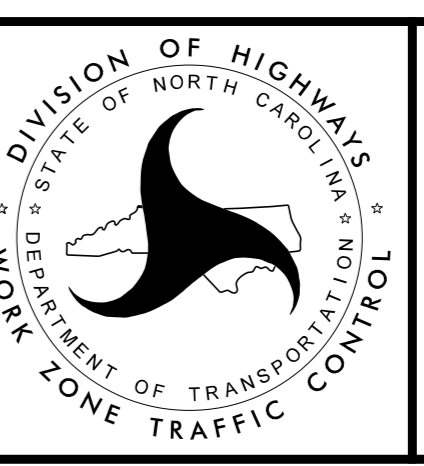

**TRANSPORTATION  
MANAGEMENT  
PLAN**

K:\CHL\_PR\01036720 - U-5112 (P3) Intersection\Traffic\CP\Sheets\U-5112\_rdy\_imp\_4.dgn 1/30/2024

END WORK AREA  
CLOSE PLEASANT PLAINS ROAD  
SEE PHASE I STEP 1



PHASE 2

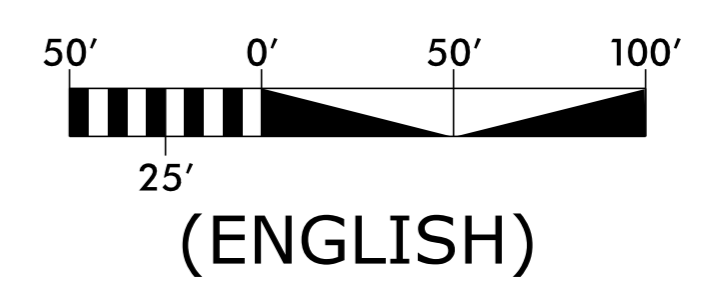
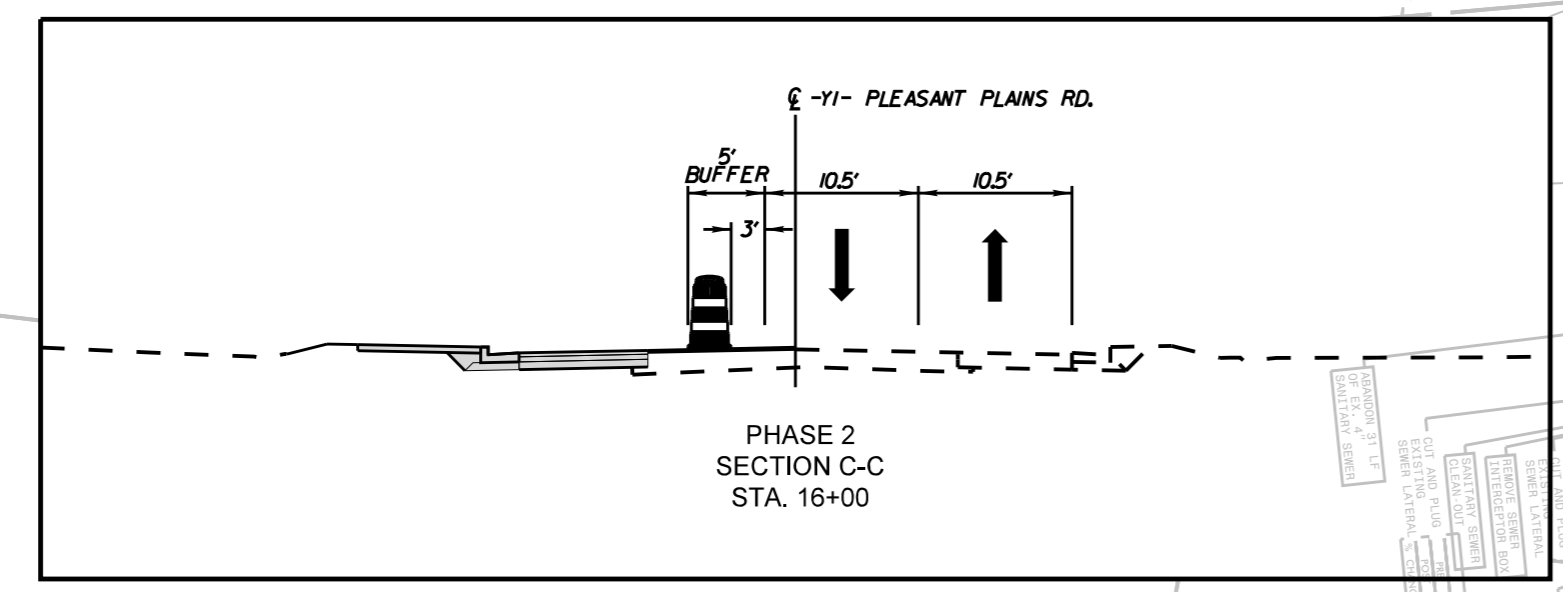
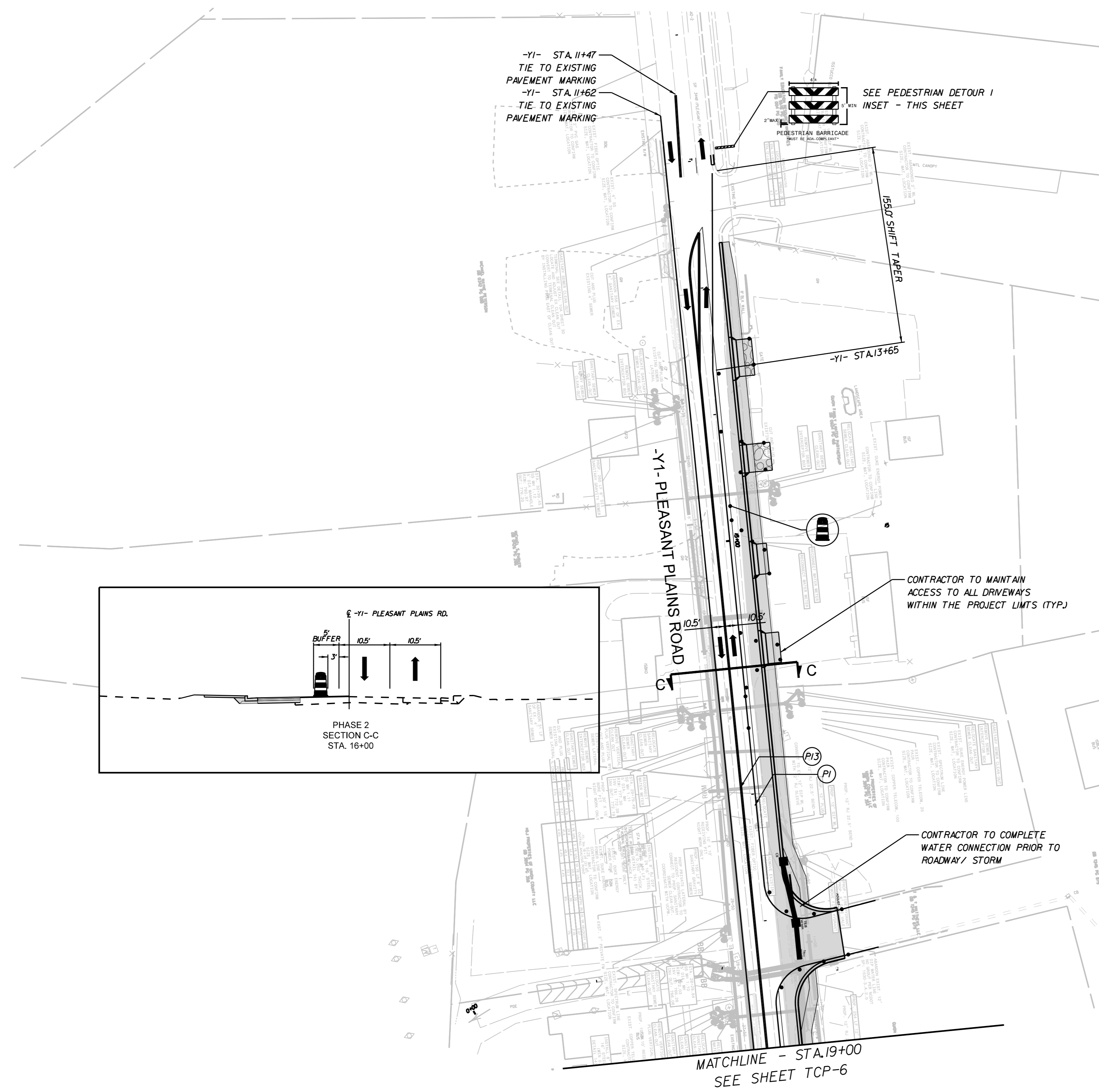
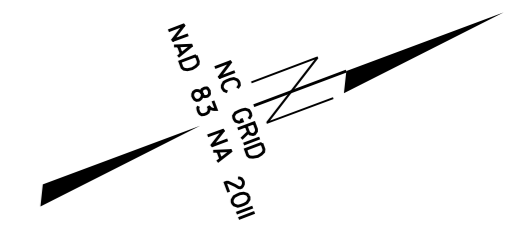

- PAVEMENT REMOVAL
- WEDGING
- WORK AREA

APPROVED: *Frank Masterson* DATE: 1/31/2024

SEAL

**TRANSPORTATION  
MANAGEMENT  
PLAN**

1/30/2024 K:\CHL\_Plan\01036720 - U-5112 (P3) Intersection\Traffic\Control\TCP\Sheets\U-5112\_rdy\_imp\_5.dgn



PHASE 2

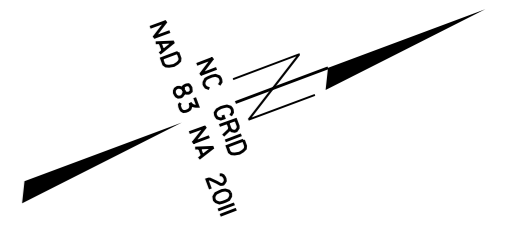

MATCHLINE - STA.19+00  
SEE SHEET TCP-5

CONTRACTOR TO MAINTAIN  
ACCESS TO ALL DRIVEWAYS  
WITHIN THE PROJECT LIMITS (TYP.)

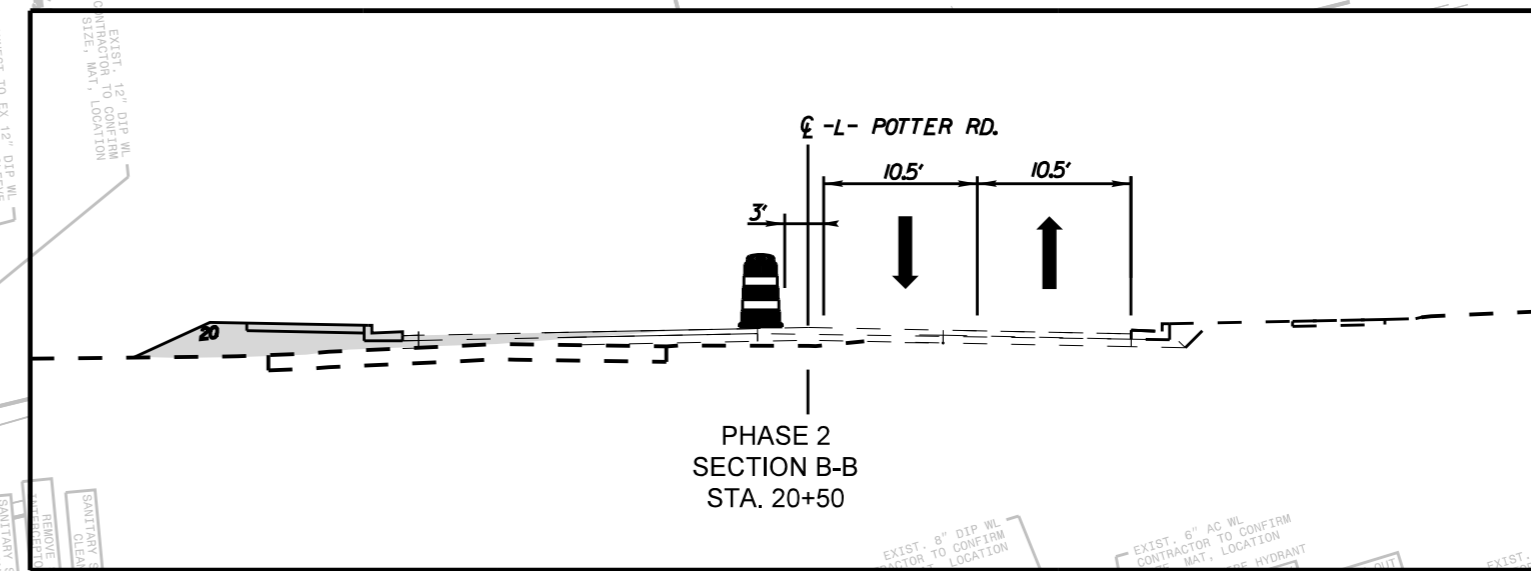

SEE PEDESTRIAN  
DETOUR 2 SHEET  
TMP-1C

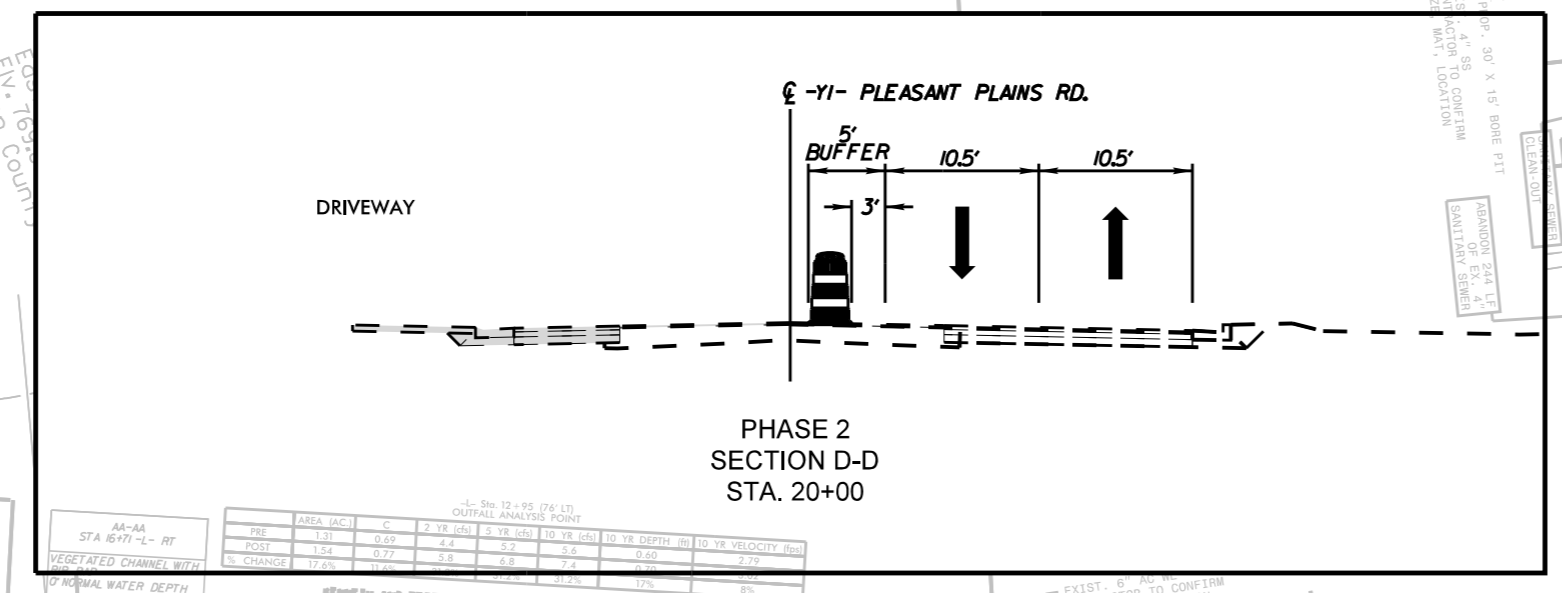

PHASE 2  
SECTION D-D  
STA. 20+00

TEMPORARY RAMP

COMPLETE CROSS PIPE  
INSTALLATION USING TEMPORARY  
LANE CLOSURE (TYP.)  
DRUMS @ 40' (TYP.)

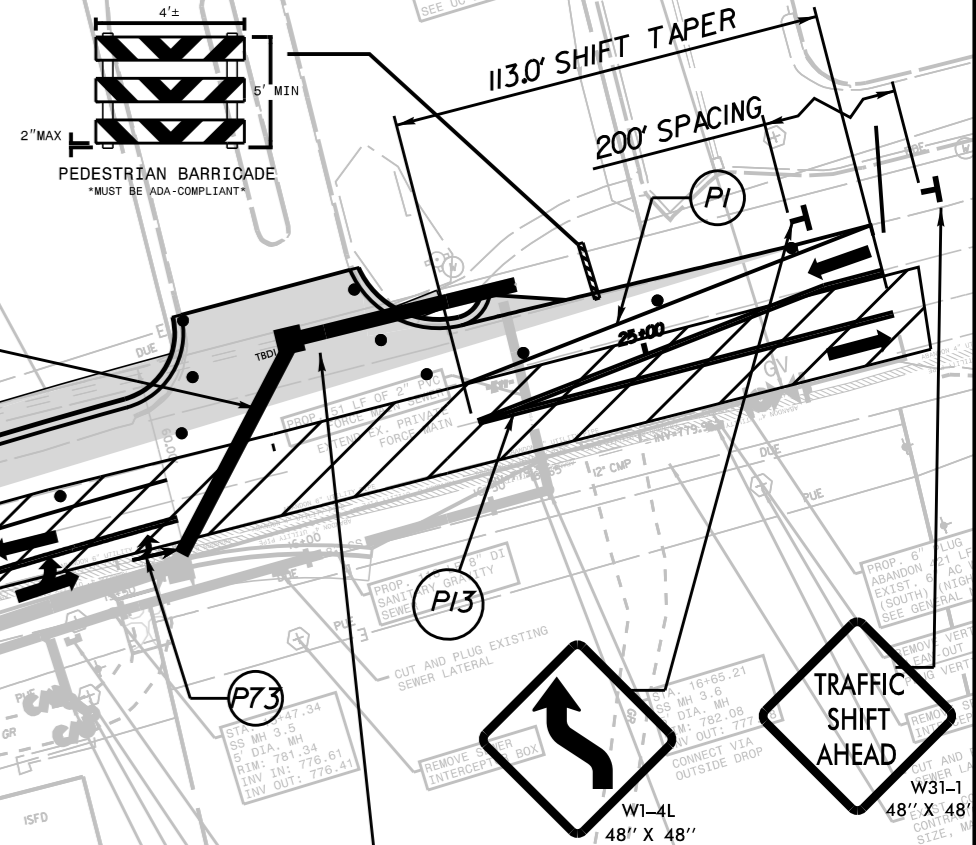

CONTRACTOR TO MAINTAIN  
ACCESS TO ALL DRIVEWAYS  
WITHIN THE PROJECT LIMITS (TYP.)

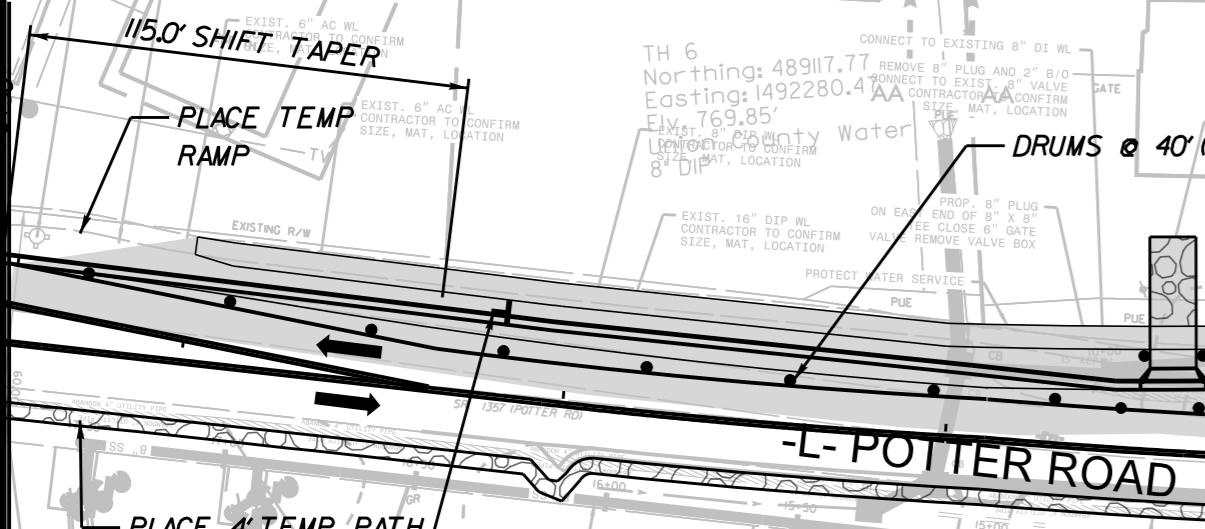

PLACE 4" TEMP PATH  
3" DEPTH OF STONE  
-L- STA 10+67



END TEMP PATH STA.17+36  
CONNECT TO SIDEWALK

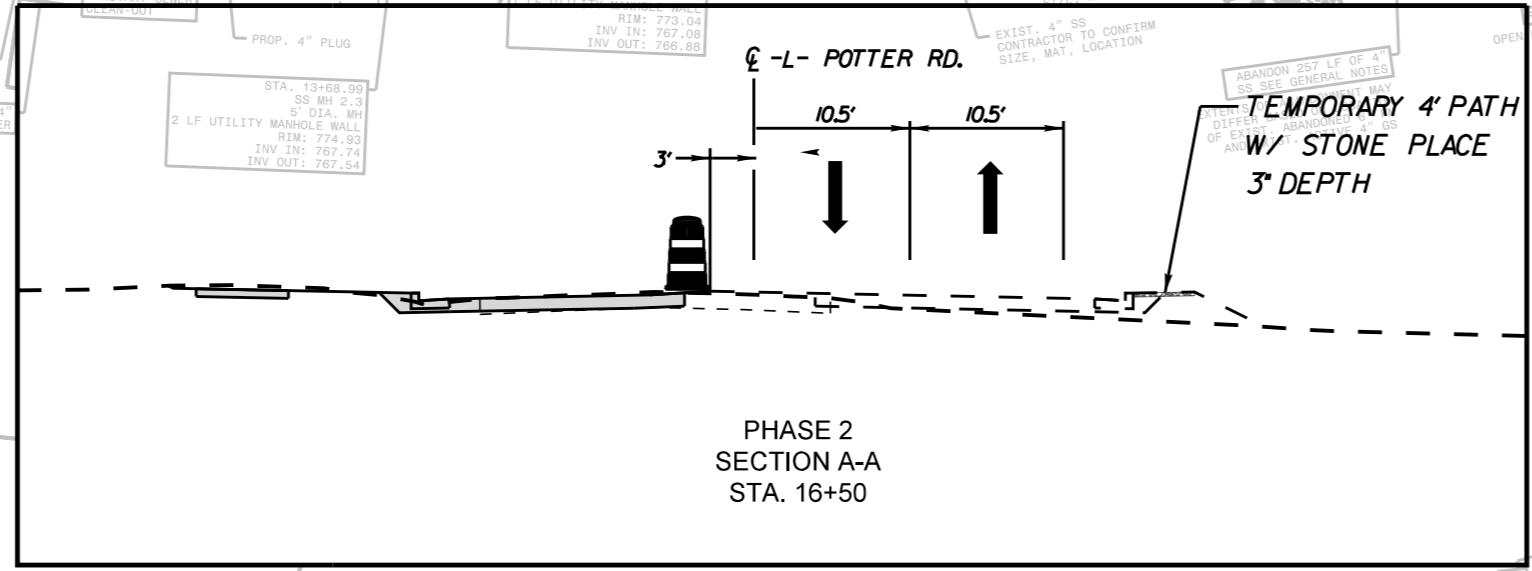

PHASE 2  
SECTION A-A  
STA. 16+50

TEMPORARY 4\"/>

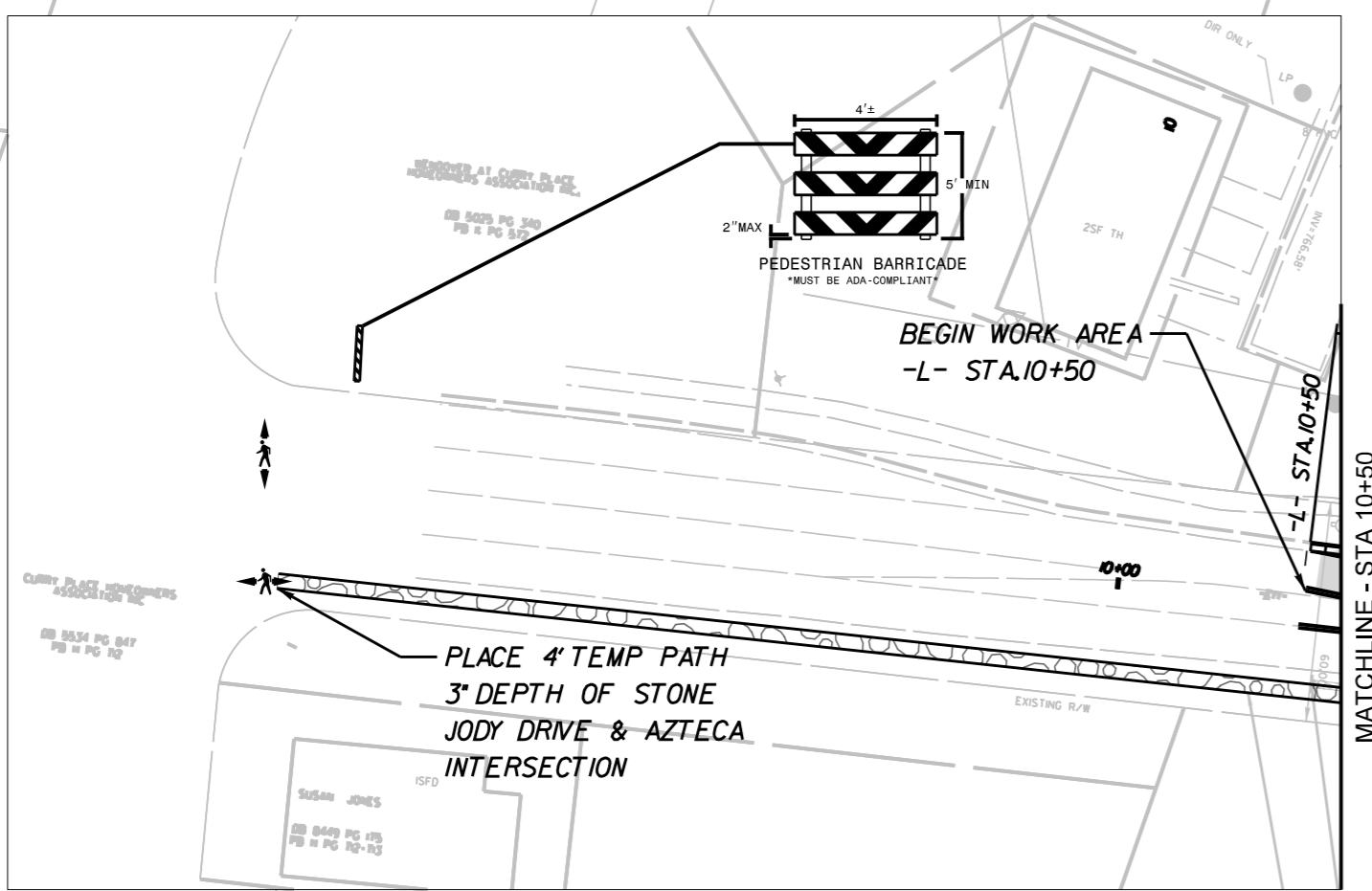

PLACE 4\"/>

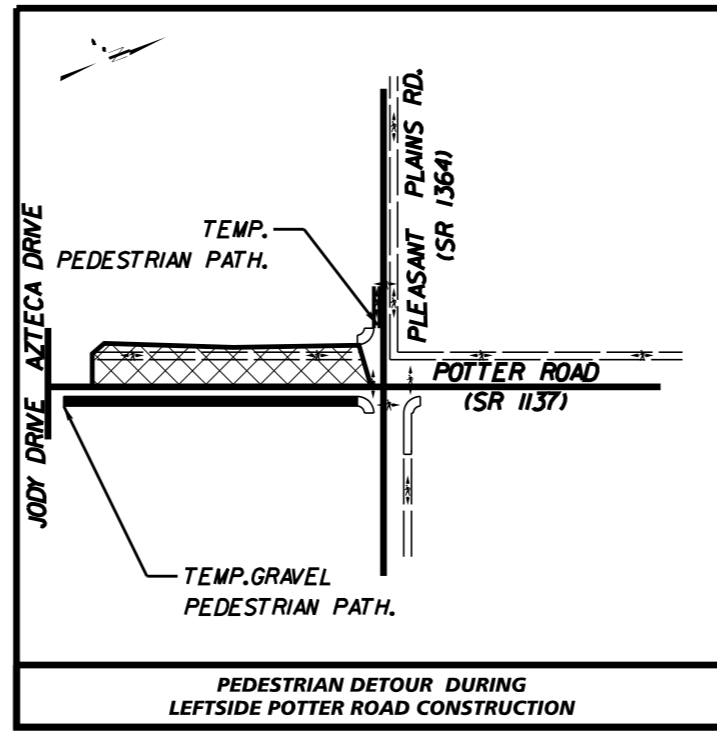

PEDESTRIAN DETOUR DURING  
LEFTSIDE POTTER ROAD CONSTRUCTION

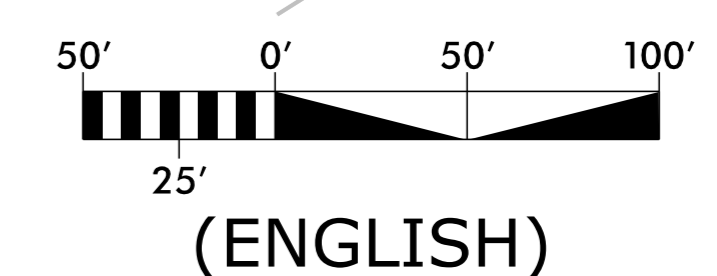

- PAVEMENT REMOVAL
- WEDGING
- WORK AREA

APPROVED: *Frank D. Masters, Jr.* DATE: 1/31/2024

SEAL

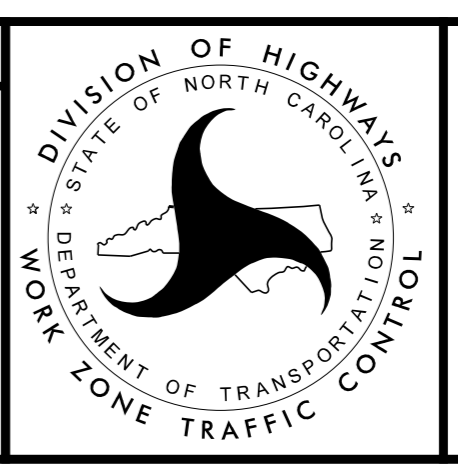

**TRANSPORTATION  
MANAGEMENT  
PLAN**

K:\CHL\_P\N\1036720 - U-5112 (P3) Intersection\Traffic\Contra\TCP\Sheets\U-5112\_rdy\_imp\_bcdgn 1/30/2024



PHASE 3

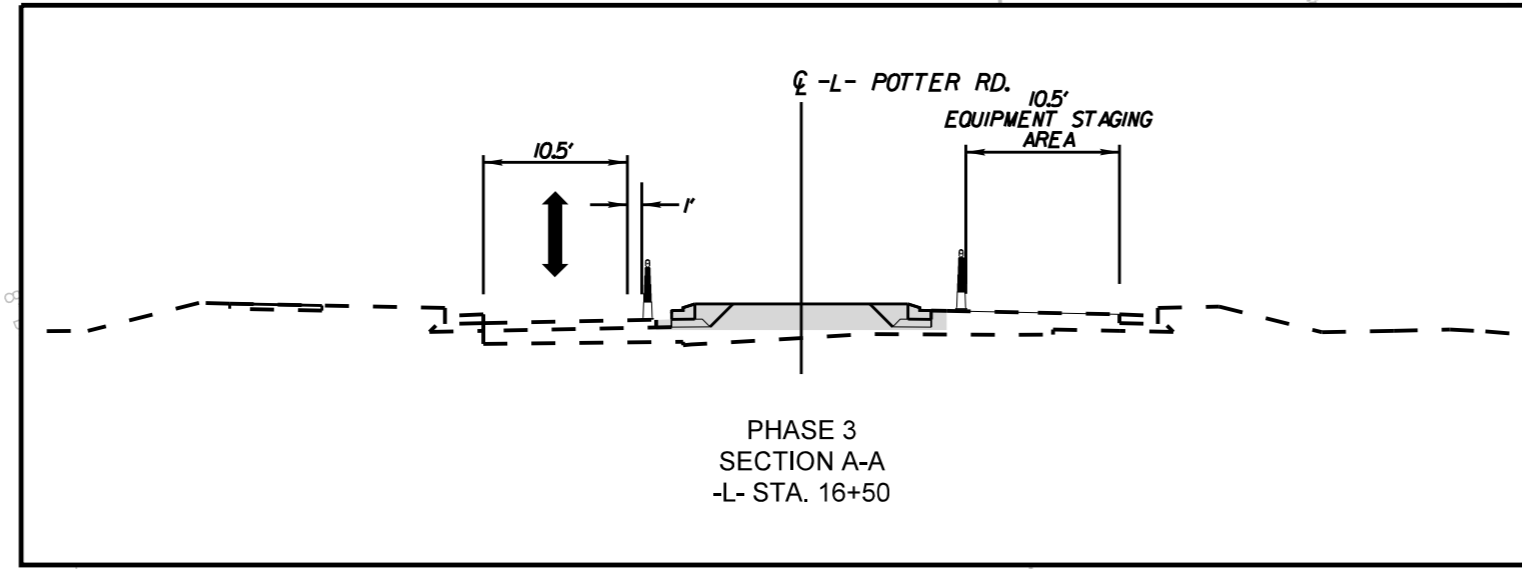
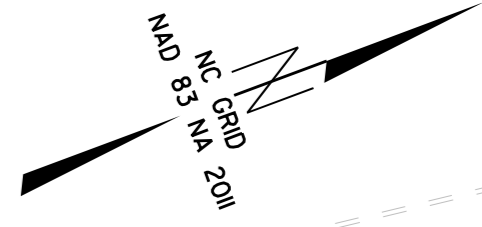

UTILIZE LEFT-TURN LANE AS STAGING AREA TO BUILD MONOLITHIC AND GRASSED MEDIAN

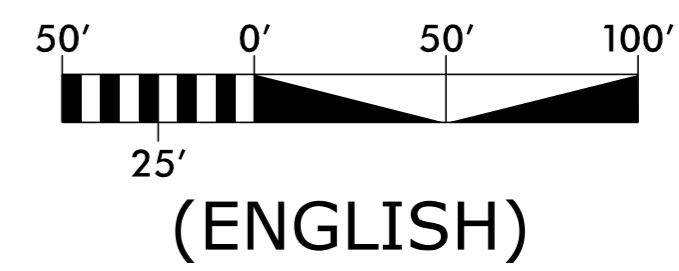

- PAVEMENT REMOVAL
- WEDGING
- WORK AREA

APPROVED: *Frank Masterson* DATE: 1/31/2024

SEAL



TRANSPORTATION MANAGEMENT PLAN

K:\CHL\_PRA\01036720 - U-5112 (P3) Intersection\TrafficControl\TCP\Sheets\U-5112\_rdy\_imp\_7.dgn 1/30/2024



PHASE 3A

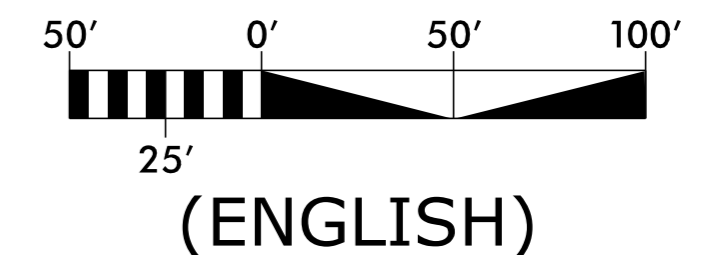
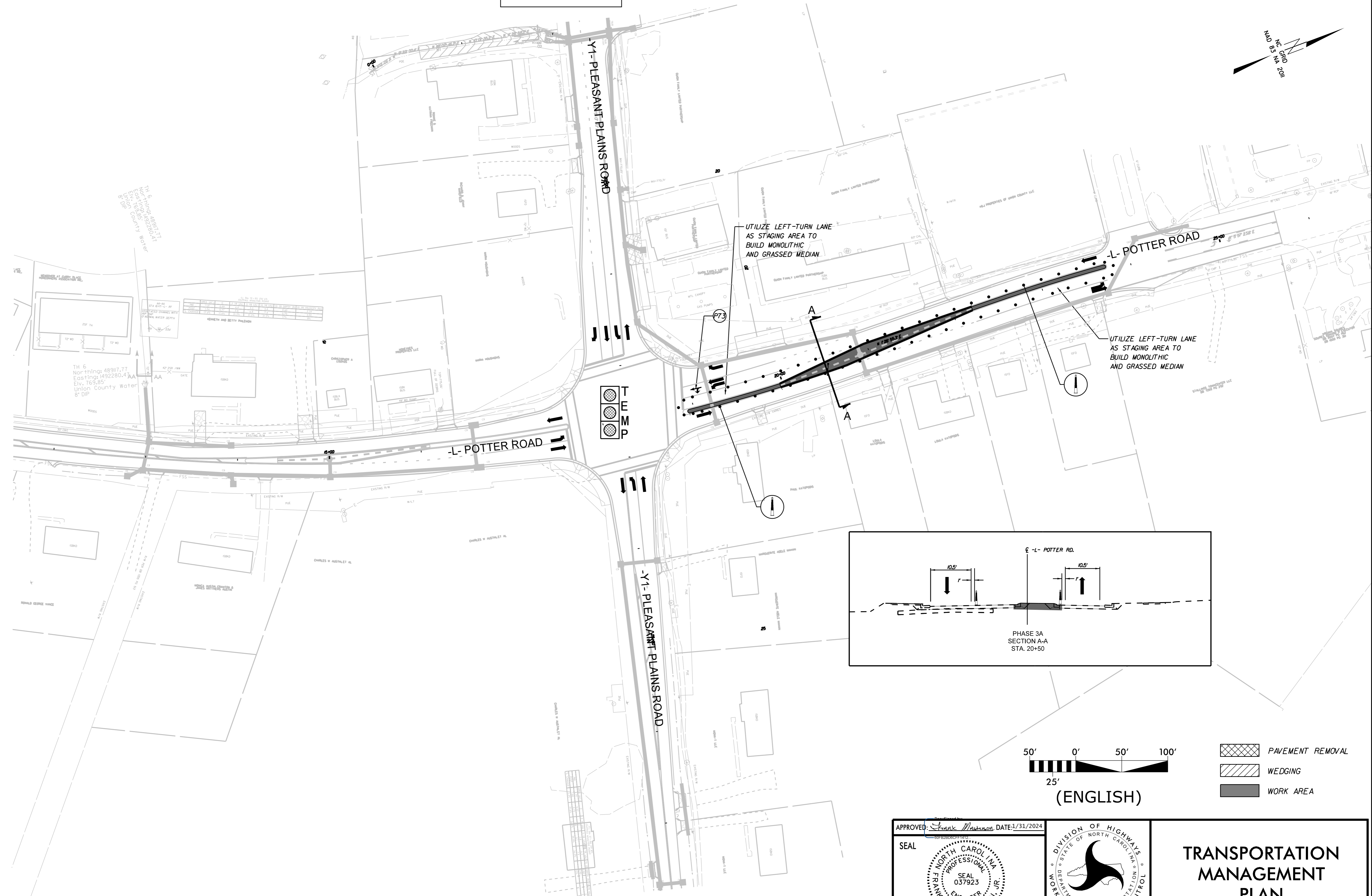
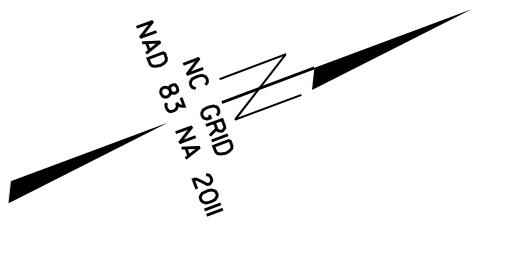

- PAVEMENT REMOVAL
- WEDGING
- WORK AREA

APPROVED: *Frank D. Masterov, Jr.* DATE: 1/31/2024

SEAL

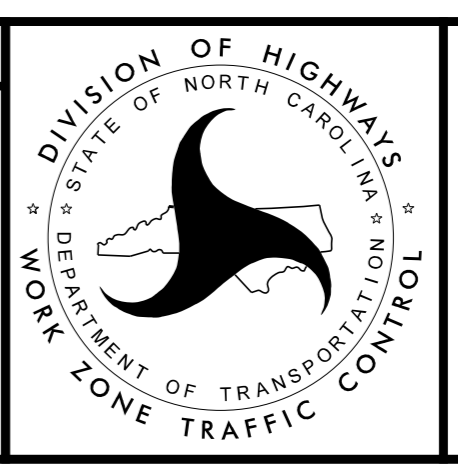

**TRANSPORTATION  
MANAGEMENT  
PLAN**

1/30/2024 K:\CHL\_PR\01036720 - U-5112 (P3 Intersection)\TrafficControl\TCP\Sheets\U-5112\_rdy\_imp\_8.dgn