

UTILITIES BY OTHERS

NOTE:
 ALL PROPOSED UTILITY WORK SHOWN ON THIS SHEET WILL BE DONE BY OTHERS. NO PAYMENT WILL BE MADE TO THE CONTRACTOR FOR PROPOSED UTILITY WORK SHOWN ON THIS SHEET.

- ② CONDUIT OWNER: SEGRA
 CONDUIT LENGTH: 1450'
 CONDUIT QTY: 3
 CONDUIT SIZE: 1.25"
 CONDUIT TYPE: HDPE
 FIBER COUNT: 96CT
 FIBER OWNER: SEGRA
 FIBER LENGTH: 1450'
 NOTES: FROM EXISTING HH-1 AT 0+00, BORE 1450' TO PROPOSED HH-2 ON SHEET 9 AT 14+50
- ⑥ CONDUIT OWNER: SEGRA
 CONDUIT LENGTH: 1450'
 CONDUIT QTY: 3
 CONDUIT SIZE: 1.25"
 CONDUIT TYPE: HDPE
 FIBER COUNT: 96CT
 FIBER OWNER: SEGRA
 FIBER LENGTH: 1450'
 NOTES: ABANDON IN PLACE FROM EXISTING HH-1 AT 0+00, 1450' TO EXISTING HH-2 AT 14+50

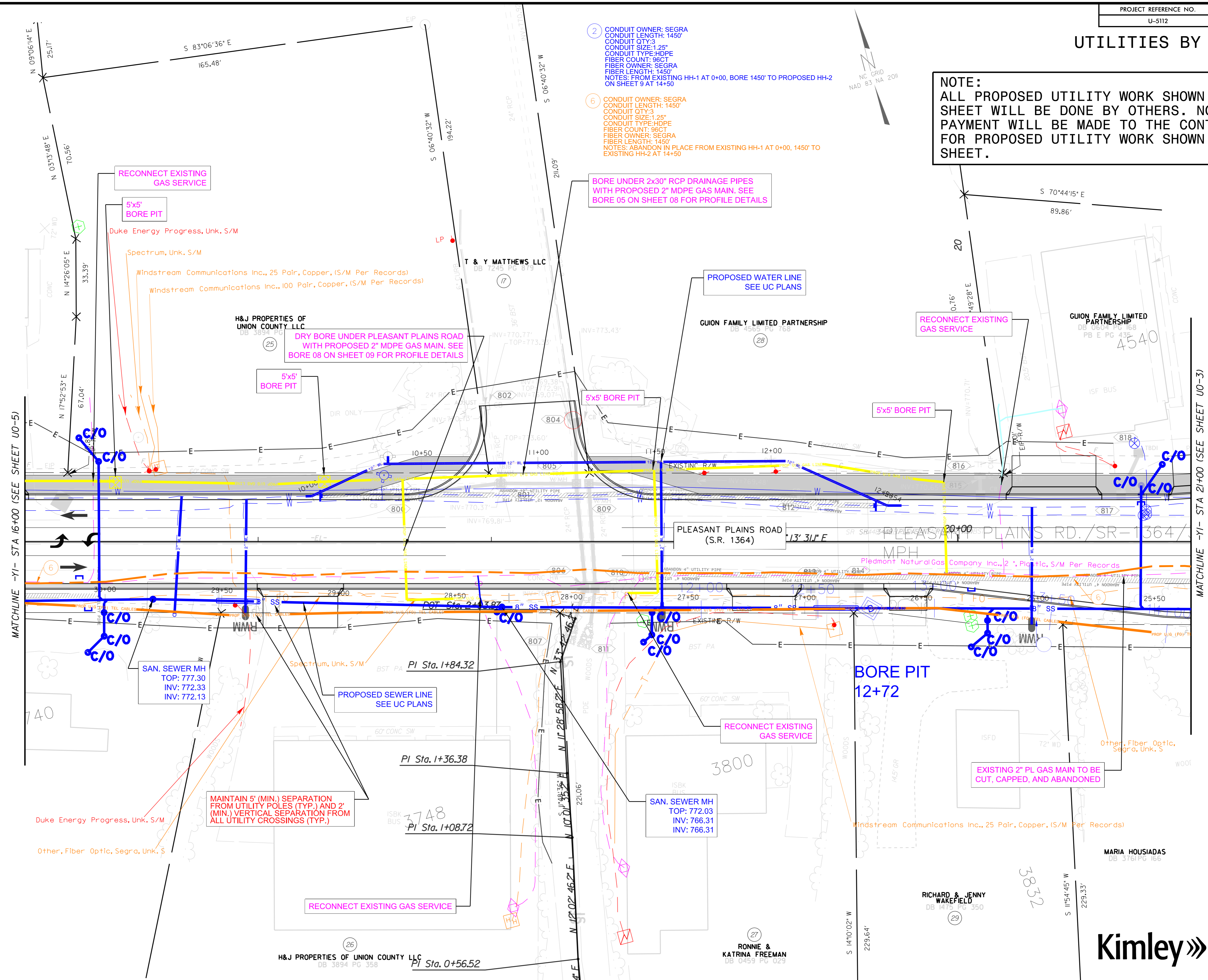

MATCHLINE -YI- STA 16+00 (SEE SHEET U0-5)

MATCHLINE -YI- STA 21+00 (SEE SHEET U0-3)

MAINTAIN 5' (MIN.) SEPARATION FROM UTILITY POLES (TYP.) AND 2' (MIN.) VERTICAL SEPARATION FROM ALL UTILITY CROSSINGS (TYP.)

12/12/2023 K:\CHL\PROJ\01036720 - U-5112 (P3) Inter section\U0\0\Pro\U-5112_rdy_lob_6.dgn