

PHASE 2

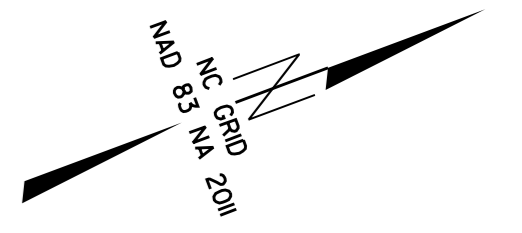

MATCHLINE - STA.19+00
SEE SHEET TCP-5

CONTRACTOR TO MAINTAIN
ACCESS TO ALL DRIVEWAYS
WITHIN THE PROJECT LIMITS (TYP.)

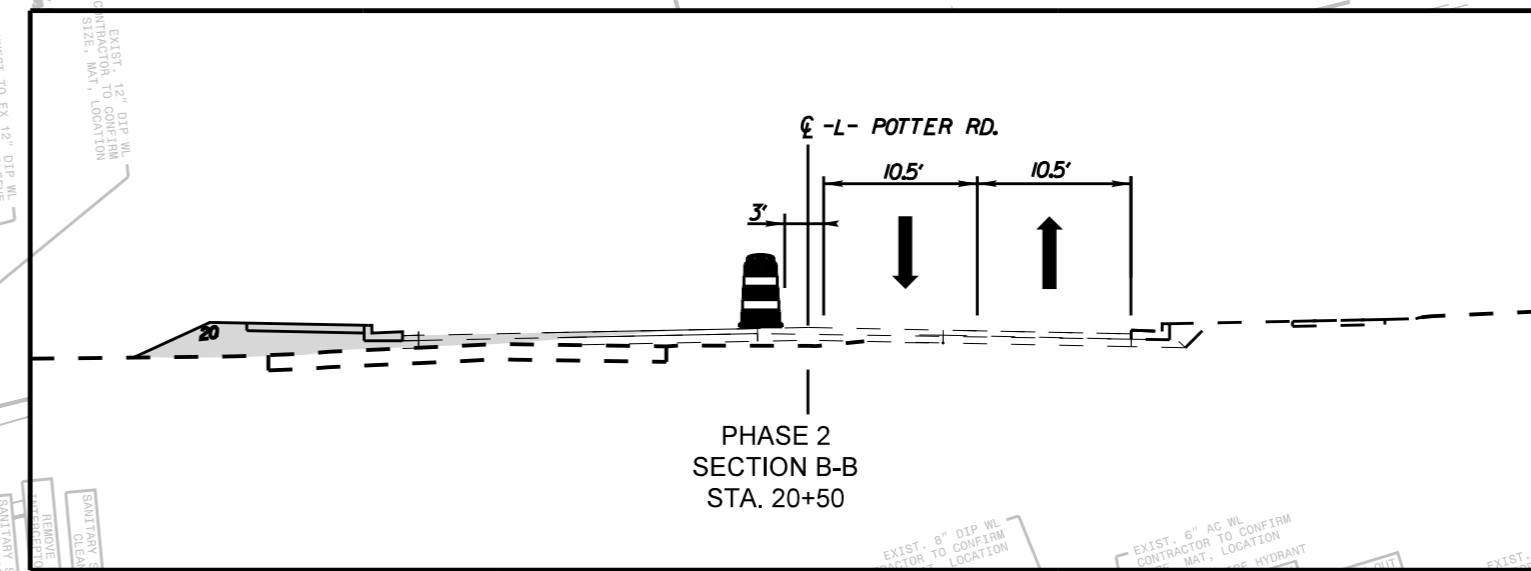
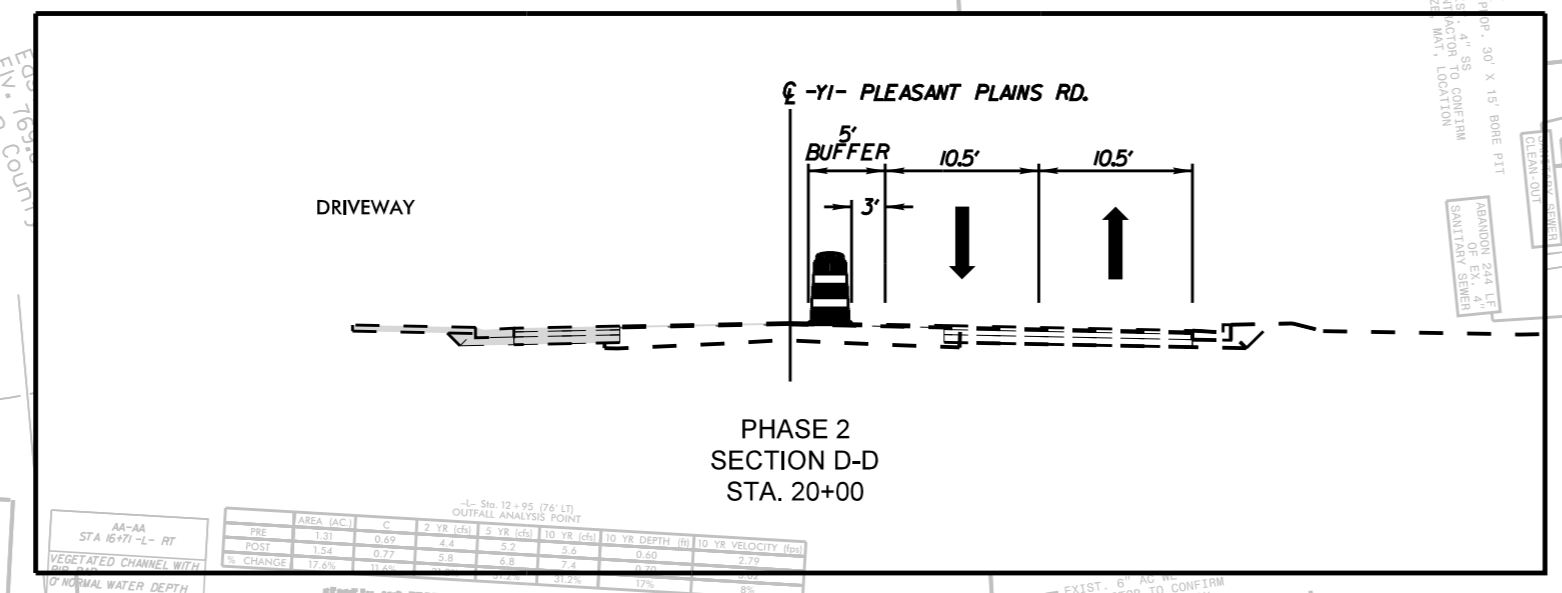

SEE PEDESTRIAN
DETOUR 2 SHEET
TMP-1C

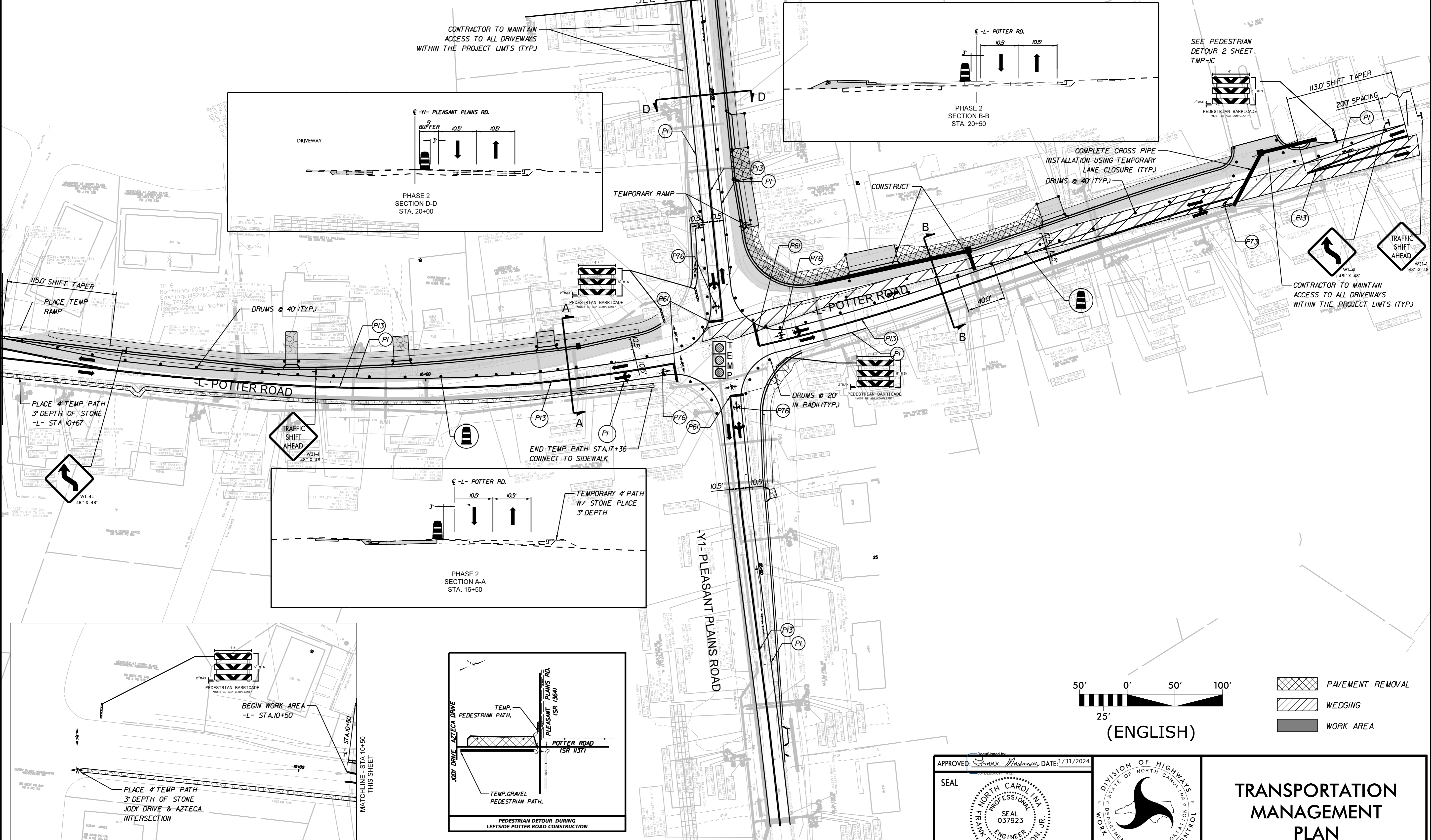

115.0' SHIFT TAPER
PLACE TEMP RAMP

PLACE 4" TEMP PATH
3" DEPTH OF STONE
-L- STA 10+67

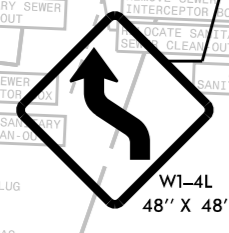

END TEMP PATH STA.17+36
CONNECT TO SIDEWALK

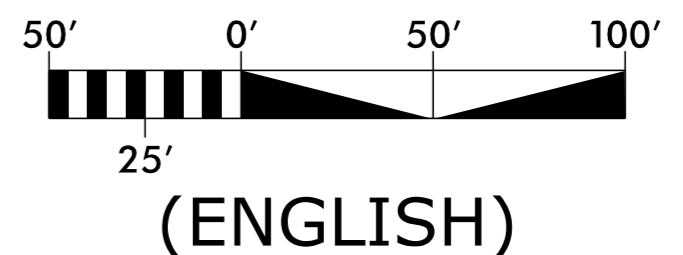
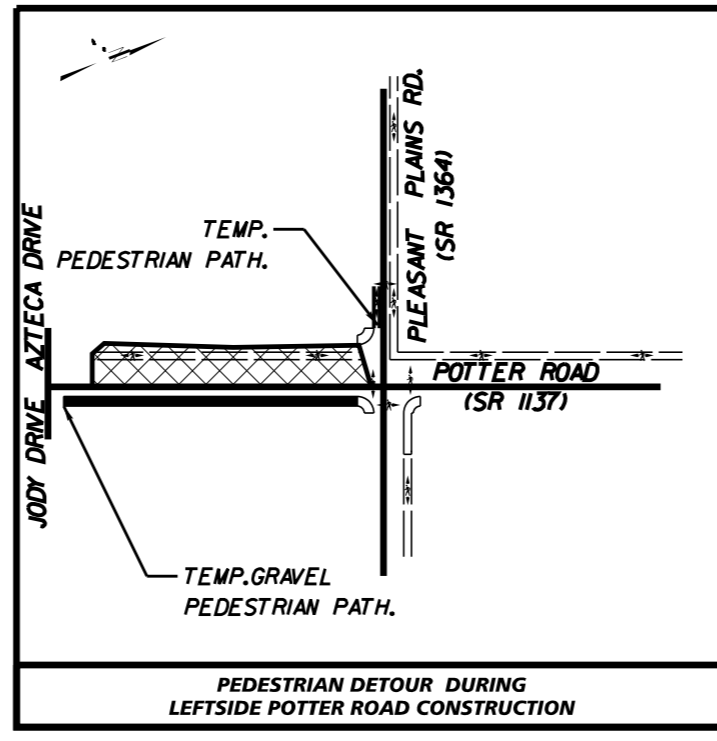
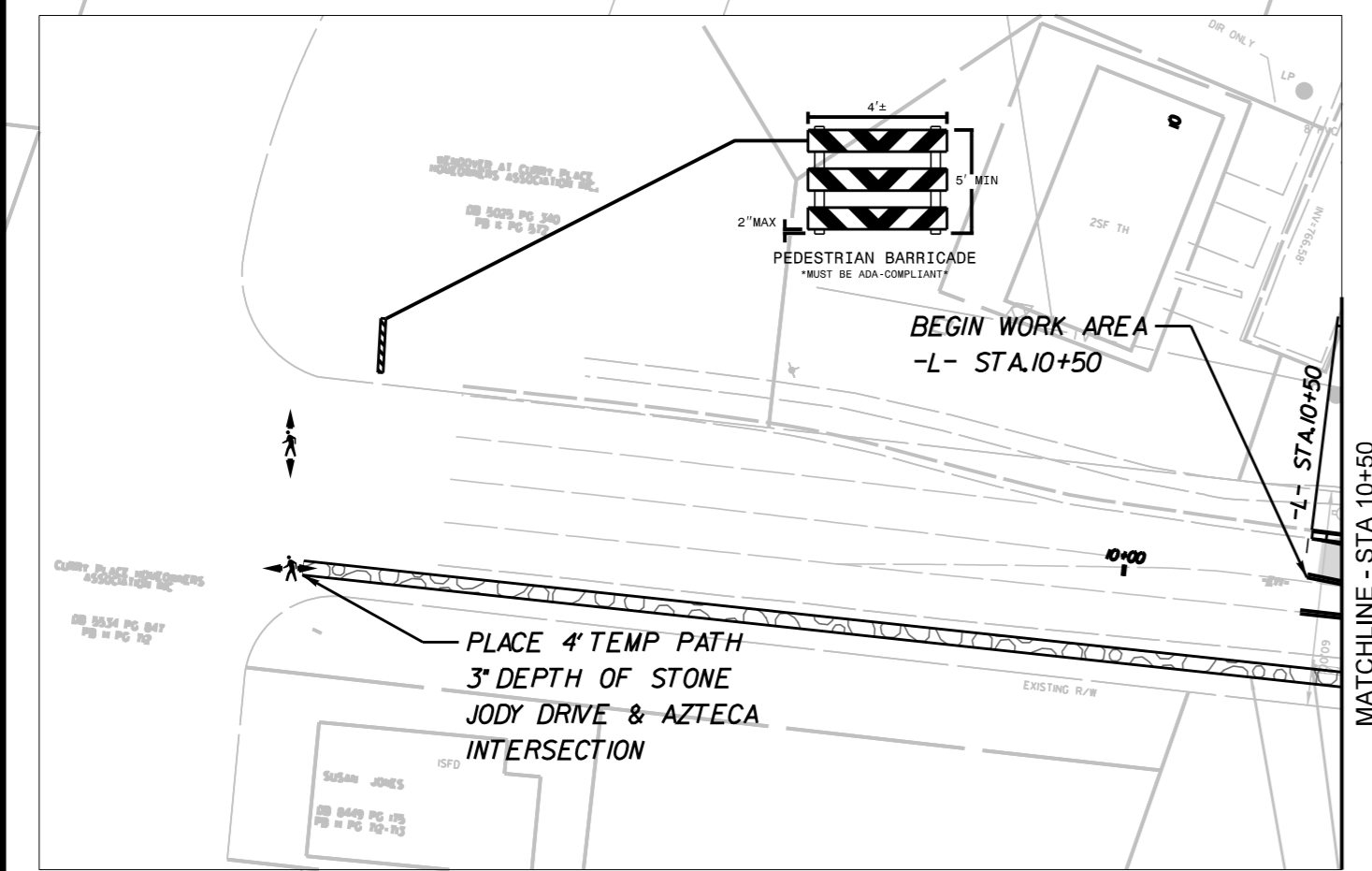
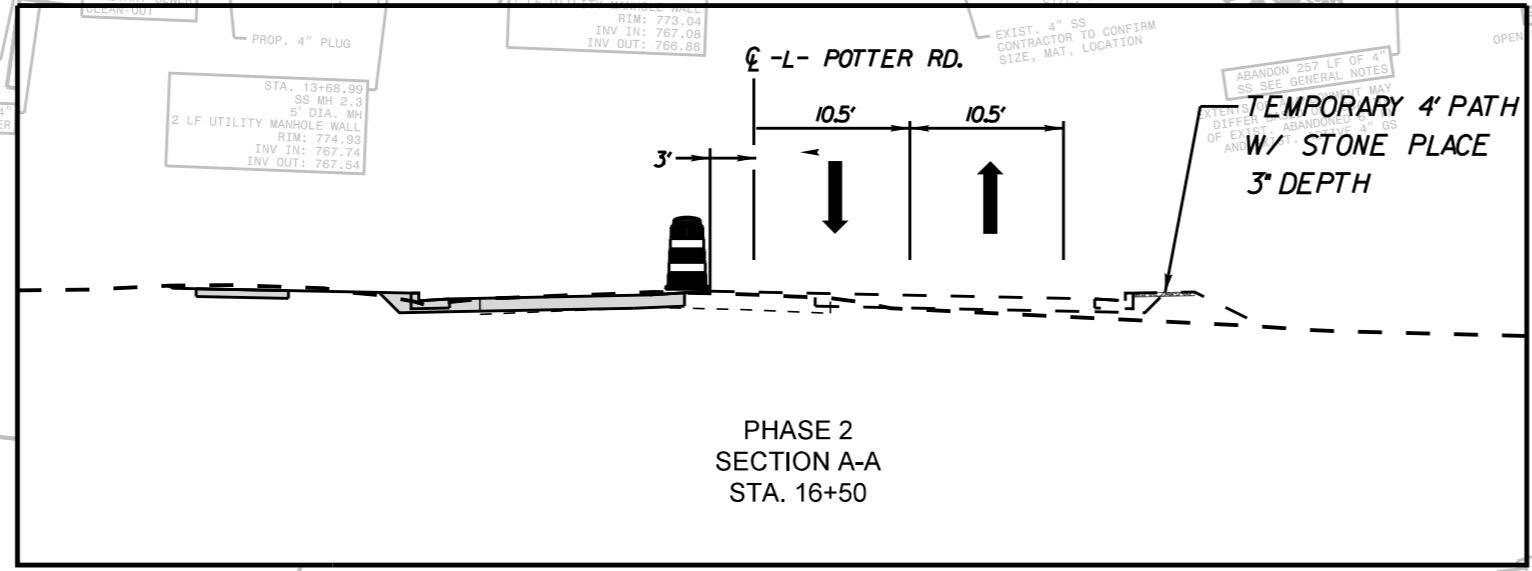

- PAVEMENT REMOVAL
- WEDGING
- WORK AREA

APPROVED: *Frank D. Masters, Jr.* DATE: 1/31/2024

SEAL

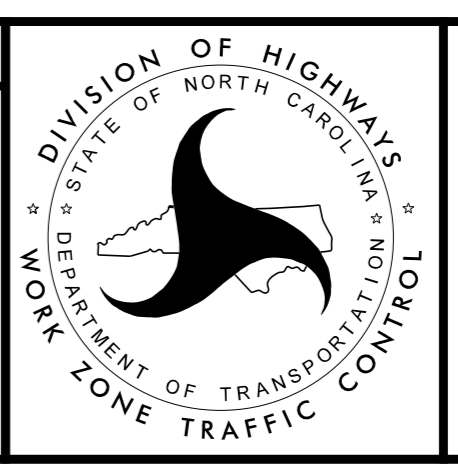

**TRANSPORTATION
MANAGEMENT
PLAN**

K:\CHL_P\N\1036720 - U-5112 (P3) Intersection\Traffic\Contra\TCP\Sheets\U-5112_rdy_imp_bcdgn 1/30/2024