

STATE OF NORTH CAROLINA
DIVISION OF HIGHWAYS

TRANSPORTATION MANAGEMENT PLAN

UNION COUNTY

LOCATION: SR 1357 (POTTER ROAD) FROM AZTECA DRIVE TO SR 1099 (OLD MONROE ROAD), AND SR 1364 (PLEASANT PLAINS ROAD) FROM AURORA BOULEVARD TO LAKEWOOD DRIVE; CONSTRUCT LEFT AND RIGHT TURN LANES ON EXISTING LOCATION

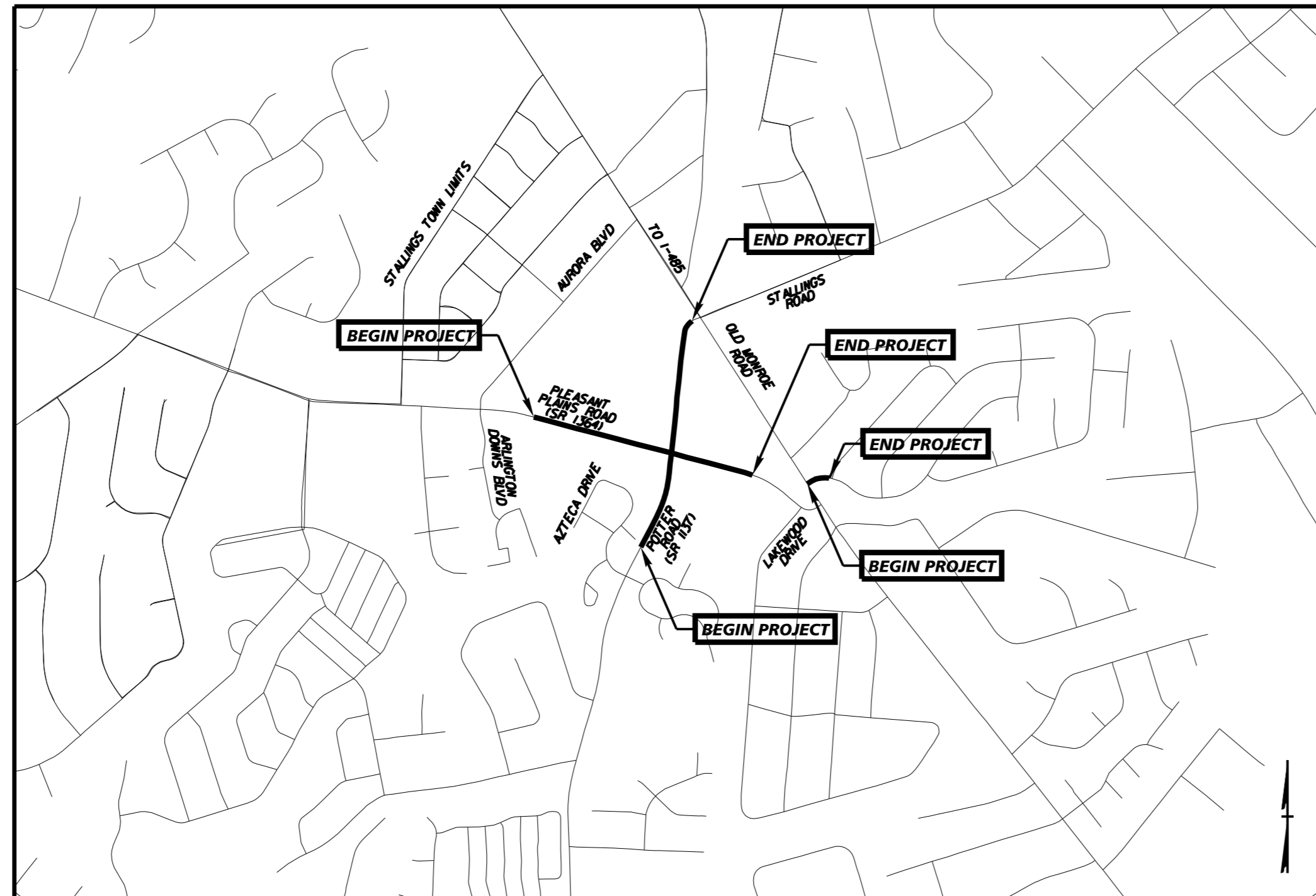
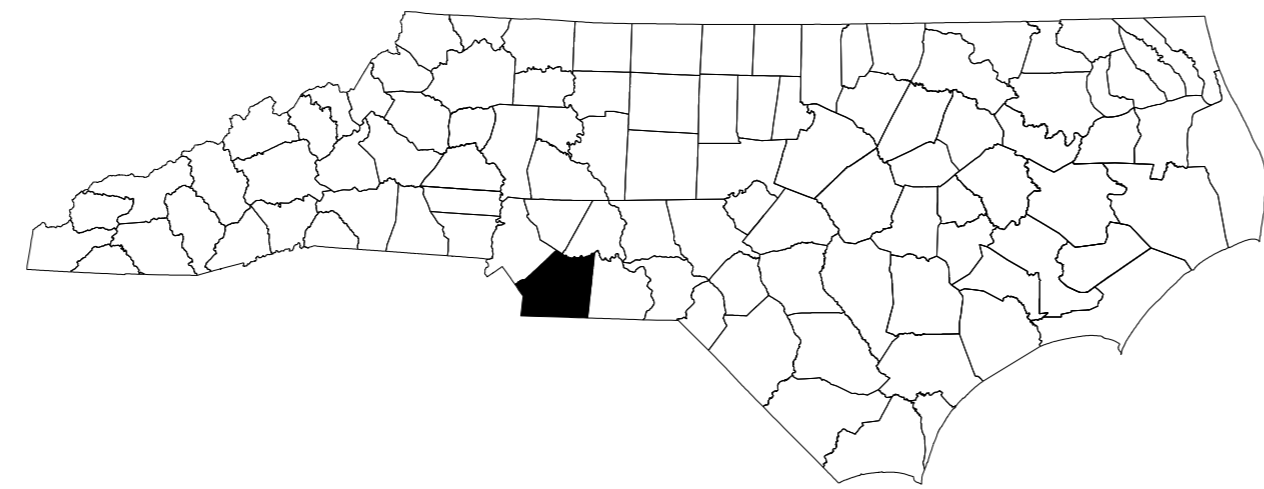

VICINITY MAP

INDEX OF SHEETS	
SHEET NO.	TITLE
TMP-1	TITLE SHEET, VICINITY MAP, AND INDEX OF SHEETS
TMP-1A THRU TMP-1C	LIST OF APPLICABLE ROADWAY STANDARD DRAWINGS, LEGEND, TEMPORARY PAVEMENT MARKINGS, MANAGEMENT STRATEGIES, AND GENERAL NOTES
TMP-2	CONSTRUCTION PHASING
TMP-2A	DETOUR SHEET
TMP-3 THRU TMP-4	PHASE 1
TMP-5 THRU TMP-6	PHASE 2
TMP-7	PHASE 3
TMP-8	PHASE 3A

SHEET NO.
TMP-1

U-5112

TIP PROJECT:

Kimley»Horn

FRANK MASTERSON, P.E. TRAFFIC CONTROL PROJECT ENGINEER

ANDREW WEEKS, E.I. TRAFFIC CONTROL PROJECT DESIGN ENGINEER

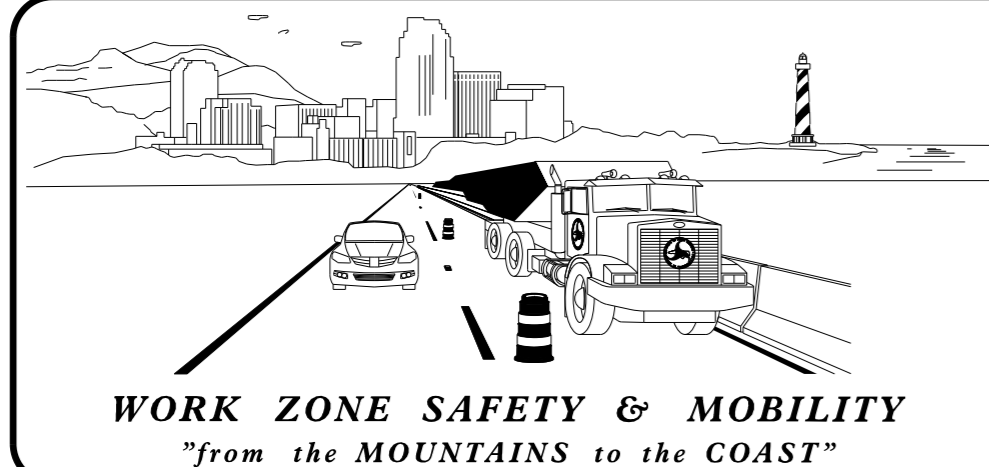

PLANS PREPARED BY:

FRANK MASTERSON, PE
PROJECT ENGINEER

ANDREW WEEKS, EI
PROJECT DESIGN ENGINEER

NCDOT CONTACTS:

TRAVIS PRESLAR, PE
DIVISION 10 - TEAM LEAD

YANWEI MA, PE
DMSTIP - PROJECT MANAGER



APPROVED: *Frank Masterson*

DATE: 1/31/2024

SEAL

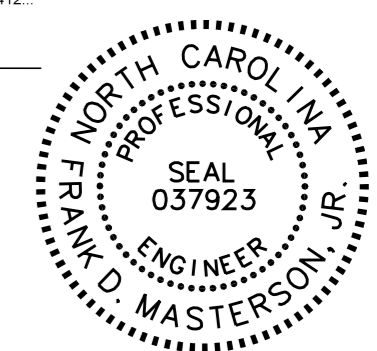

K:\CHL_P\PRJ\01036720 - U-5112 (P3 Intersection)\TrafficControl\CP\Sheets\U-5112_rdy_imp_ldgn 1/30/2024